



### PART150 STUDY

RECEIVED  
MAY 5 2009  
PLANNING  
DIVISION

### 2007 NOISE EXPOSURE MAP

PREPARED BY:



IN COORDINATION WITH:



Source: RSH & ESA Analysis (2008)

#### LEGEND

	PROPERTY LINE		65 DnL NOISE CONTOUR
	75 DnL NOISE CONTOUR		60 DnL NOISE CONTOUR
	70 DnL NOISE CONTOUR		55 DnL NOISE CONTOUR



### FIGURE 6-1

PART150 STUDY

RECEIVED  
MAY 5 2009

PLANNING  
DIVISION

2012 NOISE  
EXPOSURE MAP

PREPARED BY:

**RS&H**  
IMPROVING YOUR WORLD

IN COORDINATION WITH:

ESA Airports





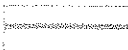

FIGURE 6-2

RSH AEP PROJECT NUMBER  
201-3363-020



Source: RSH & ESA Analysis (2008)

LEGEND

	PROPERTY LINE		65 DnL NOISE CONTOUR
	75 DnL NOISE CONTOUR		60 DnL NOISE CONTOUR
	70 DnL NOISE CONTOUR		55 DnL NOISE CONTOUR



# GAINESVILLE REGIONAL AIRPORT

PART 150 STUDY

RECEIVED

MAY 5 2009

PLANNING DIVISION

## NOISE SENSITIVE SITES MAP (2007)

PREPARED BY:



IN COORDINATION WITH

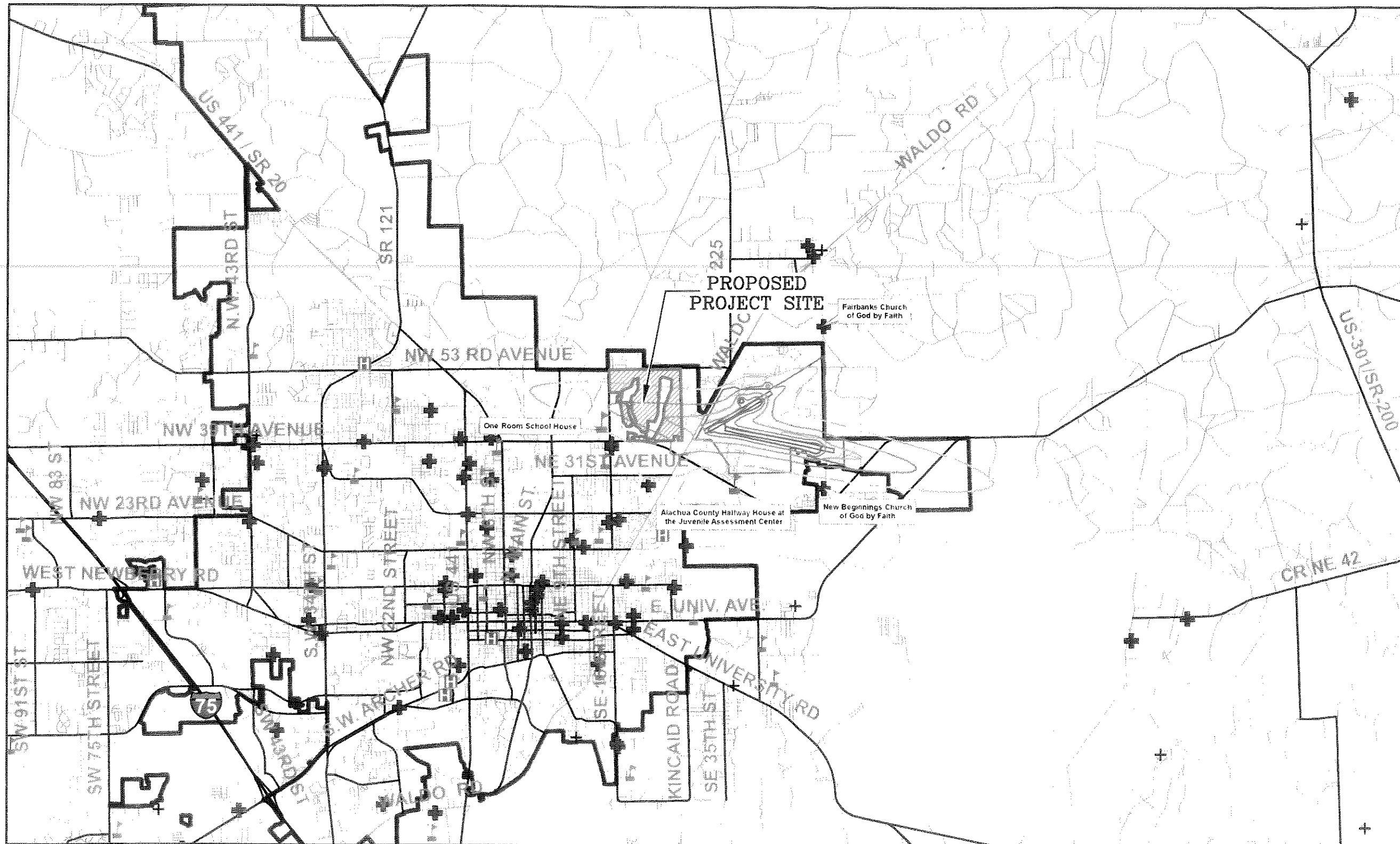

Source: FGDL (2008), RS& H and ESA Analysis (2008)

### Legend - Noise Sensitive Sites



Airport Boundary



City/County Boundary



Roads



Schools



Hospital



Churches



Cemetery



Recreational Areas

### 2007 Noise Contours

55 DnL

60 DnL

65 DnL

70 DnL

75 DnL



DRAFT

FIGURE 7-5(A)



PART 150 STUDY

RECEIVED  
MAY 5 2009  
PLANNING  
DIVISION

NOISE SENSITIVE  
SITES MAP  
(2012)

PREPARED BY:



IN COORDINATION WITH



FIGURE 7-5(B)

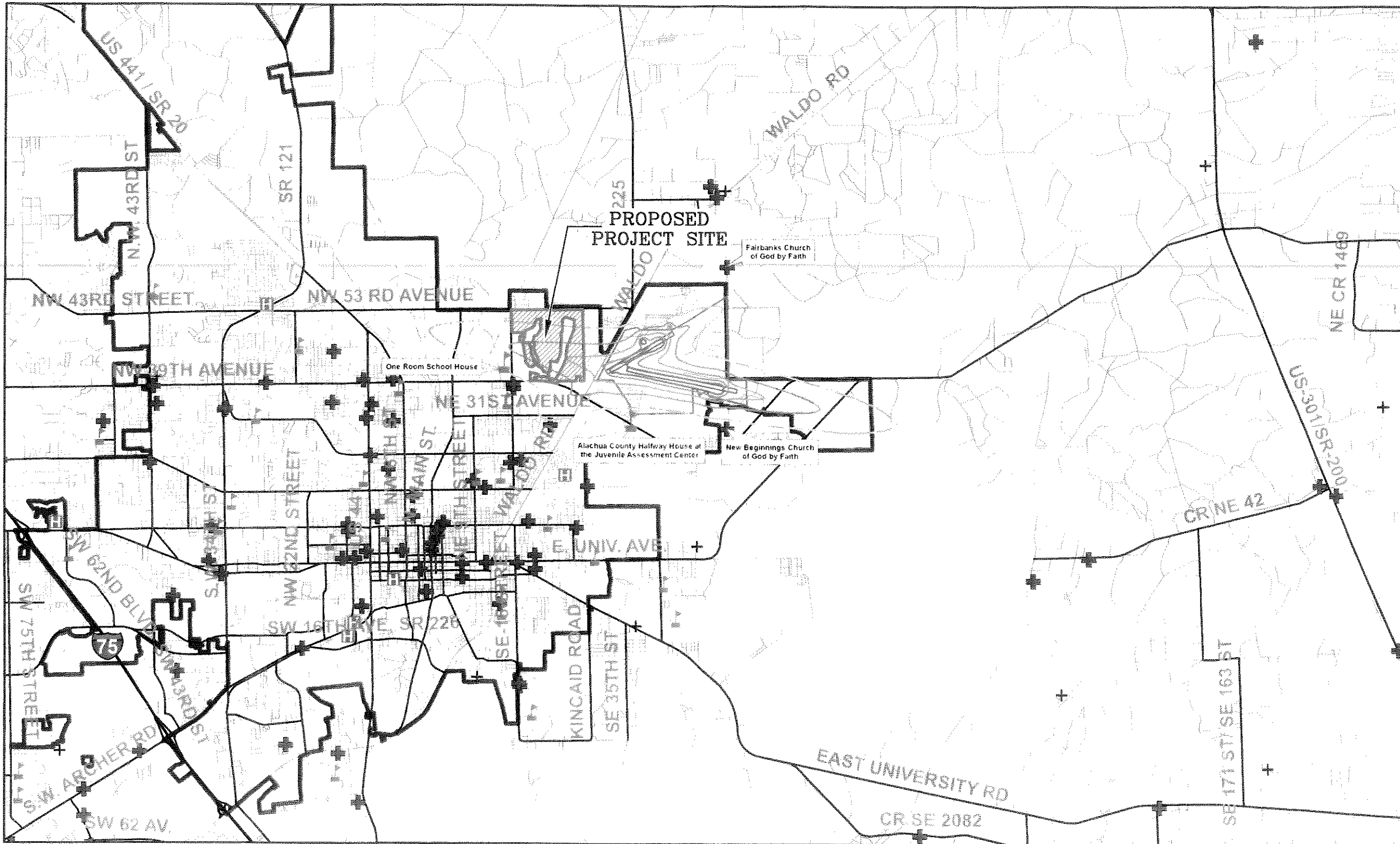

Source: FGDL (2008), RS& H and ESA Analysis (2008)

Legend - Noise Sensitive Sites

- Airport Boundary
- City/County Boundary
- Roads
- Schools
- Hospital
- Churches
- Cemetery
- Recreational Areas

2012 Noise Contours

- 55 DnL
- 60 DnL
- 65 DnL
- 70 DnL
- 75 DnL

DRAFT

