

LEGISLATIVE #





120639D

Exhibit A-3: Historic Preservation Map Series (6 maps)

FUTURE LAND USE ELEMENT

Northeast Gainesville Residential Historic District

Legend

-  Historic District Boundary
-  Added in 1997
- Historic Structures Status**
-  Contributing
-  Non-Contributing

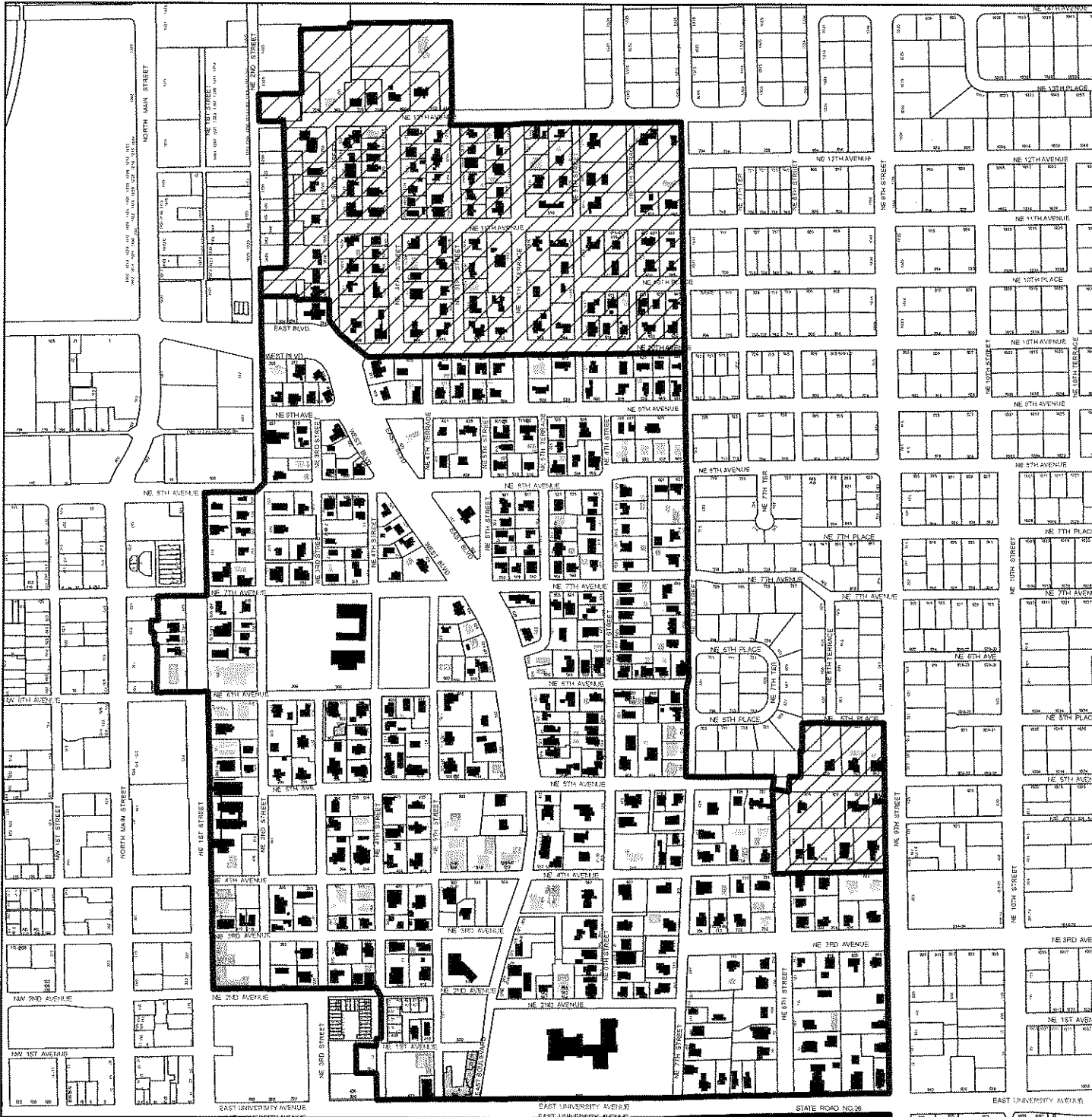

City of Gainesville Gainesville, Florida

Prepared by the Planning and
Development Services Department
February 2011

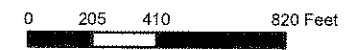

FUTURE LAND USE ELEMENT

Pleasant Street Historic District

Legend

 Historic District Boundary

Historic Structures

Status

 Contributing

 Non-Contributing

City of Gainesville Gainesville, Florida

Prepared by the Planning and
Development Services Department
February 2011

0 125 250 500 Feet

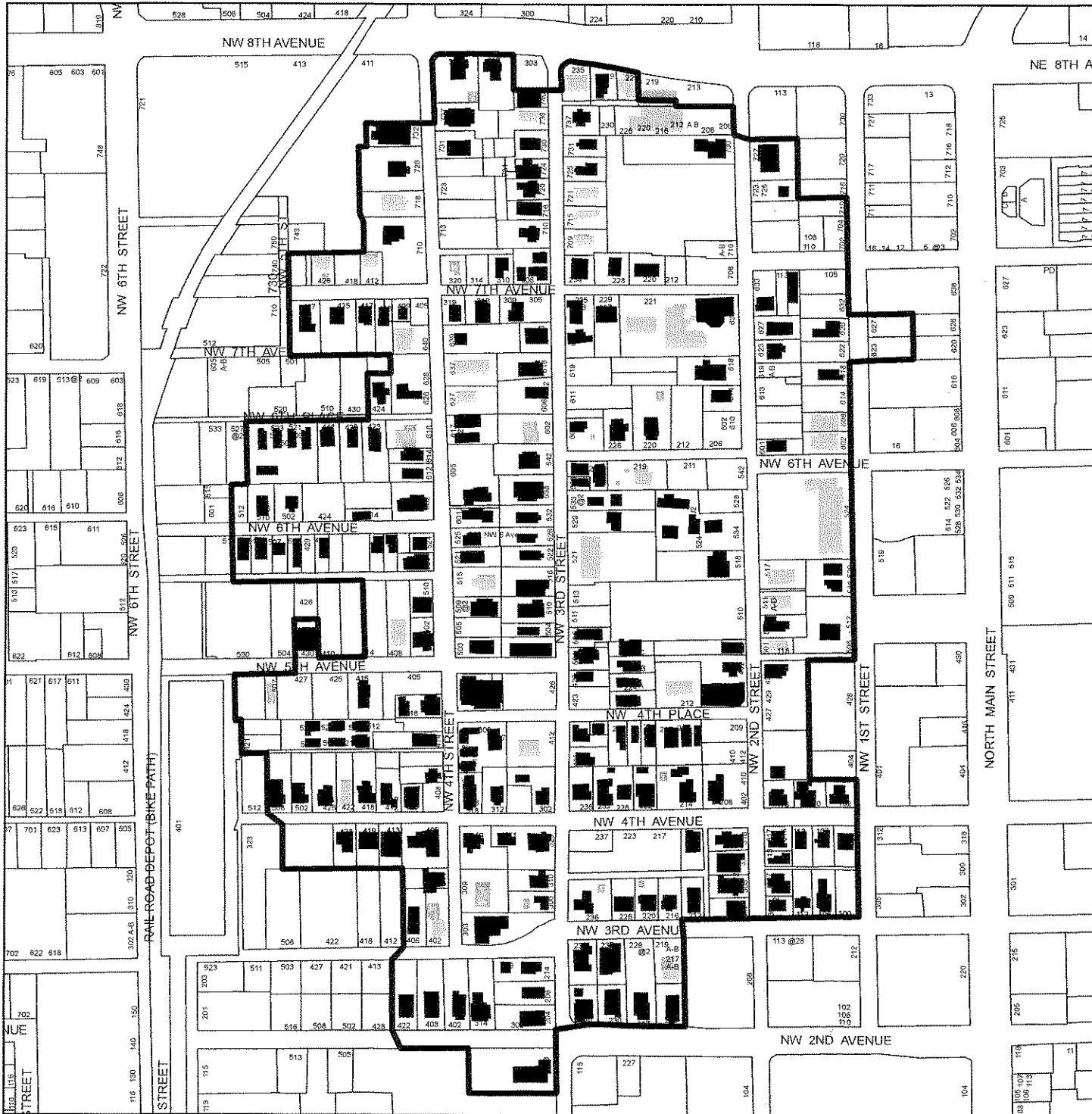

FUTURE LAND USE ELEMENT

Southeast Gainesville Historic District

Legend

 Historic District Boundary

Historic Structures

Status

 Contributing

 Non-Contributing

City of Gainesville Gainesville, Florida

Prepared by the Planning and
Development Services Department
February 2011

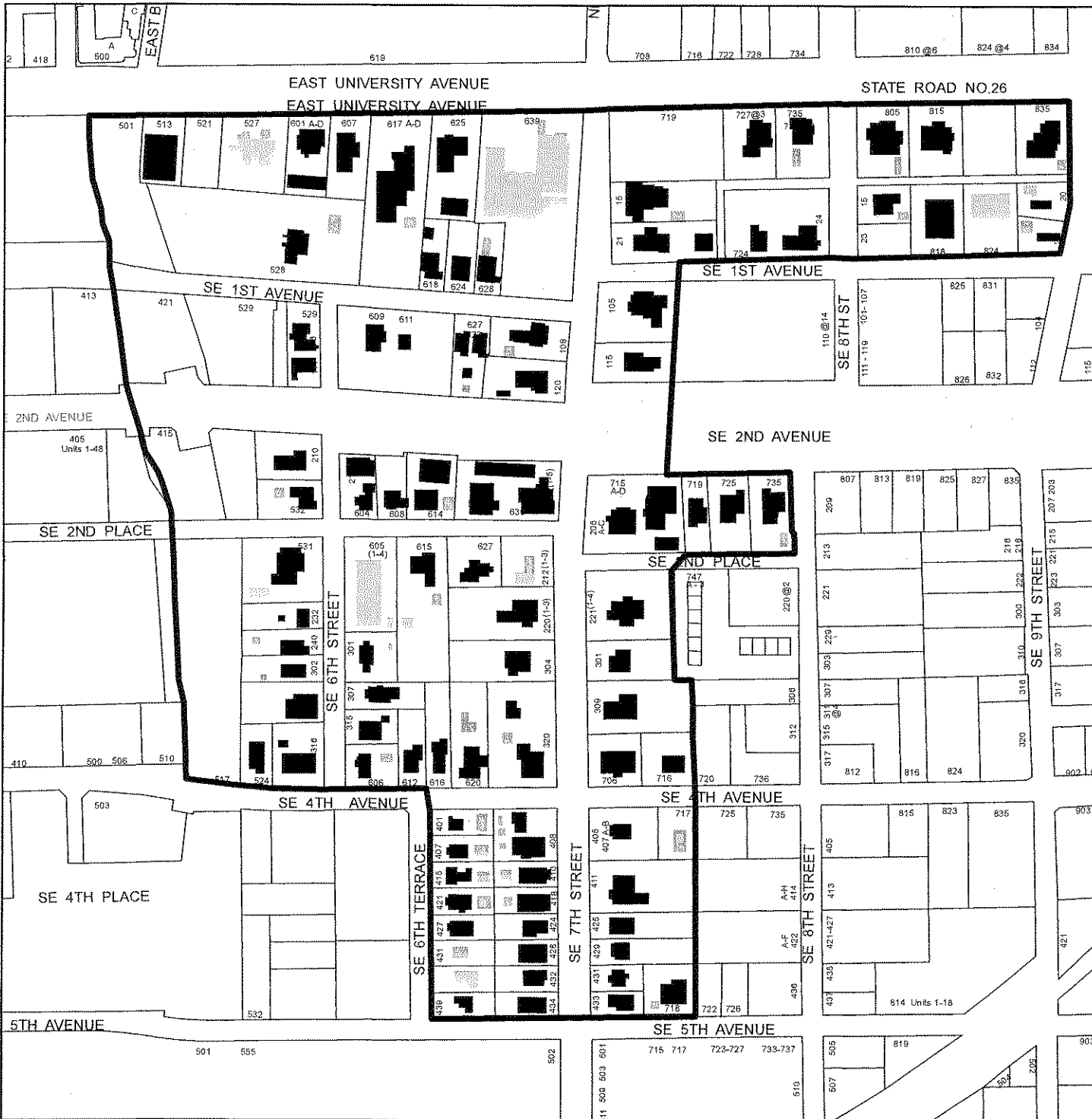

0 100 200 400 Feet



FUTURE LAND USE ELEMENT

University Heights Historic District - North

Legend

-  Historic District Boundary
- Historic Structures Status**
-  Contributing
-  Non-Contributing

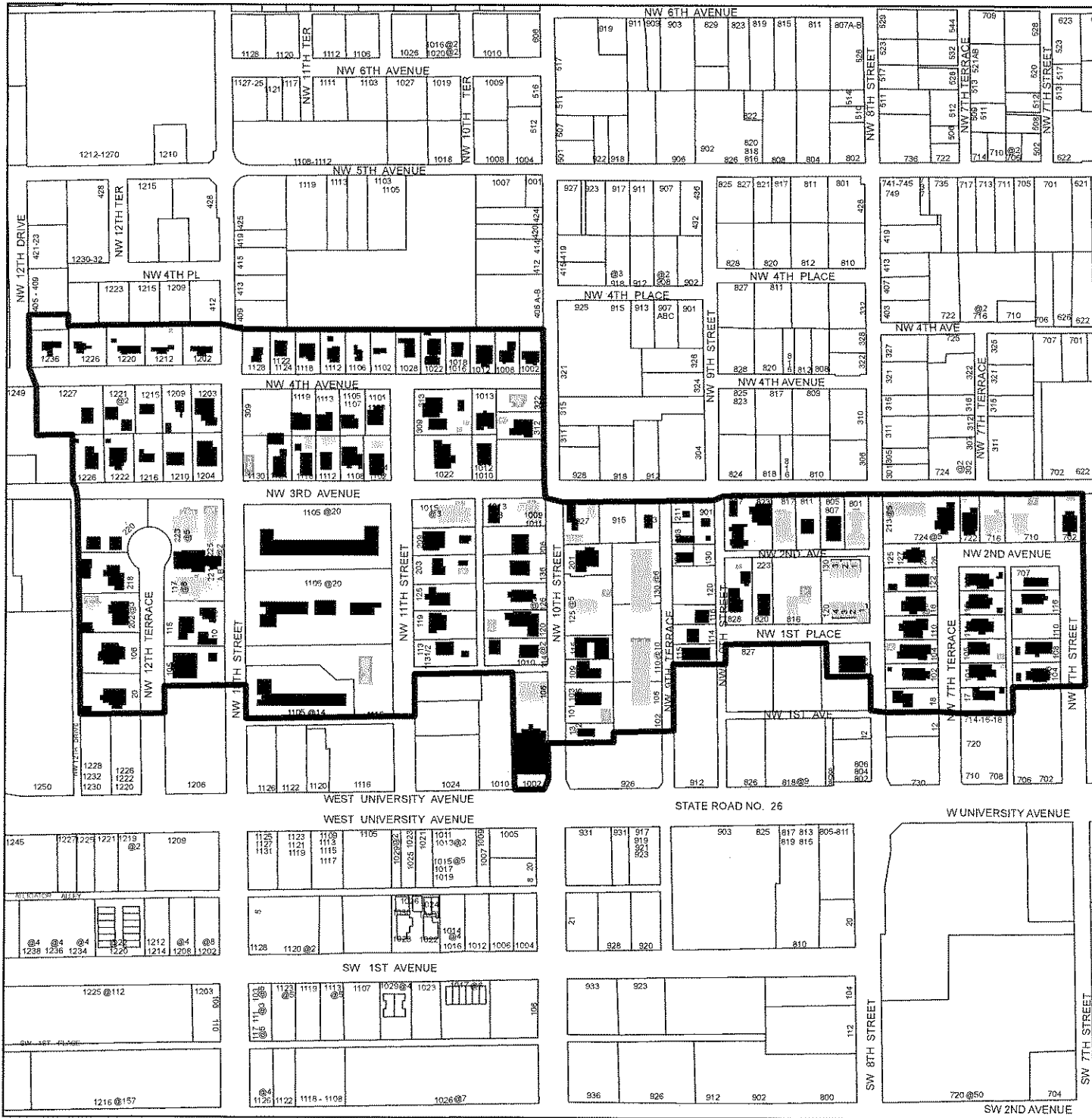

City of Gainesville Gainesville, Florida

Prepared by the Planning and
Development Services Department
February 2011

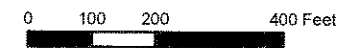



FUTURE LAND USE ELEMENT

University Heights Historic District - South

Legend

 Historic District Boundary

Historic Structures Status

-  Contributing
-  Non-Contributing

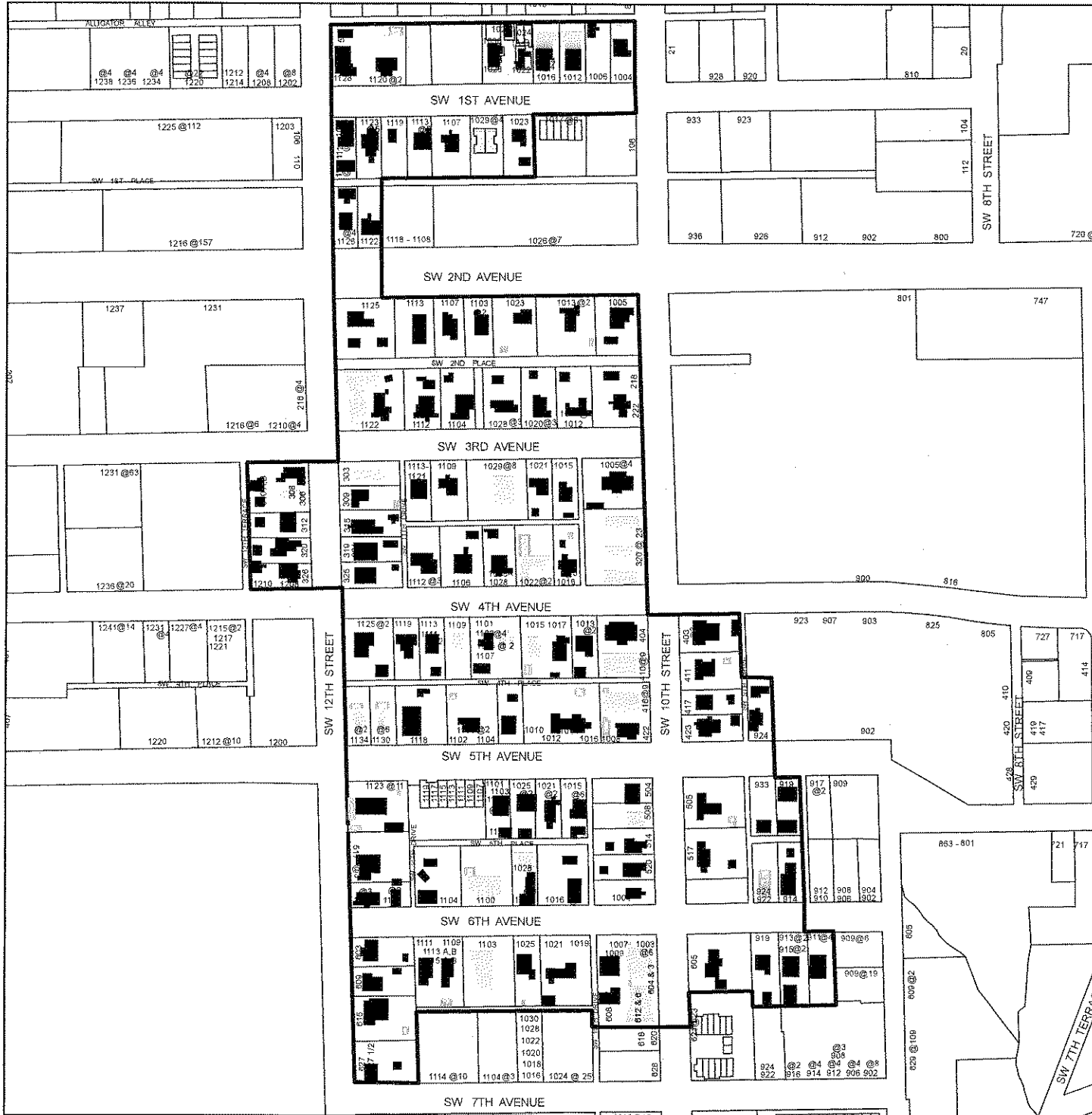

City of Gainesville Gainesville, Florida

Prepared by the Planning and
Development Services Department
February 2011

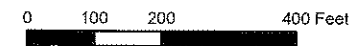

FUTURE LAND USE ELEMENT

Designated Historically Significant Properties

Legend

- Designated Historically Significant Properties
- City Limits

- 1 - Baird Hardware Company Warehouse (N)
- 2 - Boulware Springs (N)
- 3 - Star Garage (N)
- 4 - Cox Furniture Store (N)
- 5 - Cox Furniture Warehouse (N)
- 6 - Masonic Order Lodge #41 (N)
- 7 - Shady Grove Primitive Baptist Church (N)
- 8 - Bethel Gas Station (L)
- 9 - 8 SW 10th Street (L)
- 10 - Baldwin House (L)
- 11 - A Quinn Jones House (L)
- 12 - Bailey House (B)
- 13 - Hippodrome State Theater (B)
- 14 - Seagle Building (B)
- 15 - Old Gainesville Depot (B)

(N) Listed on National Register
 (L) Listed on Local Register
 (B) Listed on National and Local Register
 *Historically Significant Properties that are located in a designated Historic District are not shown on this map.

City of Gainesville Gainesville, Florida

Prepared by the Planning and Development Services Department
February 2012

1,500 750 0 1,500 Feet

