



EXHIBIT
C-1
 tabbles

AERIAL PHOTOGRAPH

 <p>No Scale</p>	<p>Name</p> <p>Eng. Denman and Associates, agent for the City of Gainesville</p>	<p>Petition Request</p> <p>Rezone from I-2 to BI and CON</p>	<p>Map(s)</p> <p>3357</p>	<p>Petition Number</p> <p>PB-11-14 ZON</p>	<p>100790C</p>
---	--	---	----------------------------------	---	-----------------------

Land Use Designations

- SF Single Family (up to 8 du/acre)
- RL Residential Low Density (up to 12 du/acre)
- RM Residential Medium Density (8-30 du/acre)
- RH Residential High Density (8-100 du/acre)
- MUR Mixed Use Residential (up to 75 du/acre)
- MUL Mixed Use Low Intensity (8-30 du/acre)
- MUM Mixed Use Medium Intensity (12-30 du/acre)
- MUH Mixed Use High Intensity (up to 150 du/acre)
- UMU1 Urban Mixed Use 1 (up to 75 du/acre)
- UMU2 Urban Mixed Use 2 (up to 100 du/acre)

- O Office
- C Commercial
- IND Industrial
- E Education
- REC Recreation
- CON Conservation
- AGR Agriculture
- PF Public Facilities
- PUD Planned Use District

--- Division line between two land use districts

— City Limits

Area under petition consideration

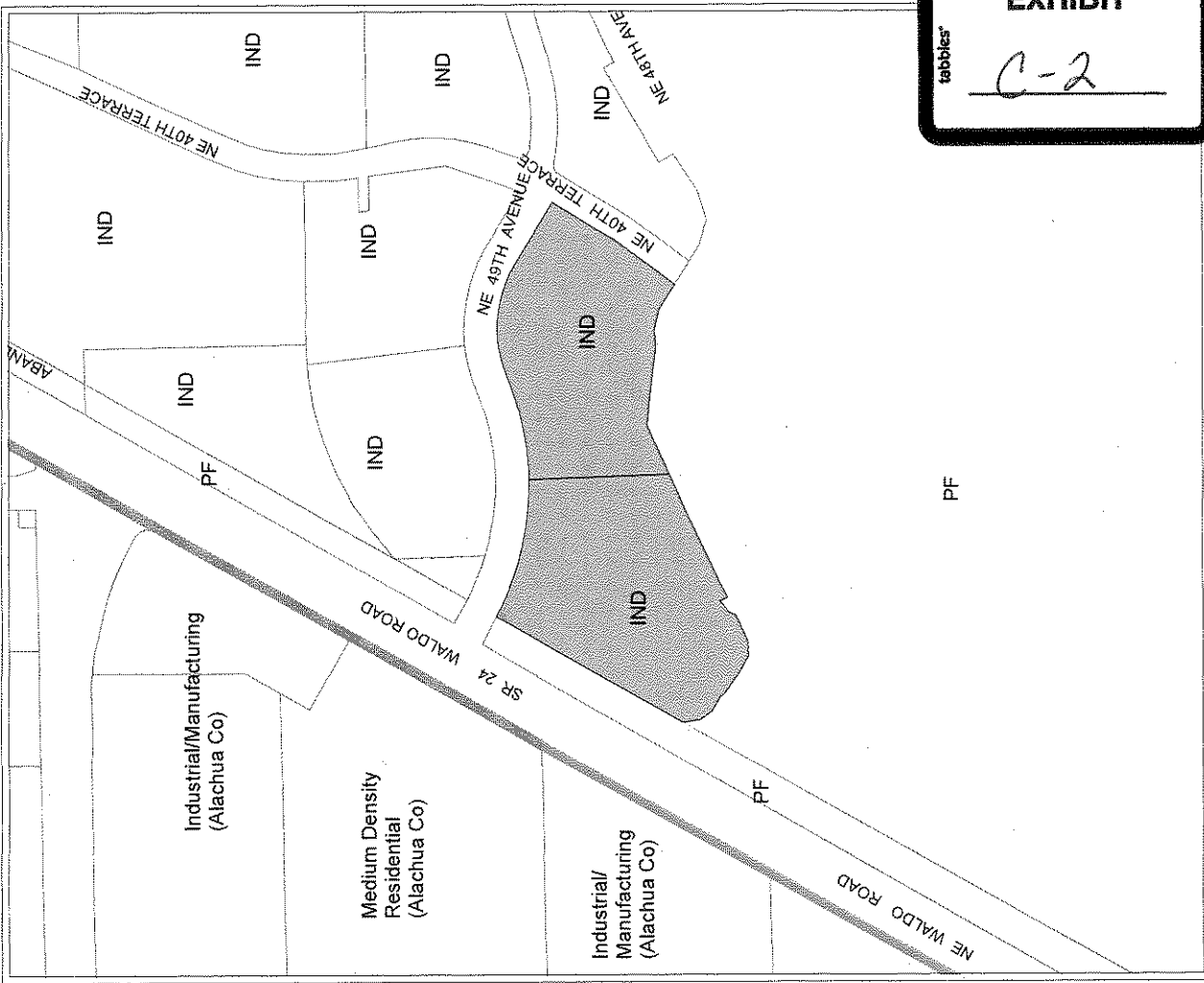

tabbles
EXHIBIT
C-2

EXISTING LAND USE		Map(s)	Petition Number
<p>Name</p> <p>Eng, Denman and Associates, agent for the City of Gainesville</p>	<p>Petition Request</p> <p>Rezone from I-2 to BI and CON</p>	<p>3357</p>	<p>100790C</p> <p>PB-11-14 ZON</p>

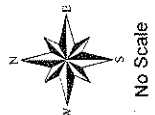

No Scale

Zoning District Categories

- RSF1 Single-Family Residential (3.5 du/acre)
- RSF2 Single-Family Residential (4.6 du/acre)
- RSF3 Single-Family Residential (5.8 du/acre)
- RSF4 Single-Family Residential (8 du/acre)
- RSFR Single-Family Rural Residential (1.0 du/acre)
- RMF5 Residential Low Density (12 du/acre)
- RC Residential Conservation (12 du/acre)
- MH Mobile Home Residential (12 du/acre)
- RMF6 Multiple-Family Medium Density Residential (8-15 du/acre)
- RMF7 Multiple-Family Medium Density Residential (8-21 du/acre)
- RMF8 Multiple-Family Medium Density Residential (8-30 du/acre)
- RMU Residential Mixed Use (up to 75 du/acre)
- RH1 Residential High Density (8-43 du/acre)
- RH2 Residential High Density (8-100 du/acre)
- OR Office Residential (up to 20 du/acre)
- OF General Office
- PD Planned Development
- BUS General Business
- BA Automotive-Oriented Business
- BT Tourist-Oriented Business
- MU1 Mixed Use Low Intensity (8-30 du/acre)
- MU2 Mixed Use Medium Intensity (12-30 du/acre)
- UMU1 Urban Mixed Use District 1 (up to 75 du/acre)
- UMU2 Urban Mixed Use District 2 (up to 100 du/acre)
- CCD Central City District
- BI Business Industrial
- W Warehousing and Wholesaling
- I1 Limited Industrial
- I2 General Industrial
- AGR Agriculture
- CON Conservation
- MD Medical Services
- PS Public Services and Operations
- AF Airport Facility
- ED Educational Services
- CP Corporate Park

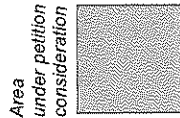

- Historic Preservation/Conservation District
- Special Area Plan
- Division line between two zoning districts
- City Limits

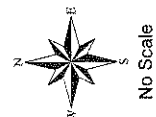

No Scale

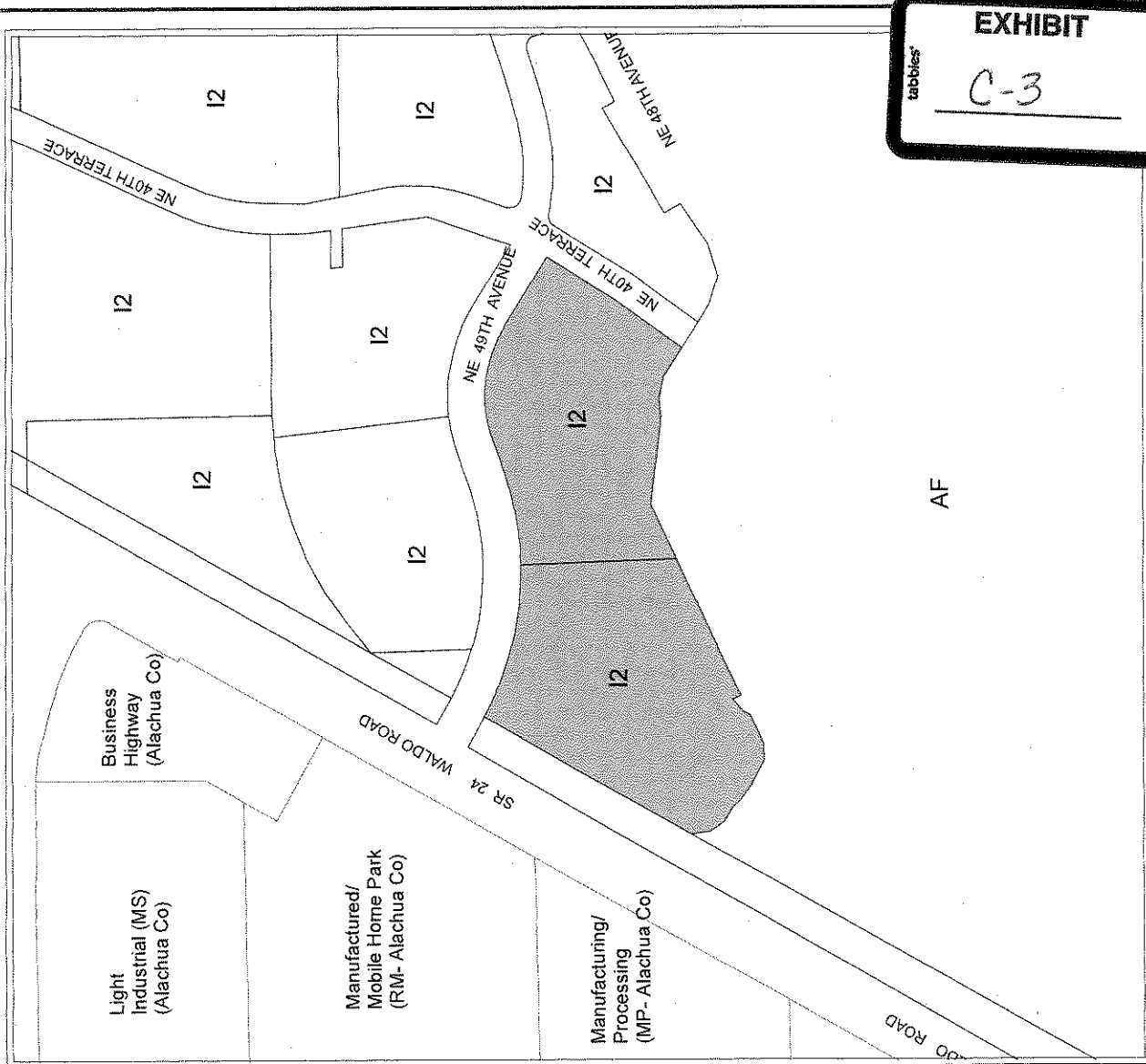
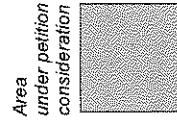

EXHIBIT
 C-3
tabbles

EXISTING ZONING			
Name	Petition Request	Map(s)	Petition Number
Eng, Denman and Associates, agent for the City of Gainesville	Rezone from I-2 to BI and CON	3357	PB-11-14 ZON
			100790C

Zoning District Categories

- RSF1 Single-Family Residential (3.5 du/acre)
- RSF2 Single-Family Residential (4.6 du/acre)
- RSF3 Single-Family Residential (5.8 du/acre)
- RSF4 Single-Family Residential (8 du/acre)
- RSFR Single-Family Rural Residential (1.0 du/acre)
- RMF5 Residential Low Density (12 du/acre)
- RC Residential Conservation (12 du/acre)
- MH Mobile Home Residential (12 du/acre)
- RMF6 Multiple-Family Medium Density Residential (8-15 du/acre)
- RMF7 Multiple-Family Medium Density Residential (8-21 du/acre)
- RMF8 Multiple-Family Medium Density Residential (8-30 du/acre)
- RMU Residential Mixed Use (up to 75 du/acre)
- RH1 Residential High Density (8-43 du/acre)
- RH2 Residential High Density (8-100 du/acre)
- OR Office Residential (up to 20 du/acre)
- OF General Office
- PD Planned Development
- BUS General Business
- BA Automotive-Oriented Business
- BT Tourist-Oriented Business
- MU1 Mixed Use Low Intensity (8-30 du/acre)
- MU2 Mixed Use Medium Intensity (12-30 du/acre)
- UMU1 Urban Mixed Use District 1 (up to 75 du/acre)
- UMU2 Urban Mixed Use District 2 (up to 100 du/acre)
- CCD Central City District
- BI Business Industrial
- W Warehousing and Wholesaling
- I1 Limited Industrial
- I2 General Industrial
- AGR Agriculture
- CON Conservation
- MD Medical Services
- PS Public Services and Operations
- AF Airport Facility
- ED Educational Services
- CP Corporate Park



- Historic Preservation/Conservation District
- Special Area Plan
- Division line between two zoning districts
- City Limits



No Scale

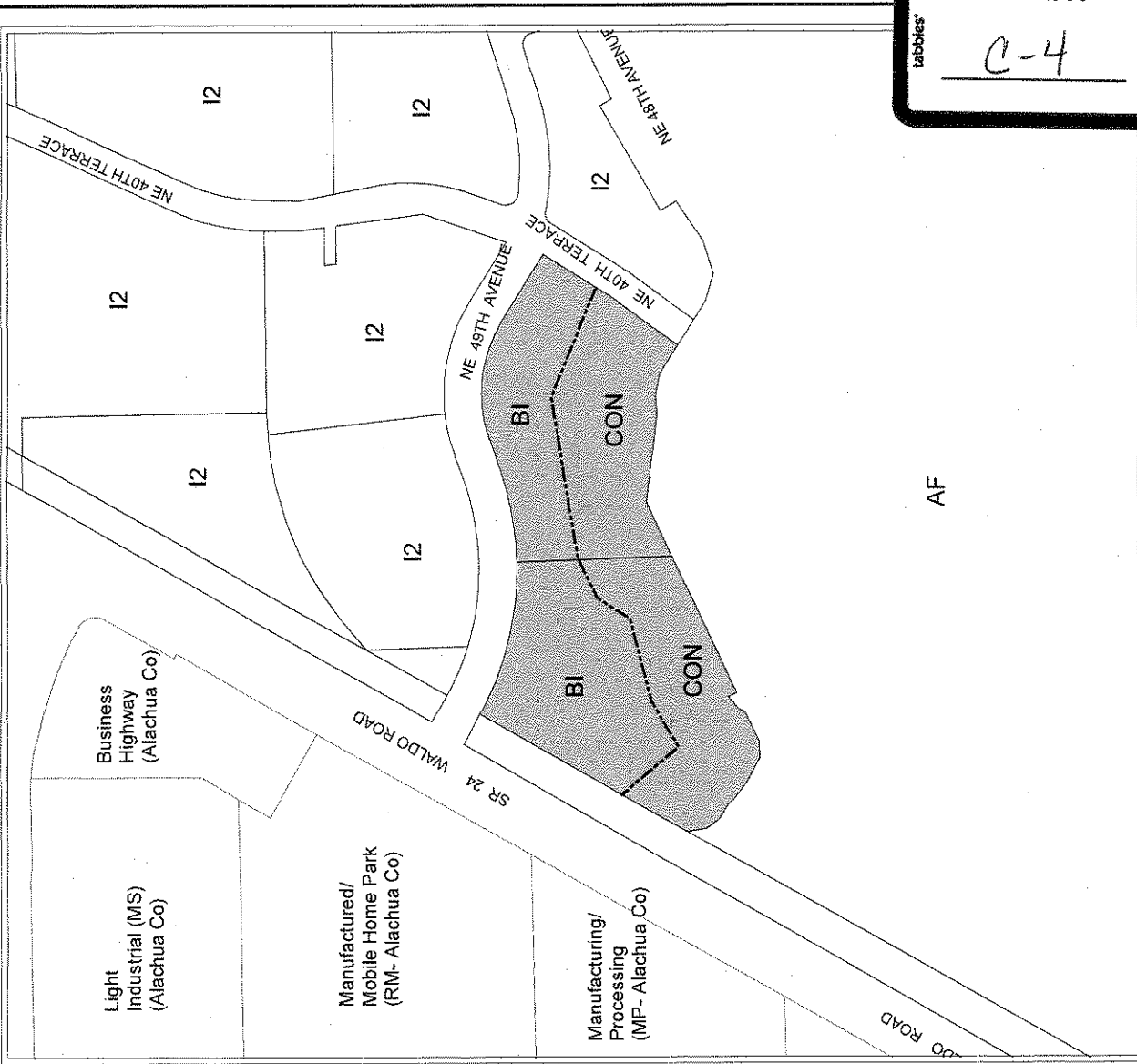

tabbies
C-4

EXHIBIT

PROPOSED ZONING

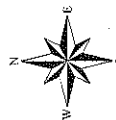
 No Scale	Name Eng. Denman and Associates, agent for the City of Gainesville	Petition Request Rezone from I-2 to BI and CON	Map(s) 3357	Petition Number PB-11-14 ZON 100790C
---	---	--	-----------------------	---