

**#11904 INTERLOCAL AGREEMENT BETWEEN CITY OF GAINESVILLE AND
ALACHUA COUNTY REGARDING MULTIUSE TRAIL IMPROVEMENTS
AT SWEETWATER PRESERVE**

This AGREEMENT is entered into this _____ day of _____, 2021 by and between the City of Gainesville, a Florida municipal corporation (“City”), and Alachua County, a charter county and a political subdivision of the State of Florida, by and through its Board of County Commissioners (hereinafter referred to as the “County”).

WITNESSETH:

WHEREAS, Chapter 163, Florida Statutes, authorizes public agencies, including cities and counties, to enter into agreements to jointly exercise the power, privilege, or authority they share in common and which each might exercise separately; and

WHEREAS, the City and County wish to coordinate the construction of recreational facilities of the City and County in order to provide more fully for the recreational needs of the citizens of the City and County at the least expense; and

WHEREAS, the County desires to make improvements to its Sweetwater Preserve Trailhead at 309 SE 16th Avenue, shown in Exhibit A, for use and benefit of the general public, while retaining control of these facilities; and

WHEREAS, the City is willing and able to reimburse the County for immediate City multiuse trail improvements at the main entrance to Sweetwater Preserve under the County’s contract with BBI Construction Management, Inc.

NOW THEREFORE, in consideration of the mutual benefits, and the covenants and agreement herein contained, the parties agree as follows:

1. **Term.** This Agreement shall take effect upon execution and shall remain in effect unless terminated in accordance with paragraph 5, below.
2. **City’s Responsibilities.** The City shall reimburse the County for the multiuse trail improvements consisting of a raised speed table crosswalk and a ten (10) foot wide sidewalk, which cross the main entrance to Sweetwater Preserve, according to Exhibit A, attached hereto and incorporated, in an amount not to exceed \$18,244.08.
3. **County’s Responsibility.** The County shall conduct procurement and oversee construction of the multiuse trail improvements described in Section 2 and as shown on Exhibit A through completion as part of the County’s Sweetwater Preserve LID Parking Area Project.

4. **Liability.** The Parties shall each be responsible for any and all risks of personal injury and property damage attributable to the acts or omissions of their own officers, employees, servants and agents. Nothing in this Agreement shall be interpreted as a waiver of either party's sovereign immunity under law. Neither Party agrees to indemnify the other.

5. **Default and Termination.** The failure of either party to comply with any provision of this Agreement shall place such party in default. Prior to terminating this agreement, the non-defaulting party shall notify the defaulting party in writing, making specific reference to the provision which gave rise to the default. The defaulting party shall then be entitled to a period of 15 calendar days in which to cure the default. In the event the default is not cured within the 15 calendar day period, this agreement may be terminated.

6. **Notices.** Except as otherwise provided herein, any notice of default or termination, from either party to the other party shall be in writing and sent by certified mail, return receipt requested or personally delivered with signed proof of delivery. The City's and County's representatives are:

City: Elizabeth D. Waite, P.E.
Director of Wild Spaces & Public Places
Parks, Recreation & Cultural Affairs Dept.
PO Box 490, Station 24
Gainesville, FL 32627

County: Evan Shane Williams, PhD, P.E.
Stormwater Engineer
Environmental Protection Department
408 W. University Ave Suite 106
Gainesville, FL 32601

7. **Amendments.** This Agreement may be amended by mutual written agreement of the parties and may be changed only by such written amendment.

8. **Laws and Regulations.** The parties will comply with all laws, ordinances, regulations, and building code requirements applicable to the work required by this agreement. The parties are presumed to be familiar with all state and local laws, ordinances, code rules and regulations that may in any way affect the work outlined in this agreement. If either party is not familiar with state and local laws, ordinances, code rules and regulations, the party remains liable for any violation and all subsequent damages or fines.

9. **Assignment.** The parties shall not assign, convey, pledge, sublet, or otherwise dispose of, any interest in this agreement and shall not transfer any interest in same, whether by assignment or notation, without the prior written consent of the other party.

10. **Third Party Beneficiaries.** This Agreement does not create any relationship with, or any rights in favor of, any third party.

11. **Severability.** If any provision of this Agreement is declared void by a court of law, all other provisions will remain in full force and effect.

12. **Non Waiver.** The failure of either party to exercise any right in this Agreement will not waive such right in the event of any further default or non-compliance.

13. **Captions and Section Headings.** Captions and section headings used herein are for convenience only and shall not be used in construing this Agreement.

14. **Construction.** This Agreement shall not be construed more strictly against one party than against the other merely by virtue of the fact that it may have been prepared by one of the parties. It is recognized that both parties have substantially contributed to the preparation of this Agreement.

15. **Governing Law and Venue.** This Agreement is governed in accordance with the laws of the State of Florida. Venue is in Alachua County.

16. **Attachments.** All exhibits attached to this Agreement are incorporated into and made part of this agreement by reference.

17. **Entire Agreement.** This Agreement constitutes the entire agreement and supersedes all prior written or oral agreements, understandings, or representations.

18. **Recording of Agreement.** The City, upon execution of this Agreement by all parties, shall record this Interlocal Agreement in the public records of Alachua County, Florida.

[REMAINDER OF PAGE INTENTIONALLY LEFT BLANK]

IN WITNESS WHEREOF, the parties hereto have caused this Agreement to be executed for the uses and purposes expressed herein, on the day and year first above written.

ATTEST:

ALACHUA COUNTY, FLORIDA

J.K. "Jess" Irby, Esq., Clerk

Ken Cornell, Chair

Date: _____

APPROVED AS TO FORM:

Alachua County Attorney's Office

ATTEST:

CITY OF GAINESVILLE

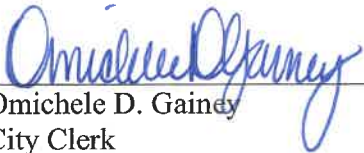

Omichele D. Gainey
City Clerk



Lauren Poe, Mayor

Date: 7/2/21

APPROVED AS TO FORM AND LEGALITY:

David C. Schwartz
David C. Schwartz (Aug 30, 2021 09:51 EDT)

City Attorney

GENERAL SCOPE OF SITE WORK FOR PERMITTING AND CONSTRUCTION OF SWEETWATER PRESERVE LID PARKING AREA PROJECT ALACHUA COUNTY, FLORIDA

LOCATED IN
SECTION 16, TOWNSHIP 10 SOUTH, RANGE 20 EAST
ALACHUA COUNTY, FLORIDA



LEGEND
----- PROJECT AREA (APPROXIMATELY 1 ACRE)

SHEET INDEX

C100	COVER SHEET
C101	GENERAL NOTES
C201	EXISTING SITE PLAN
C202	DEMOLITION PLAN
C203	EROSION & SEDIMENT CONTROL PLAN
C204	PROPOSED SITE PLAN
C205	GRADING & DRAINAGE PLAN
C206	SIGNAGE & STRIPING PLAN
C300	STREET DRAINAGE DETAILS
C310	BIOFILTRATION BASIN UNDERDRAIN DETAILS I
C320	BIOFILTRATION BASIN DRAINAGE DETAILS I
C321	BIOFILTRATION BASIN DRAINAGE DETAILS II
C330	BIOFILTRATION ISLAND UNDERDRAIN DETAILS
C340	BIOFILTRATION BASIN DRAINAGE DETAILS
C350	BIOFILTRATION BASIN PLANTING PLAN
C361	BIOFILTRATION ISLAND PLANTING PLAN
C362	LANDSCAPED AREA PLANTING PLAN
C401	TYPICAL DETAILS I
C402	TYPICAL DETAILS II
C403	TYPICAL DETAILS III
C404	TYPICAL DETAILS IV
C405	TYPICAL DETAILS V
C406	TYPICAL DETAILS VI
C407	TYPICAL DETAILS VII

wood.

WOOD ENVIRONMENTAL AND INFRASTRUCTURE SOLUTIONS, INC.
10000 WOODBURY DRIVE, SUITE 100
GAINESVILLE, FLORIDA 32608-4000
TEL: 352-332-3318 FAX: 352-332-6822
E-MAIL: Sean.Kroepfle@wood-e.com

ALAN J. PATE, P.E.
REGISTERED PROFESSIONAL ENGINEER
FLORIDA LICENSE NO. 48128

SWEETWATER PRESERVE LID PARKING AREA PROJECT



DATE:	09/23/14
PROJECT NO.:	14-0017
SCALE:	
DRAWN BY:	DAK
CHECKED BY:	WV
DATE:	09/23/14

COVER SHEET

C100

ATTENTION IS DIRECTED TO THE FACT THAT THESE PLANS MAY HAVE BEEN CHANGED IN SIZE BY REPRODUCTION. THIS MUST BE CONSIDERED WHEN OBTAINING SCALED DATA.

GOVERNING REGULATIONS:
ALACHUA COUNTY WATER MANAGEMENT DISTRICT (SUMMIT)
FLORIDA DEPARTMENT OF ENVIRONMENTAL PROTECTION (FDEP)
FLORIDA DEPARTMENT OF TRANSPORTATION (FDOT)
IN THE EVENT OF CONFLICT, THE MOST RESTRICTIVE APPLIES.

PLANS PREPARED BY:

wood.

WOOD ENVIRONMENTAL AND INFRASTRUCTURE SOLUTIONS, INC.
10000 WOODBURY DRIVE, SUITE 100
GAINESVILLE, FLORIDA 32608-4000
TEL: 352-332-3318 FAX: 352-332-6822
E-MAIL: Sean.Kroepfle@wood-e.com

CLIENT



VICINITY MAP

**SUNSHINE 811 OF FLORIDA
CALL BEFORE YOU DIG
1-800-432-4770**

1. CALL 1-800-432-4770 TWO BUSINESS DAYS (NOT MORE THAN FIVE) BEFORE ORDERING TO FIND OUT WHERE BURIED FACILITIES (ELECTRIC, GAS, TELECOMMUNICATIONS, CABLE, WATER, SEWER) ARE LOCATED.
2. WAIT THE REQUIRED TIME FOR THE UTILITIES ON SITE TO BE LOCATED AND MARKED WITH COLOR-CODED PAINT, FLAGS OR STAKES AND CONFIRM THAT THE SITE HAS BEEN LOCATED.
3. RESPECT AND PROTECT THE MARKS DURING THE PROJECT. IF MARKS ARE DESTROYED, REQUEST A NEW LOCATE TICKET.
4. DIG SAFELY, USING EXTREME CAUTION WHEN DIGGING WITHIN 24 INCHES ON EITHER SIDE OF THE MARKS TO AVOID HITTING THE BURIED UTILITY LINES.

NOTES

A. GENERAL

- 1. PROPERTY OWNERS NAMES AND ADDRESSES

ALACHUA COUNTY
406 WES GARDENWAY AVE. S.W. #110
GAINESVILLE, FL 32607

CITY OF GAINESVILLE
PO BOX 127117 STA. A130
GAINESVILLE, FL 32612

PROJECT LOCATION: I-75/326/4807 N. LONG. 82719.8307' N

THE WORKS TO BE PERFORMED INCLUDE: EROSION CONTROL, FILL, GRADING, STABILIZATION, AND STRUCTURE AND SITE RESTORATION.

3. SCOPE OF WORK ACTIVITIES

- (1) MAINTAIN EXISTING CONSTRUCTION CONTROLS AND (2) MAINTAIN THROUGHOUT CONSTRUCTION.
- (3) INTERIM APPROVED STAGING AREAS.
- (4) EROSION CONTROL, FILLING, AND EXISTING STRUCTURES AS SHOWN ON THE DRAWINGS.
- (5) CONSTRUCTION PROJECT ACCORDING TO CONSTRUCTION PLANS AND SPECIFICATIONS.
- (6) RELOCATE AND STABILIZE EXISTING WORK AREAS AS SHOWN ON THE DRAWINGS.
- (7) OBTAIN FINAL APPROVAL, EROSION CONTROL AND RESTORATION CONTROLS AND STARTUP ANY AREA DISTURBED BY THEIR REMOVAL.

4. AREA ESTIMATES: PROJECT AREA = 1.06 AC.

5. IT IS THE RESPONSIBILITY OF THE CONTRACTOR TO OBTAIN AND UNDERSTAND ALL APPLICABLE SAFETY REGULATIONS. THE CONTRACTOR SHALL COMPLY WITH ALL APPLICABLE SAFETY REGULATIONS. THE CONTRACTOR SHALL BE RESPONSIBLE FOR OBTAINING AND UNDERSTANDING ALL APPLICABLE SAFETY REGULATIONS. THE CONTRACTOR SHALL BE RESPONSIBLE FOR OBTAINING AND UNDERSTANDING ALL APPLICABLE SAFETY REGULATIONS.

B. SAFETY NOTES

- 1. BEFORE THE CONTRACTOR BEGINS MAINTENANCE OF THE PROJECT SITE, THE CONTRACTOR SHALL COMPLY WITH ALL APPLICABLE SAFETY REGULATIONS. THE CONTRACTOR SHALL BE RESPONSIBLE FOR OBTAINING AND UNDERSTANDING ALL APPLICABLE SAFETY REGULATIONS. THE CONTRACTOR SHALL BE RESPONSIBLE FOR OBTAINING AND UNDERSTANDING ALL APPLICABLE SAFETY REGULATIONS.

2. THE CONTRACTOR SHALL MAINTAIN ALL EXISTING EROSION CONTROL MEASURES AND SHALL BE RESPONSIBLE FOR OBTAINING AND UNDERSTANDING ALL APPLICABLE SAFETY REGULATIONS. THE CONTRACTOR SHALL BE RESPONSIBLE FOR OBTAINING AND UNDERSTANDING ALL APPLICABLE SAFETY REGULATIONS.

3. IT SHALL BE THE SOLE RESPONSIBILITY OF THE CONTRACTOR TO COMPLY WITH ALL APPLICABLE SAFETY REGULATIONS. THE CONTRACTOR SHALL BE RESPONSIBLE FOR OBTAINING AND UNDERSTANDING ALL APPLICABLE SAFETY REGULATIONS.

C. SURVEY NOTES

- 1. ALL EXISTING SURVEY MONUMENTS, OR MARKERS OR BENCH MARKS AND CORNERS DISTURBED AND NOT BEEN RECOVERED, RELOCATED, THE CONTRACTOR SHALL BE RESPONSIBLE FOR OBTAINING AND UNDERSTANDING ALL APPLICABLE SAFETY REGULATIONS.

2. THE EXISTING TOPOGRAPHIC INFORMATION, LOCATED WITHIN THE SET OF THE CONSTRUCTION DRAWINGS, IS THE BASIS FOR THE SURVEY. THE CONTRACTOR SHALL BE RESPONSIBLE FOR OBTAINING AND UNDERSTANDING ALL APPLICABLE SAFETY REGULATIONS.

3. THE SURVEY REFERENCED IN THESE DRAWINGS IS A TRIANGULATION SURVEY. THE CONTRACTOR SHALL BE RESPONSIBLE FOR OBTAINING AND UNDERSTANDING ALL APPLICABLE SAFETY REGULATIONS.

4. THE SURVEY WAS CONDUCTED BY THE SURVEYOR, WHO IS A LICENSED PROFESSIONAL SURVEYOR IN THE STATE OF FLORIDA. THE CONTRACTOR SHALL BE RESPONSIBLE FOR OBTAINING AND UNDERSTANDING ALL APPLICABLE SAFETY REGULATIONS.

5. THE SURVEY WAS CONDUCTED IN ACCORDANCE WITH THE SURVEYING ACTS, CHAPTER 47, F.S., AND THE SURVEYING BOARD, RULES, CHAPTER 61S-02, F.A.C.

6. THE SURVEY WAS CONDUCTED IN ACCORDANCE WITH THE SURVEYING ACTS, CHAPTER 47, F.S., AND THE SURVEYING BOARD, RULES, CHAPTER 61S-02, F.A.C.

7. THE SURVEY WAS CONDUCTED IN ACCORDANCE WITH THE SURVEYING ACTS, CHAPTER 47, F.S., AND THE SURVEYING BOARD, RULES, CHAPTER 61S-02, F.A.C.

8. THE SURVEY WAS CONDUCTED IN ACCORDANCE WITH THE SURVEYING ACTS, CHAPTER 47, F.S., AND THE SURVEYING BOARD, RULES, CHAPTER 61S-02, F.A.C.

9. THE SURVEY WAS CONDUCTED IN ACCORDANCE WITH THE SURVEYING ACTS, CHAPTER 47, F.S., AND THE SURVEYING BOARD, RULES, CHAPTER 61S-02, F.A.C.

10. THE SURVEY WAS CONDUCTED IN ACCORDANCE WITH THE SURVEYING ACTS, CHAPTER 47, F.S., AND THE SURVEYING BOARD, RULES, CHAPTER 61S-02, F.A.C.

11. THE SURVEY WAS CONDUCTED IN ACCORDANCE WITH THE SURVEYING ACTS, CHAPTER 47, F.S., AND THE SURVEYING BOARD, RULES, CHAPTER 61S-02, F.A.C.

D. TEMPORARY EROSION AND SEDIMENT CONTROL

- 1. THE CONTRACTOR SHALL INSTALL EROSION AND SEDIMENT CONTROL MEASURES PRIOR TO ANY DISTURBANCE OF THE EARTH SURFACE. THE CONTRACTOR SHALL BE RESPONSIBLE FOR OBTAINING AND UNDERSTANDING ALL APPLICABLE SAFETY REGULATIONS.

2. NO EROSION OR SEDIMENT CONTROL MEASURES SHALL BE PERMITTED UNTIL ALL EXISTING EROSION AND SEDIMENT CONTROL MEASURES ARE INSTALLED.

3. THE CONTRACTOR SHALL MAINTAIN ALL EXISTING EROSION AND SEDIMENT CONTROL MEASURES AND SHALL BE RESPONSIBLE FOR OBTAINING AND UNDERSTANDING ALL APPLICABLE SAFETY REGULATIONS.

4. EROSION AND SEDIMENT CONTROL MEASURES SHALL BE MAINTAINED THROUGHOUT CONSTRUCTION. THE CONTRACTOR SHALL BE RESPONSIBLE FOR OBTAINING AND UNDERSTANDING ALL APPLICABLE SAFETY REGULATIONS.

5. THE CONTRACTOR SHALL MAINTAIN ALL EXISTING EROSION AND SEDIMENT CONTROL MEASURES AND SHALL BE RESPONSIBLE FOR OBTAINING AND UNDERSTANDING ALL APPLICABLE SAFETY REGULATIONS.

6. THE CONTRACTOR SHALL MAINTAIN ALL EXISTING EROSION AND SEDIMENT CONTROL MEASURES AND SHALL BE RESPONSIBLE FOR OBTAINING AND UNDERSTANDING ALL APPLICABLE SAFETY REGULATIONS.

7. THE CONTRACTOR SHALL MAINTAIN ALL EXISTING EROSION AND SEDIMENT CONTROL MEASURES AND SHALL BE RESPONSIBLE FOR OBTAINING AND UNDERSTANDING ALL APPLICABLE SAFETY REGULATIONS.

8. THE CONTRACTOR SHALL MAINTAIN ALL EXISTING EROSION AND SEDIMENT CONTROL MEASURES AND SHALL BE RESPONSIBLE FOR OBTAINING AND UNDERSTANDING ALL APPLICABLE SAFETY REGULATIONS.

9. THE CONTRACTOR SHALL MAINTAIN ALL EXISTING EROSION AND SEDIMENT CONTROL MEASURES AND SHALL BE RESPONSIBLE FOR OBTAINING AND UNDERSTANDING ALL APPLICABLE SAFETY REGULATIONS.

10. THE CONTRACTOR SHALL MAINTAIN ALL EXISTING EROSION AND SEDIMENT CONTROL MEASURES AND SHALL BE RESPONSIBLE FOR OBTAINING AND UNDERSTANDING ALL APPLICABLE SAFETY REGULATIONS.

11. THE CONTRACTOR SHALL MAINTAIN ALL EXISTING EROSION AND SEDIMENT CONTROL MEASURES AND SHALL BE RESPONSIBLE FOR OBTAINING AND UNDERSTANDING ALL APPLICABLE SAFETY REGULATIONS.

12. THE CONTRACTOR SHALL MAINTAIN ALL EXISTING EROSION AND SEDIMENT CONTROL MEASURES AND SHALL BE RESPONSIBLE FOR OBTAINING AND UNDERSTANDING ALL APPLICABLE SAFETY REGULATIONS.

13. THE CONTRACTOR SHALL MAINTAIN ALL EXISTING EROSION AND SEDIMENT CONTROL MEASURES AND SHALL BE RESPONSIBLE FOR OBTAINING AND UNDERSTANDING ALL APPLICABLE SAFETY REGULATIONS.

14. THE CONTRACTOR SHALL MAINTAIN ALL EXISTING EROSION AND SEDIMENT CONTROL MEASURES AND SHALL BE RESPONSIBLE FOR OBTAINING AND UNDERSTANDING ALL APPLICABLE SAFETY REGULATIONS.

15. THE CONTRACTOR SHALL MAINTAIN ALL EXISTING EROSION AND SEDIMENT CONTROL MEASURES AND SHALL BE RESPONSIBLE FOR OBTAINING AND UNDERSTANDING ALL APPLICABLE SAFETY REGULATIONS.

E. FASTING INFRASTRUCTURE

- 1. ALL FASTING INFRASTRUCTURE SHALL BE INSTALLED PRIOR TO THE START OF CONSTRUCTION. THE CONTRACTOR SHALL BE RESPONSIBLE FOR OBTAINING AND UNDERSTANDING ALL APPLICABLE SAFETY REGULATIONS.

2. THE CONTRACTOR SHALL MAINTAIN ALL EXISTING FASTING INFRASTRUCTURE AND SHALL BE RESPONSIBLE FOR OBTAINING AND UNDERSTANDING ALL APPLICABLE SAFETY REGULATIONS.

3. THE CONTRACTOR SHALL MAINTAIN ALL EXISTING FASTING INFRASTRUCTURE AND SHALL BE RESPONSIBLE FOR OBTAINING AND UNDERSTANDING ALL APPLICABLE SAFETY REGULATIONS.

4. THE CONTRACTOR SHALL MAINTAIN ALL EXISTING FASTING INFRASTRUCTURE AND SHALL BE RESPONSIBLE FOR OBTAINING AND UNDERSTANDING ALL APPLICABLE SAFETY REGULATIONS.

5. THE CONTRACTOR SHALL MAINTAIN ALL EXISTING FASTING INFRASTRUCTURE AND SHALL BE RESPONSIBLE FOR OBTAINING AND UNDERSTANDING ALL APPLICABLE SAFETY REGULATIONS.

6. THE CONTRACTOR SHALL MAINTAIN ALL EXISTING FASTING INFRASTRUCTURE AND SHALL BE RESPONSIBLE FOR OBTAINING AND UNDERSTANDING ALL APPLICABLE SAFETY REGULATIONS.

7. THE CONTRACTOR SHALL MAINTAIN ALL EXISTING FASTING INFRASTRUCTURE AND SHALL BE RESPONSIBLE FOR OBTAINING AND UNDERSTANDING ALL APPLICABLE SAFETY REGULATIONS.

8. THE CONTRACTOR SHALL MAINTAIN ALL EXISTING FASTING INFRASTRUCTURE AND SHALL BE RESPONSIBLE FOR OBTAINING AND UNDERSTANDING ALL APPLICABLE SAFETY REGULATIONS.

9. THE CONTRACTOR SHALL MAINTAIN ALL EXISTING FASTING INFRASTRUCTURE AND SHALL BE RESPONSIBLE FOR OBTAINING AND UNDERSTANDING ALL APPLICABLE SAFETY REGULATIONS.

10. THE CONTRACTOR SHALL MAINTAIN ALL EXISTING FASTING INFRASTRUCTURE AND SHALL BE RESPONSIBLE FOR OBTAINING AND UNDERSTANDING ALL APPLICABLE SAFETY REGULATIONS.

11. THE CONTRACTOR SHALL MAINTAIN ALL EXISTING FASTING INFRASTRUCTURE AND SHALL BE RESPONSIBLE FOR OBTAINING AND UNDERSTANDING ALL APPLICABLE SAFETY REGULATIONS.

12. THE CONTRACTOR SHALL MAINTAIN ALL EXISTING FASTING INFRASTRUCTURE AND SHALL BE RESPONSIBLE FOR OBTAINING AND UNDERSTANDING ALL APPLICABLE SAFETY REGULATIONS.

13. THE CONTRACTOR SHALL MAINTAIN ALL EXISTING FASTING INFRASTRUCTURE AND SHALL BE RESPONSIBLE FOR OBTAINING AND UNDERSTANDING ALL APPLICABLE SAFETY REGULATIONS.

F. UTILITY NOTES

- 1. THE CONTRACTOR SHALL MAINTAIN ALL EXISTING UTILITIES AND SHALL BE RESPONSIBLE FOR OBTAINING AND UNDERSTANDING ALL APPLICABLE SAFETY REGULATIONS.

2. THE CONTRACTOR SHALL MAINTAIN ALL EXISTING UTILITIES AND SHALL BE RESPONSIBLE FOR OBTAINING AND UNDERSTANDING ALL APPLICABLE SAFETY REGULATIONS.

3. THE CONTRACTOR SHALL MAINTAIN ALL EXISTING UTILITIES AND SHALL BE RESPONSIBLE FOR OBTAINING AND UNDERSTANDING ALL APPLICABLE SAFETY REGULATIONS.

4. THE CONTRACTOR SHALL MAINTAIN ALL EXISTING UTILITIES AND SHALL BE RESPONSIBLE FOR OBTAINING AND UNDERSTANDING ALL APPLICABLE SAFETY REGULATIONS.

5. THE CONTRACTOR SHALL MAINTAIN ALL EXISTING UTILITIES AND SHALL BE RESPONSIBLE FOR OBTAINING AND UNDERSTANDING ALL APPLICABLE SAFETY REGULATIONS.

6. THE CONTRACTOR SHALL MAINTAIN ALL EXISTING UTILITIES AND SHALL BE RESPONSIBLE FOR OBTAINING AND UNDERSTANDING ALL APPLICABLE SAFETY REGULATIONS.

7. THE CONTRACTOR SHALL MAINTAIN ALL EXISTING UTILITIES AND SHALL BE RESPONSIBLE FOR OBTAINING AND UNDERSTANDING ALL APPLICABLE SAFETY REGULATIONS.

8. THE CONTRACTOR SHALL MAINTAIN ALL EXISTING UTILITIES AND SHALL BE RESPONSIBLE FOR OBTAINING AND UNDERSTANDING ALL APPLICABLE SAFETY REGULATIONS.

9. THE CONTRACTOR SHALL MAINTAIN ALL EXISTING UTILITIES AND SHALL BE RESPONSIBLE FOR OBTAINING AND UNDERSTANDING ALL APPLICABLE SAFETY REGULATIONS.

10. THE CONTRACTOR SHALL MAINTAIN ALL EXISTING UTILITIES AND SHALL BE RESPONSIBLE FOR OBTAINING AND UNDERSTANDING ALL APPLICABLE SAFETY REGULATIONS.

11. THE CONTRACTOR SHALL MAINTAIN ALL EXISTING UTILITIES AND SHALL BE RESPONSIBLE FOR OBTAINING AND UNDERSTANDING ALL APPLICABLE SAFETY REGULATIONS.

12. THE CONTRACTOR SHALL MAINTAIN ALL EXISTING UTILITIES AND SHALL BE RESPONSIBLE FOR OBTAINING AND UNDERSTANDING ALL APPLICABLE SAFETY REGULATIONS.

13. THE CONTRACTOR SHALL MAINTAIN ALL EXISTING UTILITIES AND SHALL BE RESPONSIBLE FOR OBTAINING AND UNDERSTANDING ALL APPLICABLE SAFETY REGULATIONS.

14. THE CONTRACTOR SHALL MAINTAIN ALL EXISTING UTILITIES AND SHALL BE RESPONSIBLE FOR OBTAINING AND UNDERSTANDING ALL APPLICABLE SAFETY REGULATIONS.

15. THE CONTRACTOR SHALL MAINTAIN ALL EXISTING UTILITIES AND SHALL BE RESPONSIBLE FOR OBTAINING AND UNDERSTANDING ALL APPLICABLE SAFETY REGULATIONS.



401 S. LANTANA STREET
GAINESVILLE, FL 32609
TEL: (352) 332-3318
WWW.WOODSUN.COM
A LICENSED PROFESSIONAL ENGINEER
NUMBER 5392



PROJECT: SWEETWATER PRESERVE LID PARKING AREA PROJECT

DATE: 11/15/2024

BY: [Signature]

FOR: [Signature]

REVISION NO.	DATE	DESCRIPTION
1	11/15/2024	ISSUED FOR PERMIT
2	11/15/2024	ISSUED FOR PERMIT
3	11/15/2024	ISSUED FOR PERMIT
4	11/15/2024	ISSUED FOR PERMIT
5	11/15/2024	ISSUED FOR PERMIT
6	11/15/2024	ISSUED FOR PERMIT
7	11/15/2024	ISSUED FOR PERMIT
8	11/15/2024	ISSUED FOR PERMIT
9	11/15/2024	ISSUED FOR PERMIT
10	11/15/2024	ISSUED FOR PERMIT

GENERAL NOTES	
1	SEE PERMIT FOR ALL APPLICABLE SAFETY REGULATIONS.
2	SEE PERMIT FOR ALL APPLICABLE SAFETY REGULATIONS.
3	SEE PERMIT FOR ALL APPLICABLE SAFETY REGULATIONS.
4	SEE PERMIT FOR ALL APPLICABLE SAFETY REGULATIONS.
5	SEE PERMIT FOR ALL APPLICABLE SAFETY REGULATIONS.
6	SEE PERMIT FOR ALL APPLICABLE SAFETY REGULATIONS.
7	SEE PERMIT FOR ALL APPLICABLE SAFETY REGULATIONS.
8	SEE PERMIT FOR ALL APPLICABLE SAFETY REGULATIONS.
9	SEE PERMIT FOR ALL APPLICABLE SAFETY REGULATIONS.
10	SEE PERMIT FOR ALL APPLICABLE SAFETY REGULATIONS.

wood.

WOOD GROUP, INC.
10000 WOODWAY DRIVE
DUBLIN, GA 30128
404.261.6000
WOODGROUP.COM

PROJECT AREA
PARCEL BOUNDARY
TREE LINE
EXISTING FENCE
OVERHEAD LINES
REINFORCED CONCRETE PIPE
EXISTING CONTOURS
EXISTING SITE FEATURE
SWEETWATER BRANCH
WETLAND BOUNDARY

SWEETWATER PRESERVE LID PARKING AREA PROJECT



NO.	DESCRIPTION	DATE

NO.	DESCRIPTION	DATE

EXISTING SITE PLAN

C201



- NOTES**
1. SEE MATRONS SP/DMN PLAN, ARE RELATIVE TO THE NORTH AMERICAN VERTICAL DATUM OF 1988 (NAVD 88).
 2. THE CONTRACTOR SHALL BE RESPONSIBLE FOR ANY EXISTING UTILITIES AND SHALL KEEP ACCESS ROADS FREE OF SOIL TRACKING AND DEBRIS.
 3. BEYOND MARKS CAN BE FORAD THROUGHOUT THE PROJECT AREA SEE SIGNED AND SEALED CIVILTY DRAWINGS FOR DETAILS.
 4. CONTRACTOR TO CONTACT ALABAMA COUNTY #2943 EXT. 28633 FOR A TREE BARRIAGE INSPECTION PRIOR TO COMMENCEMENT OF CONSTRUCTION.
 5. TREES AND NATIVE VEGETATION WILL BE PRESERVED INSIDE THE TREE PROTECTION BARRICADE.
 6. TREE REMOVAL MAY BE NECESSARY IN SOME AREAS HOWEVER CONTRACTOR SHALL RECEIVE APPROVAL FROM THE LOCAL AUTHORITIES PRIOR TO REMOVAL AND REPLANTMENT PRIOR TO PRUNING ANY TREES.
 7. SEE LAND BOUNDARY SUBJECT ALABAMA COUNTY, JULY 2019.

wood

4
 1000 N. GULF BLDG. #1000
 SUITE 1000
 TAMPA, FL 33602
 TEL: 813.241.1000
 FAX: 813.241.1001
 WWW.WOODGROUP.COM

SWEETWATER PRESERVE LID PARKING AREA PROJECT



DATE	DESCRIPTION

DATE	DESCRIPTION

DEMOLITION PLAN

DATE	DESCRIPTION

1 2 3 4 5 6

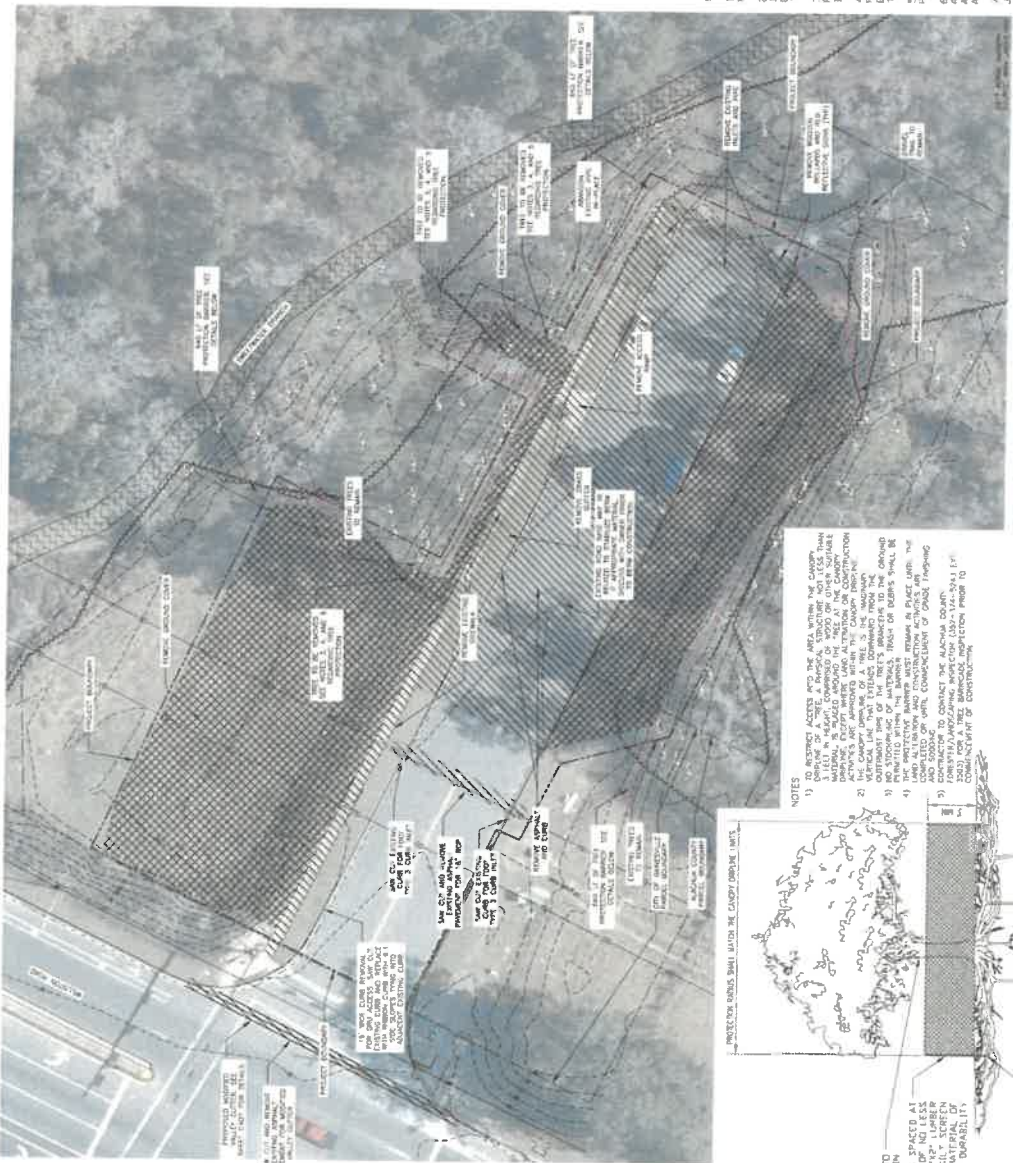

- LEGEND**
- PROJECT AREA
 - PARCEL BOUNDARY
 - TREE LINE
 - EXISTING FENCE
 - ONE/HEAD UTILITIES
 - REINFORCED CONCRETE RIFE
 - EXISTING CONTOURS
 - EXISTING SITE FEATURE
 - SWEETWATER BRANCH
 - ASPHALT, PAVEMENT, AND CURB REMOVAL
 - GROUND COVER REMOVAL
 - WETLAND BOUNDARY
 - TREE PROTECTION BARRIER

- NOTES**
- 1) ELEVATIONS SHOWN HEREON ARE RELATIVE TO THE NORTH AMERICAN VERTICAL DATUM OF 1988 (NAVD 88).
 - 2) THE CONTRACTOR SHALL BE RESPONSIBLE FOR ANY EXISTING UTILITIES AND ACCESS ROADS. THE CONTRACTOR SHALL KEEP ACCESS ROADS FREE OF SOIL TRACKING AND DEBRIS.
 - 3) BE SIGNARIES CAN BE FIELD THROUGHOUT THE PROJECT AREA SEE SIGNED AND SEALED SURVEY DRAWINGS FOR DETAILS.
 - 4) CONTRACTOR TO CONTACT ALACHUA COUNTY ENGINEERING DEPARTMENT FOR INSPECTION PRIOR TO COMMENCEMENT OF CONSTRUCTION.
 - 5) TREES AND NATIVE VEGETATION WILL BE PRESERVED INSIDE THE TREE PROTECTION BARRIERS.
 - 6) TREE REMOVAL MAY BE NECESSARY IN SPW AREAS; HOWEVER CONTRACTOR SHALL RECEIVE APPROVAL FROM THE ALACHUA COUNTY LAND CONSERVATION AND MANAGEMENT DEPT. TO REMOVING ANY TREES.
 - 7) SEE LAND BOUNDARY SURVEY: A-10-04-001.

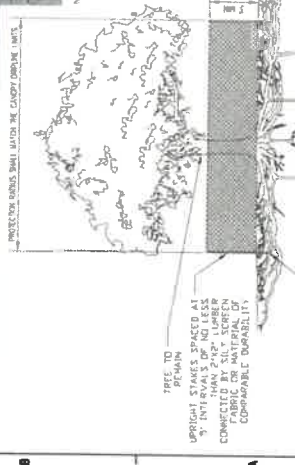



NO.	DESCRIPTION	DATE	BY

NO.	DESCRIPTION	DATE	BY



- LEGEND**
- PROJECT AREA
 - PARCEL BOUNDARY
 - TREE LINE
 - EXISTING FENCE
 - OVERHEAD UTILITIES
 - REINFORCED CONCRETE PIPE
 - EXISTING CONTOURS
 - EXISTING SITE FEATURE
 - SWEETWATER BRANCH
 - WETLAND BOUNDARY
 - SILT FENCE
 - FLOATING TURBIDITY BARRIER
 - TREE PROTECTION BARRIER

- NOTES**
- 1) ELEVATIONS SHOWN HEREON ARE RELATIVE TO THE NORTH AMERICAN VERTICAL DATUM OF 1988 ON A 5' BR.
 - 2) THE CONTRACTOR SHALL BE RESPONSIBLE FOR ANY DAMAGE TO STAGING AREAS AND ACCESS ROADS, TREE TRACKING AND BERTS.
 - 3) BENCHMARKS CAN BE FOUND THROUGHOUT THE PROJECT AREA SEE STICED AND SEALED SURVEY DRAWINGS FOR DETAILS.
 - 4) CONTRACTOR TO CONTACT ALACHUA COUNTY FORESTRY/LANDSCAPING INSPECTOR (389-374-5843) FOR TREE SURVEY AND INSPECTION PRIOR TO COMMENCEMENT OF CONSTRUCTION.
 - 5) TREES AND NATIVE VEGETATION SHALL BE PRESERVED INSIDE THE SILT PROTECTION BARRICADE.
 - 6) TREE REMOVAL MAY BE NECESSARY IN SOME AREAS; HOWEVER CONTRACTOR SHALL RECEIVE APPROVAL FROM THE OFFICE OF LAND CONSERVATION AND MANAGEMENT PRIOR TO REMOVING ANY TREES.
 - 7) WETLAND BOUNDARY SOURCE: ALACHUA COUNTY, JULY 2019.

wood.

WOOD GROUP (INCORPORATED)
 10000 WOODLARK DRIVE, SUITE 100
 WOODBRIDGE, VA 22191
 TEL: 703.766.1000 FAX: 703.766.1001
 WWW.WOODGROUP.COM

DATE: 07/20/2015
 PROJECT: SWEETWATER PRESERVE LID PARKING AREA
 DRAWING: PROPOSED SITE PLAN



NO.	DESCRIPTION	DATE

NO.	DESCRIPTION	DATE

PROPOSED SITE PLAN

C204

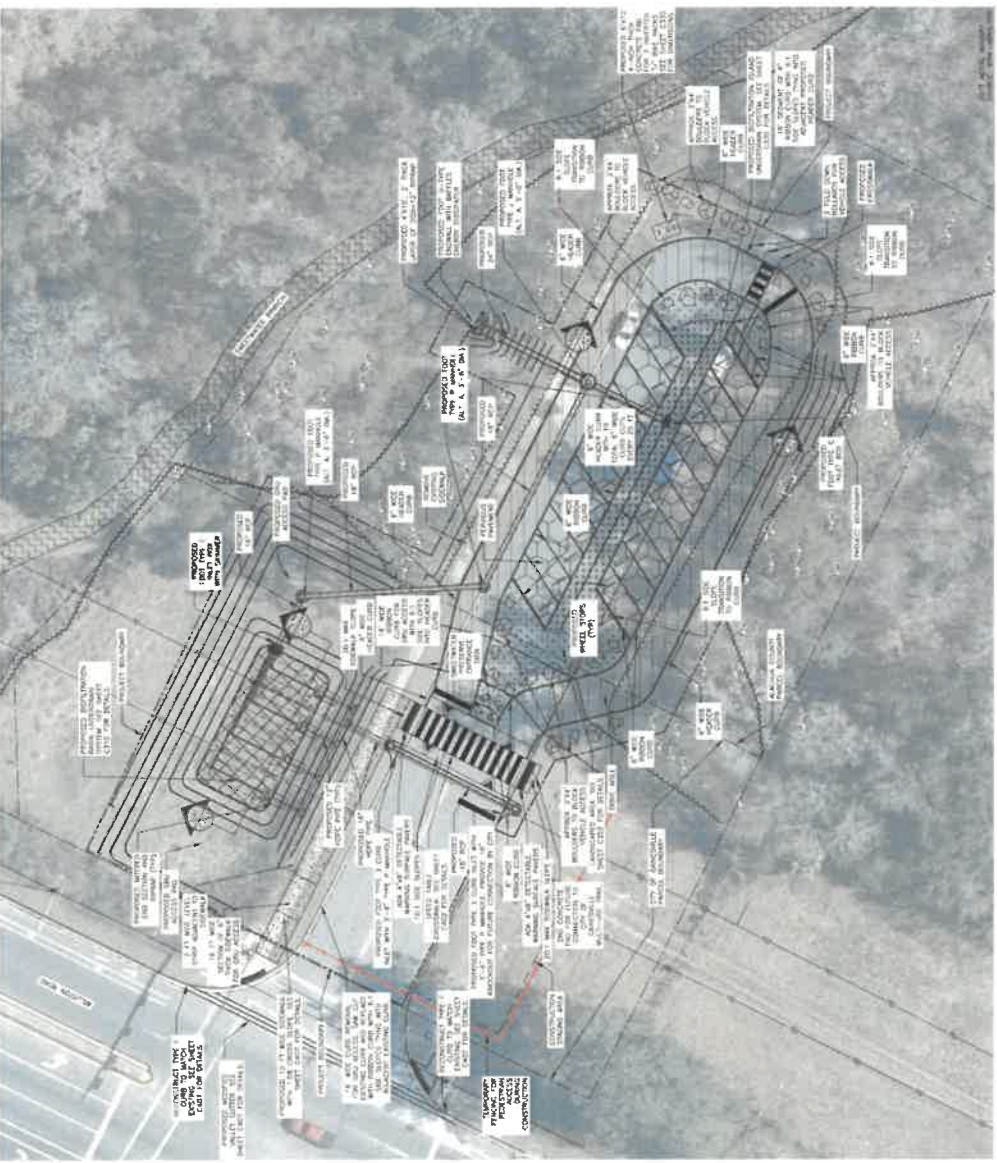

- LEGEND**
- PROJECT AREA
 - PARCEL BOUNDARY
 - TREE LINE
 - EXISTING FENCE
 - OVERHEAD UTILITIES
 - PROPOSED DRAINAGE PIPE
 - PROPOSED CONTOURS
 - SWEETWATER BRANCH
 - WETLAND BOUNDARY
 - CITY TRAIL
 - BIOFILTRATION BASIN
 - RIPRAP
 - BIOFILTRATION ISLAND
 - GREEN SPACE
 - PERVIOUS PAVEMENT
 - URNY AISLE
 - BOULDER LOCATION
 - TEMPORARY FENCE

- NOTES:**
- 1) ELEVATIONS SHOWN HEREIN ARE RELATIVE TO THE NORTH AMERICAN VERTICAL DATUM OF 1988 (NAVD 88)
 - 2) THE CONTRACTOR SHALL BE RESPONSIBLE FOR ANY DAMAGE TO STAGING AREAS AND ACCESS ROADS, THE STAGING AND DEBRIS
 - 3) PROPOSED PERMEABLE PAVEMENT SHALL BE PERVIOUS PAVEMENT SEE SIGNED AND SEALED SURVEY DRAWINGS FOR DETAILS
 - 4) CONTRACTOR TO CONTACT ALACHUA COUNTY FORESTER/LANDSCAPING INSPECTOR (352-374-5843) FOR APPROVAL OF PERVIOUS PAVEMENT AND INSPECTION PRIOR TO COMMENCEMENT OF CONSTRUCTION
 - 5) TREES AND NATIVE VEGETATION WILL BE PRESERVED INSIDE THE TREE PROTECTION BARRICADE
 - 6) TREE REMOVAL MAY BE NECESSARY IN SOME AREAS. HOWEVER CONTRACTOR SHALL RECEIVE APPROVAL FROM THE OFFICE OF LAND CONSERVATION AND MANAGEMENT PRIOR TO REMOVING ANY TREES
 - 7) WETLAND BOUNDARY SOURCE: ALACHUA COUNTY, JULY 2015
 - 8) NO TRAFFIC EQUIPMENT, BARRIS, ETC. ON PERVIOUS PAVEMENT AFTER INSTALLATION TO AVOID CLOGGING

wood.

WOOD GROUP, INC. 10000
 10000 WOODBURY DRIVE, SUITE 100
 WOODBRIDGE, VA 22191
 PHONE: 703.766.1000
 FAX: 703.766.1001
 WWW.WOODGROUP.COM

PROJECT AREA
 PARCEL BOUNDARY
 TREE LINES
 EXISTING FENCE
 OVERHEAD UTILITIES
 PROPOSED DRAINAGE PIPE
 EXISTING CONTOURS
 PROPOSED CONTOURS
 SWEETWATER BRANCH
 WETLAND BOUNDARY
 CITY TRAIL
 BIOPILTRATION BASIN
 RIPRAP
 BIOPILTRATION ISLAND
 GREEN SPACE
 PERVIOUS PAVEMENT
 PROPOSED DRAINAGE DIRECTION
 DRIVE ASYL
 BOULDER LOCATION

**SWEETWATER
 PRESERVE
 LID PARKING AREA
 PROJECT**

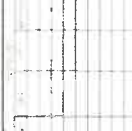

**GRADING &
 DRAINAGE PLAN**

C205

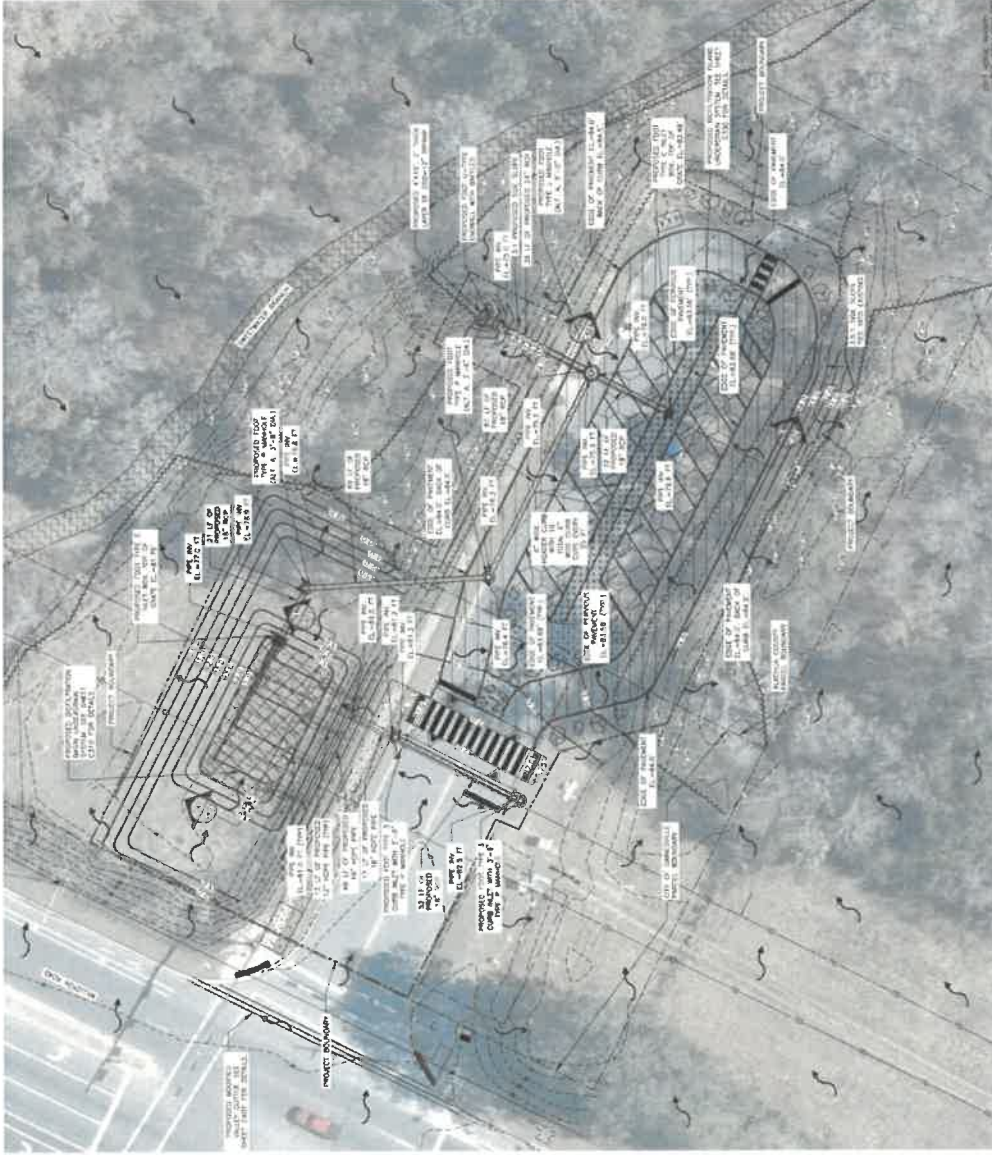

- NOTES**
- ELEVATIONS SHOWN HEREIN ARE RELATIVE TO THE NORTH AMERICAN VERTICAL DATUM OF 1988 (NAVD 88).
 - THE CONTRACTOR SHALL BE RESPONSIBLE FOR ANY DAMAGE TO STAGING AREAS AND ACCESS ROADS, THE TRACKING AND DEEPS.
 - REMARKS CAN BE FOUND THROUGHOUT THE PROJECT AREA. SEE SIGNED AND SEALED SURVEY DRAWINGS FOR DETAILS.
 - CONTRACTOR TO CONTACT ALACHUA COUNTY FORESTER/LANDSCAPING INSPECTOR (352-374-3543) FOR PERMITS AND INSPECTION PRIOR TO COMMENCEMENT OF CONSTRUCTION.
 - TREES AND NATIVE VEGETATION WILL BE PRESERVED INSIDE THE "TREE PROTECTION BARRICADE AREAS. HOWEVER, CONTRACTOR SHALL RECEIVE APPROVAL FROM THE OFFICE OF LAND CONSERVATION AND WILDLIFE PRIOR TO REMOVING ANY TREES.
 - WETLAND BOUNDARY SOURCE: ALACHUA COUNTY (JULY 2013)
 - IF ANY PART OF THE BARRICADE DEVIATES FROM PREVIOUS PAVEMENT AFTER INSTALLATION, IT WILL BE REPAIRED.

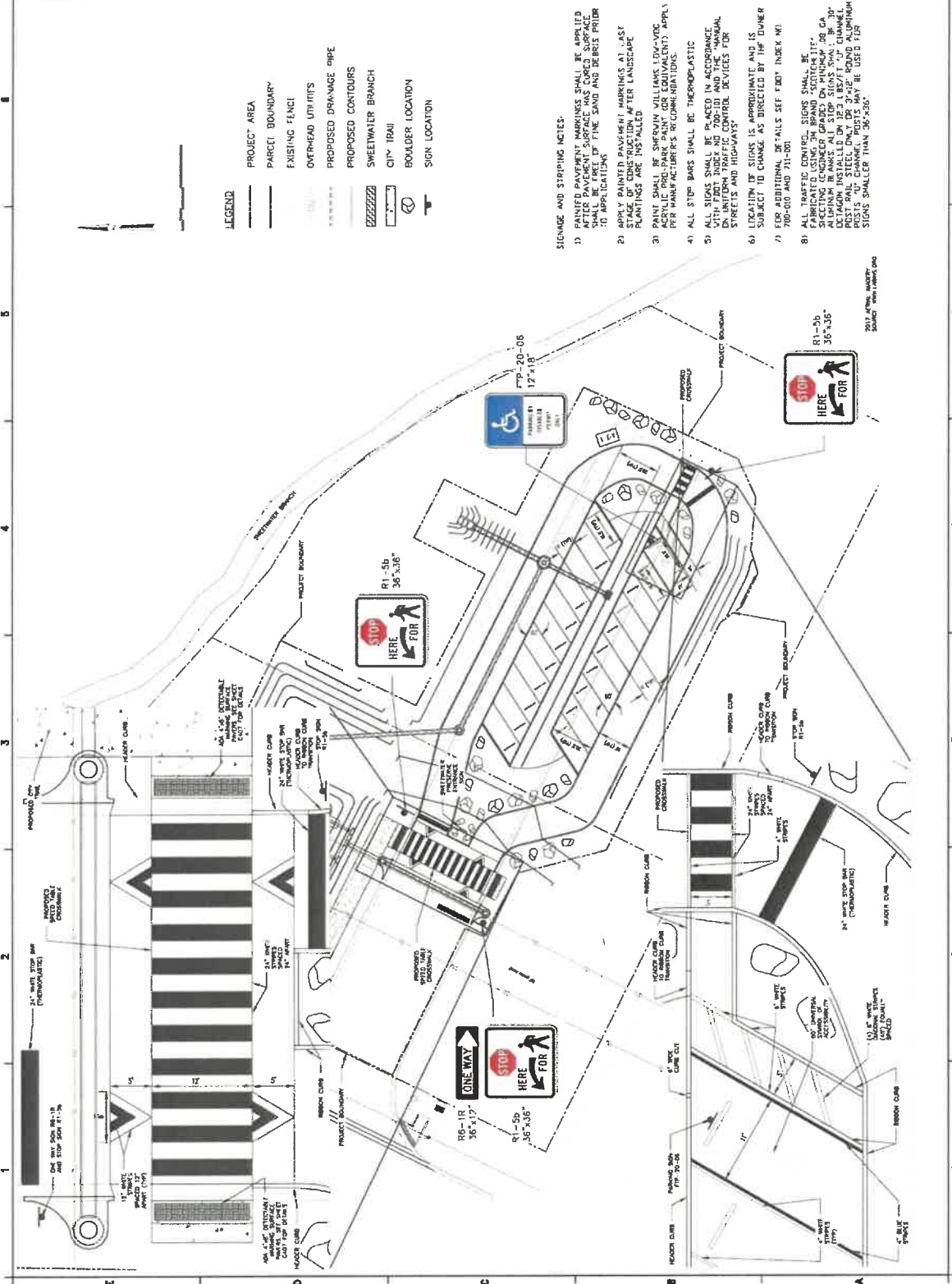

- LEGEND**
- PROJECT AREA
 - PARCEL BOUNDARY
 - EXISTING FENCE
 - OVERHEAD UTILITIES
 - PROPOSED DRAINAGE PIPE
 - PROPOSED CONTOURS
 - SWEETWATER BRANCH
 - CITY TRAIL
 - BOULDER LOCATION
 - SIGN LOCATION

- SIGNAGE AND STRIPING NOTES:**
- 1) PAINTED PAVEMENT MARKINGS SHALL BE APPLIED AFTER PAVEMENT SURFACE HAS CURED SURFACE SHALL BE FREE OF FINE SAND AND DEBRIS PRIOR TO APPLICATIONS
 - 2) APPLY PAINTED PAVEMENT MARKINGS AT LEAST 72 HOURS PRIOR TO LANDSCAPE PLANTINGS ARE INSTALLED
 - 3) PAINT SHALL BE SUPERPAVEMENT TYPE 150-MPG ACRYLIC PRE-PARK PAINT OR EQUIVALENT. APPLY PER MANUFACTURER'S RECOMMENDATIONS.
 - 4) ALL STOP BARS SHALL BE THERMOPLASTIC
 - 5) ALL SIGNS SHALL BE PLACED IN ACCORDANCE WITH TYPICAL INDEX NO. 700-100 AND THE "MANUAL ON UNIFORM TRAFFIC CONTROL DEVICES FOR STREETS AND HIGHWAYS"
 - 6) LOCATION OF SIGNS IS APPROXIMATE AND IS SUBJECT TO CHANGE AS DIRECTED BY THE OWNER
 - 7) FOR ADDITIONAL DETAILS SEE FIDY INDEX NO. 700-000 AND 711-001
 - 8) ALL TRAFFIC CONTROL SIGNS SHALL BE SELECTING CONSUMER GRADED OR HUNTER DOG CA ALUMINUM BRANES ALL STOP SIGNS SHALL BE 30" POST WALL STEEL ONLY OR 30" X 42" ROAD ALUMINUM POSTS 40" CHANNEL POSTS MAY BE USED FOR SIGNS SMALLER THAN 36" X 36"

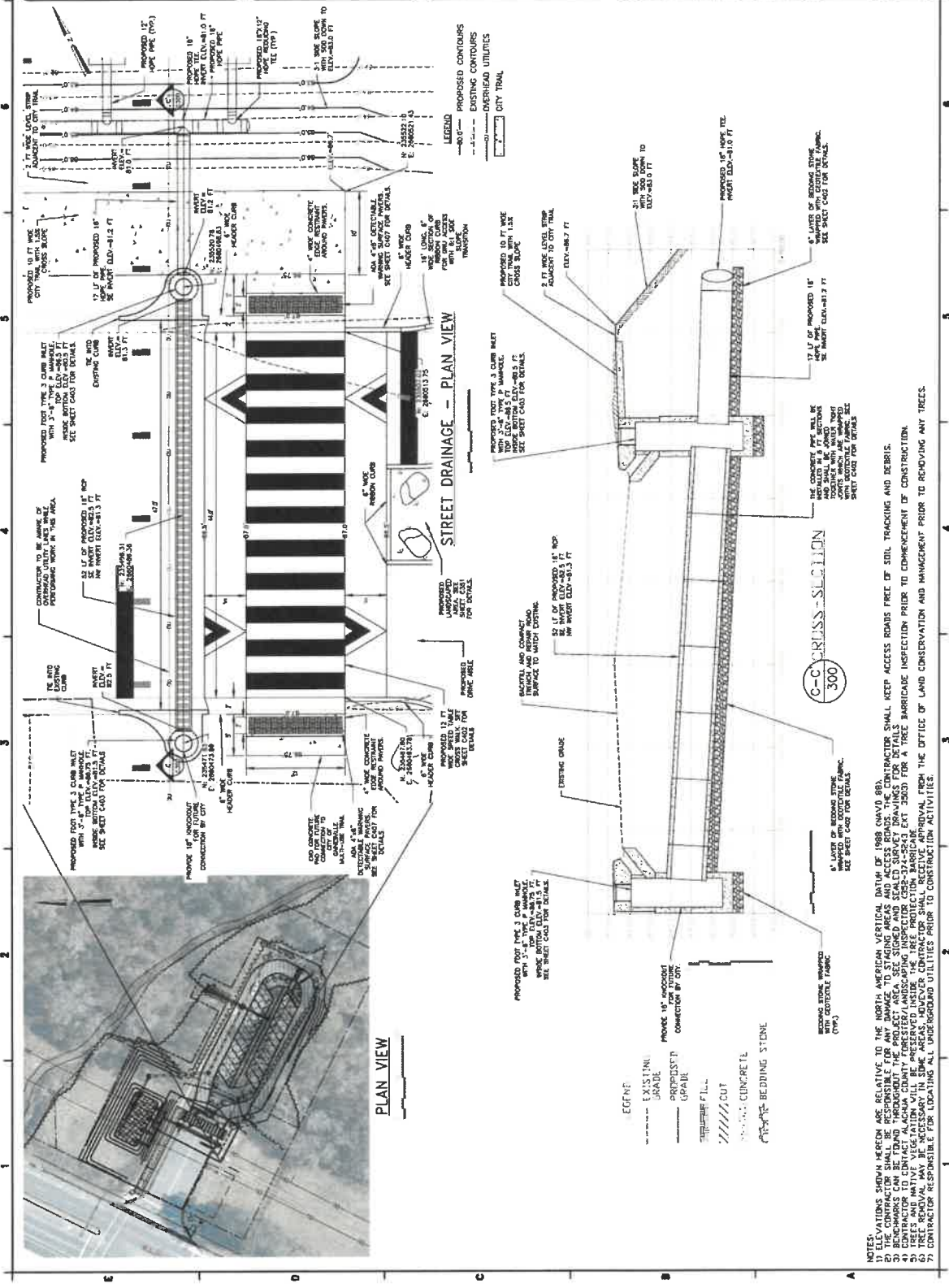

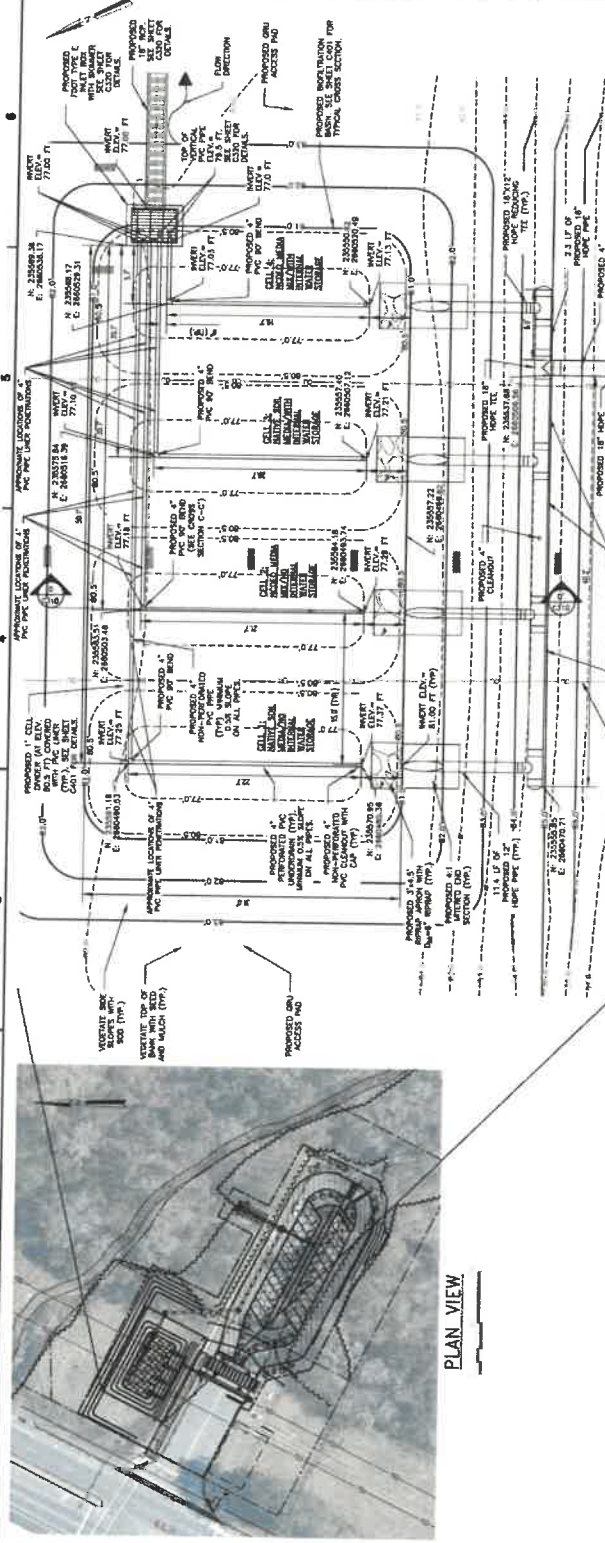

BIOFILTRATION BASIN UNDERDRAIN - PLAN VIEW

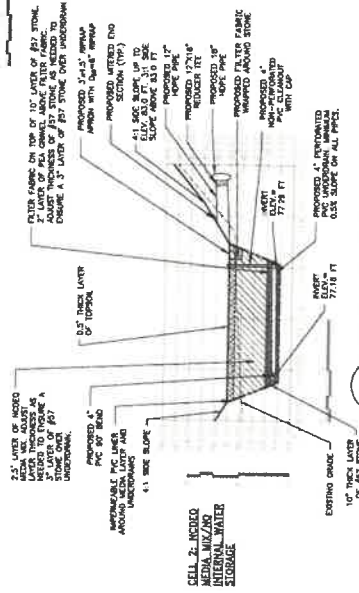

D-D CROSS-SECTION

- NOTES:
- 1) ELEVATIONS SHOWN HEREIN ARE RELATIVE TO THE NORTH AMERICAN VERTICAL DATUM OF 1988 (NAVD 88).
 - 2) CONTRACTOR SHALL BE RESPONSIBLE FOR ANY DAMAGE TO STAGING AREAS AND ACCESS ROADS. THE CONTRACTOR SHALL KEEP ACCESS ROADS FREE OF SOIL TRACKING AND DEBRIS.
 - 3) CONTRACTOR SHALL BE RESPONSIBLE FOR OBTAINING ALL NECESSARY PERMITS AND APPROVALS PRIOR TO COMMENCEMENT OF CONSTRUCTION.
 - 4) CONTRACTOR TO CONTACT ALABAMA COUNTY FORESTER/ANNUATING INSPECTOR FOR TREE PROTECTION BARRICADE SET-UP FOR A TREE PROTECTION BARRICADE.
 - 5) TREE REMOVAL MAY BE NECESSARY FOR TREE PROTECTION BARRICADE SET-UP FOR A TREE PROTECTION BARRICADE.
 - 6) CONTRACTOR SHALL BE RESPONSIBLE FOR OBTAINING ALL NECESSARY PERMITS AND APPROVALS PRIOR TO COMMENCEMENT OF CONSTRUCTION.
 - 7) CONTRACTOR RESPONSIBLE FOR LOCATING ALL UNDERGROUND UTILITIES PRIOR TO CONSTRUCTION ACTIVITIES.

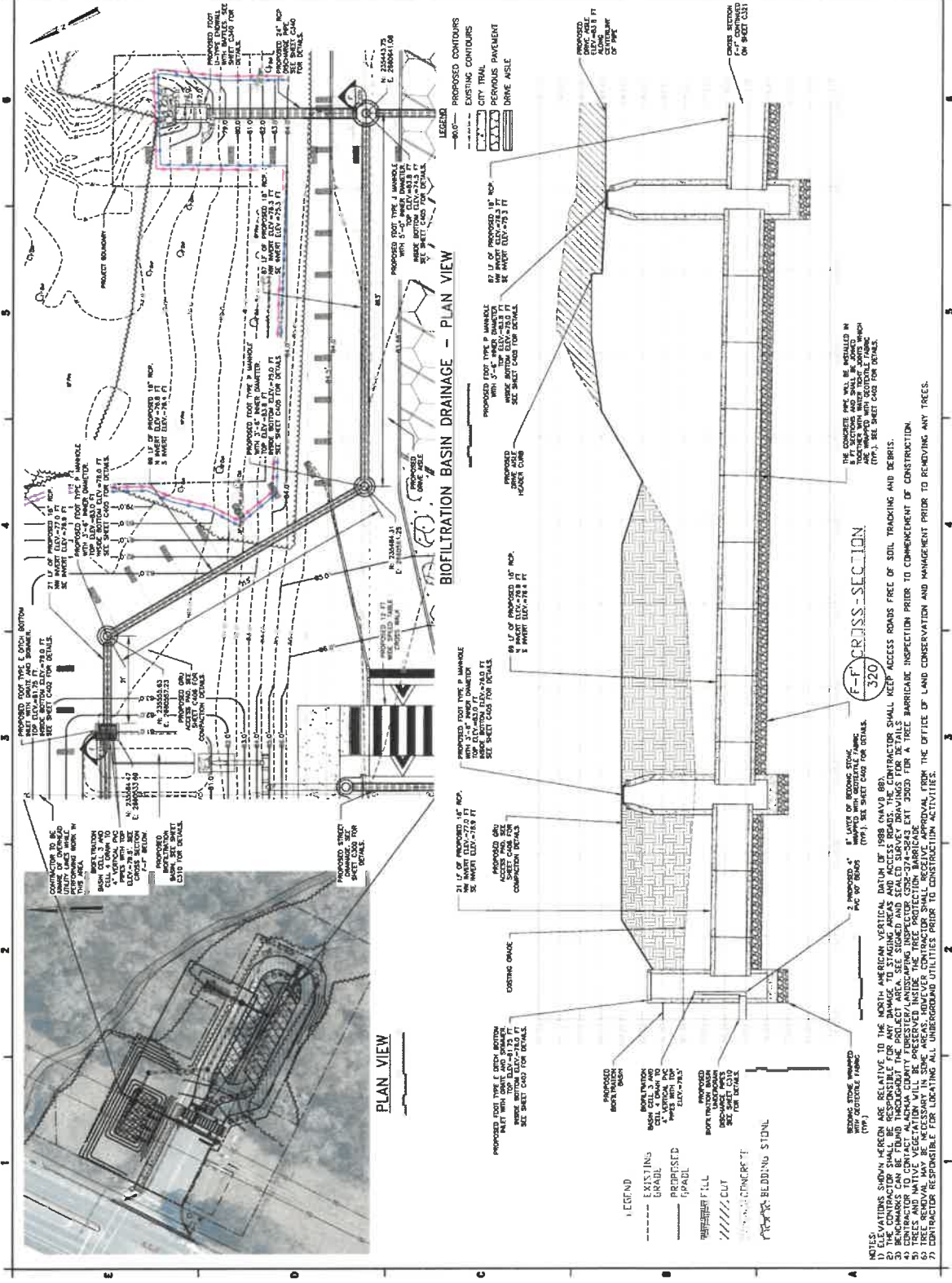

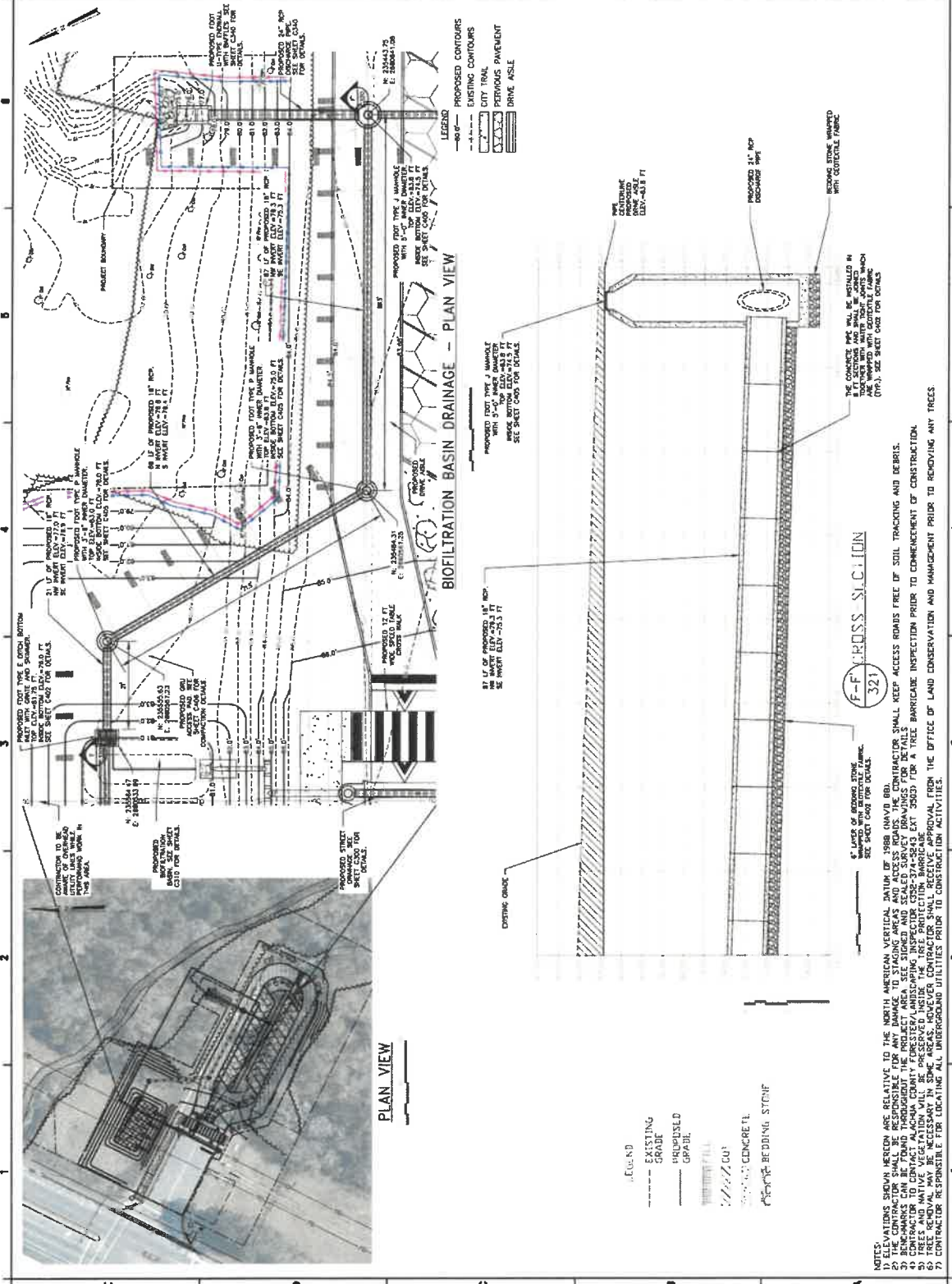

- NOTES:
- 1) ELEVATIONS SHOWN HEREON ARE RELATIVE TO THE NORTH AMERICAN VERTICAL DATUM OF 1988 (NAVD83 BVD).
 - 2) THE CONTRACTOR SHALL BE RESPONSIBLE FOR ANY DAMAGE TO STAGING AREAS AND ACCESS ROADS. THE CONTRACTOR SHALL KEEP ACCESS ROADS FREE OF SOIL TRACKING AND DEBRIS.
 - 3) THE CONTRACTOR SHALL BE RESPONSIBLE FOR OBTAINING ALL NECESSARY PERMITS AND INSURANCE PRIOR TO COMMENCEMENT OF CONSTRUCTION.
 - 4) CONTRACTOR TO CONTACT ALACHUA COUNTY FORESTER/INSPECTOR (352-374-2843 EXT. 3903) FOR A TREE PROTECTION BARRICADE.
 - 5) TREES AND NATIVE VEGETATION WILL BE PRESERVED INSIDE THE TREE PROTECTION BARRICADE.
 - 6) CONTRACTOR SHALL BE RESPONSIBLE FOR OBTAINING ALL NECESSARY PERMITS AND INSURANCE PRIOR TO COMMENCEMENT OF CONSTRUCTION.
 - 7) CONTRACTOR RESPONSIBLE FOR LOCATING ALL UNDERGROUND UTILITIES PRIOR TO CONSTRUCTION ACTIVITIES.



SWEETWATER PRESERVE LID PARKING AREA PROJECT



BIOFILTRATION ISLAND UNDERDRAIN DETAILS

C330

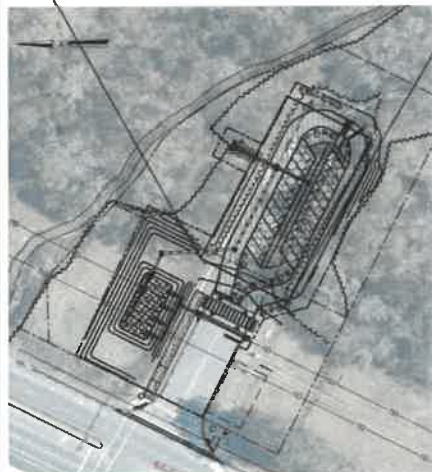
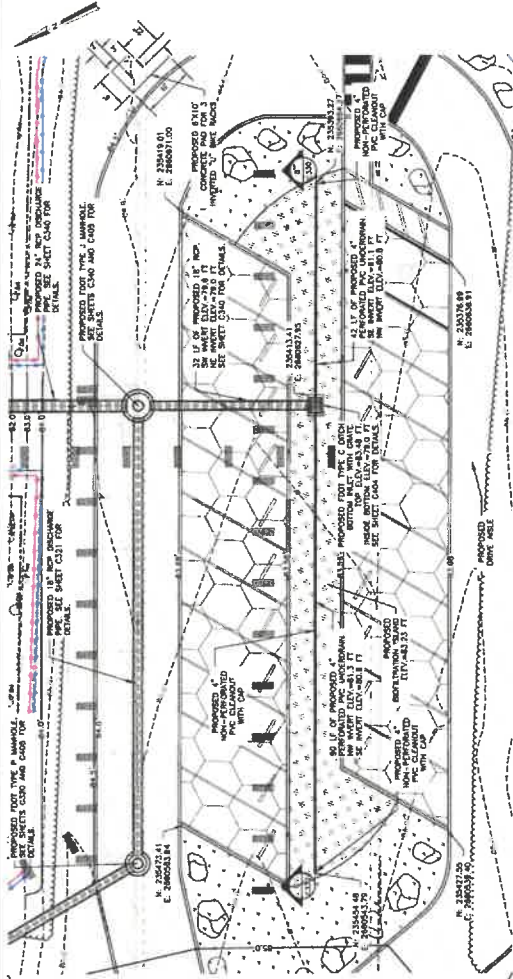

PLAN VIEW

- 1" = 10' SCALE
- EXIST'G GRADE
- PROPOSED GRADE
- CUT
- NON-PERFORATED PVC UNDERDRAIN WITH CAP
- PERFORATED PVC UNDERDRAIN WITH CAP
- CONCRETE
- BEDDING STONE
- GRAVEL

BIOFILTRATION ISLAND UNDERDRAIN - PLAN VIEW

- PROPOSED CONTOURS
- EXISTING CONTOURS
- PREVIOUS PAVEMENT
- DRIVE ASLE

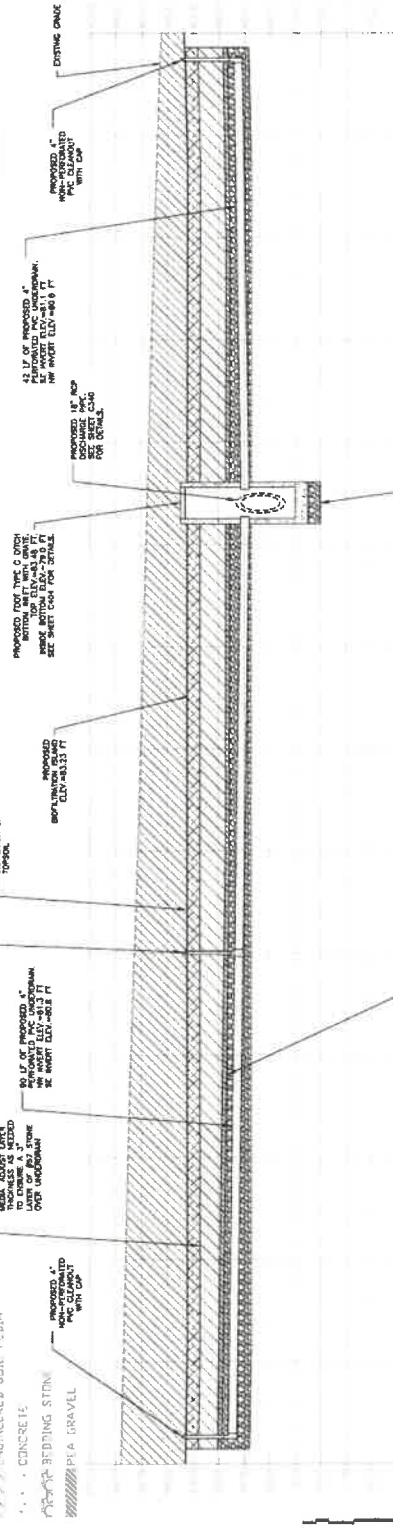

G-G CROSS-SECTION

330

FILTER FABRIC ON TOP OF 12" LAYER OF 4" STONE, 2" LAYER OF 1/2" STONE AS SHOWN ABOVE FILTER FABRIC. MINIMUM THICKNESS OF 4" STONE AS NOTED TO BEHIND 1" LAYER OF 1/2" STONE OVER UNDERDRAIN

- NOTES:
- 1) ELEVATIONS SHOWN HEREIN ARE RELATIVE TO THE NORTH AMERICAN VERTICAL DATUM OF 1988 (NAVD 88).
 - 2) THE CONTRACTOR SHALL BE RESPONSIBLE FOR ANY DAMAGE TO STAGING AREAS AND ACCESS ROADS DURING THE CONSTRUCTION. THE CONTRACTOR SHALL KEEP ACCESS ROADS FREE OF SOIL TRACKING AND DEBRIS.
 - 3) THE CONTRACTOR SHALL BE RESPONSIBLE FOR OBTAINING ALL NECESSARY PERMITS AND APPROVALS PRIOR TO COMMENCEMENT OF CONSTRUCTION.
 - 4) CONTRACTOR TO CONTACT ALABAMA COUNTY FORESTER, AND/OR INSPECTOR (335-374-5243 EXT 2302) FOR A TREE BARRICADE INSPECTION PRIOR TO COMMENCEMENT OF CONSTRUCTION.
 - 5) TREES AND NATIVE VEGETATION WILL BE PRESERVED AND PROTECTED TO THE MAXIMUM EXTENT POSSIBLE. CONTRACTOR SHALL OBTAIN APPROVAL FROM THE OFFICE OF LAND CONSERVATION AND MANAGEMENT PRIOR TO REMOVING ANY TREES.
 - 6) CONTRACTOR SHALL BE RESPONSIBLE FOR OBTAINING ALL NECESSARY PERMITS AND APPROVALS PRIOR TO COMMENCEMENT OF CONSTRUCTION.
 - 7) CONTRACTOR RESPONSIBLE FOR LOCATING ALL UNDERGROUND UTILITIES PRIOR TO CONSTRUCTION ACTIVITIES.

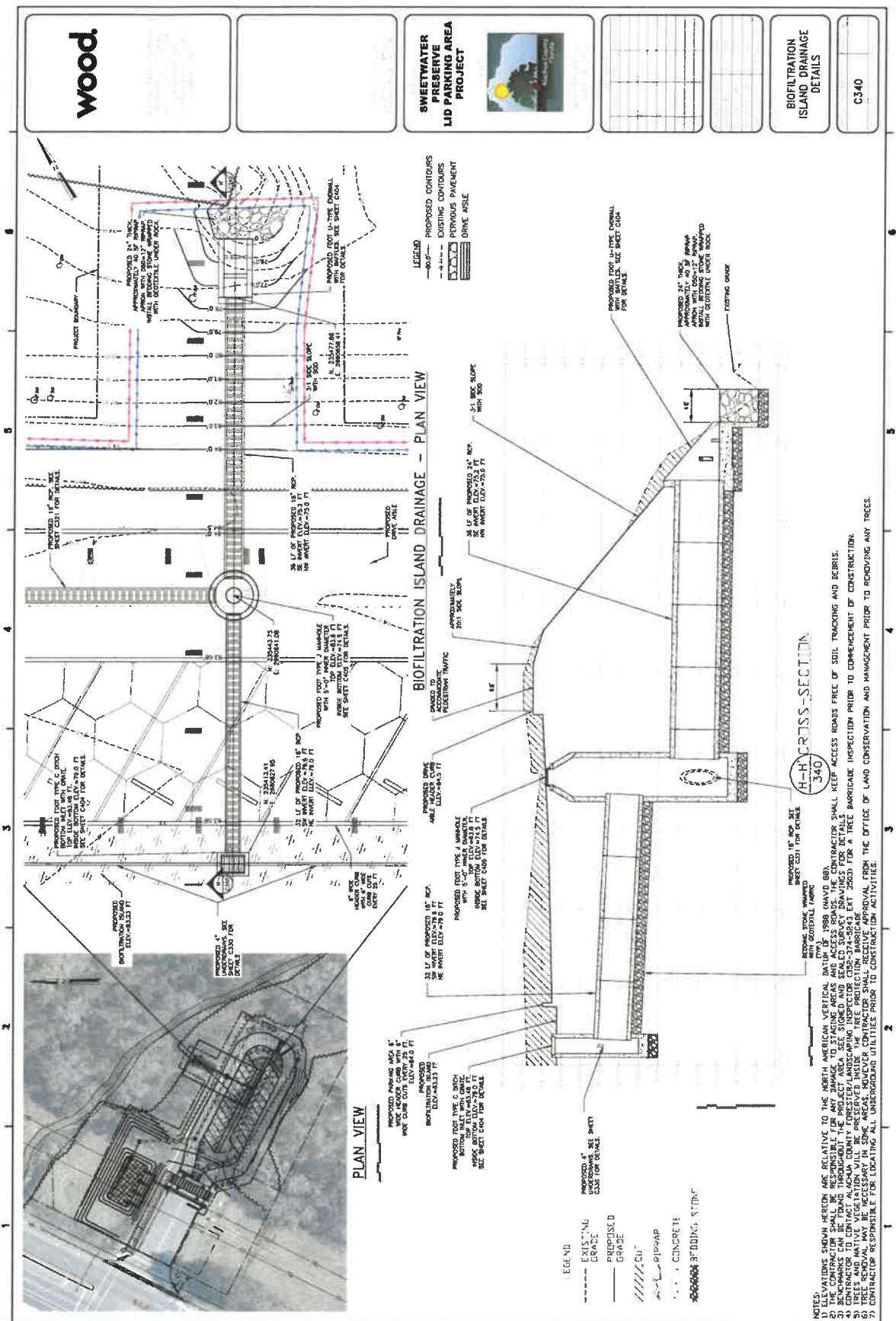

NOTES:
1) ELEVATIONS SHOWN HEREIN ARE RELATIVE TO THE NORTH AMERICAN VERTICALDatum of 1988 GRAVAD BDA.
2) THE CONTRACTOR SHALL BE RESPONSIBLE FOR ANY DAMAGE TO STAGING AREAS AND ACCESS ROADS. THE CONTRACTOR SHALL KEEP ACCESS ROADS FREE OF SOIL TRACKING AND DEBRIS.
3) THE CONTRACTOR SHALL MAINTAIN ALL EXISTING UTILITIES AND SHALL BE RESPONSIBLE FOR REPAIRING ANY DAMAGE TO EXISTING UTILITIES.
4) CONTRACTOR TO CONTACT ALASKA COUNTY FORESTIER/INSPECTOR TO OBTAIN TREE PROTECTION BARRICADE PERMITS FOR A TREE PROTECTION BARRICADE INSPECTION PRIOR TO COMMENCEMENT OF CONSTRUCTION.
5) TREES AND NATIVE VEGETATION WILL BE PRESERVED INSIDE THE TREE PROTECTION BARRICADE.
6) CONTRACTOR SHALL MAINTAIN ALL EXISTING UTILITIES AND SHALL BE RESPONSIBLE FOR REPAIRING ANY DAMAGE TO EXISTING UTILITIES.
7) CONTRACTOR RESPONSIBLE FOR LOCATING ALL UNDERGROUND UTILITIES PRIOR TO CONSTRUCTION ACTIVITIES.

wood.



Scientific Name	Common Name	Plant Size	Optimal Planting Density
<i>Spartina Bakeri</i>	Sand Cordgrass	1 gallon	3-4 ft. apart
<i>Itea virginica</i>	Virginia Sweetshrub	3 gallon	3-3.5 ft. apart
<i>Asclepias incarnata</i>	Swamp Milkweed	1 gallon	2-3 ft. apart
<i>Tripsacum dactyloides</i>	Fakahatchee Grass	1 gallon	3-5 ft. apart
<i>Conoclinium coelestinum</i>	Blue Mistflower	1 gallon	2-3 ft. apart
<i>Hypericum fasciculatum</i>	Peelbark St. John's wort	1 gallon	3-5 ft. apart

BIOFILTRATION BASIN
CELLS. SEE SHEET C310
FOR DETAILS.



NOTE:
EACH CELL MUST BE
DESIGNED TO BE AS
POSSIBLE FOR CONTINUITY IN
RESEARCH APPLICATIONS

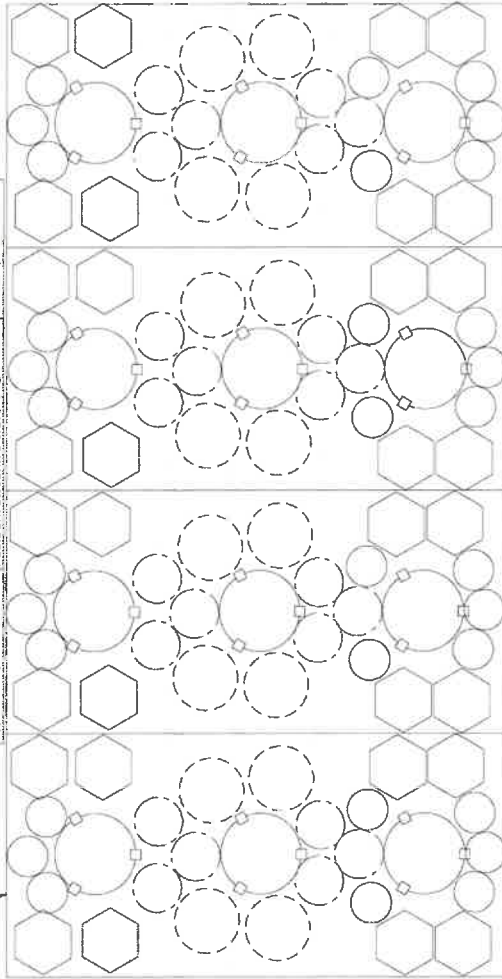

**SWEETWATER
PRESERVE
LID PARKING AREA
PROJECT**



DATE	10/1/2018
PROJECT	SWEETWATER PRESERVE LID PARKING AREA PROJECT
CLIENT	WOODS BAGOT
DESIGNER	WOODS BAGOT
SCALE	AS SHOWN

PROJECT NO.	18-001
DATE	10/1/2018
PROJECT	SWEETWATER PRESERVE LID PARKING AREA PROJECT
CLIENT	WOODS BAGOT
DESIGNER	WOODS BAGOT
SCALE	AS SHOWN

**BIOFILTRATION BASIN
PLANTING PLAN**

C350

wood.

11100 Woodloch Forest Dr.
 Suite 100
 Raleigh, NC 27617
 Phone: 919.877.1000
 Fax: 919.877.1001
 www.woodgroup.com

11100 Woodloch Forest Dr.
 Suite 100
 Raleigh, NC 27617
 Phone: 919.877.1000
 Fax: 919.877.1001
 www.woodgroup.com

**SWEETWATER PRESERVE
 LID PARKING AREA
 PROJECT**



DATE: 11/16/2011
SCALE: 1" = 10'
PROJECT: SWEETWATER PRESERVE LID PARKING AREA PROJECT
DRAWN BY: [blank]
CHECKED BY: [blank]
DATE: 11/16/2011

PROJECT NO.: [blank]
DATE: 11/16/2011
SCALE: 1" = 10'
PROJECT: SWEETWATER PRESERVE LID PARKING AREA PROJECT
DRAWN BY: [blank]
CHECKED BY: [blank]
DATE: 11/16/2011

**BIOFILTRATION ISLAND
 PLANTING PLAN**

C351

Scientific Name	Common Name	Plant Size	Spacing
<i>Helianthus angustifolius</i>	Swamp Sunflower	1 gallon	2-3 ft. apart
<i>Heliotropium angiospermum</i>	Scorpion-tail	1 gallon	2-4 ft. apart
<i>Asclepias tuberosa</i>	Butterfly Weed	1 gallon	1-2 ft. apart
<i>Muhlenbergia capillaris</i>	Muhly Grass	1 gallon	2-3 ft. apart

[Dotted pattern]	Scorpion-tail
[Orange flower pattern]	Butterfly Weed and Swamp Sunflower
[Pink grass pattern]	Muhly Grass
[Hatched pattern]	Landscaped Area

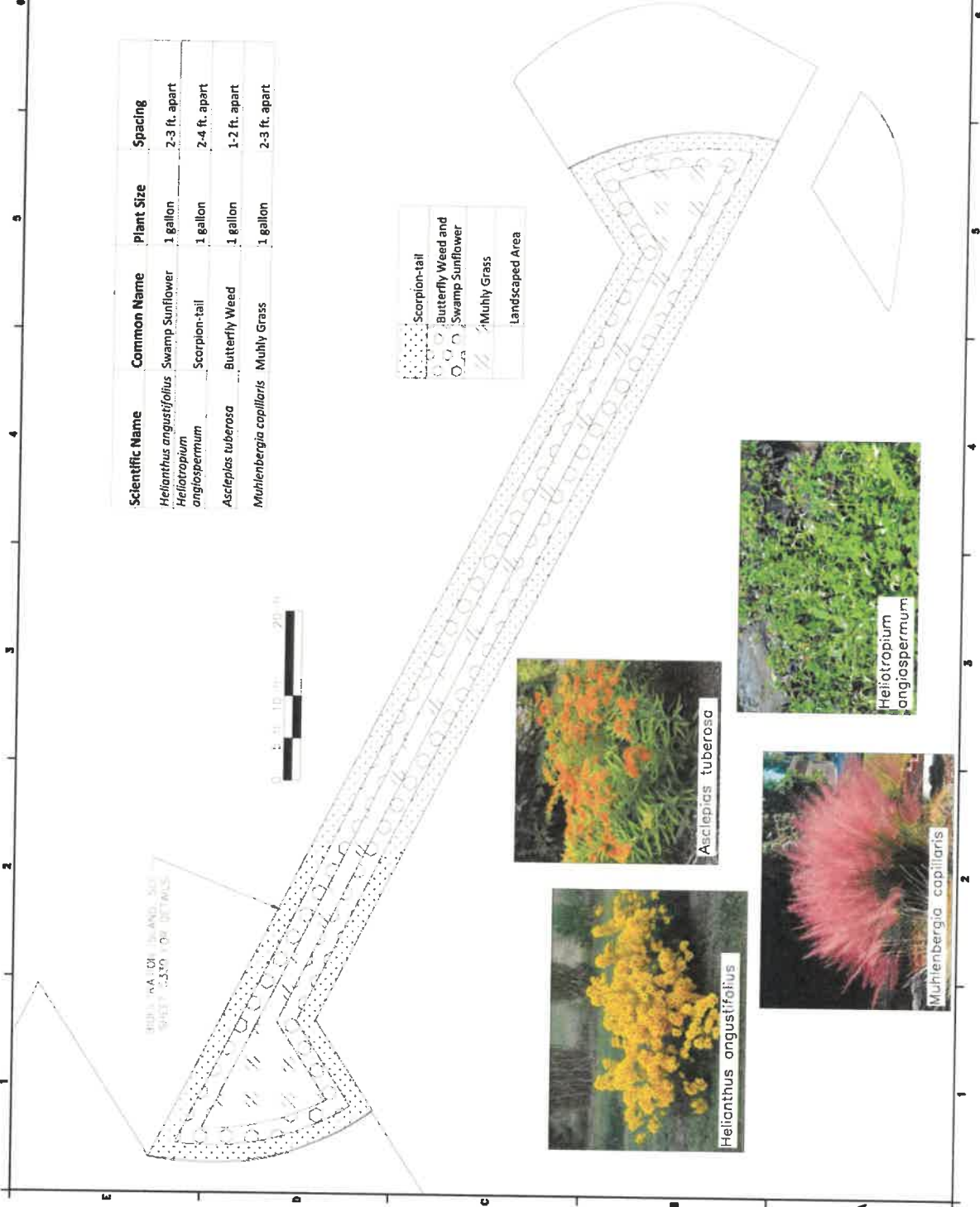

wood.

WOODS AND WATERS
 1000 W. WOODS
 SUITE 200, WOODS
 WOODS, VA 22186
 (703) 766-1000
 WWW.WOODSVA.COM

1000 W. WOODS
 SUITE 200, WOODS
 WOODS, VA 22186
 (703) 766-1000

**SWEETWATER
 PRESERVE
 LID PARKING AREA
 PROJECT**



DATE: 10/15/17
 SHEET: 28 OF 35
 PROJECT: SWEETWATER PRESERVE LID PARKING AREA PROJECT

**LANDSCAPED AREA
 PLANTING PLAN**

C352

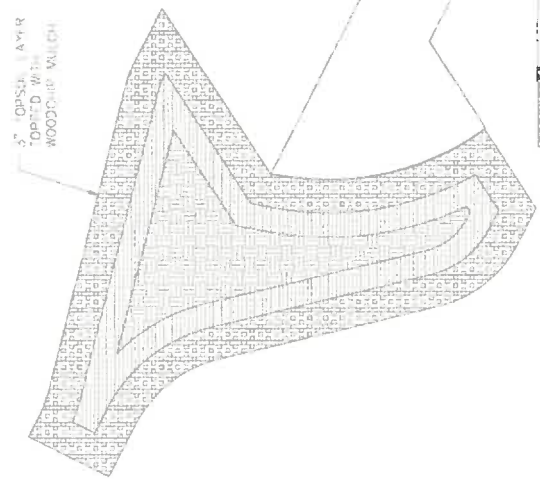

- Limestone Boulder
- Blue Porterweed and Coontie
- Blue Porterweed and Firebush
- Fringetree and Saw Palmetto
- Biofiltration Island

Scientific Name	Common Name	Plant Size	Spacing
<i>Hamamelis virginica</i>	Firebush	1 gallon	2-3 ft. apart
<i>Zamia integrifolia</i>	Coontie	1 gallon	1-2 ft. apart
<i>Stachytarpheta jamaicensis</i>	Blue Porterweed	1 gallon	3-4 ft. apart
<i>Chionanthus virginicus</i>	Fringetree	3 gallon	10-12 ft. apart
<i>Serenoa Repens</i>	Saw Palmetto	3 gallon	3-5 ft



WOOD GROUP, INC.
 10000 WOODBURY BLVD.
 SUITE 100
 WOODBRIDGE, VA 22191
 TEL: (703) 533-3398
 FAX: (703) 533-3399
 AUTOCAD NUMBER: 3392

WOOD GROUP, INC.
 10000 WOODBURY BLVD.
 SUITE 100
 WOODBRIDGE, VA 22191
 TEL: (703) 533-3398
 FAX: (703) 533-3399
 AUTOCAD NUMBER: 3392

SWEETWATER PRESERVE PARKING AREA PROJECT



WOOD PROJECT NO.: 999-P-0017

SHEET NO. 1

TYPICAL DETAILS I

C401

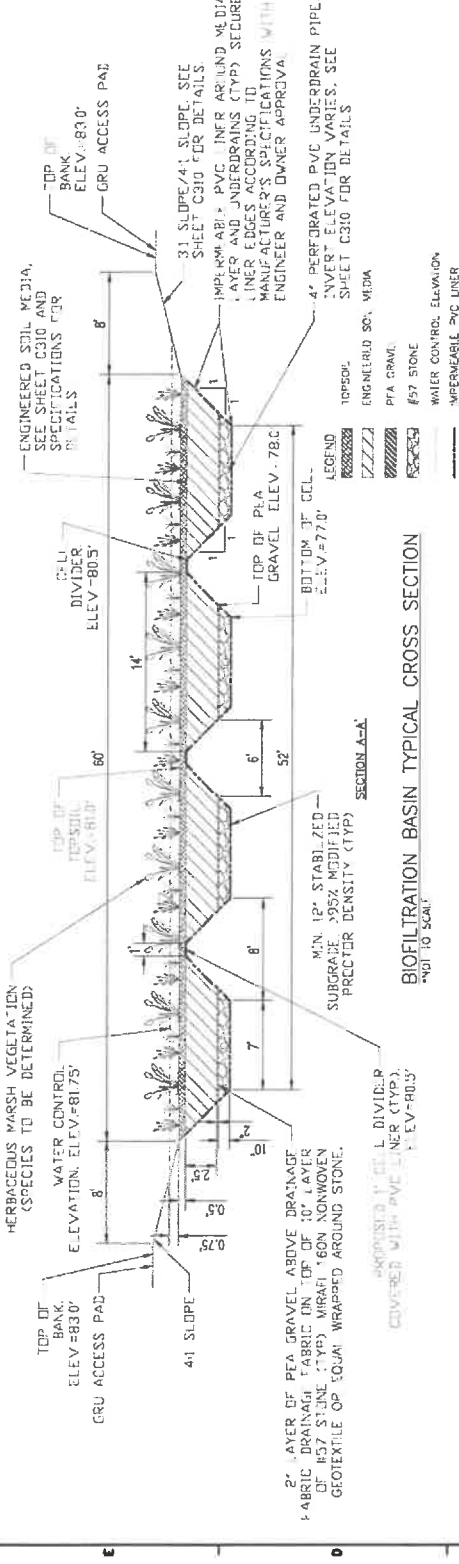

BIOFILTRATION BASIN TYPICAL CROSS SECTION A-A

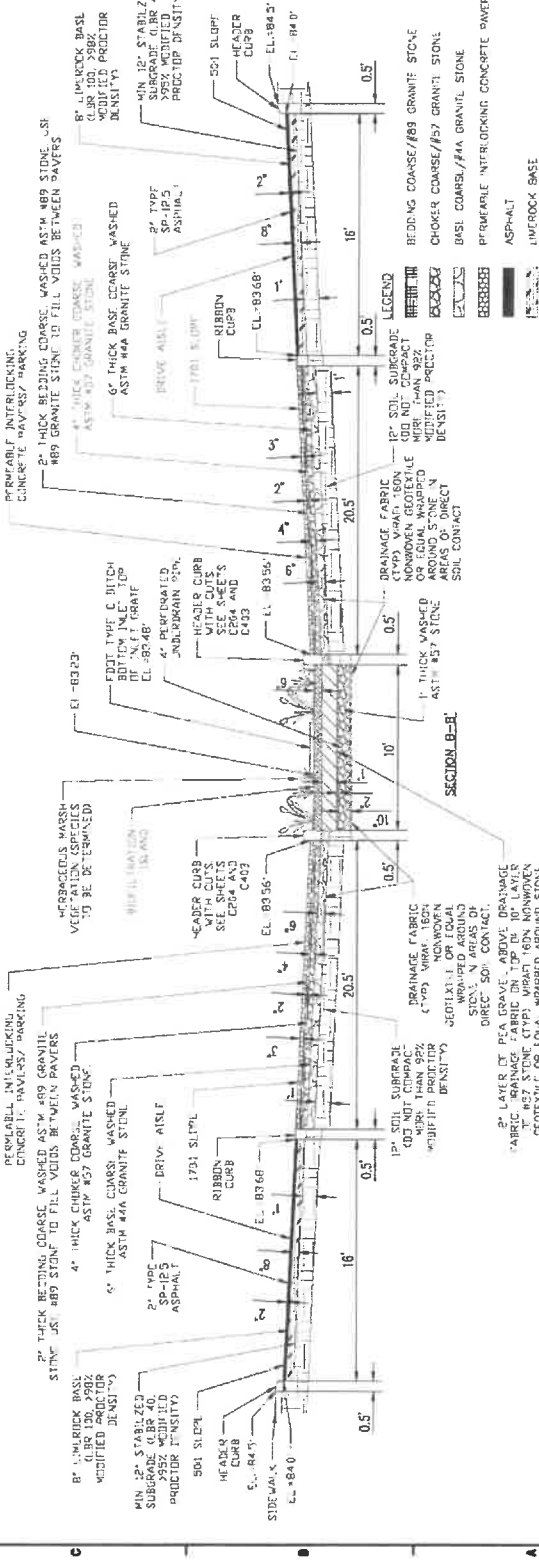

PERVIOUS PAVEMENT AREA TYPICAL CROSS SECTION

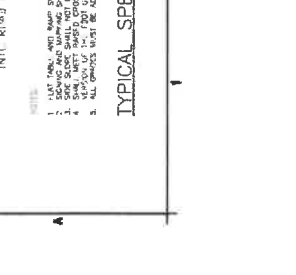
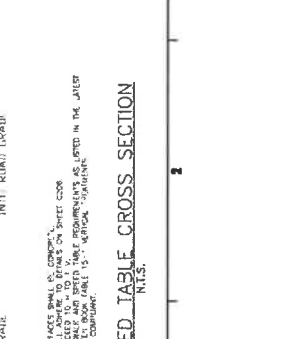
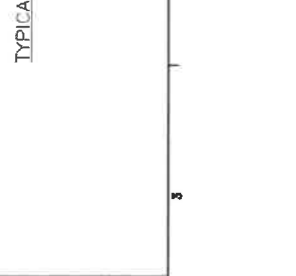
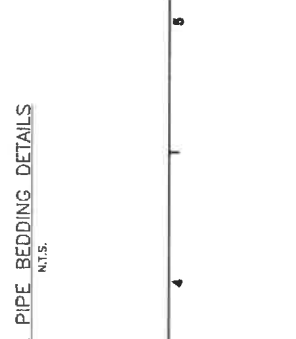
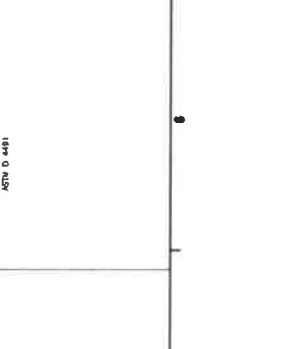
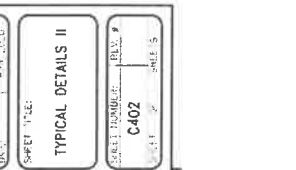
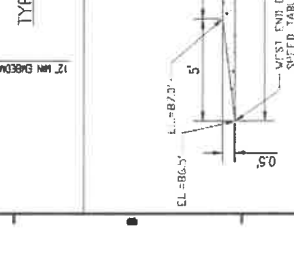
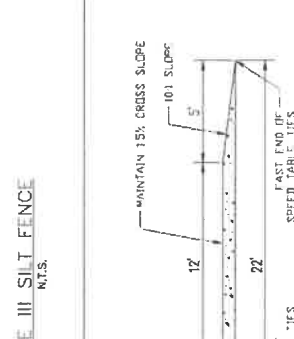
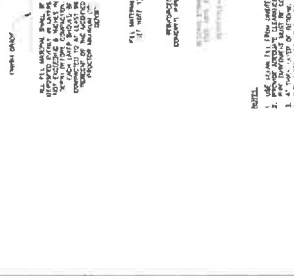
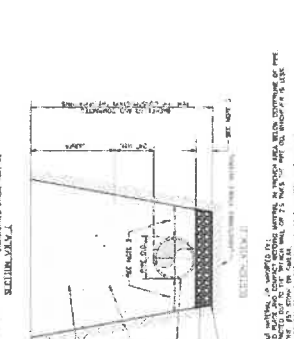
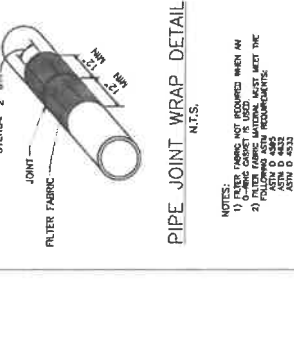
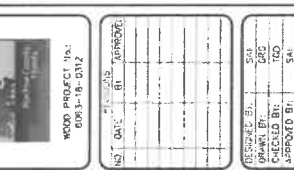
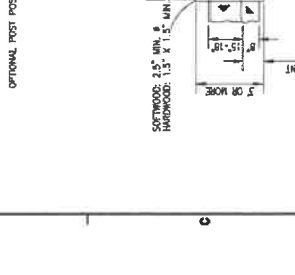
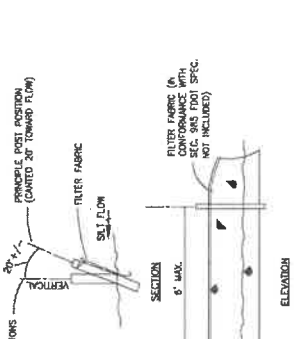
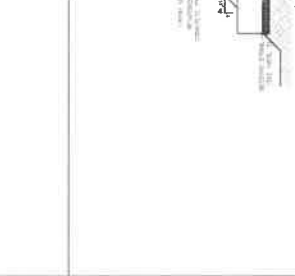
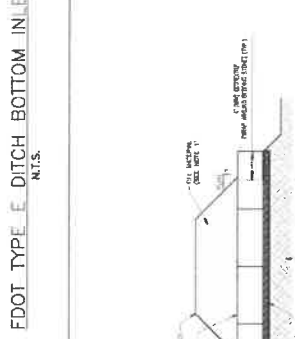
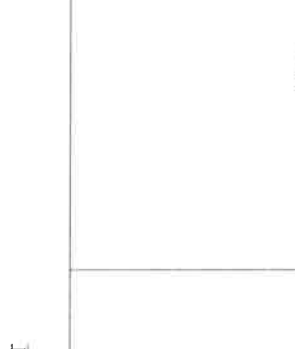
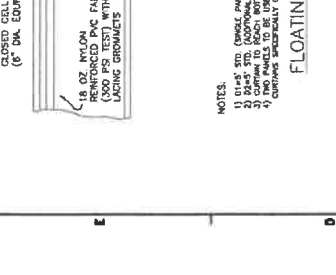
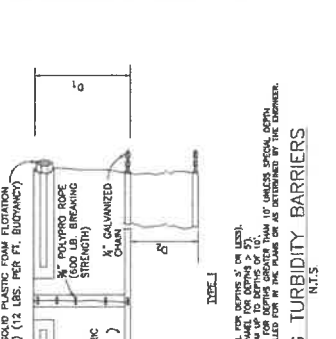
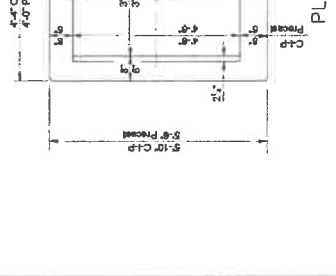
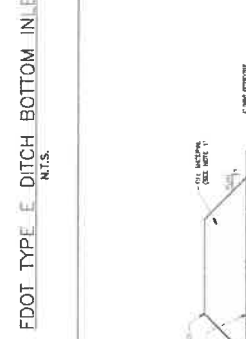
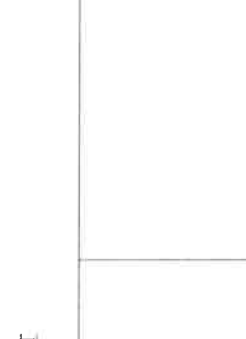
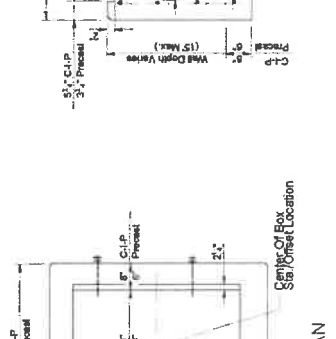
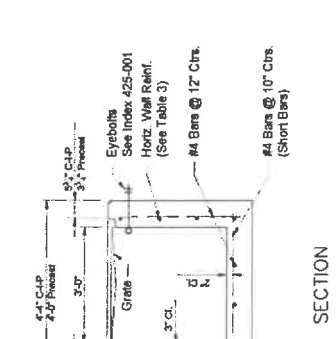

wood.

424 SW 40TH TERRACE
 NEWBERY, FL 32669
 TEL: (904) 332-3278
 AUTHORIZED LICENSE
 NUMBER 5387

SEAL & P.E.
 LICENSE NO. 12000002

PROJECT:
**SWEETWATER
 PRESERVE
 LID PARKING AREA
 PROJECT**



WOOD PROJECT No.
 005-18-0312

DESIGNED BY:	DATE:
CHECKED BY:	DATE:
PROJECT NO.:	SCALE:
DATE:	

PROJECT TITLE:
TYPICAL DETAILS III

SHEET NUMBER:	TOTAL #
C403	4
DATE:	

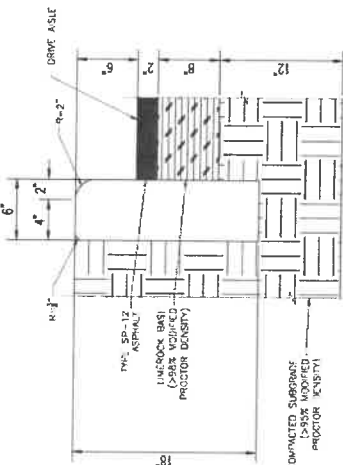

HEADER CURB DETAIL II
 (OUTER EDGE OF DRIVE AISLE)

NOTES
 1. Construct curb according to FDOT Standard Section 520

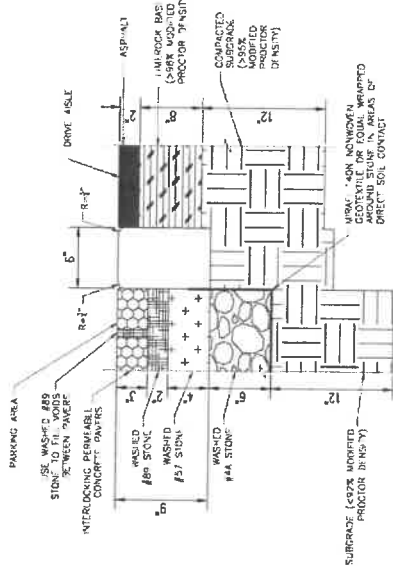

RIBBON CURB DETAIL
 (PERVIOUS PARKING TO DRIVE AISLE TRANSITION)

NOTES
 1. Construct curb according to FDOT Standard Section 520

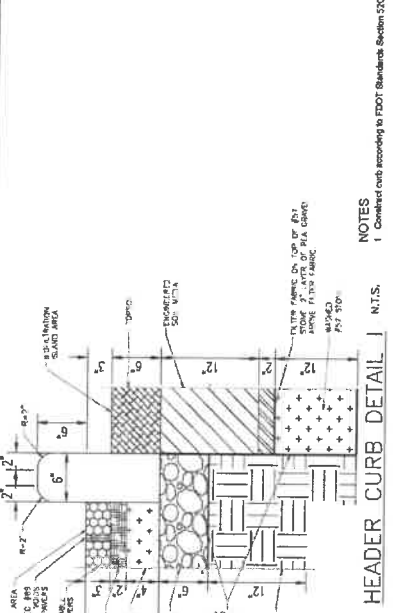

HEADER CURB DETAIL I
 (PERVIOUS PARKING TO BIOFILTRATION ISLAND TRANSITION)

NOTES
 1. Construct curb according to FDOT Standard Section 520

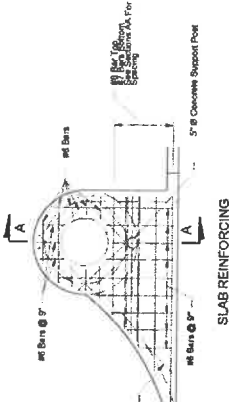

3'-0" DIA. CURB INLET
 N.T.S.

GENERAL NOTES
 1. The finished grade and slope of the inlet box is in conformance with the finished curb slope and grade of the proposed driveway and border.
 2. Inlet box shall have 1/2 inch sand below subgrade.
 3. For pervious curb the rear wall and apron may be placed as a concrete curb with 1/2 inch sand below subgrade.
 4. CONSTRUCTION JOINTS shall be in accordance with Item No. 201 (OPTIONAL).
 5. Only round concrete support curb will be acceptable.
 6. For structure bottom see Item No. 200.

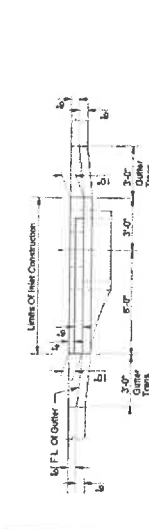
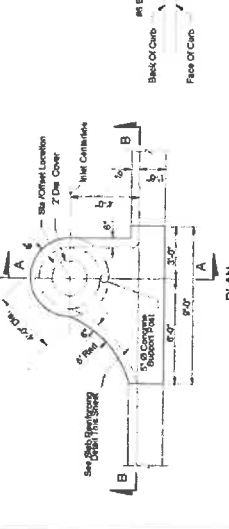

3'-0" DIA. STRUCTURE BOTTOM (SECTION AA)
 N.T.S.

GENERAL NOTES
 1. The finished grade and slope of the inlet box is in conformance with the finished curb slope and grade of the proposed driveway and border.
 2. Inlet box shall have 1/2 inch sand below subgrade.
 3. For pervious curb the rear wall and apron may be placed as a concrete curb with 1/2 inch sand below subgrade.
 4. CONSTRUCTION JOINTS shall be in accordance with Item No. 201 (OPTIONAL).
 5. Only round concrete support curb will be acceptable.
 6. For structure bottom see Item No. 200.

wood.

404 SW 140TH AVENUE
MIDDLEBORO, FL 32666
TEL: 888.791.5274
WWW.WOODGROUP.COM
CERTIFICATE OF
APPROPRIATION LICENSE
NUMBER 3887

STATE OF FLORIDA
FLORIDA PROFESSIONAL ENGINEER
REGISTERED PROFESSIONAL

PROJECT
SWEETWATER
PARKING AREA
LID PAVING AREA
PROJECT



WOOD PROJECT No:
0931-18-032

DESIGNED BY	CJA
DRAWN BY	GRG
CHECKED BY	LD
APPROVED BY	SJA
DATE	07/27/2010

SHEET TITLE

TYPICAL DETAILS IV

SCALE	AS SHOWN
DATE	7/27/10
PROJECT	C104
SHEET	28 of 19

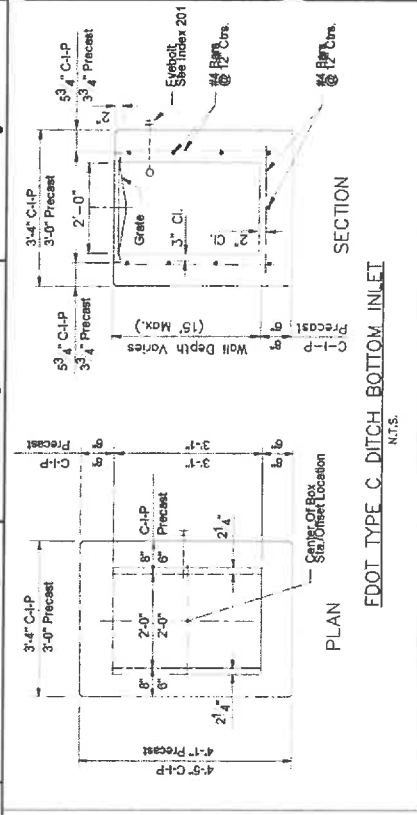

DIMENSIONS AND QUANTITIES FOR BAFFLES

Pipe Size D	X Baffle P	Y Baffle Height	R Length	Bar M	Bar N	Class I Reinf. Concrete Cu. Yd.		Class II Reinf. Steel Lbs	
						4. #4	3. #4	0.10	12
24"	5"	5"	6"	4. #4 <td>3. #4</td> <td></td> <td></td> <td></td> <td></td>	3. #4				

DIMENSIONS AND QUANTITIES FOR ONE U-ENDEWALL

Rate Of Slope	Pipe Size D	Area (Sq. Ft.)	L	H	W	Baffle Locations (When Required)			Reinf. Concrete Cu. Yd.	Reinf. Steel Lbs.
						S	B	C		
1.3	24"	3.14	7'-6"	2'-6"	2'-4"	2'-5"	2'-5"	1.94	77	

ENDWALLS WITH BAFFLES FOR 1:3 SLOPES

- GENERAL NOTES**
- All reinforcing bars shall be #4 unless noted to the contrary.
 - Minimum concrete cover shall be 2" for all bars. For bars in contact with earth, the minimum cover shall be 3" for Class I and 2" for Class II, except for bars in contact with aggregate where the minimum cover shall be 1" for Class I and 2" for Class II.
 - Reinforcing bars shall be lap spliced in accordance with Section 503 and 503.2 of the Standard Specifications.
 - Minimum concrete strength shall be 3,000 psi.
 - Concrete shall be Class I or Class II concrete in accordance with the requirements of Section 502 of the Standard Specifications.

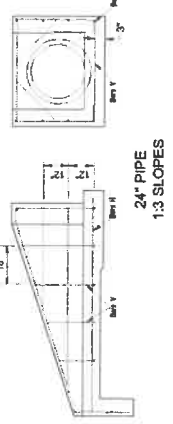

SIDE VIEW AND BACKWALL SECTION
REINFORCING DETAIL

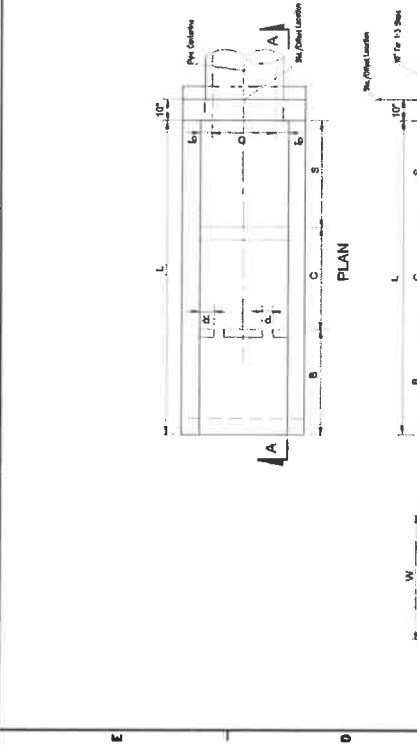

DIMENSIONAL DETAILS

Section AA details showing dimensions for the endwall and baffle locations.

DIMENSIONAL DETAILS

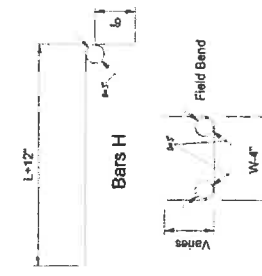

BENDING DIAGRAM

EFOOT U-TYPE CONCRETE ENDWALL WITH BAFFLES

wood.

404 SW 140TH STREET
MIRAMAR, FL 33189
TEL: (305) 433-3328
AUTOMATIC DIALING
NUMBER 5387

CLASS. & ENG. BY
ENGINEER OF RECORD

**SWEETWATER
PRESERVE
LID PARKING AREA
PROJECT**



WOOD PROJECT No.
605.1-19-0317

REV.	DATE	BY	DESCRIPTION

PROJECT NO.	509
DATE	03/02
APPROVAL BY	RJA/TSC/2007
DATE	

SHEET TITLE:
TYPICAL DETAILS V

SHEET NUMBER: REV. 2
C405

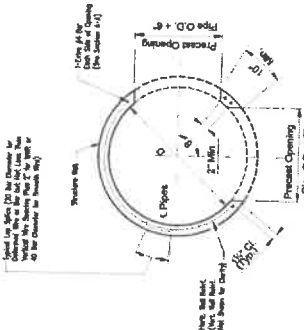

**PRECAST ROUND STRUCTURES WITH
MULTIPLE PIPE CONNECTIONS**

GENERAL NOTES

- Reinforced concrete hollow 30" diameter and smaller (All A) and 36" square (All B) are designated Type P. Larger hollow 36" diameter and smaller (All C) and 42" square (All D) are designated Type R. Reinforced concrete hollow 48" diameter and smaller (All E) are designated Type S.
- Walls of rectangular structures (All A) constructed in place may be of brick or masonry concrete with reinforcement as specified in Section 05110. Reinforced concrete hollow 36" diameter and smaller (All C) are designated Type P. Larger hollow 36" diameter and smaller (All D) are designated Type R. Reinforced concrete hollow 48" diameter and smaller (All E) are designated Type S.
- Walls of rectangular structures (All A) constructed in place may be of brick or masonry concrete with reinforcement as specified in Section 05110. Reinforced concrete hollow 36" diameter and smaller (All C) are designated Type P. Larger hollow 36" diameter and smaller (All D) are designated Type R. Reinforced concrete hollow 48" diameter and smaller (All E) are designated Type S.
- Top and bottom slab thickness and reinforcement for rectangular structures shall be in accordance with ACI 308. All concrete shall be of Class II concrete, except when Class III concrete is specified in the project documents. Reinforcement shall be in accordance with ACI 308. All reinforcement shall be in accordance with ACI 308. All reinforcement shall be in accordance with ACI 308.
- All reinforcement shall be in accordance with ACI 308. All reinforcement shall be in accordance with ACI 308. All reinforcement shall be in accordance with ACI 308.
- Reinforcement shall be in accordance with ACI 308. All reinforcement shall be in accordance with ACI 308. All reinforcement shall be in accordance with ACI 308.
- Reinforcement shall be in accordance with ACI 308. All reinforcement shall be in accordance with ACI 308. All reinforcement shall be in accordance with ACI 308.
- Reinforcement shall be in accordance with ACI 308. All reinforcement shall be in accordance with ACI 308. All reinforcement shall be in accordance with ACI 308.
- Reinforcement shall be in accordance with ACI 308. All reinforcement shall be in accordance with ACI 308. All reinforcement shall be in accordance with ACI 308.
- Reinforcement shall be in accordance with ACI 308. All reinforcement shall be in accordance with ACI 308. All reinforcement shall be in accordance with ACI 308.
- Reinforcement shall be in accordance with ACI 308. All reinforcement shall be in accordance with ACI 308. All reinforcement shall be in accordance with ACI 308.
- Reinforcement shall be in accordance with ACI 308. All reinforcement shall be in accordance with ACI 308. All reinforcement shall be in accordance with ACI 308.
- Reinforcement shall be in accordance with ACI 308. All reinforcement shall be in accordance with ACI 308. All reinforcement shall be in accordance with ACI 308.
- Reinforcement shall be in accordance with ACI 308. All reinforcement shall be in accordance with ACI 308. All reinforcement shall be in accordance with ACI 308.
- Reinforcement shall be in accordance with ACI 308. All reinforcement shall be in accordance with ACI 308. All reinforcement shall be in accordance with ACI 308.

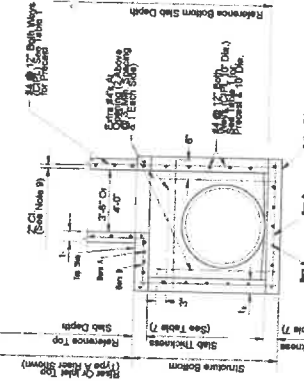

**SECTION A-A
(ALTERNATE A)**

- Reinforcement shall be in accordance with ACI 308. All reinforcement shall be in accordance with ACI 308. All reinforcement shall be in accordance with ACI 308.
- Reinforcement shall be in accordance with ACI 308. All reinforcement shall be in accordance with ACI 308. All reinforcement shall be in accordance with ACI 308.
- Reinforcement shall be in accordance with ACI 308. All reinforcement shall be in accordance with ACI 308. All reinforcement shall be in accordance with ACI 308.
- Reinforcement shall be in accordance with ACI 308. All reinforcement shall be in accordance with ACI 308. All reinforcement shall be in accordance with ACI 308.
- Reinforcement shall be in accordance with ACI 308. All reinforcement shall be in accordance with ACI 308. All reinforcement shall be in accordance with ACI 308.
- Reinforcement shall be in accordance with ACI 308. All reinforcement shall be in accordance with ACI 308. All reinforcement shall be in accordance with ACI 308.
- Reinforcement shall be in accordance with ACI 308. All reinforcement shall be in accordance with ACI 308. All reinforcement shall be in accordance with ACI 308.
- Reinforcement shall be in accordance with ACI 308. All reinforcement shall be in accordance with ACI 308. All reinforcement shall be in accordance with ACI 308.
- Reinforcement shall be in accordance with ACI 308. All reinforcement shall be in accordance with ACI 308. All reinforcement shall be in accordance with ACI 308.
- Reinforcement shall be in accordance with ACI 308. All reinforcement shall be in accordance with ACI 308. All reinforcement shall be in accordance with ACI 308.
- Reinforcement shall be in accordance with ACI 308. All reinforcement shall be in accordance with ACI 308. All reinforcement shall be in accordance with ACI 308.
- Reinforcement shall be in accordance with ACI 308. All reinforcement shall be in accordance with ACI 308. All reinforcement shall be in accordance with ACI 308.
- Reinforcement shall be in accordance with ACI 308. All reinforcement shall be in accordance with ACI 308. All reinforcement shall be in accordance with ACI 308.
- Reinforcement shall be in accordance with ACI 308. All reinforcement shall be in accordance with ACI 308. All reinforcement shall be in accordance with ACI 308.
- Reinforcement shall be in accordance with ACI 308. All reinforcement shall be in accordance with ACI 308. All reinforcement shall be in accordance with ACI 308.

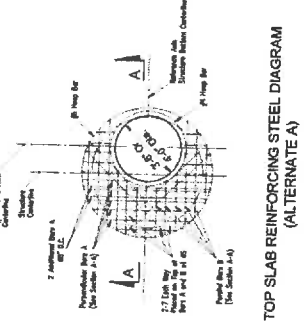

**TOP SLAB REINFORCING STEEL DIAGRAM
(ALTERNATE A)**

- Reinforcement shall be in accordance with ACI 308. All reinforcement shall be in accordance with ACI 308. All reinforcement shall be in accordance with ACI 308.
- Reinforcement shall be in accordance with ACI 308. All reinforcement shall be in accordance with ACI 308. All reinforcement shall be in accordance with ACI 308.
- Reinforcement shall be in accordance with ACI 308. All reinforcement shall be in accordance with ACI 308. All reinforcement shall be in accordance with ACI 308.
- Reinforcement shall be in accordance with ACI 308. All reinforcement shall be in accordance with ACI 308. All reinforcement shall be in accordance with ACI 308.
- Reinforcement shall be in accordance with ACI 308. All reinforcement shall be in accordance with ACI 308. All reinforcement shall be in accordance with ACI 308.
- Reinforcement shall be in accordance with ACI 308. All reinforcement shall be in accordance with ACI 308. All reinforcement shall be in accordance with ACI 308.
- Reinforcement shall be in accordance with ACI 308. All reinforcement shall be in accordance with ACI 308. All reinforcement shall be in accordance with ACI 308.
- Reinforcement shall be in accordance with ACI 308. All reinforcement shall be in accordance with ACI 308. All reinforcement shall be in accordance with ACI 308.
- Reinforcement shall be in accordance with ACI 308. All reinforcement shall be in accordance with ACI 308. All reinforcement shall be in accordance with ACI 308.
- Reinforcement shall be in accordance with ACI 308. All reinforcement shall be in accordance with ACI 308. All reinforcement shall be in accordance with ACI 308.
- Reinforcement shall be in accordance with ACI 308. All reinforcement shall be in accordance with ACI 308. All reinforcement shall be in accordance with ACI 308.
- Reinforcement shall be in accordance with ACI 308. All reinforcement shall be in accordance with ACI 308. All reinforcement shall be in accordance with ACI 308.
- Reinforcement shall be in accordance with ACI 308. All reinforcement shall be in accordance with ACI 308. All reinforcement shall be in accordance with ACI 308.
- Reinforcement shall be in accordance with ACI 308. All reinforcement shall be in accordance with ACI 308. All reinforcement shall be in accordance with ACI 308.
- Reinforcement shall be in accordance with ACI 308. All reinforcement shall be in accordance with ACI 308. All reinforcement shall be in accordance with ACI 308.

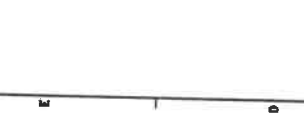

**ROUND STRUCTURE BOTTOMS (ALTERNATE A) & ROUND RISERS-
TABLE 1**

Type	Structure Outer Diameter (ft)	Class I Concrete		Class II Concrete		ASTM A305	
		Reinforcement (ft)	Reinforcement (ft)	Reinforcement (ft)	Reinforcement (ft)	(ft)	(ft)
P	3'-0"	4"	4"	4"	4"	4"	4"
R	3'-0"	4"	4"	4"	4"	4"	4"
S	3'-0"	4"	4"	4"	4"	4"	4"
T	3'-0"	4"	4"	4"	4"	4"	4"
U	3'-0"	4"	4"	4"	4"	4"	4"
V	3'-0"	4"	4"	4"	4"	4"	4"
W	3'-0"	4"	4"	4"	4"	4"	4"
X	3'-0"	4"	4"	4"	4"	4"	4"
Y	3'-0"	4"	4"	4"	4"	4"	4"
Z	3'-0"	4"	4"	4"	4"	4"	4"

SLAB DEPTH	SLAB THICKNESS	REINFORCING	REINFORCING
12"	12"	4#	4#
18"	18"	4#	4#
24"	24"	4#	4#
30"	30"	4#	4#
36"	36"	4#	4#
42"	42"	4#	4#
48"	48"	4#	4#
54"	54"	4#	4#
60"	60"	4#	4#
66"	66"	4#	4#
72"	72"	4#	4#
78"	78"	4#	4#
84"	84"	4#	4#
90"	90"	4#	4#
96"	96"	4#	4#
102"	102"	4#	4#
108"	108"	4#	4#
114"	114"	4#	4#
120"	120"	4#	4#

SLAB DEPTH	SLAB THICKNESS	REINFORCING	REINFORCING
12"	12"	4#	4#
18"	18"	4#	4#
24"	24"	4#	4#
30"	30"	4#	4#
36"	36"	4#	4#
42"	42"	4#	4#
48"	48"	4#	4#
54"	54"	4#	4#
60"	60"	4#	4#
66"	66"	4#	4#
72"	72"	4#	4#
78"	78"	4#	4#
84"	84"	4#	4#
90"	90"	4#	4#
96"	96"	4#	4#
102"	102"	4#	4#
108"	108"	4#	4#
114"	114"	4#	4#
120"	120"	4#	4#

- TABLE 3 NOTES:**
- For 3'-0" Precast Square Structure Bottoms, 30" Pipes with 4x4" Invert Dimensions when 30" pipe openings are less than 3'-0".
 - For 4'-0" Precast Square Structure Bottoms, 36" Pipes with 4x4" Invert Dimensions when 36" pipe openings are less than 3'-0".
 - For 4'-0" Precast Square Structure Bottoms, 48" Pipes with 4x4" Invert Dimensions when 48" pipe openings are less than 3'-0".
 - For 4'-0" Precast Square Structure Bottoms, 60" Pipes with 4x4" Invert Dimensions when 60" pipe openings are less than 3'-0".
 - For 4'-0" Precast Square Structure Bottoms, 72" Pipes with 4x4" Invert Dimensions when 72" pipe openings are less than 3'-0".
 - For 4'-0" Precast Square Structure Bottoms, 84" Pipes with 4x4" Invert Dimensions when 84" pipe openings are less than 3'-0".
 - For 4'-0" Precast Square Structure Bottoms, 96" Pipes with 4x4" Invert Dimensions when 96" pipe openings are less than 3'-0".
 - For 4'-0" Precast Square Structure Bottoms, 108" Pipes with 4x4" Invert Dimensions when 108" pipe openings are less than 3'-0".
 - For 4'-0" Precast Square Structure Bottoms, 120" Pipes with 4x4" Invert Dimensions when 120" pipe openings are less than 3'-0".

WOOD PRODUCTS GROUP
 1000 WEST 10TH AVENUE
 DENVER, CO 80202
 TEL: 303-733-3300
 FAX: 303-733-3301
 WWW.WOOD-PRODUCTS.COM

**SWEETWATER
 PRESERVE
 LID PARKING AREA
 PROJECT**



DATE	DESCRIPTION
12/15/11	ISSUED FOR PERMIT
12/15/11	ISSUED FOR PERMIT
12/15/11	ISSUED FOR PERMIT

PROJECT NO.	11-0000
DATE	12/15/11
SCALE	AS SHOWN
DESIGNED BY	WPG
CHECKED BY	WPG
APPROVED BY	WPG

TYPICAL DETAILS VI

C406

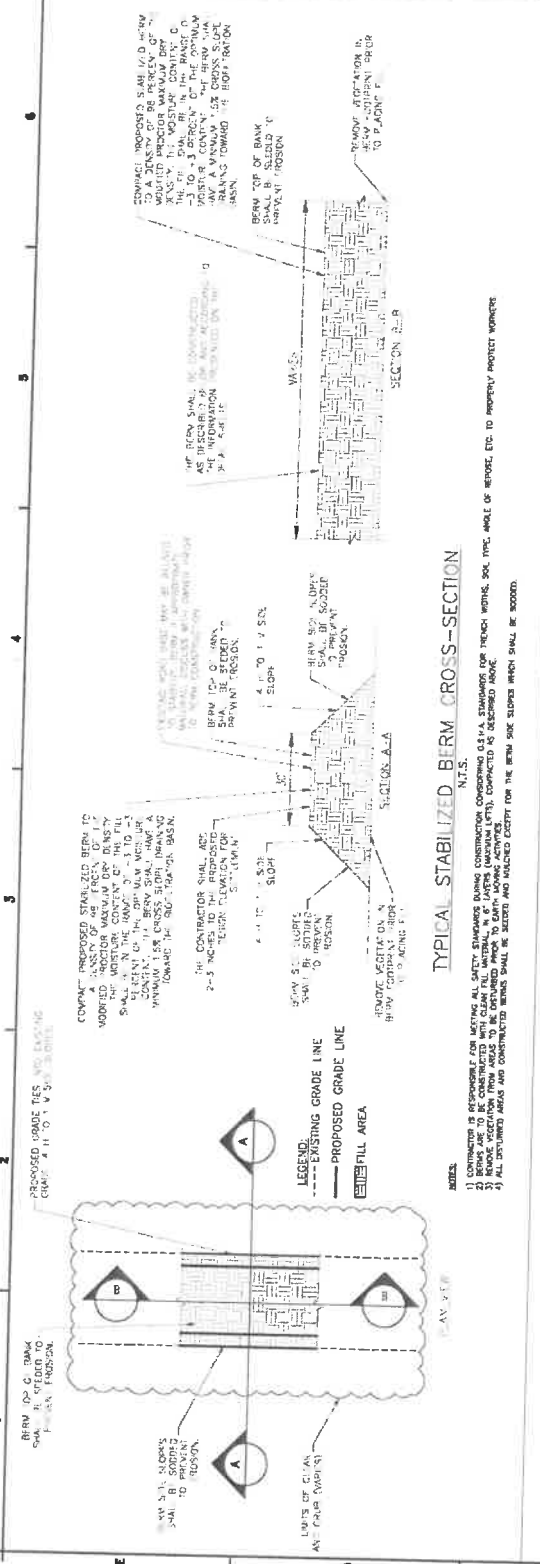

TYPICAL STABILIZED BERM CROSS-SECTION
 N.T.S.



DIMENSIONS

Point	D	X	A	B	C	E	F	G	M	N
1.4 Slope	15'	2.5'	3.05'	3.05'	3.58'	3.0'	7.0'	1.23'	4.33'	1.04'

1) CONTRACTOR IS RESPONSIBLE FOR VERIFYING ALL SAFETY DIMENSIONS BEARING CONSTRUCTION INFORMATION SHOWN ON THIS PLAN. DIMENSIONS FOR TRENCH WIDTHS, SLOPE, TYPE, ANGLE OF REPOSE, ETC. TO PROPERLY PROTECT WORKERS.
 2) BERM SHALL BE CONSTRUCTED WITH CLEAN FILL MATERIAL, 1/2" OF LAYERS IMPROVED LOCALY COMPACTED AS DESCRIBED ABOVE.
 3) ALL EXISTING AND CONSTRUCTION MARKS SHALL BE SETBACK AND MAINTAINED EXCEPT FOR THE BERM SIDE SLOPE WHICH SHALL BE SMOOTHED.

TYPICAL MITERED END SECTION
 N.T.S.



CONCRETE SLAB, 3" THICK, REINFORCED WITH #4 BAR-W/45% MIN. LIME

GENERAL NOTES

- Class NS concrete cast-in-place reinforced slabs are required for all sizes of cross drain pipes. Construct slabs 3" thick.
- Select lengths of pipe that avoid excessive connections in the assembly of the mitered end section.

wood.

WOOD PRODUCTS GROUP, INC.
 100 W. WASHINGTON AVENUE
 CHICAGO, IL 60601
 (773) 398-2000
 WWW.WOODPRODUCTSGROUP.COM

SWEETWATER PRESERVE LID PARKING AREA PROJECT



TYPICAL DETAILS VII

C407

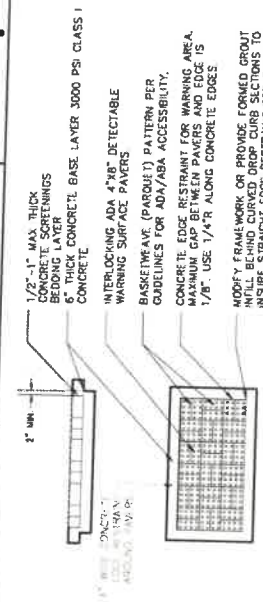

4"x8" ADA DETECTABLE WARNING PAVERS
 N.T.S.

1/2" THICK CONCRETE SCREEDINGS BEDDING LAYER
 6" THICK CONCRETE BASE LAYER 3000 PSI CLASS 1
 INTERLOCKING ADA 4"x8" DETECTABLE WARNING SURFACE PAVERS
 BASKETWEAVE (PARQUET) PATTERN PER GUIDELINES FOR ADA/ABA ACCESSIBILITY.
 CONCRETE EDGE RESTRAINT FOR WARNING AREA. MAXIMUM GAP BETWEEN PAVERS AND EDGE IS 1/8". USE 1/4" R ALONG CONCRETE EDGES.
 MOODY FRAMWORK OR PROVIDE FORMED GROUT IN TYPICAL JOINTS TO BE SET IN PLACE TO INSURE STRAIGHT EDGE RESTRAINT FOR PAVERS.

FOR TO PROVIDE LIGHT/DARK CONTRAST OF 70% OF ADJACENT SIDEWALK
 DETECTABLE WARNING SURFACE PAVERS SHALL CONSIST OF INTERLOCKING 4"x8" ADA DETECTABLE WARNING SURFACE PAVERS HAVING A MINIMUM 7/8" R RAISED TRUNCATED DOMES WITH A BASE DIAMETER OF 0.8 INCH (21 MM) MINIMUM AND 1.4 INCHES (36 MM) MAXIMUM. TOP DIAMETER OF 50 PERCENT THE BASE DIAMETER MINIMUM TO 65 PERCENT OF THE BASE DIAMETER MAXIMUM. RADIUS OF 0.2 INCHES (5.1 MM) MINIMUM. AND A CENTER-TO-CENTER SPACING OF 1.8 INCHES (45.7 MM) MINIMUM AND 2 INCHES (50.8 MM) MAXIMUM. THE SQUARE GRID CONCRETE PAVERS ARE TO MEET ASTM C902 CLASS SX, TYPE 1 AND BRICK PAVERS ARE TO BE THINWALL AMERICA'S RED HOLLANDSTONE CONCRETE PAVERS OF APPROVED EQUIVALENT.
 ALL JOINTS SHALL BE SET IN PLACE AND PROTECTED WITH THE SAME STRENGTH OF CONCRETE AS THE UNITS THAT ARE STRUCTURALLY DAMAGED DURING THE CONSTRUCTION PROCESS. UNITS SHALL BE REMOVED AND REPLACED. THE PAVERS ARE TO BE LAID IN A TWO BY TWO BASKETWEAVE PATTERN. JOINTS SHALL BE FINISH GRADE OF THE SURFACE AND HAVE GAPS BETWEEN 1/8" AND 1/8". CUT PAVERS (MASONRY SAW ON-T) SHALL BE NO SMALLER THAN ONE-THIRD OF A WHOLE PAVEMENT UNIT.

THICKENED EDGE

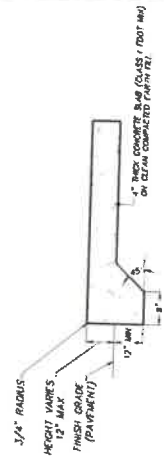

STANDARD EDGE

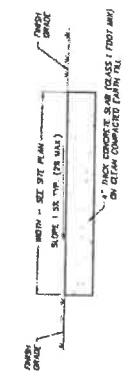

NOTES:
 1. CONSTRUCT CONCRETE TO SPECIFY PER FOOT MEET NO. 310 (02/001)
 2. CONSTRUCT 4" THICK CONCRETE WITH SUBSLAB TO FINISH GRADE PAVERS AND MORE CALLED FOR IN THE PLAN
 3. ALL CORNERS AND PARALLEL JOINTS SHALL BE CONSTRUCTED PER FOOT MEET NO. 310 (02/001)
 4. PAVERS WITH INTERLOCKING JOINTS SHALL BE CONSTRUCTED ACCORDING TO ALL TRADE OBJECTS AND PER PLAN AT CONSTRUCTION JOINTS

CONCRETE SIDEWALK
 N.T.S.

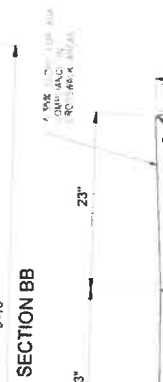
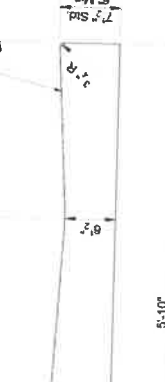
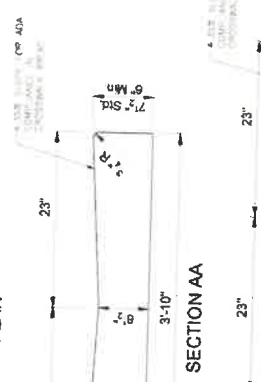
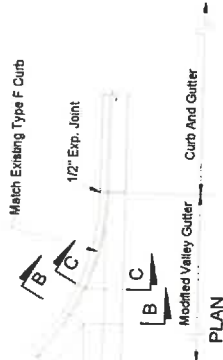

MODIFIED VALLEY GUTTER

CONCRETE CURB AND GUTTER

NOTES:
 1. Construct curb and gutter according to FDOT Standard Section 300

MODIFIED VALLEY GUTTER AND STANDARD TYPE F CURB
 N.T.S.