



4/8/02 #002579 AT Meeting

ALACHUA COUNTY URBAN AND EXTRATERRITORIAL RESERVES

Legend

-  Urban Reserve Area
-  Extra-territorial Reserves

-  Interstate
-  US Route
-  County or State Road

 Open Water

 Municipalities

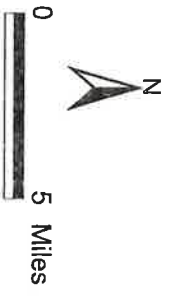
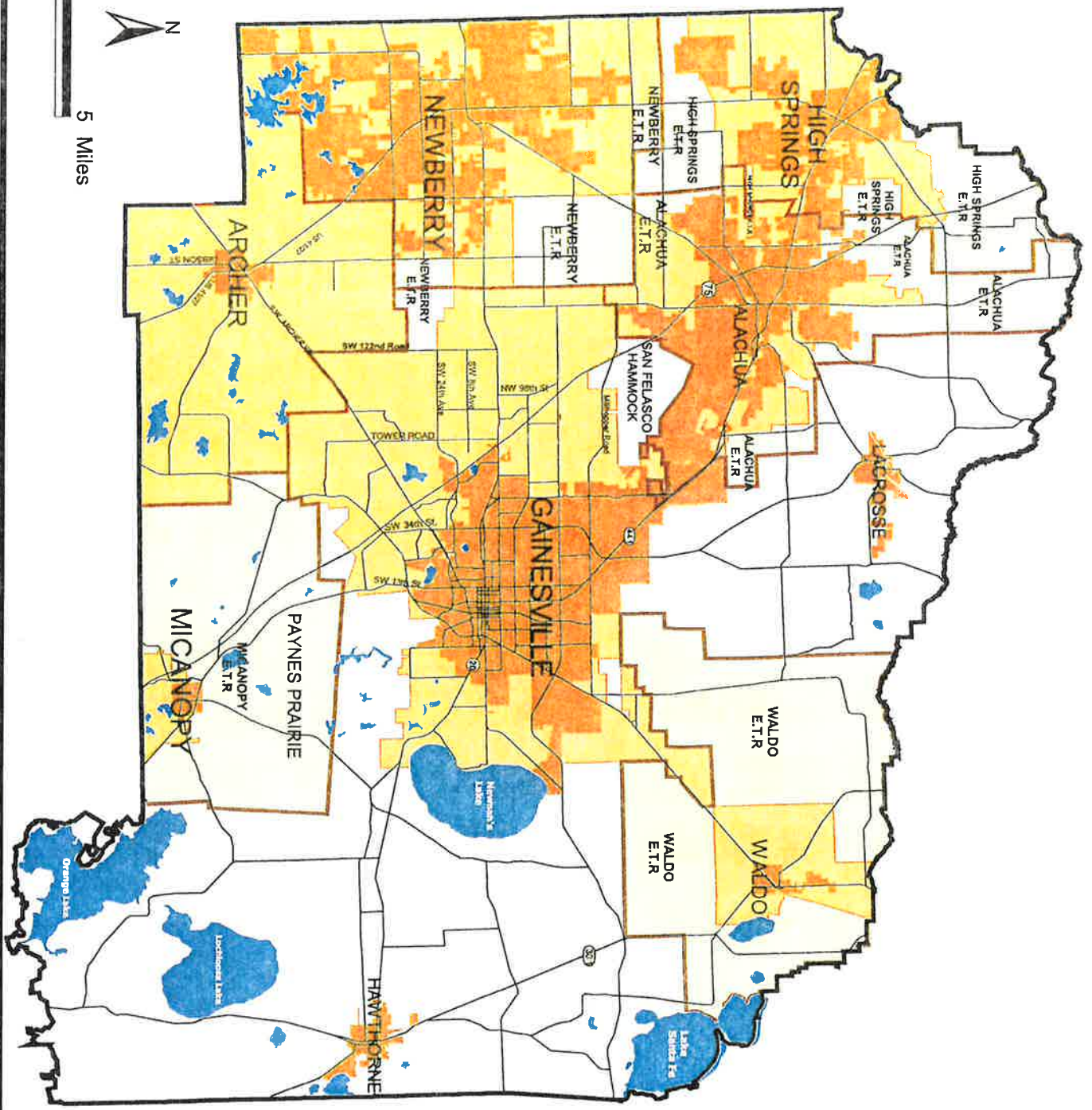

METADATA:
http://growth-management.alachua.fl.us/gis/metadata/extra_terr_reserves.htm
http://growth-management.alachua.fl.us/gis/metadata/urban_reserves.htm

NOTES:
 This map was created with the best available sources and it is intended for reference purposes only.
 Date of Production: 2-20-2002

PREPARED AT:
 Alachua County
 Department of Growth Management
 10 SW 2nd Avenue
 Gainesville, FL 32601
 (352) 374-5249
<http://growth-management.alachua.fl.us/index.php>

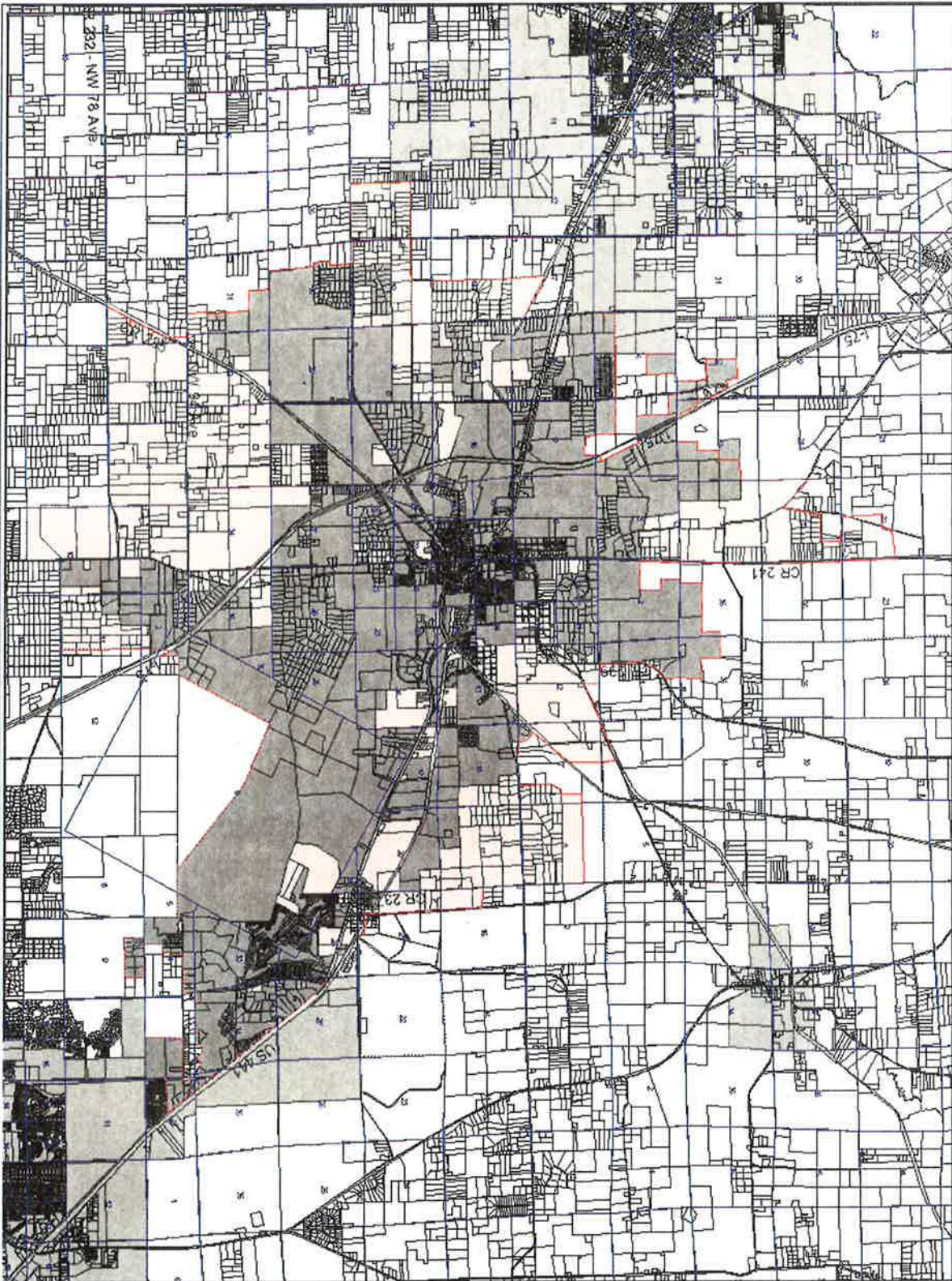

Legend

PLSS with
Section number

Municipalities

Unincorporated Parishes

Lakes

Alachua
UR Border

Unincorporated Land
inside U.R.

Notes:
Municipality boundary and names provided by the Alachua County Property Appraiser's Office. Municipalities are shown in white. Unincorporated parishes are shown in grey. The Urban Reserve is shown in light blue. The map was prepared by the City of Alachua, Planning and Development Department, January 11, 2008. The map is for informational purposes only and does not constitute a contract. The City of Alachua is not responsible for any errors or omissions on this map. The City of Alachua is not responsible for any damages or losses resulting from the use of this map. The City of Alachua is not responsible for any claims or lawsuits resulting from the use of this map. The City of Alachua is not responsible for any claims or lawsuits resulting from the use of this map.

**City of Alachua
Urban Reserve**



Prepared by:
Alachua County Office of Planning and Development
1000 W. Broadway, 1st Floor
Alachua, FL 32009
(352) 763-5200



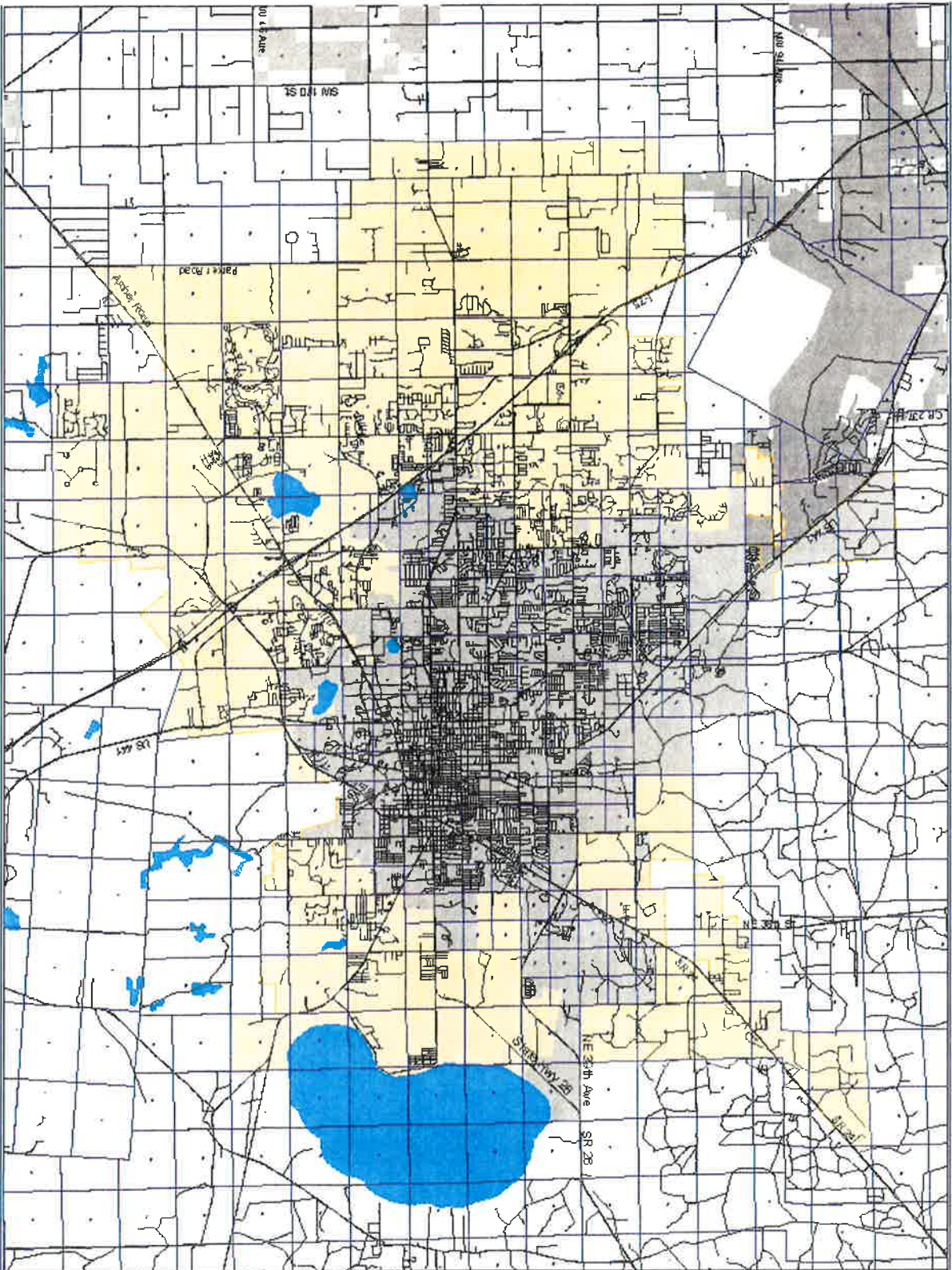

Legend

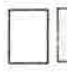
-  PLS with Section number
-  Municipalities
-  Unincorporated Parcels



Notes:
 1. Unincorporated parcels are formed by parcels not within the jurisdiction of any municipality and are subject to state jurisdiction of land use. Municipalities are defined by the Florida Statutes (Section 188.001). The U.R. includes the portion of the county which has the official address of the city. The U.R. includes the portion of the county which is not within the jurisdiction of any municipality and is subject to state jurisdiction of land use.

**City of Gainesville
 Urban Reserve**





Prepared by:
 Jackson County Office of Planning and Development
 600 W. 2nd Avenue, Gainesville, FL 32601
 352.339.4200

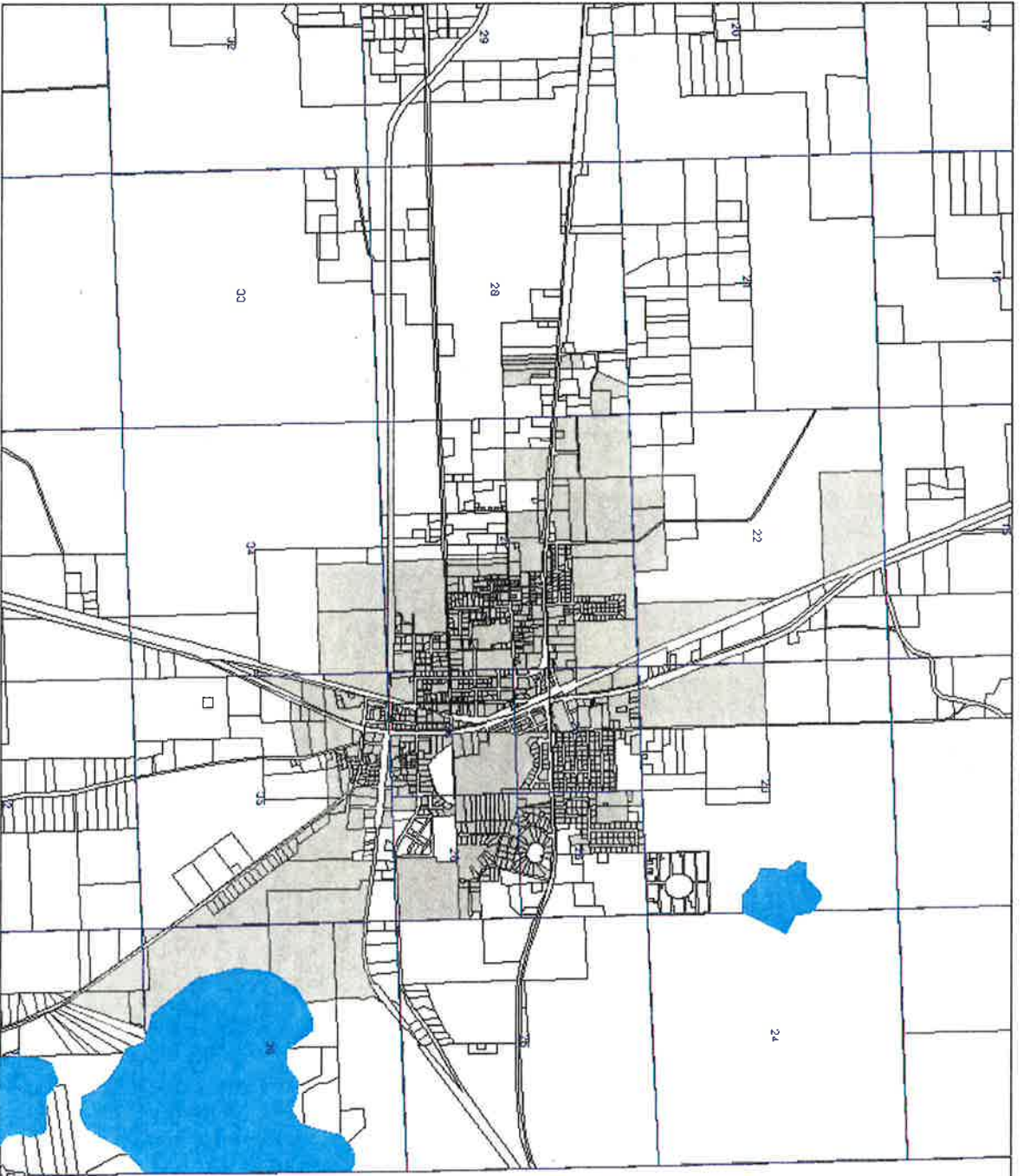



Legend

-  PLS S with Section number
-  Municipalities
-  Unincorporated Parcels



Lakes

Note:
Municipal boundary lines formed by parcels located within a section are not shown on this map. The location of the boundary lines is determined by the location of the parcels. The location of the parcels is shown by the parcel numbers. The location of the parcels is shown by the parcel numbers. The location of the parcels is shown by the parcel numbers.

**City of Hawthorne
Municipal Boundary**



Prepared by:
Ardra County Office of Planning and Development
6300 2nd Street, Alameda, MI 48001
(517) 734-2222



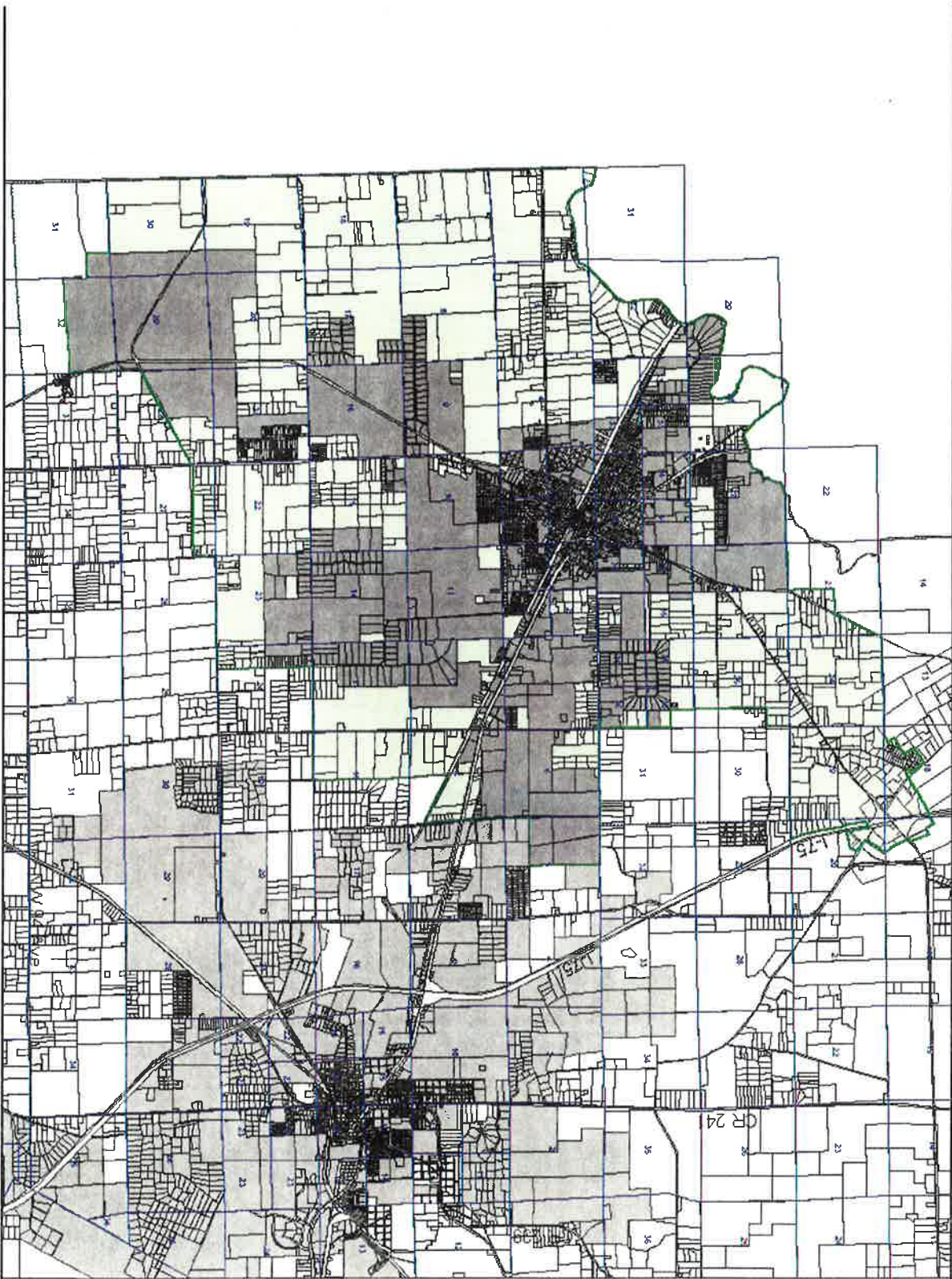

Legend

PLSS with
Section number

Municipalities

Unincorporated Parcels



Lake es

Unincorporated Land
inside UR

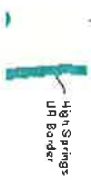

High Springs
UR Border

NOTES:
 Landfall by voluntary deed owned by private individuals within the Urban Reserve is not shown. The Urban Reserve is a public trust and is not subject to the same rules of private property. The Urban Reserve is a public trust and is not subject to the same rules of private property. The Urban Reserve is a public trust and is not subject to the same rules of private property.

City of High Springs Urban Reserve



Prepared by:
 Alford County Office of Planning and Development
 6 SW 2nd Avenue, Alfordville, GA 31708
 (706) 374-5280



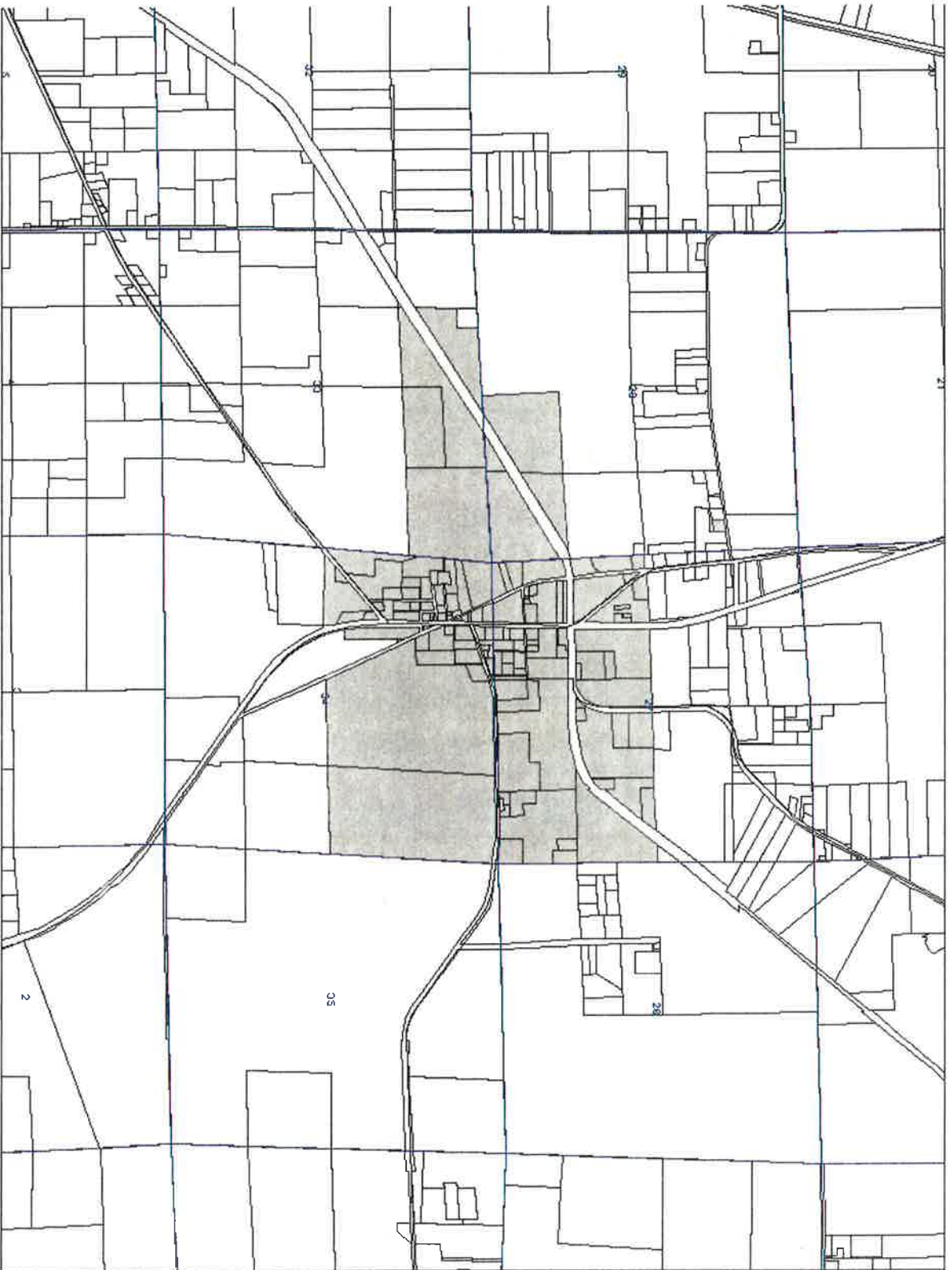

Legend

 PLUS with Section number

 Municipalities

 Unincorporated Parcels



Lakes

Notes:
 Vertically hatched parcels and parcels in purple according to the color key, are parcels that are not under Lacrosse jurisdiction. The purple parcels are the parcels that are currently under Lacrosse jurisdiction but are not yet assigned to the Lacrosse jurisdiction. The blue hatched parcels are the parcels that are currently under Lacrosse jurisdiction but are not yet assigned to the Lacrosse jurisdiction. The blue hatched parcels are the parcels that are currently under Lacrosse jurisdiction but are not yet assigned to the Lacrosse jurisdiction.

**City of Lacrosse
 Municipal Boundaries**



Prepared by:
 Adams County Office of Planning and Development
 650 2nd Street SW, Walla Walla, WA 99060
 509.865.4329



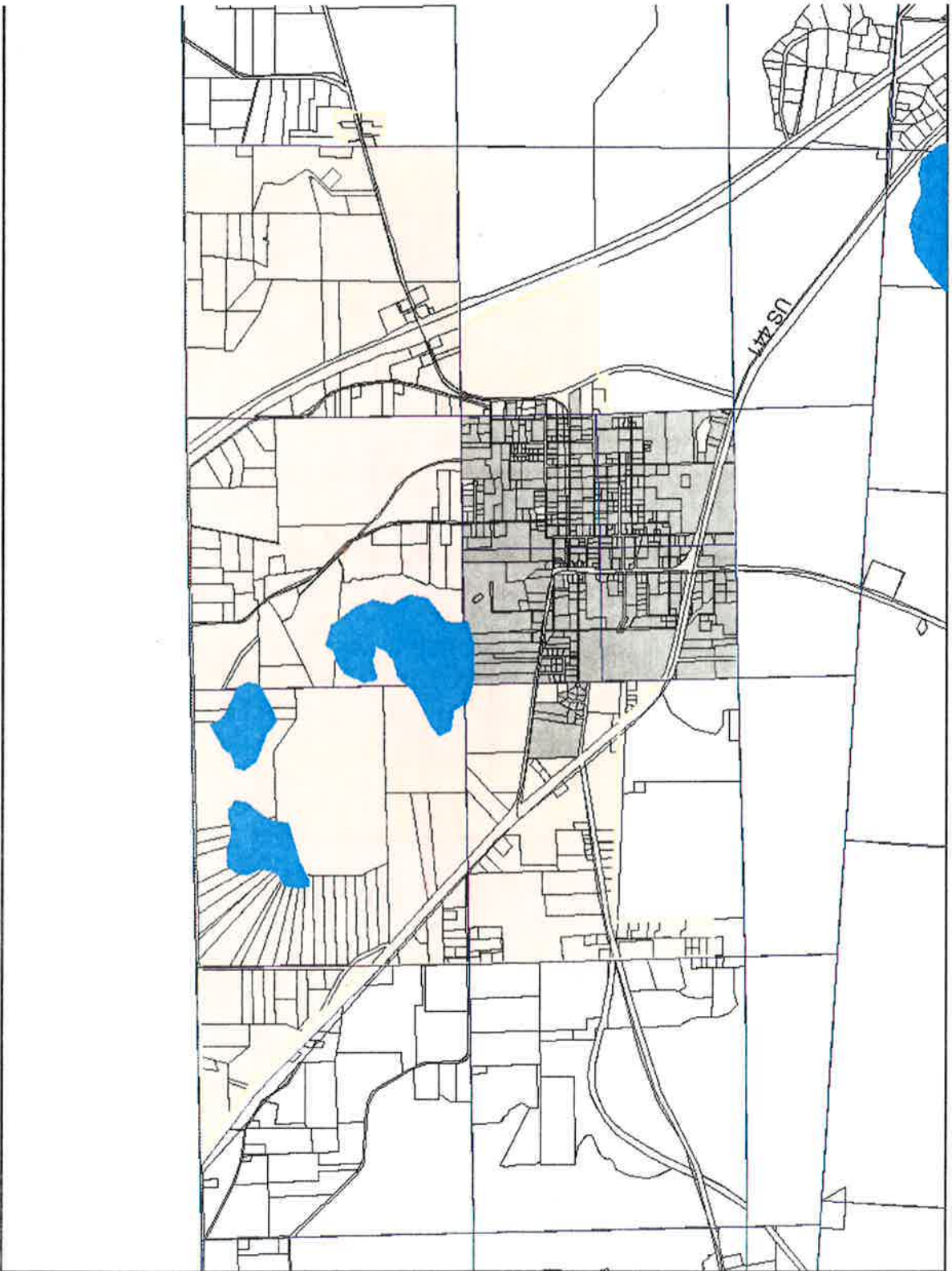

Legend

- PLSS with Section number
- Municipalities
- Unincorporated Parcels
- Lakes

unincorporated parcels are
 Micranopy
 UR border

Notes:
 1. This map shows the City of Micranopy's Urban Reserve. The Urban Reserve is a designated area within the City of Micranopy that is reserved for future development. The Urban Reserve is located in the central part of the City of Micranopy, and is bounded by the US 241 highway to the north and the City of Micranopy boundary to the south. The Urban Reserve is shown in light yellow on this map.

**City of Micranopy
 Urban Reserve**



Prepared by:
 Adaola County Office of Planning and Development
 600 West 1st Street, Adaola, Oklahoma 73001
 405.324.2222

Waldo Urban Reserve Area

Legend

-  Lakes
-  Municipalities
-  Urban Reserve Area
-  Waldo

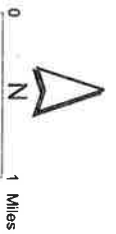
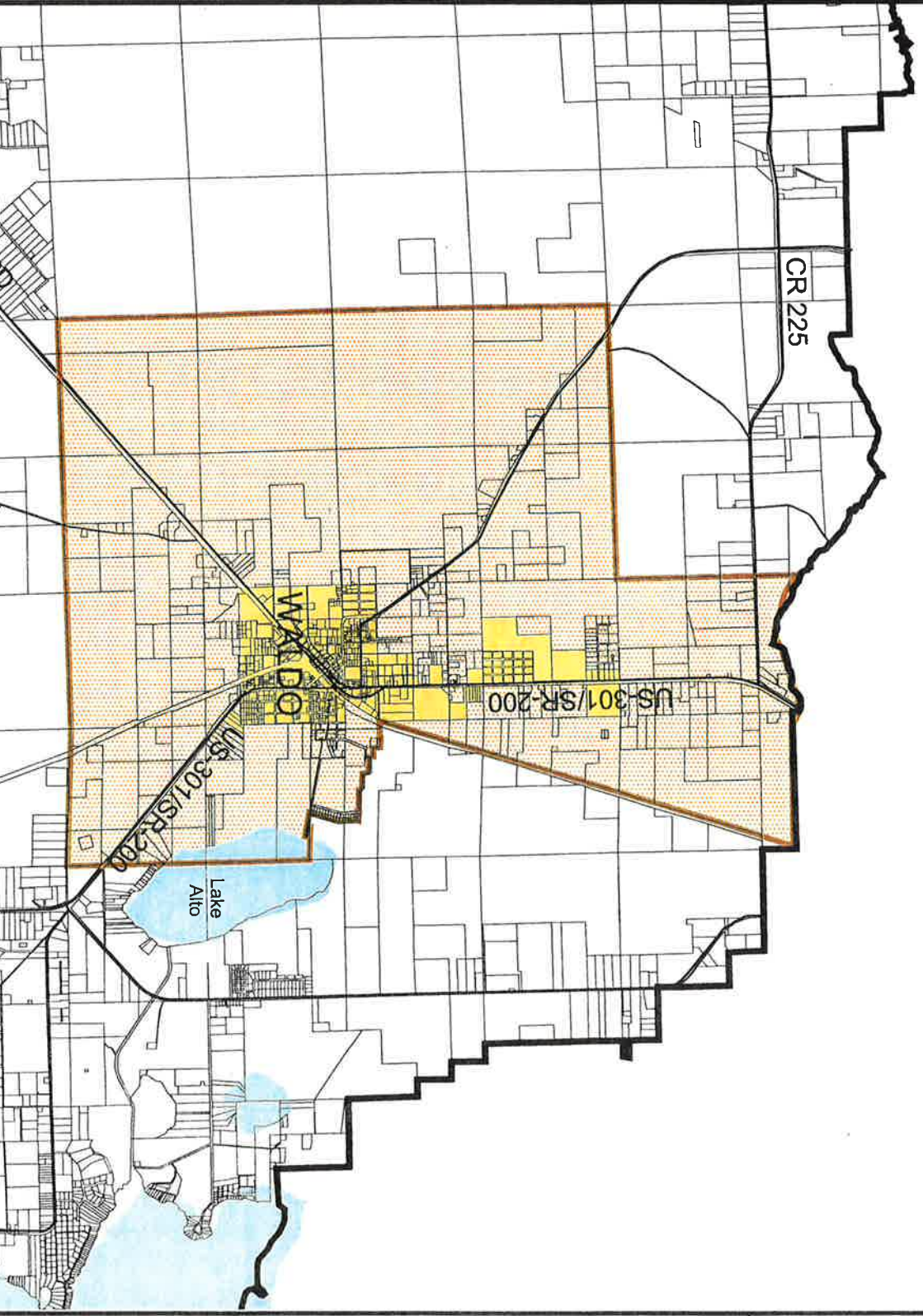

NOTES: This map was created with the best available sources and it is intended for reference purposes only.
Date of Production: 04-08-2002

PREPARED AT:
Alachua County
Department of Growth Management
10 SW 2nd Avenue
Gainesville, FL 32601
(352) 374-5249
<http://www.growth-management.alachua.fl.gov/>