

LEGISLATIVE

#121080A

1 **WHEREAS**, the Public Hearings were held pursuant to the published notice
2 described at which hearings the parties in interest and all others had an opportunity to be
3 and were, in fact, heard.

4 **NOW, THEREFORE, BE IT ORDAINED BY THE CITY COMMISSION**
5 **OF THE CITY OF GAINESVILLE, FLORIDA:**

6 **Section 1.** The real properties or portions of real properties that are owned in fee
7 simple by the City of Gainesville and that were acquired or used for conservation,
8 recreation, or cultural purposes, listed in Exhibit "A" attached hereto, are added to the
9 City of Gainesville Registry of Protected Public Places.

10 See legal description of Phase II-A Registry Listings and a description of
11 the values that support inclusion of each site as set forth in Exhibit "A"
12 attached hereto and made a part hereof as if set forth in full. The location
13 of the properties is shown on Exhibit "B" for visual reference. In the
14 event of conflict or inconsistency, Exhibit "A" shall prevail over Exhibit
15 "B".
16

17 **Section 2.** The record presented to the city commission on March 21, 2013,
18 (Legistar No. 100523, City of Gainesville Registry of Protected Places Listing), detailed
19 the values for which the property was placed on the registry and that record is
20 incorporated herein by reference.

21 **Section 3.** The City Commission finds that the City's present or future use of the
22 properties described in "Exhibit A" may be for any conservation, recreation, or cultural
23 public purposes without resulting in any loss of any stated value or values.

24 **Section 4.** That the original of this ordinance shall be recorded in the Public
25 Records of Alachua County, Florida.

CODE: Words ~~stricken~~ are deletions; words underlined are additions.

1
2
3
4
5
6
7
8
9

EXHIBIT A
to Ordinance No. 121080

NOTICE OF REGISTRATION

City of Gainesville Registry of Protected Public Places

Phase II-A Property Listing

10 The purpose of this document is to provide registration notification to the citizens of
11 Gainesville. City of Gainesville Ordinance #080567, which pertains to the protection of
12 City-owned lands acquired or used for conservation, recreation, or cultural purposes,
13 states that a registry will be created for the purpose of identifying fee-simple properties
14 owned by the City of Gainesville that are deemed to be worthy of the highest level of
15 protection. When listed on the registry, said properties may not be sold or converted to a
16 use that will result in a loss of value for which the property was placed on the registry,
17 except by a majority vote of the electors in a city-wide election. Staff evaluated city-
18 owned properties and deemed the following conservation and/or recreation lands to be
19 worthy of this level of protection. Below are the properties to be registered by adoption
20 of this ordinance.

21
22 Name: **Hogtown Creek Headwaters**
23 Location: 1500 NW 45th Ave
24 Acreage: 70 acres
25 Tax Parcel Number(s): 07883-010-004

26
27 General location of property: Located in northwest Gainesville in the upper Hogtown
28 Creek basin.

29
30 Statement of value for placement on Registry: This park is proposed for registry listing
31 because it was partially purchased with state grant funding that limits the use of the
32 property to conservation, outdoor recreation, and other related activities, and a charitable
33 donation from the Home Depot Corporation, and has exemplary examples of upland
34 mixed forest and various wetlands that make up the headwaters of Hogtown Creek.

35
36 Legal Description: PARCELS 4 AND 5 OF A MINOR SUBDIVISION AT THE
37 SW CORNER OF HIGHWAY NO. 441 AND NW 53RD AVENUE IN
38 SECTION 19, TOWNSHIP 9 SOUTH, RANGE 20 EAST, ALACHUA COUNTY,
39 FLORIDA RECORDED IN MINOR SUBDIVISION BOOK 2, PAGES 84-86,
40 BEING MORE PARTICULARLY DESCRIBED AS FOLLOWS:

41
42 PARCEL 4
43

1 COMMENCE AT THE NORTHWEST CORNER OF THE NORTHWEST 1/4 OF
2 SECTION 19, TOWNSHIP 9 SOUTH, RANGE 20 EAST, ALACHUA COUNTY,
3 FLORIDA AND RUN THENCE NORTH $89^{\circ}14'27''$ EAST ALONG THE NORTH
4 LINE OF SAID SECTION 19, A DISTANCE OF 2664.71 FEET TO AN
5 INTERSECTION WITH THE NORTHERLY PROJECTION OF THE EAST
6 RIGHT-OF-WAY LINE OF NW 19TH STREET; THENCE RUN SOUTH
7 $00^{\circ}42'53''$ EAST, ALONG SAID NORTHERLY PROJECTION, 50.00 FEET TO
8 THE SOUTH RIGHT-OF-WAY LINE OF NW 53RD AVENUE; THENCE RUN
9 NORTH $89^{\circ}14'27''$ EAST ALONG SAID SOUTH RIGHT OF-WAY LINE, A
10 DISTANCE OF 660.17 FEET; THENCE RUN SOUTH $00^{\circ}42'33''$ EAST, 655.50
11 FEET; THENCE SOUTH $46^{\circ}32'08''$ EAST, 658.39 FEET TO THE POINT OF
12 CURVATURE OF A CURVE CONCAVE NORTHEASTERLY, HAVING A
13 RADIUS OF 512.72 FEET AND A CENTRAL ANGLE OF $07^{\circ}47'06''$; THENCE
14 RUN SOUTHEASTERLY ALONG THE ARC OF SAID CURVE AN ARC
15 DISTANCE OF 69.66 FEET TO THE POINT OF BEGINNING; THENCE RUN
16 NORTH $06^{\circ}31'22''$ EAST, 69.55 FEET; THENCE NORTH $38^{\circ}27'24''$ WEST,
17 51.57 FEET; THENCE NORTH $10^{\circ}22'47''$ EAST, 29.85 FEET; THENCE NORTH
18 $00^{\circ}02'42''$ WEST, 52.18 FEET; THENCE NORTH $77^{\circ}01'02''$ EAST, 50.14
19 FEET; THENCE NORTH $32^{\circ}06'10''$ EAST, 135.13 FEET; THENCE NORTH
20 $47^{\circ}07'05''$ EAST, 55.68 FEET; NORTH $29^{\circ}57'57''$ EAST, 77.00 FEET;
21 THENCE NORTH $23^{\circ}30'55''$ EAST, 17.27 FEET; THENCE NORTH $16^{\circ}03'26''$
22 EAST, 4.00 FEET; THENCE NORTH $74^{\circ}42'11''$ EAST, 58.49 FEET; THENCE
23 NORTH $65^{\circ}23'58''$ EAST, 73.31 FEET; THENCE NORTH $82^{\circ}30'34''$ EAST,
24 94.85 FEET; THENCE NORTH $60^{\circ}06'29''$ EAST, 59.75 FEET; THENCE
25 NORTH $43^{\circ}54'18''$ EAST, 31.28 FEET; THENCE NORTH $65^{\circ}16'51''$ EAST,
26 48.46 FEET TO THE SOUTHWESTERLY RIGHT-OF-WAY LINE OF U.S.
27 HIGHWAY NO. 441(STATE ROAD NO. 25 & NW 13TH STREET); THENCE
28 RUN SOUTH $46^{\circ}38'42''$ EAST ALONG SAID SOUTHWESTERLY RIGHT-OF-
29 WAY LINE, 75.89 FEET TO A POINT OF CURVATURE OF A CURVE
30 CONCAVE SOUTHWESTERLY, HAVING A RADIUS OF 5679.58 FEET AND
31 A CENTRAL ANGLE OF $08^{\circ}26'00''$ AND BEING SUBTENDED BY A CHORD
32 BEARING AND DISTANCE OF SOUTH $42^{\circ}36'21''$ EAST, 835.22 FEET,
33 RESPECTIVELY; THENCE RUN SOUTHEASTERLY ALONG THE ARC OF SAID
34 CURVE, AN ARC DISTANCE OF 835.98 FEET; THENCE RUN SOUTH
35 $89^{\circ}11'43''$ WEST, 373.70 FEET; THENCE NORTH $00^{\circ}42'01''$ WEST, 10.33
36 FEET; THENCE SOUTH $89^{\circ}13'02''$ WEST, 464.51 FEET TO THE POINT OF
37 CURVATURE OF A CURVE CONCAVE NORTHEASTERLY, HAVING A
38 RADIUS OF 512.72 FEET AND A CENTRAL ANGLE OF $36^{\circ}27'44''$, THENCE
39 RUN NORTHWESTERLY ALONG THE ARC OF SAID CURVE, AN ARC
40 DISTANCE OF 326.29 FEET TO THE POINT OF BEGINNING.
41 CONTAINING 11.10 ACRES, MORE OR LESS.

1
2 LESS AND EXCEPT

3 A PARCEL OF LAND LYING IN PARCEL 4 OF A MINOR SUBDIVISION AT
4 THE SW CORNER OF HIGHWAY NO. 441 AND NW 53RD AVENUE IN
5 SECTION 19, TOWNSHIP 9 SOUTH, RANGE 20 EAST, ALACHUA COUNTY,
6 FLORIDA RECORDED IN MINOR SUBDIVISION BOOK 2, PAGES 84-86,
7 BEING MORE PARTICULARLY DESCRIBED AS FOLLOWS:

8
9 COMMENCE AT THE NORTHWEST CORNER OF THE NORTHWEST 1/4 OF
10 SECTION 19, TOWNSHIP 9 SOUTH, RANGE 20 EAST, ALACHUA COUNTY,
11 FLORIDA AND RUN THENCE NORTH $89^{\circ}14'27''$ EAST ALONG THE
12 NORTH LINE OF SAID SECTION 19, A DISTANCE OF 2664.71 FEET TO
13 AN INTERSECTION WITH THE NORTHERLY PROJECTION OF THE EAST
14 RIGHT-OF-WAY LINE OF NW 19TH STREET; THENCE RUN SOUTH
15 $00^{\circ}42'53''$ EAST, ALONG SAID NORTHERLY PROJECTION, 50.00 FEET
16 TO THE SOUTH RIGHT-OF-WAY LINE OF NW 53RD AVENUE; THENCE
17 RUN NORTH $89^{\circ}14'27''$ EAST ALONG SAID SOUTH RIGHT-OF-WAY
18 LINE, A DISTANCE OF 660.17 FEET; THENCE RUN SOUTH $00^{\circ}42'33''$
19 EAST, 655.50 FEET; THENCE SOUTH $46^{\circ}32'08''$ EAST, 658.39 FEET TO
20 THE POINT OF CURVATURE OF A CURVE CONCAVE NORTHEASTERLY,
21 HAVING A RADIUS OF 512.72 FEET AND A CENTRAL ANGLE OF
22 $44^{\circ}14'50''$; THENCE RUN SOUTHEASTERLY ALONG THE ARC OF SAID
23 CURVE AN ARC DISTANCE OF 395.95 FEET; THENCE RUN NORTH
24 $89^{\circ}13'02''$ EAST, 464.51 FEET TO THE POINT OF BEGINNING; THENCE
25 RUN NORTH $00^{\circ}42'01''$ WEST, 426.55 FEET TO THE SOUTHWESTERLY
26 RIGHT-OF-WAY LINE OF U.S. HIGHWAY NO. 441 (STATE ROAD NO. 25
27 & NW 13TH STREET) AND A POINT ON A CURVE CONCAVE
28 SOUTHWESTERLY, HAVING A RADIUS OF 5679.58 FEET, A CENTRAL
29 ANGLE OF $05^{\circ}47'49''$ AND BEING SUBTENDED BY A CHORD BEARING
30 AND DISTANCE OF SOUTH $41^{\circ}17'15''$ EAST, 574.39 FEET,
31 RESPECTIVELY; THENCE RUN SOUTHEASTERLY ALONG SAID
32 SOUTHWESTERLY RIGHT-OF-WAY LINE AND THE ARC OF SAID CURVE, AN
33 ARC DISTANCE OF 574.63 FEET; THENCE RUN SOUTH $89^{\circ}11'43''$ WEST, A
34 DISTANCE OF 373.70 FEET; THENCE RUN NORTH $00^{\circ}42'01''$ WEST, 10.33
35 FEET TO THE POINT OF BEGINNING. CONTAINING 1.94 ACRES MORE
36 OR LESS.

37
38 PARCEL 5

39 COMMENCE AT THE NORTHWEST CORNER OF THE NORTHWEST 1/4 OF
40 SECTION 19, TOWNSHIP 9 SOUTH, RANGE 20 EAST, ALACHUA COUNTY,
41 FLORIDA AND RUN THENCE NORTH $89^{\circ}14'27''$ EAST ALONG THE NORTH
42 LINE OF SAID SECTION 19, A DISTANCE OF 2664.71 FEET TO AN
43 INTERSECTION WITH THE NORTHERLY PROJECTION OF THE EAST RIGHT-
44 OF-WAY LINE OF NW 19TH STREET; THENCE RUN SOUTH $00^{\circ}42'53''$ EAST,
45 ALONG SAID NORTHERLY PROJECTION, 50.00 FEET TO THE SOUTH RIGHT-
46 OF-WAY LINE OF NW 53RD AVENUE TO THE POINT OF BEGINNING;
47 THENCE RUN NORTH $89^{\circ}14'27''$ EAST ALONG SAID SOUTH RIGHT-OF-WAY
48 LINE, A DISTANCE OF 660.17 FEET; THENCE RUN SOUTH $00^{\circ}42'33''$ EAST,
49 655.50 FEET; THENCE SOUTH $46^{\circ}32'08''$ EAST, 658.39 FEET TO THE POINT
50 OF CURVATURE OF A CURVE CONCAVE NORTHEASTERLY, HAVING A
51 RADIUS OF 512.72 FEET AND A CENTRAL ANGLE OF $44^{\circ}14'50''$; THENCE
52 RUN SOUTHEASTERLY ALONG THE ARC OF SAID CURVE AN ARC

1 DISTANCE OF 395.95 FEET; THENCE RUN NORTH 89°13'02' EAST, 464.90
2 FEET; THENCE SOUTH 00°42'01" EAST, 10.34 FEET; THENCE RUN SOUTH
3 00°42'02" EAST, 1297.21 FEET TO THE NORTH RIGHT-OF-WAY LINE OF
4 NW 45TH AVENUE; THENCE RUN SOUTH 89°13'09" WEST, 894.79 FEET;
5 THENCE NORTH 29°36'50" WEST, 342.45 FEET; THENCE SOUTH 89°13'09"
6 WEST, 259.54 FEET; THENCE NORTH 00°42'33" WEST, 125.00 FEET; THENCE
7 SOUTH 89°13'09" WEST, 150.68 FEET; THENCE SOUTH 28°56'32" WEST,
8 201.51 FEET; THENCE SOUTH 89°13'09" WEST, 80.00 FEET; THENCE
9 SOUTH 00°48'35" EAST, 140.00 FEET; THENCE SOUTH 29°24'49" EAST, 125.33
10 FEET TO SAID NORTH RIGHT-OF-WAY LINE; THENCE SOUTH 89°13'09"
11 WEST ALONG SAID NORTH RIGHT-OF-WAY LINE, 295.00 FEET; THENCE
12 NORTH 58°01'35" WEST, 83.17 FEET TO THE EAST RIGHT-OF-WAY LINE
13 OF NW 19TH STREET; THENCE NORTH 00°42'53" WEST ALONG SAID EAST
14 RIGHT-OF-WAY LINE, 566.07 FEET; THENCE NORTH 89°13'05" EAST,
15 634.99 FEET; THENCE NORTH 00°42'33" WEST, 686.08 FEET; THENCE SOUTH
16 89°13'02" WEST, 635.05 FEET TO SAID EAST RIGHT-OF-WAY LINE;
17 THENCE NORTH 00°42'53" WEST, 304.01 FEET; THENCE NORTH 89°11'45"
18 EAST, 305.04 FEET; THENCE NORTH 00°42'43" WEST, 354.12 FEET; THENCE
19 SOUTH 89°10'28" WEST, 305.06 FEET; THENCE NORTH 00°42'53" WEST,
20 612.94 FEET TO THE POINT OF BEGINNING. CONTAINING 64.74 ACRES,
21 MORE OR LESS.
22

23 LESS AND EXCEPT

24 A PORTION OF PARCEL 5 OF A MINOR SUBDIVISION AT THE SW CORNER
25 OF HIGHWAY NO. 441 AND NW 53RD AVENUE IN SECTION 19,
26 TOWNSHIP 9 SOUTH, RANGE 20 EAST, ALACHUA COUNTY, FLORIDA
27 RECORDED IN MINOR SUBDIVISION BOOK 2, PAGES 84-86, BEING MORE
28 PARTICULARLY DESCRIBED AS FOLLOWS:
29

30 COMMENCE AT THE NORTHWEST CORNER OF THE NORTHWEST 1/4 OF
31 SECTION 19, TOWNSHIP 9 SOUTH, RANGE 20 EAST, ALACHUA COUNTY,
32 FLORIDA AND RUN THENCE NORTH 89°14'27" EAST ALONG THE NORTH
33 LINE OF SAID SECTION 19, A DISTANCE OF 2664.71 FEET TO AN
34 INTERSECTION WITH THE NORTHERLY PROJECTION OF THE EAST RIGHT-
35 OF-WAY LINE OF NW 19TH STREET; THENCE RUN SOUTH 00°42'53" EAST,
36 ALONG SAID NORTHERLY PROJECTION, 50.00 FEET TO THE NORTHWEST
37 CORNER OF SAID PARCEL 5 AND THE POINT OF BEGINNING; THENCE RUN
38 NORTH 89°14'27" EAST ALONG THE SOUTH RIGHT-OF-WAY LINE OF NW
39 53RD AVENUE AND ALONG THE NORTH LINE OF SAID TRACT 5, A
40 DISTANCE OF 660.42 FEET TO THE NORTHEAST CORNER OF SAID TRACT 5;
41 THENCE RUN SOUTH 00°42'33" EAST ALONG THE EAST LINE OF SAID TRACT
42 5, A DISTANCE OF 155.00 FEET; THENCE SOUTH 89°14'20" WEST, A
43 DISTANCE OF 360.00 FEET; THENCE SOUTH 30°06'11" WEST, A
44 DISTANCE OF 244.64 FEET; THENCE SOUTH 89°14'20" WEST, A
45 DISTANCE OF 175.00 FEET TO THE EAST RIGHT-OF-WAY LINE OF NW 19TH
46 STREET AND THE WEST LINE OF SAID TRACT 5; THENCE RUN NORTH
47 00°43'31" WEST ALONG SAID EAST RIGHT-OF-WAY LINE AND SAID
48 WEST LINE, A DISTANCE OF 365.00 FEET TO THE POINT OF BEGINNING.
49

1 Name: **Pinkoson Property**
2 Location: East of Green Acres Park and west of 34th St
3 Acreage: 17 acres
4 Tax Parcel Number(s): 06693-000-000

5
6 Generally located along the lower reaches of Hogtown Creek within the Greenway in
7 southwest Gainesville.

8
9 Statement of value for placement on Registry: This park features extensive floodplain
10 forest around Hogtown Creek. This property provides necessary flood control and water
11 quality functions for the surrounding area and the creek. This park is proposed for
12 registry listing to protect the natural resources and ecological functions for which it was
13 acquired.

14
15 Legal Description: LOTS 1 AND 2 IN SECTION 11, TOWNSHIP 10 SOUTH, RANGE
16 19 EAST, ACCORDING TO A SURVEY PLAT OF SAID LOT 2 MADE BY J.W.
17 PATTON, IN MAY 1923, RECORDED IN DEED BOOK 250, PAGE 397, OF THE
18 PUBLIC RECORDS OF ALACHUA COUNTY, FLORIDA, CONTAINING 376,200
19 SQUARE FEET OR 8.64 ACRES, MORE OR LESS.

20
21 Name: **San Felasco Park**
22 Location: 6400 NW 43rd Way
23 Acreage: 194 acres
24 Tax Parcel Number(s): 06022-000-000

25
26 Generally located in northwest Gainesville along Blues Creek.

27
28 Statement of value for placement on Registry: this park features a mixture of flatwoods
29 types, upland pine forest, and a series of wetlands and creeks which create the headwaters
30 of Blues Creek. This park also abuts the state owned Devil's Millhopper Geological Site
31 State Park. This park is proposed for registry listing due to specific federally-required
32 deed restrictions regarding land use and because it has exemplary examples of the
33 aforementioned habitat types.

34
35 Legal Description: ALL THAT LOT, PIECE, OR PARCEL OF LAND LYING AND
36 BEING IN ALACHUA COUNTY, FLORIDA, AND CONSISTING OF A TOTAL OF
37 194± ACRES AND MORE FULLY DESCRIBED AS FOLLOWS:

38
39 THE EAST ONE-HALF OF THE SOUTHEAST QUARTER (E ½ OF SE ¼) OF
40 SECTION 10, TOWNSHIP 9 SOUTH, RANGE 19 EAST, TOGETHER WITH THE
41 EAST 31.5 CHAINS OF THE NORTHEAST QUARTER (NE ¼) AND THE EAST 17.7
42 CHAINS OF THE NORTH 11.0 CHAINS OF THE SOUTHEAST QUARTER (SE ¼)

1 OF SECTION 15, TOWNSHIP 9 SOUTH, RANGE 19 EAST, AND TRACTS AS PER
2 OR 294/261, LESS TRACT AS PER OR 294/265, LESS TRACT AS PER OR 627/185,
3 AND LESS OR 695/23, ALL BEING AND LYING IN SAID SECTION 15,
4 TOWNSHIP 9 SOUTH, RANGE 19 EAST, ALACHUA COUNTY, FLORIDA,
5 TOGETHER CONTAINING APPROXIMATELY 197 ACRES, LESS AND EXCEPT A
6 TRACT OR PARCEL OF LAND CONSISTING OF APPROXIMATELY 50 FEET OF
7 RIGHT-OF-WAY BEING MORE PARTICULARLY DESCRIBED AS FOLLOWS:

8
9 THE EAST 50 FEET OF THE EAST ½ OF THE SOUTHEAST ¼ OF SECTION 10,
10 TOWNSHIP 9 SOUTH, RANGE 19 EAST; LESS AND EXCEPT THE NORTH 30
11 FEET OF THE SOUTHEAST ¼ OF THE SOUTHEAST ¼ OF SECTION 10,
12 TOWNSHIP 9 SOUTH, RANGE 19 EAST, ALACHUA COUNTY, FLORIDA, AND
13 CONTAINING 2.996 ACRES, MORE OR LESS.

14
15 THE ABOVE DESCRIPTION IS ALSO DESCRIBED AS AND IN MORE DETAIL
16 BY THE FOLLOWING:

17
18 ALL THAT PART OF SECTIONS 10 AND 15, TOWNSHIP 9 SOUTH, RANGE 19
19 EAST, ALACHUA COUNTY, FLORIDA, AND BEING MORE PARTICULARLY
20 DESCRIBED AS FOLLOWS:

21
22 THE EAST ½ OF THE SOUTHEAST ¼ OF SAID SECTION 10; AND ALSO,
23 COMMENCE AT THE NORTHEAST CORNER OF SAID SECTION 15 FOR THE
24 **POINT OF BEGINNING**; THENCE SOUTH 00 DEG. 20 MIN. 23 SEC. EAST,
25 ALONG THE EAST LINE OF SAID SECTION 15, A DISTANCE OF 1763.55 FEET
26 TO AN INTERSECTION WITH THE EASTERLY PROLONGATION OF THE
27 NORTH LINE OF THE MAINE COMMUNICATIONS, INC. PROPERTY, AS PER
28 DEED RECORDED IN OFFICIAL RECORD BOOK 1642, PAGE 742 OF THE
29 PUBLIC RECORDS OF SAID ALACHUA COUNTY; THENCE SOUTH 89 DEG. 35
30 MIN. 37 SEC. WEST, ALONG THE SAID EASTERLY PROLONGATION AND
31 ALONG THE SAID NORTH LINE OF THE MAINE COMMUNICATIONS, INC.
32 PROPERTY, A DISTANCE 840.0 FEET TO THE NORTHWEST CORNER OF THE
33 SAID MAINE COMMUNICATIONS, INC. PROPERTY; THENCE SOUTH 00 DEG.
34 20 MIN. 23 SEC. EAST, ALONG THE WEST LINE OF THE SAID MAINE
35 COMMUNICATIONS, INC. PROPERTY, AND ALONG THE WEST LINE OF COX
36 CABLE UNIVERSITY CITY, INC. PROPERTY, AS PER PARCEL NO. 5 IN THE
37 DEED RECORDED IN OFFICIAL RECORD BOOK 1664, PAGE 398 OF THE SAID
38 PUBLIC RECORDS OF ALACHUA COUNTY, A DISTANCE OF 1570.0 FEET TO A
39 BOUNDARY CORNER OF THE SAID COX CABLE PROPERTY; THENCE SOUTH
40 89 DEG. 35 MIN. 37 SEC. WEST, ALONG THE BOUNDARY LINE OF THE SAID
41 COX CABLE PROPERTY, A DISTANCE OF 425.36 FEET TO AN INTERSECTION
42 WITH THE EAST LINE OF DEVIL'S MILLHOPPER, AS PER DEED RECORDED IN

1 OFFICIAL RECORD BOOK 831, PAGE 591 OF THE SAID PUBLIC RECORDS
 2 (A.K.A. A BOUNDARY CORNER OF SAID COX CABLE PROPERTY); THENCE
 3 NORTH 00 DEG. 20 MIN. 23 SEC. WEST, ALONG THE SAID EAST LINE OF
 4 DEVIL’S MILLHOPPER, A DISTANCE OF 593.02 FEET TO THE NORTHEAST
 5 CORNER OF THE SAID DEVIL’S MILLHOPPER; THENCE SOUTH 89 DEG. 37
 6 MIN. 13 SEC. WEST, ALONG THE NORTH LINE OF THE SAID DEVIL’S
 7 MILLHOPPER, A DISTANCE OF 704.80 FEET TO THE SOUTHEAST CORNER OF
 8 THE BOARD OF TRUSTEES OF THE INTERNAL IMPROVEMENT TRUST FUND
 9 (TIITF) PROPERTY, AS PER DEED RECORDED IN OFFICIAL RECORD BOOK
 10 695, PAGE 23 OF THE SAID PUBLIC RECORDS; THENCE NORTH 40 DEG. 28
 11 MIN. 17 SEC. WEST, ALONG THE NORTHEASTERLY BOUNDARY LINE OF THE
 12 SAID TIITF PROPERTY, A DISTANCE OF 176.25 FEET TO THE MOST
 13 NORTHERLY CORNER OF THE SAID TIITF PROPERTY (A.K.A. AN
 14 INTERSECTION WITH THE EAST LINE OF A SECOND TIITF PROPERTY, AS
 15 PER DEED RECORDED IN OFFICIAL RECORD BOOK 698, PAGE 121 OF THE
 16 SAID PUBLIC RECORDS); THENCE NORTH 00 DEG. 20 MIN. 23 SEC. WEST,
 17 ALONG THE SAID EAST LINE OF THE TIITF PROPERTY, A DISTANCE OF
 18 APPROXIMATELY 153.92 FEET TO THE SOUTHEAST CORNER OF LOT 29 OF
 19 DEER RUN – UNIT 3, AS PER PLAT RECORDED IN PLAT BOOK “L”, PAGE 34
 20 OF THE SAID PUBLIC RECORDS; THENCE NORTH 00 DEG. 20 MIN. 23 SEC.
 21 WEST, ALONG THE EAST LINE OF SAID DEER RUN – UNIT 3, AND ALONG
 22 THE EAST LINE OF THE VIOLET MIDKIFF PROPERTY, AS PER DEED
 23 RECORDED IN OFFICIAL RECORD BOOK 1650, PAGE 2597 OF THE SAID
 24 PUBLIC RECORDS, A DISTANCE OF 2613.54 FEET TO AN INTERSECTION
 25 WITH THE NORTH LINE OF SAID SECTION 15; THENCE NORTH 89 DEG. 39
 26 MIN. 06 SEC. EAST, ALONG THE SAID NORTH LINE OF SECTION 15, A
 27 DISTANCE OF 2079.00 FEET TO THE SAID **POINT OF BEGINNING** (A.K.A. THE
 28 SAID NORTHEAST CORNER OF SECTION 15).

29
30 LESS AND EXCEPT:

- 31 1. THE RIGHT OF WAY OF NW 73 AVENUE, AS PER DEED
32 RECORDED IN OFFICIAL RECORD BOOK 2229, PAGE 1740 OF
33 THE SAID PUBLIC RECORDS; AND ALSO,
- 34 2. THE RIGHT OF WAY OF NW 43 STREET FROM NW 53 AVENUE,
35 NORTHERLY TO THE NORTH LINE OF THE SAID EAST ½ OF THE
36 SOUTHEAST ¼ OF SECTION 15; AND ALSO,
- 37 3. THE RIGHT OF WAY OF NW 43 WAY THAT EXTENDS FROM NW
38 43 STREET NORTHERLY TO THE NORTH LINE OF TAX PARCEL
39 NO. 6022-002-000, AND THAT LIES IN SAID SECTION 15.

40
41 CONTAINING APPROXIMATELY 194 ACRES.

1 **BEARING NOTE:** THE BEARINGS AS SHOWN HEREIN HAVE BEEN
2 PROJECTED ENTIRELY FROM THE BEARINGS RECITED IN THE
3 DESCRIPTION, AS RECORDED IN OFFICIAL RECORD BOOK 1378, PAGE 132
4 OF THE SAID PUBLIC RECORDS.

5
6 Name: **Springtree Park**
7 Location: 2700 NW 39th Ave
8 Acreage: 12 acres
9 Tax Parcel Number(s): 06080-001-000

10
11 Generally located in northwest Gainesville along Three Lakes Creek.

12
13 Statement of value for placement on Registry: Three Lakes Creek is a tributary to
14 Possum Creek. This park is proposed for registry listing because of the “stream to sink”
15 nature of Three Lakes Creek and because it was acquired to develop the property as a
16 neighborhood park for recreational use.

17
18 Legal Description: LOT 120, SPRINGTREE, A SUBDIVISION AS PER PLAT
19 THEREOF RECORDED IN PLAT BOOK “T”, PAGE 62, OF THE PUBLIC RECORDS
20 OF ALACHUA COUNTY, FLORIDA.

21 ALSO:

22
23 A PARCEL LOCATED IN THE SOUTHEAST QUARTER OF SECTION 24,
24 TOWNSHIP 9 SOUTH, RANGE 19 EAST, ALACHUA COUNTY, FLORIDA, BEING
25 MORE PARTICULARLY DESCRIBED AS FOLLOWS;

26
27 COMMENCE AT A SET NAIL AND CAP (#3524), MARKING THE SOUTHWEST
28 CORNER OF THE SOUTHEAST QUARTER OF SECTION 24, TOWNSHIP 9
29 SOUTH, RANGE 19 EAST, AND A POINT ON THE CENTERLINE OF
30 NORTHWEST 39TH AVENUE, THENCE NORTH 1 DEGREE 20 MINUTES 40
31 SECONDS WEST A DISTANCE OF 50.04 FEET TO A FOUND CONCRETE
32 MONUMENT MARKING THE INTERSECTION WITH THE NORTH RIGHT-OF-
33 WAY OF NORTHWEST 39TH AVENUE, THENCE NORTH 89 DEGREES 36
34 MINUTES 41 SECONDS EAST ALONG SAID NORTH RIGHT-OF-WAY LINE A
35 DISTANCE OF 217.74 FEET TO A SET IRON PIN (#3524) AND THE POINT OF
36 BEGINNING, THENCE CONTINUE ALONG SAID LINE NORTH 89 DEGREES 36
37 MINUTES 41 SECONDS EAST A DISTANCE OF 200.00 FEET TO A FOUND
38 CONCRETE MONUMENT, THENCE NORTH 00 DEGREES 57 MINUTES 55
39 SECONDS WEST A DISTANCE OF 1286.57 FEET TO A FOUND IRON PIN,
40 THENCE SOUTH 89 DEGREES 9 MINUTES 24 SECONDS WEST A DISTANCE OF
41 418.19 FEET TO A FOUND CONCRETE MONUMENT, THENCE SOUTH 0
42 DEGREES 59 MINUTES 12 SECONDS EAST A DISTANCE OF 1006.81 FEET TO A

1 SET IRON PIN (#3524), MARKING THE INTERSECTION WITH THE
2 CENTERLINE OF A CREEK, THENCE ALONG THE CENTERLINE OF SAID
3 CREEK THE FOLLOWING COURSES AND DISTANCES, NORTH 74 DEGREES 49
4 MINUTES 49 SECONDS EAST A DISTANCE OF 34.39 FEET TO A SET IRON PIN
5 (3524), THENCE NORTH 18 DEGREES 39 MINUTES 13 SECONDS EAST A
6 DISTANCE OF 26.24 FEET TO A SET IRON PIN (#3524), THENCE NORTH 61
7 DEGREES 47 MINUTES 19 SECONDS EAST A DISTANCE OF 22.18 FEET TO A
8 SET IRON PIN (#3524), THENCE NORTH 74 DEGREES 40 MINUTES 35 SECONDS
9 EAST A DISTANCE OF 28.65 FEET TO A SET IRON PIN (#3524), THENCE
10 NORTH 13 DEGREES 30 MINUTES 16 SECONDS EAST A DISTANCE OF 18.95
11 FEET TO A SET IRON PIN (#3524), THENCE NORTH 84 DEGREES 57 MINUTES
12 35 SECONDS EAST A DISTANCE OF 28.64 FEET TO A SET IRON PIN (#3524),
13 THENCE SOUTH 19 DEGREES 40 MINUTES 41 SECONDS EAST A DISTANCE OF
14 18.31 FEET TO A SET IRON PIN (#3524), THENCE NORTH 81 DEGREES 0
15 MINUTES 40 SECONDS EAST A DISTANCE OF 17.31 FEET TO A SET IRON PIN
16 (#3524), THENCE NORTH 23 DEGREES 27 MINUTES 46 SECONDS EAST A
17 DISTANCE OF 14.29 FEET TO A SET IRON PIN (#3524), THENCE LEAVING SAID
18 CREEK SOUTH 30 DEGREES 14 MINUTES 34 SECONDS EAST A DISTANCE OF
19 134.75 FEET TO A SET IRON PIN (#3524), THENCE SOUTH 0 DEGREES 59
20 MINUTES 12 SECONDS EAST A DISTANCE OF 230.00 FEET TO THE POINT OF
21 BEGINNING, CONTAINING 10.78 ACRES, MORE OR LESS.
22

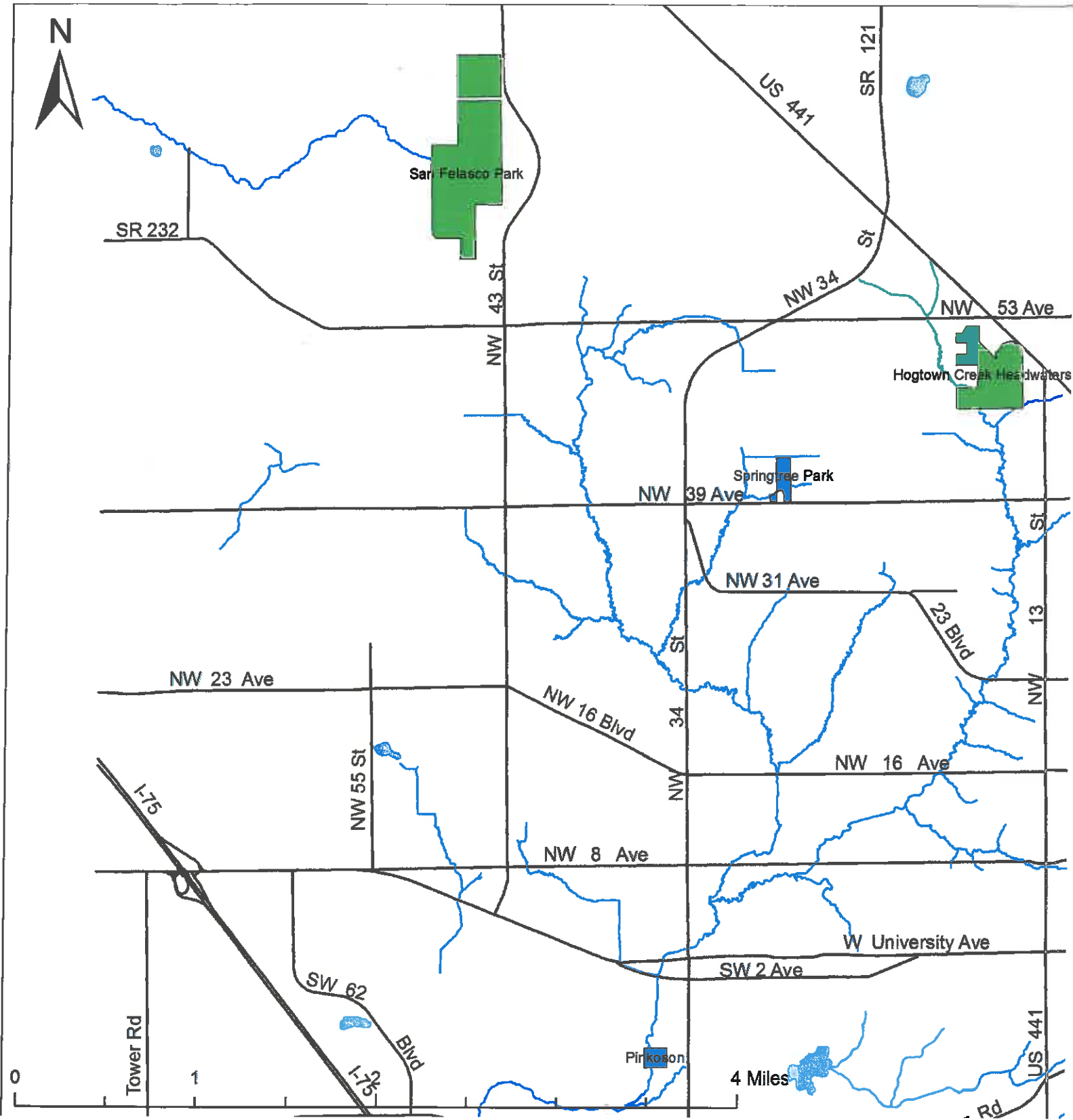

EXHIBIT "B" TO ORDINANCE 121080