

**LEGISLATIVE ID**

**#120213B**

# EXHIBIT "A"

## GRAPHIC SCALE

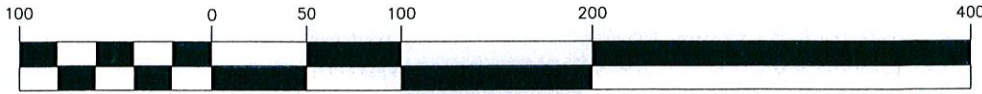

( IN FEET )  
1 inch = 100 ft.

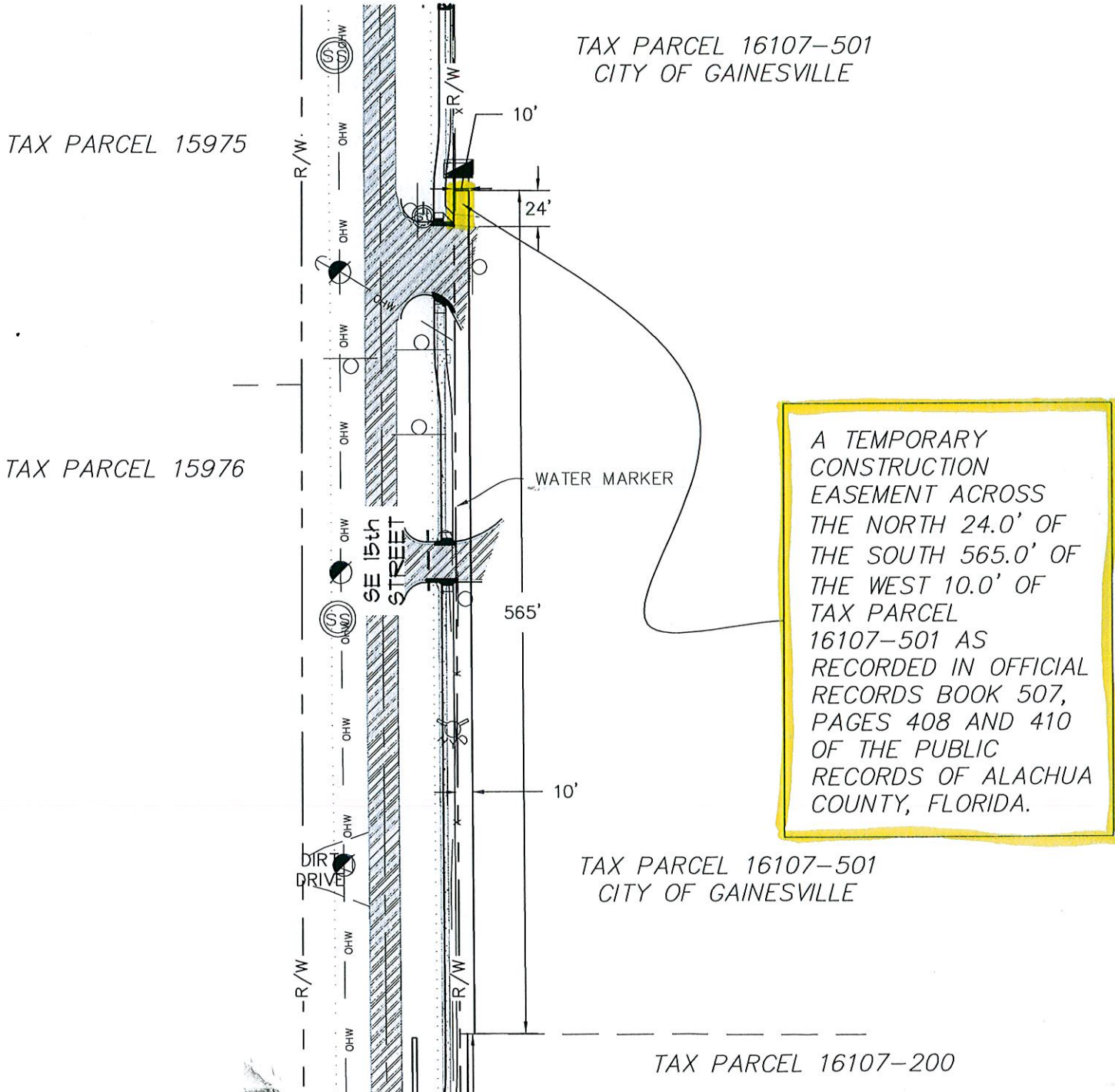

A TEMPORARY  
CONSTRUCTION  
EASEMENT ACROSS  
THE NORTH 24.0' OF  
THE SOUTH 565.0' OF  
THE WEST 10.0' OF  
TAX PARCEL  
16107-501 AS  
RECORDED IN OFFICIAL  
RECORDS BOOK 507,  
PAGES 408 AND 410  
OF THE PUBLIC  
RECORDS OF ALACHUA  
COUNTY, FLORIDA.

PROJECT NO. 09-029	DRAFTER H. ROBINSON	FIELD BOOK 14 (p. 4-7)	SURVEY DATE 3/31/11	ALACHUA COUNTY PUBLIC WORKS SURVEYING PHONE: 352-374-3243 / 352-492-0055 8620 HWY 12001 LAKE GAINESVILLE, FLORIDA 32653	NOT VALID WITHOUT THE SIGNATURE AND ORIGINAL RAISED SEAL OF A FLORIDA LICENSED SURVEYOR AND MAPPER <i>Stephen J. Remmons</i> STEPHEN J. REMMONS Professional Surveyor & Mapper	M.A.R. 09-029-EASEMENTS 06/07/12 7:51 6-07-2012 Date
SHEET NO. Tax Parcel 16107-501	COMPUTER FILE 09-029-EASEMENTS.dwg	DRAWING SCALE AS SHOWN	REVISION DATE(S)			