

0309560

# DESIGN PLAT

OF

# MEADOWS NORTH

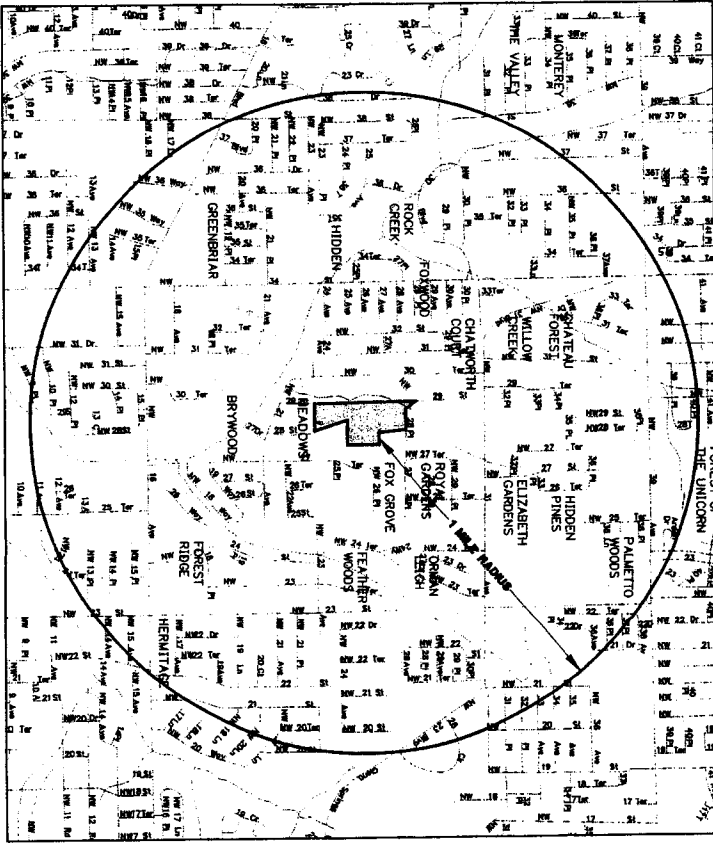

LOCATION MAP  
SCALE: 1"=500'

1	12/22/03	REVISIONS PER THE COMMENTS
2		
3		
4		
5		
6		
7		
8		
9		
10		
11		
12		
13		
14		
15		
16		
17		
18		
19		
20		

### GENERAL NOTES:

- PROJECT DESCRIPTION: THE PROJECT IS A PROPOSED PLAT TO CREATE 13 LOTS FOR DEVELOPMENT OF A COMMUNITY WITH STREET SERVICES AND STORMWATER MANAGEMENT SYSTEM.
- PROPERTY OWNERS: EVANS & HARRIS  
2000 NW 28TH STREET  
GAINESVILLE, FL 32608  
AL AND DANA DAY  
176 AMERSONWOOD STREET  
BOSTON, MA 02116
- DEVELOPER: ALBEMARLE DEVELOPMENT CORP  
2201-42 NW 41ST STREET  
GAINESVILLE, FL 32608
- ENGINEER: BROWN & CULLEN, INC  
1000 W. UNIVERSITY AVENUE  
GAINESVILLE, FL 32608
- FORUM LAND USE: ALL PROPERTY IS SF
- ZONING: ALL PROPERTY IS RSF-1
- TAX PARCELS: 06007-000-000, 06007-006-706, 06007-029-001
- UTILITIES: THERE IS EXISTING POTABLE WATER AND SANITARY SEWER SERVICES ADJACENT TO THE SITE. THE DEVELOPMENT WILL TIE INTO THESE SERVICES AND PROVIDE EXTENSIONS INTO THE SITE.
- NATURAL OR UNUSUAL FEATURES: THERE ARE NO SIGNIFICANT NATURAL OR UNUSUAL FEATURES ON THE SITE.
- TREES: A SIGNIFICANT NUMBER OF TREES EXIST ON THE SITE. THE PROPOSED IMPROVEMENTS WILL ONLY REMOVE APPROXIMATELY 3 TREES SOUTH AND WEST. THESE GENERAL FLOW PATTERNS WILL BE MAINTAINED AND A STORMWATER MANAGEMENT SYSTEM IS PROPOSED TO CONSIST OF SMALL BASINS AND DETENTION NATURAL BUFFERS.
- SOILS: THE SOIL TYPES ARE SHOWN ON THE DESIGN PLAT.
- STREETS: THE STREET MEAS WILL BEQUAN PROVIDED. AN EMERGENCY ACCESS WILL BE PROVIDED TO NW 28TH AVE.
- WATER GENERATION DATA: THE SITE IS LOCATED IN THE TYPICAL ZONE B, THE HIGH TYPICAL, AND IS NOT NEW OR PEAK HOUR TRAFFIC.

DESIGN PLAT OF MEADOWS NORTH	
SHEET NO.	SHEET TITLE
1	COVER SHEET
2	DESIGN PLAT
SUR-1	BOUNDARY SURVEY (MCMILLEN)
SUR-2, SUR-3	TOPOGRAPHIC SURVEY (MCMILLEN)
SUR-4	BOUNDARY, TOPOGRAPHIC & LOCATION SURVEY (MVERS)

**BROWN & CULLEN**  
INC.  
CIVIL ENGINEERS  
AND  
LAND PLANNERS

1000 W. UNIVERSITY AVENUE  
GAINESVILLE, FL 32608  
PHONE: (352) 379-3800 FAX: (352) 379-0400  
WWW.BROWNANDCULLEN.COM  
56 of the Seal of Prof. Eng. Code of Fla. No. 0003





Quasi-Judicial Registration Form

CITY OF GAINESVILLE  
CITY COMMISSION

RE: Petition 159SUB-03 DB, Albemarle Development, agent for Andrew Evans, Karen Harris, John Day, and Dana Day. Design Plat approval of Meadows North Subdivision, thirteen lots on 16.543 acres more or less. Located in the vicinity of Northwest 28<sup>th</sup> Street and Northwest 23<sup>rd</sup> Avenue, north side. Zoned: RSF-1.  
City Commission Hearing Date: 02/23/04

FEB 16 AM 10:42

Name: (please print) Bill Stasiwicz

Address: 2220 N.W. 28<sup>TH</sup> ST Gainesville, FL

Telephone Number: 352-384-1665

Please indicate whether you are for or against this petition: FOR \_\_\_ or AGAINST  (mark "X")

Please indicate whether you are requesting a Formal Hearing: YES \_\_\_ or NO  (mark "X")

\*\*\*\*\*  
Complete the following section of the form **only** if you are requesting a **formal** quasi-judicial hearing:

(Please refer to the enclosed Quasi-Judicial Hearing sheet contained in this mail-out for more information.)

As an affected person receiving notice of the public hearing on Petition 159SUB-03 DB, I hereby request that the City Commission conduct a formal quasi-judicial hearing as described above.

Signature: \_\_\_\_\_

This form and exhibits to be presented to the City Commission must be delivered to the Clerk of the Commission at least 7 days prior to the public hearing as stated in the notification letter sent to you. The Clerk of the Commission Office is located at City Hall, 1st floor, 200 East University Avenue, Gainesville, Florida. Forms may be mailed to the following address: Clerk of the Commission—Mail Station 19, Quasi-Judicial Hearing, Petition 159SUB-03 DB, P.O. Box 490, Gainesville, Florida, 32602.

Attorney Information (If applicable):

Name: (please print) \_\_\_\_\_

Address: \_\_\_\_\_

Signature: \_\_\_\_\_

Telephone Number: \_\_\_\_\_

Quasi-Judicial Registration Form

CITY OF GAINESVILLE  
CITY COMMISSION

RE: Petition 159SUB-03 DB, Albemarle Development, agent for Andrew Evans, Karen Harris, A.L. Day, and Dana Day. Design Plat approval of Meadows North Subdivision, thirteen lots on 16.543 acres, more or less. Located in the vicinity of Northwest 28<sup>th</sup> Street and Northwest 23<sup>rd</sup> Avenue, north side. Zoned: RSF-1.  
City Commission Hearing Date: 02/23/04

2004 FEB 15 AM 10:16

Name: (please print) Alexander Stephan

Address: 2402 NW 27th Terrace, Gainesville, FL 32609

Telephone Number: 352-338-0141

Please indicate whether you are for or against this petition: FOR  or AGAINST  (mark "X")

Please indicate whether you are requesting a Formal Hearing: YES  or NO  (mark "X")

\*\*\*\*\*

Complete the following section of the form only if you are requesting a formal quasi-judicial hearing:

(Please refer to the enclosed Quasi-Judicial Hearing sheet contained in this mail-out for more information.)

As an affected person receiving notice of the public hearing on Petition 159SUB-03 DB, I hereby request that the City Commission conduct a formal quasi-judicial hearing as described above.

Signature: \_\_\_\_\_

This form and exhibits to be presented to the City Commission must be delivered to the Clerk of the Commission at least 7 days prior to the public hearing as stated in the notification letter sent to you. The Clerk of the Commission Office is located at City Hall, 1st floor, 200 East University Avenue, Gainesville, Florida. Forms may be mailed to the following address: Clerk of the Commission—Mail Station 19, Quasi-Judicial Hearing, Petition 159SUB-03 DB, P.O. Box 490, Gainesville, Florida, 32602.

Attorney Information (If applicable):

Name: (please print) Alexander and Halina Stephan

Address: 2402 NW 27th Terrace, Gainesville, FL 32609

Signature: Alexander Stephan Halina Stephan

Telephone Number: 352-338-0141