



060913

A PETITION FOR VOLUNTARY ANNEXATION

TO: THE HONORABLE MAYOR AND MEMBERS OF THE CITY COMMISSION OF THE
CITY OF GAINESVILLE, FLORIDA

FROM: _____ Valentin Zahariev _____ (Petitioner(s))

DATE: _____

I/We, _____ Valentin Zahariev _____, as

_____ Owner _____ (title) of the _____

_____ (corporation, if necessary)

submit this petition to the City Commission of the City of Gainesville, Alachua County, Florida, and request annexation to the City of Gainesville, of all the property described below and incorporate this property within the territorial limits of the City of Gainesville, pursuant to Chapter 90-496, Laws of Florida, as amended.

The undersigned officer(s) certifies that he/she is/are the lawful owner(s) of the property and is/are authorized to bind the corporation and execute this petition on behalf of the corporation as the owner(s) of the following described property, which is situated in Alachua County, Florida.

(See Exhibit A for description attached hereto and made a part hereof as if set forth in full)

The property described above which is requested to be annexed is contiguous with the corporate limits of the City of Gainesville, is reasonably compact, and is part of the City's urban reserve area. It is generally located in the vicinity of:



south of Williston Road,
west of SW 20th Terrace,
north of Tax Parcels 07177-002-000 and 07177-002-001,
and east of the City Limits.

The undersigned officer (s) expresses the corporation's consent to the adoption of Ordinances of the City of Gainesville adopting a report, and if not withdrawn in the time specified by law, voluntarily annexing and incorporating the property described above into the City of Gainesville, Alachua County, Florida, pursuant to Chapter 90-496, as amended by Chapter 91-382 and Chapter 93-347 Special Acts, Laws of Florida.

SIGNATURE:
VLADISLAV PETROV FOR

NAME: Valentin Zahariev
TITLE: Owner
ADDRESS: East Park Trade Center 1407
53A N. Vaptzarov Blvd., Sofia, Bulgaria

SIGNATURE:

NAME: VLADISLAV PETROV
TITLE: MANAGER INTER INVEST LLC
ADDRESS: 1210 SW 82nd DR
GAINESVILLE FL 32607

STATE OF Florida
COUNTY OF Alachua

The foregoing instrument was acknowledged before me this 19 day of January 2007 by Vladislav Petrov who is personally known to me or has produced FLDL as identification & who did not take an oath

Notary Public

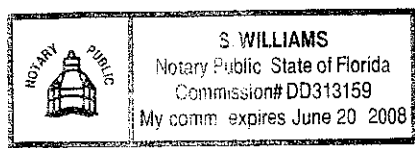
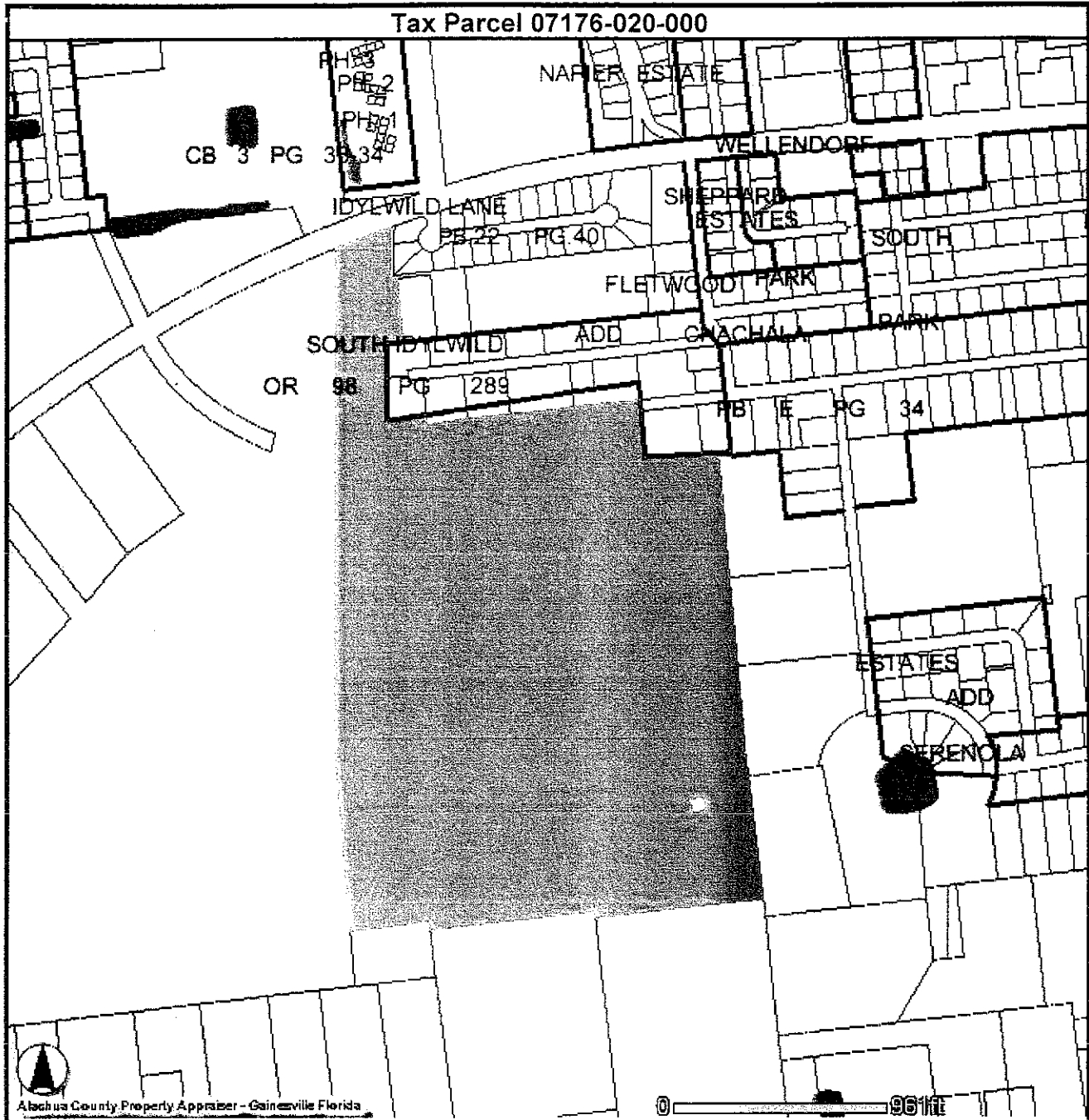

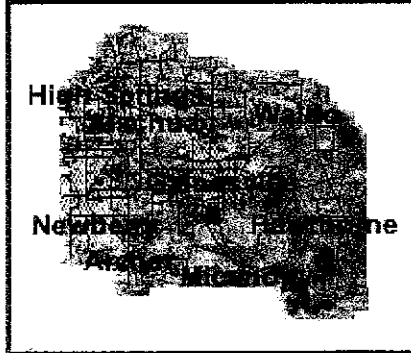

EXHIBIT A

Tax Parcel Number 07176-020-000 recognized by the Alachua County Property Appraiser, being more accurately defined on the attached map.



Alachua County Property Appraiser - Gainesville Florida



This map is prepared for the inventory of real property found within this jurisdiction, and is compiled from recorded deeds, plats, and other public records and data. Users of this map are hereby notified that the aforementioned public primary information sources should be consulted for verification of the information contained on this map. The Alachua County Property Appraiser assumes no legal responsibility for the information contained on this map or in this website.

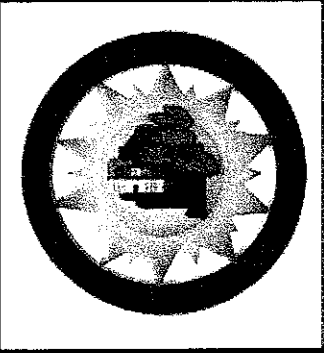

<http://WWW.ACPAFL.ORG>