

DETAIL OF SIGNAL HEADS



3-SECT. TRAFFIC SIGNAL
 12" LED
 6 EA 650-51-37
 6 EA 650-51-50
 6 EA 653-1B
 2 AS 653-1B2
 2 AS 653-1B2
 2 AS

5-SECT. TRAFFIC SIGNAL
 12" LED
 6 EA 650-51-37
 6 EA 650-51-50
 6 EA 653-1B
 2 AS 653-1B2
 2 AS 653-1B2
 2 AS

(SEE SPECIAL NOTE 7)

INTERNATIONAL PEDESTRIAN SIGNAL COUNT-DOWN 1-SECTION, 1-WAY
 1 EA 653-7-1
 1 AS 670-5-132
 1 EA 695-128
 1 EA 695-140

INTERNATIONAL PEDESTRIAN SIGNAL COUNT-DOWN 1-SECTION, 2-WAY
 1 EA 653-1-16
 1 EA 653-1-15
 1 EA 694-1-14
 1 EA 694-1-15
 1 EA 695-140

- CONTROLLER & OPERATION NOTES:
 CONTROLLER WILL BE A NATEQ - NEMA T52, TYPE 1, WITH ETHERNET COMMUNICATION, OR FULLY APPROVED EQUIVALENT, FULLY COMPATIBLE WITH THE CITY OF GAINESVILLE CLOSED LOOP SYSTEM SOFTWARE. INITIALLY OPERATED AS SOP 7, WITH FLASHER.
- SPECIAL NOTES:
 1. THE MAJOR STREET IS S.R. 26, NEWBERRY RD. LOCUMENTS 1, 2, 5, AND 6, AND 8.
 2. THE MINOR STREET IS NW 48TH BLVD. LOCUMENTS 4 AND 8.
 3. STREET NAMES FOR FT-23-04 SIGNS SHALL BE NEWBERRY RD. (P8) AND NW 48TH BLVD. (P2 AND P6).
 4. POWER SERVICE FOR THE SIGNAL TO BE OBTAINED FROM EXISTING POWER POLE LOCATED ON THE NORTHWEST CORNER OF THE INTERSECTION. SEE UNDERGROUND POWER SERVICE DETAIL ON SHEET T-1.
 5. FURNISH AND INSTALL FIBER OPTIC CABLE FROM CONTROLLER CABINET TO JUNCTION BOX ON A-F-RAME.
 6. TREE TRIMMING WILL BE REQUIRED TO INSTALL MAST ARM *1.
 7. COST OF COUNT-DOWN PEDESTRIAN SIGNAL HEADS SHALL BE PAID FOR UNDER PAY ITEMS 653-1B1 AND 653-1B2.

MAST ARM MOUNTED SIGNS

USE MAST ARM MOUNTED SIGN DETAILS FOR LAYOUT
 SIGN ID1 SIGN ID2
Newberry **NW 48TH**
 BM BM
 2 EA 700-4B-1B 2 EA 700-4B-1B

CONTROLLER TIMINGS

TURNS FUNCTION	1	2	3	4	5	6	7	8
MINIMUM GREEN	4.0	18.0	-	4.0	4.0	18.0	-	4.0
EXTENSION	3.0	2.5	-	3.0	3.0	2.5	-	3.0
WARNING GREEN 1	CITY OF GAINESVILLE WILL PROVIDE							
YELLOW CLEARANCE	4.0	4.5	-	4.0	4.0	4.5	-	4.0
ALL RED	1.0	1.0	-	1.0	1.0	1.0	-	1.0
PEDESTRIAN WALK	9	-	-	-	-	13	-	12
PEDESTRIAN WALK	18	-	-	-	-	25	-	23
RECALL	-	-	-	-	-	-	-	-
DETECT. FUNCTION	NON-LOCK	NON-LOCK	NON-LOCK	NON-LOCK	NON-LOCK	NON-LOCK	NON-LOCK	NON-LOCK

VIDEO DETECTION ZONES

ZONES	DETECTION TYPE	DELAY TIME	PRESENCE / ADVANCED (SEC)
V-1	PRESENCE	5	PRESENCE
V-21 & V-20	PRESENCE	0	PRESENCE
V-4	PRESENCE	0	PRESENCE
V-4R	PRESENCE	5	PRESENCE
V-5	PRESENCE	0	PRESENCE
V-61 & V-60	PRESENCE	0	PRESENCE
V-8R	PRESENCE	5	PRESENCE
V-8	PRESENCE	0	PRESENCE

DELAY TIME IS INITIAL AND MAY REQUIRE FIELD ADJUSTING AS DIRECTED BY THE PROJECT ENGINEER.
 653-74-11 4 EA

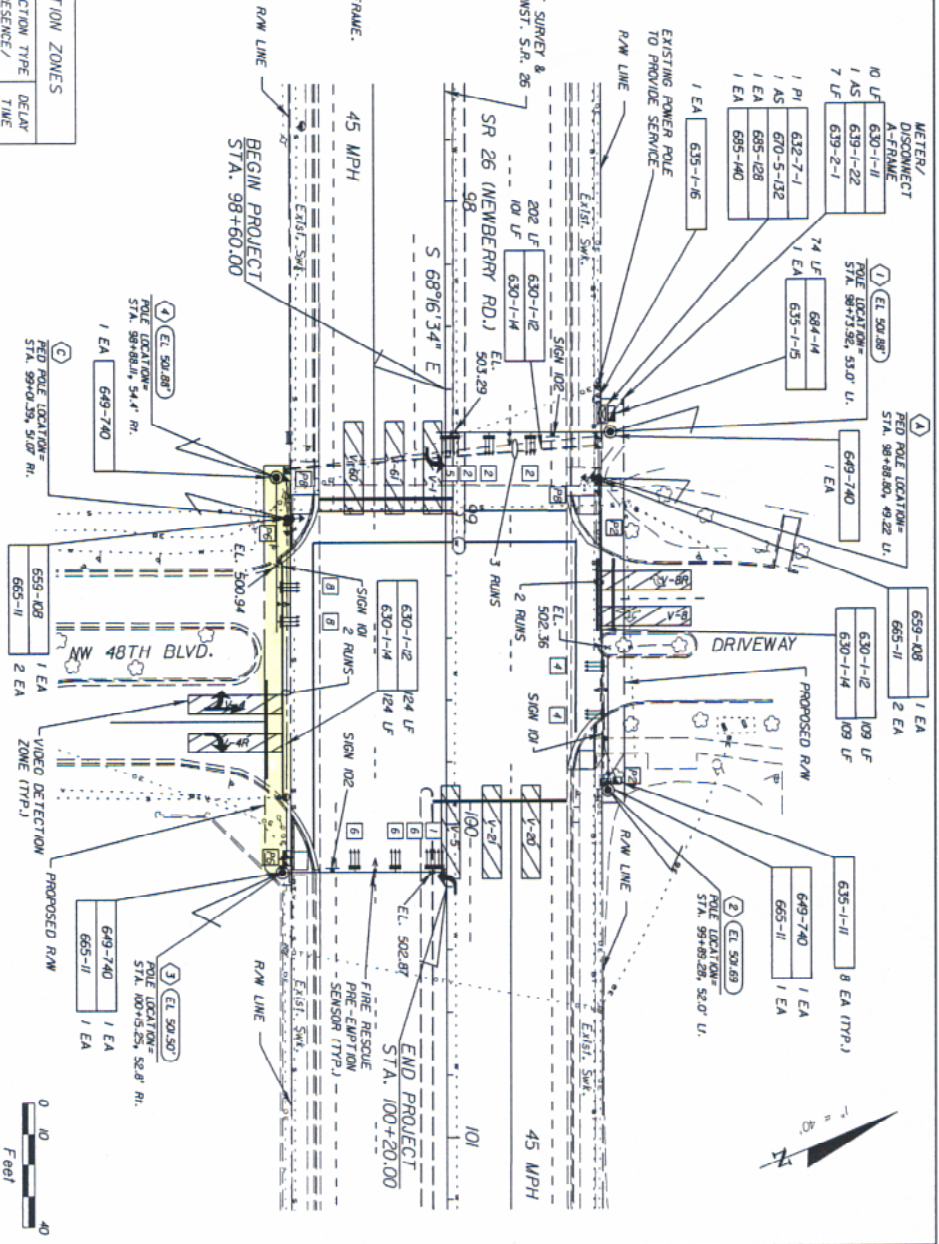

DATE: _____ DESCRIPTION: _____ R.E.V.'S / O.K.S.: _____ DATE: _____ BR: _____

DATE: _____ DESCRIPTION: _____ R.E.V.'S / O.K.S.: _____ DATE: _____ BR: _____

201 S Orange Ave, Suite 1300 Orlando, FL 32801-3442
 Certificate of Authorization Number: 7892
 Ryan A. McGinnis, P.E., License No. 98994

COMPANIONATIVE CES Engineering Services, Inc.

STATE OF FLORIDA DEPARTMENT OF TRANSPORTATION
 COUNTY: _____ FINANCIAL PROJECT ID: _____
 ROAD NO.: SR 26 ALACHUA 2076599-2-52-01

SIGNALIZATION PLAN

SHEET NO. T-5