

LEGISLATIVE #

110519



DESIGN OPTIONS PRESENTATION

Mills Gilbane HARVARD • JOLLY
DESIGN / BUILD TEAM



City of Gainesville

Gainesville Police Department Headquarters and Physical Training Facility

City Commission Meeting
February 16, 2012



Agenda

UW Mills Gilbane HARVARD • JOLLY
DESIGN / BUILD TEAM

Project Team

Background

Design Options

Questions & Answers

PROJECT TEAM



Jack Williams
Harvard Jolly
Design Project Mgr.
Lead Architect



Steve Johnson
Harvard Jolly
Project Architect



Joe Frisco
Mills Gilbane
Project Executive



Gary Krueger
TLC - Engineering
SMEP Engineer
LEED Administrator



Jay Brown Jr.
Brown & Cullen
Civil Engineer



Agenda

UW Mills Gilbane HARVARD • JOLLY
DESIGN / BUILD TEAM

Project Team

Background

Design Options

Questions & Answers

BACKGROUND

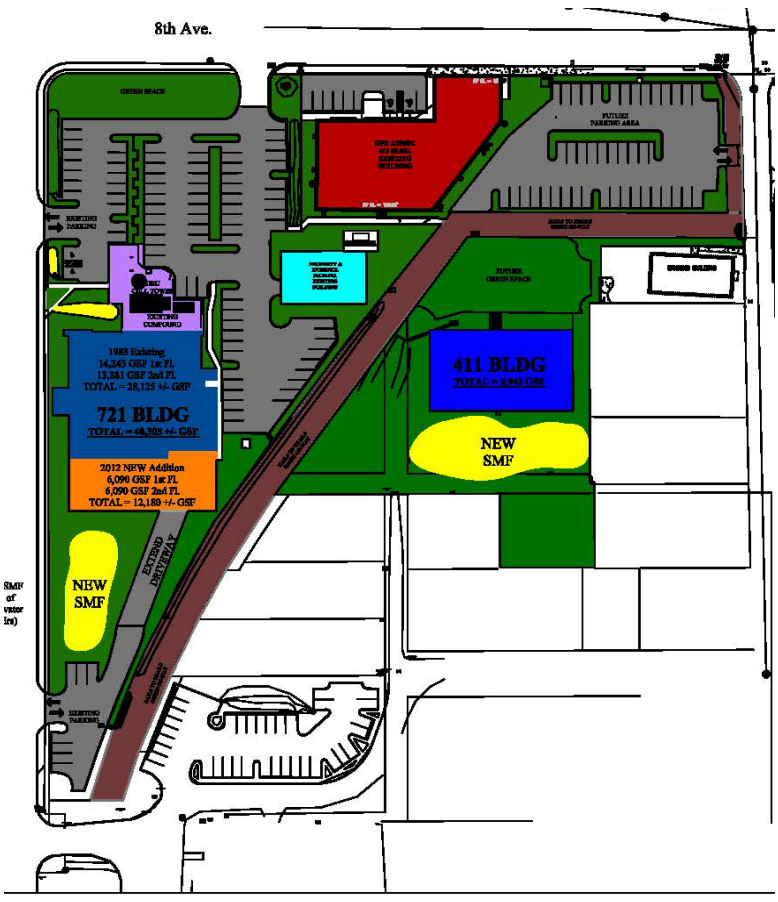

RFQ Option 1

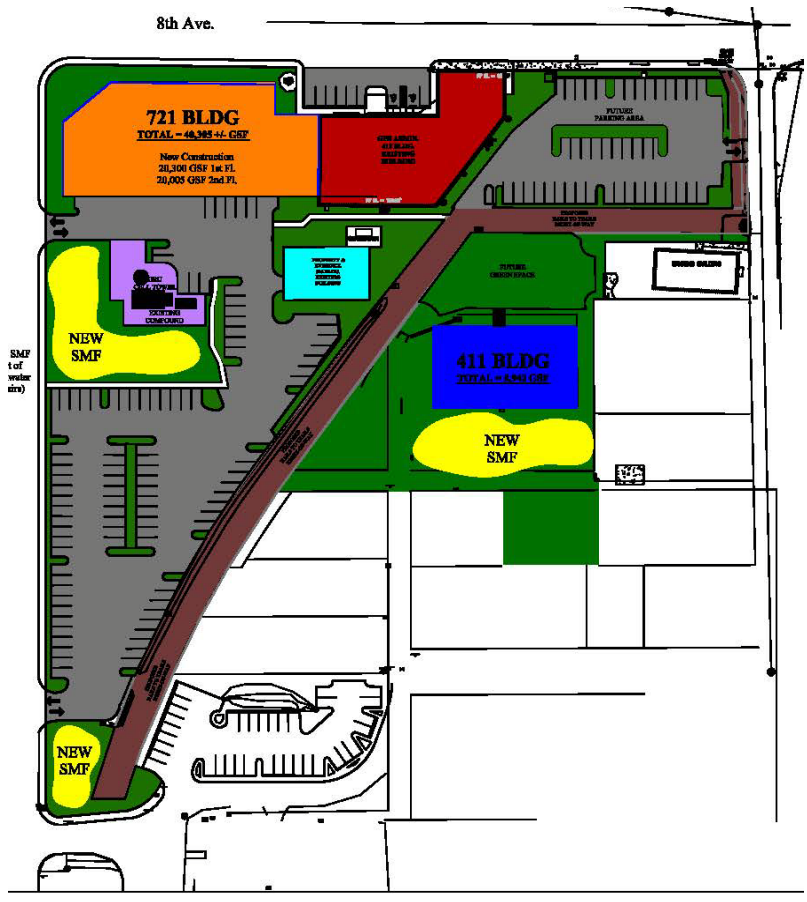

RFQ Option 2

PRE-DESIGN ACTIVITIES

- ▶ Dec. 5, 2011 – Kickoff Meeting
- ▶ Dec. 6, 2011 – 1st Step Meeting
- ▶ Dec. 13, 2011 – Design Charrette
- ▶ Dec. 13, 2011 – Planning Meeting
- ▶ Dec. 20, 2011 – Spatial Analysis/Conc. Schematic
- ▶ Dec. 21, 2011 – Site Survey Commences
- ▶ Jan. 4, 2012 – Design Charrette
- ▶ Jan. 4, 2012 – Survey Review Meeting
- ▶ Jan. 9, 2012 – Design Charrette
- ▶ Jan. 18, 2012 – Project Review Meeting
- ▶ Jan. 19, 2012 – City Manager Presentation
- ▶ Jan. 26, 2012 – Follow-up Presentation to COG





Agenda

UW Mills Gilbane HARVARD • JOLLY
DESIGN / BUILD TEAM

Project Team

Background

Design Options

Questions & Answers

EXISTING SITE LAYOUT

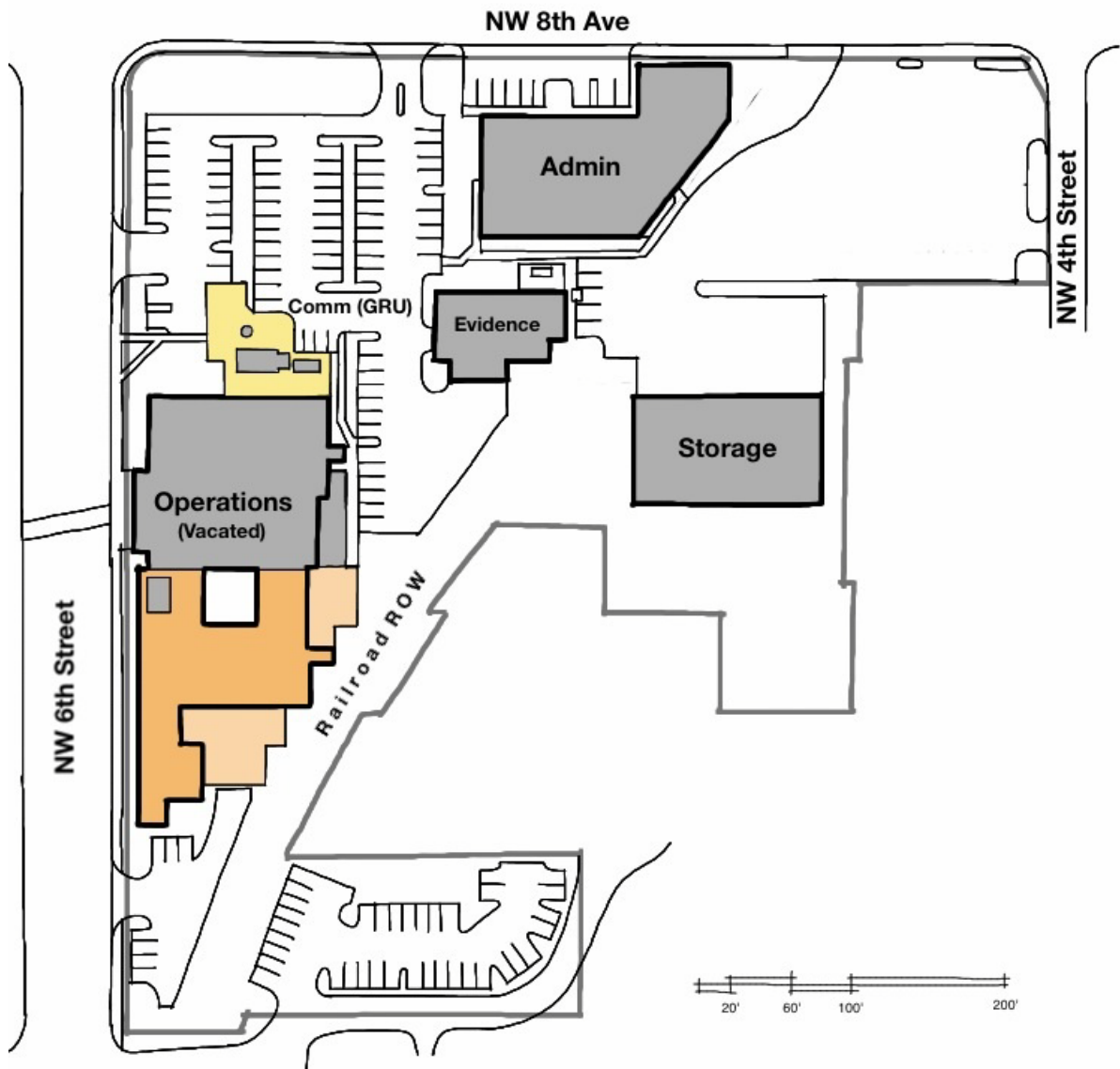

Option 1 | SITE LAYOUT

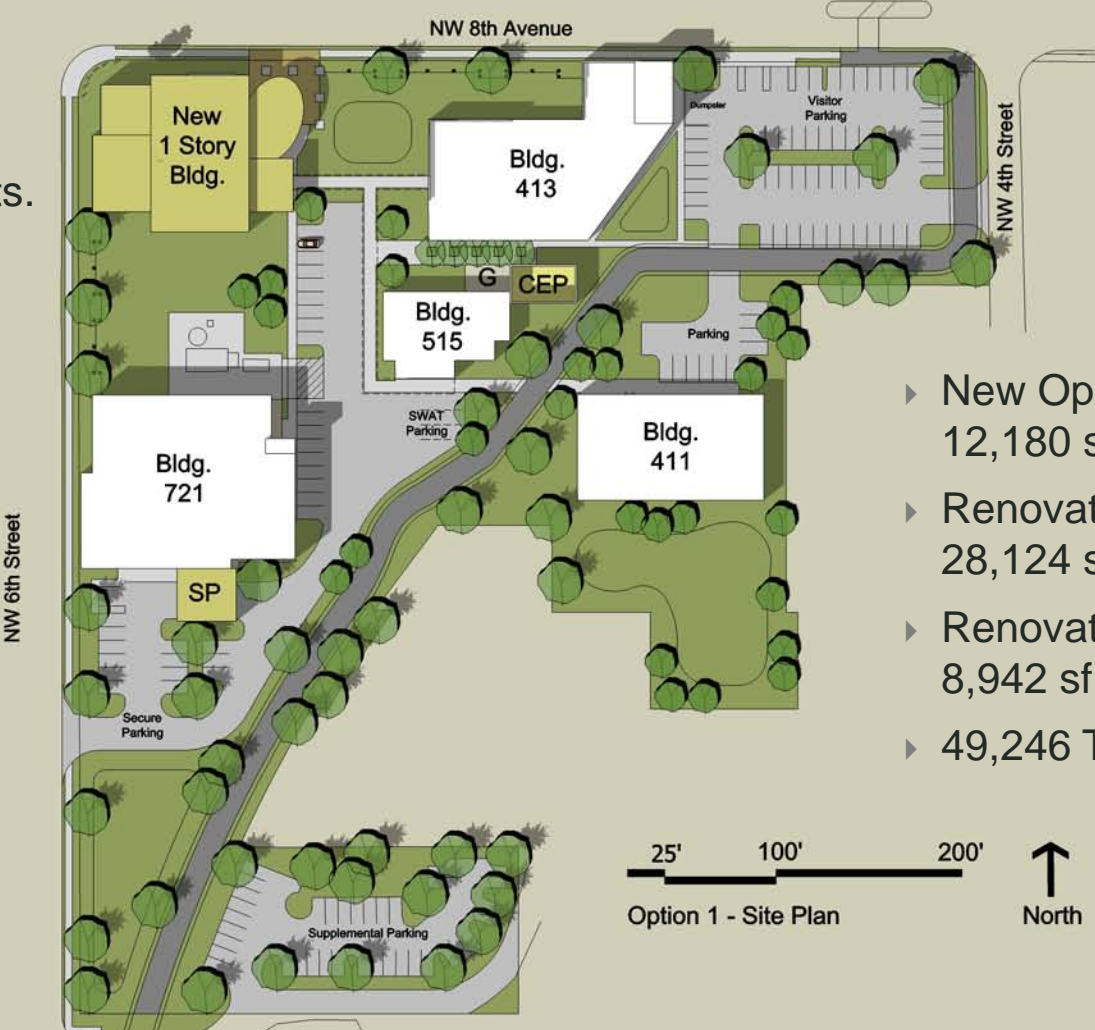

- ▶ Meets Trad. City Rqmts.
- ▶ Parking Limitations
- ▶ Inefficient Ops.
- ▶ Compromised Work Environment
- ▶ Unforeseen Risks
- ▶ Budget: \$9,781,721

- ▶ New Ops. Addition 12,180 sf
- ▶ Renovate 721 Bldg. 28,124 sf
- ▶ Renovate Training (411) 8,942 sf
- ▶ 49,246 Total sf

25' 100' 200' 
Option 1 - Site Plan North

Option 1 | RENDERING



Option 1 | RENDERING



Option 2 | SITE LAYOUT

- ▶ Meets Trad. City Rqmts.
- ▶ Parking Limitations
- ▶ Efficient Cmd./Control
- ▶ New Construction
- ▶ Enhanced Security
- ▶ Budget: \$10,901,316



- ▶ New Ops. Building 40,304 sf
- ▶ Demo. 721 Bldg.
- ▶ Renovate Training (411) 8,942 sf
- ▶ 49,246 Total sf

25' 100' 200' North
Option 2 - Site Plan

Option 2A | SITE LAYOUT

- ▶ Meets Trad. City Rqmts.
- ▶ Optimal Parking
- ▶ Efficient Cmd./Control
- ▶ New Construction
- ▶ Enhanced Security
- ▶ Budget: \$10,547,592



- ▶ New Ops. Addition 46,246 sf
- ▶ Demo. 721 Bldg.
- ▶ New Training

Option 2A - Site Plan

Option 2 | RENDERING



Option 2 | RENDERING



Option 2 | RENDERING



OPTIONS ANALYSIS SUMMARY

Option 1



- ▶ New Ops. Addition
- ▶ Renovate 721 Bldg.
- ▶ Renovate Training (411)

Option 2



- ▶ New Ops. Building
- ▶ Demo. 721 Bldg.
- ▶ Renovate Training (411)

Option 2A



- ▶ New Ops. Building
- ▶ Demo. 721 Bldg.
- ▶ New Training

- ▶ Meets Trad. City Rqmts.
- ▶ Parking Limitations
- ▶ Inefficient Ops.
- ▶ Compromised Work Env.
- ▶ Unforeseen Risks
- ▶ Budget: \$9,781,721

- ▶ Meets Trad. City Rqmts.
- ▶ Parking Limitations
- ▶ Efficient Cmd./Control
- ▶ New Construction
- ▶ Enhanced Security
- ▶ Budget: \$10,901,316

- ▶ Meets Trad. City Rqmts.
- ▶ Optimal Parking
- ▶ Efficient Cmd./Control
- ▶ New Construction
- ▶ Enhanced Security
- ▶ Budget: \$10,547,592

- ▶ Feb. 16, 2012 – City Commission Meeting
- ▶ Mar. 1, 2012 – Contract Signing & Notice to Proceed
- ▶ 8 Month Design & Approval Phase (March → October)
- ▶ 6 Month Permit Phase (June → November)
- ▶ November 2012 – Guaranteed Maximum Price
- ▶ Dec. 2012 – Commence Construction
- ▶ 12 Month Construction Phase (Dec. 2012 → Dec. 2013)

**Dates are approximate... As the schedule evolves the team will analyze options to fast-track process*



Agenda

UW Mills Gilbane **HARVARD • JOLLY**
DESIGN / BUILD TEAM

Introduction

Project Team

Design Options

Questions & Answers