

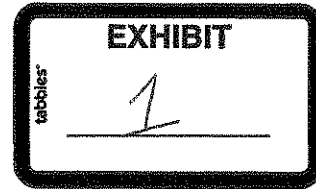

100243A  
City of Gainesville  
Text File



Introduced: 4/15/2010

File Number: 090911.

Version: 0

Status: Passed

..Title

Vacate a Portion of Southwest 2nd Place (B)

This item is a request for the City Commission to approve a petition to the Planning and Development Services Department to vacate a portion of Southwest 2nd Place at the request of the Public Works Department.

..Explanation

Additional right-of-way is needed as part of the Southwest 6th Street and Southwest 2nd Avenue traffic roundabout. Approximately 1,400 square feet is needed on the southwest corner of this intersection. The property needed is a portion of Tax Parcel 13327-000-000, owned by Shands Teaching Hospital & Clinics, Inc. (Shands). As a portion of its redevelopment adjacent to Southwest 10th Street, Shands has requested public interest in a segment of Southwest 2nd Place be vacated in exchange for the deed of the portion of its property needed for this project. The portion of Southwest 2nd Place is approximately 20 feet wide by 157.2 feet deep. It runs easterly from Southwest 10th Street along the south side of Lots 6, 7, and 8, Block 7, University Place, Plat Book "A", page 77 and terminates at a portion of Southwest 2nd Place which was vacated in 1972 by Ordinance No.1792.

..Fiscal Note

The fiscal impact is associated with the alternative recommendation below in the amount of \$41,120 should the City decide to purchase the required 1,400 square feet of Shands property needed for the traffic roundabout.

..Recommendation

The City Commission authorize staff to initiate a petition to vacate a portion of Southwest 2nd Place, running easterly from Southeast 10th Street, along the south side of Lots 6, 7, and 8, Block 7, University Place, Plat Boot A, page 77 for approximately 157.2 feet.

Alternative Recommendation: City Commission deny this request and Public Works purchases the required 1,400 square feet of Shands property needed for the traffic roundabout for \$41,120.

100243A

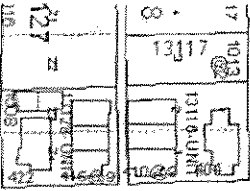

SW 10TH STREET

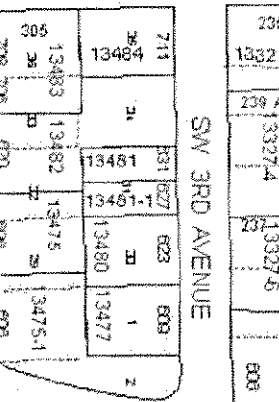
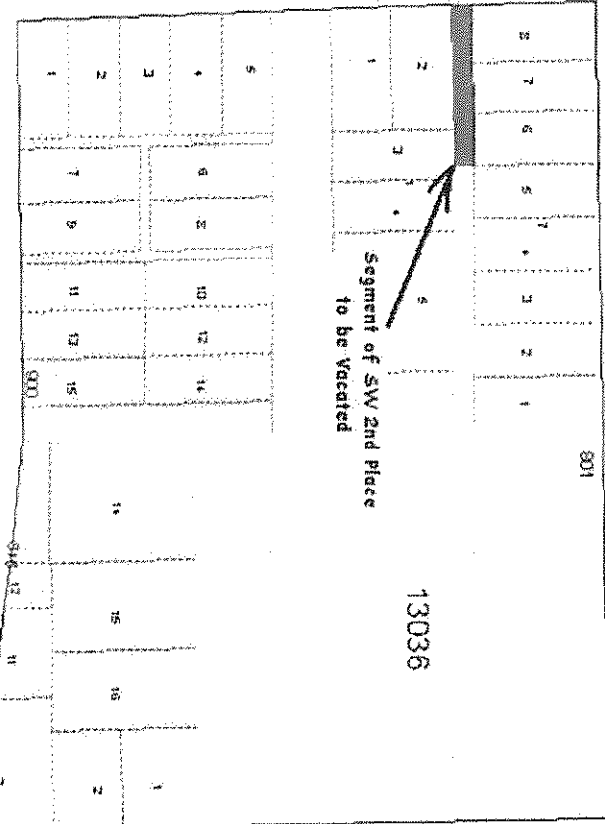
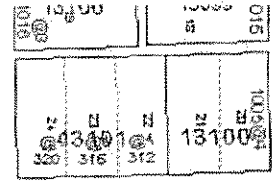
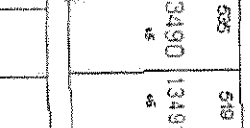
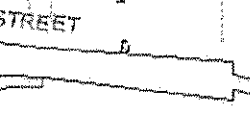
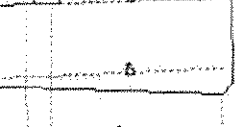
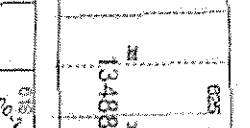
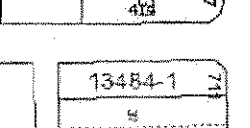
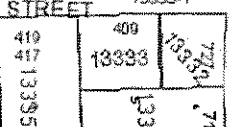
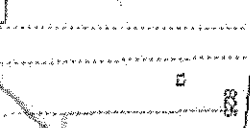
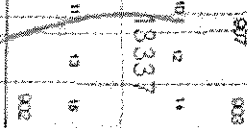
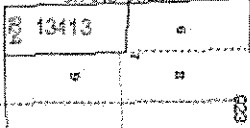
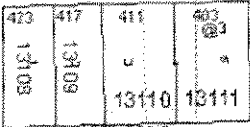

SW 3RD AVENUE

Right of way to be Decided to the City

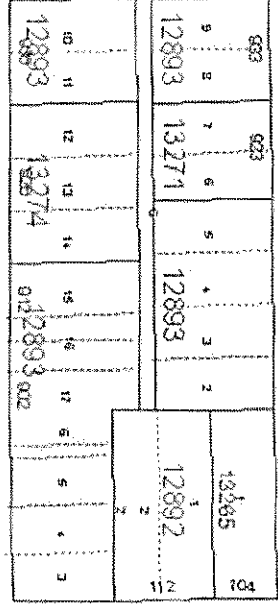
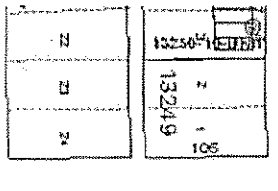

SW 8TH STREET

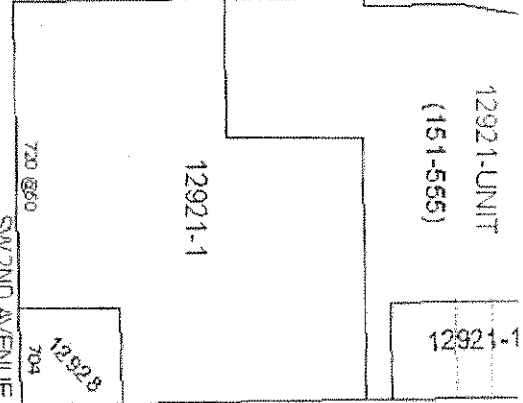

SW 2ND AVENUE

SW 7TH STREET

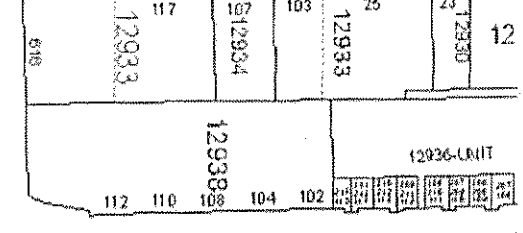

SW 6TH STREET

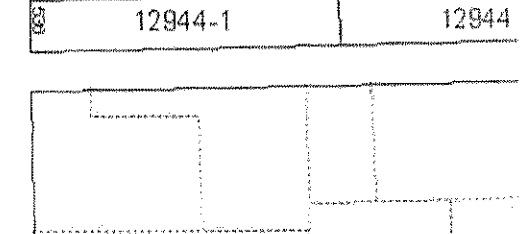

Closed Ord 060414

100243A

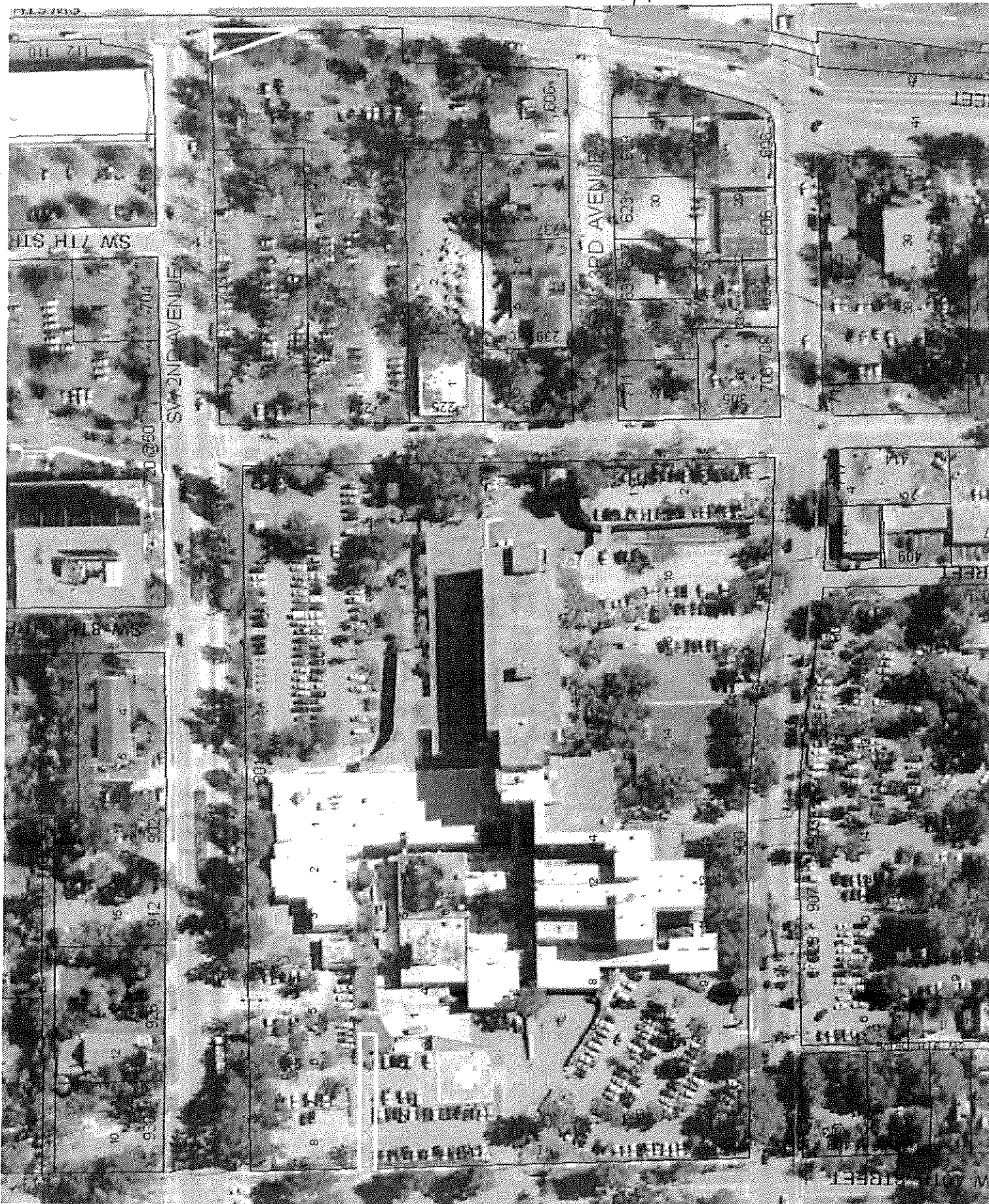

SW 17th Street  
SW 18th Street  
SW 19th Street  
SW 20th Street  
SW 21st Street  
SW 22nd Street  
SW 23rd Street  
SW 24th Street  
SW 25th Street  
SW 26th Street  
SW 27th Street  
SW 28th Street  
SW 29th Street  
SW 30th Street  
SW 31st Street  
SW 32nd Street  
SW 33rd Street  
SW 34th Street  
SW 35th Street  
SW 36th Street  
SW 37th Street  
SW 38th Street  
SW 39th Street  
SW 40th Street  
SW 41st Street  
SW 42nd Street  
SW 43rd Street  
SW 44th Street  
SW 45th Street  
SW 46th Street  
SW 47th Street  
SW 48th Street  
SW 49th Street  
SW 50th Street

SW 2nd Avenue  
SW 3rd Avenue  
SW 4th Avenue  
SW 5th Avenue  
SW 6th Avenue  
SW 7th Avenue  
SW 8th Avenue  
SW 9th Avenue  
SW 10th Avenue  
SW 11th Avenue  
SW 12th Avenue  
SW 13th Avenue  
SW 14th Avenue  
SW 15th Avenue  
SW 16th Avenue  
SW 17th Avenue  
SW 18th Avenue  
SW 19th Avenue  
SW 20th Avenue  
SW 21st Avenue  
SW 22nd Avenue  
SW 23rd Avenue  
SW 24th Avenue  
SW 25th Avenue  
SW 26th Avenue  
SW 27th Avenue  
SW 28th Avenue  
SW 29th Avenue  
SW 30th Avenue  
SW 31st Avenue  
SW 32nd Avenue  
SW 33rd Avenue  
SW 34th Avenue  
SW 35th Avenue  
SW 36th Avenue  
SW 37th Avenue  
SW 38th Avenue  
SW 39th Avenue  
SW 40th Avenue  
SW 41st Avenue  
SW 42nd Avenue  
SW 43rd Avenue  
SW 44th Avenue  
SW 45th Avenue  
SW 46th Avenue  
SW 47th Avenue  
SW 48th Avenue  
SW 49th Avenue  
SW 50th Avenue

SW 1st Street  
SW 2nd Street  
SW 3rd Street  
SW 4th Street  
SW 5th Street  
SW 6th Street  
SW 7th Street  
SW 8th Street  
SW 9th Street  
SW 10th Street  
SW 11th Street  
SW 12th Street  
SW 13th Street  
SW 14th Street  
SW 15th Street  
SW 16th Street  
SW 17th Street  
SW 18th Street  
SW 19th Street  
SW 20th Street  
SW 21st Street  
SW 22nd Street  
SW 23rd Street  
SW 24th Street  
SW 25th Street  
SW 26th Street  
SW 27th Street  
SW 28th Street  
SW 29th Street  
SW 30th Street  
SW 31st Street  
SW 32nd Street  
SW 33rd Street  
SW 34th Street  
SW 35th Street  
SW 36th Street  
SW 37th Street  
SW 38th Street  
SW 39th Street  
SW 40th Street  
SW 41st Street  
SW 42nd Street  
SW 43rd Street  
SW 44th Street  
SW 45th Street  
SW 46th Street  
SW 47th Street  
SW 48th Street  
SW 49th Street  
SW 50th Street