

PUBLIC WORKS
12/01

CEDAR GROVE - DUVAL HEIGHTS

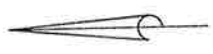

CEDAR GROVE - DUVAL HEIGHTS

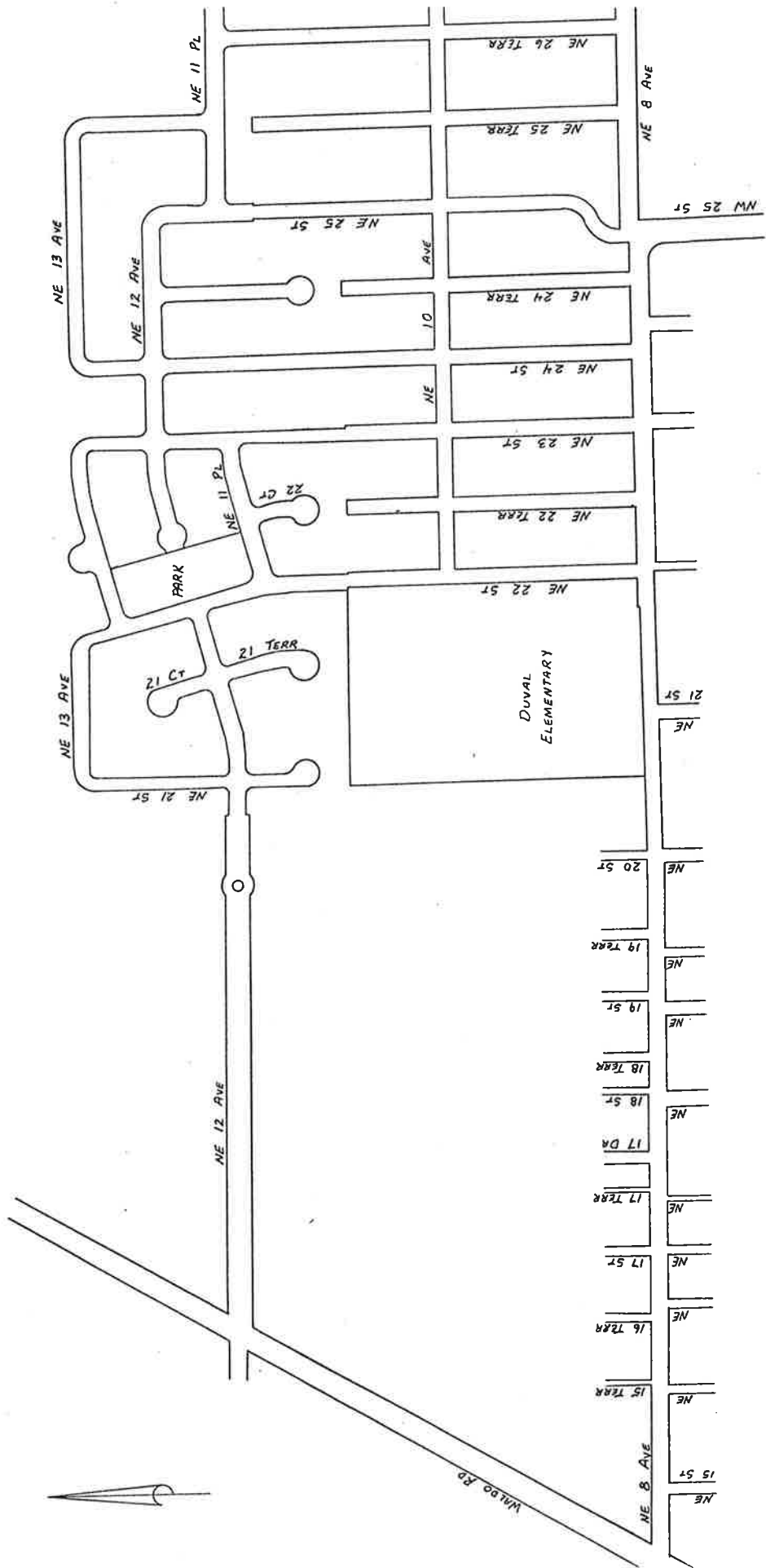
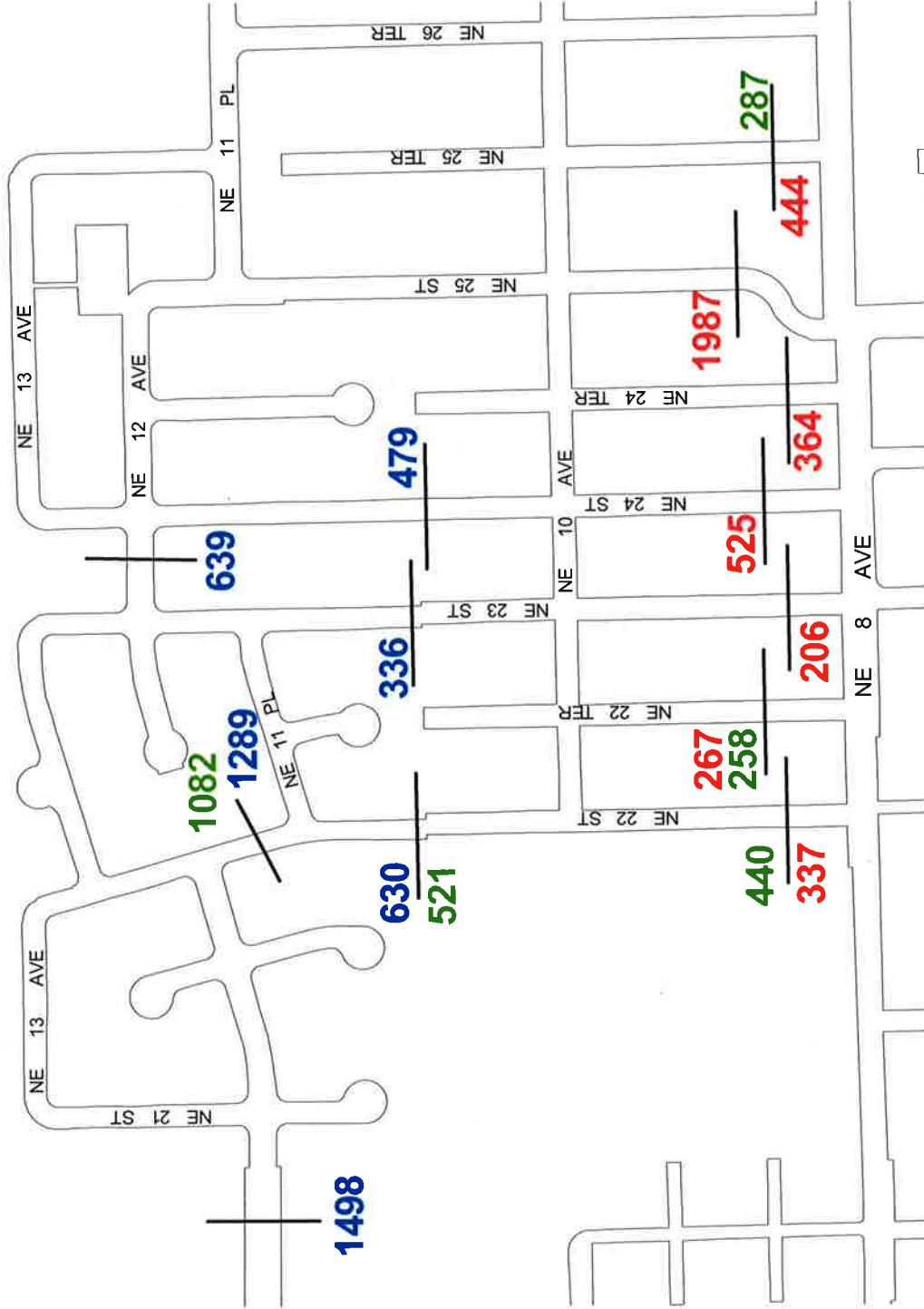

TRAFFIC COUNTS

Before Cedar Grove II

**After Cedar Grove II
(July, 2000)**

December, 2001 Counts

Counts are 24 hour ADT



N.T.S

CITY OF GAINESVILLE
PUBLIC WORKS DEPARTMENT
FEBRUARY, 2002

Recommendation CEDAR GROVE ROADS

Street closed to vehicular traffic.
Open to bike & pedestrian traffic only.

