

Depot Park

Gainesville, Florida



Technical Standards

February 2010

Prepared for:

The Gainesville Community
Redevelopment Agency
Gainesville, Florida

Prepared by:

Carol R. Johnson Associates, Inc.
Landscape Architects

Depot Park

Gainesville, Florida

Technical Standards

February 2010

Prepared for:

The Gainesville CRA on behalf of the
City of Gainesville, Florida

Prepared by:

Carol R. Johnson Associates, Inc.
Landscape Architects

Volkert & Associates
Engineers

Depot Park: Technical Standards

Introduction	1	Section 4: Site Furnishings	31
Depot Park Mission Statement	3	A. Benches	
Section 1: Design Approach	5	B. Picnic Tables	
A. Park Entrances		C. Bike Racks	
B. Promenade		D. Fencing	
C. Multi-Use Trail		E. Tree Grates	
D. Children's Play Areas		F. Bollards	
E. Historic Depot Context Area		G. Receptacles	
Section 2: Park Elements	11	H. Drinking Fountain	
A. Gateway Structures		Section 5: Lighting and Electrical	39
B. Signage		A. Promenade Lighting	
C. Monuments and Memorials		B. Site Lighting for Walkways, Trails, and Parking Areas	
D. Bike Memorial		C. Boardwalk Lighting	
E. Art Installations		D. Historic Depot Context Area and Tertiary Walkway Lighting	
F. Play Elements for Depot Play Area		E. Gateway Accent Lighting	
G. Play Elements for Natural Play Area		F. Security Phones	
H. Pavilion		G. Power Supply	
I. Picnic Shelters		H. Miscellaneous Utilities, WIFI	
J. Steel Truss Bridge		Section 6: Landscape	47
Section 3: Pavement	23	A. Plant Materials	
A. Special Pavement		B. Raised Plant Beds	
B. Primary and Secondary Walkways		Section 7: Energy Conservation and Sustainable Design Recommendations	51
C. Tertiary Walkways		Section 8: Dog Friendly Recommendations	53
D. Boardwalks		Summary Table	55
E. Play Surfacing			
F. Multi-Use Trail Pavement			
G. Parking Areas			

Introduction

The purpose of the Technical Standards is to establish specific standards that would be applied for all landscape elements within Depot Park. It is anticipated that Depot Park will be built in various phases over time. Thus, the Gainesville Community Redevelopment Agency (CRA) could distribute the Technical Standards to their design consultants or to other City agencies, such as the Department of Public Works (PWD) and the Parks Department to preserve cohesion and uniformity within the Park.

The Technical Standards document is broken down into sections:

- Section 1: Design Approach - sets the design tone for major aspects of the park
- Sections 2-8: Landscape Elements - provides technical standards for individual park elements

Within sections 2-8, each landscape element contains the following:

- Design concept narrative text
- Location criteria (if applicable)
- Specifications identifying materials, colors, finishes, manufacturers, models, etc. for the element
- Installation information (if applicable)
- Representative image consisting of: construction detail, design detail, product manufacturer's photographic imagery (where applicable), and/or a precedent image of the same standard from another project.

Accompanying these sections will be the following:

- Summary Table: A spread sheet containing a list of all the park elements with their size, color, manufacturer, model, etc. indicated in an easy-to-use at-a-glance format.

For any future park landscape improvements initiative, the administering agency will provide these technical standards to their design consultants, who will incorporate these standards into their design. There are standards for paving, lighting, plant materials, site furniture, bridges, picnic shelters, pavilions, public art, monuments, and memorials.

The Technical Standards are intended to complement the Depot Park Master Plan. Any parties using the Technical Standards should also reference the Depot Park Master Plan Report prepared by Carol R. Johnson Associates, Inc (CRJA) for the CRA, to understand the larger design approach for Depot Park and the context for the Technical Standards.

The CRA does not encourage any deviation from the Technical Standards. However, if there are justifiable reasons, the CRA will review variance requests to deviate from the standards on a case-by-case basis. Any approved deviations should continue to adhere to the intent of the Design Approach and the design concept narrative text.

Depot Park Mission Statement

(To Be Provided by CRA)

1. Design Approach

A. Park Entrances

The five entrances to Depot Park shall provide a unified, welcoming portal for the park visitor that is suggestive of the character of the park within. Given the prominence of the entrances at the intersection of Depot Ave and S Main Street (hereafter referred to as the northwest entrance) and at the intersection of Depot Ave and SE 4th Street (hereafter referred to as the northeast entrance), these two portals shall serve as the major entrances to the park and shall receive a much more substantial treatment to announce the park to passersby. The remaining three park entrances, while being reduced in scale, shall share elements of the major entrances to provide a unified initial impression to the park visitor.

All of the entrances share elements abstractly referencing nature, such as limestone seatwalls and “larger than life” steel grass blades that are suggestive of Florida’s once ubiquitous wiregrass, *Aristida spicata*. The major entrances add an abstract reference to the park’s cultural rail heritage with a wavy pair of steel rails framing a swath of stainless steel fabric. The steel grass blades penetrate the rails in a way that happens when nature overcomes abandoned rail beds. The gateways set the tone that the park is about natural systems, and the grass blade motif is repeated in other elements within the park. (See 2A, Gateway Structures)

All entrances respond to the available space as defined by the public way. Note that for the northwest entrance, the entrance design shall be coordinated with the planned roundabout at Main Street and Depot Ave. All of the park entrances shall accommodate required emergency and service access as well as multiple pedestrian ways into the park. From the northwest entrance, the visitor can proceed toward the Cade Museum on the western edge of the park or directly into the center of the park. The northeast entrance shall serve to welcome pedestrian visitors to the Historic Depot area and the greater park as well as to welcome bicyclists to the portion of the Depot Ave Rail Trail passing through the park. The multiple pathways shall

be incorporated into one entry statement that expresses the comprehensiveness of the park.

The two major entrances shall be spacious, dynamic spaces that establish the character of the park improvements beyond, attract the eye and the visitor, provide park information of an interpretive, wayfinding, and regulatory nature and allow for informal gathering (See 2B, Signage). Lighting of the spaces shall provide for pedestrian safety as well as increasing the visual impact of the entry. (See 5E, Gateway Accent Lighting)

The park entrance from the parking area shall be smaller in scale than the major entrances, given its location off the public way. Due to the proximity of the parking area and the Promenade at this point, it will be important that this entrance share those place-making vertical and overhead elements of the major entrances that can serve to provide a separation of the vehicular and pedestrian scaled spaces. Given that the entrance shall serve as a primary portal to the park for visitors arriving by car, it shall also include the park information provided at the major entrances.

The two remaining entrances on the south and western edges of the park shall be announced with minor gateways, as appropriate to the available space for each of the entries. Regulations shall not be incorporated into the entrance, but shall be provided along the pathway just beyond the portal. (See 2A, Gateway Structures) Wayfinding signage shall be placed further into the park at a major decision point along the pathway. (See 2B, Signage)

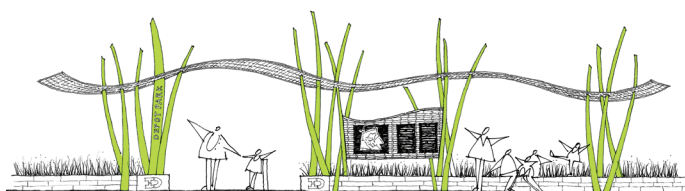

B. Promenade

The Promenade along the northern edge of the Phase II Pond shall be the major organizing space for the northern half of the park, weaving together all four of the northernmost park entrances. The eastern end of the Promenade links directly to the parking area for the park, rendering the Promenade and the heart of the park very accessible to all park users.

The Promenade shall also be the major paved gathering space for the park – its 24' width at the water's edge provides an exciting space for festivals and other city gatherings. Along its length, five overlooks expand the 24' width of the promenade providing informal stages for larger gatherings. The adjacent mown lawn areas and future amphitheater will accommodate the largest gatherings of people at an event.

During regular daily use, the breadth of the Promenade is rendered more intimate through the subdivision of the pavement with a concrete paved central portion that undulates between paved edge bands of exposed aggregate pavement, abstractly referencing the sandy shoals of a bay, pond, or river. (See 3A, Special Pavement) Site furnishings trash/recycling receptacles, benches, and light fixtures – are located within the outer band, (See Section 4, Site Furnishings) with occasional groupings of trees located within the band along the water's edge to provide pockets of shade along the Promenade.

While the benches at the back edge of the Promenade offer direct views to the water and the park beyond, seating

immediately at the water's edge is provided at the overlooks. At each of the five overlooks, the raised limestone curb edge that defines the juncture between the Promenade and the pond is raised to seat height to define the edge of the overlook and provide informal seating. The use of the overlooks for informal gathering or as small stages for larger gatherings shall be accommodated by maintaining the spaces as simple paved open spaces. The flexibility of the spaces shall not be compromised by the addition of sculptural or memorial elements to the spaces.

For the three major semicircular overlooks – the Promenade paving palette shall be used to create a pattern that reinforces these three areas as a destination within the park. The remaining two overlooks shall be treated as an extension of the paving banding that follows the length of the Promenade. (See 3A, Special Pavement)

Illumination of the Promenade shall be accomplished through the signature light fixtures that help to define the back edge of the Promenade. The arc of the light poles abstractly references grass blades. Additional lighting shall be provided in the face of the raised curb at the pond's edge and at the overlooks to articulate the edge of the Promenade. (See 5A, Promenade Lighting) Electrical service for the use of vendors and performers during festivals and other city gatherings shall be provided at regular intervals along the Promenade within the curb at the pond's edge and within the seatwalls at the overlooks. (See 5G, Power Supply)



C. Multi-Use Trail

For brevity, the Depot Park Trail and Depot Avenue Rail Trail within Depot Park, which are contiguous within Depot Park and which will be treated with the same Technical Standards, shall be referred to herein as the Multi-use Trail.

The portion of the Multi-use Trail within Depot Park shall maintain the dimensions, surface materials, and special logos that will identify the paved way as part of the City-wide and regional multi-use trail system. However, given that the trail is within a public park, distinctive treatments of the trail will communicate to bicyclists that the trail is within a space that is designed for the enjoyment of all users.

The logo designed for the trail shall be placed at key points along the trail identifying it as a part of the Rails-to-Trails system, but the logo shall be mounted on stylized grass blade posts to coordinate with other park signage. The posts shall be held three feet from the edge of the trail. (See 2B, Signage)

The numerous intersections of the Multi-use Trail with pedestrian walkways within the park shall be articulated in a manner that interrupts the trail while giving the pedestrian an uninterrupted paved way. In addition, textured banding shall be located within the trail in advance of the intersections to alert bicyclists of the approaching confluence of pedestrians and bikes. (See 3F, Multi-use Trail Pavement)

The trail shall conform to all standards for a shared trail within the AASHTO Guide for the Development of Bicycle Facilities. The minimum design speed, as set by the AASHTO Guide, shall be 20 mph. Sight distances and stopping distances shall be based on that design speed. A 2' clear zone shall be provided on each side of the trail. For those areas where the trail is adjacent to a sloped area that drains toward the trail, a swale shall be provided on the uphill side of the trail to intercept the drainage. The trail shall also conform to all requirements of the funding grant – with the provision of parking, lighting, restroom facilities, and picnic facilities for the enjoyment of the trail.



D. Children's Play Areas

The youngest users of Depot Park shall be accommodated in two dedicated areas, the Depot Play Area and the Natural Play Area. The unique setting of the two play areas – next to the Historic Depot, the northeast gateway, and the Children's Garden for the Depot Play Area and for the Natural Play Area, within the natural landscape of the southern half of the park – shall be reflected in the design of the play area to enhance the visual landscape of the park.

Both of the play areas shall be designed to create an exciting space that challenges and engages children of all abilities and interests by applying the principles of Boundless Playgrounds. The areas shall provide for a diversity of play activities – physical, imaginative, and creative and maximize the incorporation of manipulative elements. They shall foster interaction among children, but also provide for individual play as well as large group and small group play.

Within the Depot Play Area, the design of the play surfacing and the larger play elements of the park shall be compatible

with the general site furnishings for the park established by the nearby gateway, with other smaller elements suggestive of the adjacent Children's Garden. (See 2F, Play Elements for Depot Play Area)

Given its proximity to vehicular traffic, the Depot Play Area shall be entirely fenced and a single entry gate provided, making the area especially appealing to families with young children. (See 4D, Fencing) The perimeter of the Natural Play Area will not be fenced, but will blend into the park landscape. Play equipment provided in this area shall be for the enjoyment of older children.

The play elements for the Natural Play Area shall be a combination of natural elements, such as landforms, rockscapes, and plantings, with simple play equipment, such as swings and ziplines, or track rides, that comfortably integrate into the natural landscape as well as the general site furnishings for the park. (See 2G, Play Elements for Natural Play Area)



Boulder Slide



Natural Play Element

E. Historic Depot Context Area

The landscape surrounding the Historic Depot shall recall the building's historic industrial setting and meet the needs of its future urbane and natural setting. The materials used within the context area shall be reflective and respectful of the uniqueness of the Depot and of its contribution to the park's significance. It is critical, however, that the landscape within the context area shall also blend with the character of the park as a whole.

Depot Plaza, which serves as the entrance to the park from the context area, shall be comprised of site elements and furnishings that have been selected to create a unique character for Depot Park. The pavement for the plaza shall be the exposed aggregate pavement used along the Promenade and at the major park entrances. (See 3A, Special Pavement) The seating within the plaza shall be provided through native limestone seatwalls that shall match those at the park's gateway structures. (See 2A, Gateway Structures) Incorporated into the seatwalls shall be two GFC-protected

power sources. Several additional power sources shall be distributed across the building façade to enable the area to accommodate a variety of uses.

The walkways to the plaza from the east and the west that parallel the tracks, shall be illuminated with the light bollard selected for Depot Park. The bollard is appropriate to both this dense allee of trees as well as the natural area on the south side of the park, where a lower height of lighting is desired, and gives a distinctive character to both. (See 5D, Historic Depot Context Area and Tertiary Walkway Lighting)

Planting within the Historic Depot Context Area shall be native species appropriate to both the historic industrial context of the Depot and the natural context of the park in general.

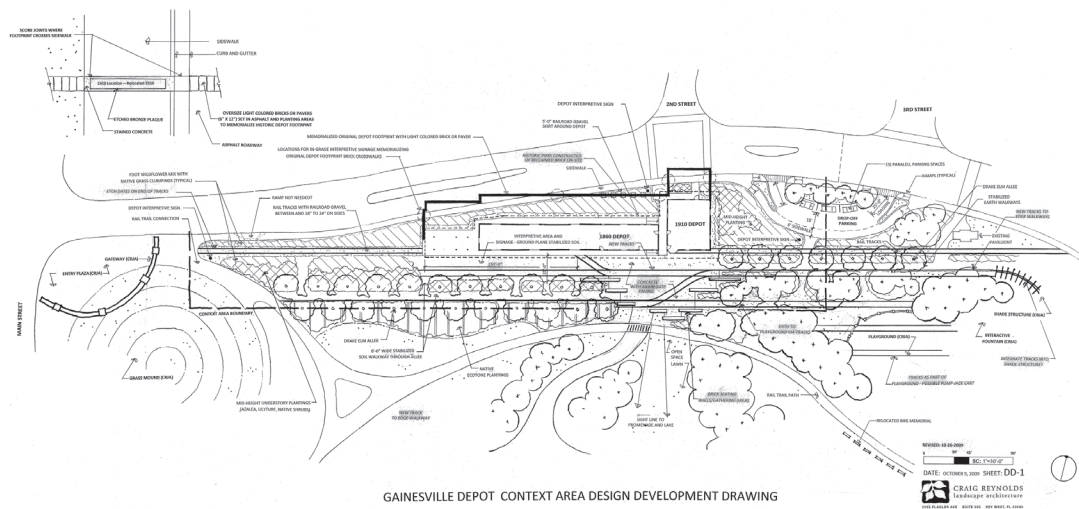

Historic Depot Context Area Designed by Bender & Associates and Craig Reynolds Landscape Architect

2. Park Elements

A. Gateway Structures

The gateways celebrate both the industrial past of Depot Park and its natural future, and shall establish a design vocabulary that will extend throughout the entire park. Major gateway structures shall be used at the northwest and northeast entrances. A smaller, modified gateway structure shall be located at the parking entrance. Minor gateway structures shall be used at the southern park entrances on S Main Street and on SE 10th Avenue.

The gateway structures shall be constructed of round tubular steel for vertical “grass blades” rising from behind and in front of a low, curved native limestone wall that defines the gateway area and provides informal seating. At the major entrances and the parking entrance, the verticals shall support an overhead structure of stainless steel fabric mesh within a stainless steel frame that arcs and curves both vertically and horizontally. The design and the openness of the fabric shall create a semi transparent portal for the entries as well as a separate vertical face for the mounting of wayfinding, interpretive, and regulatory signage. (See 2B, Signage)

The curving limestone seatwalls shall be 18 to 20” in height and 20” wide. The walls shall be constructed of three courses of limestone blocks that vary in height from 5” to 8” and in length from 18” to 36”, and span the full depth of the wall. All exposed faces of the stone shall have a smooth finish, and all edges shall be eased $\frac{1}{4}$ ". All wall sections shall terminate in a full-height piece of limestone on the vertical face of which the Depot Park logo can be engraved. Where the entrance area creates two or more wall sections, one vertical face of the terminal blocks can become a location for the acknowledgement of the funding source for the park entrance.

The vertical grass blades are suggestive of wiregrass, *Aristida spicata*, a grass that is native and once ubiquitous to Florida. Interpretation of this significant design motif can be interpreted on the panels incorporated into the entry signage. One of the vertical blades shall be a half circle in section allowing “Depot Park” to be incorporated into the flat surface. All vertical supports shall receive a powdercoat finish. Color for the vertical supports shall be a light green that shall be used throughout the park for all sign supports.

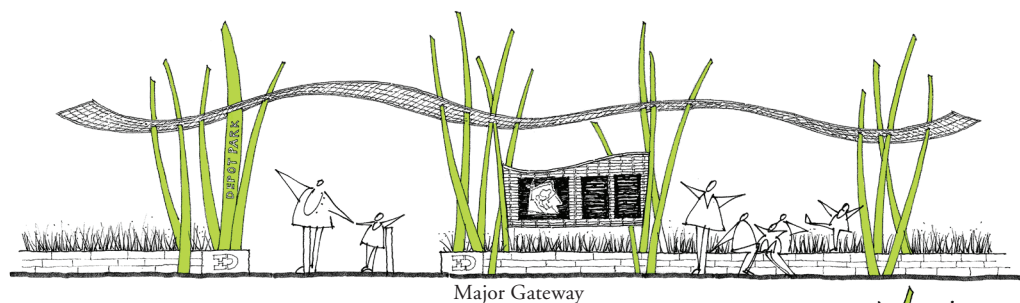

Major Gateway

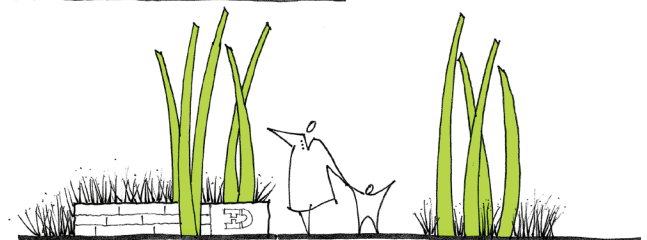

Minor Gateway

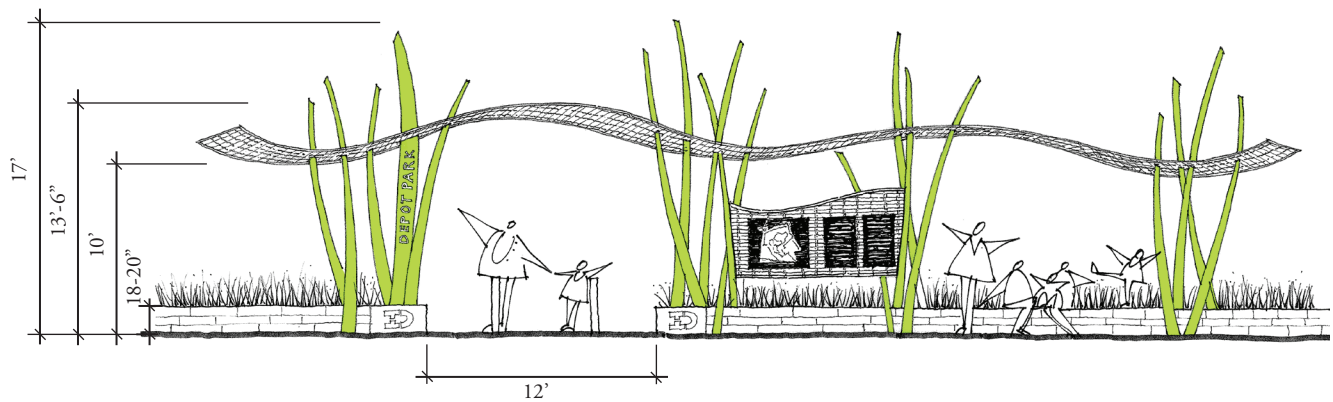

Major Gateway

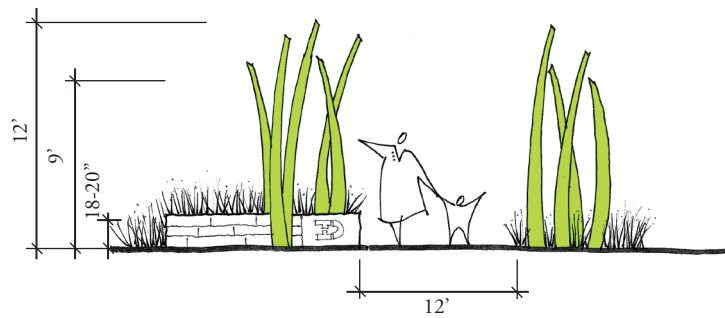

Minor Gateway

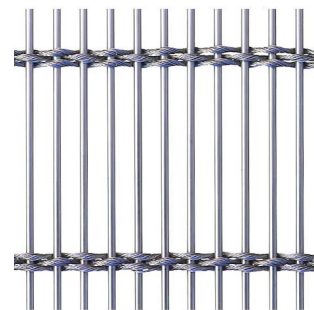

Stainless Steel Fabric for Overhead Structure and Sign Background for Major Gateway

B. Signage

Depot Park shall feature a family of signs that reinforces the unique character of the park. Anchored by replicas of oversized blades of *Aristida spicata*, the once ubiquitous Florida wiregrass, the signs will extend the character of the park entrances into the park and be playful, cheerful elements within the landscape. The light green color of these tall blades will enable park goers to quickly locate entryways, key maps, and interpretive and informational signage.

The largest sign shall be incorporated into the major gateway structures, at other key intersections, and at major facilities such as the Outdoor Classroom/Picnic Pavilion, the Aviary, and the rental kiosk. These informational signs shall include a wayfinding map and interpretive and regulatory information. At the minor entrances to the park, only the double-posted regulatory sign shall be located in conjunction with the entry, and then at a minimum of 25' further into the park on the right edge of the walkway facing the arriving park visitor.

Throughout the park, where directional or interpretive information needs to be conveyed, a single-posted sign

shall be installed to provide minimal intrusion into the landscape. Along the Multi-use Trail, the official Rails-to-Trails logo shall be mounted on the same arching grass blade post reinforcing the public park setting for this portion of the trail. The sign shall be mounted 3' from the trail edge with the bottom of the sign at 7'. (See 3F, Multi-use Trail Pavement)

The smallest signs needed within the park, those that convey information regarding parking and access, shall be conventionally mounted on standard tubular steel posts with a welded plate to seal the end of the post. Their integration into the family of park signs shall be reinforced with the same light green color on the posts. They shall be mounted to meet all applicable codes.

Within the breezeway of the historic depot, a bulletin board will be mounted to an exterior building wall. The bulletin board shall be an enclosed, lockable, two-door aluminum cabinet. The color of the frame and the pinning surface shall be selected to blend with the paint color selected for the building.

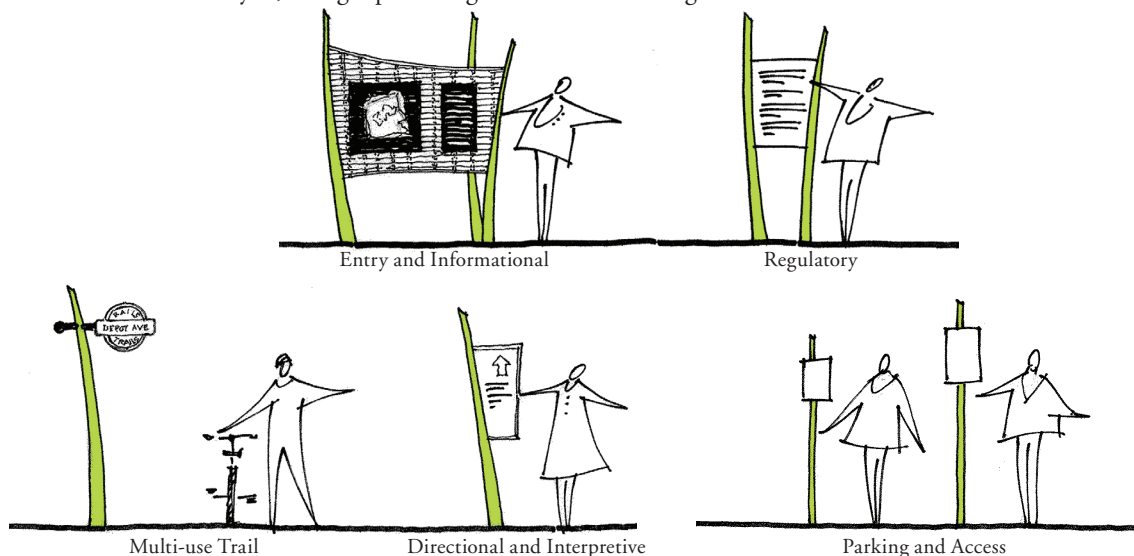

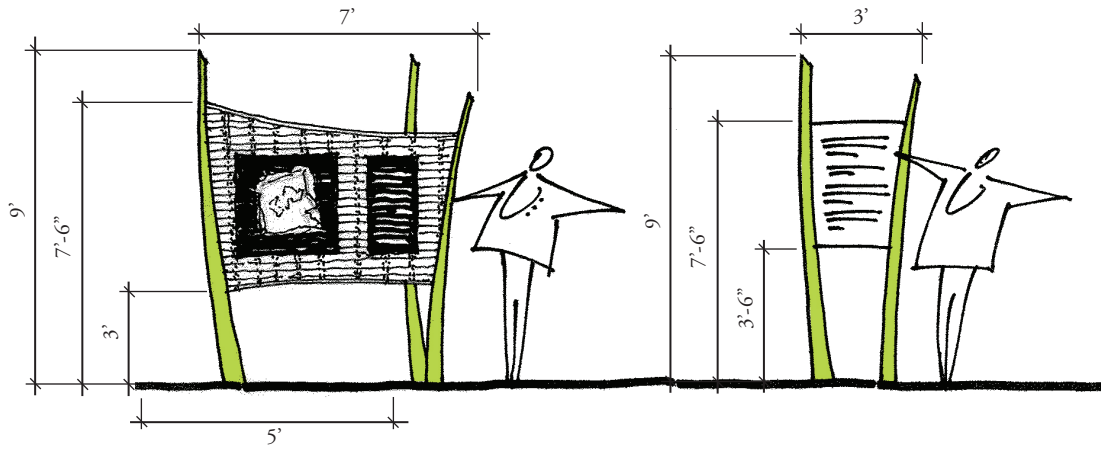

Entry and Informational

Regulatory

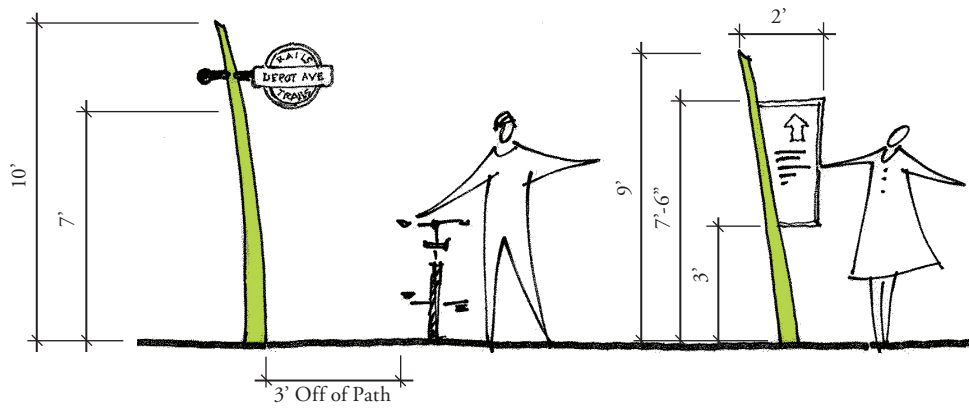

Multi-use Trail

Directional and Interpretive

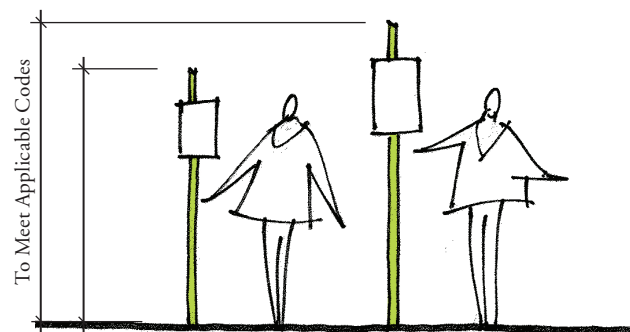

Parking and Access

C. Monuments and Memorials

The incorporation of monuments and memorials into a cultural landscape such as Depot Park requires thoughtful planning to ensure that the integrity of the landscape is not compromised. Chapter 5.5 of the Gainesville Code of Ordinances provides for the review of all art installations by the Art in Public Places Trust. A similar policy and protocol for the addressing of requests for the addition of monuments to events and memorials to individuals must be in place before any requests shall be considered. The recommended protocol includes the establishment of a policy and a consistent application of that policy through the formation of a Monuments and Memorials Review Commission comprised of members that provide expertise in landscape architecture, design, history, park maintenance, and public policy.

Basic to the policy shall be the identification of the park as a public natural landscape for the enjoyment of the broadest spectrum of users. Also critical is an understanding of the carrying capacity of the proposed landscape with regard to memorials and monuments, both for the sake of the park user as well as the integrity of the existing monuments and memorials. The relocated Bike Memorial at the northeast corner of the park, the interpretation of the Historic Depot, and the interpretation at the Cade Museum provide a richness to the northern half of the park that can be diluted with the addition of too many monuments; even with a small physical presence in the landscape, a monument or memorial may project a large psychological presence. The natural landscapes of the southern half of Depot Park are not appropriate for the erection of monuments and memorials.

Within the northern half of the park, monuments and memorials shall not be placed within spaces that have been

designed for flexibility of use, such as Depot Plaza, the Promenade, and the overlooks. Monuments and memorials shall be sited to minimize the visibility from one monument to the next and reduce their visibility from within the park using planting to blend the installation with the adjacent park landscape. Siting a monument within an open lawn area is not recommended. The maximum height for a monument or memorial shall be 36". Monuments and memorials sited adjacent to park pathways shall be set back a minimum of 2' from the paved way to allow spectators to view the monument/memorial without impeding the use of the pathway.

While the donation of trees to the memory of individuals benefits the tree collection of the park, the accompanying documentation of the donation must be handled in a manner that does not create problems for park maintenance or interrupt the ground plane of open lawn areas. One of two alternatives to the traditional installation of a marker at the foot of the tree is recommended – either all donations are noted in a register or dedication board within the Depot building that commemorates all of the gifts to the landscape, or the tree donation must be accompanied by the donation of a bench for the mounting of a small commemorative plaque.

The location and species of the donated tree shall conform to the plan for the park and shall be selected by a knowledgeable person. In addition, the policy for the donation of trees shall be written to ensure that the memorial gift is adequate to cover the cost of the selection, purchase, installation, and memorialization, and to ensure an understanding of the protocol regarding the death of donated trees.

D. Bike Memorial

With the development of the Historic Depot Context Area, the Multi-use Trail and the Bike Memorial shall be relocated southward.

The existing orientation of the five stones along the Multi-use Trail shall be maintained – they shall remain north facing and the sequence and spacing shall be retained.

The stones shall be set 8' from the edge of the trail to allow for the safe viewing of the memorial. They shall be set within one field of stabilized aggregate that extends

4' to the south of all of the stones and 4' to the west of the far western stone, and 4' beyond the new interpretive sign placed to the east of the memorial. The sign shall be separated from the eastern stone by a distance of 1 ½ times the dimension between the stones.

The new interpretive sign shall be in keeping with the family of signs designed for Depot Park. Due to the quantity of information on the existing memorial sign, the new sign may be the double-posted sign for regulatory information rather than the single-posted sign intended for interpretation. (See 2B, Signage)



Existing Bike Memorial

E. Art Installations

The addition of art can enrich a community's experience of a landscape, but the additions shall be approached in a comprehensive manner to ensure that they enhance rather than interrupt or overwhelm the landscape.

The addition of art to the park, whether permanent or temporary, shall be undertaken through a consistent design review process that utilizes a standard protocol for the acceptance, placement, as well as the funding of the long-term maintenance of the artwork, and in the case of temporary installations, the restoration of the site following their removal. Additions shall also be undertaken with a sensitivity to the scale and character of each piece of art and the needs of its setting to determine if the artwork is an appropriate addition to the park.

Chapter 5.5 of the Gainesville Code of Ordinances provides for the review of all art installations by the Art in Public Places Trust. Members of the Trust, along with a

representative of the project's design team, shall be attuned to the carrying capacity of the landscape, recognizing that the addition of too many works of art not only dilute the effectiveness of the artwork but the landscape as well.

If art is to be created for the park, it shall be "of its setting," constructed of natural materials – wood, stone, glass, and metal – as well as durable, vandal-resistant and weather-resistant so as not to create problems for park maintenance. Sites for the elements shall be selected that do not require the manipulation of grades or the addition of plant materials, allowing the landscape to flow, interrupted only by the element itself. Within the natural areas of the park, artwork shall be limited to environmental art pieces that are easily integrated into the landscape.

The City shall consider leasing art for various locations within the park.

F. Play Elements for Depot Play Area

Play elements for the Depot Play Area shall be a combination of contemporary, free-form, boundless, structured, natural, and interactive element to provide for a diversity of play activities. The elements shall also be visually appealing for children, families, and general park users.

The Depot Play Area shall be completely fenced (See 4D, Fencing); thus the play elements within this play area shall appeal to a broad age range – including both the toddler through 5-year-old and the 5- to 12-year-old age groups. Structured play elements, such as climbing structures, slides, tunnels, and bridges, shall provide age-appropriate physical challenges for all ages. Other elements, both structured and natural, shall support creative, imaginative, and quiet play. A natural play area shall be incorporated into the play space. Manipulative elements and elements that promote

the changeability of the environment by its users shall be maximized.

The unique setting of the play area, adjacent to the historic Depot, can be celebrated with elements that are suggestive of trains without being proscriptive. Additional pieces within the Depot Play Area can incorporate the theme of growth and gardening to connect the play area to the Children's Garden and the greater restoration of Depot Park.

The play area shall meet all applicable local, state and federal codes for the safety of children. Code compliant surfacing shall be provided within all fall zones from raised play elements. (See 3E, Play Surfacing) All metal elements shall have a powdercoated finish and all plastic components shall be UV resistant.

G. Play Elements for Natural Play Area

Play elements for the Natural Play Area shall be a combination of contemporary, free form, boundless, structured, natural, and interactive elements to provide for a diversity of play activities. The elements shall also be visually appealing for children, families, and general park users.

The Natural Play Area will not be fenced, but will blend into the park landscape. Play elements provided in this area shall be for the enjoyment of older children in the 5- to 12-year-old age group who require less parental supervision.

The play elements for the Natural Play Area shall be a combination of natural elements of landforms and plantings and simple play elements of swings and ziplines, or track rides, which comfortably integrate into the natural landscape as well as the general site furnishings for the park. A concrete “rock slide” shall be integrated into the grading for this area. Hillocks shall be designed to inspire imaginative and physical

play without requiring intensive maintenance procedures. Plantings of clumping bamboo fastened to galvanized steel space frames designed as tunnels and rooms for imaginative play shall be placed within mulch areas. Note that the planting of spreading bamboo, such as Arrow, Henon, and Palm Leaf are prohibited within the City; the Green Goddess variety of clumping bamboo shall be considered.

Swings for the Natural Play Area shall be the Xscape Swings, Model 26119; the zipline shall be Xscape Track Ride, Model 26038, both manufactured by Gametime, <http://www.gametime.com>. The swing element shall accommodate a variety of swing types – belt and bench – at a variety of heights. Both elements shall have a powdercoated finish and all plastic components shall be UV resistant. The color palette for the two elements shall be Gametime’s Green, Spring Green, Royal Purple and Yellow. The area within the critical fall zone for both the swings and track line play elements shall be paved with poured-in-place rubber surfacing material. (See 3E, Play Surfacing)



GameTime Xscape Track Ride



GameTime Xscape Swing



Natural Play Elements

H. Pavilion

The large Outdoor Classroom/Picnic Pavilion will occupy a prominent place within the natural landscape of the southern half of the park when viewed from across the Phase II Pond, and will serve as a draw to visitors to progress from the more formal to the more natural parts of the park. The pavilion shall not only blend with the natural landscape surrounding it, but also with the more formal landscape from which it will be primarily viewed. No prefabricated pavilions are currently available that merit the prominence of the pavilion in Depot Park; a structure shall be fabricated from materials used within the park to ensure that the pavilion comfortably sits in its setting.

The supports for the pavilion shall be constructed of native limestone laid in courses to blend with the edging of the pond and the limestone seatwalls that are incorporated into the major park entrances. (See 2A, Gateway Structure) Wire

vine supports shall be added to the face of the columns that support the trellised portions of the pavilion to enable the growth of twining vines to reach the trellis.

The large central section of the roof shall be solid; the flanking smaller portions of the roof shall be trellised to accommodate the growth of native vines. The framework for both roof sections shall be constructed of Cor-ten steel for ease of maintenance and for integration of the structure into the landscape. The framework and the metal roofing material shall both communicate a contemporary aesthetic. Picnic tables shall be provided within all sections of the pavilion in an arrangement that will accommodate the use of the shelter both for learning/teaching and dining/gathering. (See 4B, Picnic Tables)



Outdoor Classroom/Picnic Pavilion

I. Picnic Shelters

Two picnic shelters shall be located within the picnic area on the east end of the park. Given the proximity of the picnic area to the northeast and parking area entrances, the shelters shall continue the theme set by the major gateway structure. The arrangement and curve of the shelters shall also serve to create an eastern edge for the open spaces of the park. The linear form of the structure shall be used to accommodate a linear arrangement of pairs of tables and individual tables under a common roof. Half of all of the tables provided within the picnic shelters shall be accessible. (See 4B, Picnic Tables)

The shelters shall be constructed of the same elements that comprise the major gateways with the exception of a solid metal material for the roof over the table areas. (See 2A, Gateway Structure) The roofing material shall be pliable enough to retain the same fluid character of the overhead structure of the gateway structures. The vertical supports

for the overhead canopy shall segregate the spaces for either individual or paired tables. The tables shall be set with a distance of 8' from the end of the table to the center of the cluster of vertical supports. Paired tables shall be separated by a distance of 6'.

The floor of the shelters shall be paved with concrete. 5' of concrete pavement shall be provided to each side of the table. The overhang shall project 4' from the edge of the table. The pavement shall be connected to the adjacent walkway with an accessible path.

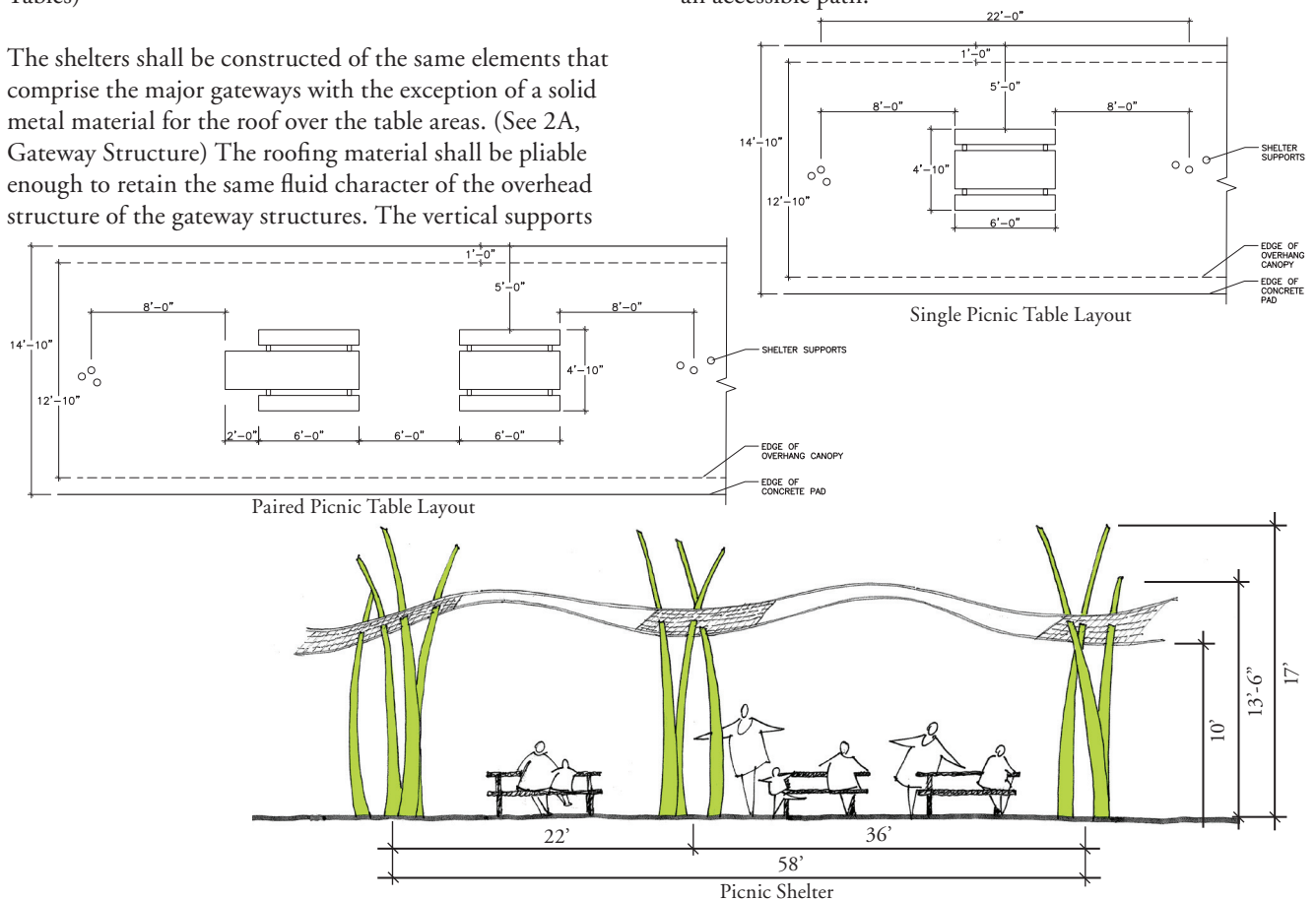

J. Steel Truss Bridge

The steel truss pedestrian bridge over the Phase I Pond provides an important connection for the Multi-use Trail, general park users, and maintenance vehicles. The width of the bridge shall allow two-way use by bicyclists and pedestrians and accommodate park maintenance vehicles. It is not intended for use by emergency vehicles. The bridge width shall be 12 feet.

The bridge shall span the distance from the top of slope on each side of the Phase I Pond at the designed crossing point with a slight camber. The embankments shall be incorporated into the existing grade at the top of slope allowing a simple transition from bridge to Multi-use Trail without the need for railings at the junction due to a grade differential between the trail surface and the adjacent grade.

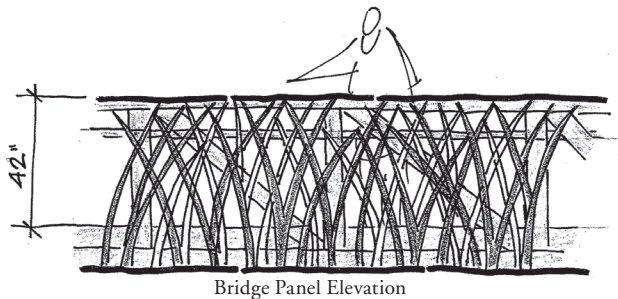

Steel Truss Bridge

The bridge shall be fabricated off-site and brought to the site for installation. It shall be fabricated of Cor-ten steel to integrate the bridge into the natural landscape. The bridge shall be designed for Ipe wood, recycled plastic timber decking, or concrete flooring. If concrete is used for the deck surface, the surface shall receive a heavy broom finish and bicycle safe expansion joints shall be used. If recycled plastic timber decking is used, the structure of the boardwalk shall be adjusted to provide more support with a tighter joist spacing.

The height of the steel truss structure shall be 42" above the finished deck. A rub rail shall be provided at standard handrail height on the inside of the steel truss structure. A 6" curb shall provide a vertical edge on both sides of the decking. Panels of custom-designed laser-cut sheet metal in a grass blade motif shall be applied to the exterior of the steel truss structure to serve as guardrails and to further integrate the bridge into the character of the site furnishings proposed for Depot Park. Spacing between the elements of the panel shall not exceed 4". The height of the panel shall match that of the steel truss.

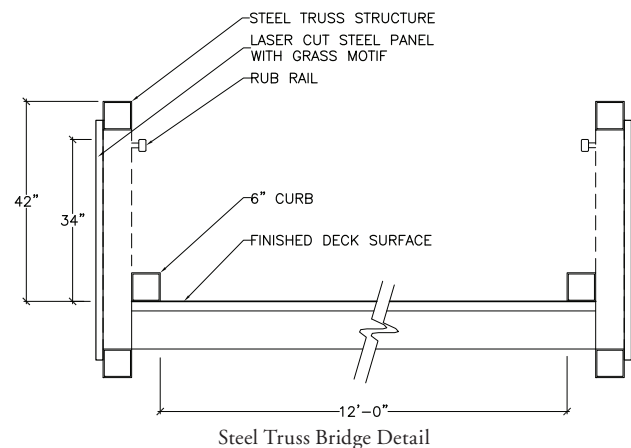

3. Pavement

A. Special Pavement

The major paved gathering spaces at Depot Park – the northeast and northwest park entrances, the Promenade, the overlooks, the pavilion, Depot Plaza, and Cade Plaza – shall be paved in a pattern of exposed aggregate and concrete pavement that reinforces the use of the spaces.

Both concrete pavements shall meet all of the standards of ADA Guidelines and the Florida DOT including those for slab thickness, smoothness, and compressive strength. The standard concrete pavement shall receive a medium broom finish perpendicular to the direction of traffic. Joints and edges shall be tooled. Color admixtures may be incorporated to reduce solar glare from the pavement. If used, the admixtures shall be integral to the pavement and shall ensure that the pavement retains a Solar Reflectance Index (SRI) of at least 29, for compliance with the USGBC LEED Rating System for Heat Island Mitigation.

The stone for the exposed aggregate banding shall be a native stone selected for the color compatibility with other design elements, the proximity of its source, and the maintenance of a Solar Reflectance Index (SRI) of at least 29.

The 24' width of the Promenade shall be subdivided through the use of standard concrete pavement and exposed

aggregate pavement. The use of both pavements visually minimizes the width of the Promenade and accommodates site furnishings within the exposed aggregate pavement for ease of maintenance of the mown lawn areas beyond. The major portion of the Promenade, the central concrete band, shall vary in width from 12' to 16', which undulates between paved edge bands of exposed aggregate pavement, reflecting the Promenade's location at the pond edge.

The exposed aggregate band at the pond edge shall vary in width from 3' to 8'. Occasional groupings of trees shall be located along the pond edge to provide pockets of shade along the Promenade. Located within round tree grates, the junction of the two paving types may fall within the 6' diameter of the tree grate. (See 4E, Tree Grates)

The exposed aggregate band at the back of the Promenade shall vary from 4' to 9' in width to ensure adequate space for the site furnishings located within the band – light fixtures, benches, and paired trash and recycling receptacles. (See Section 4, Site Furnishings and 5A, Promenade Lighting)

The pavement shall be edged with a 6" high, 24" wide limestone curb on the pond side. The back edge of the Promenade pavement shall meet the adjacent lawn and planted areas in a flush condition.

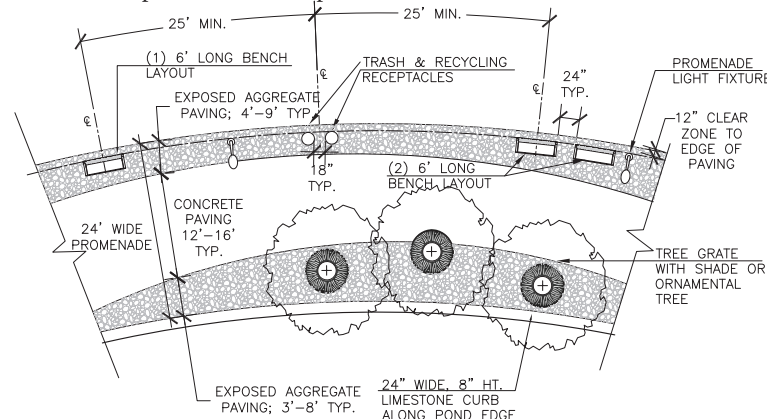

B. Primary and Secondary Walkways

The primary walkways within the park – those that connect the northeast and northwest entrances to the Promenade and the walkway connecting the maintenance facility with SE 10th Avenue – shall be 12' in width. All other concrete paved walkways shall be 8' in width.

All primary and secondary walkways shall be constructed of poured-in-place concrete that meets all of the standards of the Florida DOT including those for slab thickness, smoothness, and compressive strength. Color admixtures may be incorporated into the concrete to reduce solar glare from the pavement. If used, the admixtures shall be integral to the pavement and shall ensure that the pavement retains a

Solar Reflectance Index (SRI) of at least 29.

The surface of the walkways shall be a medium broom finish perpendicular to the direction of traffic. Joints and edges shall be tooled.

While it is acceptable to shed water across walkways, concentrated surface water shall not cross a walkway. Provide swales along the sides of walkways as needed.

All primary and secondary walkways shall be illuminated to the light level standards set for public walkways. (See 5B, Site Lighting for Walkways, Trails, and Parking Areas)

Detail to be Added

C. Tertiary Walkways

Walkways within the natural area that lead to boardwalks and that are not part of a through route shall be paved in a stabilized aggregate. The width of the walkways shall be 6'.

The stone selected for the stabilized surface shall be a native material that is stabilized in keeping with the standards set forth in the USDA Forest Service's document, "Stabilization Selection Guide for Aggregate and Natural Surfaced Low Volume Roads." Should coquina shells be the selected

material, care shall be taken to ensure that the plant material selected for the edges of the pathways is adaptable to the raised pH of the adjacent growing medium that will result from the use of the shells.

A steel edge restraint shall be used to define the edge of the stabilized aggregate pavement to facilitate maintenance and installation.

Detail to be Added

D. Boardwalks

Accessible boardwalks shall be constructed through the park wetlands to enhance the public's enjoyment of this natural area without compromising the habitat for wildlife. The boardwalks shall be constructed maintaining a 12" clearance between the finished grade and the supporting structure of the boardwalk to allow for the movement of small mammals and reptiles under the boardwalks. The boardwalk width shall be 8'.

The boardwalks shall be designed to meet local and state codes. If such codes permit, where the boardwalk is less than 30" above the existing grade, the boardwalks shall be constructed without handrails to maximize access to the water/wetlands. Both edges of the boardwalk shall be defined with a 4" x 4" recycled plastic timber curb, which is set 1" from the edge of the boardwalk on 2" x 4" blocks. The net clear walking surface between the curb faces shall be just over 7'. Small LED light fixtures shall be set flush with the vertical face of the curb. The light emitted from the light fixtures shall lightly wash the walking surface of the boardwalk. Spaced at 6' to 8' o.c., the lighting is not intended to provide the lighting levels that can be expected along the primary and secondary walkways, but shall provide an outline of the route of the boardwalk at night. (See 5C, Boardwalk Lighting)

Where codes require the installation of railings at the edge of the boardwalk, the railings shall be constructed of yellow pine or cedar. The spaces between the posts and rails shall be infilled with steel mesh. The curb shall be



provided in addition to the railings to allow for a consistent lighting treatment of all boardwalks.

The boardwalks shall be constructed utilizing a combination of recycled plastic timber products and pressure-treated lumber. The submerged posts shall be constructed of structural plastic lumber that is comprised of recycled HDPE and strengthened with fiberglass strands, such as manufactured by RENEW Plastics, www.renewplastics.com, to provide the strength for this structural application. Unsubmerged structural beams and joists shall be constructed of wood that has been pressure-treated with ACQ.

The decking shall be constructed of ACQ pressure-treated wood or recycled plastic timbers. If the latter is used, the structure of the boardwalk shall be adjusted to provide more support with a tighter joist spacing. The color of the recycled plastic materials shall be selected to blend with the adjacent landscape as much as possible. Note that the color of the recycled plastic timber fades with time and an initial darker color may be advisable.

At selected locations along the course of the boardwalk system, the boardwalk shall be widened and seating shall be incorporated into the edge of the boardwalk. Any interpretative signage of the wetlands along the boardwalks shall also be incorporated into the edge of the boardwalk. Both seating and signage framing and supports shall be constructed of yellow pine or cedar.



E. Play Surfacing

The children's play area shall be surfaced with a poured-in-place rubber surfacing material that meets federal and state safety requirements for children's play. Depths and extent of the surfacing shall be determined by the critical fall height of the selected play elements and determined in accordance with ASTM standards.

The poured-in-place rubber surfacing shall be composed of two layers – a resilient base course of recycled rubber and a top layer of virgin rubber that is sealed with a polyurethane agent that are installed over a base course of asphalt, concrete or compacted stone.

Within the Depot Play Area, the design and selected colors of the wear layer can subtly enhance a train theme for play and provide an exciting play environment for all. Linear routes, simulating “train tracks”, shall be woven through the periphery of the play area with elements suggestive of trains located on “spurs” of the tracks. (See 2F, Play Elements for Depot Play Area)

Within the Natural Play Area, a single color of play surfacing shall be used within the area determined by the critical fall zones under the swings and track rides.

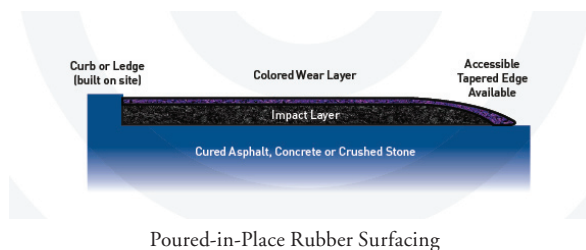

F. Multi-Use Trail Pavement

The portion of the Rails-to-Trails system that falls with Depot Park will provide its users with a route that is largely free of encounters with vehicles, but will create a zone in which bicyclists will need to be very attuned to the actions of many pedestrians sharing and crossing the Multi-use Trail. Posted park regulations shall clarify the role of the bicyclist as the yielder of the right-of-way in such encounters, but additional measures shall be taken along the trail to communicate this role to bicyclists.

Along the Multi-use Trail, the official Rails-to-Trails logo shall be mounted on an arching grass blade post to coordinate with the family of signs within the park. The location of this sign along the trail near intersections with primary walkways shall also serve to alert pedestrians of the potential presence of bicyclists. The sign shall be mounted 3' from the trail edge with the bottom of the sign at 7' for the safety of bicyclists and pedestrians. (See 2B, Signage)

At the intersection of the Multi-use Trail with a concrete walkway, the asphalt pavement of the trail shall be interrupted by the concrete pavement of the walkway to signal the intersection to the faster moving bicyclists. In

addition, 24" wide rumble strips of scored concrete shall be located in advance of intersections with pedestrian walkways to allow the bicycles to stop as necessary. When intersections occur in rapid succession, rumble strips shall be deleted where intersections are less than 60' apart.

The trail shall conform to all standards for a shared trail within the AASHTO Guide for the Development of Bicycle Facilities. The pavement shall have a 2% cross slope that is pitched rather than crowned.

The pavement for the Multi-use Trail shall meet all of the standards established for the Rails-to-Trails system. The width of the trail shall be 12'. The trail shall not be striped in a manner that attempts to create separate lanes for pedestrians and bicyclists as the striping creates slippery surfaces that are unsafe for bicyclists and pedestrians.

The trail shall be constructed of bituminous asphalt or porous asphalt to conform to the standards set by the Florida Department of Transportation. Porous concrete or asphalt shall be considered for use as an alternate to asphalt for the trail.

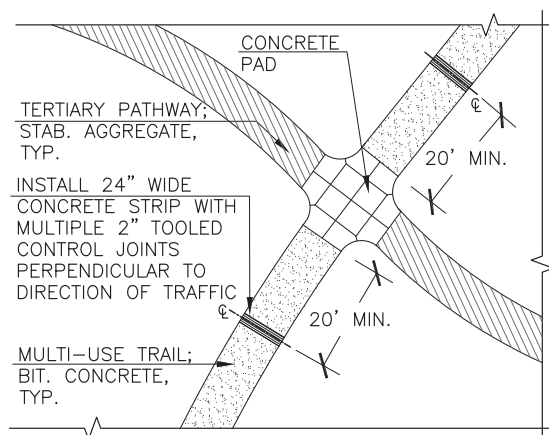
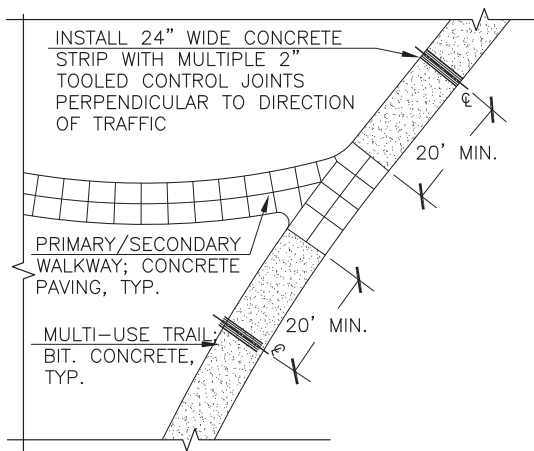

Multi-use Trail Intersections

G. Parking Areas

The parking areas for Depot Park along SE 4th Street and S Main Street are critical in enhancing the accessibility of the park. The parking areas shall meet all Florida and federal accessibility standards.

The parking area shall be constructed of bituminous asphalt or porous asphalt to conform to the standards set by the Florida Department of Transportation. Porous concrete or

asphalt shall be considered for use as an alternate to asphalt for the parking areas offering the durability of standard asphalt and assisting in the infiltration of water into the soil by retaining stormwater runoff. The installation of porous asphalt must be accompanied by the installation of a properly engineered substrate beneath the porous pavement to store the water percolating into the soil.

Detail to be Added

4. Site Furnishings

A. Bench

The largest gathering areas within Depot Park accommodate the gathering of large or small groups through seatwalls or, in the case of the Pavilion, picnic tables. Elsewhere, with the exception of boardwalks, where seating shall be integral to the boardwalk structure, benches shall be located individually or in pairs throughout Depot Park to create seating for use by individuals or small groups.

Along the Promenade, benches shall be installed within the walkway. (See 1B, Promenade) When installed along other walkways, the bench shall be located on a separate pad adjacent to the walkway that is sized to allow 1' of pavement to the rear of the bench, 2' to the front, 1' to one end, and 4' to the opposite end to accommodate a wheelchair next

to the bench. For the comfort of the bench users, trash and recycling receptacles and ash urns shall not be placed within 25' of a bench.

The bench used in Depot Park shall be a comfortable bench with a back and arms and shall be a key element in the establishment of the character for the park. The selected bench is the "Lakeside" Model steel bench with plasma cut grass designed metal backs with custom wooden slat seats, as manufactured by Landscape Forms, <http://www.landscapeforms.com>. The bench shall be provided with skateguards. The bench shall be surface mounted. The color for the bench as well as the selected Landscape Forms' trash and recycling containers shall be "Stone".

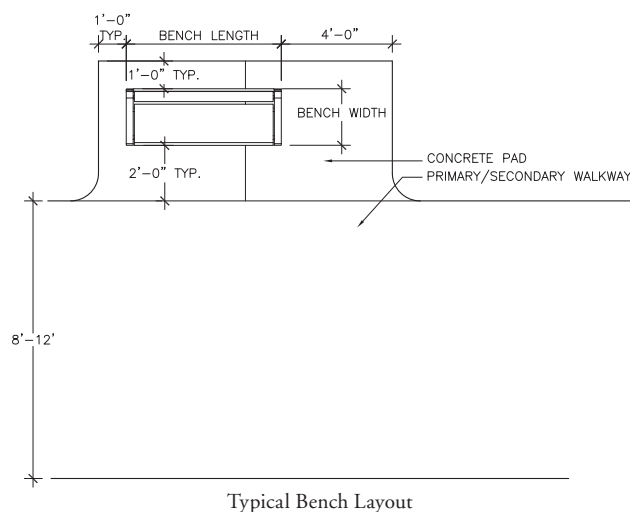

Lakeside, Landscape Forms

B. Picnic Table

Picnic tables shall be located in Depot Park within the picnic area on the east side of the park and at the Outdoor Classroom/Picnic Pavilion. Within the picnic area, picnic tables shall be located within the two picnic shelters as well as in the open lawn. The linear form of the picnic shelters shall be used to accommodate a linear arrangement of pairs of tables and individual tables under a common roof. Tables shall be oriented to facilitate the cleaning of the pavement under the table. (See 2I, Picnic Shelters) For the comfort of the bench users, trash and recycling receptacles and ash urns shall not be placed within 25' of a picnic table.

Half of the tables provided within the park shall be universally accessible and shall be evenly distributed. An accessible route shall link any accessible table with park walkways. When installed individually within lawn areas, the tables shall be installed on a concrete pad that is sized to extend 6' beyond the table at the accessible end and 4' beyond all other sides of the table.

Picnic tables shall also be located within the Outdoor Classroom/Picnic Pavilion in an arrangement that will accommodate the use of the shelter both for learning/teaching and dining/gathering as well as facilitate cleaning of the pavement under the table.

Picnic tables shall be easily maintainable. The picnic tables used within the park shall be a modified 6' Parker table, Model PKPT-6, as manufactured by Wishbone Site Furnishings, <http://www.wishboneltd.com>. The standard table and bench surfaces shall be replaced with black vinyl-coated perforated steel. The color for the powder-coated aluminum bench and table supports shall be "Textured Black." The standard 6' table shall seat six. The accessible version, with a 24" extension to one end, shall seat seven.



Wishbone Site Furnishings Parker Accessible Picnic Table

C. Bike Rack

The location of Depot Park on the Rails-to-Trails system will bring bicyclists into the park as well as promote commuting to the park by bicycle. Given the park's size and predominance of boardwalks, which shall be identified as bike walking zones, most bicyclists who come to the park will choose to park their bike and enjoy the park on foot. Bike racks shall be located along the Multi-use Trail near park entrances and at parking areas adjacent to heavily-used areas that are easily monitored to provide security for parked bikes. Bike racks shall not be located within a major view corridor or within the natural areas.

Bike racks shall be installed within concrete pavement for ease of mowing and maintenance. The bike parking areas shall be located adjacent to the Multi-use Trail, and sized adequately to ensure that bike parkers do not interfere with movement along the trail. Quantities of bike racks for each location shall vary depending on anticipated use.

The bike racks selected for use within Depot Park shall be the imbedded Bike Garden Bike Rack as manufactured by

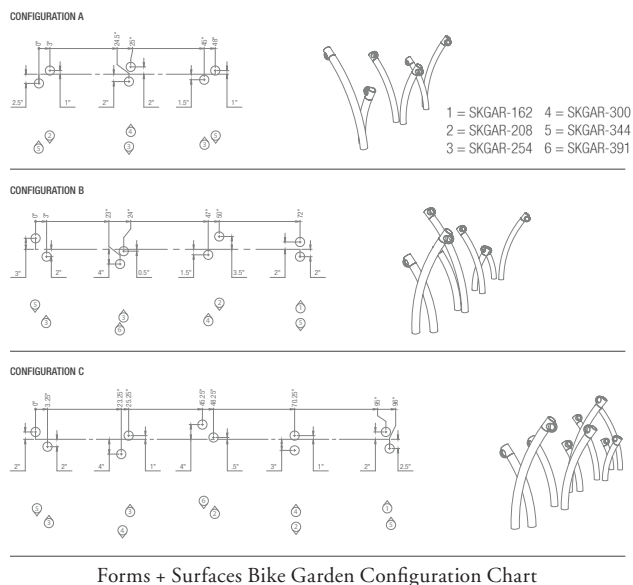

Forms + Surfaces, <http://www.forms-surfaces.com>. The Bike Garden rack is comprised of six differently-sized members. The manufacturer's suggested arrangement shall be modified as necessary so that the majority of pieces used within any grouping shall be the second to fourth shortest pieces, which accommodate the locking of bicycles with "U" bike locks. The shortest piece shall be used occasionally, predominantly near the play areas, as it accommodates children's bikes. The two tallest pieces, which accommodate the use of cable bike locks, shall also be used occasionally within a grouping. The finish for the imbedded Bike Garden Bike Racks shall be stainless steel.



Forms + Surfaces Bike Garden

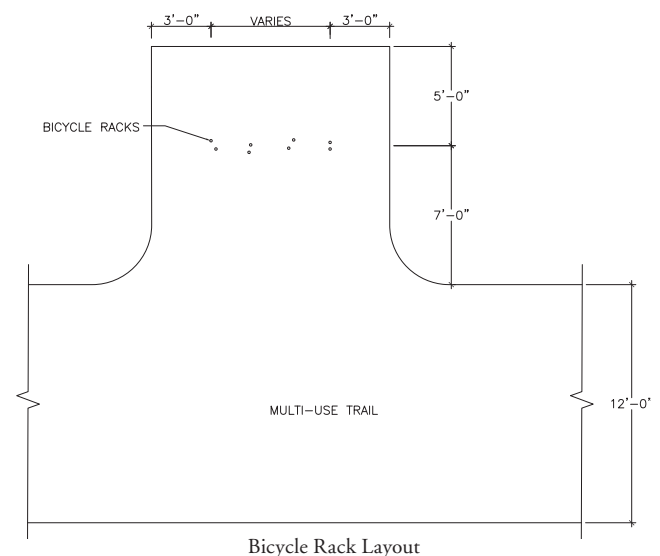

D. Fencing

The Depot Play Area shall be fenced with a gated 4' high fence to accommodate use of the play area by families with very young children. The fence shall be transparent to permit easy surveillance of the play area by passersby. The fence and gate shall meet all Florida and federal codes for playground safety.

The fencing for the children's playground shall be the modular fence system, LEGI-Fit Fence as constructed by Legi, <http://www.fences.com>. The standard length for the panels shall be 8'. The color for the fence shall be black. The fence panels shall be modified to ensure that the verticals do

not protrude beyond the horizontal rails on the top or the bottom of the fence. The spacing between fence members shall not exceed 4". The gates and the two flanking 5' long panels shall be a custom steel fabrication that employs similar panels applied to the steel truss bridge and echos the grass theme throughout the park. (See 2J, Steel Truss Bridge) The gates shall be framed by the same vertical steel "grass blades" that announce each of the park's entrances. At selected locations along the fenceline, the standard 8' long LEGI fence panels shall be interrupted by additional custom panels. The color for the LEGI panels shall be black.

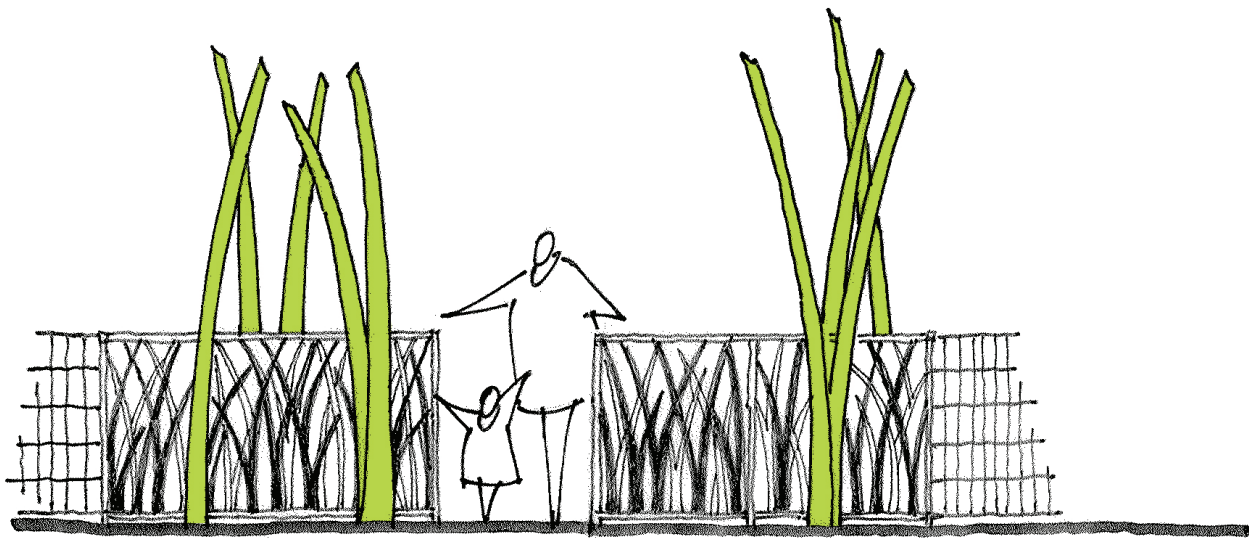

Gateway at Depot Play Area

E. Tree Grates

Given the greater success and health enjoyed by trees planted within plant beds and open lawns, tree grates shall only be used within the park on the Promenade, and possibly at the major park entrance plazas, where those growing conditions cannot be met. At selected locations along the Promenade, groups of trees shall be planted in tree grates along the edge of the pond to provide shade for the south-facing Promenade and the benches along its length. (See 1B, Promenade)

The tree grate selected for use along the Promenade is the solid cast iron 'SERPO' round tree grate as manufactured by Hess AG, <http://www.hess.eu>. The color and finish shall be RAL 9011 graphite black finish. The grass blade-like cut-outs on the grate echo the natural grass motif of the specified Lakeside benches and trash/recycling receptacles.



Cast iron; Hess AG Serpo Tree Grate



F. Bollard

Bollards shall be located at all park entrances and in plaza areas where vehicular areas abut pedestrian areas without a separation in grade. Within plaza spaces at the Depot and the Cade Museum, where entry by service vehicles is not necessary, permanent bollards shall be used. At pedestrian park entrances that need to accommodate service and emergency vehicle access, removable bollards shall be installed to restrict vehicular traffic within the park to authorized vehicles. Spacing of the bollards is critical to their success in restricting vehicular traffic.

All removable bollards shall be Model SSR4080, a 4" diameter, 36" tall stainless steel bollard that locks into an embedded sleeve and is secured by a tamper proof internal lock, as manufactured by Cal Pipe Security Bollards, <http://www.calpipebollards.com>.

All permanent bollards shall be Model SSB4000, a 4" diameter, 36" tall stainless steel bollard with a fixed base plate, as manufactured by Cal Pipe Security Bollards, <http://www.calpipebollards.com>.



Cal Pipe Security Bollard

G. Receptacles

Trash and recycling receptacles shall be located just inside the park at the five park entrances, at the picnic area, Depot Play Area, adjacent to major gathering areas, such as the overlooks, amphitheater, and Outdoor Classroom/Picnic Pavilion, and at facilities such as the comfort stations, rental kiosk, and aviary. Ultimate review of the proposed receptacle locations shall be by the Park Maintenance staff to ensure that the locations match the park maintenance capabilities and the park philosophy regarding the individual park user's responsibility for his or her trash. Receptacles shall be located within the natural areas only where maintenance by park vehicles will be feasible. For the comfort of park users, trash and recycling receptacles and ash urns shall be placed a minimum of 25' from any bench, seatwall, or picnic table.

Along the Promenade, trash and recycling receptacles shall be installed within the walkway. (See 1B, Promenade) When installed along other walkways, the receptacles shall be located on a separate pad adjacent to the walkway that is sized to allow 12" of pavement at all sides of the receptacles when the pair is installed 18" apart.

The trash receptacle selected for use in the park shall be the "Lakeside" model with removable black polyethylene liner, minimum 30 gallon size, as manufactured by Landscape Forms, <http://www.landscapeforms.com>. The color for the



Lakeside Trash Receptacle,
Landscape Forms



Lakeside Recycling Receptacles,
Landscape Forms

powdercoat finish for the receptacle as well as the selected Landscape Forms' bench shall be "Stone". Selection of the top or side opening shall be made by park maintenance staff. The receptacle shall be surface mounted.

Each trash receptacle shall be paired with a recycling receptacle to accommodate and reinforce recycling efforts by park users. The recycling receptacle shall match the trash receptacle by Landscape Forms, <http://www.landscapeforms.com>, with modifications for recycling. The receptacle shall have two labeled openings – for paper and non-paper recycling – and a divided interior to separate the materials. The openings shall be grouped on one side of the receptacle to permit use from one side. The color for the powdercoat finish for the receptacle as well as the selected Landscape Forms' bench shall be "Stone". The receptacle shall be surface mounted.

The ash urn selected for use in the park shall be the large, 6" diameter by 16" tall Butler Ash Receptacle, as manufactured by Forms + Surfaces, <http://www.forms-surfaces.com>. The receptacle shall be mounted to the face of a 48" high simple black tubular steel post with a welded plate to seal the end of the post. The color of the ash receptacle shall be "Aluminum Texture".

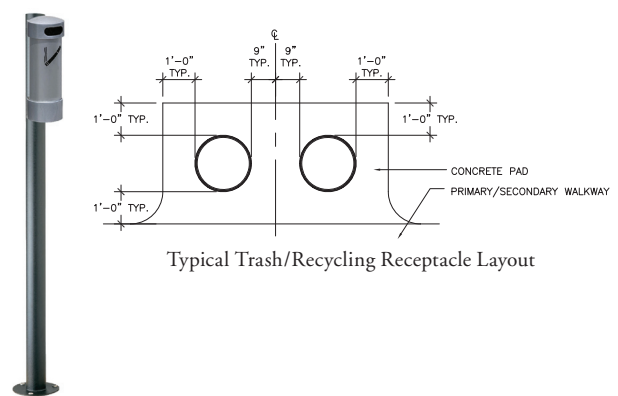

Typical Trash/Recycling Receptacle Layout

Butler Ash Receptacle,
Forms + Surface

H. Drinking Fountain

Two fountains shall be located within the park in conjunction with the two comfort stations to capitalize on the water service. The fountain at the northern comfort station shall be conveniently located near the Children's Play Area, with the southern one strategically located at the center of the park. Both shall be located in close proximity to trailheads for the Multi-use Trail. Drinking fountains shall meet all current Federal Regulations in the Americans with Disabilities Act, as well as the Federal Safe Drinking Water Act.

The drinking fountain selected for use in the park shall be Model 3202, a barrier-free, vandal-resistant, trough style drinking fountain, as manufactured by the Haws Corp, <http://www.hawscorp.com>. The Model 3202 does not include a drain and thus requires the installation of a drainage inlet adjacent to the trough to collect water. The color for the drinking fountain shall be "Silver."



Haws Corp, Model 3202 Trough View



Drain

Haws Corp, Model 3202 Drain View

5. Lighting and Electrical

A. Promenade Lighting

Lighting for the Promenade shall reflect the prominence of this space within Depot Park. Along the Promenade, the standard light fixture selected for the park shall be mounted on a signature pole that establishes a special character for the Promenade and establishes a third dimension for the space. The pond edge of the Promenade shall be distinctly marked with the installation of curb-mounted LED fixture that projects a light wash over the surface of the Promenade.

Lighting design for the Promenade and the overlooks must meet the Average Foot-candles and Uniformity Ratio defined by lighting industry standards and the City of Gainesville requirements. This standard is satisfied by the pole-mounted light fixture that is placed at the back side of the Promenade. The light fixture shall be the Canto G, Model CC450G, with a full cut-off 150 watt metal halide

fixture, mounted on a 17' arching steel pole as manufactured by Hess America, <http://www.hessamerica.com>. The spacing of the light poles shall be approximately 80' o.c. The pole comes with the option for the addition of a banner arm. The color of the fixture shall be Hess America's "Matte Silver Grey Metallic".

The LED accent light fixture selected to articulate the pond edge and overlooks at night shall be the Recessed Wall Linear Clear LED, Model 8306LED, with a 1.5W LED as manufactured by BEGA-US, <http://www.bega.com>. The light fixtures shall be spaced at 8' to 10' o.c. The light shall have a stainless steel finish.



BEGA Recessed Wall Linear Clear LED



Hess Canto G

B. Lighting for Walkways, Trail, and Parking Areas

All primary and secondary walkways, the Multi-use Trail, and parking areas shall be illuminated by the same fixture. While the fixture is similar to the one selected for the Promenade, a simpler look for the walkways, trail, and parking areas is achieved through the selection of a fixture with a simpler straight pole.

Lighting design for the park walkways, trail, and parking areas must meet the Average Foot-candles and Uniformity Ratio defined by lighting industry standards and the City of Gainesville requirements. In addition, lighting levels for the Multi-use Trail shall also meet the requirements of the AASHTO Guide for the Development of Bicycle Facilities of horizontal illumination levels of 5 to 22 lux.

The light fixture selected for primary and secondary walkways, Multi-use Trail, and parking areas shall be the Athens, Model ATH640P, with the energy efficient Philips CosmoPolis lamp, mounted on a 16' steel pole as manufactured by Hess America, <http://www.hessamerica.com>. The spacing of the light poles shall be approximately 80' o.c. The pole comes with the option for the addition of a banner arm. The color of the fixture shall be Hess America's "Graphite Grey".



Hess Athens

C. Boardwalk Lighting

At night, the boardwalks shall be minimally illuminated to define the edge of the boardwalks. Small LED fixtures shall be set flush with the vertical face of the boardwalk curb. The light emitted from the light fixtures shall lightly wash the walking surface of the boardwalk. Spaced at 6' to 8' o.c., the lighting is not intended to provide the lighting levels that can be expected along the primary and secondary walkways, but shall provide an outline of the route of the boardwalk at night.

The light fixture for installation in the boardwalk curbs shall be the Recessed Wall Round Clear LED, Model 8689LED, with a 1.5W LED as manufactured by BEGA, <http://www.bega.com>. The light fixtures shall be spaced at 6' to 8' o.c. The light shall have a stainless steel finish.



BEGA Recessed Wall Round Clear LED

D. Historic Depot Context Area and Tertiary Walkway Lighting

The straight walkways to Depot Plaza from the east and the west are to be lined with straight lines of trees to create a distinctive space within the park that recalls the train tracks and the industrial history of the site. The pole light fixture selected for the walkways in the park would be less successful within the dense allee of trees. The bollard light selected for the natural areas of the south side of the park, where a lower height of lighting is desired, is also appropriate for these allees, and will give both areas a distinctive character.

The bollard light selected for these two areas shall be the Horizontal Louver Bollard with 180° Light Distribution, Model 8136P as manufactured by BEGA, <http://www.bega.com>. The finish for the fixture shall be brushed stainless steel.



BEGA Horizontal Louver Bollard

E. Gateway Accent Lighting

The northwest and northeast entrances to the park have been designed to be dynamic spaces that serve to attract and welcome visitors to the park. It is important that the entrance spaces retain their visual appeal in the evening so that the park is perceived as a safe environment, whether or not the park is open or in use. For this reason, while the light fixtures for the park walkways have been selected for their cut-off features, minimal uplighting is proposed at these two entrances to illuminate the two major gateway structures.

The fixture selected to wash some of the faces of the vertical grass blades and portions of the stainless steel fabric overhead shall be the PHENIX CRL, with 12W nominal load multi-LED source, as manufactured by Targetti, <http://www.targetti.it>. The fixture shall be set within the plaza pavement in front of the limestone seatwall as well as to the rear of the wall within the planting bed. The light shall have a stainless steel finish.



Targetti PHENIX CRL

F. Security Phones

Security Phones shall be placed strategically in the park, in consultation with the Gainesville Police Department. One location within the northern half of the park and another in the southern half shall be selected that offers quick and easy access for park users and the police.

The phones shall be installed adjacent to a public walkway on a paved pad to ensure universal accessibility. The phone shall be mounted at the correct height for universal access. The phone system shall be activated by simply pushing a red button for help.

The security phone selected for the park is the TR400 modular phone column as manufactured by Vandal Proof Products, <http://www.vandalproof.com>. The selected modules for the TR400 column include the TR400-5 blue marker light at the top of the column, the TR400-4 “Emergency” labeled column and TR400-1 column base, the TR400-3 LED illuminated hood, and the T2110 phone. The TR400-6 down lighting fixture shall not be included in the column. The finish shall be the standard black powdercoated steel and stainless steel.



Vandal Proof Product Phone

G. Power Supply

Power sources shall be available within the park at areas where the need is anticipated for special events, such as the stage area of the amphitheater, the Promenade, the major park entrances, Depot Plaza, and the Outdoor Classroom/Picnic Pavilion. It is critical that these sources be GFC-protected and protected from stormwater, and as minimal in profile as possible to eliminate the visual intrusion into the landscape, minimize potential tripping or bumping hazards, and not complicate maintenance practices.

Along the Promenade the power sources shall be mounted within the limestone seatwalls at each of the overlooks. They shall also be mounted within the limestone curb at the pond's edge for the length of the Promenade to minimize

their intrusion into the landscape. The spacing for the power sources along the Promenade shall be approximately 80', placing at least one source between each of the overlooks.

At Depot plaza, two GFC-protected power sources shall be incorporated into the seatwalls flanking the major connection to the park. Several additional power sources shall be distributed across the building façade to enable the area to accommodate a variety of uses.

For the other designated locations within the park, the sources shall also be integrated into the structures – the stage of the amphitheater, the walls at the major park entrances, and the columns of the Outdoor Classroom/Picnic Pavilion.

H. Miscellaneous Utilities, Wi-fi

Digital Downtown provides free wireless Internet access in downtown Gainesville. This service operates in the area of the Downtown Community Plaza, Courthouse, City Hall, downtown restaurants and main library.

Cade Museum and the Depot Building can be designated as wi-fi access points.

6. Landscape

A. Plant Materials

Planting within Depot Park shall be undertaken with the dual objectives of providing outdoor space for public use and replicating the natural landscape of northern Florida for the sustenance of humans and the native flora and fauna. All planting within the park and the implied maintenance of that planting shall adhere to the nine principles of Florida-friendly Landscaping, as described in the web site, <http://floridayards.org/index.php>. Wherever possible, all plant materials selected for the park shall be native species.

Mown lawn areas, due to the high maintenance that they require and the associated energy costs, are not a sustainable approach to the landscape and shall be used within the park only where they are needed for usable open space. As alternatives to mown lawn, low-growing native meadow grasses that require only biannual mowing or low-growing native groundcovers shall be planted in areas where a visual openness is desired but a useable ground surface is not required.

Outdoor spaces benefit by the inclusion of the same elements necessary to make an indoor space – a floor, walls, and a ceiling. For the open mown lawn areas, the largest outdoor “rooms” at Depot Park, in addition to a “floor” of mown lawn and “walls” of various site elements and native plantings, a “ceiling” created by large canopy trees is critical for the creation of a successful space. Flowering trees with their low branching, native palmettos with their lower height, and coniferous trees with their greater opacity are less suited to providing an appropriately high ceiling for large

spaces. Within the open lawn area the large canopy trees shall be located where they will provide shade for seating and gathering.

Within smaller spaces, the lower “ceiling height” provided by smaller flowering trees and low-growing native palms and palmettos make them an appropriate choice. Palms shall only be used as understory under larger canopy trees or as low-growing specimens, as would be appropriate to North Florida.

The size of a landscape space determines the complexity of the appropriate landscape treatment, in particular the shrub, groundcover/grass layers. The larger the space, the simpler the landscape treatment should be, so as not to interfere with the perception of the landscape as a whole. Smaller spaces within Depot Park, such as the small plaza area near the northwest entrance to the park, that are intended as a destination for gathering and are thus viewed over a longer period of time from a stationary perspective, shall receive a much more intricate treatment to hold the viewer’s attention. Species of shrubs, groundcovers, and grasses can be planted in smaller groupings amid a variety of other species to create the space. Within the larger spaces of Depot Park, such as the edge of the picnic area, that are to be planted in shrubs, perennials, and groundcovers, however, the plant beds that help define the edges and create a buffer from adjacent uses, shall be filled with broad sweeps of a single species.

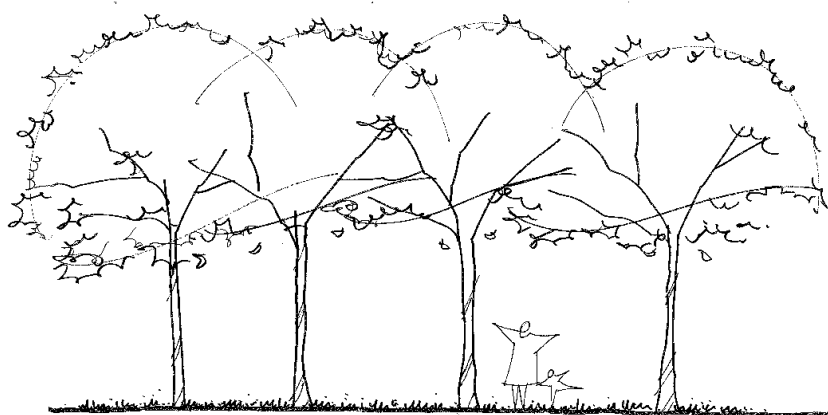

Large Canopy Trees for Large Outdoor 'Rooms'



More Complex Plantings for Smaller Spaces

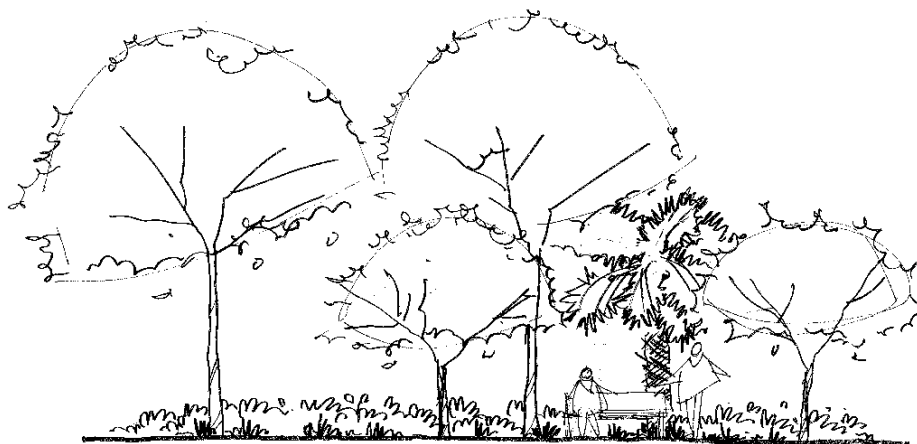

Smaller Flowering Trees and Palms at Smaller Spaces

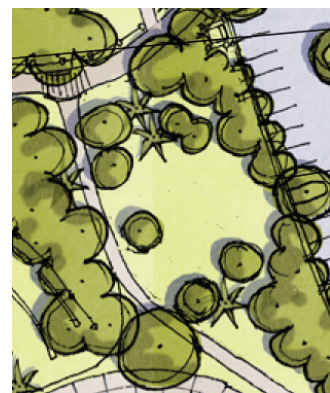

Broad Sweeps of Single Species for Large Spaces

B. Raised Plant Beds

The plant beds within the children's garden shall be raised to provide universal access and facilitate maintenance. The bed heights shall vary from 12" to 24", providing optimum access for children of all ages and abilities and gardening styles.

The beds shall be edged with ¼" thick sheets of Cor-ten steel that will accommodate curves and corners with a minimal amount of planting area lost to edge construction, something of value for short arms. Steel shall meet the



Cor-ten Steel Edged Planter

Florida standard specification. Steel shall not have sharp corners and edges. Welding shall be continuous, water tight and shall extend for the entire length of the joints. Cor-ten steel sheets shall be installed with the support of reinforced concrete footings held behind the steel and 12" minimum below the finish grade of the raised bed.

Cor-ten steel discolors adjacent surfaces, so the walking surface adjacent to the steel edged raised steel shall be a stabilized aggregate.

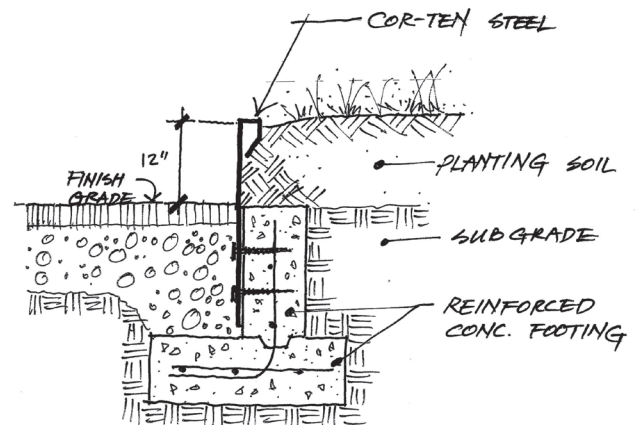

7. Energy Conservation and Sustainable Design Recommendations

Energy Conservation

The southeast corner of the park shall be used as a site for the installation of a photovoltaic array as a means of making the development of the park a more sustainable endeavor. The solar panels of the array make use of renewable energy from the sun, and are a clean and environmentally sound means of collecting solar energy. While the energy produced may not be directly used within the park, the energy generated and supplied to the power grid can help offset the energy requirements of the park. Interpretive signage shall be installed adjacent to the array to educate the park visitor about the photovoltaic process and the reasons for the installation.

Sustainable Design Recommendations

- Porous pavements
- Hi-reflectance pavements
- Native plants – less irrigation- and maintenance-dependent
- Native wildflower/meadow alternative to lawn
- Recycled timber
- ACQ pressure-treated wood
- Local stone
- HDPE alternatives to PVC
- 100% cut-off light fixtures to honor dark sky concerns
- Philips CosmoPolis light source – long life and optical efficiency
- LED light source – long life

8. Dog Friendly Recommendations

As a community park, it is recommended that Depot Park provide pet-friendly site elements, such as waste bag/mitten dispenser stations and water fountains.

The waste bag/mitten dispensers shall be located near each of the park entrances inside the park beyond the gateways. The dispenser selected for the park is the Mutt-Mitt, as manufactured by the company of the same name, <http://www.pickupmitts.com>. Color of the dispenser shall be black.

The dispenser shall be mounted on the front of a simple black tubular steel post with welded flush top.

The drinking fountain identified for use within the park has been selected for its ease in providing water for pets through the sheeting of water down the fountain's open trough.



Mutt-Mitt Pet Waste Bag/Mitten Dispenser Station

Summary Table

Item	Manufacturer	Model	Color	Modified
Gateway Structure	Custom Fabrication		Light Green, SS	
Signage	Custom Fabrication		Light Green	
Play Elements for Natural Play Area				
Swings	GameTime	Xscape #26119	Green, Spring Green, Royal Purple, Yellow	
Track Ride	GameTime	Xscape #26038	Green, Spring Green, Royal Purple, Yellow	
Pavilion Shelter	Custom Fabrication			
Picnic Structure	Custom Fabrication		Light Green, SS	
Steel Truss Bridge	Custom Fabrication		Cor-ten Steel	
Bench	Landscape Forms	Lakeside, grass cutouts	Stone	X
Picnic Table	Wishbone Site Furnishings	Parker PKPT-6	Textured Black	X
Bike Rack	Forms + Surfaces	Bike Garden	SS	
Fencing (Children's Playground)	Legi	LEGI-Fit Fence	black	
Laser Cut Steel Panels	Custom Fabrication			
Fence Gate	Custom Fabrication			
Tree Grate	Hess AG	SERPO	Graphite black	
Bollard: Removable	Cal Pipe Security Bollards	SSB4080, 4"Dia, 36" Ht.	SS	
Bollard: Permanent	Cal Pipe Security Bollards	SSB4000, 4"Dia, 36" Ht.	SS	
Trash Receptacle	Landscape Forms	Lakeside, grass cutouts; min 30 gal.	Stone	
Recycling Receptacle	Landscape Forms	Lakeside, grass cutouts	Stone	X
Ash Receptacle	Forms + Surfaces	Large Butler	Aluminum texture	
Drinking Fountain	Haws Corp.	3202	Silver	
Promenade Overhead Lighting	Hess America	Canto G 17', CC450G	Matte Silver Grey Metallic	
Promenade Curb Lighting	BEGA	8306	SS	
Site Lighting for Walkways and Trail	Hess America	Athens 16', ATH640P	Graphite Grey	
Parking Lighting	Hess America	Athens 20', ATH860P	Graphite Grey	
Boardwalk Lighting	BEGA	8689	SS	
Historic Depot Context Area and Tertiary Walkway Lighting	BEGA	8136P	Brushed SS	
Gateway Accent Lighting	Targetti	PHE CRL	SS	
Security Phone	Janus	TR400Vandal Proof Phone	Black, SS	
Dog Waste Bag Dispenser	Mutt-Mitt	Mutt Mitt	Black	