

WATER AND WASTEWATER FACILITIES

Gainesville Regional Utilities (GRU), owned and operated by the City of Gainesville, presently provides water and wastewater services to residents of the unincorporated area of Alachua County. Extension policies for serving new customers are the same in the City and in the proposed annexation Area.

Financing the Extension of Water and Wastewater Facilities

GRU's existing water/wastewater extension policy is that new water and wastewater customers pay the fully allocated cost for the service they receive. This cost includes the cost of the treatment facilities required for service in the form of plant connection fees, and the cost of distribution or collection facilities in the form of transmission and distribution charges and/or collection system charges. Additionally, any developer requesting an extension pays a Contribution In Aid of Construction (CIAC) sufficient to ensure that GRU receives an appropriate rate of return on its portion of extension costs. This policy applies both in the City of Gainesville and the surrounding unincorporated area of Alachua County.

Actual facility construction is funded from either one or both of GRU's Construction Fund or the Utility Plant Improvement Fund (UPIF). The Construction Fund consists of proceeds from the issuance of revenue bonds. The UPIF is funded by operating revenue.

Existing Major Trunk Water Mains and Proposed Extensions

In accordance with Section 13 (1) (a) of the Boundary Adjustment Act, Figure 3 shows existing major water mains in the City of Gainesville and the surrounding proposed annexation Area. Figure 4 shows water distribution system projects in GRU's approved 2004 budget. The fiscal year in which each project is proposed for construction is also shown in Figure 4. Additional funding is included in GRU's budget for extending water facilities to meet the needs of new customers and whose location will depend on development. Project timing is based on projected growth within the GRU service area. Actual construction times of the projects shown in Figure 4 may vary based on the actual rate or location of growth within the service area.

Existing Wastewater Collection System and Proposed Extensions

In accordance with Section 13 (1) (a), Figure 5 shows the existing major wastewater collection system in the City of Gainesville and the Area. Figure 6 shows wastewater collection system projects in GRU's approved 2004 budget. The fiscal year in which each project is proposed for construction is also shown in Figure 6. Additional funding is included in GRU's budget for extending wastewater facilities, to meet the needs of new customers and whose location will depend upon development. Project timing is based on projected growth within the GRU service area. Actual construction times may vary as a result of service being required either earlier or later than originally anticipated.

Figure 1: Area Proposed for Annexation

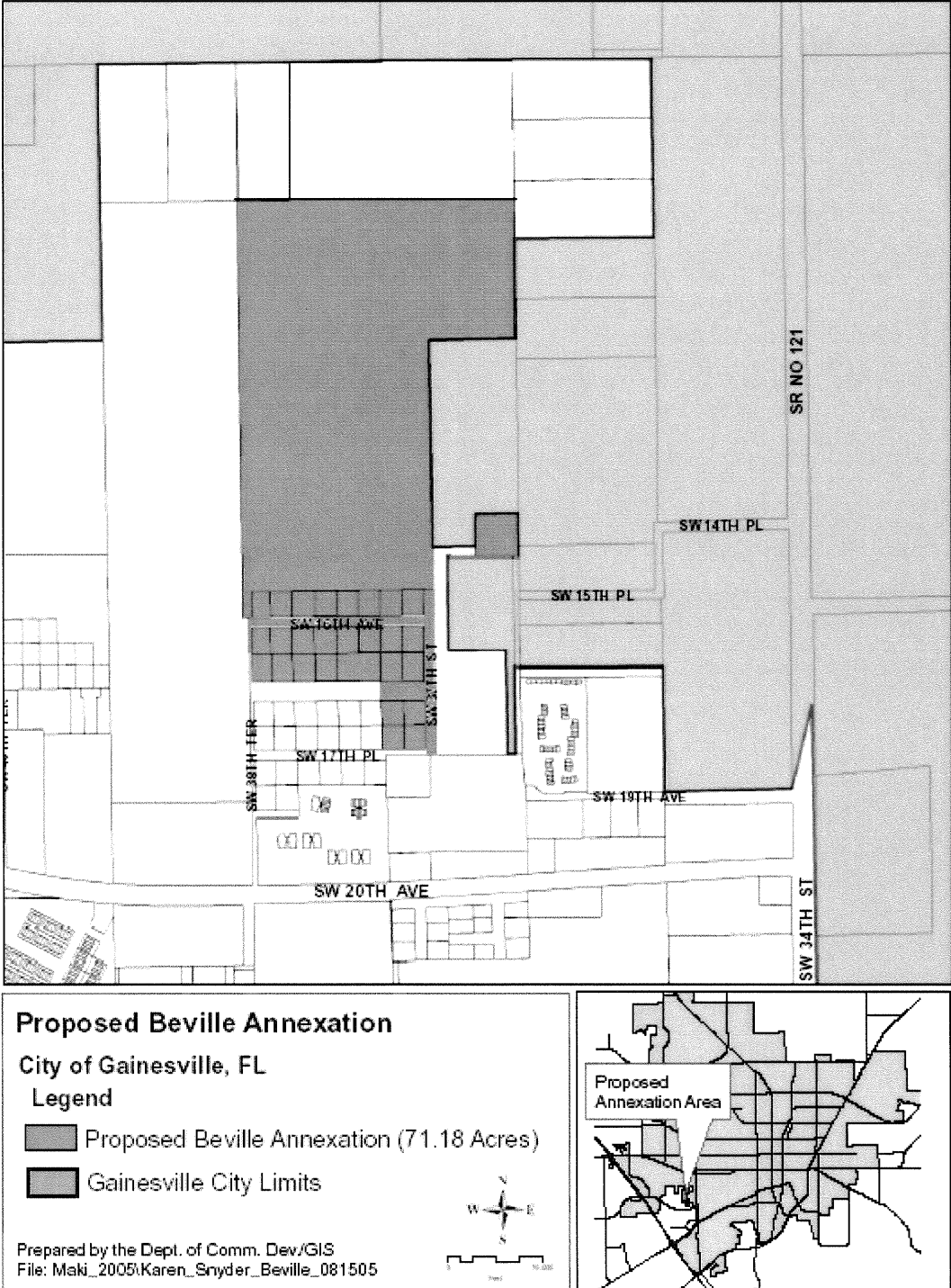

Figure 2: Land Use of Parcels No.

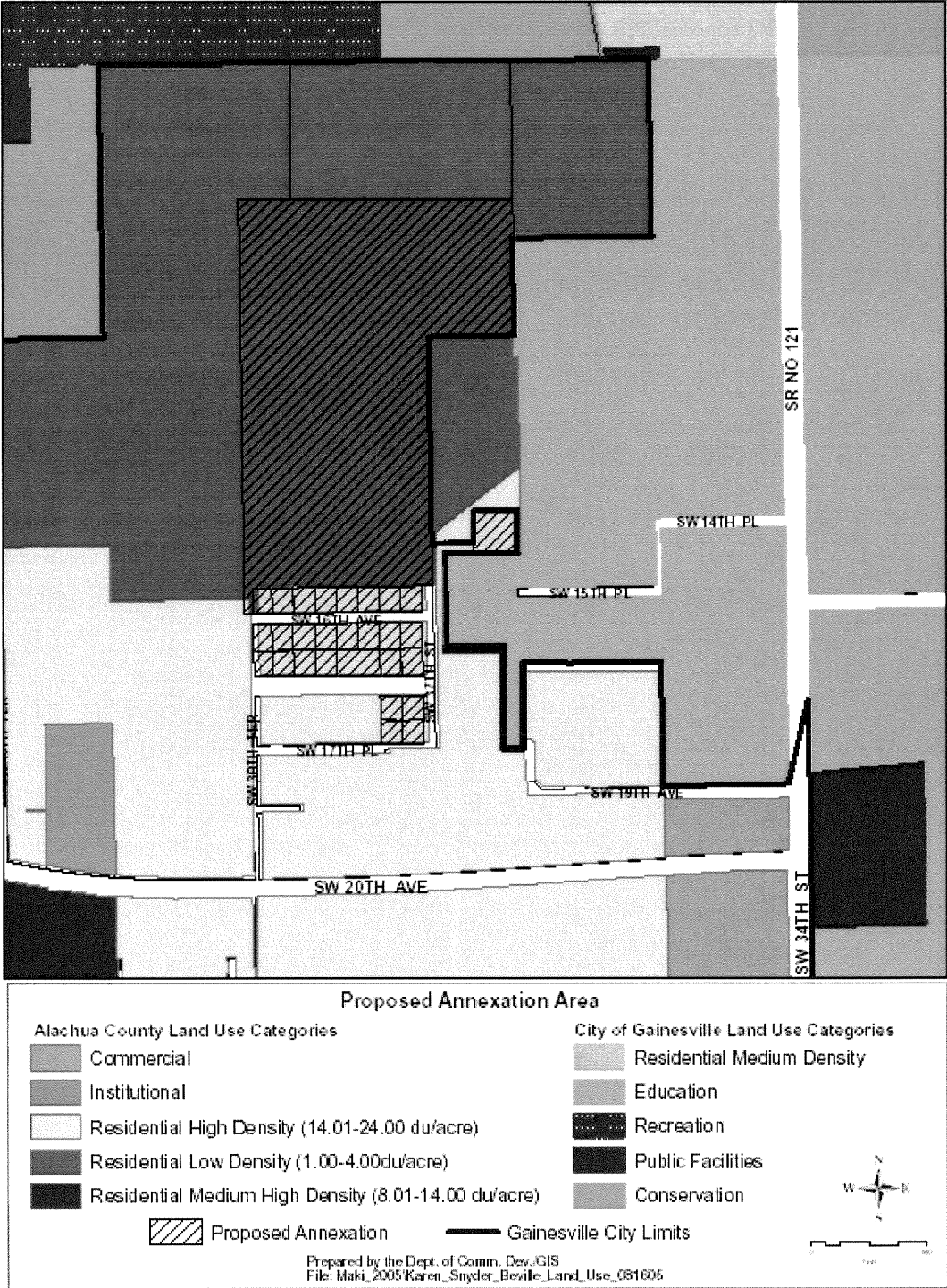

Figure 3: Major Water Mains

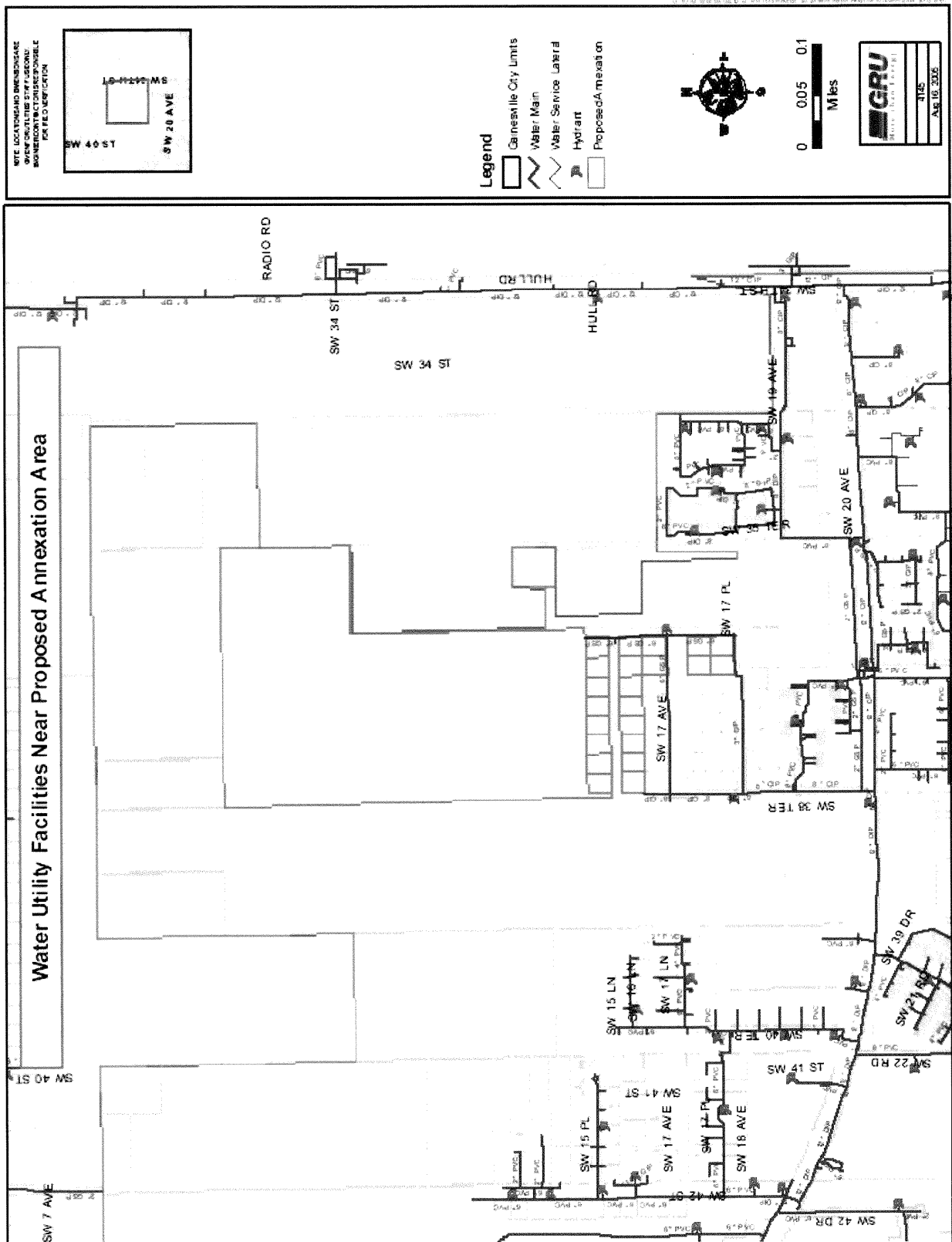

Figure 4: Major Water Systems Projects

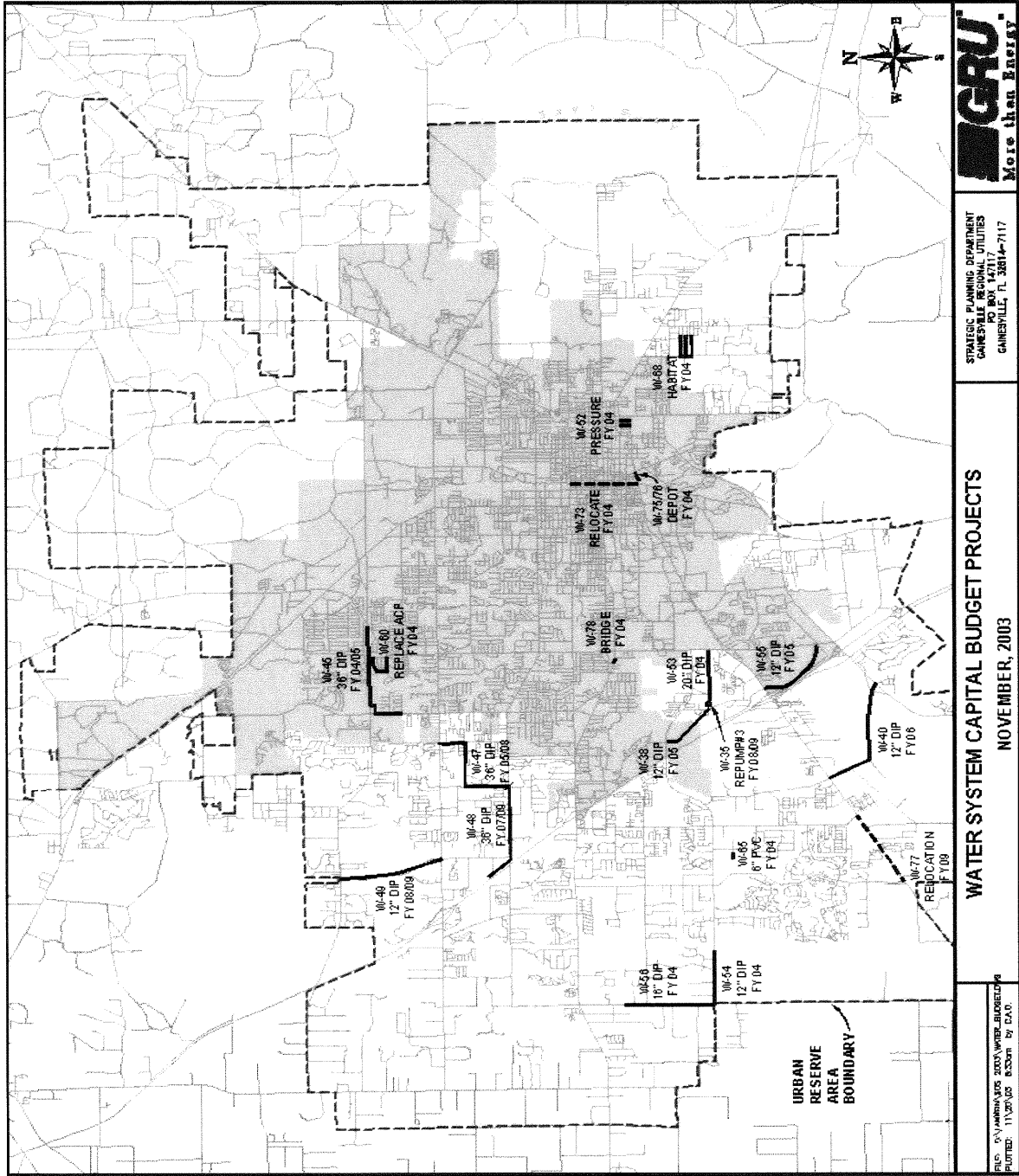

Figure 5: Wastewater Utility Facilities

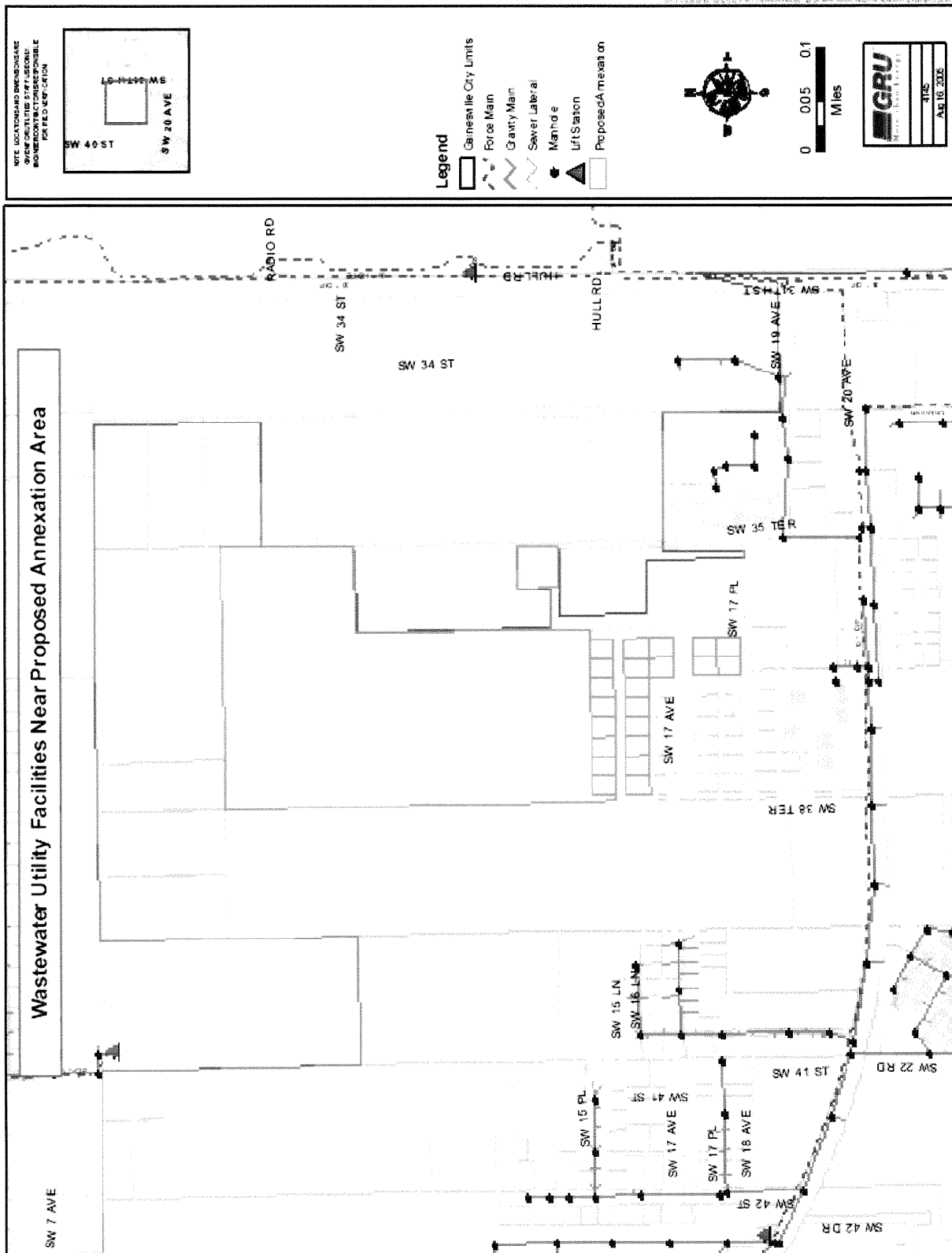

Figure 6: Wastewater Collection System Projects

