

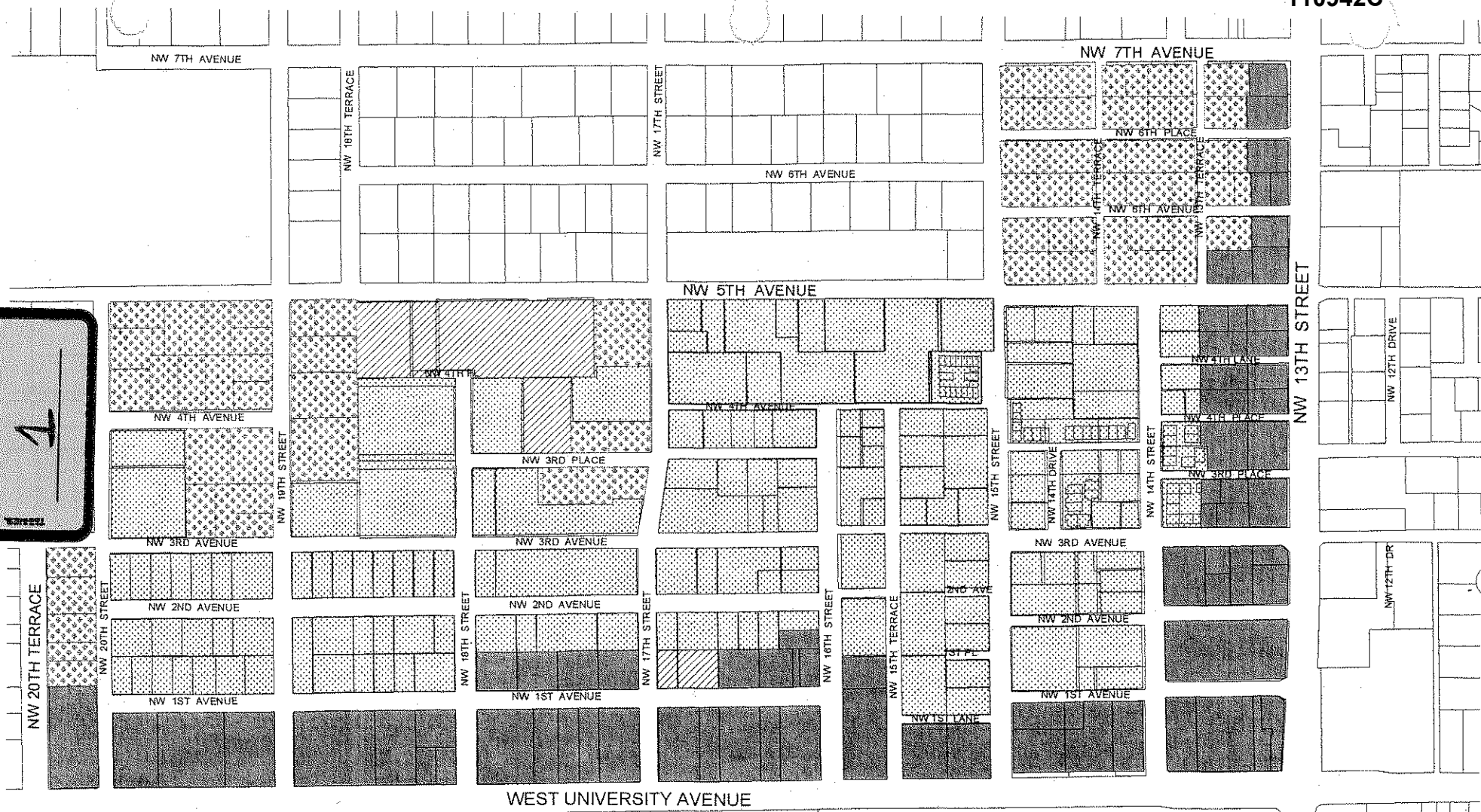

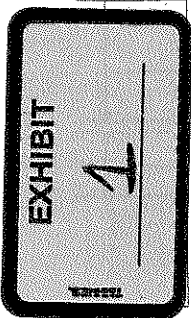



LEGISLATIVE #

110942C



College Park

Master Plan & Regulating Plan for New Construction

-  Type I - Shopfront/Office/Apartment
-  Type II - Apartment/House
-  Type III - House
-  Type IV - Civic
-  College Park Boundary

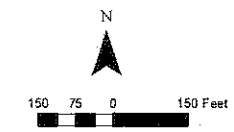

City of Gainesville, FL
Prepared by the
Dept of Community Development
June 2007