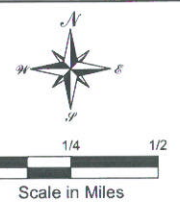
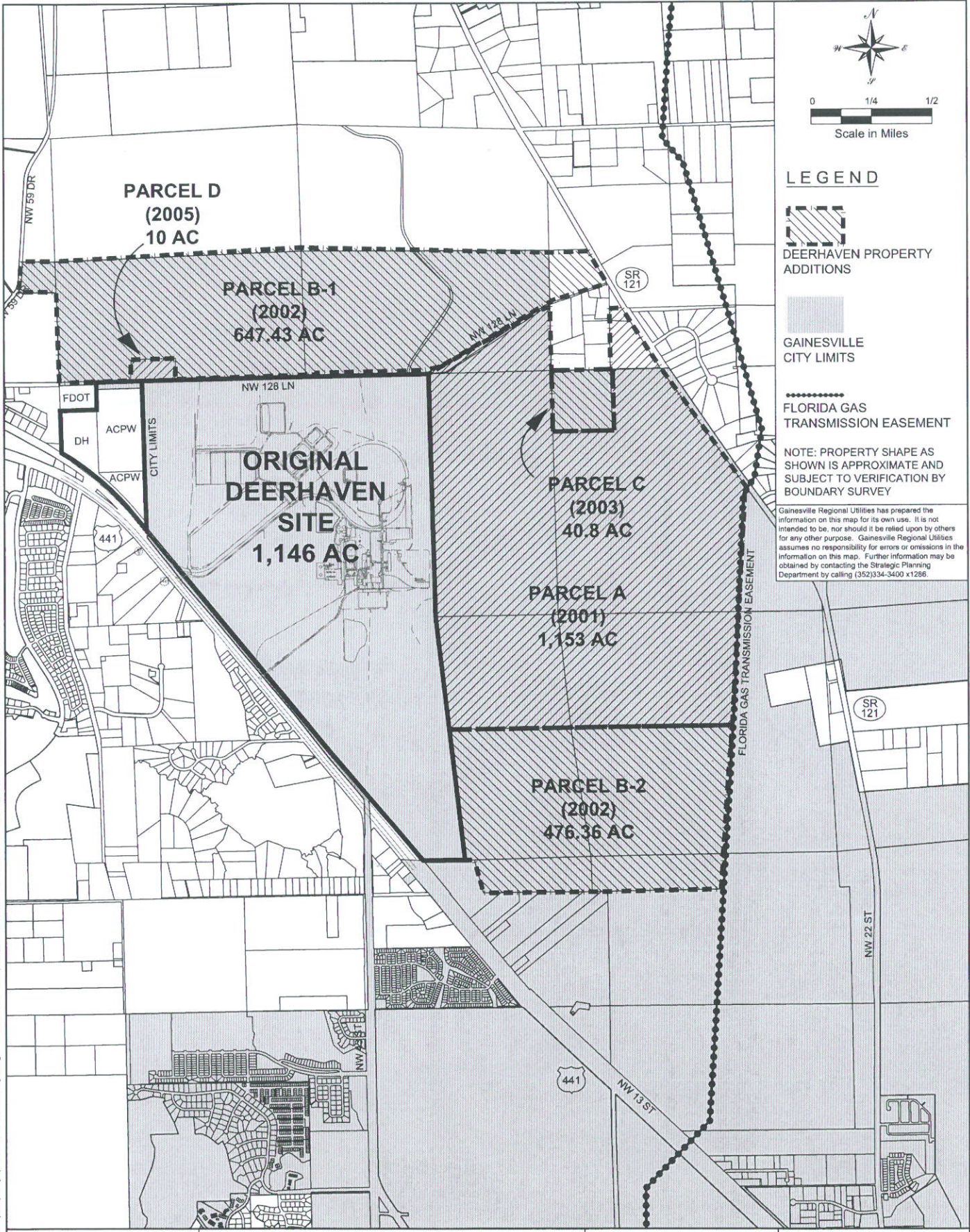

EXHIBIT D

D:\Deerhaven\Property\Purchase Summary.dwg PLOTTED: 02/02/09 7:36am by C.A.O. XREFS: DHSITE XREF & PLSS & LBL & RTEXT & CITYLIM & ACPA_PublicMapCD Layout tab: 8x11



LEGEND

- DEERHAVEN PROPERTY ADDITIONS
- GAINESVILLE CITY LIMITS
- FLORIDA GAS TRANSMISSION EASEMENT

NOTE: PROPERTY SHAPE AS SHOWN IS APPROXIMATE AND SUBJECT TO VERIFICATION BY BOUNDARY SURVEY

Gainesville Regional Utilities has prepared the information on this map for its own use. It is not intended to be, nor should it be relied upon by others for any other purpose. Gainesville Regional Utilities assumes no responsibility for errors or omissions in the information on this map. Further information may be obtained by contacting the Strategic Planning Department by calling (352)334-3400 x1286.

**DEERHAVEN GENERATING STATION
PROPERTY**

STRATEGIC PLANNING DEPARTMENT
GAINESVILLE REGIONAL UTILITIES
PO BOX 147117
GAINESVILLE, FL 32614-7117



FILE: D:\Deerhaven\Property\Purchase Summary.dwg
PLOTTED: 02/02/09 7:36am by C.A.O.