

Proposed 302 units



A09000913  
 2114 NW 40th Terrace B-3  
 Gainesville, Florida 32605 P 352.377.0505  
 F 352.377.0590

WOODLAND PARK REDEVELOPMENT

Gainesville, Florida

SCHEMATIC DESIGN

VERIFY SCALE  
 0' = 1" BAR LENGTH IS ONE INCH ON ORIGINAL DRAWING

ARCHITECT'S PROJECT NUMBER: PP-15001

DRAWN BY: PM

DATE: 06.02.15

REVISIONS: DATE XXXX

DESCRIPTION XXXX

SITE PLAN DEVELOPMENT DATA

A0.10

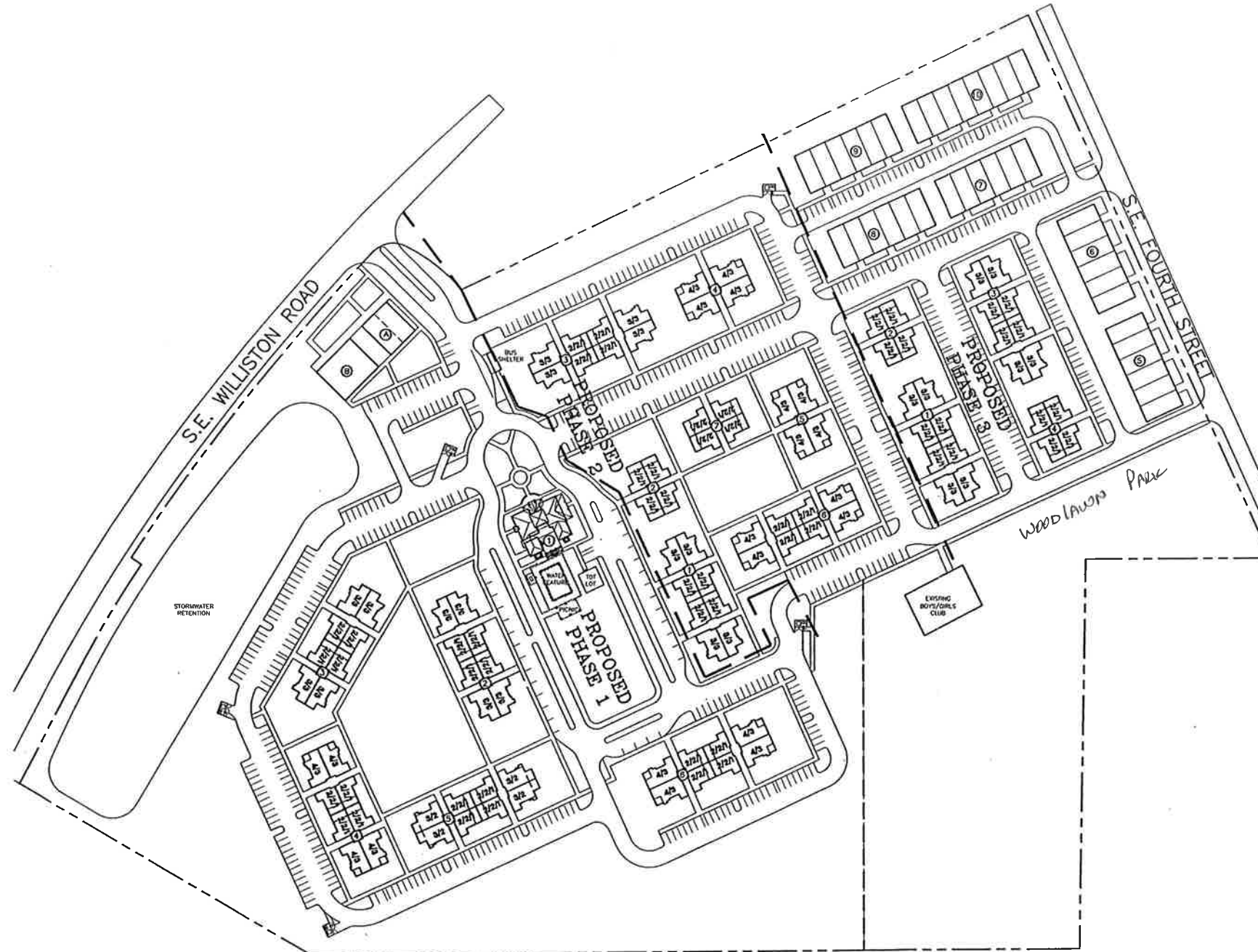

**BUILDING SUMMARY - PROPOSED PHASE ONE**

| BUILDING DESIGNATION | BUILDING TYPE | BUILDING CONFIGURATION |           |           |           | UNIT AREA |           |           |           | TOTAL NET AREA ** | UNITS/ BLDG | # OF STORES | G.S.F./ BLDG |
|----------------------|---------------|------------------------|-----------|-----------|-----------|-----------|-----------|-----------|-----------|-------------------|-------------|-------------|--------------|
|                      |               | 1-BR 1-BA              | 2-BR 2-BA | 3-BR 2-BA | 4-BR 2-BA | 1-BR 1-BA | 2-BR 2-BA | 3-BR 2-BA | 4-BR 2-BA |                   |             |             |              |
| A                    | COMMERCIAL    |                        |           |           |           |           |           |           |           |                   | 1           | 1           | 3,000        |
| B                    | CHA OFFICE    |                        |           |           |           |           |           |           |           |                   | 1           | 1           | 4,200        |
| C                    | CLUBHOUSE     |                        |           |           |           |           |           |           |           |                   | 1           | 1           | 3,400        |
| 2                    | APARTMENT     | 6                      | 8         | 8         | 0         | 705       | 990       | 1,180     | 1,290     | 20160             | 20          | 26.3        | 25,360       |
| 3                    | APARTMENT     | 6                      | 8         | 8         | 0         | 705       | 990       | 1,180     | 1,290     | 20160             | 20          | 26.3        | 25,360       |
| 4                    | APARTMENT     | 4                      | 8         | 8         | 4         | 705       | 890       | 1,180     | 1,290     | 20620             | 20          | 26.3        | 25,800       |
| 5                    | APARTMENT     | 4                      | 12        | 4         | 0         | 705       | 990       | 1,180     | 1,290     | 19420             | 20          | 26.3        | 24,500       |
| 6                    | APARTMENT     | 4                      | 8         | 4         | 4         | 705       | 990       | 1,180     | 1,290     | 20620             | 20          | 26.3        | 25,800       |
| TOTALS               |               | 20                     | 44        | 28        | 8         |           |           |           |           | 101,020           | 100         |             | 137,520      |

\*\* NET AREA IS THE UNIT SPACE THAT IS AVAILABLE EXCLUSIVELY TO THE TENANT AND IS HEATED & COOLED BY A MECHANICAL HVAC SYSTEM. NET AREA IS MEASURED TO THE OUTSIDE OF THE STUDS OF A UNIT OR TO THE MIDDLE OF WALLS IN COMMON WITH OTHER UNITS. NET AREA DOES NOT INCLUDE COMMON HALLWAYS, STAIRWELLS, ELEVATOR SHAFTS, JANITOR CLOSETS, ELECTRICAL CLOSETS, BALCONIES, PORCHES, PATIOS, OR OTHER AREAS NOT ACTUALLY AVAILABLE TO THE TENANTS FOR THEIR FURNISHINGS.

\*\*\* BUILDING AREA AS DEFINED IN THE FLORIDA BUILDING CODE AS THE AREA INCLUDED WITHIN THE SURROUNDING EXTERIOR WALLS EXCLUSIVE OF VENT SHAFTS & COURTS. (INCLUDES BREZZEWAY, PORCH AREAS & EXTERIOR CLOSETS)

TOTAL DWELLING UNITS = 100  
 8'X18' PARKING SPACES = 342  
 10'X12' PARKING SPACES = 245  
 TOTAL PARKING SPACES = 247

CLUBHOUSE AREA IS GROSS AREA MEASURED TO THE OUTSIDE OF THE ENCLOSING STUD WALLS.

LEASABLE HANDICAP UNITS SUMMARY  
 MOBILITY, HEARING & VISUAL  
 8X x 100 = 3 UNITS  
 LABELED UNITS/BLDG INC UNIT ON SITE PLAN  
 HEARING & VISUAL  
 2X x 100 = 2 UNITS  
 LABELED BY UNIT ON SITE PLAN

**BUILDING SUMMARY - PROPOSED PHASE TWO**

| BUILDING DESIGNATION | BUILDING TYPE | BUILDING CONFIGURATION |           |           |           | UNIT AREA |           |           |           | TOTAL NET AREA ** | UNITS/ BLDG | # OF STORES | G.S.F./ BLDG |
|----------------------|---------------|------------------------|-----------|-----------|-----------|-----------|-----------|-----------|-----------|-------------------|-------------|-------------|--------------|
|                      |               | 1-BR 1-BA              | 2-BR 2-BA | 3-BR 2-BA | 4-BR 2-BA | 1-BR 1-BA | 2-BR 2-BA | 3-BR 2-BA | 4-BR 2-BA |                   |             |             |              |
| 1                    | APARTMENT     | 4                      | 8         | 8         | 0         | 705       | 890       | 1,180     | 1,290     | 20160             | 20          | 26.3        | 25,360       |
| 2                    | APARTMENT     | 4                      | 8         | 0         | 0         | 705       | 890       | 1,180     | 1,290     | 10740             | 13          | 3           | 13,640       |
| 3                    | APARTMENT     | 4                      | 8         | 8         | 0         | 705       | 890       | 1,180     | 1,290     | 20160             | 20          | 26.3        | 25,360       |
| 4                    | APARTMENT     | 0                      | 0         | 4         | 4         | 705       | 890       | 1,180     | 1,290     | 9800              | 8           | 2           | 11,830       |
| 5                    | APARTMENT     | 0                      | 0         | 4         | 4         | 705       | 890       | 1,180     | 1,290     | 9800              | 8           | 2           | 11,830       |
| 6                    | APARTMENT     | 4                      | 8         | 4         | 4         | 705       | 890       | 1,180     | 1,290     | 20620             | 20          | 26.3        | 25,800       |
| 7                    | APARTMENT     | 4                      | 8         | 0         | 0         | 705       | 890       | 1,180     | 1,290     | 10740             | 13          | 3           | 13,640       |
| TOTALS               |               | 20                     | 40        | 28        | 12        |           |           |           |           | 102,220           | 100         |             | 127,460      |

\*\* NET AREA IS THE UNIT SPACE THAT IS AVAILABLE EXCLUSIVELY TO THE TENANT AND IS HEATED & COOLED BY A MECHANICAL HVAC SYSTEM. NET AREA IS MEASURED TO THE OUTSIDE OF THE STUDS OF A UNIT OR TO THE MIDDLE OF WALLS IN COMMON WITH OTHER UNITS. NET AREA DOES NOT INCLUDE COMMON HALLWAYS, STAIRWELLS, ELEVATOR SHAFTS, JANITOR CLOSETS, ELECTRICAL CLOSETS, BALCONIES, PORCHES, PATIOS, OR OTHER AREAS NOT ACTUALLY AVAILABLE TO THE TENANTS FOR THEIR FURNISHINGS.

\*\*\* BUILDING AREA AS DEFINED IN THE FLORIDA BUILDING CODE AS THE AREA INCLUDED WITHIN THE SURROUNDING EXTERIOR WALLS EXCLUSIVE OF VENT SHAFTS & COURTS. (INCLUDES BREZZEWAY, PORCH AREAS & EXTERIOR CLOSETS)

TOTAL DWELLING UNITS = 100  
 8'X18' PARKING SPACES = 250  
 10'X12' PARKING SPACES = 6  
 TOTAL PARKING SPACES = 256

CLUBHOUSE AREA IS GROSS AREA MEASURED TO THE OUTSIDE OF THE ENCLOSING STUD WALLS.

LEASABLE HANDICAP UNITS SUMMARY  
 MOBILITY, HEARING & VISUAL  
 8X x 100 = 6 UNITS  
 LABELED UNITS/BLDG INC UNIT ON SITE PLAN  
 HEARING & VISUAL  
 2X x 100 = 2 UNITS  
 LABELED BY UNIT ON SITE PLAN

**BUILDING SUMMARY - PROPOSED PHASE THREE**

| BUILDING DESIGNATION | BUILDING TYPE | BUILDING CONFIGURATION |           |           |             | UNIT AREA |           |           |             | TOTAL NET AREA ** | UNITS/ BLDG | # OF STORES | G.S.F./ BLDG |
|----------------------|---------------|------------------------|-----------|-----------|-------------|-----------|-----------|-----------|-------------|-------------------|-------------|-------------|--------------|
|                      |               | 1-BR 1-BA              | 2-BR 2-BA | 3-BR 2-BA | 3-BR 2.5-BA | 1-BR 1-BA | 2-BR 2-BA | 3-BR 2-BA | 3-BR 2.5-BA |                   |             |             |              |
| 1                    | APARTMENT     | 4                      | 8         | 8         | 0           | 705       | 890       | 1,180     | 1,445       | 20160             | 20          | 26.3        | 25,360       |
| 2                    | APARTMENT     | 4                      | 8         | 0         | 0           | 705       | 890       | 1,180     | 1,445       | 10740             | 13          | 3           | 13,640       |
| 3                    | APARTMENT     | 4                      | 8         | 8         | 0           | 705       | 890       | 1,180     | 1,445       | 20160             | 20          | 26.3        | 25,360       |
| 4                    | APARTMENT     | 4                      | 8         | 0         | 0           | 705       | 890       | 1,180     | 1,445       | 10740             | 13          | 3           | 13,640       |
| 5                    | TOWNHOME      | 0                      | 0         | 0         | 0           | 705       | 890       | 1,180     | 1,445       | 8670              | 8           | 2           | 10,590       |
| 6                    | TOWNHOME      | 0                      | 0         | 0         | 0           | 705       | 890       | 1,180     | 1,445       | 8670              | 8           | 2           | 10,590       |
| 7                    | TOWNHOME      | 0                      | 0         | 0         | 0           | 705       | 890       | 1,180     | 1,445       | 8670              | 8           | 2           | 10,590       |
| 8                    | TOWNHOME      | 0                      | 0         | 0         | 0           | 705       | 890       | 1,180     | 1,445       | 8670              | 8           | 2           | 10,590       |
| 9                    | TOWNHOME      | 0                      | 0         | 0         | 0           | 705       | 890       | 1,180     | 1,445       | 8670              | 8           | 2           | 10,590       |
| 10                   | TOWNHOME      | 0                      | 0         | 0         | 0           | 705       | 890       | 1,180     | 1,445       | 11560             | 8           | 2           | 10,590       |
| TOTALS               |               | 16                     | 32        | 16        | 0           |           |           |           |             | 116,750           | 102         |             | 138,180      |

\*\* NET AREA IS THE UNIT SPACE THAT IS AVAILABLE EXCLUSIVELY TO THE TENANT AND IS HEATED & COOLED BY A MECHANICAL HVAC SYSTEM. NET AREA IS MEASURED TO THE OUTSIDE OF THE STUDS OF A UNIT OR TO THE MIDDLE OF WALLS IN COMMON WITH OTHER UNITS. NET AREA DOES NOT INCLUDE COMMON HALLWAYS, STAIRWELLS, ELEVATOR SHAFTS, JANITOR CLOSETS, ELECTRICAL CLOSETS, BALCONIES, PORCHES, PATIOS, OR OTHER AREAS NOT ACTUALLY AVAILABLE TO THE TENANTS FOR THEIR FURNISHINGS.

\*\*\* BUILDING AREA AS DEFINED IN THE FLORIDA BUILDING CODE AS THE AREA INCLUDED WITHIN THE SURROUNDING EXTERIOR WALLS EXCLUSIVE OF VENT SHAFTS & COURTS. (INCLUDES BREZZEWAY, PORCH AREAS & EXTERIOR CLOSETS)

TOTAL DWELLING UNITS = 102  
 8'X18' PARKING SPACES = 134  
 10'X12' PARKING SPACES = 10  
 TOTAL PARKING SPACES = 144

CLUBHOUSE AREA IS GROSS AREA MEASURED TO THE OUTSIDE OF THE ENCLOSING STUD WALLS.

LEASABLE HANDICAP UNITS SUMMARY  
 MOBILITY, HEARING & VISUAL  
 8X x 100 = 6 UNITS  
 LABELED UNITS/BLDG INC UNIT ON SITE PLAN  
 HEARING & VISUAL  
 2X x 100 = 3 UNITS  
 LABELED BY UNIT ON SITE PLAN

ARCHITECTURAL SITE PLAN

