

# EXHIBIT 3

STATE OF FLORIDA  
DEPARTMENT OF STATE  
Division of Archives, History  
and Records Management  
DS-HSP-3AAA Rev. 3-79

## FLORIDA MASTER SITE FILE Site Inventory Form

FDAHRM 802 = =  
1009 = =

Site Name \_\_\_\_\_ Site No. 8 AC 1143  
Address of Site: 1211 SW 4th Ave 830 = = Survey Date 8007 820 = =  
Instruction for locating \_\_\_\_\_ 905 = =

Location: University Heights (see tax roll no. 13135) 813 = =  
subdivision name 9 block no. 20 lot no. 868 = =

County: Alachua 808 = =

Owner of Site: Name: Hughes, Mariann i

Address: 402 SW 12th St

Gainesville, FL 902 = =

Type of Ownership private 848 = = Recording Date \_\_\_\_\_ 832 = =

Recorder: \_\_\_\_\_

Name & Title: Ann DeRosa Byrne, (Consultant) i

Address: The History Group 300 W. Peachtree St.

Suite 16 DE Atlanta, Ga. 30308 818 = =

Condition of Site: Integrity of Site: \_\_\_\_\_ Original Use private residence 838 = =

Check One	Check One or More	Present Use <u>private residence</u> 850 = =
<input type="checkbox"/> Excellent 863 = =	<input type="checkbox"/> Altered 858 = =	Dates: Beginning _____ 844 = =
<input checked="" type="checkbox"/> Good 863 = =	<input type="checkbox"/> Unaltered 858 = =	Culture/Phase <u>American</u> 840 = =
<input type="checkbox"/> Fair 863 = =	<input type="checkbox"/> Original Site 858 = =	Period <u>20th century</u> 845 = =
<input type="checkbox"/> Deteriorated 863 = =	<input type="checkbox"/> Restored ( ) (Date: <u>X</u> ) 858 = =	
	<input type="checkbox"/> Moved ( ) (Date: <u>X</u> ) 858 = =	

NR Classification Category: building 916 = =

Threats to Site: \_\_\_\_\_

Check One or More	
<input type="checkbox"/> Zoning ( <u>X</u> ) 878 = =	<input type="checkbox"/> Transportation ( <u>X</u> ) 878 = =
<input type="checkbox"/> Development ( <u>X</u> ) 878 = =	<input type="checkbox"/> Fill ( <u>X</u> ) 878 = =
<input type="checkbox"/> Deterioration ( <u>X</u> ) 878 = =	<input type="checkbox"/> Dredge ( <u>X</u> ) 878 = =
<input type="checkbox"/> Borrowing ( <u>X</u> ) 878 = =	
<input type="checkbox"/> Other (See Remarks Below): _____ 878 = =	

Areas of Significance: architecture, local history 910 = =

Significance:

2-story, imbricated shingle dwelling with jerkinhead roof.  
House is located in University Heights subdivision, 1912.

SEE SITE FILE STAFF FOR  
ORIGINAL PHOTO(S) OR MAP(S)

911 = =

ARCHITECT \_\_\_\_\_ 872 ==  
 BUILDER \_\_\_\_\_ 874 ==  
 STYLE AND/OR PERIOD frame vernacular#WWI-WWII 904 ==  
 PLAN TYPE rectangular; irregular 906 ==  
 EXTERIOR FABRIC(S) wood: imbricated shingle 854 ==  
 STRUCTURAL SYSTEM(S) wood frame: balloon 856 ==  
 PORCHES \_\_\_\_\_  
 \_\_\_\_\_ 942 ==  
 FOUNDATION: pier 942 ==  
 ROOF TYPE: jerkinhead 942 ==  
 SECONDARY ROOF STRUCTURE(S): entry porch: jerkinhead 942 ==  
 CHIMNEY LOCATION: \_\_\_\_\_ 942 ==  
 WINDOW TYPE: DHS, wood 942 ==  
 CHIMNEY: \_\_\_\_\_ 882 ==  
 ROOF SURFACING: composition shingles 882 ==  
 ORNAMENT EXTERIOR: \_\_\_\_\_ 882 ==  
 NO. OF CHIMNEYS 952 == NO. OF STORIES 2 950 ==  
 NO. OF DORMERS \_\_\_\_\_ 954 ==  
 Map Reference (incl. scale & date) \_\_\_\_\_  
 \_\_\_\_\_ 809 ==  
 Latitude and Longitude: \_\_\_\_\_  
 \_\_\_\_\_ 800 ==  
 Site Size (Approx. Acreage of Property): LT 1 833 ==

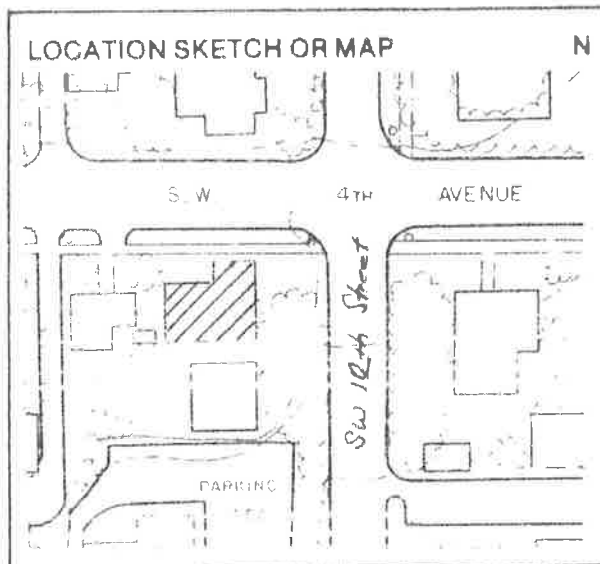

Township	Range	Section
10S	20E	05

812 ==

UTM Coordinates:

Zone Easting Northing

890 ==

14D11

860 ==

Photographic Records Numbers

Contact Print



[Previous](#) | [Next](#) | Record 1 of 1**FMSFweb****Quick Search**  
(Enter SiteID or MS#)[New Search](#)[Back to Results](#)[Print/Save Report](#)[View Scanned  
Forms &  
Documents](#)

<b>AL1143 - 1211 SW 4TH AVE</b>	Historic Structure
<b>SHPO Evaluation</b> Not Evaluated by SHPO	
<b>Address</b> 1211 SW 4TH AVE	
<b>Structure Uses</b> Private Residence (House/Cottage/Cabin)	
<b>Style</b> Frame Vernacular	
<b>Exterior Fabrics</b> Wood shingles	
<b>Roof Type</b> Clipped gable Gable on hip	
<b>City</b> GAINESVILLE	
<b>Township   Range   Section</b> 10S   20E   5	
<b>Field Visit Dates</b>	