

LEGISLATIVE #

110557D

Petition PB-11-126 ZON
November 1, 2011

Appendix B – Supplemental Documents

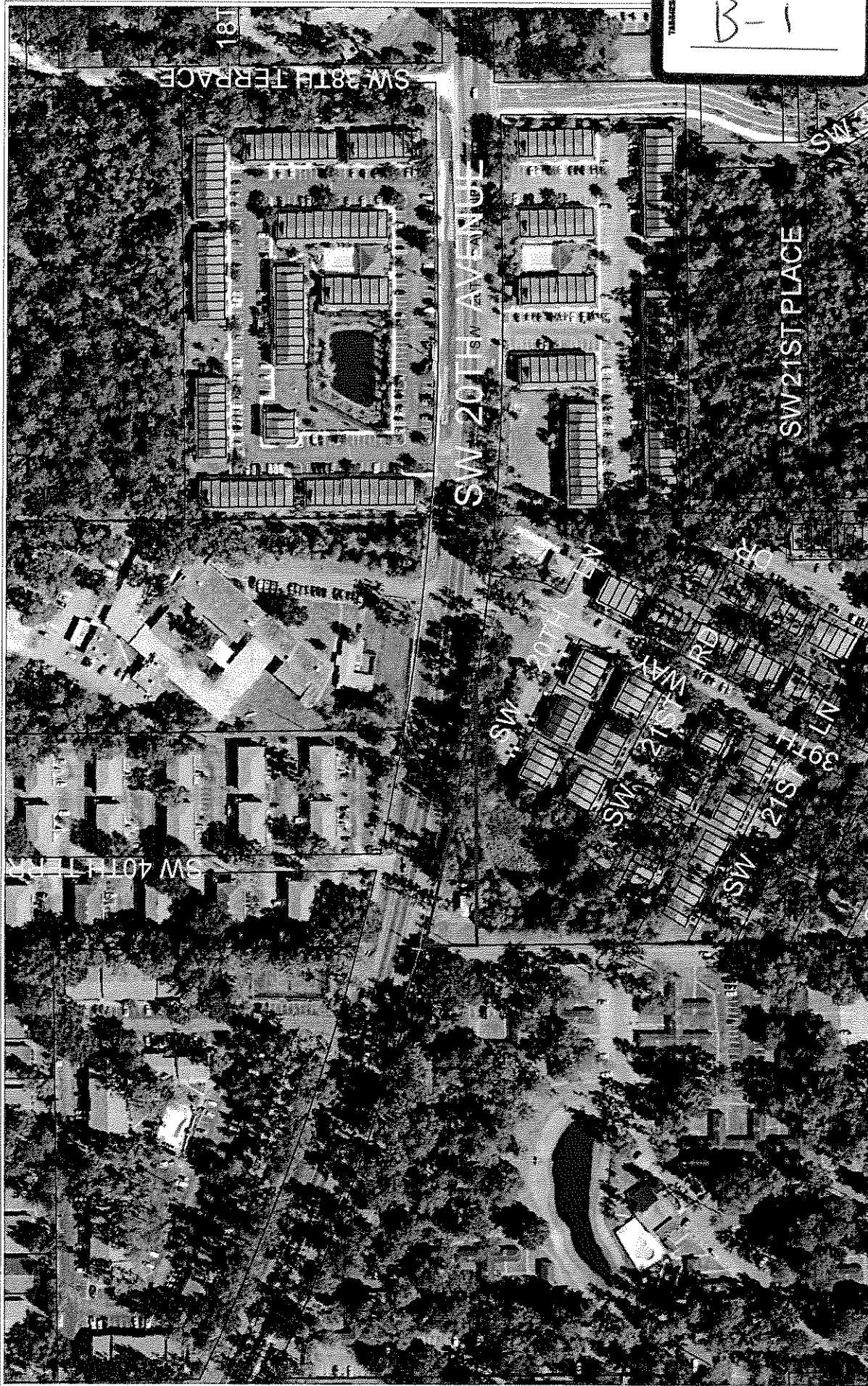

AERIAL PHOTOGRAPH

<p>Name</p> <p>City Plan Board, applicant</p>	<p>Petition Request</p> <p>Rezone from Alachua County PD district to City of Gainesville PS district.</p>	<p>Map(s)</p> <p>4244</p>	<p>Petition Number</p> <p>PB-11-126 ZON</p>
--	--	----------------------------------	--

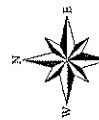

No Scale

EXHIBIT
B-2

Alachua County Zoning Districts

- PD Planned Development
- R-2 Multi-Family, Medium-High Density Residential (8-14 units/acre)
- R-3 Multi-Family, High Density Residential (14 to 24 units/acre)

Area under petition consideration

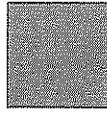
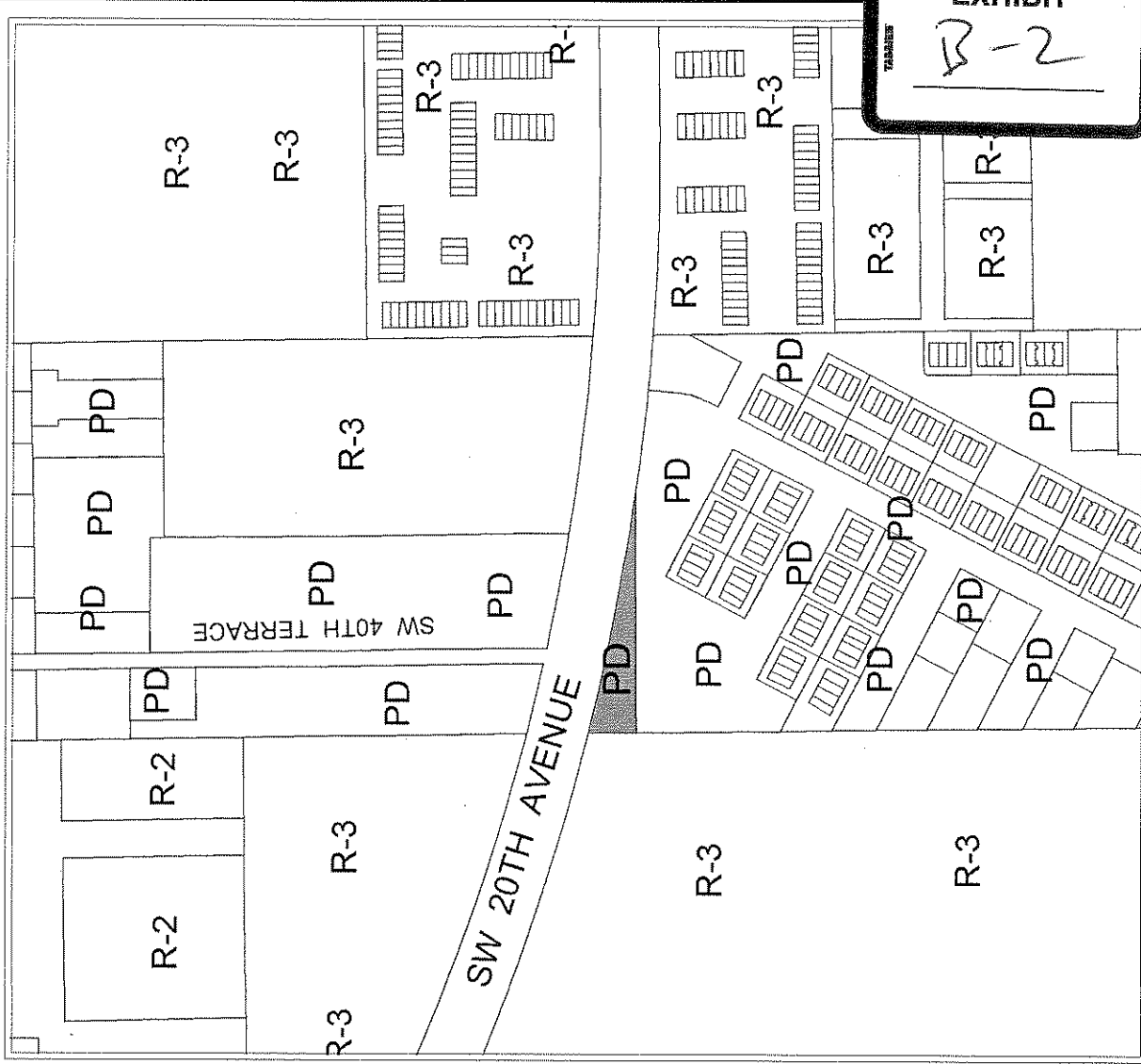
EXISTING ZONING

Name	Petition Request	Map(s)	Petition Number
City Plan Board, applicant	Rezone from Alachua County PD district to City of Gainesville PS district.	4244	PB-11-126 ZON



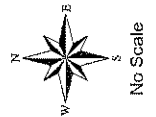

**Alachua County
Zoning Districts**

- PD Planned Development
- R-2 Multi-Family, Medium Density Residential (4-8 units/acre)
- R-3 Multi-Family, High Density Residential (14 to 24 units/acre)

**City of Gainesville
Zoning Districts**

- PS Public Services and Operations

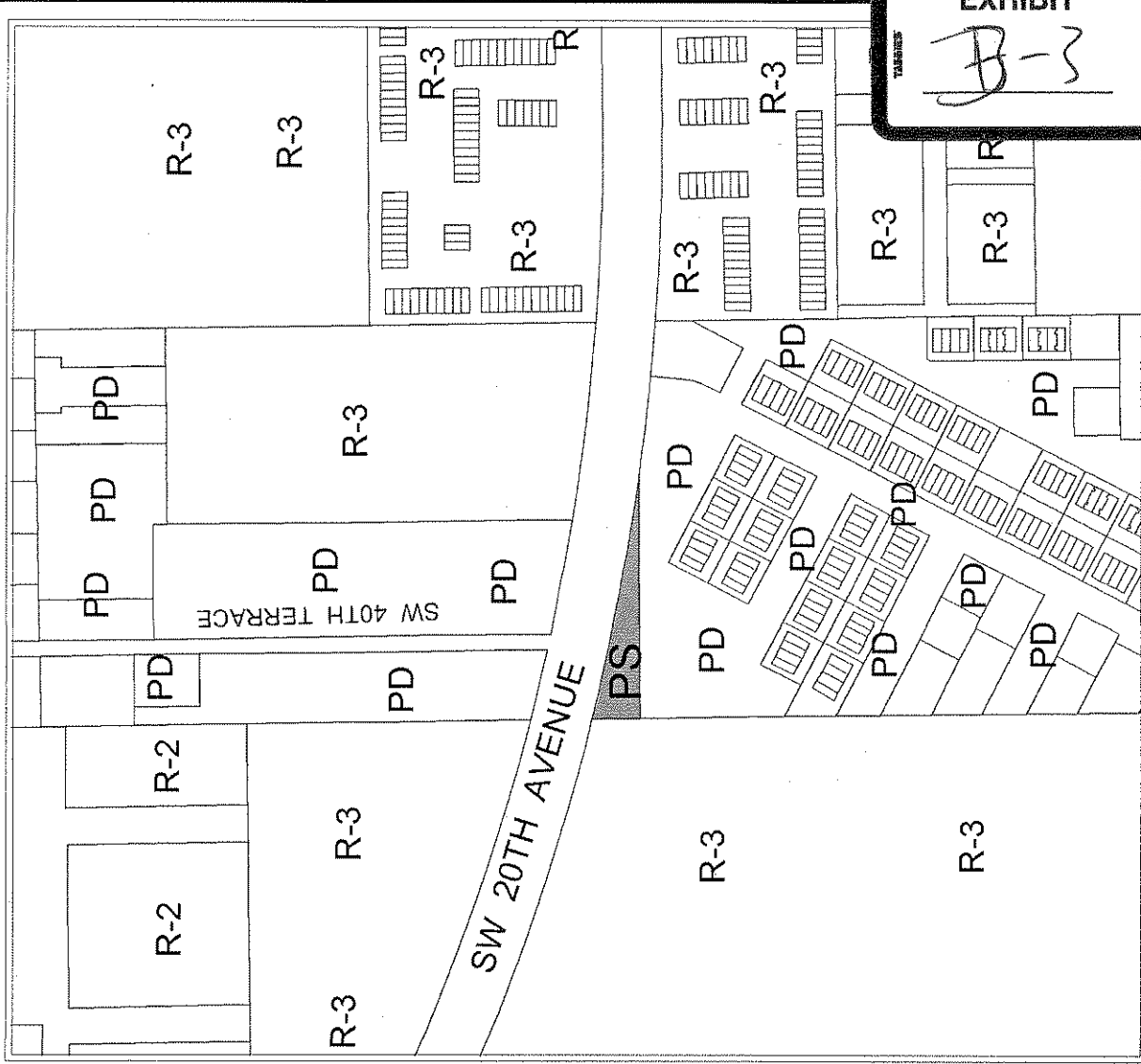
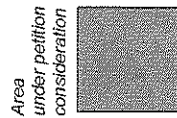

PROPOSED ZONING

Name	Petition Request	Map(s)	Petition Number
City Plan Board, applicant	Rezone from Alachua County PD district to City of Gainesville PS district.	4244	PB-11-126 ZON



No Scale