

**Walmart**

**MASTER DEVELOPMENT PLAN** 090906 c

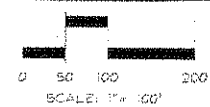
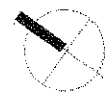

Engineers  
Architects  
Surveyors  
Planners  
Landscape Architects  
Environmental Scientists  
Construction Management  
Design / Build

800 Wood Eufemia Street  
Gainesville, FL 32609  
352-321-2600  
Phone: 807.232.0841  
Fax: 807.536.0639

March, 2010

0710466.1

# PROPOSED DEVELOPMENT PLANS FOR



090906

## STORE NO. 538-05 GAINESVILLE, FLORIDA S.W.Q. OF NW 34<sup>TH</sup> STREET (SR 121) & NW 58<sup>TH</sup> AVENUE

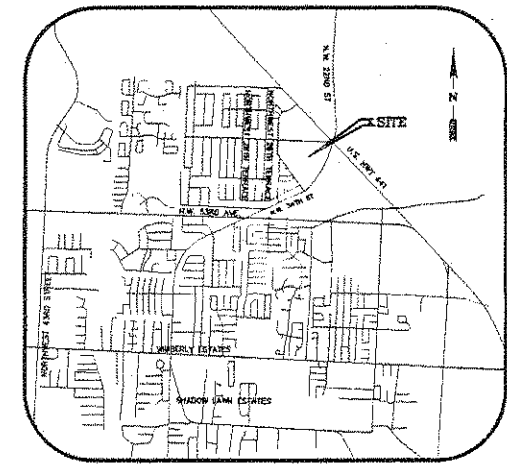

GAINESVILLE EAST, FL (U.S.G.S. MAP)  
SECTION 13, TOWNSHIP 9 SOUTH, RANGE 19 EAST  
SECTION 18, TOWNSHIP 9 SOUTH, RANGE 20 EAST  
**VICINITY MAP**  
N.T.S.

**CPH**  
500 West Fulton Street  
Sanford, Florida 32771  
P. O. Box 2906  
Sanford, Florida 32772-2906  
Phone: 407-322-6841  
Fax: 407-330-4639

Engineers  
Surveyors  
Architects  
Planners  
Landscape Architects  
Environmental Scientists  
Construction Management  
Traffic/Transportation

Eng. C.O.A. No. 3213  
Survey L.B. No. 7143  
Arch. Lic. No. AA2688926  
Landscape Lic. No. LC0600298  
© 2010

### DEVELOPER

WAL - MART STORES EAST, L.P.  
2001 S.E. 10<sup>TH</sup> STREET  
BENTONVILLE, ARKANSAS 72716  
(479) 273-4000

### ARCHITECT

BRR ARCHITECTURE  
6700 ANTIOCH PLAZA, SUITE 300  
MERRIAM, KANSAS 66204  
(913) 262-9095  
ATTN: MICHAEL BLINN, AIA

### ENGINEER

CPH ENGINEERS, INC.  
500 WEST FULTON STREET  
SANFORD, FLORIDA 32771  
(407) 322-6841  
ATTN: H. LARRY WRAY, P.E.

### SURVEYOR

CPH ENGINEERS, INC.  
500 WEST FULTON STREET  
SANFORD, FLORIDA 32771  
(407) 322-6841  
ATTN: PAUL J. KATREK, P.S.M.

### SOILS CONSULTANT

ECS - FLORIDA, LLC  
2815 DIRECTORS ROW, SUITE 500  
ORLANDO, FLORIDA 32809  
(407) 859-8378  
ATTN: J. CAIN DIEHL, P.G.

### ENVIRONMENTAL CONSULTANT

ECOSYSTEMS RESEARCH  
CORPORATION  
2906 NW 142<sup>ND</sup> AVENUE  
GAINESVILLE, FLORIDA 32609  
(386) 462-5005  
ATTN: PETER M. WALLACE

ADJACENT DEVELOPMENT	LOCATION
NW 62ND AVE, NORTHWOOD VILLAGE SHOPPING CENTER	NORTH
DRIVER LICENSE OFFICE, LIQUOR STORE	EAST
NW 34TH STREET, NORTHSIDE PARK	SOUTH-EAST
PINERIDGE RESIDENTIAL SUBDIVISION, GAS FUELING STATION	SOUTH-WEST
PINERIDGE RESIDENTIAL SUBDIVISION	WEST

### WATER & SEWER SERVICE

GAINESVILLE REGIONAL UTILITIES  
301 S.E. 4<sup>TH</sup> AVENUE  
GAINESVILLE, FLORIDA 32601  
(352) 393-1644

### ELECTRIC SERVICE

GAINESVILLE REGIONAL UTILITIES  
301 S.E. 4<sup>TH</sup> AVENUE  
GAINESVILLE, FLORIDA 32601  
(352) 393-1644

### PERMITTING AGENCIES

CITY OF GAINESVILLE  
306 NE 6<sup>TH</sup> AVENUE  
GAINESVILLE, FLORIDA 32602  
(352) 334-5023

SUWANNEE RIVER WATER MANAGEMENT DISTRICT  
9225 CR 49  
LIVE OAK, FLORIDA 32060  
(386) 362-1001

GAINESVILLE REGIONAL UTILITIES  
301 SE 4<sup>TH</sup> AVENUE  
GAINESVILLE, FLORIDA 32601  
(352) 393-1644

FLORIDA DEPARTMENT OF TRANSPORTATION  
5301 NE 39<sup>TH</sup> AVENUE  
GAINESVILLE, FLORIDA 32609  
(352) 381-4314

### INDEX OF SHEETS

C-1	COVER SHEET
C-2	ALTA/ACSM LAND TITLE SURVEY (COVER SHEET)
C-2A	ALTA/ACSM LAND TITLE SURVEY (LEGAL)
C-2B	ALTA/ACSM LAND TITLE SURVEY (BOUNDARY SURVEY)
C-2C - C-2G	ALTA/ACSM LAND TITLE SURVEY (TOPOGRAPHIC SURVEY)
C-2H	ALTA/ACSM LAND TITLE SURVEY (TREE, UTILITIES & WETLANDS)
C-3	PHASE I EROSION & SEDIMENTATION CONTROL
C-3A	PHASE I EROSION & SEDIMENTATION CONTROL
C-4	MASTER SITE PLAN
C-4A	OVERALL SITE PLAN
C-4B	SITE DEVELOPMENT PLAN
C-4C	SITE DEVELOPMENT PLAN
C-5	SITE GRADING PLAN
C-5A	SITE GRADING PLAN
C-6	SITE UTILITY PLAN
C-6A	SITE UTILITY PLAN
C-11	GENERAL DETAIL SHEET
C-11A	GENERAL DETAIL SHEET
C-15	PRELIMINARY SITE LIGHTING LAYOUT
L-1	OVERALL LANDSCAPE PLAN
L-2 - L-6	LANDSCAPE PLAN
L-7	LANDSCAPE NOTES & DETAILS
TR-1	TREE RETENTION PLAN
TR-2	TREE RETENTION PLAN

TAX PARCEL NO.	OWNER	ADDRESS
06014-031-000	CHARLES PINKOSON	3945 N.W. 30TH PLACE GAINESVILLE, FL 32606
	RAINER PINKOSON	3945 N.W. 30TH PLACE GAINESVILLE, FL 32606
	C. LEE PINKOSON	2820 N.W. 38TH DRIVE GAINESVILLE, FL 32605
06014-031-001	SUNTRUST BANK ATTN.: KEVIN M. CLARK, VICE PRESIDENT	303 PEACHTREE ST. N.E., SUITE 3600 ATLANTA, GA 30308
06014-031-002	SUNTRUST BANK ATTN.: KEVIN M. CLARK, VICE PRESIDENT	303 PEACHTREE ST. N.E., SUITE 3600 ATLANTA, GA 30308
06014-031-003	CHARLES PINKOSON	3945 N.W. 30TH PLACE GAINESVILLE, FL 32606
	RAINER PINKOSON	3945 N.W. 30TH PLACE GAINESVILLE, FL 32606
	C. LEE PINKOSON	2820 N.W. 38TH DRIVE GAINESVILLE, FL 32605
06014-031-004	TURKEY CREEK, INC. ATTN.: N. FOREST HOPE, PRESIDENT	11520 TURKEY CREEK BLVD. ALACHUA, FL 32615
06014-032-000	TURKEY CREEK, INC. ATTN.: N. FOREST HOPE, PRESIDENT	11820 TURKEY CREEK BLVD. ALACHUA, FL 32615
06014-032-001	TURKEY CREEK, INC. ATTN.: N. FOREST HOPE, PRESIDENT	11820 TURKEY CREEK BLVD. ALACHUA, FL 32615
06014-032-005	ELOISE R. CHANDLER	105 N. CHURCHILL DRIVE ST. AUGUSTINE, FL 32086
06014-032-006	PINNACLE PROPERTIES, LLC ATTN.: STEVEN A. BAGEN, MANAGER	424 S.W. 93RD STREET GAINESVILLE, FL 32607
06014-033-000	NORTHWOOD CENTER OWNERS ASSOC., INC. ATTN.: N. FOREST HOPE, SECRETARY	

NOTE: REFER TO SHEET C-2A FOR LEGAL DESCRIPTION OF EACH PARCEL

### PROJECT SITE NOTES:

- THE SITEWORK FOR THE WAL-MART PORTION OF THIS PROJECT SHALL MEET OR EXCEED THE "WAL-MART STANDARD SITEWORK SPECIFICATIONS."
  - ALL NECESSARY INSPECTIONS AND/OR CERTIFICATIONS REQUIRED BY CODES AND/OR UTILITY SERVICE COMPANIES SHALL BE PERFORMED PRIOR TO ANNOUNCED BUILDING POSSESSION AND THE FINAL CONNECTION OF SERVICES.
  - THE BUILDING SHALL COMPLY WITH THE FLORIDA FIRE PREVENTION CODE [GAINESVILLE FIRE PREVENTION AND PROTECTION CODE SECTION 10-5(a)&(b)].
  - THIS PROJECT SITE AND BUILDING COMPLY WITH THE STATE OF FLORIDA ACCESSIBILITY CODES AND STANDARDS.
  - FIRE HYDRANTS AND STABILIZED SURFACES MUST BE IN SERVICE PRIOR TO THE ACCUMULATION OF COMBUSTIBLES ON-SITE.
  - ELECTRIC DESIGN PROVIDED BY GRU ENERGY DELIVERY
  - THE PROPOSED WATER AND WASTEWATER SYSTEM HAS BEEN DESIGNED IN ACCORDANCE WITH GRU DESIGN STANDARDS.
- △ 8. THERE IS NO MANUFACTURE, STORAGE, USE, OR SALE OF HAZARDOUS MATERIALS AT THE SITE OR DEVELOPMENT AS DEFINED AND REGULATED IN THE ALACHUA COUNTY HAZARDOUS MATERIALS MANAGEMENT CODE, OTHER THAN HAZARDOUS MATERIALS EXCLUDED FROM THE PROVISIONS OF THE HAZARDOUS MATERIALS MANAGEMENT CODE, AS MAY BE AMENDED FROM TIME TO TIME



COVER SHEET

Walmart

STORE NO. 538-05 GAINESVILLE, FLORIDA

090906

Sheet No. **C-1**

DB-10-6 SPL















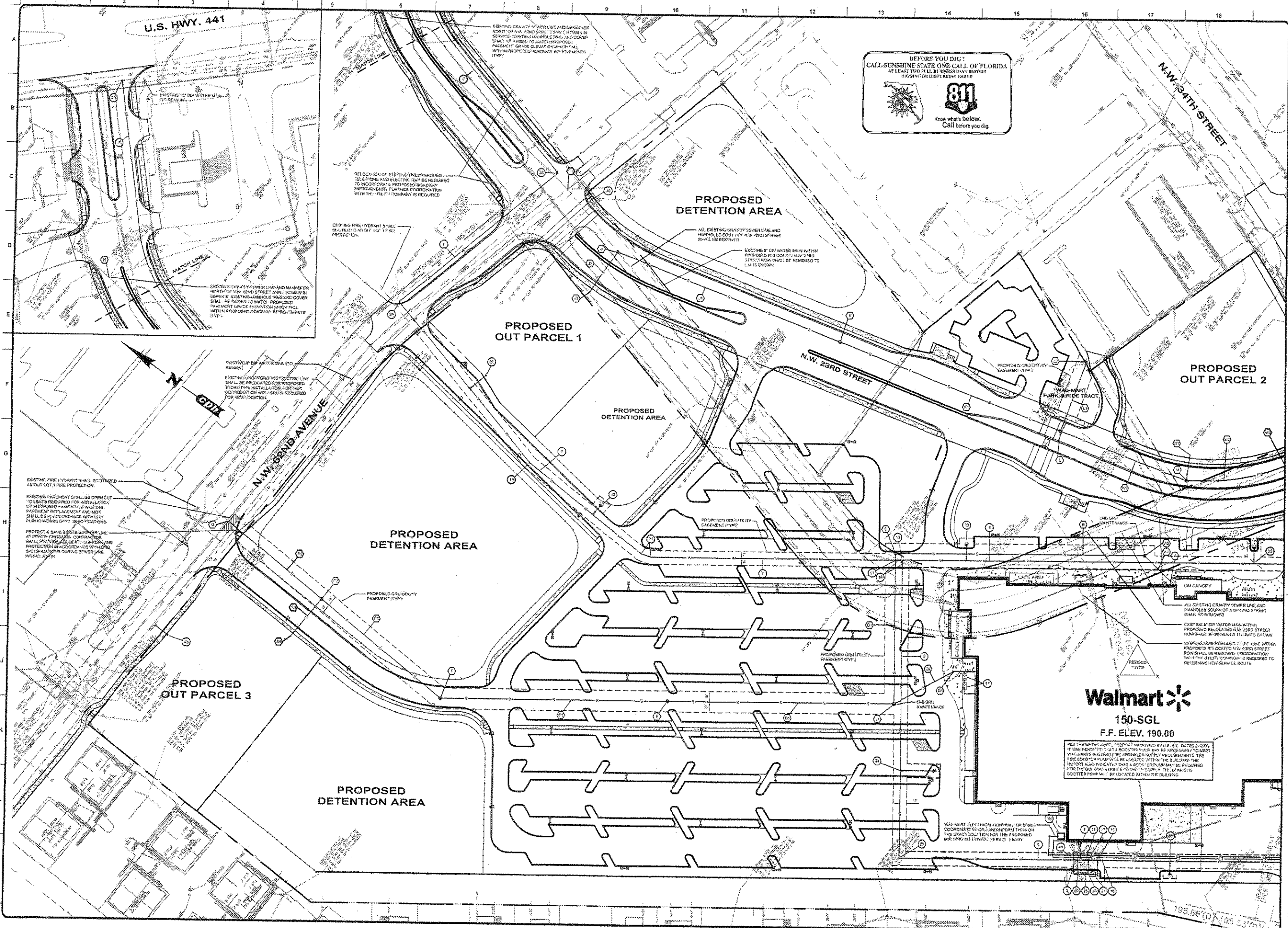

BEFORE YOU DIG!  
 CALL SUNSHINE STATE ONE CALL OF FLORIDA  
 AT LEAST TWO FULL BUSINESS DAYS BEFORE  
 BEGINNING YOUR DIGGING WORK

**811**  
 Know what's Below.  
 Call before you dig.

**Gph**  
 500 West Union Street  
 Sanford, Florida 32791  
 P. O. Box 2902  
 Sanford, Florida 32772-2902  
 Phone 407-321-0841  
 Fax 407-321-0832

Engineers  
 Surveyors  
 Architects  
 Planners  
 Landscape Architects  
 Environmental Scientists  
 Construction Management  
 Traffic/Transportation

Eng. C.O.A. No. 3215  
 Survey L.B. No. 7143  
 Arch. Lic. No. AA2600926  
 Landsc. Lic. No. LC8000295  
 © 2010

PROJECT: 150-SGL  
 DRAWN BY: J.K.B.  
 CHECKED BY: J.A.B.  
 APPROVED BY: H.L.W.  
 SCALE: 1" = 60'  
 DATE: 1/13/10  
 JOB NO.: W13450-1  
 FILE: CUP

By	Revision	Date	No.
			1
			2
			3
			4
			5
			6
			7
			8
			9
			10
			11
			12
			13
			14
			15
			16
			17
			18

**Walmart**  
 150-SGL  
 F.F. ELEV. 190.00

**Walmart**  
 STORE NO. 150-SGL (SUNSHINE STATE ONE CALL)

SITE UTILITY PLAN  
**C-6**

Sheet No.  
**C-6**

090906 C





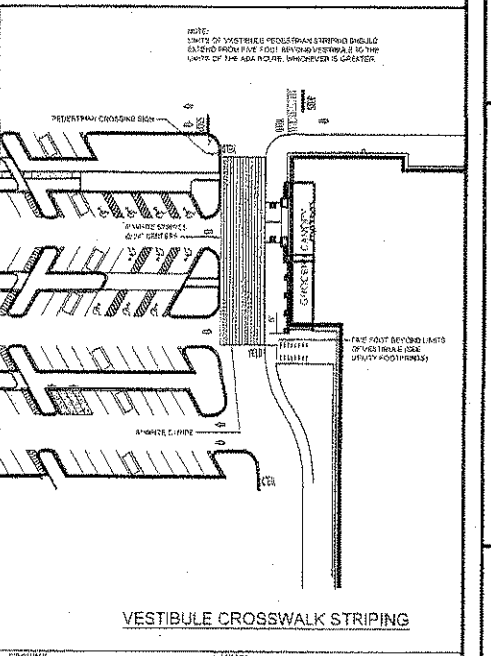
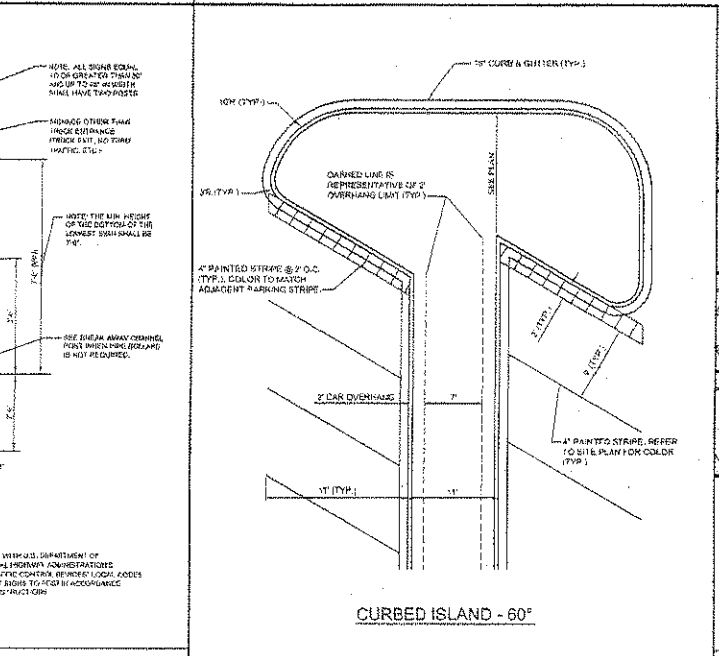
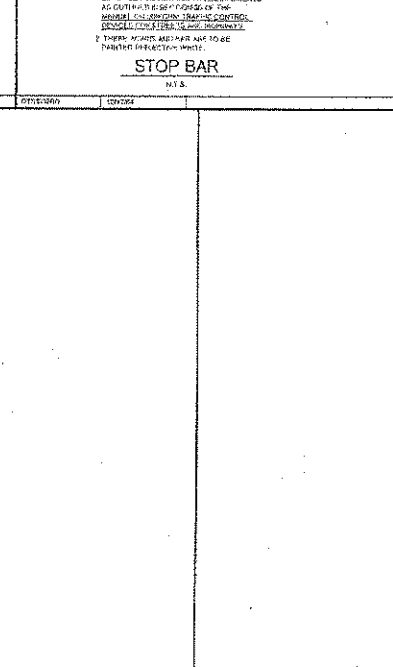
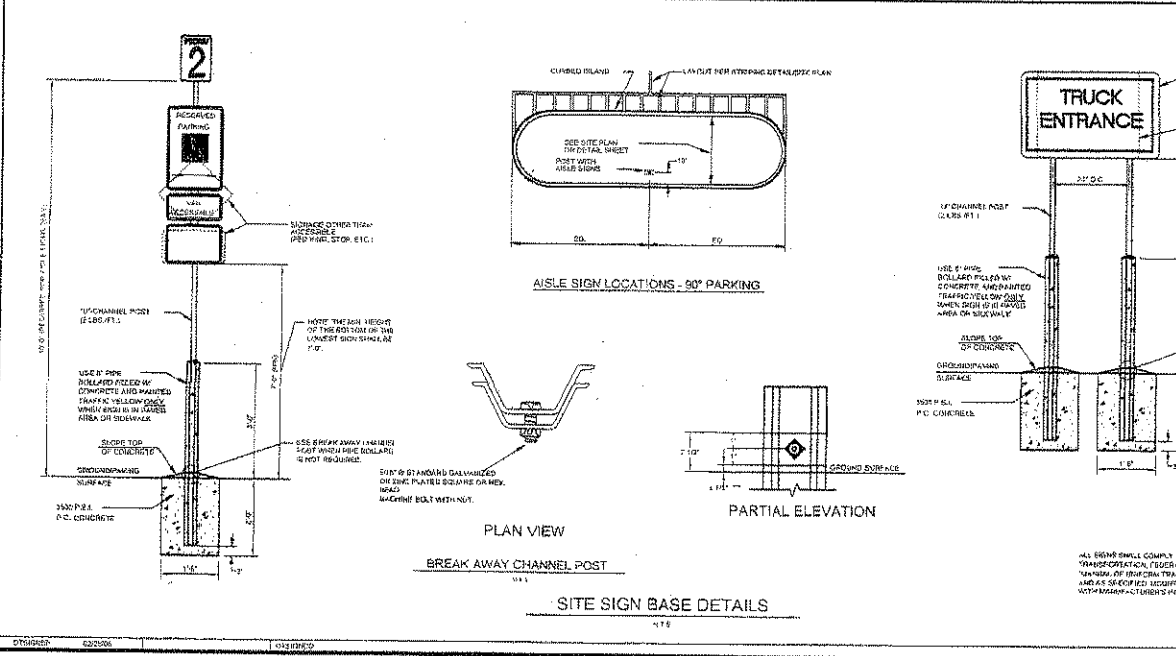
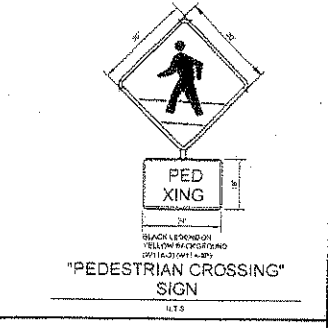
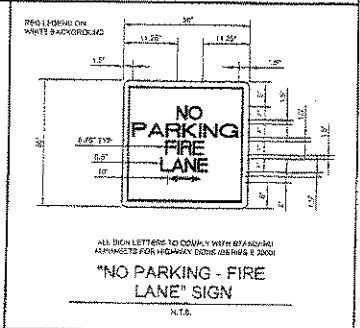
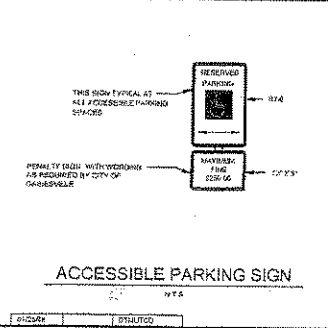
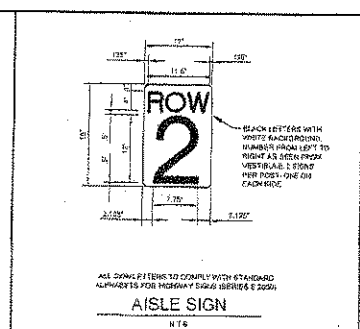
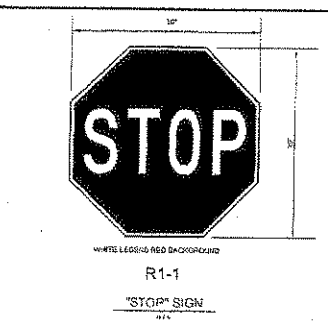
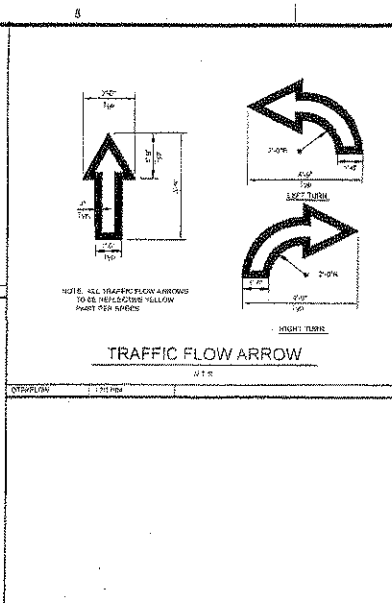
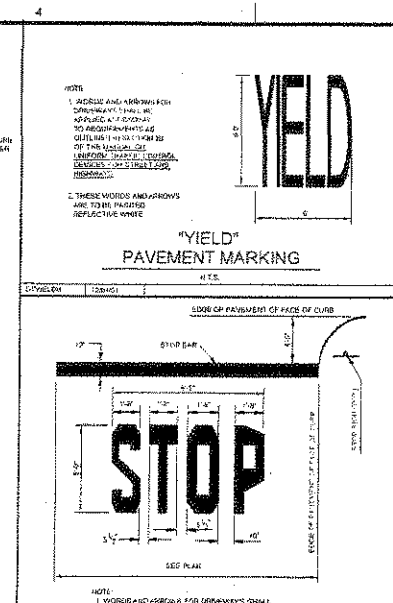
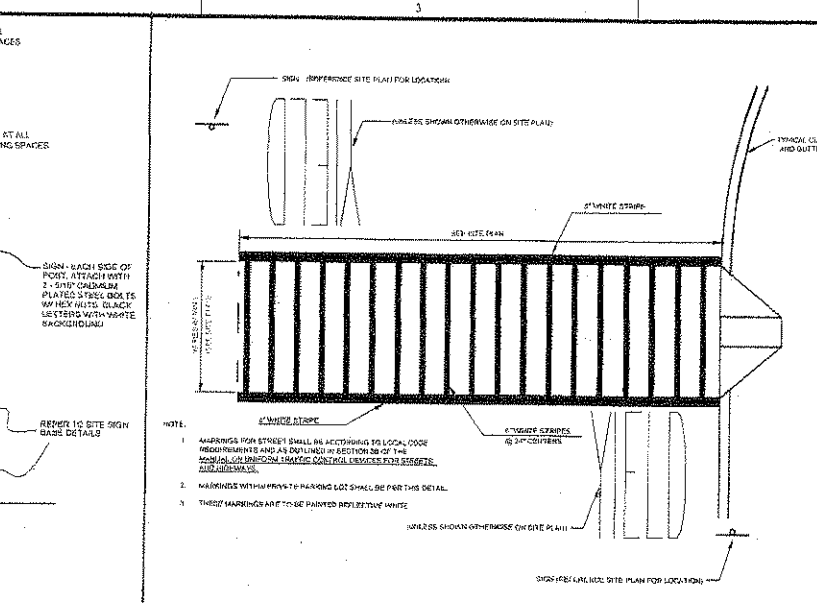
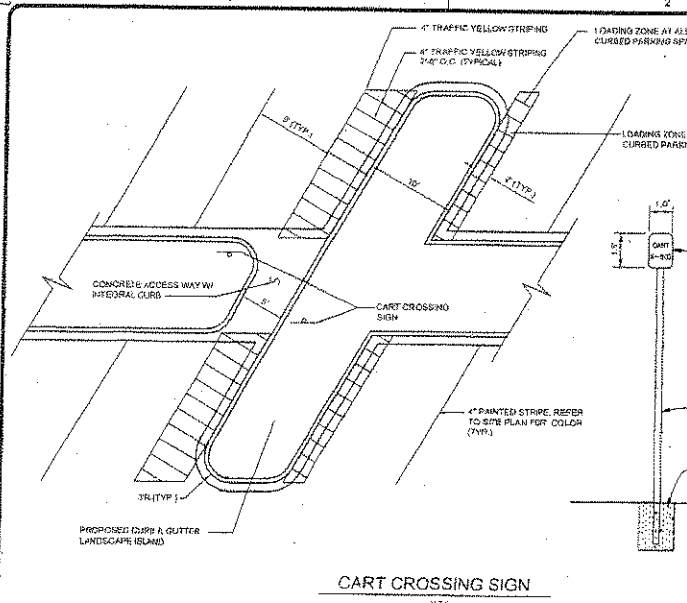

**gph**  
588 West 1st Street  
Sanford, Florida 32773  
P.O. Box 2948  
Sanford, Florida 32772-2808  
Phone 407 322-4647  
Fax 407 330-0689

Engineers  
Surveyors  
Architects  
Planners  
Landscape Architects  
Environmental Scientists  
Construction Management  
Traffic / Transportation

Eng. C.D.A. No. 1275  
Survey L.B. No. 7143  
Arch. Lic. No. AA260926  
Landscape Lic. No. LC0000258  
© 2010

By	Date	No.	Revision
J.K.B.		1	
J.K.B.		2	
G.D.		3	
H.L.W.		4	
AS SHOWN		5	
1/13/10		6	
W13450-1		7	
SDP		8	

GENERAL DETAIL SHEET

**Walmart**  
STORE NO. 5818 SANFORD GARNEVILLE (NW), FLORIDA

Sheet No.  
**C-11**

090906C





CART CORRALS WILL BE PROVIDED BY WELLMART AND ASSEMBLED/INSTALLED BY THE CONTRACTOR AT THE LOCATIONS SHOWN ON THE SITE PLAN

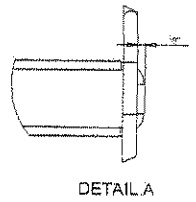
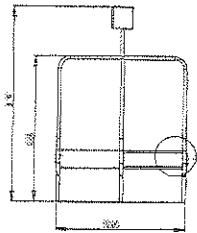
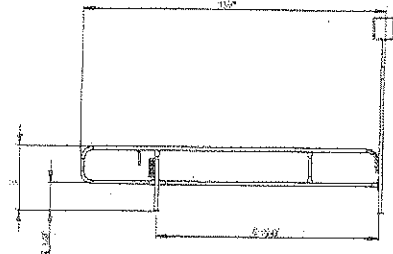
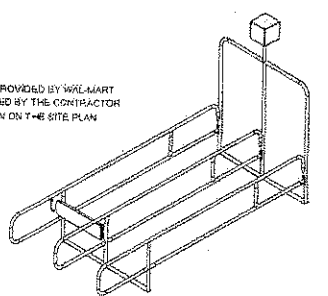

CART CORRAL  
WTC

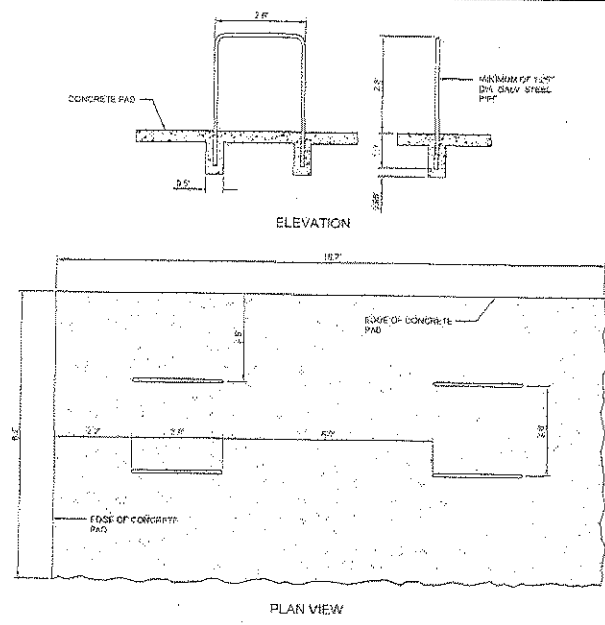

BIKE RACK STANDARD INSTALLATION DIMENSIONS  
WTC

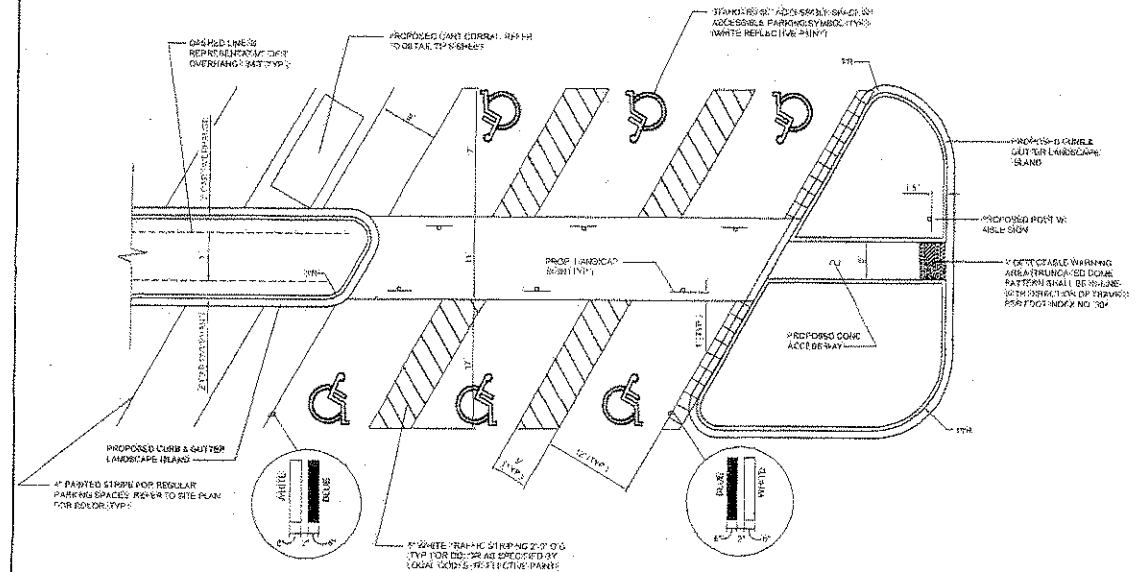

PARKING LOT STRIPING DETAILS  
WTC

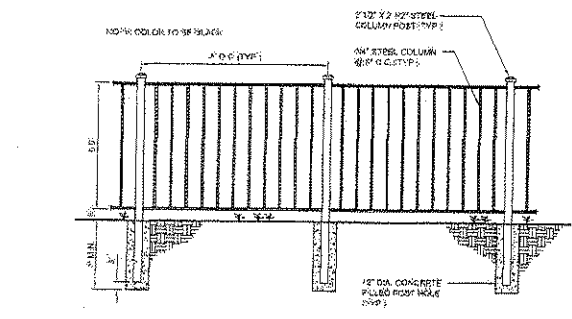

STEEL PICKET FENCE DETAIL  
WTC

NOTE: CONTRACTOR SHALL VERIFY ALL DIMENSIONS AND MATERIALS WITH WELLMART. CONTRACTOR SHALL BE RESPONSIBLE FOR OBTAINING ALL NECESSARY PERMITS AND APPROVALS FROM LOCAL AUTHORITIES. CONTRACTOR SHALL BE RESPONSIBLE FOR OBTAINING ALL NECESSARY PERMITS AND APPROVALS FROM LOCAL AUTHORITIES.

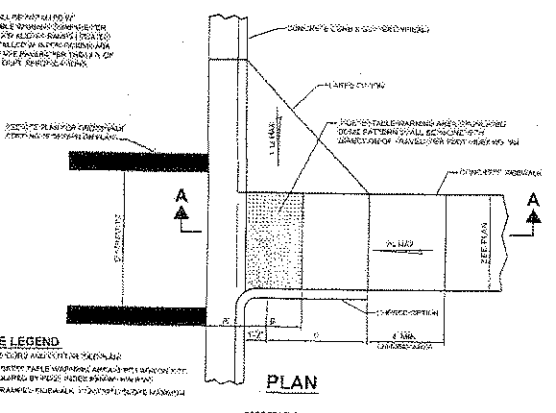

KEYNOTE LEGEND

- 1. CONCRETE CURB AND CURB WHEEL
- 2. 1/2\"/>

NOTES

- 1. SEE DETAIL FOR MATERIALS AND DIMENSIONS
- 2. ALL DIMENSIONS SHALL BE IN ACCORDANCE WITH THE 2010 ADA STANDARDS FOR ACCESSIBLE DESIGN
- 3. CONTRACTOR SHALL BE RESPONSIBLE FOR OBTAINING ALL NECESSARY PERMITS AND APPROVALS FROM LOCAL AUTHORITIES
- 4. CONTRACTOR SHALL BE RESPONSIBLE FOR OBTAINING ALL NECESSARY PERMITS AND APPROVALS FROM LOCAL AUTHORITIES
- 5. CONTRACTOR SHALL BE RESPONSIBLE FOR OBTAINING ALL NECESSARY PERMITS AND APPROVALS FROM LOCAL AUTHORITIES
- 6. CONTRACTOR SHALL BE RESPONSIBLE FOR OBTAINING ALL NECESSARY PERMITS AND APPROVALS FROM LOCAL AUTHORITIES

ADA RAMP DETAIL (ON-SITE USE ONLY)  
WTC

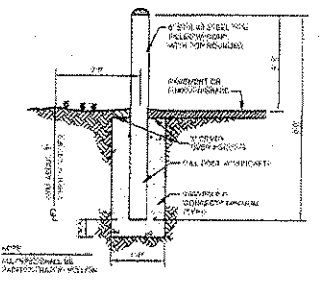

PIPE BOLLARD  
WTC

**gph**  
500 West 1st Street  
Sanbury, Florida 32771  
P. O. Box 2306  
Sanbury, Florida 32772-2306  
Phone: 407-322-6842  
Fax: 407-330-0639

Engineers  
Surveyors  
Architects  
Planners  
Landscape Architects  
Environmental Scientists  
Construction Management  
Traffic/Transportation

Eng. C.O.A. No. 9275  
Survey L.C. No. 7143  
Arch. Lic. No. AAZ696924  
Landscape Lic. No. LC0000298  
© 2010

NON-CURRENT VERSION IN FILE

By	Date	Revision
JKB		
JKB		
G.D.		
HLW		
AS SH/CW1		
1/13/10		
W13450.1		
SPP		

GENERAL DETAIL SHEET

**Walmart**  
STORE NO. 859 OF GAINESVILLE (NW), FLORIDA

Sheet No.  
**C-11A**

090906C

J:\13450\_TDC\DWG\DWG\GENERAL DETAIL PLAN W13450.1.DWG (REV) 10/19/2010 9:28am

GREENBRIAR  
FLAT LENS  
IESNA FULL CUTOFF

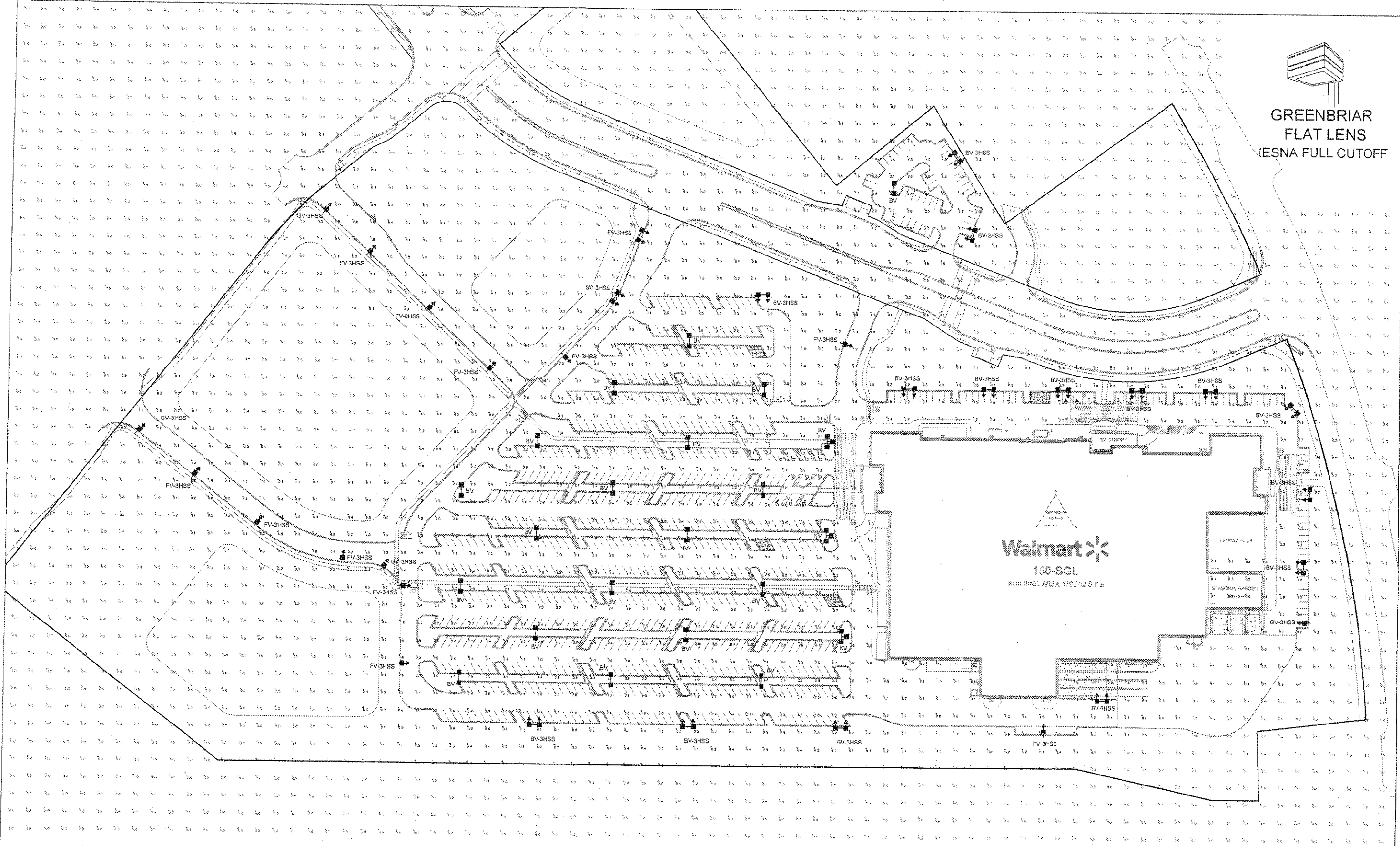

**Walmart**  
150-SGL  
BUILDING AREA 170,000 SF ±

Minimum Footcandle level at ground

Calculation Summary	Case Type	Units	Avg	Max	Min	Highway	Mainlot
FRONT DRIVE SUMMARY	Rumorsance	Fc	3.71	4.4	1.3	2.39	3.38
MAIN LOT SUMMARY	Rumorsance	Fc	2.65	3.0	1.3	2.06	3.85

Symbol	Qty	Label	Arrangement	Total Lumens	LF	Description	Total Watts
⬇	10	BV	0.150	88000	0.720	GPR-5-400-PSMAK 27' POLE 3' BASE	594
⬇	10	BV-3HSS	ROTATED 2 IN 90	88000	0.720	GPR-5-400-PSMAK 27' POLE 3' BASE	594
⬇	2	EV-3HSS	ROTATED 2 IN 90	28000	0.750	GPR-3-400-PSMAK 27' POLE 3' BASE	504
⬇	11	FV-3HSS	SINGLE	44000	0.750	GPR-3-400-PSMAK 27' POLE 3' BASE	594
⬇	4	GV-3HSS	SINGLE	44000	0.750	GPR-3-400-PSMAK 27' POLE 3' BASE	422
⬇	3	KV	3 @ 90 DEGREES	132000	0.750	GPR-5-400-PSMAK 27' POLE 3' BASE	1398

Total Project Watts  
Total Watts = 43562

**LI INDUSTRIES**  
LIGHTING PROPOSAL FOR  
WALMART STORE #555  
DUNEDIN, FL  
DATE: 11/11/11  
SHEET 06

LO-90730-7

**C-15**

2906060









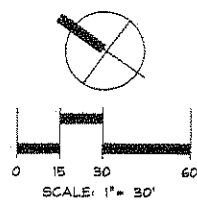
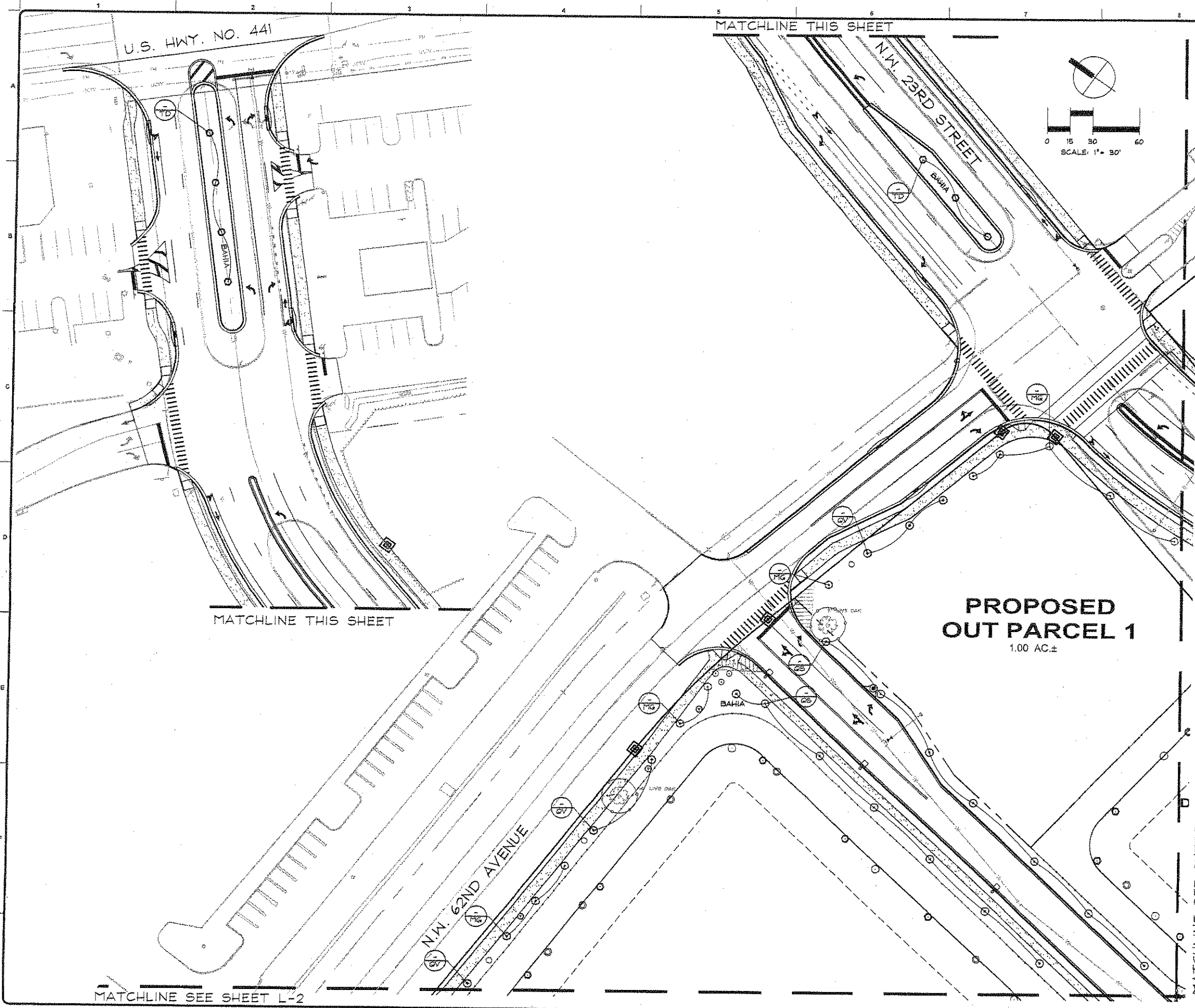

**PLANT LEGEND**

SYM.	COMMON NAME
<b>TREES</b>	
⊙ MG1	BRACKEN'S BROWN BEAUTY
⊙ QV1	LIVE OAK
⊙ UP	ALLEE ELM
⊙ UA	WINGED ELM
⊙ LI	GRAPE MYRTLE
⊙ VO	WALTER'S VIBURNUM
⊙ PP	LONGLEAF PINE
⊙ QV	LIVE OAK
⊙ SP	CABBAGE PALMETTO
⊙ WR	WASHINGTON PALM
⊙ OS	BLUFF OAK
⊙ NS	BLACK GUM
⊙ TD	BALD CYPRESS
⊙ MG	BRACKEN'S BROWN BEAUTY
⊙ CC	AMERICAN HORNBEEAM
⊙ IC	DAHOON HOLLY
⊙ LJ	TREE LIGUSTRUM
<b>LARGE SHRUBS</b>	
⊙ VO1	WALTER'S VIBURNUM
<b>SMALL SHRUBS &amp; GROUND COVER</b>	
TA	TRICOLOR JASMINE
MC	MULHY GRASS
RI	INDIAN HAWTHORN
TF	DWARF FAKAHATCHEE
IVS	STOKES DWARF
HD	DUNE SUNFLOWER
BAHIA	ARGENTINE BAHIA SOD

**LITTORAL PLANTINGS**

SB	SAND CORDGRASS
CF	GOLDEN CANNA
IV	SOUTHERN BLUE FLAG IRIS
NO	FRAGRANT WHITE WATERLILY
PC	PICKERELWEED

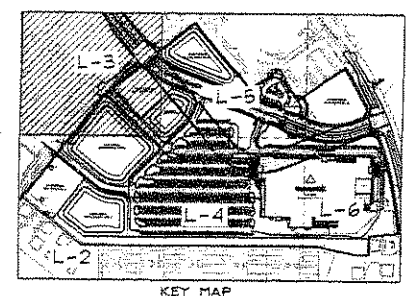

**cph**  
 500 West Fulton Street  
 Sanford, Florida 32777  
 P. O. Box 2808  
 Sanford, Florida 32773-2808  
 Phone 407 322-6847  
 Fax 407 330-0630

Engineers  
 Surveyors  
 Architects  
 Planners  
 Landscape Architects  
 Environmental Scientists  
 Construction Management  
 Traffic/Transportation

Eng. C.O.A. No. 3215  
 Survey L.S. No. 7143  
 Arch. Lic. No. AA2600926  
 Landscape Lic. No. LC6006298  
 © 2019

DESIGNED BY	DRAWN BY	CHECKED BY	APPROVED BY	SCALE	DATE	JOB NO.	FILE
G.J.P.	M.A.A.	J.K.W.	G.J.P.	1" = 30'	01/12/10	W13450.1	LSP

DATE	NO.	PER CITY COMMENTS	REVISION	BY
02/09/10	1			

LANDSCAPE PLAN

**Walmart**

STORE NO. 539-95 GAINESVILLE (N.W.), FLORIDA

Sheet No.  
**L-3**

090906

MATCHLINE SEE SHEET L-5

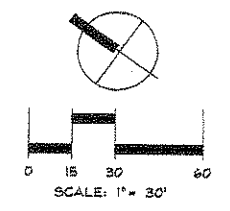
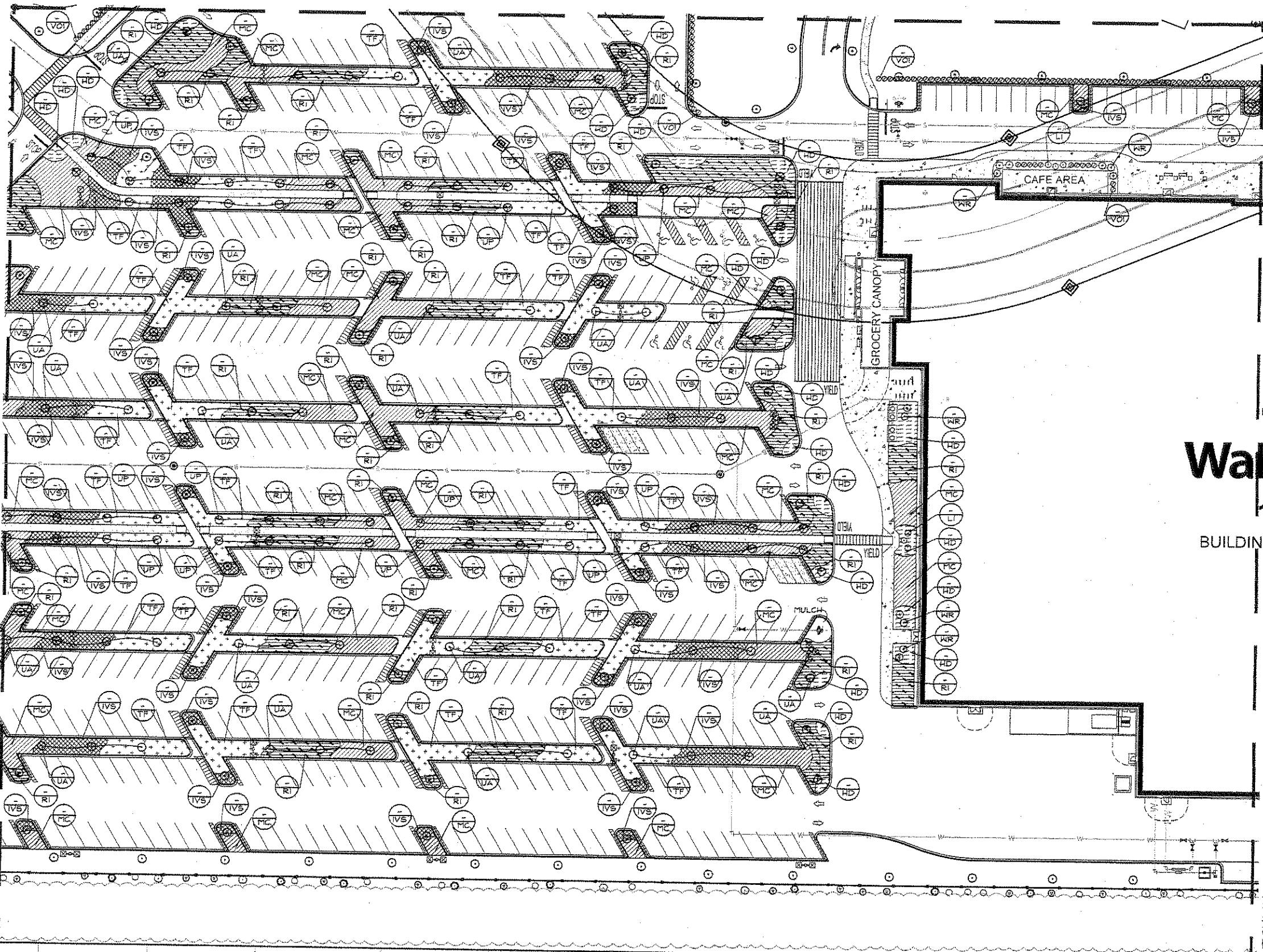

**PLANT LEGEND**

SYM.	COMMON NAME
<b>TREES</b>	
⊕ MG1	BRACKEN'S BROWN BEAUTY
⊕ QV1	LIVE OAK
⊕ UP	ALLEE ELM
⊕ UA	WINGED ELM
⊕ LI	CRAPE MYRTLE
⊕ VO	WALTER'S VIBURNUM
⊕ PP	LONGLEAF PINE
⊕ QV	LIVE OAK
⊕ SP	CABBAGE PALMETTO
⊕ WR	WASHINGTON PALM
⊕ GS	BLUFF OAK
⊕ NB	BLACK GUM
⊕ TD	BALD CYPRESS
⊕ MG	BRACKEN'S BROWN BEAUTY
⊕ CC	AMERICAN HORNBEAM
⊕ IC	DAHON HOLLY
⊕ LJ	TREE LIGUSTRUM
<b>LARGE SHRUBS</b>	
⊕ VO1	WALTER'S VIBURNUM
<b>SMALL SHRUBS &amp; GROUNDCOVER</b>	
TA	TRICOLOR JASMINE
MC	MUHLT GRASS
RI	INDIAN HAWTHORN
TF	DWARF FAKAHATCHEE
IVS	STOKES DWARF
HD	DUNE SUNFLOWER
BAHIA	ARGENTINE BAHIA SOD

**Walmart**  
BUILDING

MATCHLINE SEE SHEET L-2

MATCHLINE SEE SHEET L-6

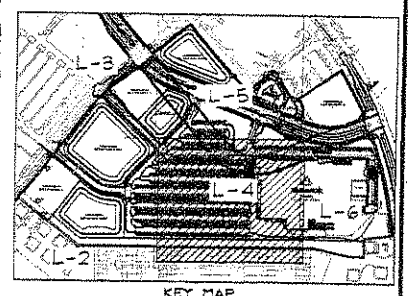

**e-ph**  
500 West Fulton Street  
Seaford, Florida 32771  
P. O. Box 2866  
Seaford, Florida 32772-2808  
Phone 407 522-6843  
Fax 407 530-0619

Engineers  
Surveyors  
Architects  
Planners  
Landscape Architects  
Environmental Scientists  
Construction Management  
Traffic / Transportation

Eng. C.G.A. No. 3215  
Survey L.B. No. 7143  
Arch. Lic. No. AA2600926  
Landscape Lic. No. LC0000298  
© 2010

Designated by:	G.J.P.	M.A.A.	J.K.W.	G.J.P.	Scale:	Date:	Job No.:	File:
Drawn by:					1" = 30'	01/12/10	WT3450.1	LSP
Checked by:								
Approved by:								
Revision:								
PER CITY COMMENTS:								

LANDSCAPE PLAN

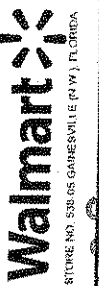

STORE NO. 535 65 GAINESVILLE (P.W.), FLORIDA

Sheet No.

**L-4**

090906

1 2 3 4 5 6 7 8 9 10 11 12 13 14 15 16 17 18 19 20 21 22 23 24 25 26 27 28 29 30

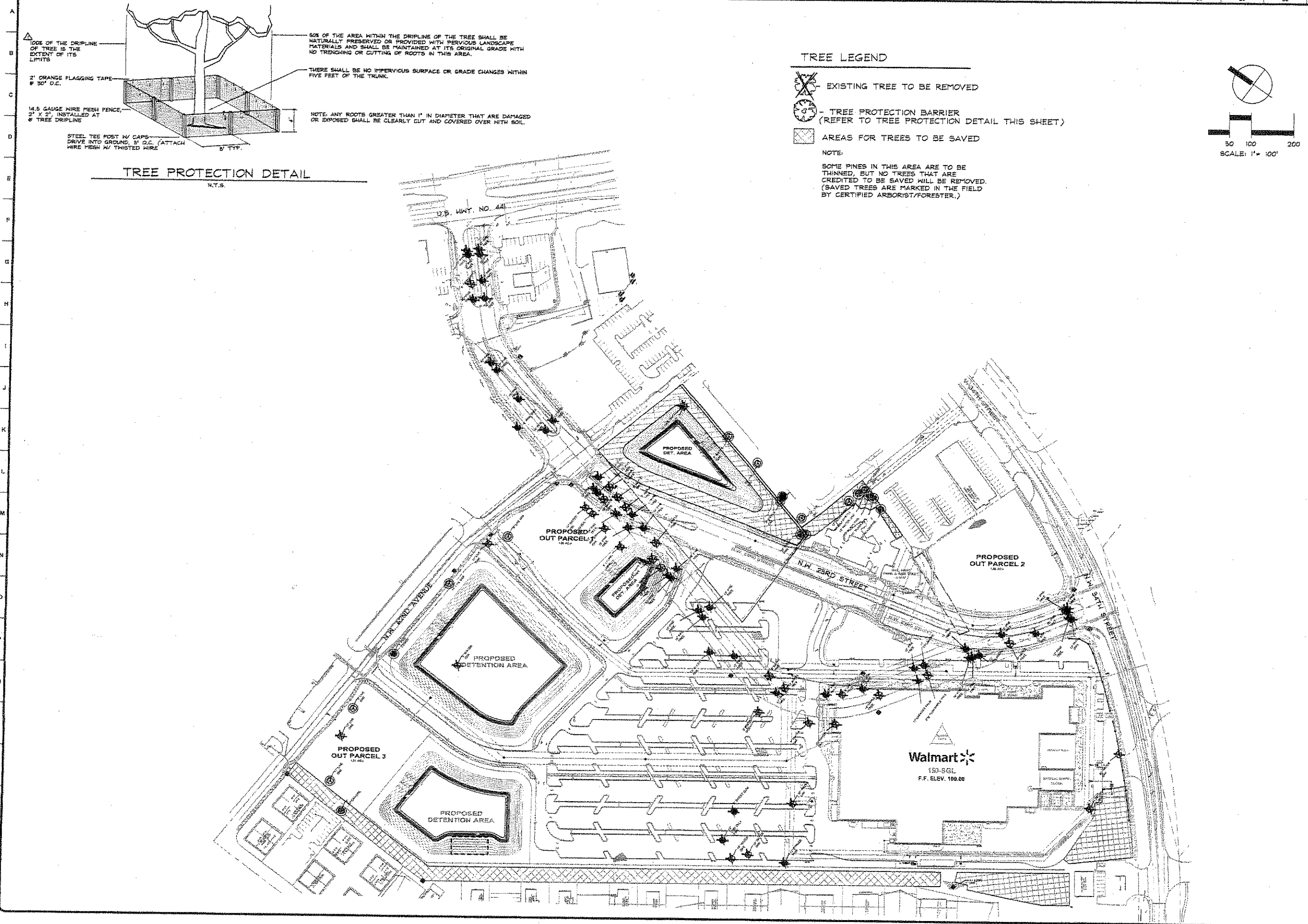

TREE PROTECTION DETAIL  
N.T.S.

TREE LEGEND

- EXISTING TREE TO BE REMOVED
- TREE PROTECTION BARRIER (REFER TO TREE PROTECTION DETAIL THIS SHEET)
- AREAS FOR TREES TO BE SAVED

NOTE:  
SOME PINES IN THIS AREA ARE TO BE THINNED, BUT NO TREES THAT ARE CREDITED TO BE SAVED WILL BE REMOVED. (SAVED TREES ARE MARKED IN THE FIELD BY CERTIFIED ARBORIST/FORESTER.)

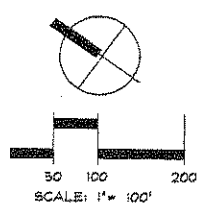

**eph**  
500 West Fulton Street  
Sanford, Florida 32771  
P. O. Box 2808  
Sanford, Florida 32772-2808  
Phone 407 322-6842  
Fax 407 330-0639

Engineers  
Surveyors  
Architects  
Planners  
Landscape Architects  
Environmental Scientists  
Construction Management  
Traffic/Transportation

Eng. C.O.A. No. 3215  
Survey L.B. No. 7143  
Arch. Lic. No. AA260926  
Landscape Lic. No. LC0000298  
© 2010

DESIGNED BY	DRAWN BY	CHECKED BY	APPROVED BY	SCALE	DATE	FILE NO.	TRP	NO.	DATE	PER CITY COMMENTS	REVISION	SLE	BY
G.J.P.	M.A.A.	J.K.W.	C.J.P.	1" = 100'	2/26/08	W13450.1			02/09/10				

TREE RETENTION PLAN

**Walmart**  
STORE NO. 538 US GAINESVILLE (FL), FLORIDA

090906C



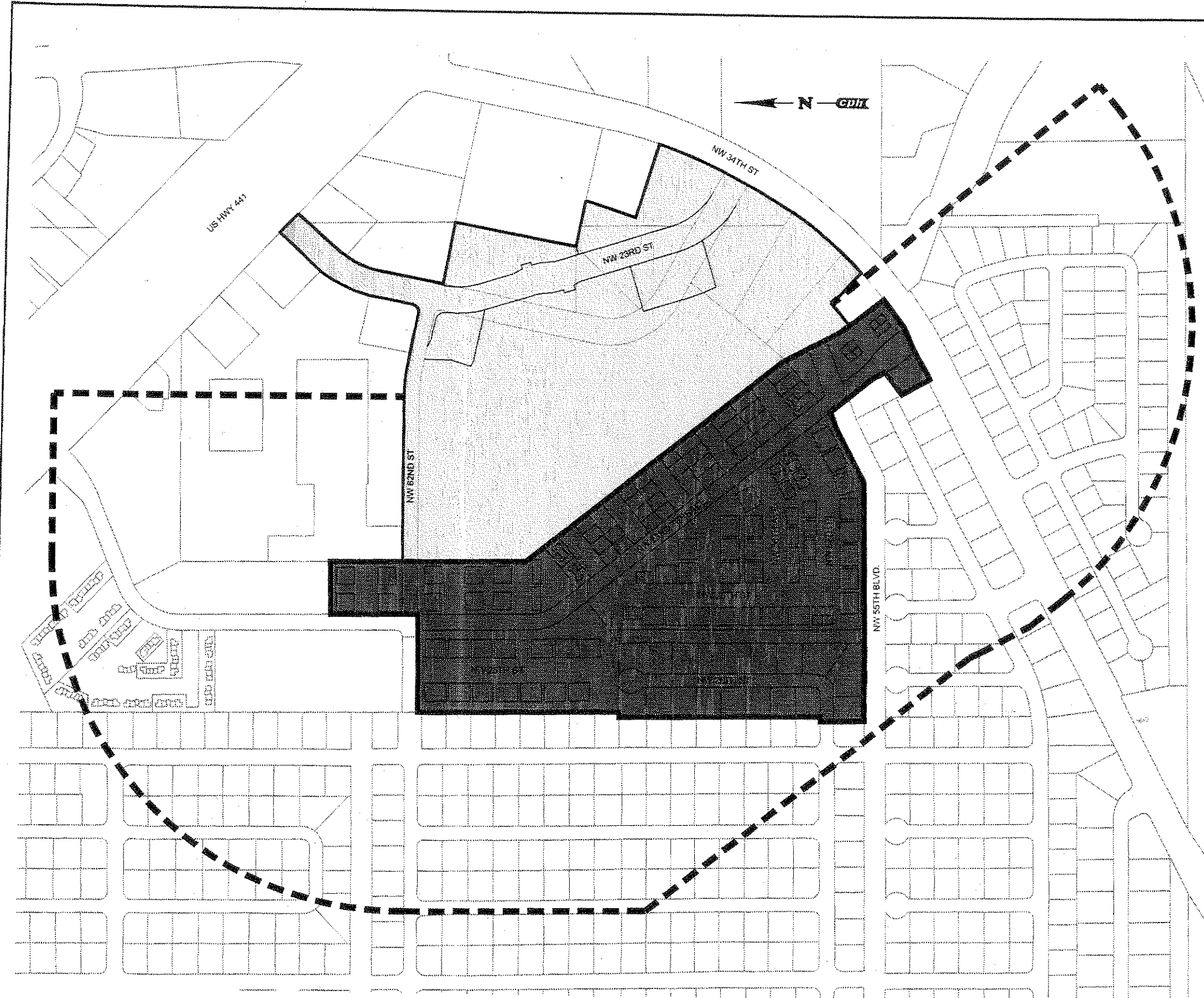

### SITE DATA

LAND COVERAGE SUMMARY	SITE AREA (POST-DEVELOPMENT)
WALMART WEST TRACT: (LESS OUT PARCEL)	1,165,760.17 S.F.± (26.76 AC±)
WALMART EAST TRACT: (LESS OUT PARCEL)	75,099.07 S.F.± (1.72 AC±)
OUT PARCEL 1	43,352.92 S.F.± (1.00 AC±)
OUT PARCEL 2	68,836.50 S.F.± (1.58 AC±)
OUT PARCEL 3	57,216.34 S.F.± (1.31 AC±)
WALMART PARK & RIDE TRACT	30,829.06 S.F.± (0.71 AC±)
N.W. 23RD STREET ROW:	196,284.21 S.F.± (4.51 AC±)
N.W. 62ND AVENUE ROW:	58,236.17 S.F.± (1.34 AC±)
<b>TOTAL WAL-MART SITE AREA:</b>	<b>1,695,614.45 S.F.± (38.93 AC±)</b>

RESIDENTIAL LOT LAND COVERAGE SUMMARY	
RESIDENTIAL LOT SITE AREA:	1,697,569.95 S.F.± (38.97 AC±)
RESIDENTIAL UNITS WITHIN SITE AREA:	299 UNITS
RESIDENTIAL UNITS PER ACRE:	7.67 UNITS / ACRE

RECEIVED  
FEB 10 2010  
PLANNING  
DIVISION

### LEGEND

- RESIDENTIAL PROPERTY AREA \*
- PROPOSED WAL-MART PROPERTY AREA
- QUARTER MILE DELINEATION LINE FROM WAL-MART BOUNDARY

\* NOTE: EXISTING RESIDENTIAL LOT LIMITS WERE INCORPORATED INTO THIS EXHIBIT BASED ON INFORMATION OBTAINED FROM ALACHUA COUNTY PROPERTY APPRAISER WEBSITE AND NOT ACTUAL SURVEY DATA.

Designed by:	J.K.B.	Date:	2/3/09
Drawn by:	J.K.B.	Job No.:	W13450.1
Checked by:	J.A.B.	File:	UNIT EXHIBIT
Approved by:	H.L.W.		
Scale:	1" = 400'		© 2009

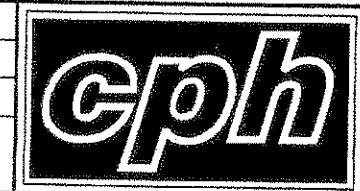

Engineers (C.O.A. No. 3215)  
Architects (Lic. No. AA2600926)  
Surveyors (L.B. No. 7143)  
Landscape Arch. (Lic. No. LC0000298)  
Planners  
Environmental Scientists  
Construction Management  
Traffic/Transportation

500 West Fulton Street  
Sanford, FL 32771  
P.O. Box 2808  
32772-2808  
Phone: 407.322.6841  
Fax: 407.330.0639

**RESIDENTIAL UNIT PER ACRE EXHIBIT**

**Walmart\***

STORE NO. 538-05 GAINESVILLE (N.W.), FLORIDA

Sheet No.  
**C-1**  
DB-10-6-SPL  
Walmart @ 441

0909060

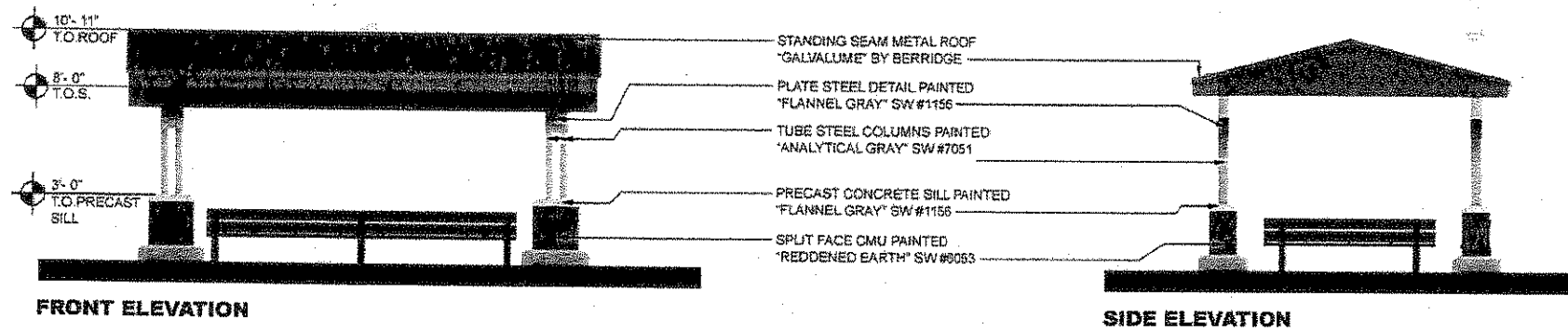
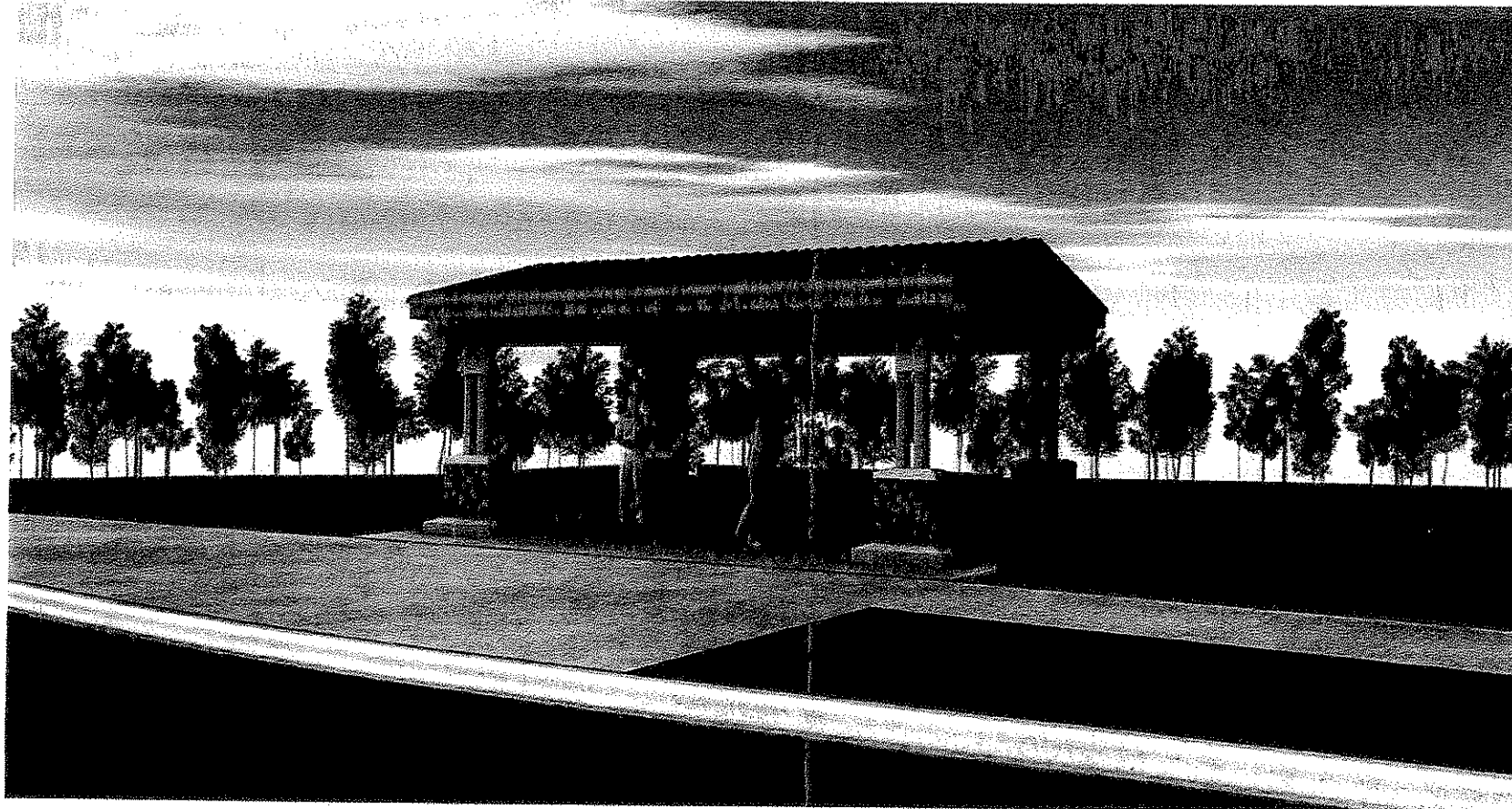

REPRESENTATION ONLY  
NOT FOR CONSTRUCTION

BUILDING IMAGES SHOWN ARE A REPRESENTATION OF THE DESIGN INTENT AND MAY NOT REFLECT ANY SUBTLE VARIATIONS IN COLOR, MATERIAL OR CONSTRUCTION THAT MAY OCCUR DUE TO LOCAL MATERIAL DIFFERENCES AND FINAL DESIGN DETAILING.

RECEIVED  
FEB 10 2010  
PLANNING  
DIVISION

DB-10-6 SPL  
Walmart @ 441

090906c

Gainesville (NE), FL  
#3877 08/26/08

