

CITY OF GAINESVILLE CITY COMMISSION

Quasi-Judicial Registration Form

RE: Petition 161MSC-05 PB City Plan Board. Modify contributing structures map of Pleasant Street Historic District. Change status from non-contributing to contributing for various properties in the Pleasant Street Historic District.

2006 AUG -3 AM 11:47

CC Meeting Date: 8/14/06

Name: (please print) Richard Selwach

Address: 523 NW 3rd Ave

Telephone Number: 352-371-4367

Please indicate whether you are for or against this petition: FOR ~~NO~~ or AGAINST (mark "X")

I am Against this petition

Please indicate whether you are requesting a Formal Hearing: YES or NO _____ (mark "X")

Complete the following section of the form only if you are requesting a formal quasi-judicial hearing:

(Please refer to the enclosed Quasi-Judicial Hearing sheet contained in this mail-out for more information)

As an affected person receiving notice of the public hearing on Petition 161MSC-05 PB, I hereby request, that the City Commission conduct a formal quasi-judicial hearing as described above.

Signature: [Handwritten Signature] Richard Selwach

This form and exhibits to be presented to the City Commission must be delivered to the Clerk of the Commission at least 7 days prior to the PUBLIC HEARING as stated in this notification letter sent to you. The Clerk of the Commission Office is located at City Hall, 1st floor, 200 East University Avenue, Gainesville, Florida. Forms may be mailed to the following address: Clerk of the Commission—Station 19, Quasi-Judicial Hearing, Petition 161MSC-05 PB, P.O. Box 490, Gainesville, Florida, 32602.

Attorney Information (If applicable):

Name: (please print) _____

Address: _____

Signature: _____

Telephone Number: _____

- ① I was NOT noticed properly that my property was being added to district.
- ② SFCC - No certificate of Appropriateness
- ③ Enclave created at clean cut barbershop
- ④ VACANT LOTS do not add anything to district adjacent to my property.

2006 AUG - 3 AM 11:47

[Handwritten signature]

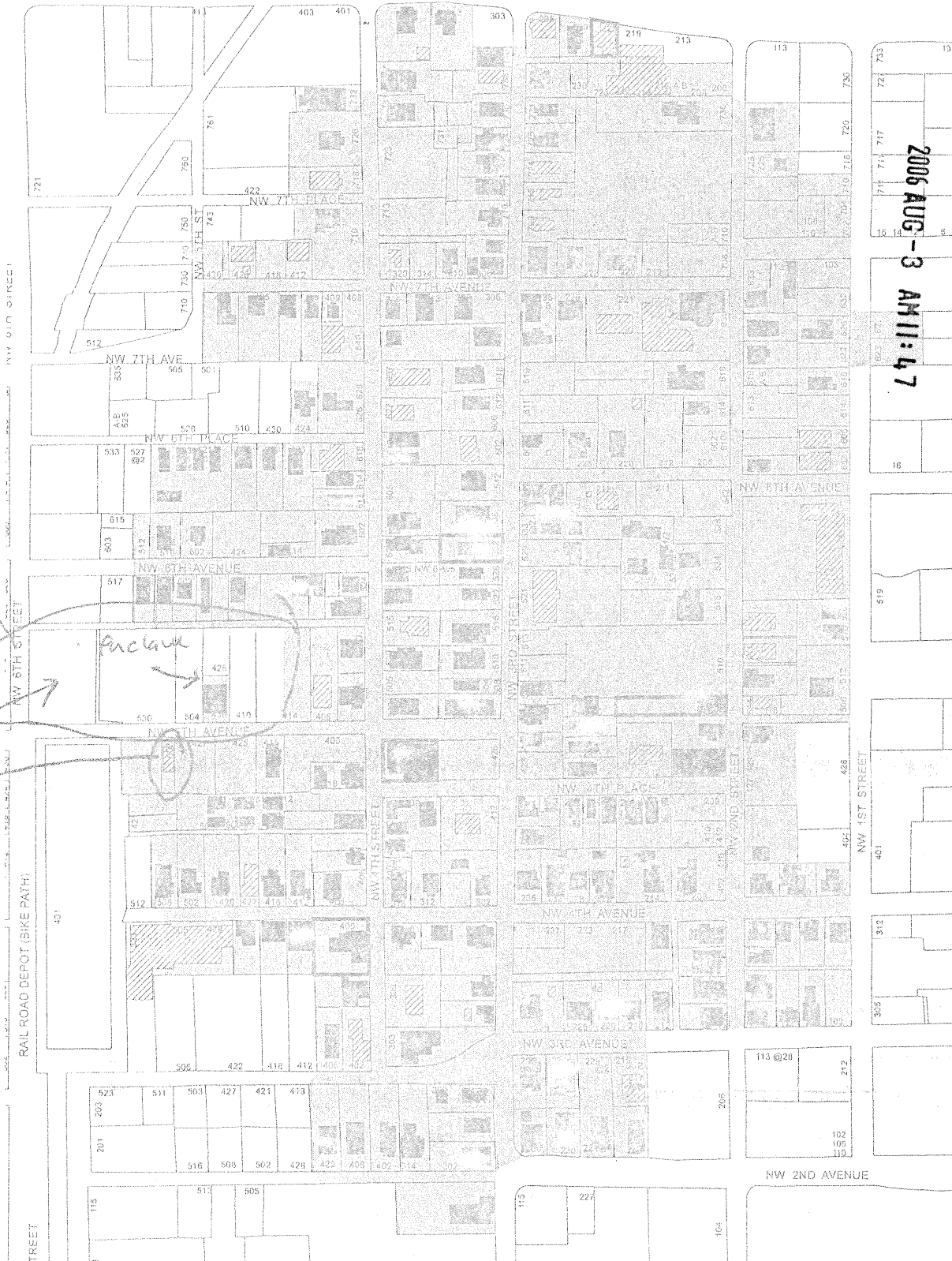

no
of
SFCC
an
been
checked





no
of
SFCC

My Property
is on
the
of the
District
P. IS

own
entirely

NOT
any
taken
of district
completely.

Pleasant Street Historic District
Gainesville, Florida

-  Contributing Structures
-  Non-Contributing Structures
-  Pleasant Street Historic District Boundary
-  Change in Status (Principle Structure)

[Note: If you are interested in the status of a particular structure within the historic district, please check the "contributing" and "non-contributing" categories on this map. Do not rely solely on the outlined change of status.]

Exhibit 7

1101 [NOT] notified property.
I never received certified letter or information adding my property to district.

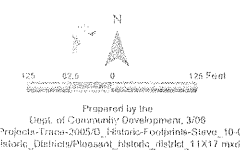

Prepared by the Dept. of Community Development, 306
acProjects-Trans-200503_03_SiteMap-040105-10-03/18046_DistrictMap040105_030105_11x17.mxd
This map is for information purposes only. The City of Gainesville does not assume responsibility to update this information or for any error or omission on this map. For specific information, you are directed to contact the City of Gainesville, Florida.