

CITY OF GAINESVILLE URBAN SERVICES REPORT

Exhibit A

Voluntary East Side Properties Area



TABLE OF CONTENTS

| | |
|---|-----------|
| INTRODUCTION..... | 3 |
| CHARACTER OF THE AREA TO BE ANNEXED..... | 3 |
| QUALIFICATION OF THE AREA UNDER SECTION 9..... | 4 |
| THE PROVISION OF SERVICES..... | 5 |
| a) Services in the Next Five Years..... | 5 |
| b) Taxes in the Next Five Years..... | 5 |
| POLICE SERVICES..... | 5 |
| FIRE PROTECTION..... | 6 |
| SOLID WASTE DISPOSAL..... | 6 |
| POTABLE WATER..... | 7 |
| SANITARY SEWER..... | 7 |
| STREETS, DRAINAGE AND FLOOD CONTROL..... | 7 |
| PARKS, RECREATION AND CULTURAL AFFAIRS..... | 7 |
| HOUSING..... | 9 |
| STREET LIGHTING..... | 9 |
| TRANSPORTATION..... | 10 |
| PLANNING AND ZONING SERVICES..... | 11 |
| OTHER GOVERNMENTAL SERVICES..... | 11 |
| WATER AND WASTEWATER FACILITIES..... | 12 |
| FINANCING THE EXTENSION OF WATER AND WASTEWATER FACILITIES..... | 12 |
| EXISTING MAJOR TRUNK WATER MAINS AND PROPOSED EXTENSIONS..... | 12 |
| EXISTING WASTEWATER COLLECTION SYSTEM AND PROPOSED EXTENSIONS..... | 12 |
| FIGURE 1: AREA PROPOSED FOR ANNEXATION..... | 13 |
| FIGURE 2: ALACHUA COUNTY GENERAL LAND USE SURROUNDING AREA..... | 14 |
| FIGURE 3: MAJOR WATER MAINS..... | 15 |
| FIGURE 4: MAJOR WATER SYSTEMS PROJECTS..... | 16 |
| FIGURE 5: WASTEWATER UTILITY FACILITIES..... | 17 |
| FIGURE 6: WASTEWATER COLLECTION SYSTEM PROJECTS..... | 18 |

URBAN SERVICES REPORT

INTRODUCTION

This Urban Services Report satisfies all the criteria required under the Alachua County Boundary Adjustment Act, as provided in Chapter 90-496, Special Act, Laws of Florida, as amended by Chapters 91-382 and 93-347, Special Acts, Laws of Florida (the "Act") for municipal annexation. Section 13 of the Act outlines the prerequisites for annexation. This report, with accompanying documentation and maps, complies with the applicable provisions of the Act.

CHARACTER OF THE AREA TO BE ANNEXED

The area proposed for annexation is shown in Figure 1 ("Area") and is comprised of Tax Parcel Numbers 10890-000-000, 10889-000-000, 10889-002-000, 10889-003-000, 16127-003-000, 16127-003-001, 16125-005-000, 16125-000-000, 16126-000-000 and 16125-007-000. Tax parcel 10890-000-000 is generally located south of East University Avenue, west of the vicinity of S.E. 43rd Street, north of tax parcel 10890-002-000, and east of the Gainesville City Limits. Tax parcel 10889-000-000 is generally located south of East University Avenue, west of the vicinity of S.E. 43rd Street, north of tax parcels 16127-002-002 and 16127-002-001, and east of tax parcels 10890-000-000 and 10890-002-000. Tax parcels 10889-002-000 and 10889-003-000 are generally located south of East University Avenue, west of the vicinity of S.E. 43rd Street, north of tax parcels 16127-003-000 and 16125-001-001, and east of tax parcel 10889-000-000. Tax parcel 16127-003-000 is generally located south of East University Avenue, west of South East 43rd Street, north of South East Hawthorne Road, and east of the Gainesville City Limits. Tax parcel 16127-003-001 is generally located south of East University Avenue, west of South East 43rd Street, north of South East Hawthorne Road, and east of the Gainesville City Limits. Tax parcel 16125-005-000 is generally located south of East University Avenue, west of South East 43rd Street, north of South East Hawthorne Road, and east of tax parcel 16127-003-000. Tax parcel 16125-000-000 is generally located south of East University Avenue, west of South East 43rd Street, north of South East Hawthorne Road, and east of tax parcel 16125-007-000. Tax parcel 16126-000-000 is generally located south of South East Hawthorne Road, west of South East 43rd Terrace, north of Paynes Prairie Preserve State Park, and east of South East 39th Terrace. Tax parcel 16125-007-000 is generally located south of tax parcel 16127-003-001, west of S.E. 43rd Street, north of Hawthorne Road, and east of tax parcel 16127-003-001; the area is proposed for annexation by the City of Gainesville pursuant to Chapter 90-496, Special Acts, Laws of Florida, as amended, known as the Alachua County Boundary Adjustment Act; providing directions to the City Manager, the City Attorney and the Clerk of the Commission; providing a repealing clause; providing a severability clause; and providing an immediate effective date. The general land use pattern of the Area is shown in Figure 2.

Qualification of the Area under Section 9

Because this is a voluntary annexation, Section 9 of the Act does not apply; however, in accordance with Section 13 (b), the extent to which the Area does qualify under Section 9 is as follows:

Extent of Qualification under Section 9 (1) (a) - This Area meets all qualifications for this section. The Area is contiguous to Gainesville's boundaries and reasonably compact. No part of the Area is within the boundary of another county or another incorporated municipality. All of the Area is within the Gainesville Urban Reserve Area adopted by the Alachua County Commission on January 10, 2006, and which became final on March 13, 2006. The Annexation will not create an enclave.

THE PROVISION OF SERVICES

The Provision of Services under Section 13 (1) (b)

a) Services in the Next Five Years

It is anticipated that services to the Area will be improved within the next five years as a result of the annexation of the Area. It is not reasonably anticipated that services to current city residents will be reduced within the next five years as a result of the annexation of the Area. The following discussion outlines proposed services. All services are subject to the annual lawful appropriation of funds.

b) Taxes in the Next Five Years

It is not reasonable to anticipate that the City's ad valorem taxes would need to be adjusted in the next five years to provide services to the Area as a result of the annexation of the Area. This includes services required by the Comprehensive Plan. Any level of service issue that is outlined in the City of Gainesville Comprehensive Plan or the Alachua County Comprehensive Plan, whichever applies at the time of development, must be addressed.

Police Services

Upon the effective date of annexation, police services will be provided to the Area by the Gainesville Police Department, utilizing similar policing strategies that are provided within the existing City limits. Police District Two, Romeo Zone will be extended to serve the area. The level of services will be dependent upon identified crime patterns and service demand within a prescribed area. The current staffing in the Department can provide these services to the Area.

Current police services include preventative patrol and criminal apprehension, criminal investigations, special operations, crime prevention, neighborhood police services, crime scene processing, Police Service Technicians, air support, traffic management, combined communications, and other support services including planning and research, fiscal management, records management, crime analysis, automated information services, property and evidence management, personnel and recruitment, and training. The Area will receive the same services that are provided in the existing city limits upon the effective date of the annexation.

Gainesville Police Department Zones

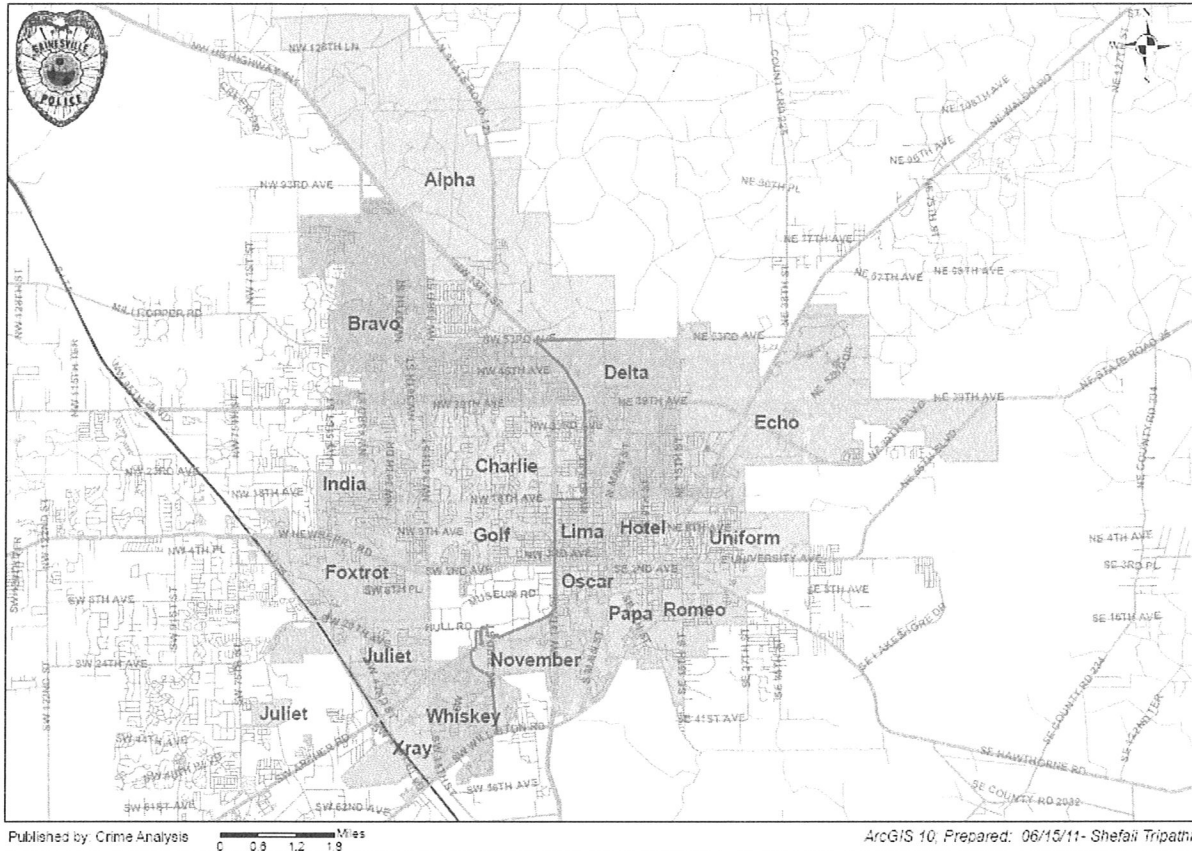

Fire Protection

Gainesville Fire-Rescue Department (GFR) presently provides emergency and non-emergency services to portions of the unincorporated urban area of Alachua County. These services are required under the current Fire Services Assistance Agreement between the City and Alachua County. City of Gainesville Stations 3 and 1 provide services to this area. The Area will receive the same services that are provided in the existing city limits upon the effective date of the annexation.

Fire hydrants in the unincorporated area of Alachua County are currently provided and maintained by the City of Gainesville in accordance with the 1990 Fire Hydrant and Public Street Lighting Services Agreement. Funding for fire hydrants is included in the base rates for water utility service.

Solid Waste Disposal

The City of Gainesville Solid Waste Department monitors residential solid waste and recycling collection services, provided under contract to residents living in single family houses and buildings containing less than five dwelling units. Other residents, businesses and

institutions contract for solid waste and recycling collection with one of several commercial providers operating under non-exclusive franchises with the City.

Alachua County contracts for residential solid waste, recycling and yard trash collection in the unincorporated mandatory service areas with the same company as does the City. Services will be extended and fees for this service will be collected through the utility billing process beginning the next October 1 after annexation.

Potable Water

Potable water services are addressed in the Gainesville Regional Utilities section of this report. That section outlines the current service level and plans for extensions after annexation.

Sanitary Sewer

Sanitary sewer services are addressed in the Gainesville Regional Utilities section of this report. That section outlines the current service level and plans for extensions after annexation.

Streets, Drainage and Flood Control

The City of Gainesville Public Works Department provides basic maintenance and repair services for all City streets within its current jurisdiction. This work includes maintenance of asphalt pavement, concrete sidewalks, concrete curbs and gutters, and roadside ditches. Basic maintenance services are also provided for public ditches and stormwater management detention/retention facilities.

The City of Gainesville currently charges a stormwater management utility fee. Any increase in impervious surfaces, without onsite mitigation, in accordance with ordinances, policies and regulations in effect at that time, will cause the stormwater management utility fee to be charged for the area that increases the total impervious surface. This fee pays for mosquito control, drainage improvements for public facilities and sweeping of streets within the City limits.

Street sweeping is an effective means of reducing the amount of debris and pollutants that enter the City's storm drain system and water resources. The Public Works Operations Division currently sweeps the City on a 4 to 6 week cycle, depending on weather and equipment. All City streets are currently swept 9 to 10 times a year.

Parks, Recreation and Cultural Affairs

The Parks, Recreation and Cultural Affairs Department currently provides organized recreation programs for youth and adults. The Department also provides passive nature facilities and programming for youth and adults. Organized recreation programs in the areas of aquatics, athletics, recreation centers, after-school and summer playground programs are provided, and a variety of special events are also available. The Area will receive the same services that are provided in the existing city limits upon the effective date of the annexation. Fees for these

programs are charged at a differential rate depending upon residency. Upon annexation, any residents of this Area would be eligible for the City of Gainesville residents' rates.

The Parks Division is responsible for the cleaning and upkeep of all City parks. In addition, this Division provides cleaning of City-owned parking lots, removal and trimming of trees located on City property, maintenance of grounds around City-owned buildings and operation of the City's Evergreen Cemetery. Basic mowing of City rights-of-way is provided on a regular basis by the Public Works Department. The Area will receive the same services that are provided in the existing City limits upon the effective date of the annexation.

Ironwood Golf Course is owned and operated by the City of Gainesville. The facilities are available to all without restriction to residence. Fees for golf programs and services are currently charged at a differential rate depending upon residency. Upon annexation, any residents of the Area would be eligible for the same rates that are available to the residents of the City of Gainesville.

The Cultural Affairs Division provides for cultural enlightenment through various programs in the arts, historical interpretation, special events and cultural programs in the County school system. The Area will receive the same services that are provided in the existing City limits upon annexation.

Housing

The Building Inspections Department enforces building and fire codes. The Department is responsible for permitting and inspections of new construction and remodeling or repair of existing buildings. Building contractors are also licensed through the Department in accordance with state and local regulations. The Building Inspections Department will provide permitting, plan review and inspections for the Area. The current staffing for the department can provide inspection services and the permitting and plan review services. The current staff will deliver services to this area without significant delays.

The City's Code Enforcement Division enforces codes relating to zoning, housing, and vehicles, hazardous or perilous lands/buildings and special sales. The current staffing in the Department can provide these services to the Area.

The Housing Division provides grants for low and moderate income housing through the use of federal and state grant funds. The City of Gainesville is a Community Development Block Grant (CDBG) entitlement jurisdiction. Upon annexation, any eligible residents of the Area would be entitled to apply for programs funded by CDBG funds. HOME funds are also utilized in the provision of housing services. The Area will receive the same services that are provided in the existing City limits upon the effective date of annexation.

Street Lighting

Street lighting in the unincorporated area of Alachua County is currently provided and funded by the City of Gainesville General Operating Fund along arterials and collectors for vehicle and pedestrian safety through the 1990 Fire Hydrant and Public Street Lighting Services Agreement. Additional streetlights may be provided in the Area in accordance with the guidelines of the City of Gainesville Transportation Services Division of the Public Works Department, as outlined in the "City of Gainesville Standards for Roadway Lighting".

Transportation

The City of Gainesville currently operates a public transportation system, the Gainesville Regional Transit System (RTS). There are bus stops located on and around the Area (see map below).

The Transportation Services Division is responsible for installation and maintenance of traffic signs, pavement markings on City streets, all parking meter operations, and mechanical traffic counts for traffic studies. The Transportation Services Division is also responsible for traffic signal operations and construction inspection services for all of Alachua County and the other municipalities, under the annual City-County Traffic Engineering Services Agreement. The Area will receive the same services that are provided in the existing city limits upon the effective date of the annexation.

Regional Transit System Routes 7, 11 and 406

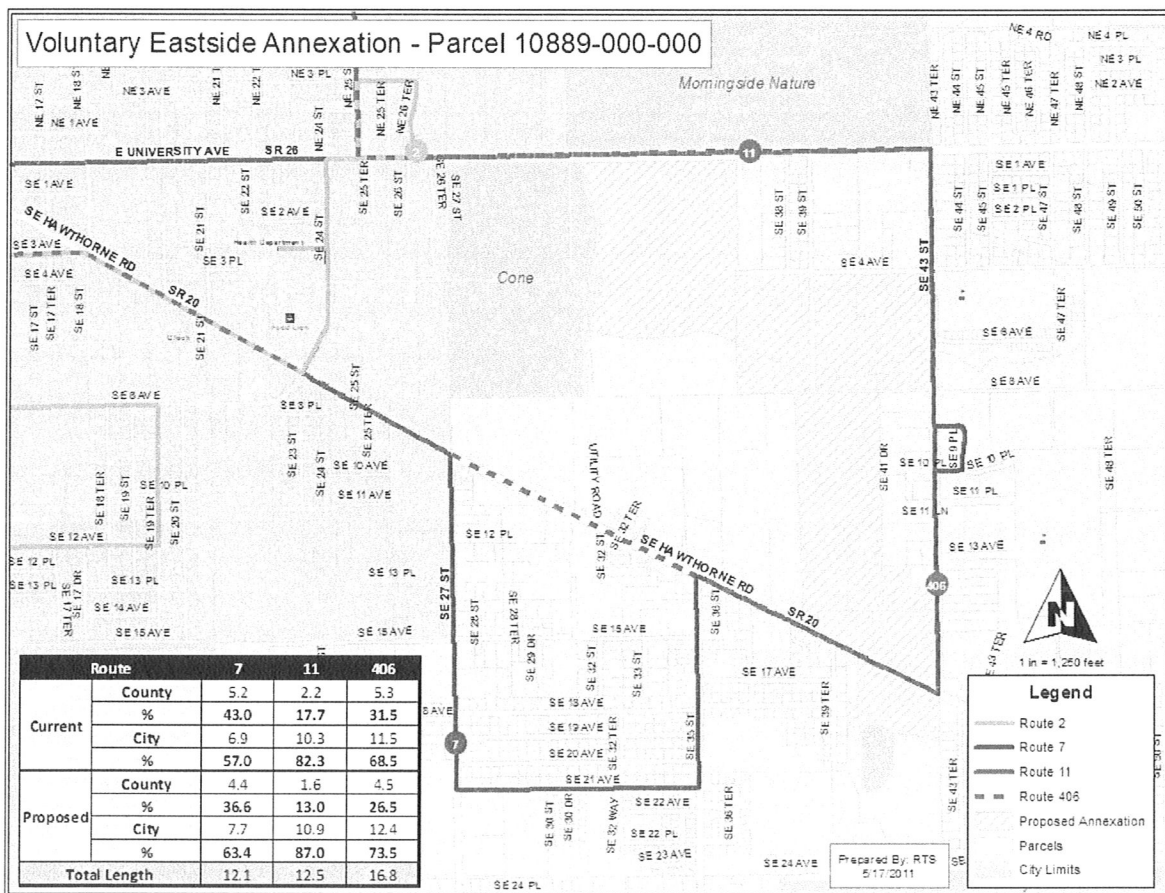

Planning and Zoning Services

The Planning and Development Services Department will provide planning and development assistance to the Area. The Alachua County Comprehensive Plan and Zoning Code will continue to regulate land use and zoning for any development in the Area until the Gainesville Comprehensive Plan is amended and the Area is rezoned to City of Gainesville zoning categories. All requests for development are reviewed by City staff and the City Plan Board or Development Review Board where appropriate. Following annexation, the City will undertake the necessary studies to amend the City Comprehensive Plan and zoning map to include the Area and will commence appropriate public hearings to complete such an amendment.

Other Governmental Services

Other services currently provided to the residents within the existing City limits of Gainesville shall be extended to the Area, where necessary, on substantially the same basis and in the same manner as such services are provided within the rest of the municipality.

WATER AND WASTEWATER FACILITIES

Gainesville Regional Utilities (GRU), owned and operated by the City of Gainesville, presently provides water and wastewater services to residents of the unincorporated area of Alachua County. Extension policies for serving new customers are the same in the City and in the proposed annexation Area.

Financing the Extension of Water and Wastewater Facilities

GRU's existing water/wastewater extension policy is that new water and wastewater customers pay the fully allocated cost for the service they receive. This cost includes the cost of the treatment facilities required for service in the form of plant connection fees. It also includes the cost of distribution or collection facilities in the form of transmission and distribution charges and/or collection system charges. Additionally, any developer requesting an extension pays a Contribution In Aid of Construction (CIAC) sufficient to ensure that GRU receives an appropriate rate of return on its portion of extension costs. This policy applies both in the City of Gainesville and in the surrounding unincorporated area of Alachua County.

Actual facility construction is funded through GRU's Construction Fund, the Utility Plant Improvement Fund (UPIF), or a combination from both funding sources. The Construction Fund consists of proceeds from the issuance of revenue bonds. The UPIF is funded by operating revenue.

Existing Major Trunk Water Mains and Proposed Extensions

In accordance with Section 13 (1) (a) of the Boundary Adjustment Act, Figure 3 shows existing major water mains in the City of Gainesville and the surrounding proposed annexation Area. Figure 4 shows water distribution system projects in GRU's approved 2008 budget. The fiscal year in which each project is proposed for construction is also shown in Figure 4. Additional funding is included in GRU's budget for extending water facilities to meet the needs of new customers and for those whose location will depend on development. Project timing is based on projected growth within the GRU service area. Actual construction times of the projects shown in Figure 4 may vary based on the actual rate or location of growth within the service area.

Existing Wastewater Collection System and Proposed Extensions

In accordance with Section 13 (1) (a), Figure 5 shows the existing major wastewater collection system in the City of Gainesville and the Area. Figure 6 shows wastewater collection system projects in GRU's approved 2008 budget. The fiscal year in which each project is proposed for construction is also shown in Figure 6. Additional funding is included in GRU's budget for extending wastewater facilities, to meet the needs of new customers and for those whose location will depend upon development. Project timing is based on projected growth within the GRU service area. Actual construction times may vary as a result of service being required either earlier or later than originally anticipated.

Figure 1: Area Proposed for Annexation



Voluntary East Side Properties Annexation City of Gainesville, FL

- Proposed Annexation Area (approx. 228.9 acres)
- Gainesville City Limits

0 500 1,000 2,000 Feet



Prepared by Planning and Development Services/GIS, May 12, 2011
File: T:\Projects\Planning\Urban_Service_Reports\Demetree\Metro_05-12-11

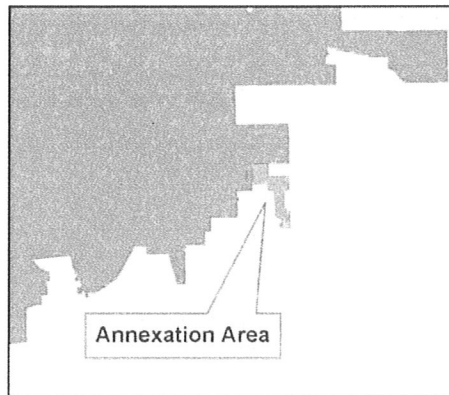

**Figure 2:
Alachua County General Land Use Surrounding Area**

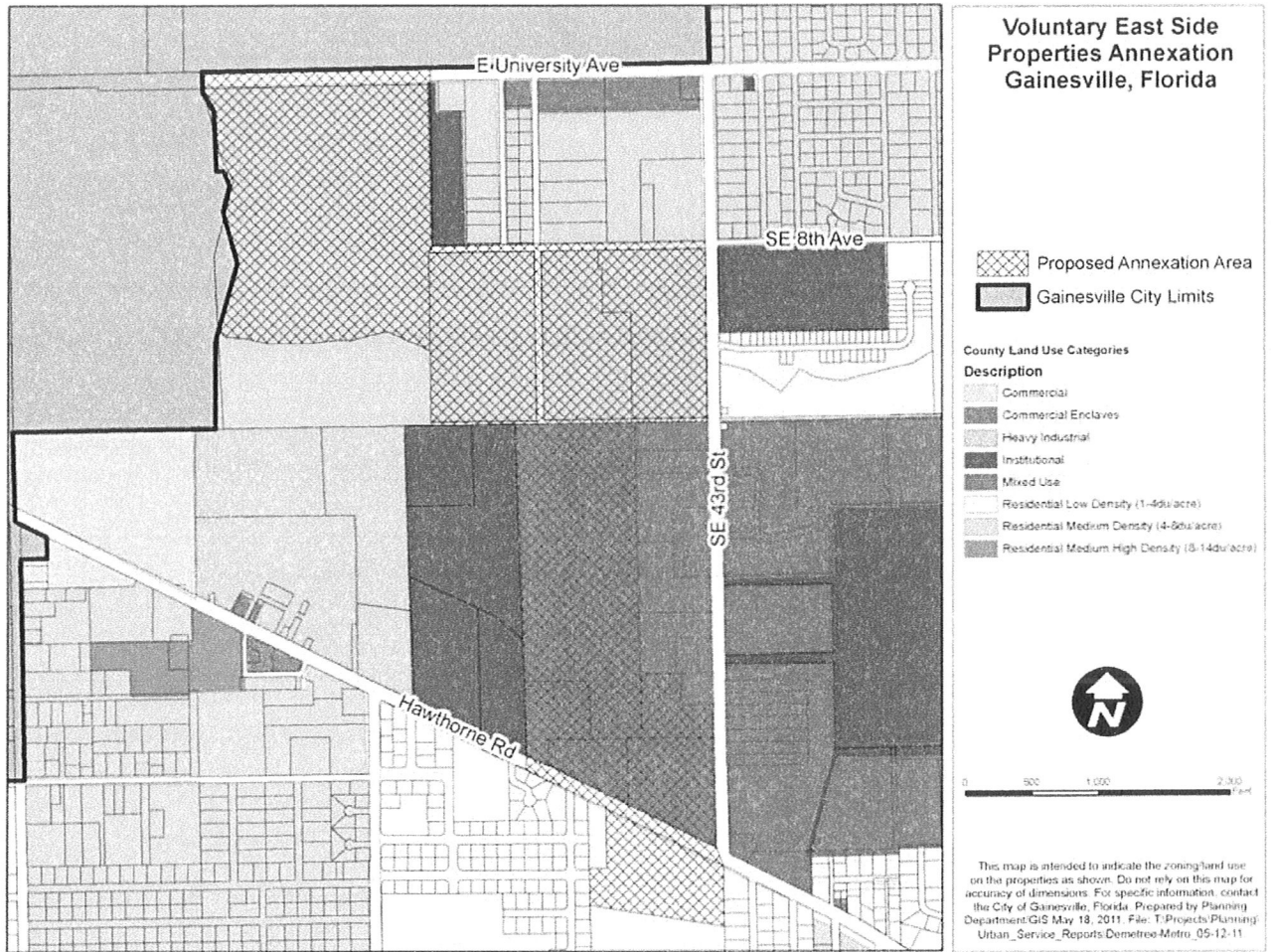

Figure 5: Wastewater Utility Facilities

