

St. Michael's Church Property
Development

Traffic and Safety Issues

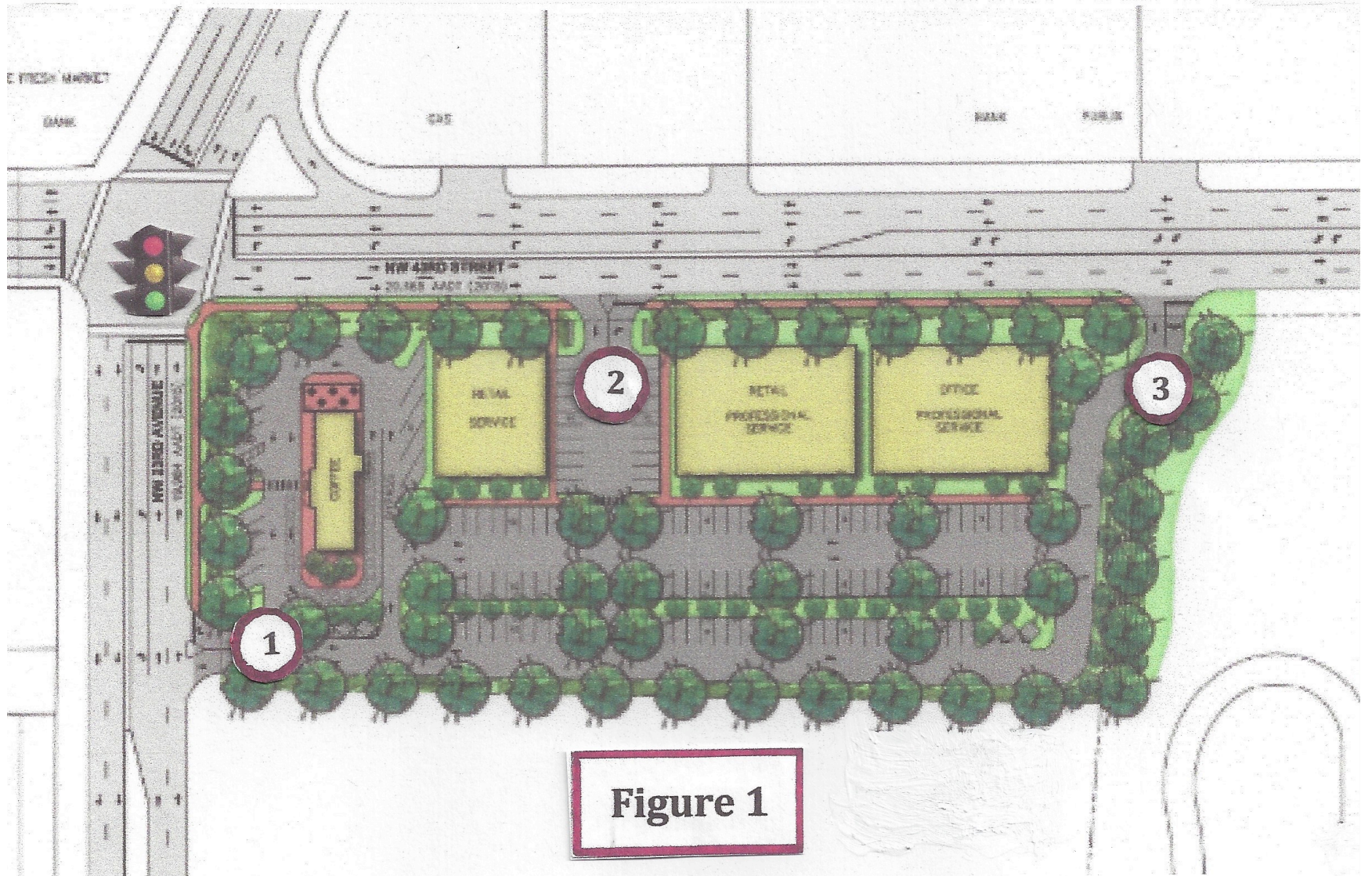
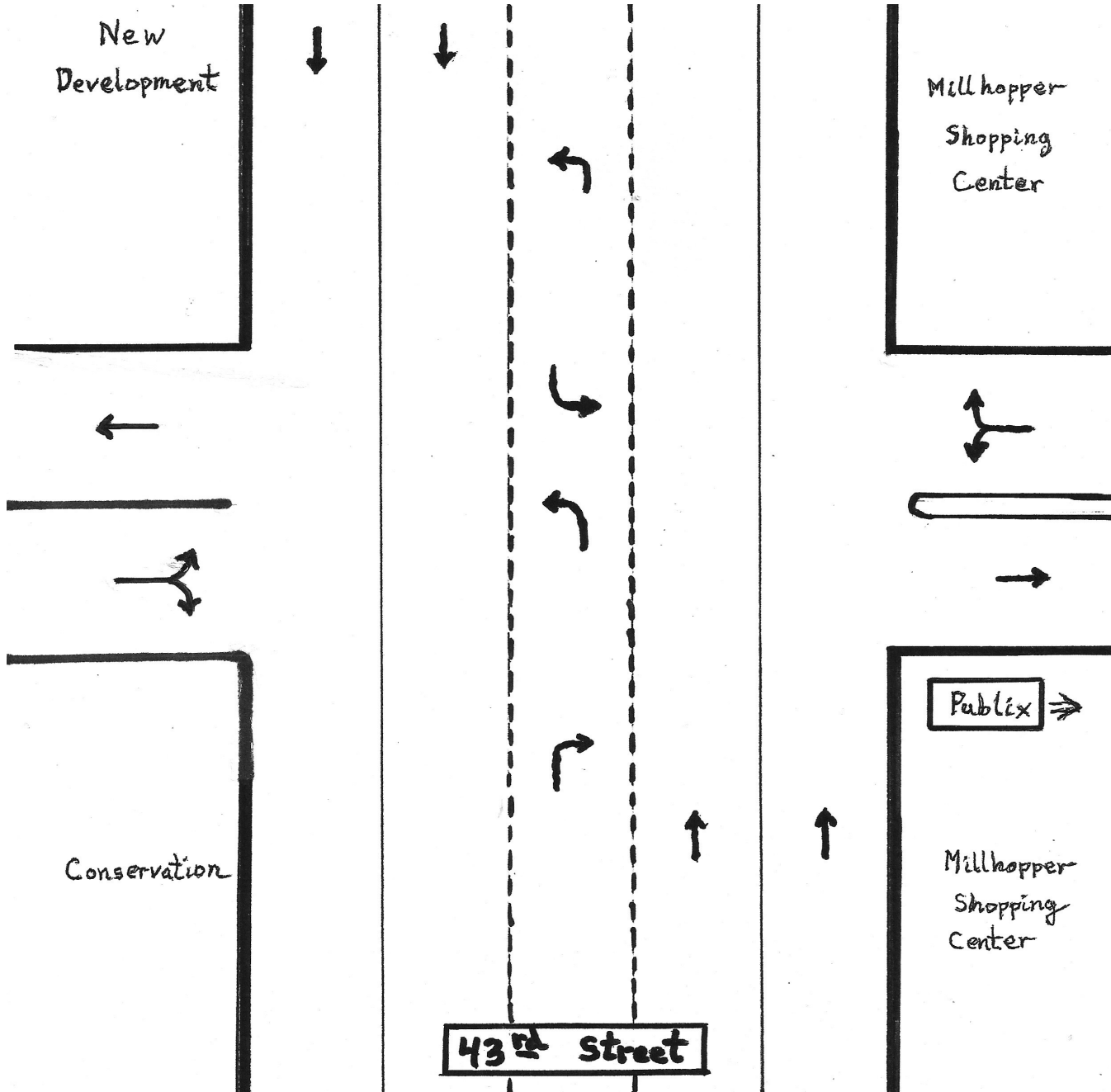
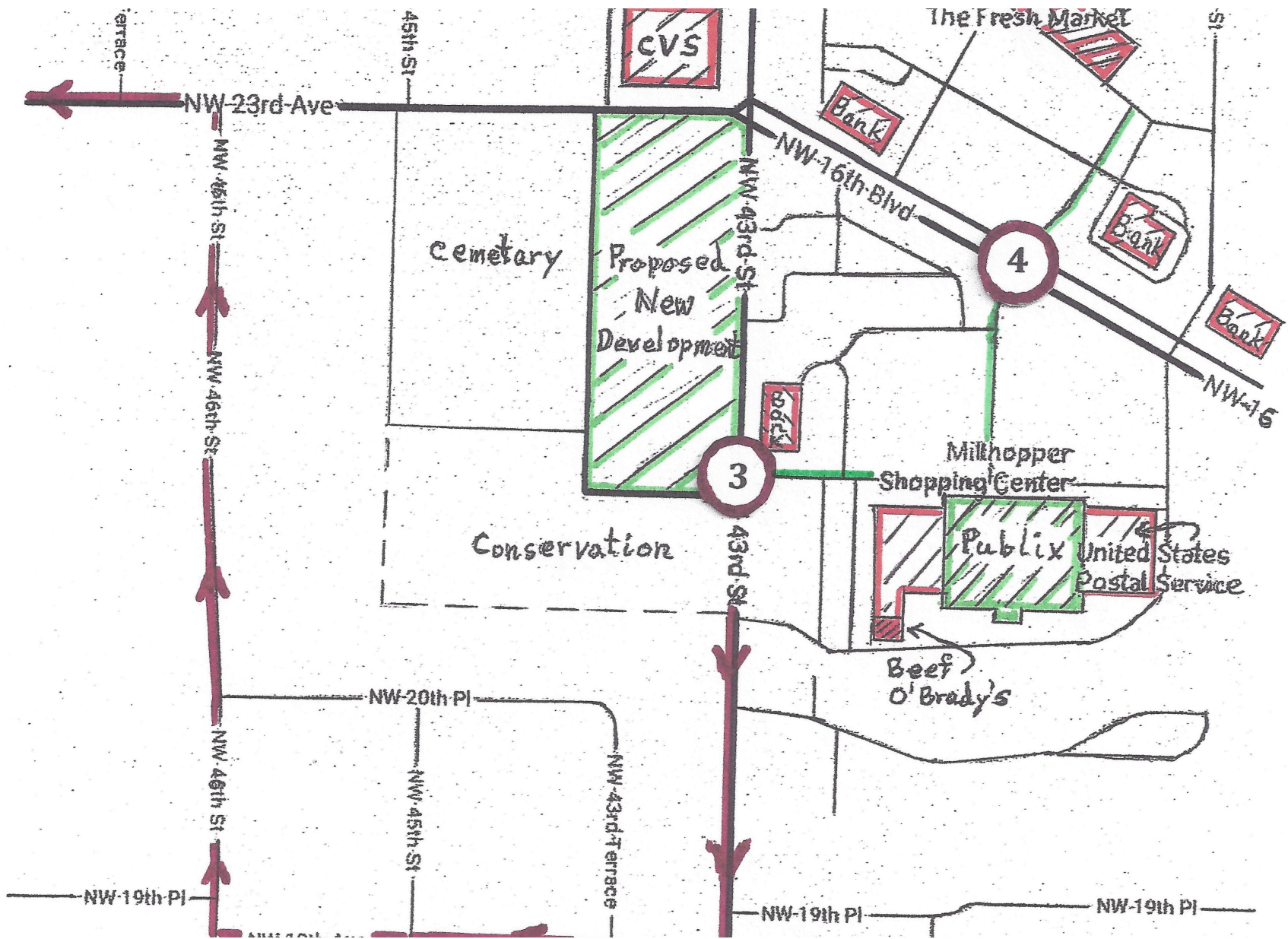

Figure 1

Traffic Safety Issues

1: The Southeast Exit (#3) will not function safely as it is Proposed





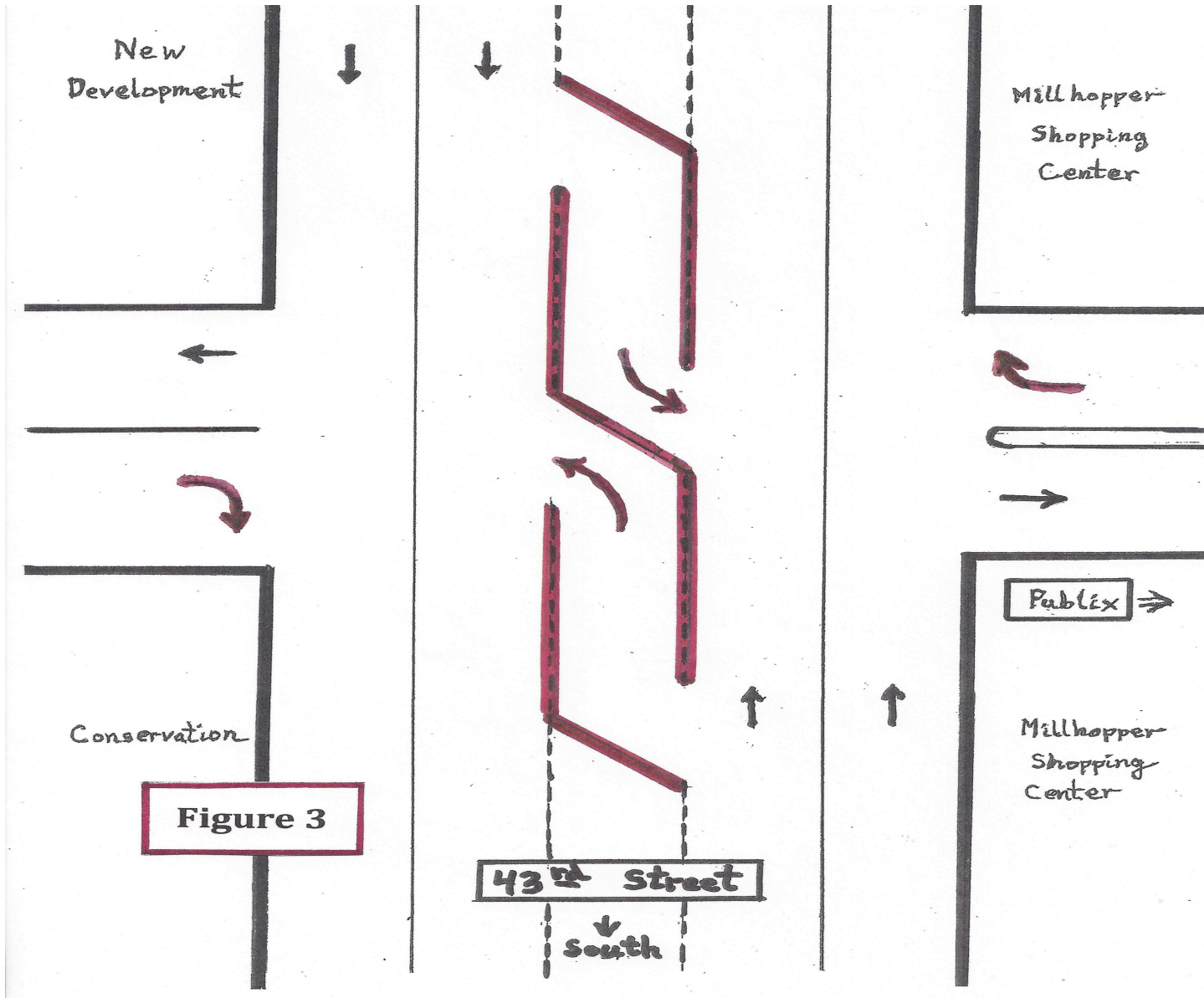

Traffic Safety Issues

1: The Southeast Exit (#3) will not function safely as it is proposed

**2: There are Only Two Safe Exit Directions from this New Development:
East on 23rd Avenue and
South on 43rd Street**

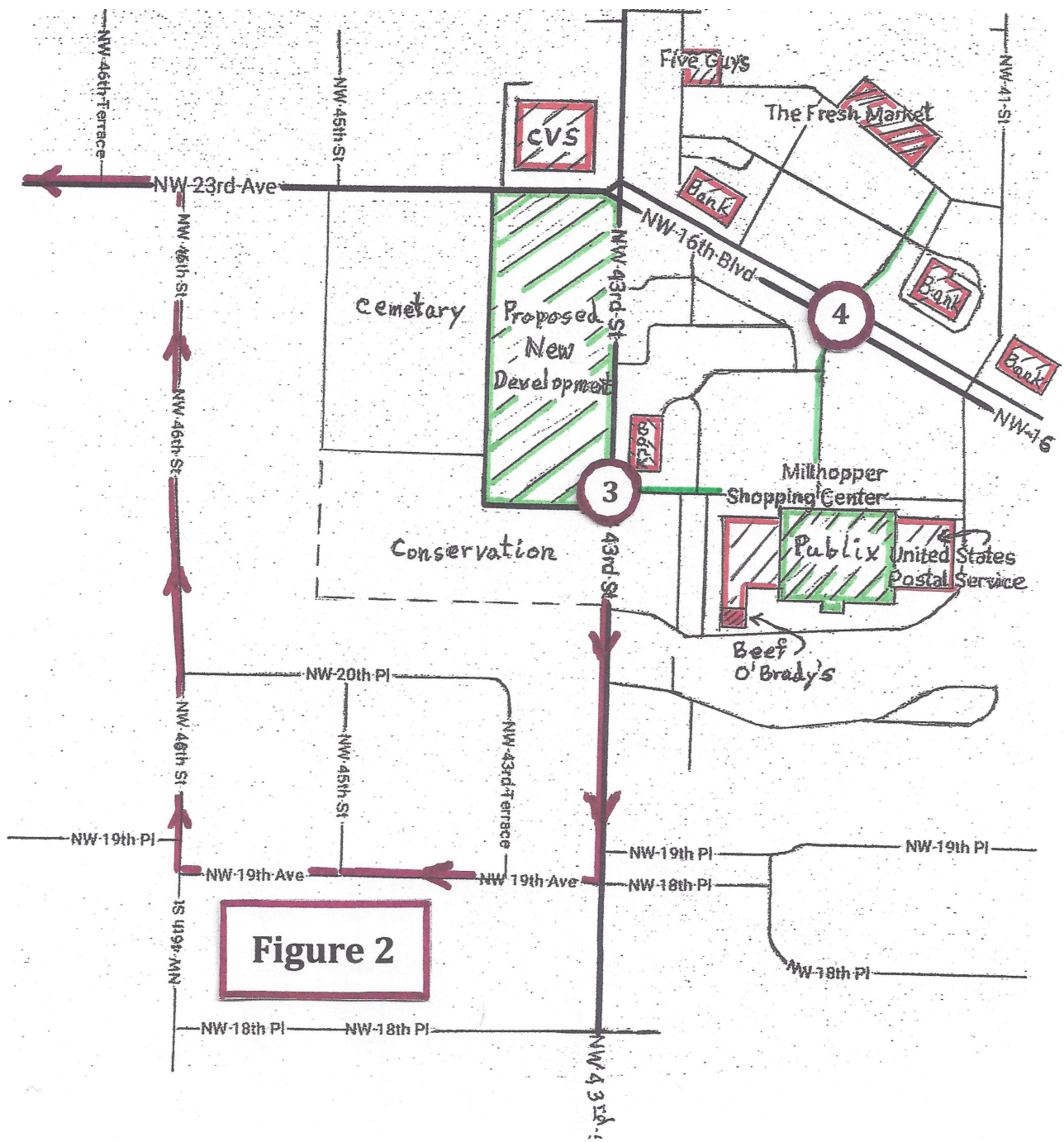

Figure 2

Traffic Safety Issues

- 1: The Southeast Exit (#3) will not function safely as it is Proposed**
- 2: There are Only Two Safe Exit Directions from this New Development**
- 3: Development Customers wishing to Exit West on 23rd Avenue will Cut-Thru Suburban Heights – Introducing Substantial Cut-Thru Traffic and Pedestrian Safety Hazards into that Neighborhood**

Development Traffic Volume (their Number):

1472 Vehicles per day

Conservative Estimate:

17% want to exit West on 23rd Ave.

Suburban Heights Cut-Thru Traffic Volume:

250 Vehicles per day

Request:

**Protect our Suburban Heights Neighborhood
Children and other Pedestrians and Bikers**

**The development's extensive West Exit Cut-Thru
Traffic should not be allowed to pour thru
Suburban Heights**

**Say NO to the Rezone and
YES to a Safer Community**