

LEGISLATIVE #

110821D

Petition PB-11-136 LUC
December 5, 2011

Appendix B Supplemental Documents



EXHIBIT B-1

AERIAL PHOTOGRAPH



Name	Petition Request	Map(s)	Petition Number
City Plan Board, applicant	Amend the FLUM from Alachua County Commercial (COMM) to City of Gainesville Urban Mixed Use 2 (UMU2).	4245	PB-11-136 LUC

**City of Gainesville
Land Use Categories**

- MU-L Mixed-Use Low Intensity (8-30 units per acre)
- C Commercial
- E Education
- PF Public Facilities
- PUD Planned Use Development

**Alachua County
Land Use Categories**

- COMM Commercial
- HIGH High Density Residential (14-24 units/acre)

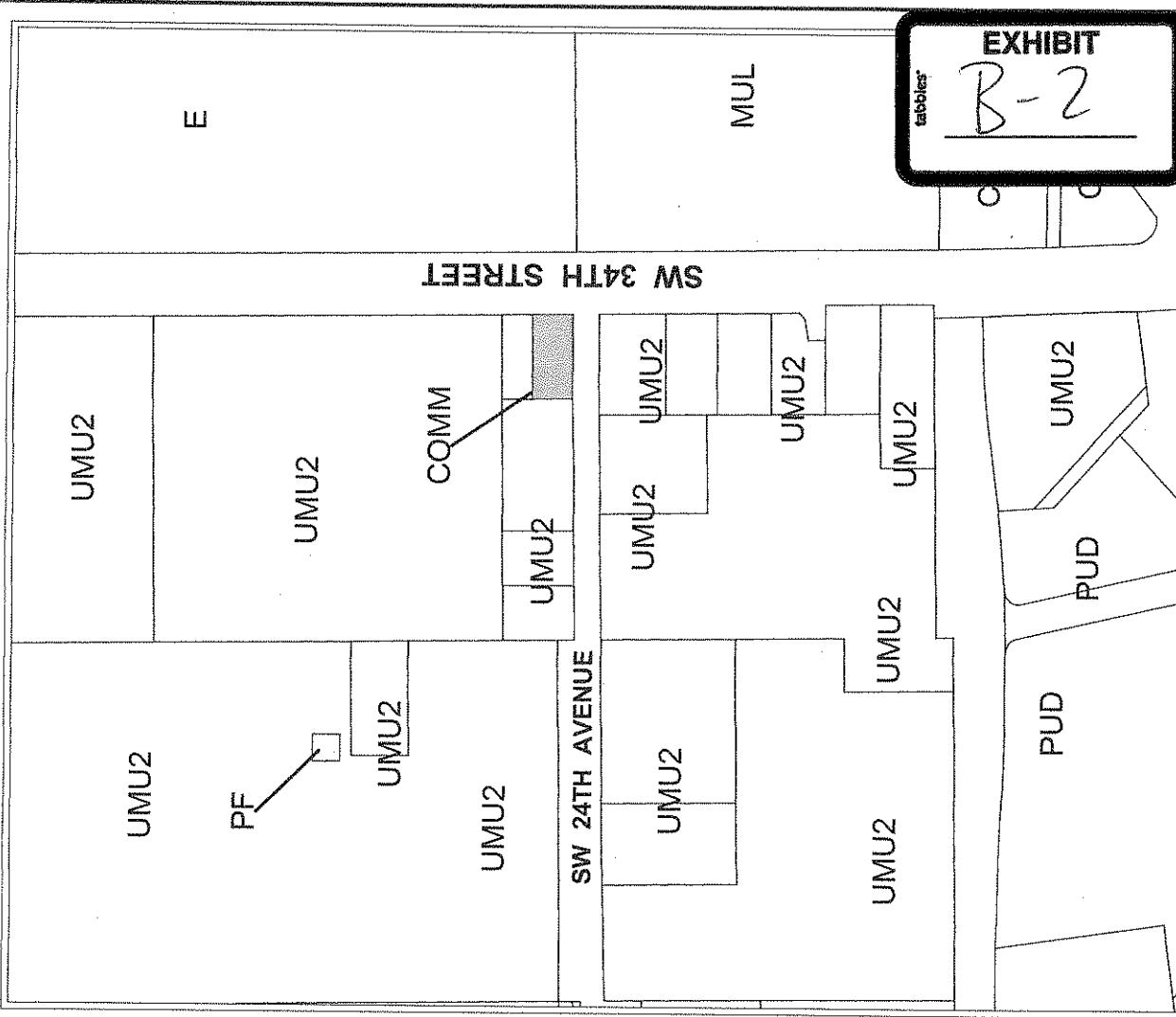

EXHIBIT
B-2

EXISTING LAND USE	
Name	Petition Request
City Plan Board, applicant	Amend the FLUM from Alachua County Commercial (COMM) to City of Gainesville Urban Mixed Use 2 (UMU2).
	Map(s)
	4245
	Petition Number
	PB-11-136 LUC
	110821D

**City of Gainesville
Land Use Categories**

- MU-L Mixed-Use Low Intensity (8-30 units per acre)
- C Commercial
- E Education
- PF Public Facilities
- PUD Planned Use Development

**Alachua County
Land Use Categories**

- COMM Commercial
- HIGH High Density Residential (14-24 units/acre)

Area under petition consideration

----- Division line between two zoning districts

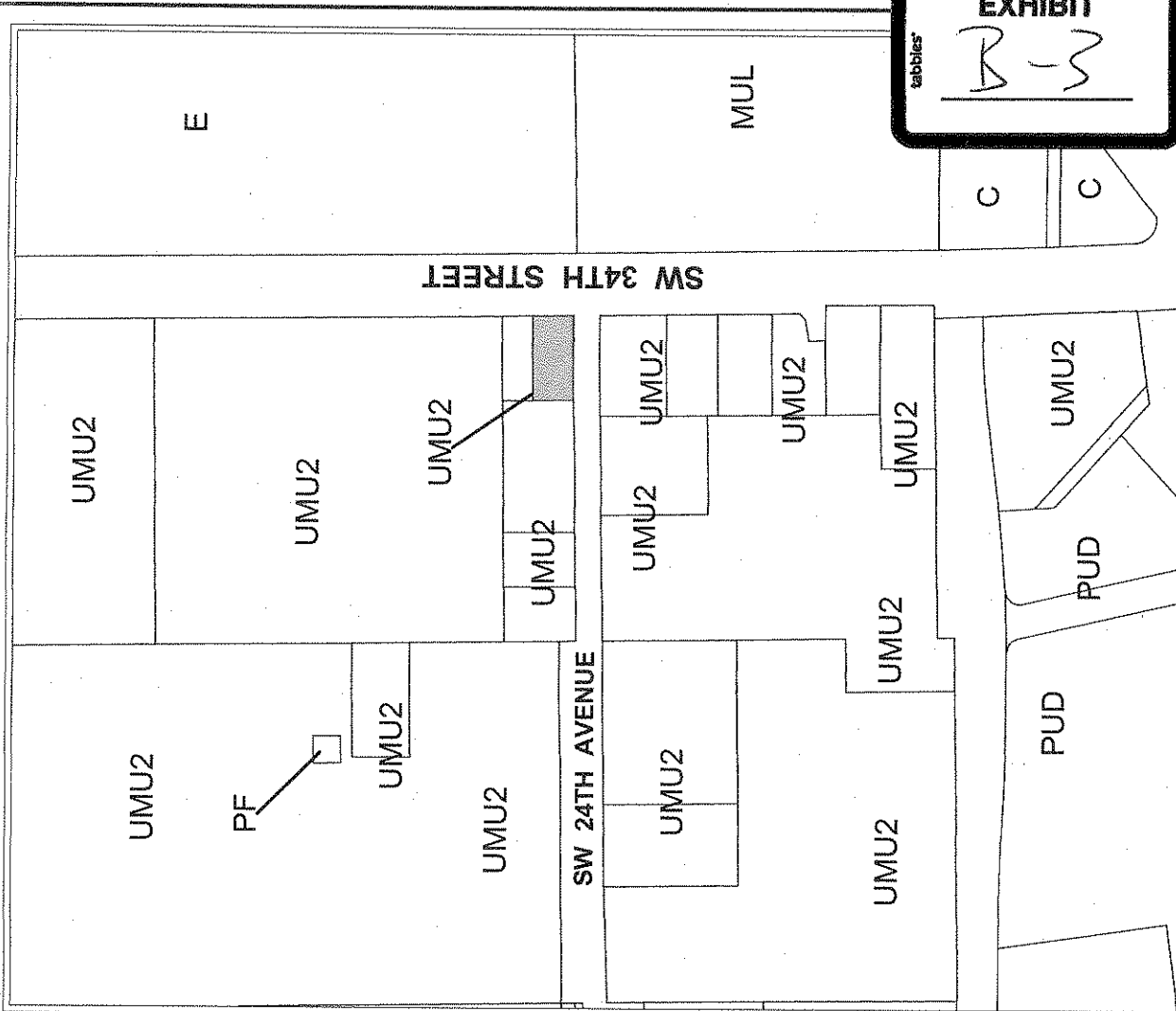

PROPOSED LAND USE

Name	Petition Request	Map(s)	Petition Number
City Plan Board, applicant	Amend the FLUM from Alachua County Commercial (COMM) to City of Gainesville Urban Mixed Use 2 (UMU2).	4245	PB-11-136 LUC 110821D



No Scale