

**AERIAL PHOTOGRAPH**

090299A

Name	Petition Request	Map(s)	Petition Number
<p>Causseaux, Hewett &amp; Walpole, Inc agents for Alachua County</p>	<p>Rezone Subject Property from PS and Conservation to BI (Business-Industrial). Change FLUM from PF and CON designations to BI (Business Industrial).</p>	<p>3556</p>	<p>PZ-09-80 LUC PZ-09-81 ZON</p>



# Zoning District Categories

- RSF1 Single-Family Residential (3.5 du/acre)
  - RSF2 Single-Family Residential (4.6 du/acre)
  - RSF3 Single-Family Residential (5.8 du/acre)
  - RSF4 Single-Family Residential (8 du/acre)
  - RSF5 Residential Low Density (12 du/acre)
  - RC Residential Conservation (12 du/acre)
  - MH Mobile Home Residential (12 du/acre)
  - RMF6 Multiple-Family Medium Density Residential (8-15 du/acre)
  - RMF7 Multiple-Family Medium Density Residential (8-21 du/acre)
  - RMF8 Multiple-Family Medium Density Residential (8-30 du/acre)
  - RMU Residential Mixed Use (up to 75 du/acre)
  - RH1 Residential High Density (8-43 du/acre)
  - RH2 Residential High Density (8-100 du/acre)
  - OR Office Residential (up to 20 du/acre)
  - OF General Office
  - PD Planned Development
  - BUS Business
  - BA Automotive-Oriented Business
  - BT Tourist-Oriented Business
  - MU1 Mixed Use Low Intensity (8-30 du/acre)
  - MU2 Mixed Use Medium Intensity (12-30 du/acre)
  - UMU1 Urban Mixed Use District 1 (up to 75 du/acre)
  - UMU2 Urban Mixed Use District 2 (up to 100 du/acre)
  - CCD Central City District
  - BI Business Industrial
  - W Warehousing and Wholesaling
  - I1 Limited Industrial
  - I2 General Industrial
  - AGR Agriculture
  - CON Conservation
  - MD Medical Services
  - PS Public Services and Operations
  - AF Airport Facility
  - ED Educational Services
  - CP Corporate Park
- Historic Preservation/Conservation District  
 Special Area Plan  
 Division line between two zoning districts  
 City Limits
- Area under petition consideration

090299A

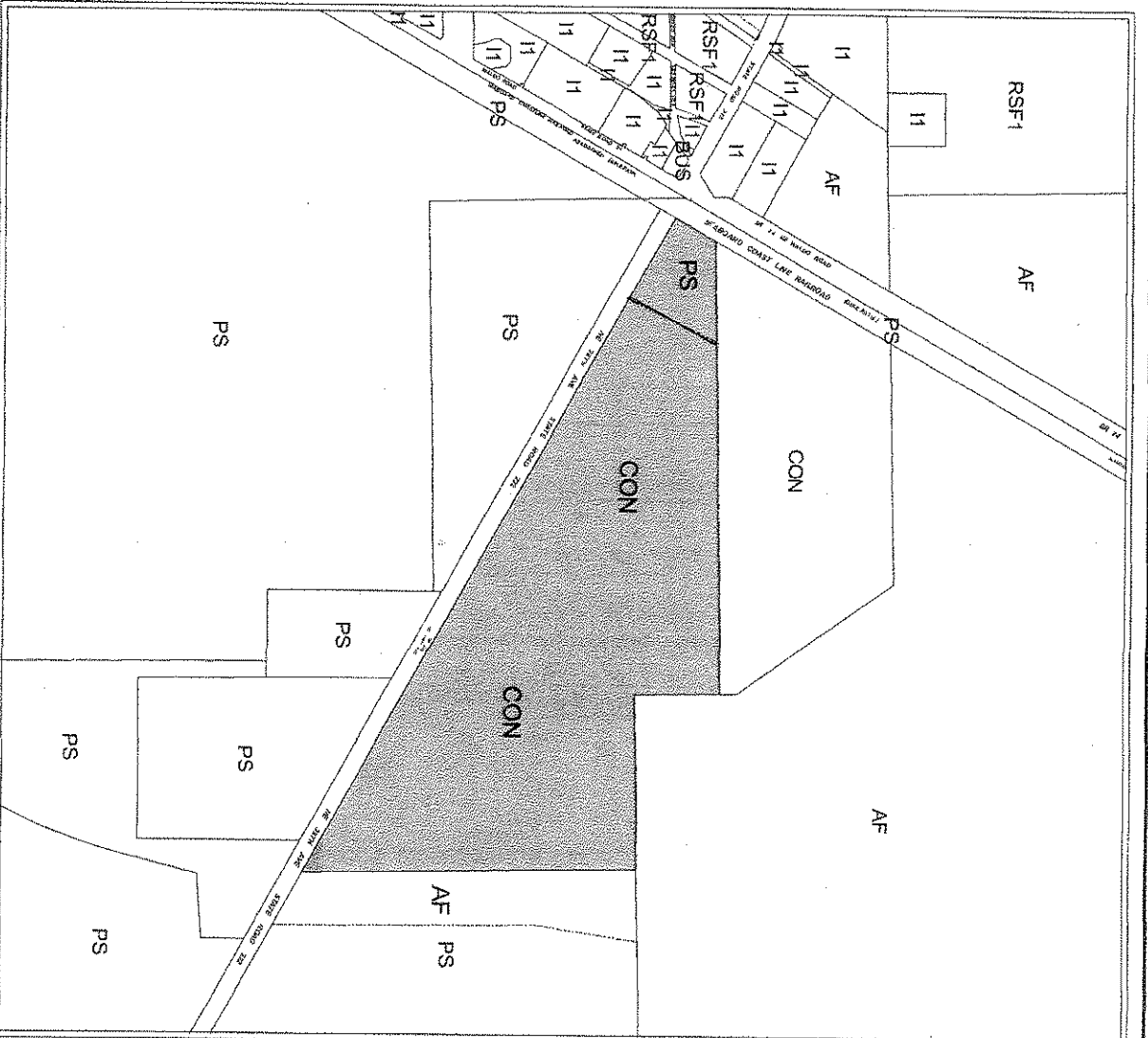

## EXISTING ZONING

Name	Petition Request	Map(s)	Petition Number
Causseaux, Hewett & Walpole, Inc agents for Alachua County	Rezoned Subject Property from PS and Conservation to BI (Business-Industrial).	3556	PZ-09-81 ZON

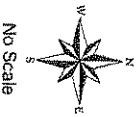

# Zoning District Categories

- RSF1 Single-Family Residential (3.5 du/acre)
- RSF2 Single-Family Residential (4.6 du/acre)
- RSF3 Single-Family Residential (5.8 du/acre)
- RSF4 Single-Family Residential (8 du/acre)
- RMF5 Residential Low Density (12 du/acre)
- RC Residential Conservation (12 du/acre)
- MH Mobile Home Residential (12 du/acre)
- RMF6 Multiple-Family Medium Density Residential (8-15 du/acre)
- RMF7 Multiple-Family Medium Density Residential (8-21 du/acre)
- RMF8 Multiple-Family Medium Density Residential (8-30 du/acre)
- RMU Residential Mixed Use (up to 75 du/acre)
- RH1 Residential High Density (8-43 du/acre)
- RH2 Residential High Density (8-100 du/acre)
- OR Office Residential (up to 20 du/acre)
- OF General Office
- PD Planned Development
- BUS Business
- BA Automotive-Oriented Business
- BT Tourist-Oriented Business
- MU1 Mixed Use Low Intensity (8-30 du/acre)
- MU2 Mixed Use Medium Intensity (12-30 du/acre)
- UMU1 Urban Mixed Use District 1 (up to 75 du/acre)
- UMU2 Urban Mixed Use District 2 (up to 100 du/acre)
- CCD Central City District
- BI Business Industrial
- W Warehousing and Wholesaling
- I1 Limited Industrial
- I2 General Industrial
- AGR Agriculture
- CON Conservation
- MD Medical Services
- PS Public Services and Operations
- AF Airport Facility
- ED Educational Services
- CP Corporate Park
- Historic Preservation/Conservation District
- Special Area Plan
- Division line between two zoning districts
- City Limits

Area under petition consideration

662060

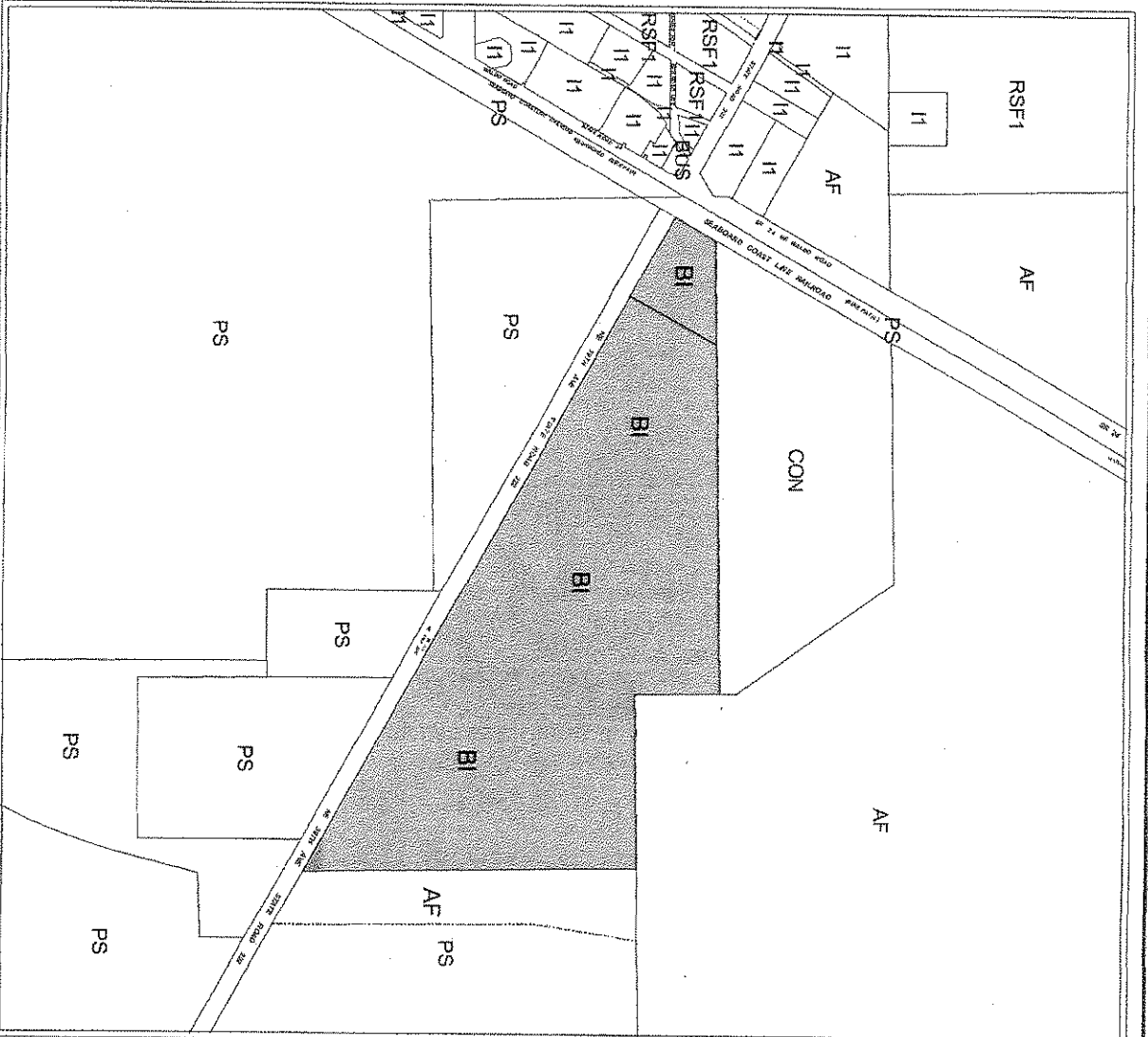

## PROPOSED ZONING

Name	Petition Request	Map(s)	Petition Number
Causseaux, Hewett & Walpole, Inc agents for Alachua County	Rezone Subject Property from PS and Conservation to BI (Business-Industrial).	3556	PZ-09-81 ZON

