

## Firm Profile

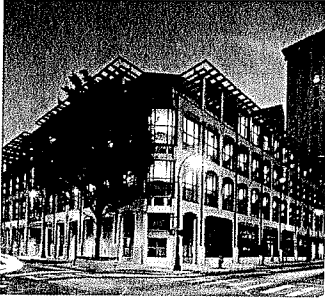

Lord, Aeck & Sargent is a full-service, award-winning architectural firm with over 3,000 projects completed. With offices in Atlanta, Ann Arbor, Michigan, and Chapel Hill, North Carolina, our firm has five studios: Architecture for Arts & Culture, Architecture for Education, Architecture for Historic Preservation, Architecture for Science, and Architecture for Housing & Mixed-Use.

We share a common mission of providing **responsive design**, **technological expertise** and **exceptional service** in order to provide our clients with the best possible facilities that will serve them well into the future.



Our portfolio includes museums, arts centers, government buildings, laboratories, corporate headquarters, education facilities and conference facilities. Our services range from master planning and programming to design, construction administration and facility management support.

The design staff at Lord, Aeck & Sargent represents a broad range of experiences in design and construction. Our staff includes registered architects, interior designers, materials specialists, land planners, cost estimators and zoning specialists.

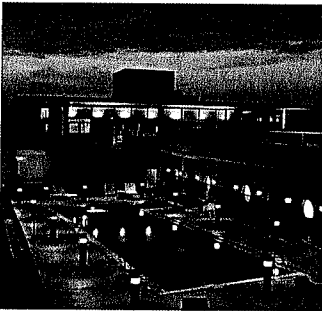

We are proud of our long-standing reputation for providing exceptional service to repeat clients including The Woodruff Arts Center, Arizona State University, the National Park Service, Duke University Medical Center, Board of Regents University System of Georgia, University of North Carolina at Chapel Hill School of Medicine, U.S. Department of Agriculture and Emory University School of Medicine.

Our projects have been featured in over 500 articles in various publications. We have been awarded more than 150 awards including national distinctions such as four *R&D Magazine* Laboratory of the Year and Special Mentions Awards as well as multiple AIA Honor Awards for Excellence in Architecture for our work with a wide variety of clients, including the Georgia Public Health Laboratory, the Aaron Diamond AIDS Research Center and the Georgia State Capitol.



At Lord, Aeck & Sargent, our goal is to create buildings that have a restorative, positive impact on the building's inhabitants and to reduce the negative impact of construction on the environment. We have practiced sustainability in architecture since the early 1990s and believe in using an analytical approach to optimizing building performance.



Additionally, Lord, Aeck & Sargent has become one of the first architecture firms in the country to adopt The 2030 Challenge, an initiative that calls on the global building sector to immediately reduce energy usage by 50 percent in new buildings and major renovations in order to avoid hazardous climate change.

## Housing & Mixed-Use Studio

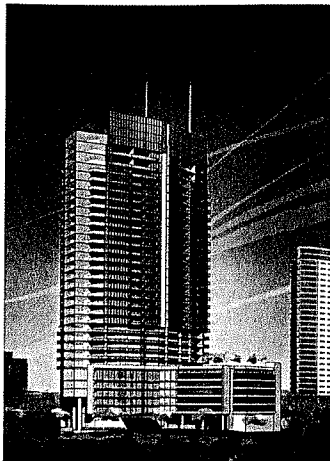

The Housing & Mixed-Use studio is very active in providing creative solutions for new, innovative urban residential buildings, as well as converting obsolete buildings to new uses. Our projects are often complex, and may involve a combination of new construction, adaptive use, historic preservation and mixed-use programs. We provide creative solutions for land-use, planning, residential and mixed-use architecture as well as zoning, and entitlement services.

Our areas of expertise are in the design and planning of residential units, multifamily buildings and vertically integrated mixed-use developments. We are experienced in the technical aspects of residential and mixed-use construction - from low-rise to high-rise. To every project, we bring an understanding of the fundamentals of urban planning, including assistance with planning for neighborhood development and projects that encompass multi-acre sites, strong design concepts and an attention to detail that is critical to the success of mixed-use projects. A sampling of our Housing & Mixed-Use Studio clients includes:

<i>Alliance Realty Partners</i>	<i>Julian LeCraw &amp; Company</i>
<i>Alpine Homes</i>	<i>Kim King Associates</i>
<i>AMLI Residential</i>	<i>The Lane Company</i>
<i>Ambling Companies</i>	<i>Long Real Estate Developers</i>
<i>Atlanta Beltline Inc.</i>	<i>McCord Development</i>
<i>BHC Property Group</i>	<i>MCL Companies</i>
<i>Braden Fellman Group</i>	<i>Miles Development Partners</i>
<i>Cartel Properties</i>	<i>The Morgan Companies</i>
<i>Carter Management &amp; Leasing</i>	<i>OA Development</i>
<i>Chosewood Park Nbrhd. Assoc.</i>	<i>Opus South Corporation</i>
<i>City of Atlanta, Bureau of Planning</i>	<i>Parkside Partners</i>
<i>City of Dahlonega</i>	<i>Place Properties</i>
<i>Coro Realty Advisors</i>	<i>Perennial Properties</i>
<i>Cross-Town Realty Development</i>	<i>Pollack Partners</i>
<i>Dartmouth Development</i>	<i>Rame Homes</i>
<i>Gables Residential</i>	<i>Related Group</i>
<i>Gallman Development Group</i>	<i>Thirty-third Latitude Properties</i>
<i>Grant Park Neighborhood Assoc.</i>	<i>Touchstone Homes</i>
<i>Home Marketing America</i>	<i>Virginia Highland Civic Assoc.</i>
<i>Home Park Comm. Imprv. Assoc.</i>	<i>Wieland Commercial Group</i>
<i>Inman Park Properties</i>	

## Science Studio

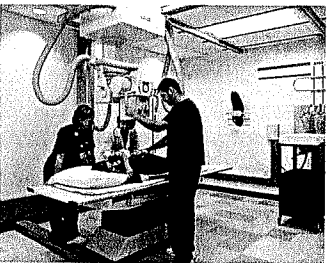
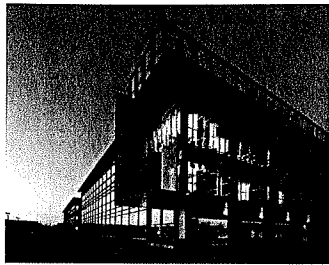

Lord, Aeck & Sargent's Architecture for Science Studio designs scientific, medical research and teaching facilities using innovative materials, functional, user-friendly layouts and strict attention to environmental and biosafety standards. The pursuit of science has become an interdisciplinary endeavor. We strive to create environments that enhance interaction and collaboration while maintaining the highest attainable level of design, technology and safety.

Scientific inquiry begins with a BIG IDEA. We listen. We create. We deliver exceptional facilities that support moving the idea into reality faster and more effectively, with results that provide the outcome appropriate to our client. Our interactive design process helps ensure that these facilities not only support the work being done, but also provide pleasant, attractive spaces that can improve morale, user satisfaction and employee effectiveness. We help our clients achieve their goals through responsive design, technological expertise and exceptional service.

Our Science Studio has the experience to take your complex science project from the early dream stage to final systems commissioning. A sampling of our Science Studio clients includes:

#### **Government Agencies**

*New York Dept. of Public Health  
Arkansas Department of Health  
Centers for Disease Control  
Environmental Protection Agency  
Georgia Dept. of Public Health  
Jet Propulsion Laboratory  
NASA  
Oak Ridge National Laboratories  
U.S. Department of Agriculture*

#### **Corporate and Non-Profit**

*Aaron Diamond Research Center  
AlphaVax, Inc.  
Arizona Chemicals  
Inspire Pharmaceuticals  
Merial, Ltd.  
Siemens  
Solvay Pharmaceuticals  
Thiele Kaolin*

#### **Colleges & Universities**

*Arizona State University  
Duke University Medical Center  
Emory University  
Georgia Institute of Technology  
Georgia State University  
Meredith College  
Medical College of Georgia  
North Carolina State University  
Presbyterian College  
St. Bonaventure University  
University of Michigan  
University of Michigan-Dearborn  
University of North Carolina  
Vanderbilt University*



Lord, Aeck & Sargent's Community Planning Studio is active in providing creative solutions for land-use, planning, residential and mixed-use architecture. Work includes the design of new and innovative buildings as well as the conversion of former mills, factories, warehouses, schools and office buildings to residential, office and mixed-use occupancies.



Our projects are complex and often involve a combination of contextual design, adaptive use, historic preservation and multi-layered programmatic requirements. We have been involved in projects at the master planning and urban design levels, including assistance with neighborhood development, multi-acre sites, single-family residential neighborhood planning in undeveloped urban core areas and large mixed-use developments.

Our portfolio includes a variety of planning projects that demonstrate our strength in urban planning and architecture. Examples of our innovative design solutions include:

- Studioplex, an old mill building in the historic Old Fourth Ward that was rehabilitated into offices, studios and living space for local artists.
- The former General Motors plant in South Atlanta, which involves the redevelopment of a 40-acre site into mixed-use housing and retail.
- A 10-acre site in the Inman Park neighborhood of northeast Atlanta that straddles the proposed Atlanta Belt Line and includes historic single-family housing and dense, residential and retail mixed-use development.

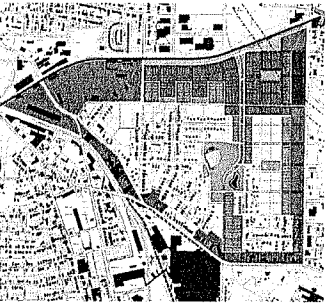

Each of these projects includes master planning the multi-acre, primary site, and collaborating with various neighborhood organizations and jurisdictional authorities, in preparing an urban design strategy for the redevelopment of the neighborhood.



Lord, Aeck & Sargent provides a full range of architectural services, as well as planning, zoning, and entitlement services. Areas of expertise are in the design of residential units, multifamily buildings and vertically integrated mixed-use developments. We are experienced in the technical aspects of planning, residential and mixed-use construction - from low-rise to high-rise. We bring to every project an understanding of the fundamentals of urban planning, strong design concepts and an attention to detail that is critical to the success of complex projects.