



STATE OF FLORIDA DEPARTMENT OF STATE Division of Archives, History and Records Management DS-HSP 3AAA Rev 3-79

FLORIDA MASTER SITE FILE Site Inventory Form

FDAHRM 802 = = 1009 = = 820 = = 905 = =

Site Name _____ 830 = = Site No. 8 AL 1573 Survey Date 8007 820 = = 905 = = Address of Site: 1227 NW 4 Ave, Gainesville, Fla. 32601 Instruction for locating _____ (Tax No. 14012) 813 = =

Location: Brown's Addition 14 lot 5 & 10' adj. on W side 808 = = subdivision name block no. lot no.

County: Alachua 808 = = Owner of Site: Name: Jenkins, Mary E. Address: 3840 NW 15 St Gainesville, Fla. 32601 902 = =

Type of Ownership private 848 = = Recording Date _____ 832 = = Recorder: Name & Title: Ann DeRosa Byrne, (Consultant) Address: The History Group 300 W. Peachtree St. Suite 16 DE Atlanta, Ga. 30308 818 = =

Condition of Site: Integrity of Site: Original Use private residence 838 = =

Check One: Excellent 863 = = Good 863 = = Fair 863 = = Deteriorated 863 = = Check One or More: Altered 858 = = Unaltered 858 = = Original Site 858 = = Restored () (Date: X) 858 = = Moved () (Date: X) 858 = = Present Use private residence 850 = = Dates: Beginning c+1930 844 = = Culture/Phase American 840 = = Period 20th Century 845 = =

NR Classification Category: building 916 = =

Threats to Site: Check One or More: Zoning (X) 878 = = Transportation (X) 878 = = Development (X) 878 = = Fill (X) 878 = = Deterioration (X) 878 = = Dredge (X) 878 = = Borrowing (X) 878 = = Other (See Remarks Below): 878 = =

Areas of Significance: architecture, local history 910 = =

Significance: This house contributes in scale and character to the Fifth Avenue neighborhood which has been evolving since the mid-nineteenth century. This common bond brick house is period revival cottage with classical tendencies. The door surround is made up of two Corinthian pilasters with entablature. The house is located in Shellie Court which was platted in 1935, although the tax assessor's reported date of construction is 1933. SEE SITE FILE STAFF FOR ORIGINAL PHOTO(S) OR MAP(S) 911 = =

5

1

ARCHITECT _____ 872 = =
 BUILDER _____ 874 = =
 STYLE AND/OR PERIOD masonry vernacular period revival 964 = =
 PLAN TYPE rectangular: irregular 966 = =
 EXTERIOR FABRIC(S) brick: common 854 = =
 STRUCTURAL SYSTEM(S) masonry: brick 856 = =
 PORCHES _____ 942 = =
 FOUNDATION: continuous: brick 942 = =
 ROOF TYPE: gable 942 = =
 SECONDARY ROOF STRUCTURE(S): _____ 942 = =
 CHIMNEY LOCATION: E: wall, exterior 942 = =
 WINDOW TYPE: DHS, 6/6, wood 942 = =
 CHIMNEY: brick 882 = =
 ROOF SURFACING: composition shingle 882 = =
 ORNAMENT EXTERIOR: _____ 882 = =
 NO. OF CHIMNEYS 1 852 = = NO. OF STORIES 1 950 = =
 NO. OF DORMERS _____ 954 = =
 Map Reference (incl. scale & date) _____ 809 = =
 Latitude and Longitude: _____ 800 = =
 Site Size (Approx. Acreage of Property): LT 1 833 = =

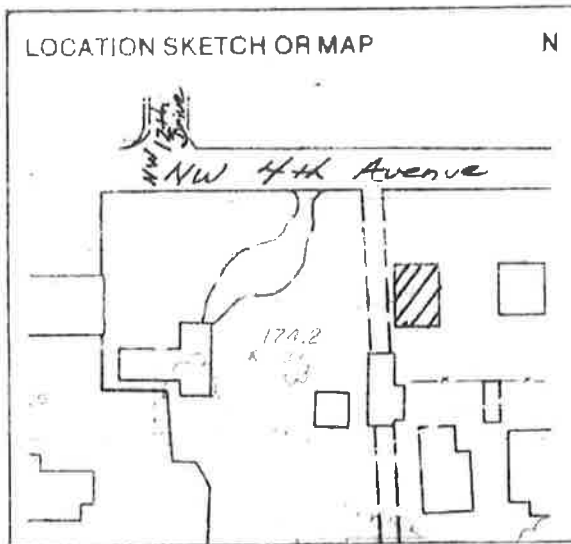

Township	Range	Section
10S	20E	05

812 = =

UTM Coordinates: _____ 890 = =

Zone _____ Easting _____ Northing _____

Photographic Records Numbers 12B20, PBA-64, PBC-61, PBC-77 860 = =

Contact Print





Previous | Next >> Record 1 of 1

FMSFweb

Quick Search
(Enter SKeyID or MS#)

New Search

Back to Results

Print/Save Report

View Scanned
Forms &
Documents

AL1573 - 1227 NW 4TH AVE	Historic Structure
SHPO Evaluation Not Evaluated by SHPO	
Address 1227 NW 4TH AVE	
Year Constructed c1930	
Structure Uses Private Residence (House/Cottage/Cabin)	
Style Masonry Vernacular	
Exterior Fabrics Brick	
Roof Type Gable	
City GAINESVILLE	
Township Range Section 10S 20E 5	
Field Visit Dates	