



tabbles
EXHIBIT
B-1

AERIAL PHOTOGRAPH

 No Scale	<p>Name</p> <p>Causseaux, Hewett & Walpole, Inc., agent for Bishop of Diocese of St Augustine</p>	<p>Petition Request</p> <p>Rezone property from RSF-4: 8 units/acre single-family residential district to MU-1: 8-30 Mixed Use-Low Intensity (8-30 units/acre)</p>	<p>Petition Number</p> <p>PB-14-52 ZON</p>	<p>140369C</p>
---	---	---	---	----------------

City of Gainesville Zoning Districts

- RSF-1 3.5 units/acre Single-Family Residential
- RSF-4 8 units/acre Single-Family Residential
- RMF7 8-21 units/acre Multiple-Family Residential
- OR 20 units/acre Office Residential
- OF General Office
- BA Automotive-Oriented Business
- MU1 8-30 units/acre Mixed Use Low Intensity
- CON Conservation
- PS Public Services and Operations
- CP Corporate Park
- PD Planned Development

Area under petition consideration



Division line between two zoning districts

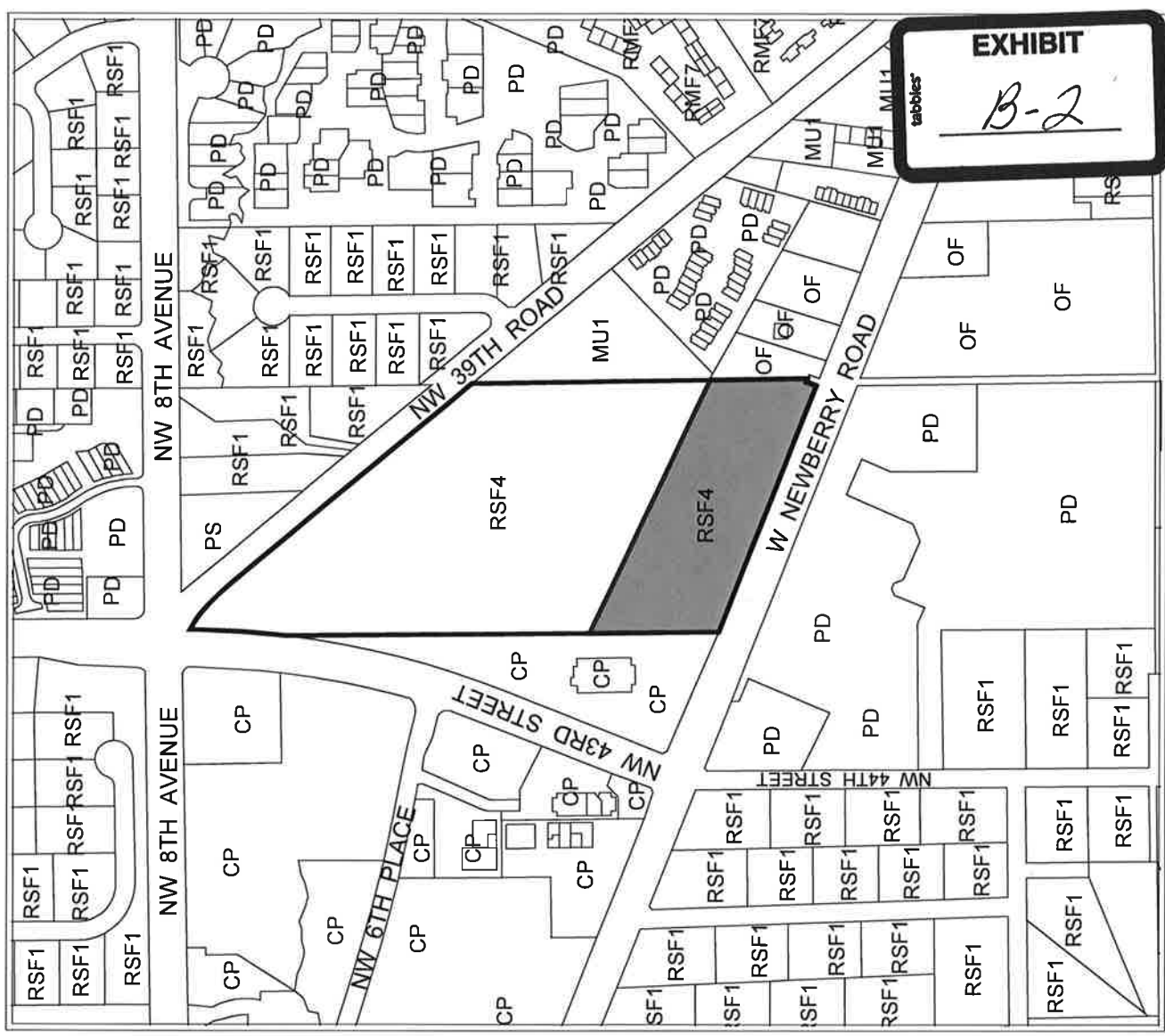

EXISTING ZONING

<p>Petition Number</p> <p>140369C</p>	<p>Petition Request</p> <p>Rezone property from RSF-4: 8 units/acre single-family residential district to MU-1: 8-30 Mixed Use-Low Intensity (8-30 units/acre)</p>	<p>Name</p> <p>Causseaux, Hewett & Walpole, Inc., agent for Bishop of Diocese of St Augustine</p>
--	---	--



No Scale

City of Gainesville Zoning Districts

- RSF-1 3.5 units/acre Single-Family Residential
- RSF-4 8 units/acre Single-Family Residential
- RMF7 8-21 units/acre Multiple-Family Residential
- OR 20 units/acre Office Residential
- OF General Office
- BA Automotive-Oriented Business
- MU1 8-30 units/acre Mixed Use Low Intensity
- CON Conservation
- PS Public Services and Operations
- CP Corporate Park
- PD Planned Development

Area under petition consideration



Division line between two zoning districts

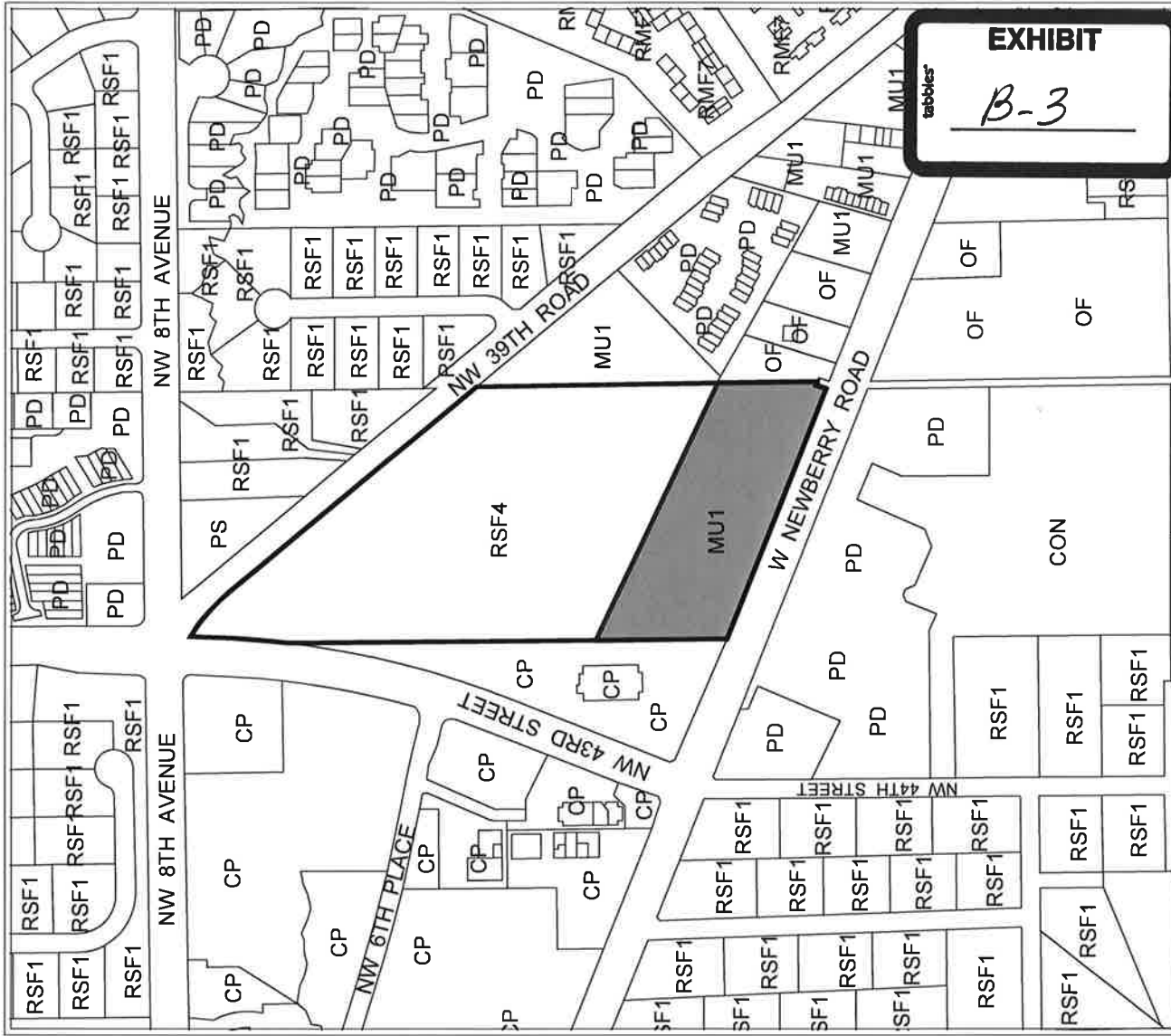

PROPOSED ZONING

 No Scale	Name Causseaux, Hewett & Walpole, Inc., agent for Bishop of Diocese of St Augustine	Petition Request Rezone property from RSF-4: 8 units/acre single-family residential district to MU-1: 8-30 Mixed Use-Low Intensity (8-30 units/acre)	Petition Number 140369C
			PB-14-52 ZON