

**LEGISLATIVE #**

**110398A**

# Sweetwater Branch/Paynes Prairie Sheetflow Restoration Project 60% Plans

*Water/Wastewater Systems  
Gainesville Regional Utilities*

*Gainesville City Commission  
October 20, 2011*

*Recreation, Cultural Affairs and Public Works Committee  
April 9, 2012*



# Project Location

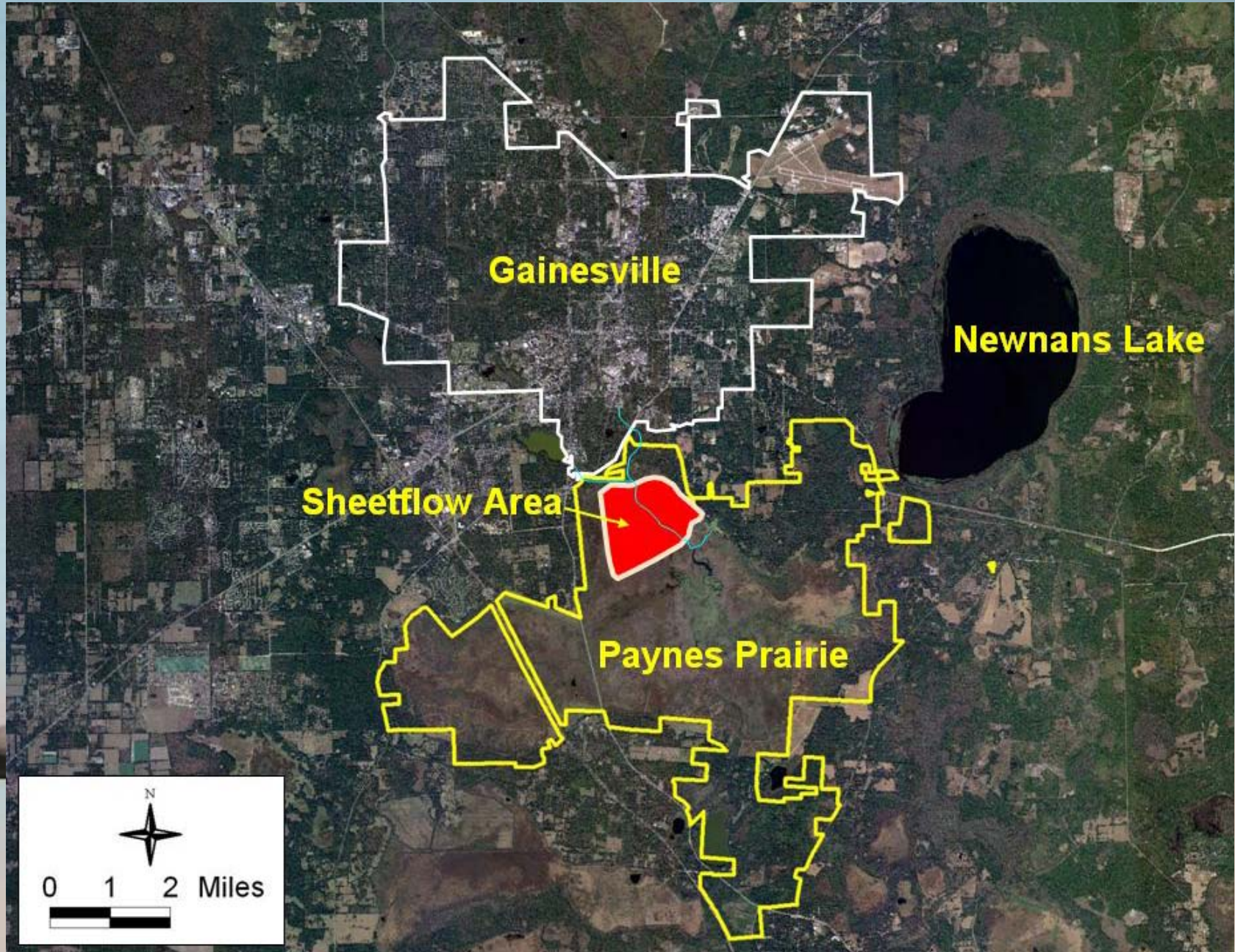

# Description of the Problem



- Sweetwater Branch was channeled directly to Alachua Sink in 1930s
- Sheetflow Lost
- 1,300 acres of wetlands impacted.
- Direct flow path from Gainesville to Alachua Sink
- City of Gainesville must reduce nutrient loads from MSWRF and Stormwater Utility for Total Maximum Daily Loads (TMDL)

# Project Benefits

1. Improve Water Quality in Alachua Sink
  - Meet TMDL
2. Restore 1,300 ac natural wetlands
  - Rehydrate
  - Remove Trash & Sediment
3. Protect Floridan Aquifer
4. Help Restore flow balance to Paynes Prairie
5. Wildlife habitat & public park
  - Additional conservation land added to park

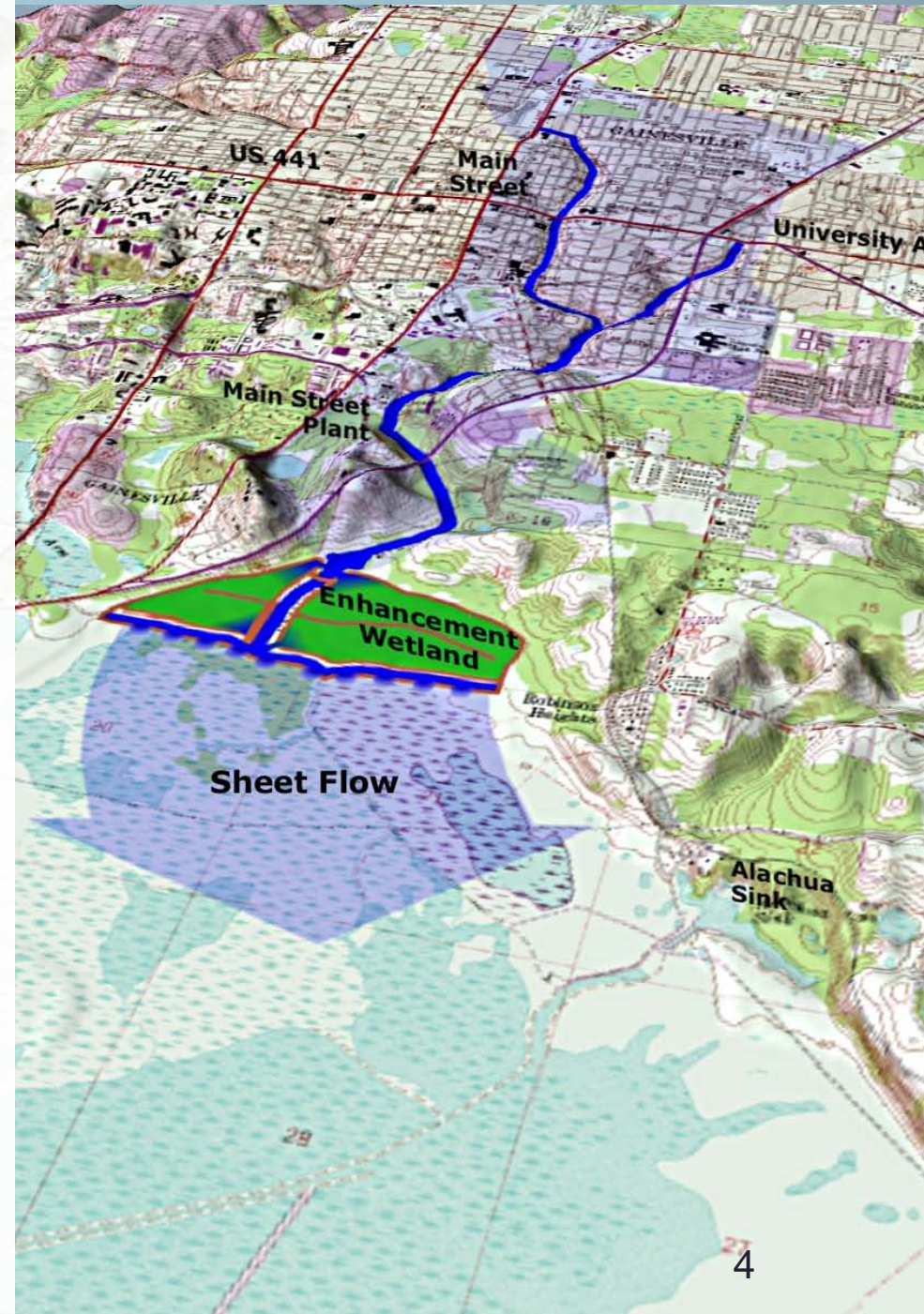

# Conceptual Site Plan Paynes Prairie Sheetflow Restoration

-  Regional Trail Connector
-  Berm Trails
-  Boardwalk
-  Nature Trails
-  Viewpoints
-  Shallow Water
-  Deep Water

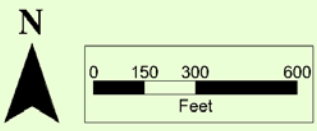
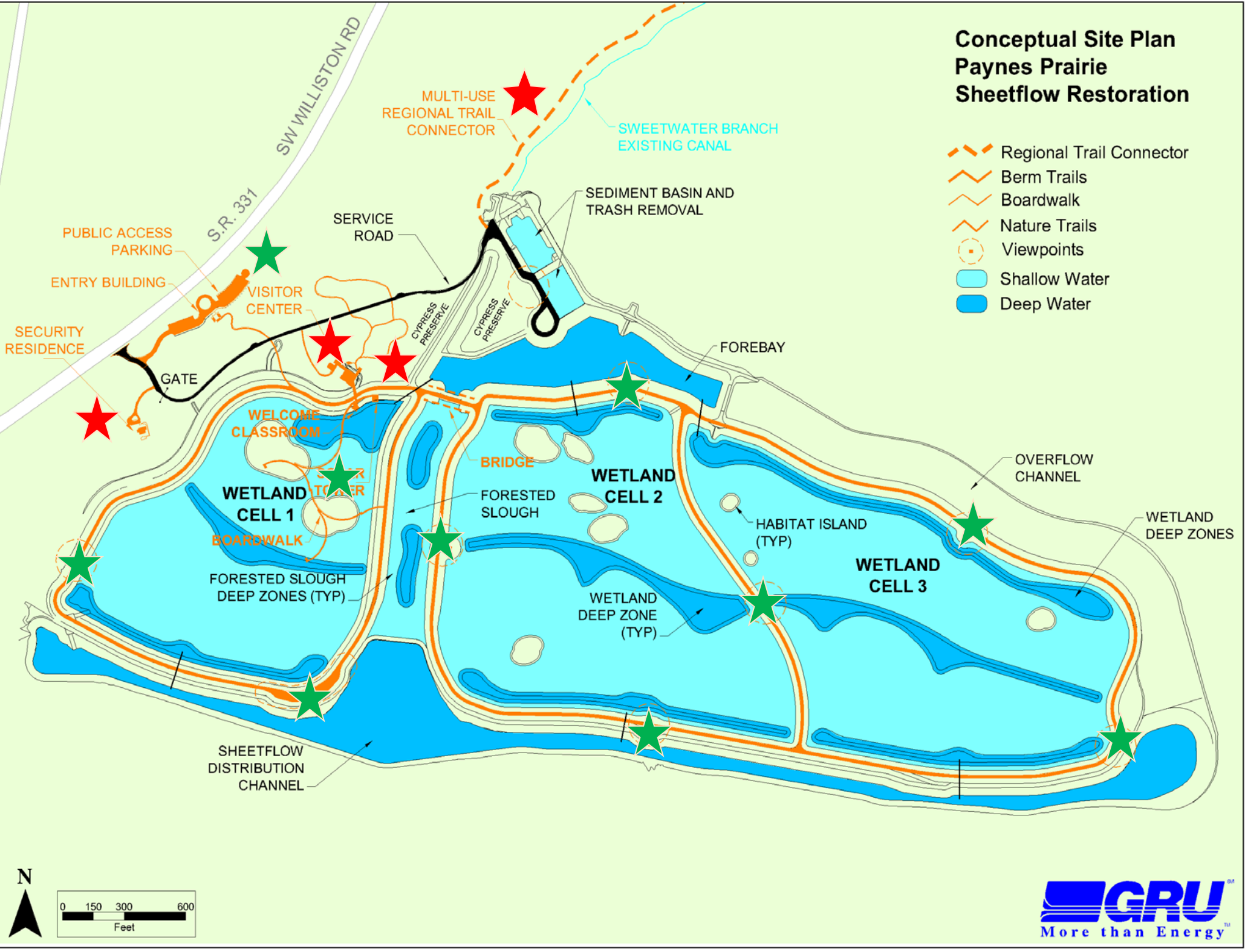



SEARCH Type Search Here GO

HOME I WANT TO... GOVERNMENT RESIDENT VISITOR BUSINESS

Tuesday, November 23, 2010 :: GOVERNMENT » City Departments (N-Z) » Public Works » Paynes Prairie Sheetflow project ::

Public Works

- Public Works Management
- Project Management
- Depot Park Project
- Archer Rd/SW 16th Ave Project
- Paynes Prairie Sheetflow Project
- Permits

Operations

- Three Year Pavement Management Program
- Public Works Operations
- Right of Way Maintenance
- Street Sweeping
- Mosquito Control
- Sidewalk Maintenance

## Sweetwater Branch / Paynes Prairie Sheetflow Restoration Project

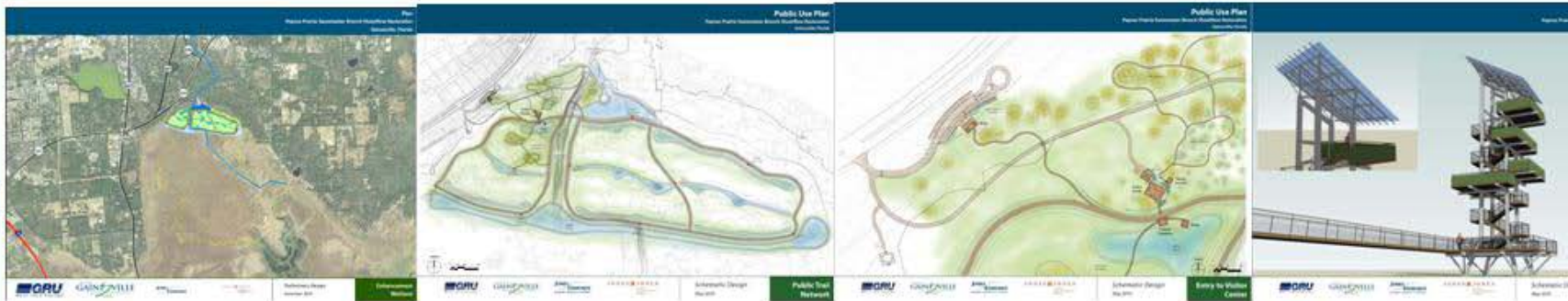

### What's the Project?

A 125-acre constructed enhancement wetland to polish the base flow from Sweetwater Branch before it is discharged to a mile long sheetflow distribution project, the EDEP will fill two miles of agricultural drainage canals in Paynes Prairie Preserve State Park. This will restore the historic Sheetflow will be resto

[www.cityofgainesville.org/pps](http://www.cityofgainesville.org/pps)

# Public Use Entry Area

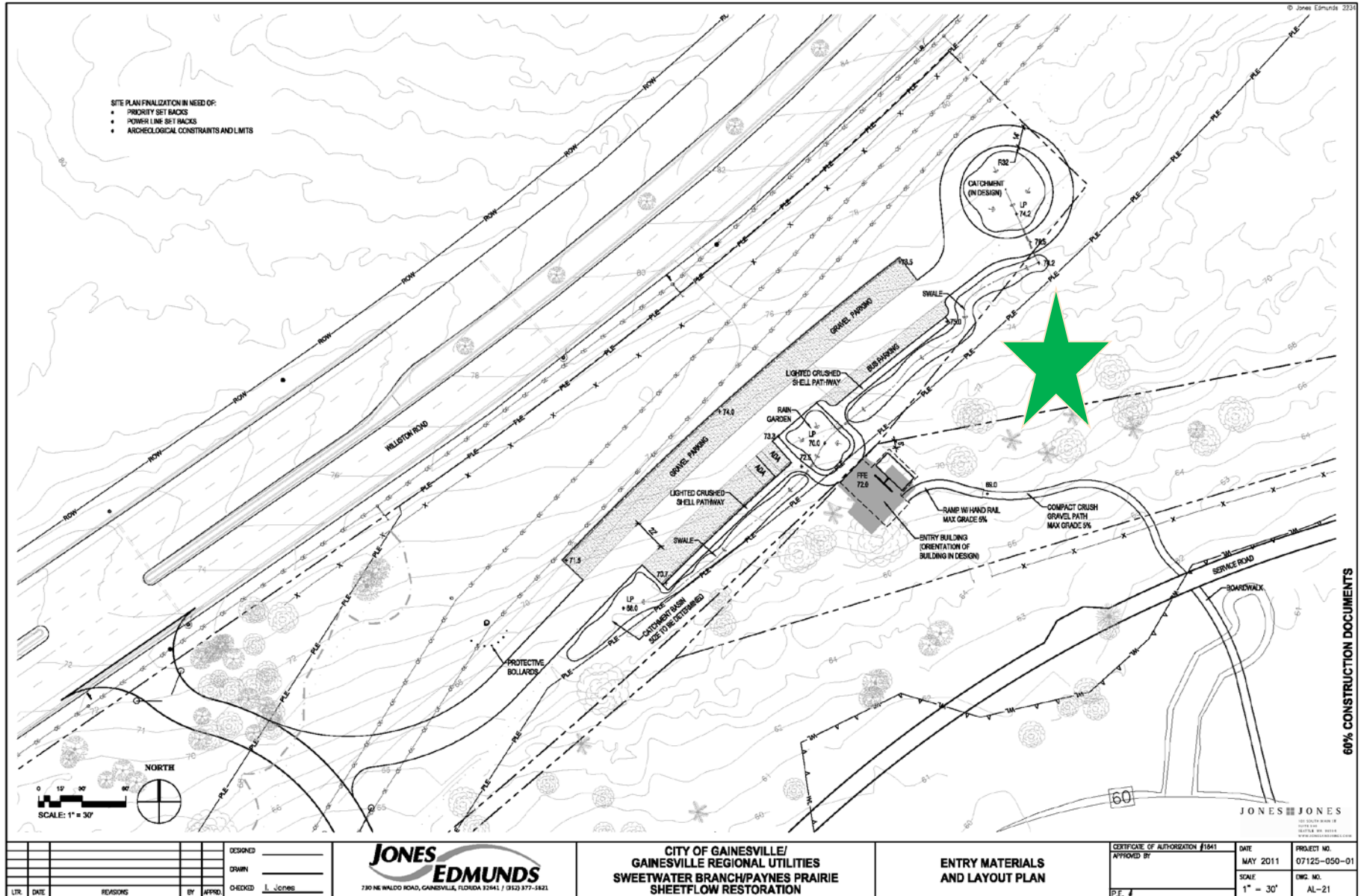



# Visitor Center Complex



60% CONSTRUCTION DOCUMENTS

DESIGNED	
DRAWN	
CHECKED	J. JONES
DATE	
REVISIONS	
LIT.	



CITY OF GAINESVILLE/  
GAINESVILLE REGIONAL UTILITIES  
SWEETWATER BRANCH/PAYNES PRAIRIE  
SHEETFLOW RESTORATION

**VISITOR CENTER COMPLEX  
MATERIALS AND LAYOUT PLAN**

CERTIFICATE OF AUTHORIZATION #1841	DATE	PROJECT NO.
APPROVED BY	MAY 2011	07125-050-01
	SCALE	DWG. NO.
	1" = 20'	AL-51
P.E. #		

JONES JONES

# Visitor Center Complex

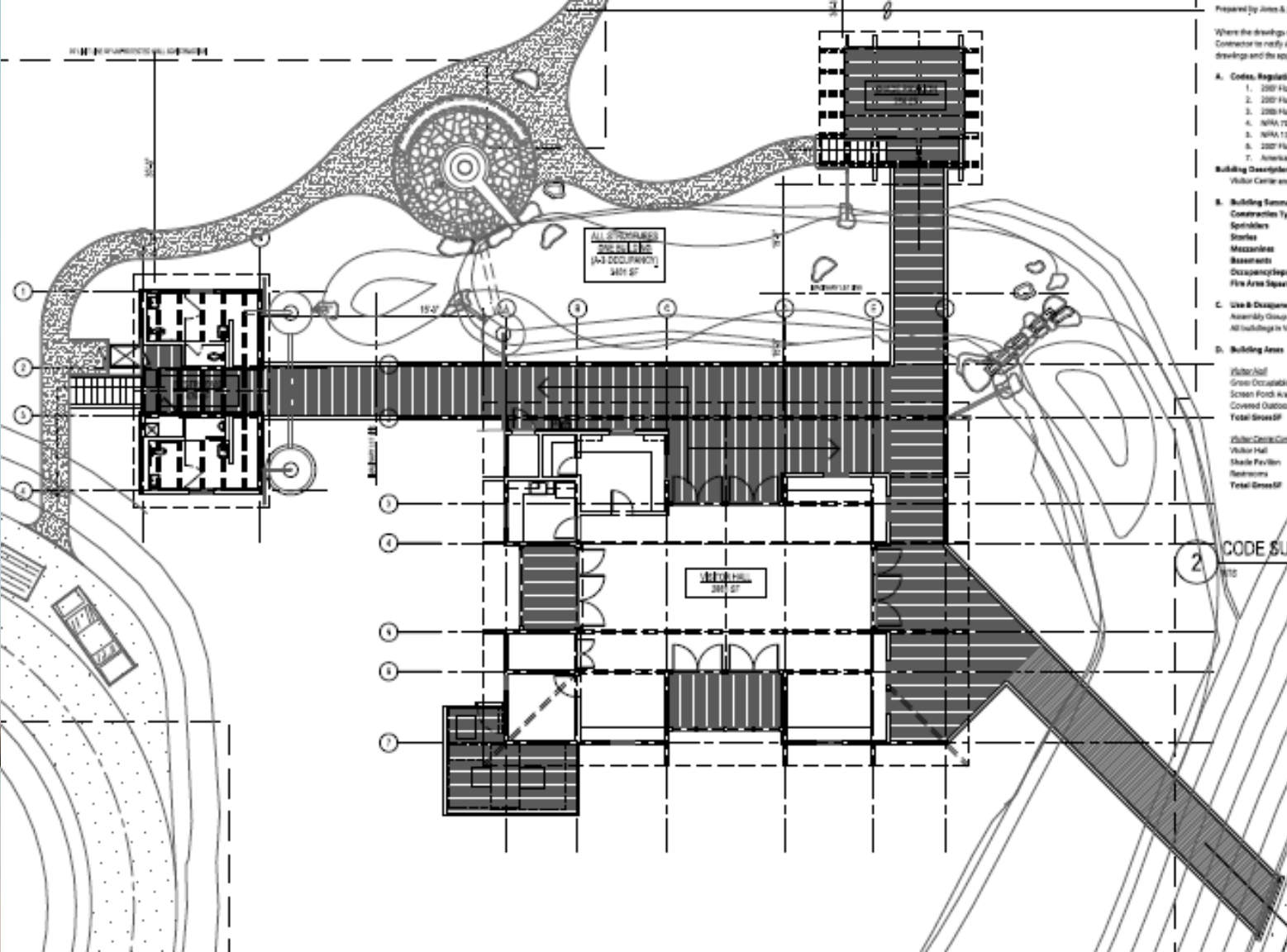

# Visitor Center Complex

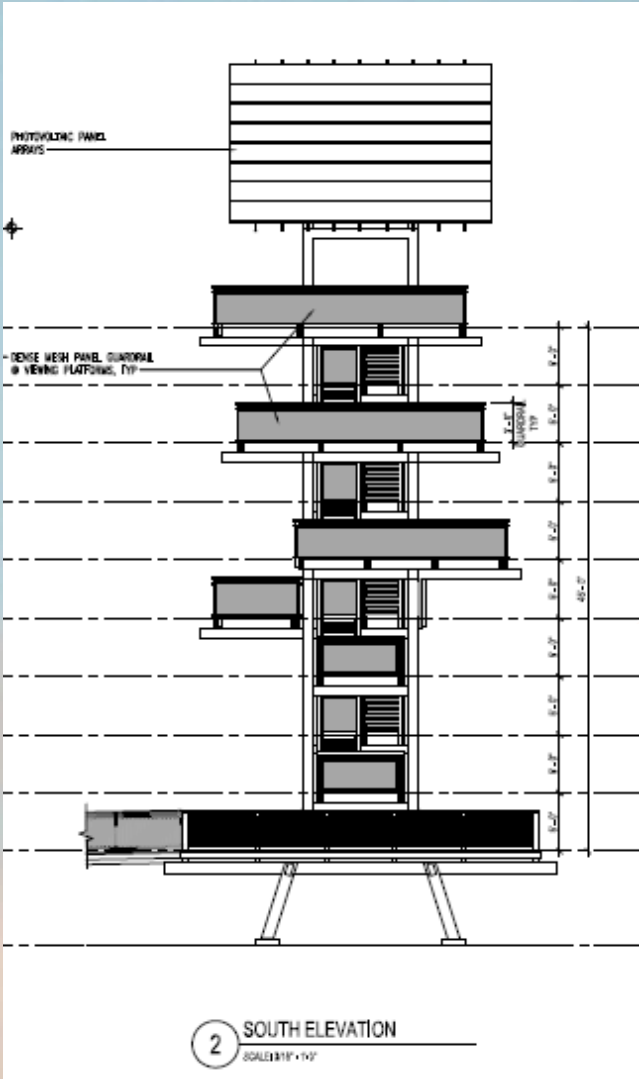

45 ft.



# Visitor Hall, Welcome Classroom and Boardwalk

© Jones Edmunds 2234

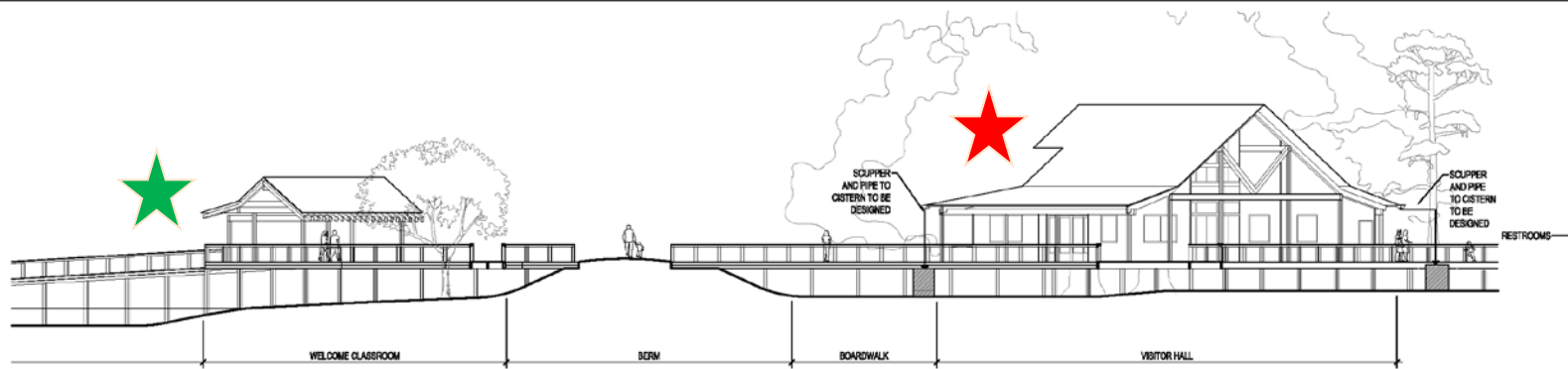

1 VISITOR CENTER COMPLEX - ELEVATION  
SCALE: 1"=10'

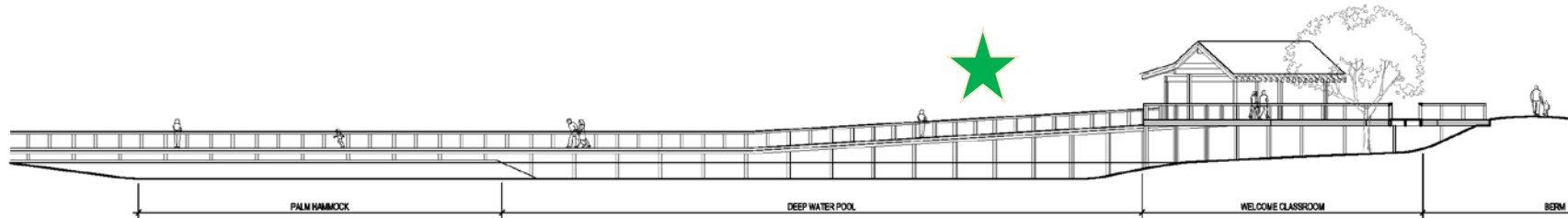
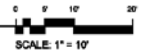

2 VISITOR CENTER COMPLEX - ELEVATION  
SCALE: 1"=10'

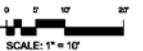

60% CONSTRUCTION DOCUMENTS

JONES JONES  
301 SOUTH GARDEN ST.  
GAINESVILLE, FL 32608  
TEL: 352.336.1100  
WWW.JONESJONES.COM

DESIGNED	_____			
DRAWN	_____			
CHECKED	J. Jones			
LTR.	DATE	REVISIONS	BY	APPD.



CITY OF GAINESVILLE/  
GAINESVILLE REGIONAL UTILITIES  
SWEETWATER BRANCH/PAYNES PRAIRIE  
SHEETFLOW RESTORATION

VISITOR CENTER  
ELEVATIONS

CERTIFICATE OF AUTHORIZATION #1841	DATE	PROJECT NO.
APPROVED BY _____	MAY 2011	07125-050-01
P.E. # _____	SCALE	DWG. NO.
	AS NOTED	AL-64

# Overlook View Points

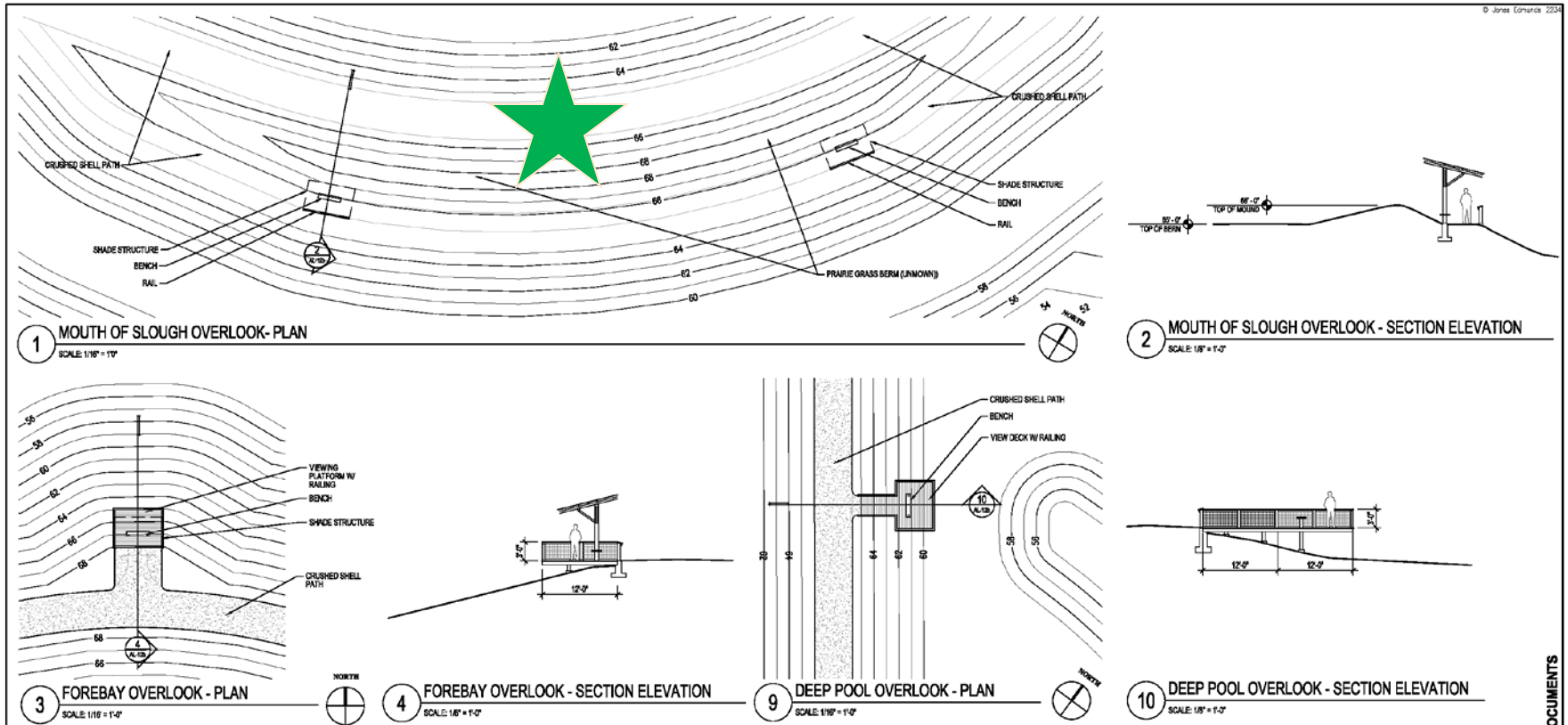

60% CONSTRUCTION DOCUMENTS

JONES JONES  
100 EAST PALM BLVD  
SUITE 200  
GAINESVILLE, FL 32601  
WWW.JONESJONES.COM

NO.	DATE	REVISIONS	BY	APPD.	CHECKED

**JONES EDMUNDS**  
730 NE WALDO ROAD, GAINESVILLE, FLORIDA 32601 | (352) 377-5362

CITY OF GAINESVILLE/  
GAINESVILLE REGIONAL UTILITIES  
SWEETWATER BRANCH/PAYNES PRAIRIE  
SHEETFLOW RESTORATION

**SHADE STRUCTURES &  
VIEWING PLATFORMS**

CERTIFICATE OF AUTHORIZATION #1041	DATE MAY 2011	PROJECT NO. 07125-050-01
APPROVED BY	SCALE AS NOTED	DWG. NO. AL-13b
P.E. #		

# Project Issues

- Cultural Resource Mitigation
- Soil Contaminants
- Numeric Nutrient Criteria
- Public Use Management

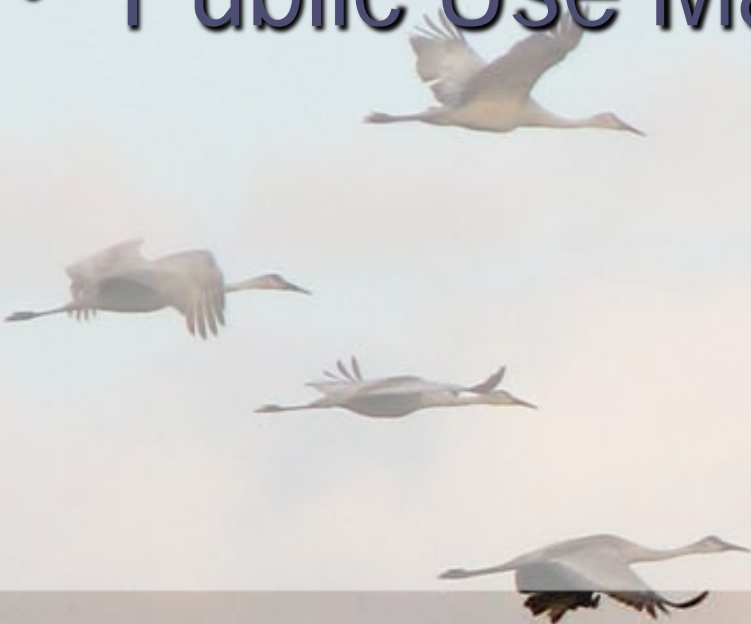

# Public Use Management

© Jones Edmunds 2011

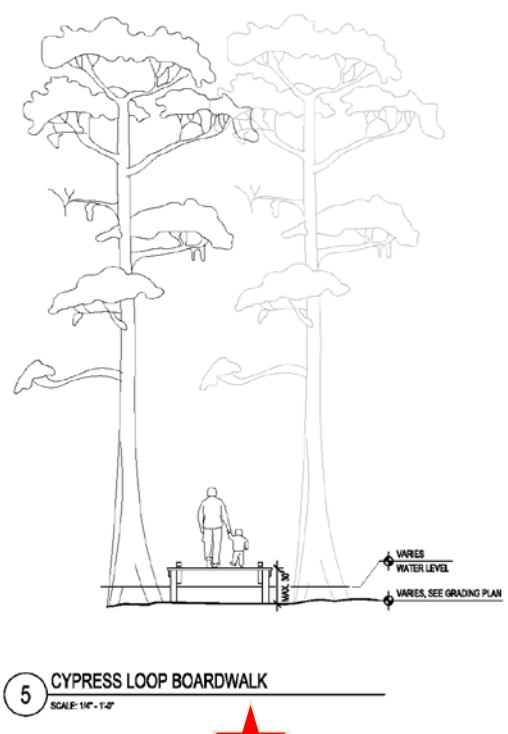
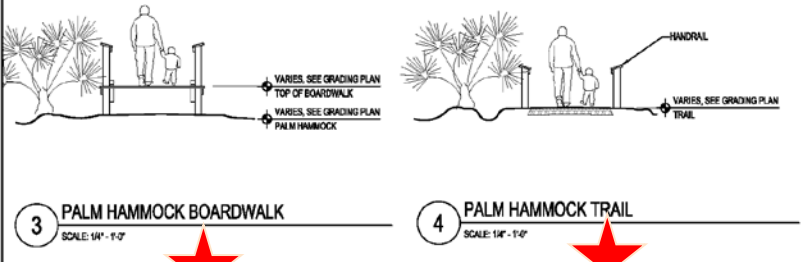
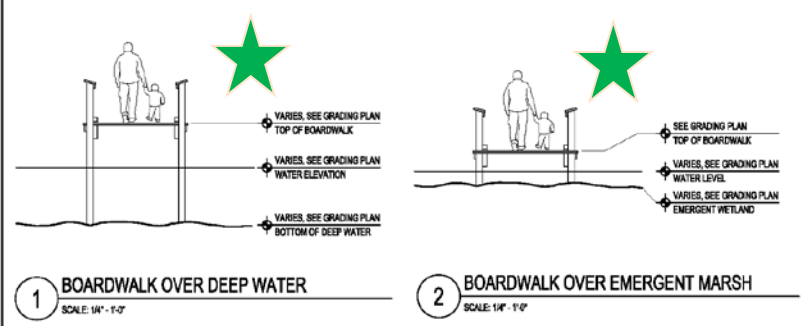

60% CONSTRUCTION DOCUMENTS

JONES JONES

DESIGNED	
DRAWN	
CHECKED	J. Jones
DATE	
REVISIONS	
BY	
APP'D	

**JONES EDMUNDS**  
730 NE WALDO ROAD, GAINESVILLE, FLORIDA 32641 | (352) 377-5821

CITY OF GAINESVILLE/  
GAINESVILLE REGIONAL UTILITIES  
SWEETWATER BRANCH/PAYNES PRAIRIE  
SHEETFLOW RESTORATION

CORE NETWORK  
SECTIONS

CERTIFICATE OF AUTHORIZATION #1841	DATE	PROJECT NO.
APPROVED BY	MAY 2011	07125-050-01
	SCALE	DWG NO.
	AS NOTED	AL-14
P.E. #		

# Trails



*Boardwalk at Paynes Prairie Preserve State Park*



*Boardwalk over wetlands*





# Kanapaha Botanical Gardens

[Home](#) [About us](#) [Tour gardens](#) [Events](#) [Rentals](#) [Links](#) [Newsletter](#) [Spring Garden Festival](#) [Wish list](#)

We are in the process of updating this page. Some of the specialty gardens can be clicked on for pictures and more information and eventually they all will be accessible. Thanks for your patience.



# Kanapaha Botanical Gardens

[Home](#) [About us](#) [Tour gardens](#) [Events](#) [Rentals](#) [Links](#) [Newsletter](#) [Spring Garden Festival](#) [Wish list](#)

## Gainesville Wedding Venue / Gainesville Indoor & Outdoor Rental



We have hosted hundreds of wedding ceremonies, wedding receptions, meetings, retreats and other social functions and are pleased to have the opportunity to serve you as well. Kanapaha Gardens on average hosts a wedding a week.

Kanapaha's visitors center, Summer House, and our 62-acre garden facility has both indoor and outdoor spaces. The rental fee includes chairs and tables (inside) and chairs (outside) arranged to your specifications. Also included in your rental fee is access to the gardens for any rehearsals. The rental fee also waives the regular cost of admission for your guests.

Summer House corridors featured above

\*\*\*\*\*





Reception Hall featured above



**Outdoor spaces:**

Kanapaha has four designated areas for rental outside for a maximum of 150 guests: studio gazebo, wedding oak, bamboo garden and Balenoff lawn. There are also a few other areas available for smaller rentals.



Studio Gazebo featured above





Wedding Oak featured above



# Kanapaha Botanical Gardens

[Home](#) [About us](#) [Tour gardens](#) [Events](#) [Rentals](#) [Links](#) [Newsletter](#) [Spring Garden Festival](#) [Wish list](#)

## Hours of Operation:

- Mon., Tues., Wed., Fri. - 9am til 5pm
- Sat., Sun. - 9am til the earlier of 7:00pm or dusk, whichever comes first\*
- Thursday: Closed
- **\*note: hours of operation for special events differ from hours listed above (please see [events](#))**
- we are closed for Christmas

## Admission Price:

- Adults: \$6
- Children (ages 6-13): \$3
- Children under 6: Free (when accompanied by parent)
- **note: admission prices vary for days with special events (please see [events](#))**

## Educational groups: (minimum 10)

- **Must** pay with a single payment for all members to qualify and **must** all come in at the same time.
- Adult: \$4.50
- Children (ages 1-13): \$2.25
- **Not available for special events (please see [events](#))**

## Membership Information:

- Student - \$25 (Available to students with identification)
- Individual - \$35
- Family - \$45 (Provides admission for a couple and minor children. Extended family members will be admitted at \$1.00 off regular price.)
- Contributing/Organizational - \$125 and above. Includes up to six clients.



*Don't forget to visit the gift shop!*

## KANAPAHA BOTANICAL GARDENS RENTAL RATE SCHEDULE

TYPE AND TIME OF RENTAL	NON-PEAK RATE*	TAX	NON-REFUNDABLE DEPOSIT (APPLIED TOWARDS RENTAL RATE)***	REFUNDABLE DAMAGE/OVER-TIME DEPOSIT
<b>OUTDOOR ONLY EVENTS</b>	INCLUDES THE USE ONE OUTDOOR LOCATION OF YOUR CHOOSING WITH CHAIRS.			
MONDAY – FRIDAY 9 AM – 5 PM	\$100/HOUR 4 HOUR MINIMUM	\$6.25/ HOUR	\$250.00	\$100.00
SATURDAY – SUNDAY 9 AM – 1 PM OR 2 PM – 6 PM	\$600.00	\$37.50	\$500.00	\$100.00
<b>INDOOR ONLY EVENTS **</b>	INCLUDES THE USE OF ONE INDOOR ROOM OF YOUR CHOOSING WITH TABLES AND CHAIRS.			
MONDAY – FRIDAY 9 AM – 5 PM	\$100/HOUR 4 HOUR MINIMUM	\$6.25/ HOUR	\$250.00	\$200.00
MONDAY – FRIDAY 5 PM – 9 PM OR 7 PM – 11 PM	\$680.00	\$42.50	\$500.00	\$400.00
SATURDAY – SUNDAY 9 AM – 1 PM OR 2 PM – 6 PM	\$700.00	\$43.75	\$500.00	\$200.00
SATURDAY – SUNDAY 7 PM – 11 PM	\$780.00	\$48.75	\$500.00	\$400.00
<b>INDOOR &amp; OUTDOOR EVENTS **</b>	INCLUDES ONE OUTDOOR LOCATION WITH CHAIRS AND THE INDOOR ROOM OF YOUR CHOOSING WITH TABLES AND CHAIRS.			
SATURDAY – SUNDAY 9 AM – 1 PM OR 2 PM – 6 PM	\$800.00	\$50.00	\$500.00	\$400.00
<b>KITCHEN RENTAL ADD-ON</b>	\$125.00	\$7.81	INCLUDES REFRIGERATOR, MICROWAVE, FREEZER, ICE MAKER, SINKS AND COUNTERS.	
<b>WEEKEND SPECIALS**</b>	INCLUDES ONE OUTDOOR LOCATION WITH CHAIRS AND THE INDOOR ROOM OF YOUR CHOOSING WITH TABLES AND CHAIRS. USE OF THE KITCHEN IS INCLUDED AT NO ADDITIONAL CHARGE.			
SATURDAY – SUNDAY 9 AM – 6 PM	\$1,200.00	\$75.00	\$600.00	\$400.00
SATURDAY – SUNDAY 2 PM – 11 PM	\$1,300.00	\$81.25	\$600.00	\$400.00
SATURDAY – SUNDAY 9 AM – 11 PM	\$1,600.00	\$100.00	\$700.00	\$400.00

*NOTE: PRICES ARE SUBJECT TO CHANGE AT ANY TIME*

\* MARCH IS THE ONLY MONTH WITH PEAK RATE PRICES. WEEKEND RENTAL RATES WILL BE INCREASED BY \$200 (\$212.50 WITH TAX).

\*\* RATES FOR INDOOR RENTALS INCLUDE THE USE OF 1 ROOM OF YOUR CHOOSING. A SECOND ROOM MAY BE ADDED FOR A FLAT RATE OF \$350 (\$371.88 WITH TAX).

# Paynes Prairie Preserve State Park

[Home](#) [About the Park](#) [Activities](#) [Events](#) [Ranger Programs](#) [Photo Gallery](#) [History](#) [Additional Info](#)

## Park Activities

-  Bicycling
-  Campfire Circles
-  Camping, Equestrian
-  Camping, Full Facility
-  Camping, Primitive
-  Canoeing & Kayaking
-  Fishing
-  Hiking/Nature Trail
-  Horse/Equestrian Trail
-  Pets
-  Picnicking
-  Visitor Center
-  Wildlife Viewing



### Park Alerts for Paynes Prairie Preserve State Park

**Due to current drought conditions, vegetation may limit wildlife viewing opportunities along the LaChua Trail. This is part of the natural fluctuation of water levels. Abundant water and alligator sightings will return when Mother Nature provides a wetter rain cycle.**

### Welcome to Paynes Prairie Preserve State Park

Paynes Prairie is biologically, geologically and historically unique. This park became Florida's first state preserve in 1971 and is now designated as a National Natural Landmark. Noted artist and naturalist William Bartram called it the great Alachua Savannah when he wrote about his visit to the prairie in 1774.

Over 20 distinct biological communities provide a rich array of habitats for wildlife and livestock, including alligators, bison, horses and over 270 species of birds. Exhibits and an audio-visual program at the visitor center explain the area's natural and cultural history. A 50-foot-high observation tower near the visitor center provides a panoramic view of the preserve.

## Park Information

100 Savannah Boulevard  
Micanopy, Florida 32667  
(352) 466-3397

[Hours](#)

[Fees](#)

[Camping/Cabin  
Reservations](#)





# Paynes Prairie Fees

## Fee Schedule

[Close](#)

### Admission Fee:

\$6.00 per vehicle. Limit 2-8 people per vehicle.

\$4.00 Single Occupant Vehicle.

\$2.00 Pedestrians, bicyclists, extra passengers, passengers in vehicle with holder of Annual Individual Entrance Pass.

### Picnic Pavilion

\$30 plus tax - Picnic pavilion seats 65 people.

### Camping Fee:

\$18.00 per night, plus tax. Includes water and electricity. Florida residents who are 65 years of age or older or who hold a social security disability award certificate or a 100 percent disability award certificate from the Federal Government are permitted to receive a 50 percent discount on current base campsite fees. [Proof of eligibility](#)

### Group Camping:

\$4.00 per person, plus tax (minimum of \$20.00 per night).





# Paynes Prairie Fees





## Marjorie Kinnan Rawlings Historic State Park

### Park Activities

-  Gardens
-  Hiking/Nature Trail
-  Interpretive Exhibit
-  Pets
-  Tours



### Welcome to Marjorie Kinnan Rawlings Historic State Park

Visitors to this Florida homestead can walk back in time to 1930s farm life where Marjorie Kinnan Rawlings lived and worked in the tiny community of Cross Creek. Her cracker style home and farm, where she lived for 25 years and wrote her Pulitzer prize-winning novel *The Yearling*, has been restored and is preserved as it was when she lived here.

### Park Information

18700 S. County Road 325  
Cross Creek, Florida 32640  
(352) 466-3672

[Hours](#)

[Fees](#)



# Rawlings's Fees

## Fee Schedule

[Close](#)

### Admission Fee:

The park admission fee is \$3.00 per group in one vehicle. Please use the honor box to pay the fee; correct change is needed.

### Guided tours of the Rawlings's home:

\$3.00 per adult; \$2.00 for children, ages 6 to 12; children aged 5 and under are free.





## Dudley Farm Historic State Park

### Park Activities

-  [Hiking/Nature Trail](#)
-  [Picnicking](#)
-  [Tours](#)
-  [Visitor Center](#)
-  [Wildlife Viewing](#)



### Park Information

18730 W. Newberry Road  
Newberry, Florida 32669  
(352) 472-1142

[Hours](#)

[Fees](#)



### Welcome to Dudley Farm Historic State Park

Listed on the National Register of Historic Places, this park demonstrates the evolution of Florida farming from the 1850s to the mid-1940s-through three generations of the Dudley family. An authentic working farm, the homestead consists of 18 buildings, including the family farmhouse with original furnishings, an 1880s kitchen outbuilding, a general store and post office, and a functional cane syrup complex. Park staff in period clothing perform daily chores, raise crops and tend to livestock. The farm features seasonal cane grindings, corn shuckings and heritage varieties of livestock and plants. Deer, wild turkeys, gopher tortoises and bluebirds are still seen in the fields. The park has a visitor center, picnic area and nature trail.



# Dudley Fees

## Fee Schedule

[Close](#)

### Admission Fee:

\$5.00 per vehicle. Please use the honor box to pay fees. Correct change is required.  
Limit 8 people per vehicle.





\$2.00 Pedestrians, bicyclists, extra passengers, passengers in vehicle with holder of  
Annual Individual Entrance Pass.



# San Felasco Hammock Preserve State Park

[Home](#) [About the Park](#) [Activities](#) [Events](#) [Ranger Programs](#) [Photo Gallery](#) [History](#) [Additional Info](#)

## Park Activities

-  Bicycling
-  Hiking/Nature Trail
-  Horse/Equestrian Trail
-  Pets



## Park Information

See Hours for Trailhead addresses.

Alachua & Gainesville, Florida

(386) 462-7905

[Hours](#)

[Fees](#)

## Welcome to San Felasco Hammock Preserve State Park

This preserve has one of the few remaining mature forests in Florida. The limestone outcrops and extreme changes in elevation provide ideal conditions for many species of hardwood trees, including several champion trees. Bobcats, white-tailed deer, gray foxes, turkeys, and many species of songbirds make their homes in the 18 natural communities found in the preserve. The park offers outdoor adventure to hikers, off-road bicyclists, horseback riders, and nature lovers. To ensure solitude and quiet for a true wilderness experience, the southern two-thirds of the park is designated for hiking only. The northern third of the park has horse trails, off-road cycling, and hiking. Equestrians must carry proof of a negative Coggins test. The hiking trailhead is located four miles northwest of Gainesville on State Road 232. The horseback and bicycle trailheads are located off U.S. 441 just south of Alachua.



# San Felasco Fees

## Fee Schedule

[Close](#)

### Admission Fee:

\$4.00 per vehicle. Please use the honor box to pay fees. Correct change is required.  
Limit 8 people per vehicle.

\$2.00 Pedestrians, bicyclists, extra passengers, passengers in vehicle with holder of Annual Individual Entrance Pass.











## Devil's Millhopper Geological State Park

### Park Activities

-  Hiking/Nature Trail
-  Pets
-  Picnicking
-  Tours
-  Visitor Center
-  Wildlife Viewing



### Park Information

4732 Millhopper Road  
Gainesville, Florida 32653  
(352) 955-2008

[Hours](#)

[Fees](#)



### Welcome to Devil's Millhopper Geological State Park

In the midst of north Florida's sandy terrain and pine forests, a bowl-shaped cavity 120 feet deep leads down to a miniature rain forest. Small streams trickle down the steep slopes of the limestone sinkhole, disappearing through crevices in the ground. Lush vegetation thrives in the shade of the walls even in dry summers. A significant geological formation, Devil's Millhopper is a National Natural Landmark that has been visited by the curious since the early 1880s. Researchers have learned a great deal about Florida's natural history by studying fossil shark teeth, marine shells and the fossilized remains of extinct land animals found in the sink. Visitors can enjoy picnicking and learn more about this sinkhole through interpretive displays.



# Devils Millhopper Fees

## Fee Schedule

[Close](#)

### Admission Fee:

\$4.00 per vehicle. Please use the honor box to pay fees. Correct change is required.  
Limit 8 people per vehicle.

\$2.00 Pedestrians, bicyclists, extra passengers, passengers in vehicle with holder of Annual Individual Entrance Pass.



Questions?

