



**Florida Department of Transportation**

**CHARLIE CRIST**  
GOVERNOR

605 Suwannee Street  
Tallahassee, FL 32399-0450

**STEPHANIE C. KOPELOUSOS**  
SECRETARY

April 29, 2010

E.J. Bolduc III, ASLA  
Buford Davis + Associates  
2406 NW 43<sup>rd</sup> Street  
Gainesville, FL 32606

**Subject:** University United Methodist Church  
Permit 09-K-291-0003, on SR-26, at mile post 19.429, Alachua County  
Approved General Use Permit – Cover Letter

Mr. Bolduc:

The above referenced permit and plans signed & sealed by E.J. Bolduc on 03/31/2010 and Monique M. Heathcock on 03/31/2010 are approved as noted.

Attached is your General Use Permit. Be sure to note the General Provisions and Special Provisions listed in the Permit and that your permit will expire one year from the date of issuance. In addition to the notes specific to your project, we have attached a document labeled "Permit Terms and Conditions" that stipulates additional requirements for your project. As stated in the permit, the brick pavers shall not be constructed until an appropriate maintenance agreement between FDOT and the City of Gainesville has been executed.

|       | Conceptual Review | Completeness Review | Technical Review | Pre-Construction   | Construction | Final Acceptance |
|-------|-------------------|---------------------|------------------|--------------------|--------------|------------------|
| Step  |                   |                     |                  |                    |              |                  |
| Phase | Review Phase      |                     |                  | Construction Phase |              |                  |

The next step in the process is to call the Permits Manager and activate your permit. You must notify the Permits Manager prior to any construction on state right-of-way, and you must complete all work before the permit expires.

A pre-construction meeting must be held at least 72 hours prior to beginning construction on state right-of-way. When you call to activate your permit, be prepared to schedule this meeting. After this meeting is held and all outstanding issues are resolved, construction may begin.

If there are any changes during the construction phase of your project that affect the state right-of-way, you must contact the Permits Manager for approval. Changes made to your project without approval may void your permit and require you to resubmit your application.

Notify the Permits Manager when your project is close to completion. A final inspection must be performed within 10 days after construction is finished.

If you have questions or concerns about your project, please feel free to call me at 352-381-4308 or email to [adam.doyle@dot.state.fl.us](mailto:adam.doyle@dot.state.fl.us).

Sincerely,

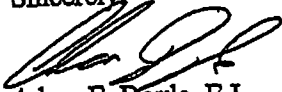

Adam E. Doyle, E.I.  
Permits Coordinator  
5301 NE 39th Ave.  
Gainesville, FL 32609

Enclosure: General Use Permit  
Permit Terms and Conditions  
Approved Plan Set, signed and sealed 03/31/2010

cc: James Perkins; University United Methodist Church (email only)  
Nathan Lee, P.E.; District Permits Engineer

STATE OF FLORIDA DEPARTMENT OF TRANSPORTATION  
GENERAL USE PERMIT

Date: 04/29/10 Permit No.: 09-K-291-0003

Name of Applicant or Authorized Agent: James Perkins, Treasurer

Entity (if applicable): University United Methodist Church

(If entity, furnish contact information for responsible representative)

Address: 1320 W. University Avenue (P.O. Box 13434) Zip Code: 32604-1434

City/State: Gainesville, Florida Telephone No.: 352-372-8183

Email Address: uumc@aol.com

**Activity / Project Site**

County: Alachua State Road: 26 Section: 26070 Intersection with NW 14th Street

From Mile Post: 19.429 to Mile Post: 19.429

Construction Proposed or Underway: Yes  No  FM Project No.: 207665-2-52-01

Name of Municipality if Work is within Limits: City of Gainesville

Description of Work Activity: Removal of existing sidewalk and replacement with pavers. Finished site to conform with City of Gainesville CRA Standards. See plans for details.

**General Provisions**

1. Attach any pertinent plans or drawings.
2. Attach notification letters sent to any Utilities both aerial and underground that will be potentially impacted.
3. The designated FDOT Engineer shall be notified 48 hours prior to beginning of work. Contact Robbie Finns at (352) 381-4314.
4. All work, materials and equipment shall be subject to inspection and approval by FDOT. Applicants certification of work at completion is required.
5. The permittee shall be responsible to place and display safety devices and proper maintenance of traffic in accordance with the latest version of the Department's Design Standards, Index series 600, or an alternative plan signed and sealed by a professional Engineer and attached with the permit.
6. All FDOT property shall be restored to its original condition. Any damage to FDOT property as a result of this work shall be repaired and restored in a manner acceptable to the FDOT at the sole expense of the permittee.





EXHIBIT 1 pg 3 of 8

|                           |
|---------------------------|
| <b>Special Provisions</b> |
| See attached "Exhibit A". |
|                           |
|                           |
|                           |

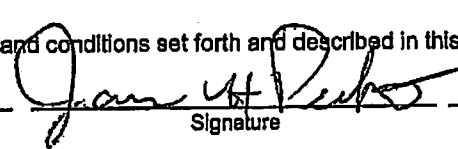
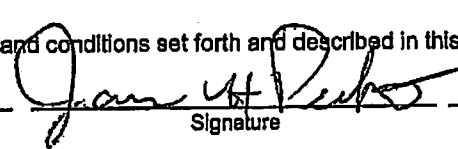
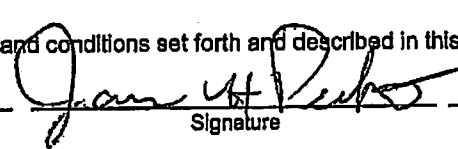
|  |
|--|
| <b>Conditions</b>  |
| <p>1. In the event the permittee fails to meet any of the requirements of this permit by the FDOT, the permitted activity must cease until brought into compliance. If compliance can not be met, then the permit will be rendered void and said work shall be removed from the right of way at no cost to the FDOT.</p> <p>2. Work shall commence within <u>365</u> days of permit approval.<br/>Work shall be completed by <del>04/29/11</del> <u>04/29/11</u><br/>(Date)</p> <p>3. The rights and privileges herein set out are granted only to the extent of the State's right, title and interest in the land to be entered upon and used by the permittee, and the permittee will, at all times, and to the extent permitted by law, assume all risk of and indemnify, defend and save harmless the State of Florida and the FDOT from and against any and all loss, damage, cost or expense arising in any manner on account of the exercise or attempted exercises by said permittee of the aforesaid rights and privileges.</p> |

|  |  |  |            |                                 |           |      |
|--|--|--|------------|---------------------------------|-----------|------|
| <b>Applicant</b>   |  |  |            |                                 |           |      |
| I hereby agree to comply with all terms and conditions set forth and described in this permit.   |  |  |            |                                 |           |      |
| <table> <tr> <td>James Perkins, Treasurer</td> <td></td> <td>12-17-2008</td> </tr> <tr> <td>Printed or Typed Name and Title</td> <td>Signature</td> <td>Date</td> </tr> </table> | James Perkins, Treasurer   |  | 12-17-2008 | Printed or Typed Name and Title | Signature | Date |
| James Perkins, Treasurer   |  | 12-17-2008   |            |                                 |           |      |
| Printed or Typed Name and Title  | Signature  | Date   |            |                                 |           |      |

|  |  |  |                 |                           |           |      |                            |  |  |       |  |  |
|--|--|--|-----------------|---------------------------|-----------|------|----------------------------|--|--|-------|--|--|
| <b>FDOT</b>  |  |  |                 |                           |           |      |                            |  |  |       |  |  |
| <table> <tr> <td>Approved By: <u>Adam Doyle</u></td> <td></td> <td><u>04/29/10</u></td> </tr> <tr> <td>Print Designated Engineer</td> <td>Signature</td> <td>Date</td> </tr> <tr> <td><u>Permits Coordinator</u></td> <td></td> <td></td> </tr> <tr> <td>Title</td> <td></td> <td></td> </tr> </table> | Approved By: <u>Adam Doyle</u>   |  | <u>04/29/10</u> | Print Designated Engineer | Signature | Date | <u>Permits Coordinator</u> |  |  | Title |  |  |
| Approved By: <u>Adam Doyle</u>   |  | <u>04/29/10</u>  |                 |                           |           |      |                            |  |  |       |  |  |
| Print Designated Engineer  | Signature  | Date   |                 |                           |           |      |                            |  |  |       |  |  |
| <u>Permits Coordinator</u>   |  |  |                 |                           |           |      |                            |  |  |       |  |  |
| Title  |  |  |                 |                           |           |      |                            |  |  |       |  |  |

**Exhibit A for Permit 09-K-291-0003**

Permit approved 04/29/2010 by Adam Boyle, Permits Coordinator.

**Project Name:** University United Methodist Church  
**FDOT Permit #:** 09-K-291-0003  
**Applicant:** University United Methodist Church, James Perkins  
**SR #:** 26  
**Section/MP:** .26070 at MP 19.429  
**Description:** Installing phase 1 temporary concrete sidewalks and installing brick paver sidewalk and concrete curb ramp contingent upon maintenance agreement with the City of Gainesville.

**Permit Special Provisions:**

This approved general use permit for University United Methodist Church is to adhere to the signed and sealed plans dated: 03/31/2010 by E.J. Bolduc and 03/31/2010 by Monique M. Heathcock.

The brick pavers shown on FDOT right-of-way in the plans (sheets LD.100 and LD.101) shall not be constructed until an appropriate maintenance agreement between FDOT and the City of Gainesville has been executed. The "temporary sidewalks" shown on sheet LS-1 may be constructed to allow pedestrian access to the site until the brick paver sidewalk is allowed to be constructed.

## PERMIT TERMS AND CONDITIONS

### FDOT Gainesville Maintenance

**Project Name:** University United Methodist Church  
**Permit #:** 09-A-291-0003  
**SR-#:** 26  
**Rdwy. Section:** 26070  
**Mile Post:** 19.429

All construction and/or maintenance on the Department's right-of-way shall conform to the most recent editions of: FDOT Design Standards, the FDOT Standard Specifications for Road and Bridge Construction, the FDOT Plans Preparation Manual Volume 1, and the Manual on Uniform Traffic Control.

The permittee shall be responsible for any damages caused by the construction associated with this permit. The permittee shall repair any damages according to the most current standards.

All damaged concrete within the project limits shall be replaced joint to joint.

All portions of the right-of-way disturbed during construction associated with this permit shall be sodded as follows:

- Urban Areas: sod with St. Augustine, Bermuda or Centipede, FDOT will specify.
- Rural Areas: sod to match existing.

48 hours before digging operations the contractor shall call Sunshine State One Call at 811. The permittee is cautioned that utilities may be present within the construction area.

No tree trimming or tree removal will be allowed unless special permission is granted by the FDOT.

The permittee shall maintain proper placement and condition of all existing FDOT regulatory and/or Informational signs.

Notify the Department of Transportation Maintenance office 48 hours in advance of starting proposed work at (352) 381-4314 or (352) 381-4300.

No unapproved signs are to be placed on or overhanging into the right-of-way.

The connection to or modification of any portion of the FDOT stormwater system is prohibited unless approved by a separate drainage permit.

All permits shall include a maintenance of traffic plan before any work can begin. A worksite traffic supervisor with a certification from the FDOT approved Work Zone Traffic Control Course must be on-site anytime the contractor is working in the FDOT right-of-way.

All lane closure shall be called in to the FDOT Maintenance Office at (352) 381-4300 when the lane is closed and immediately after the lane is open.

Pedestrian traffic shall be detoured around the work area in a safe manner and in accordance with the FDOT Design Standards (2008) index 660.

Lane closure will only be allowed between the hours of 9:00 am and 4:00 pm unless otherwise approved by the FDOT.

There shall be no tracking of soil from the permitted job site onto the roadway. If tracking does occur, the permittee and or contractor shall install the "Soil Tracking Prevention Device" per Standard Index 106.

EXHIBIT 1 pg 7 of 9

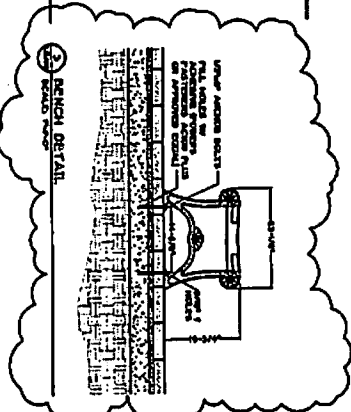
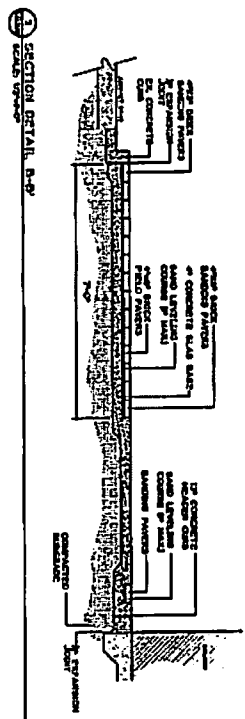
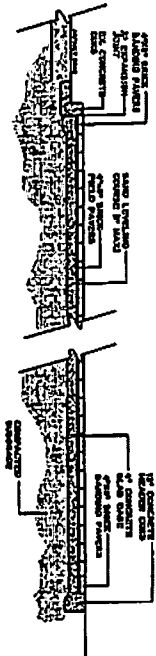
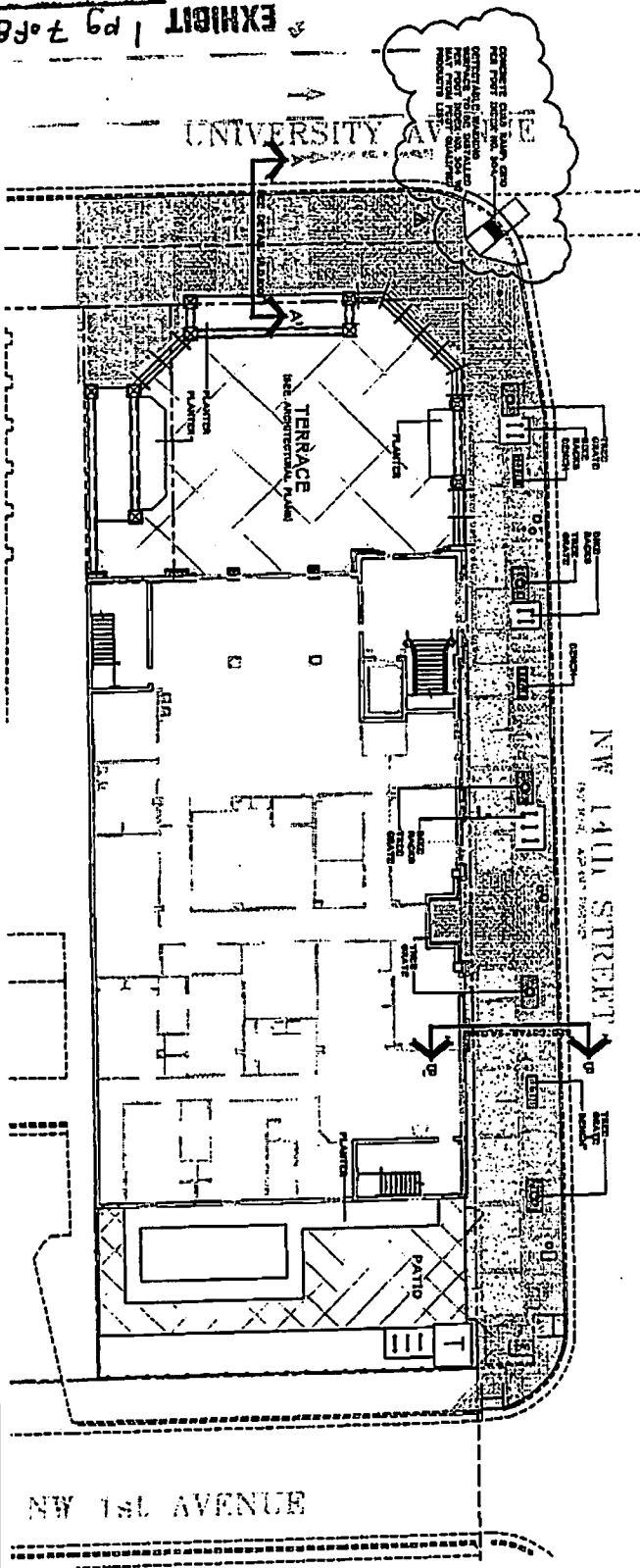

**NOTES**  
 EXISTING LANDSCAPE ARCHITECTURE AT THIS LOCATION TO BE MAINTAINED AND RESTORED TO ORIGINAL CONDITION.

**1. PRIMARY CORRIDOR MATERIALS SCHEDULE PER CRA STANDARD**

**2. COLLEGE PARK/UNIVERSITY HEIGHTS CAMPUS/RESIDENTIAL CORRIDOR MATERIALS SCHEDULE PER CRA STANDARD**

SEE SHEET TLM FOR FURTHER MATERIALS SCHEDULES

**SCALE**  
 AS SHOWN  
 1/4" = 1'-0"

**STREETSCAPE PLAN**  
 CONSTRUCTION DOCUMENTS

**UNIVERSITY UNITED METHODIST CHURCH**  
 N.W. 14th St. & UNIVERSITY AVE.  
 GAINESVILLE, FLORIDA

**DESIGN TEAM**  
 ARCHITECT  
 ENGINEER  
 LANDSCAPE ARCHITECT

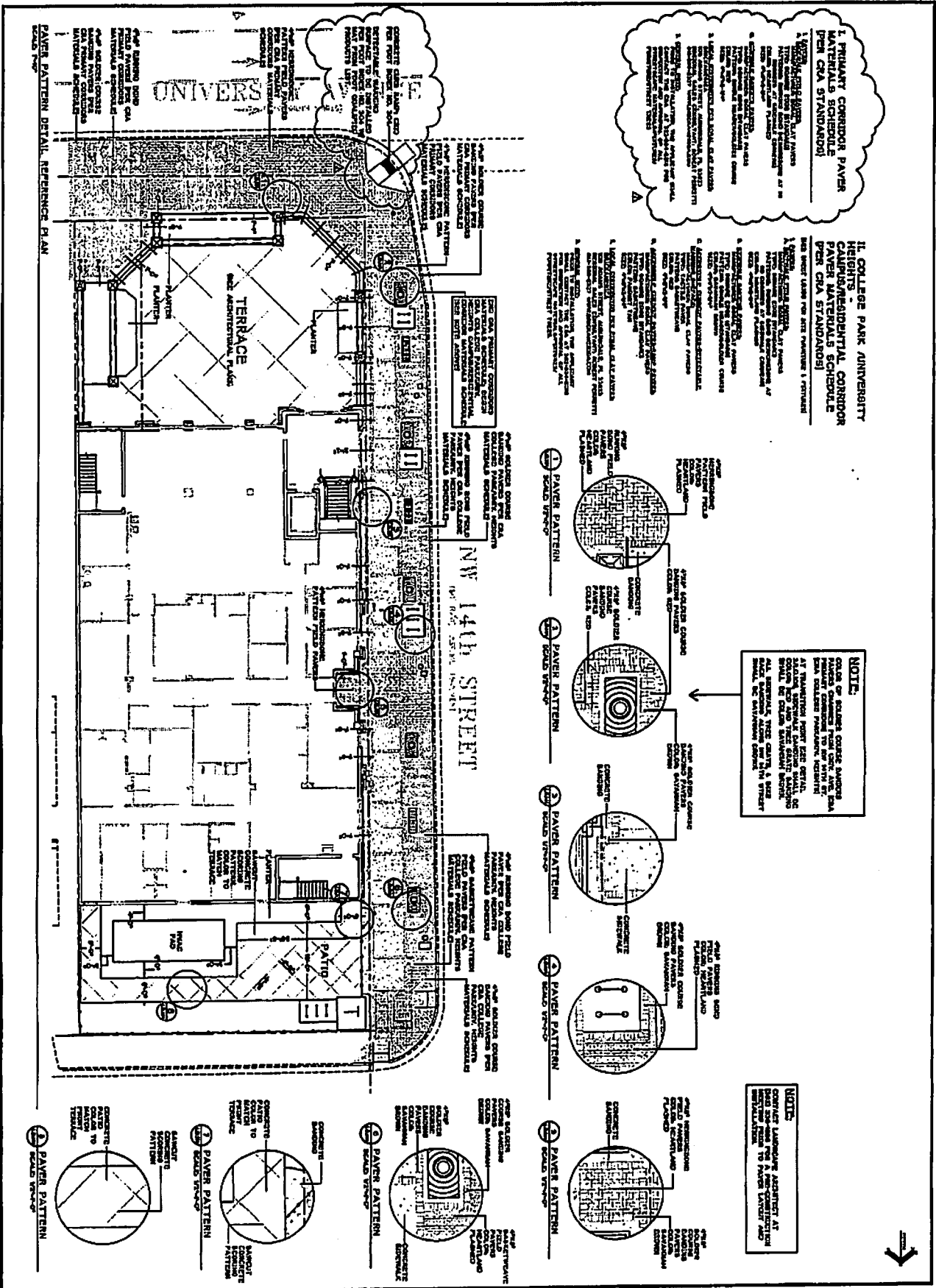

EXHIBIT 1 pg 8 of 8

**UNIVERSITY UNITED METHODIST CHURCH**  
 N.W. 14th St. & University Ave.  
 GAINESVILLE, FLORIDA

**PAVER PATTERN DETAILS**  
 CONSTRUCTION DOCUMENTS

**PROJECT TITLE & LOCATION:**  
 UNIVERSITY UNITED METHODIST CHURCH  
 N.W. 14th St. & University Ave.  
 GAINESVILLE, FLORIDA

**DATE:** 08/11/2011

**SCALE:** AS SHOWN

**DESIGNED BY:** J. W. BROWN

**CHECKED BY:** J. W. BROWN

**DATE:** 08/11/2011

**PROJECT NUMBER:** 11-0000

**DATE:** 08/11/2011