

LEGISLATIVE #

120227C



Petition PB-12-61 CPA
June 28, 2012

Appendix B - Updated Associated Maps of Future Land Use Map Series

FUTURE LAND USE ELEMENT

100-year Flood Plain

Legend

-  100-year Flood Plain
-  Gainesville City Limits

Source: Federal Emergency Management Administration (FEMA) Flood Insurance Rate Maps (FIRMs), 2004. 100-year Flood Plain based on FEMA categories A and A.E.

This map is for general reference use only. For more information, please contact the City of Gainesville.

City of Gainesville Gainesville, Florida

Prepared by the
Planning Department
May 2012



EXHIBIT
B-1
Tables

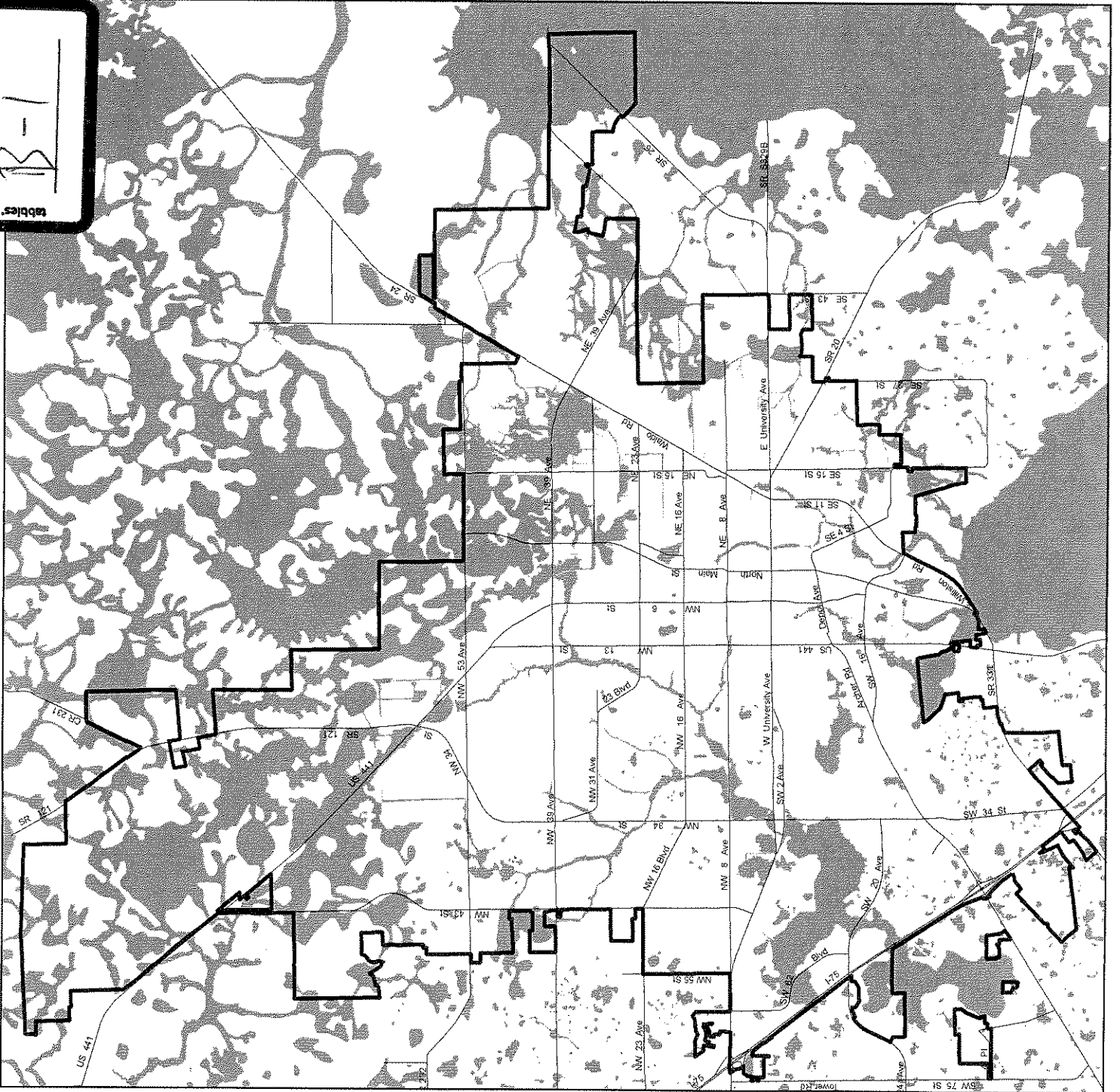

ENVIRONMENTALLY SIGNIFICANT LAND & RESOURCES

Surface Waters & Wetlands

Legend

- * Spring
- Wetland
- Lake
- Creek
- Gainesville City Limits

Original Source Data:
 Wetlands & Lakes:
 SJRWMD digital files
 (sjlu95.shp, wetlands=
 LU6000-6999 and
 lakes=LU5200

City of Gainesville Gainesville, Florida

Prepared by the
 Planning Department
 May 2012



EXHIBIT
 B-4
 Tables

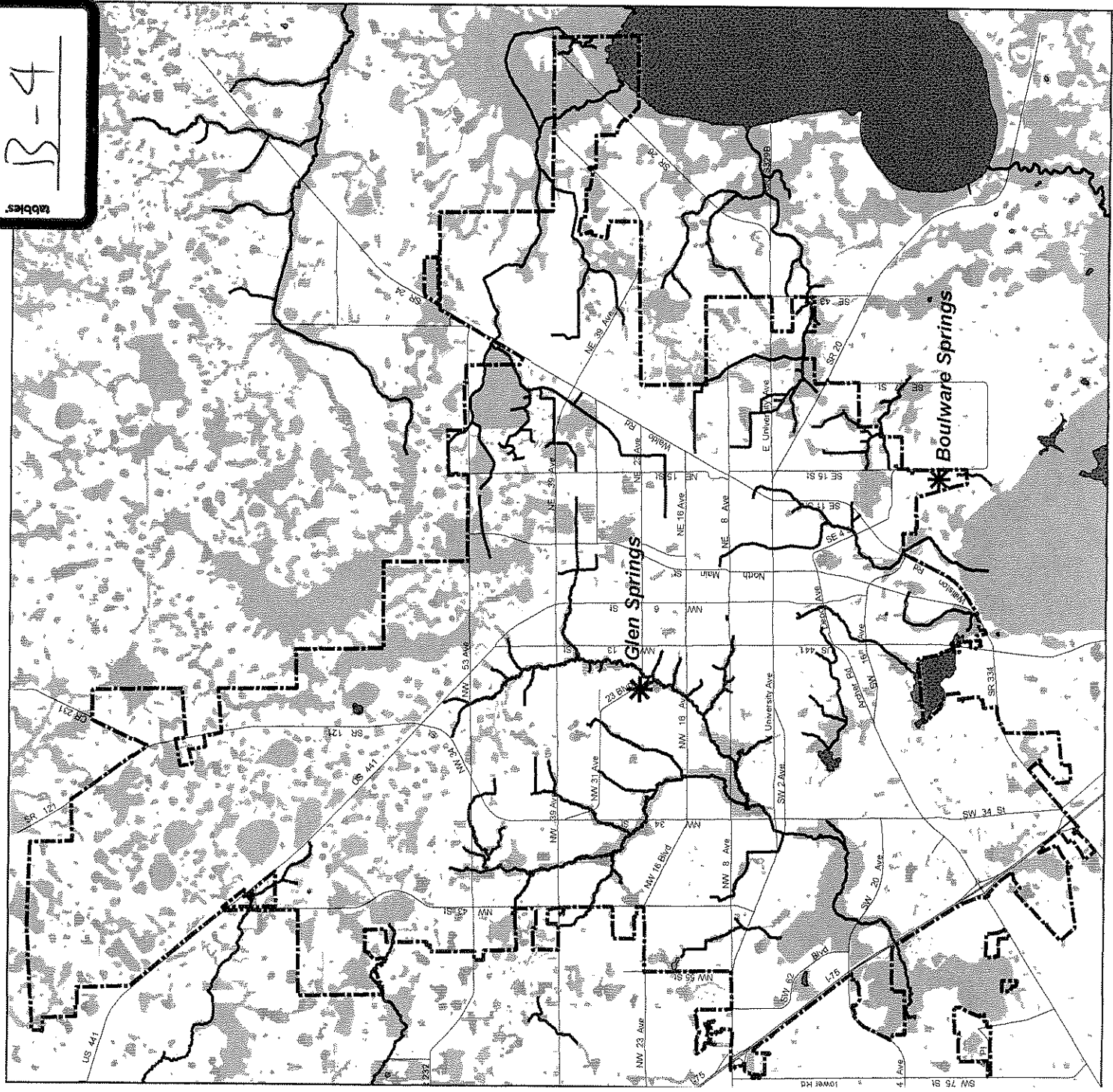

EXHIBIT

B-5

bbbles

CONSERVATION, OPEN SPACE, & GROUNDWATER RECHARGE ELEMENT

Active Mine Sites

Legend

- X Limestone Mine Site
- Gainesville City Limits
- Alachua County

Note: There are no active mine sites inside the City of Gainesville City Limits.
Source: Florida Department of Environmental Protection (FDEP) shapefile, 2006

City of Gainesville Gainesville, Florida

Prepared by the
Planning Department
May 2012

