

**LEGISLATIVE #**

**110168C**



**Appendix B Updated Maps for Historic Preservation Data and Analysis Report**



# HISTORIC PRESERVATION ELEMENT

Northeast Gainesville Residential Historic District

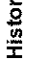
## Legend

-  Historic District Boundary
-  Historic Structures
- Status**
-  Contributing
-  Non-Contributing

City of Gainesville  
Gainesville, Florida

Prepared by the  
Planning Department  
February 2011

0 205 410 820 Feet





# HISTORIC PRESERVATION ELEMENT

Southeast Gainesville  
Historic District

## Legend

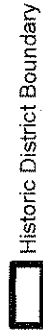

Historic District Boundary

Historic Structures

Contributing

Non-Contributing

City of Gainesville  
Gainesville, Florida

Prepared by the  
Planning Department  
February 2011

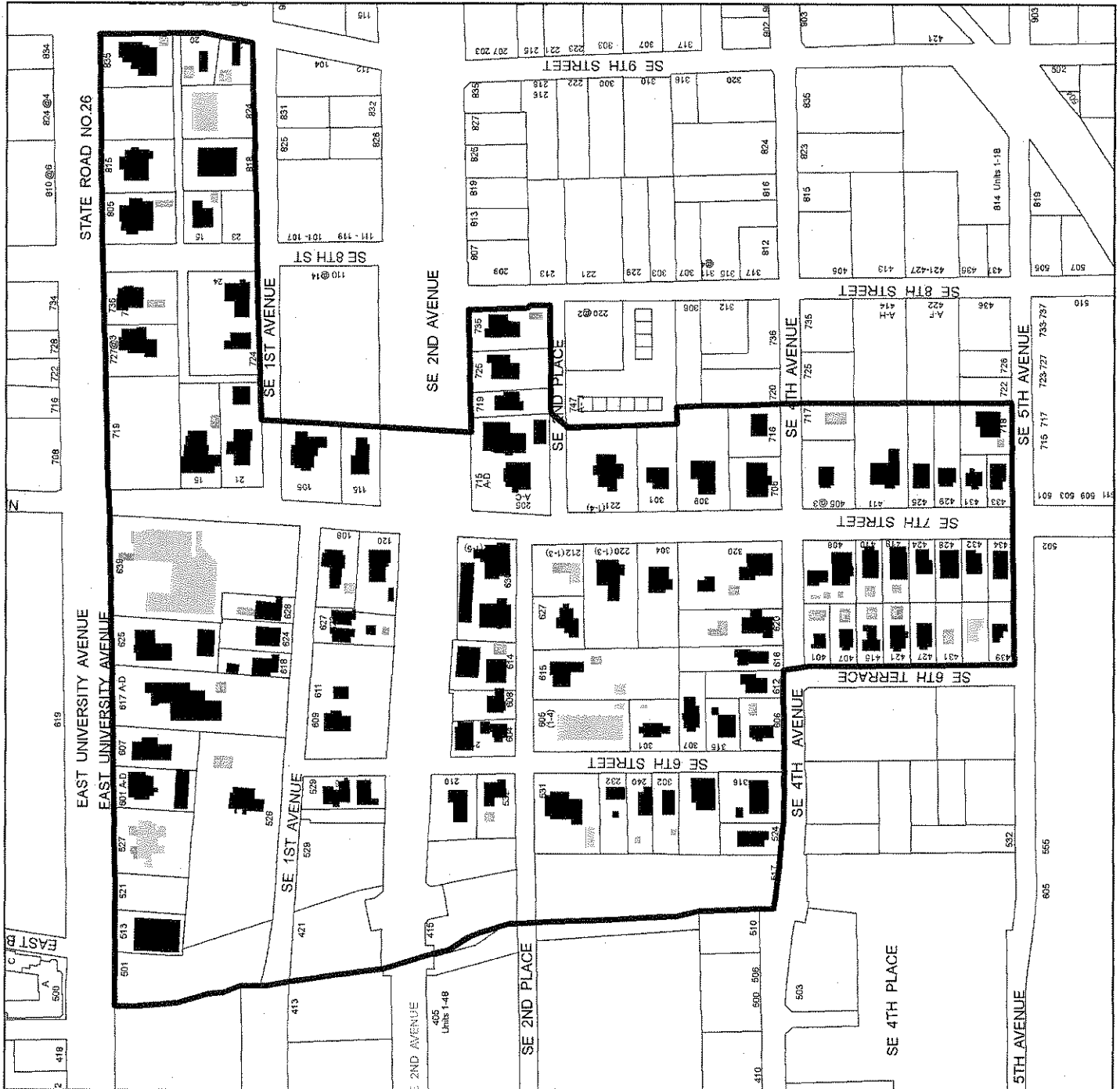





City of Gainesville  
Gainesville, Florida

Prepared by the  
Planning Department  
February 2011

# HISTORIC PRESERVATION ELEMENT

Pleasant Street Historic District

## Legend



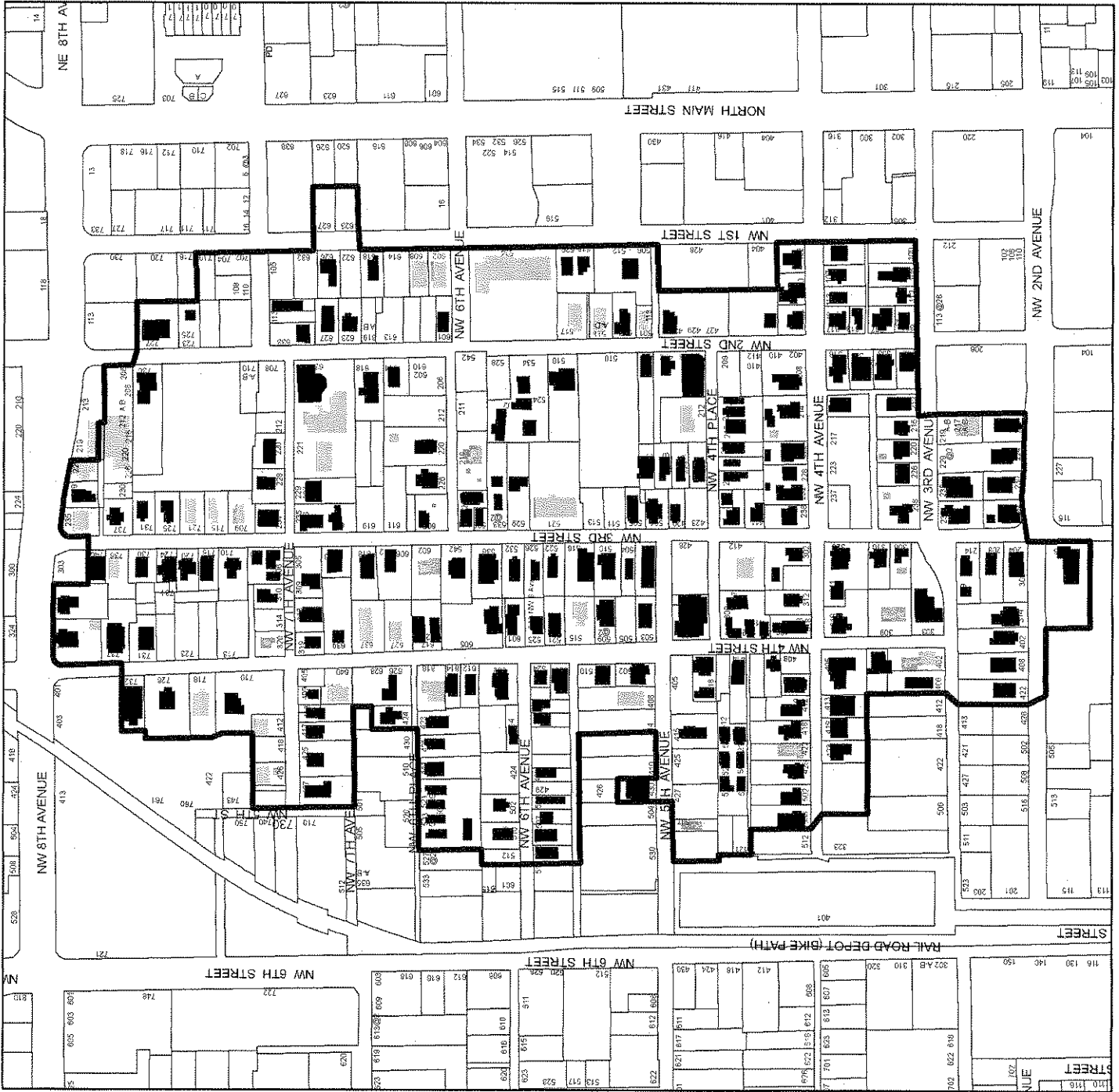

-  Historic District Boundary
- Historic Structures**
- Status**
-  Contributing
-  Non-Contributing



# HISTORIC PRESERVATION ELEMENT

University Heights North  
Historic Residential District

## Legend

-  Historic District Boundary
-  Historic Structures
-  Contributing
-  Non-Contributing



0 100 200 400 Feet

### City of Gainesville Gainesville, Florida

Prepared by the  
Planning Department  
February 2011

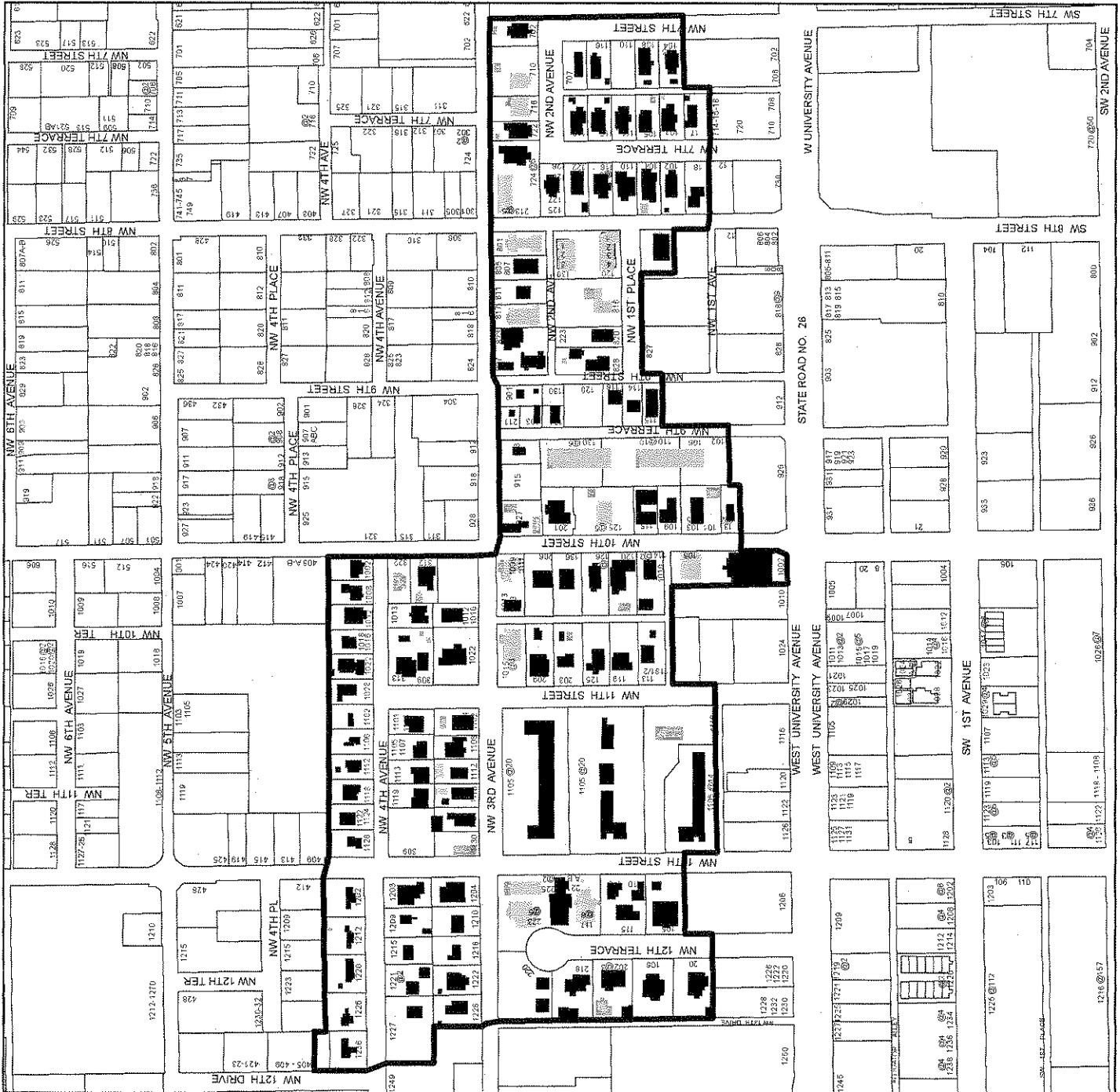







# HISTORIC PRESERVATION ELEMENT

University Heights Historic District - South

## Legend

-  Historic District Boundary
-  Historic Structures
- Status**
-  Contributing
-  Non-Contributing

### City of Gainesville Gainesville, Florida

Prepared by the  
Planning Department  
February 2011

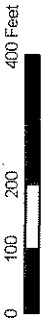





# HISTORIC PRESERVATION ELEMENT

Potential Golfview Historic Residential District

## Legend

-  Golfview Boundary
-  Contributing Parcels

### City of Gainesville Gainesville, Florida

Prepared by the  
Planning Department  
February 2011

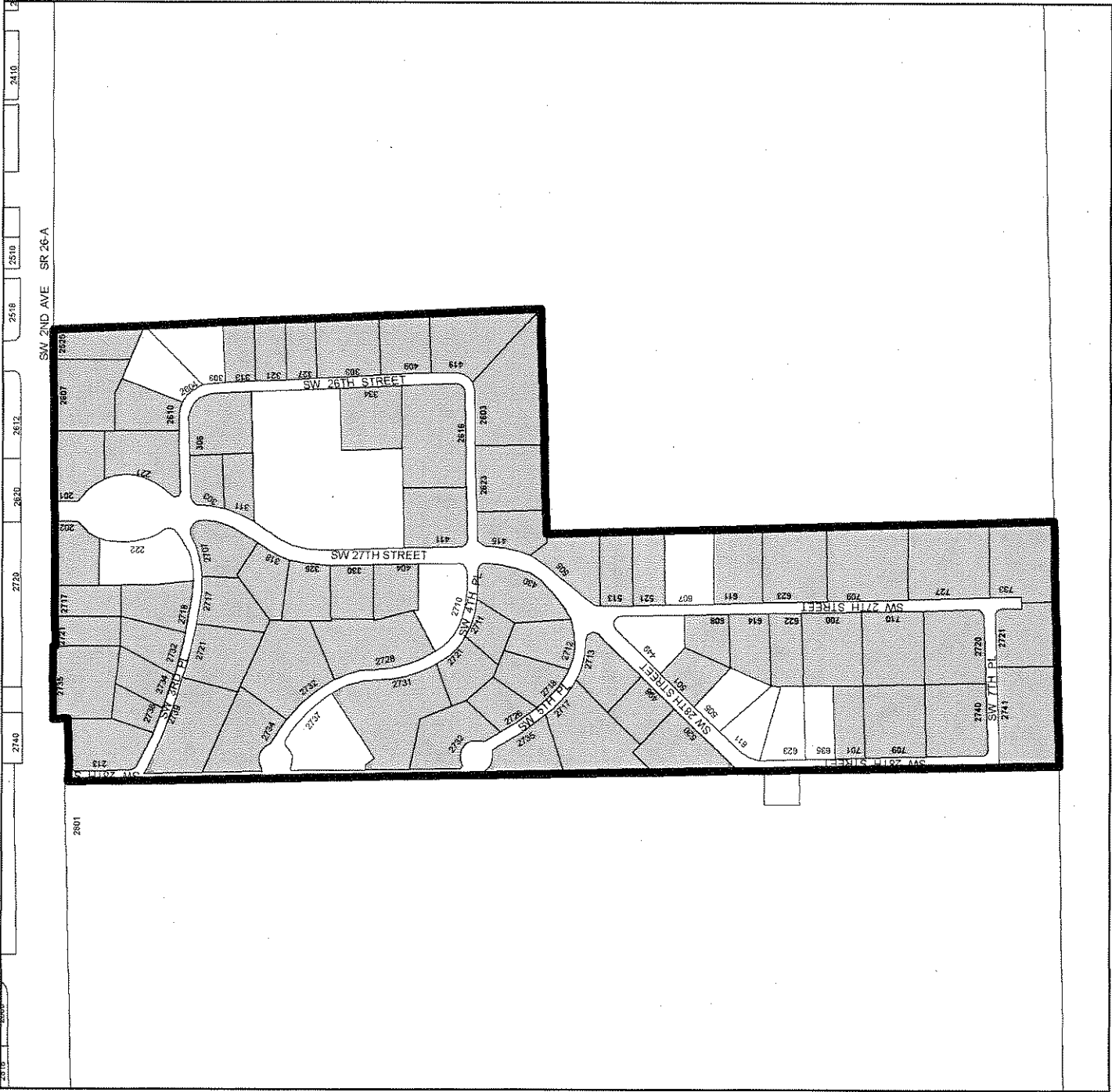







0 112.5 225 450 Feet

# HISTORIC PRESERVATION ELEMENT

Potential College Park West Historic Residential District

## Legend

-  College Park West Boundary
-  Contributing Parcels

### City of Gainesville Gainesville, Florida

Prepared by the  
Planning Department  
February 2011

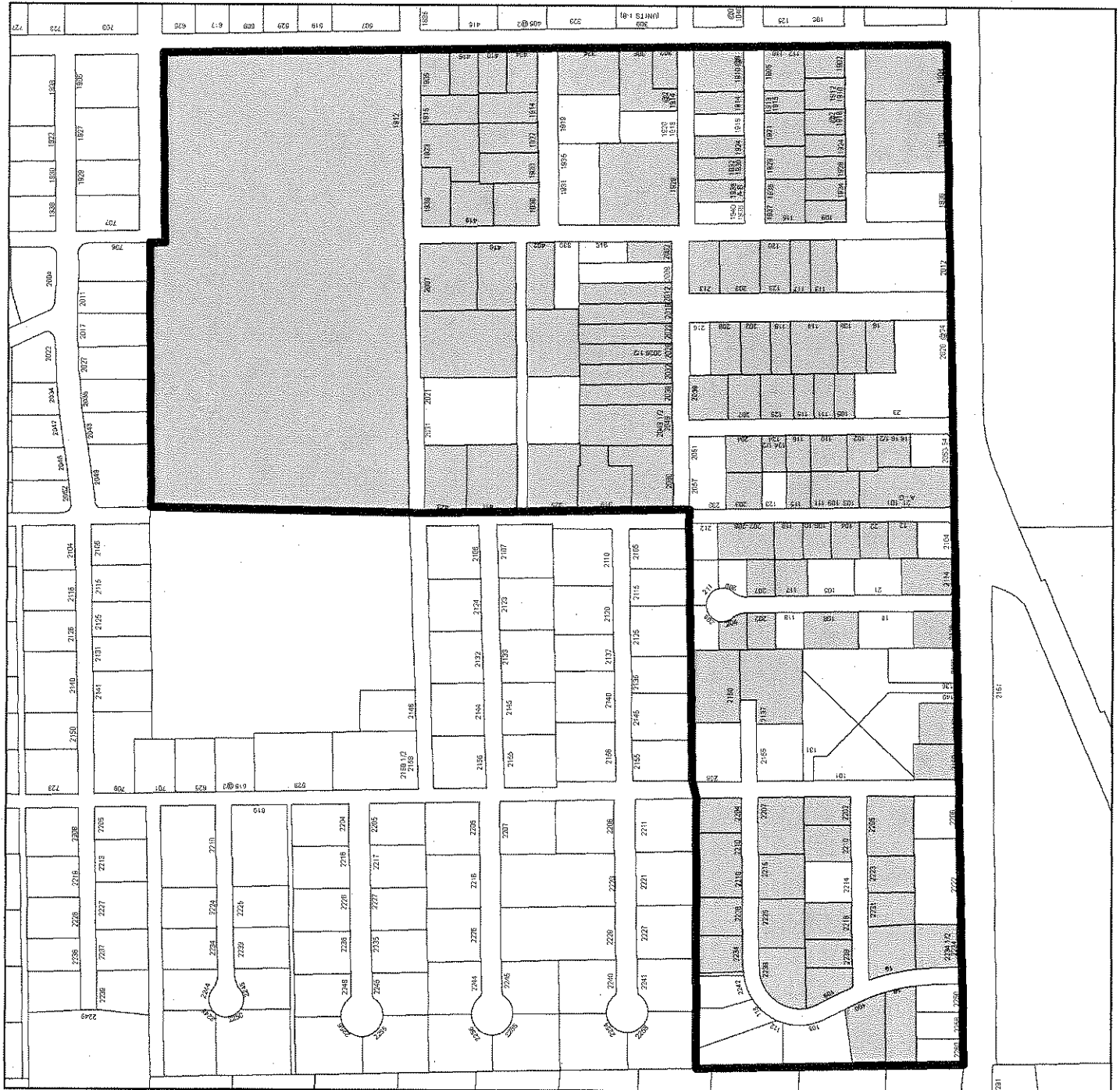





# HISTORIC PRESERVATION ELEMENT

University of Florida Historic District

## Legend

-  National Historic Register Buildings
-  UF Historic District
-  UF Historic Impact Area

## Historic Buildings

- |                          |                         |
|--------------------------|-------------------------|
| 1. Plaza of the Americas | 17. Infirmary           |
| 2. University Auditorium | 18. Reid Hall           |
| 3. Walker Hall           | 19. Florida Gymnasium   |
| 4. Peabody Hall          | 20. Carleton Auditorium |
| 5. Smathers Library      | 21. Weil Hall           |
| 6. Bryan Hall            | 22. Tigert Hall         |
| 7. Anderson Hall         | 23. University Police   |
| 8. Flint Hall            | 24. HUB                 |
| 9. Leigh Hall            | 25. Yulee Hall          |
| 10. Griffin-Floyd Hall   | 26. Malloy Hall         |
| 11. Rolfs Hall           | 27. Norman Hall         |
| 12. Newell Hall          | 28. Dauer Hall          |
| 13. Usler Hall           | 29. Fletcher Hall       |
| 14. Buckman Hall         | 30. Murphree Hall       |
| 15. Stead Hall           | 31. Matherly Hall       |
| 16. Thomas Hall          | 32. Century Tower       |

## City of Gainesville Gainesville, Florida

Prepared by the  
Planning Department  
February 2011



350 175 0 350 Feet

