



## Planning & Development Services

# **PB-11-14 ZON** **Zoning Change**

**4/21/11**

City Legistar 100790



**AERIAL PHOTOGRAPH**

	<b>Name</b>	<b>Petition Request</b>	<b>Map(s)</b>	<b>Petition Number</b>
	Eng, Denman and Associates, agent for the City of Gainesville	Rezone from I-2 to BI and CON	3357	PB-11-14 ZON



# Zoning District Categories

- RSF1 Single-Family Residential (3.5 du/acre)
- RSF2 Single-Family Residential (4.6 du/acre)
- RSF3 Single-Family Residential (5.8 du/acre)
- RSF4 Single-Family Residential (8 du/acre)
- RSFR Singel-Family Rural Residential (1.0 du/acre)
- RMF5 Residential Low Density (12 du/acre)
- RC Residential Conservation (12 du/acre)
- MH Mobile Home Residential (12 du/acre)
- RMF6 Multiple-Family Medium Density Residential (8-15 du/acre)
- RMF7 Multiple-Family Medium Density Residential (8-21 du/acre)
- RMF8 Multiple-Family Medium Density Residential (8-30 du/acre)
- RMU Residential Mixed Use (up to 75 du/acre)
- RH1 Residential High Density (8-43 du/acre)
- RH2 Residential High Density (8-100 du/acre)
- OR Office Residential (up to 20 du/acre)
- OF General Office
- PD Planned Development
- BUS General Business
- BA Automotive-Oriented Business
- BT Tourist-Oriented Business
- MU1 Mixed Use Low Intensity (8-30 du/acre)
- MU2 Mixed Use Medium Intensity (12-30 du/acre)
- UMU1 Urban Mixed Use District 1 (up to 75 du/acre)
- UMU2 Urban Mixed Use District 2 (up to 100 du/acre)
- CCD Central City District
- BI Business Industrial
- W Warehousing and Wholesaling
- I1 Limited Industrial
- I2 General Industrial
- AGR Agriculture
- CON Conservation
- MD Medical Services
- PS Public Services and Operations
- AF Airport Facility
- ED Educational Services
- CP Corporate Park

- Historic Preservation/Conservation District
- Special Area Plan
- - - - - Division line between two zoning districts
- City Limits

Area  
under petition  
consideration

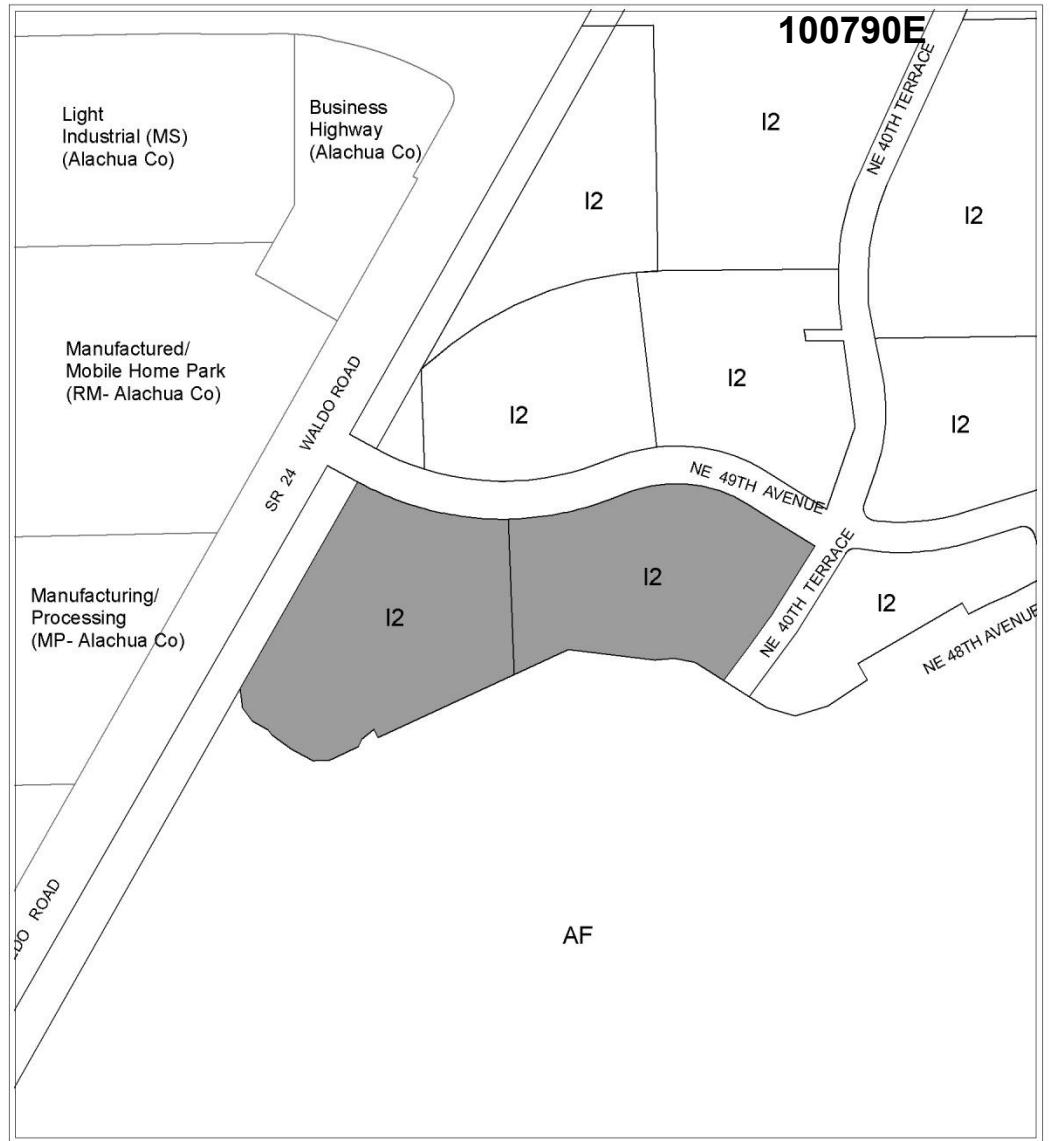
## EXISTING ZONING

	Name	Petition Request	Map(s)	Petition Number
 <p>No Scale</p>	Eng, Denman and Associates, agent for the City of Gainesville	Rezone from I-2 to BI and CON	3357	PB-11-14 ZON

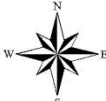
# Zoning District Categories

- RSF1 Single-Family Residential (3.5 du/acre)
- RSF2 Single-Family Residential (4.6 du/acre)
- RSF3 Single-Family Residential (5.8 du/acre)
- RSF4 Single-Family Residential (8 du/acre)
- RSFR Singel-Family Rural Residential (1.0 du/acre)
- RMF5 Residential Low Density (12 du/acre)
- RC Residential Conservation (12 du/acre)
- MH Mobile Home Residential (12 du/acre)
- RMF6 Multiple-Family Medium Density Residential (8-15 du/acre)
- RMF7 Multiple-Family Medium Density Residential (8-21 du/acre)
- RMF8 Multiple-Family Medium Density Residential (8-30 du/acre)
- RMU Residential Mixed Use (up to 75 du/acre)
- RH1 Residential High Density (8-43 du/acre)
- RH2 Residential High Density (8-100 du/acre)
- OR Office Residential (up to 20 du/acre)
- OF General Office
- PD Planned Development
- BUS General Business
- BA Automotive-Oriented Business
- BT Tourist-Oriented Business
- MU1 Mixed Use Low Intensity (8-30 du/acre)
- MU2 Mixed Use Medium Intensity (12-30 du/acre)
- UMU1 Urban Mixed Use District 1 (up to 75 du/acre)
- UMU2 Urban Mixed Use District 2 (up to 100 du/acre)
- CCD Central City District
- BI Business Industrial
- W Warehousing and Wholesaling
- I1 Limited Industrial
- I2 General Industrial
- AGR Agriculture
- CON Conservation
- MD Medical Services
- PS Public Services and Operations
- AF Airport Facility
- ED Educational Services
- CP Corporate Park

- Historic Preservation/Conservation District
- Special Area Plan
- - - - - Division line between two zoning districts
- City Limits

Area  
under petition  
consideration

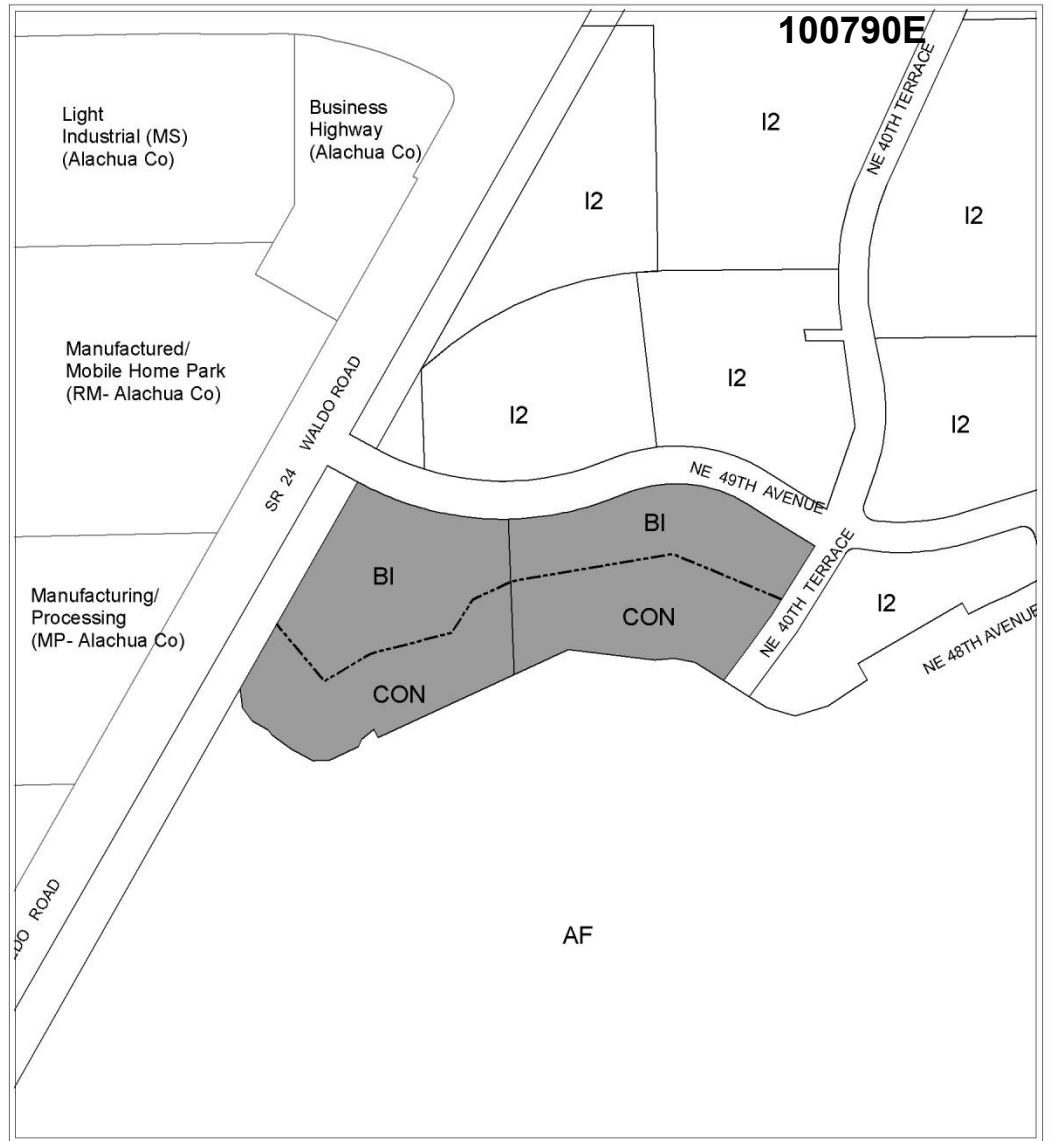
## PROPOSED ZONING

	Name	Petition Request	Map(s)	Petition Number
	Eng, Denman and Associates, agent for the City of Gainesville	Rezone from I-2 to BI and CON	3357	PB-11-14 ZON

# Land Use Designations

- SF Single Family (up to 8 du/acre)
- RL Residential Low Density (up to 12 du/acre)
- RM Residential Medium Density (8-30 du/acre)
- RH Residential High Density (8-100 du/acre)
- MUR Mixed Use Residential (up to 75 du/acre)
- MUL Mixed Use Low Intensity (8-30 du/acre)
- MUM Mixed Use Medium Intensity (12-30 du/acre)
- MUH Mixed Use High Intensity (up to 150 du/acre)
- UMU1 Urban Mixed Use 1 (up to 75 du/acre)
- UMU2 Urban Mixed Use 2 (up to 100 du/acre)
- O Office
- C Commercial
- IND Industrial
- E Education
- REC Recreation
- CON Conservation
- AGR Agriculture
- PF Public Facilities
- PUD Planned Use District

----- Division line between two land use districts  
**—** City Limits

Area  
under petition  
consideration

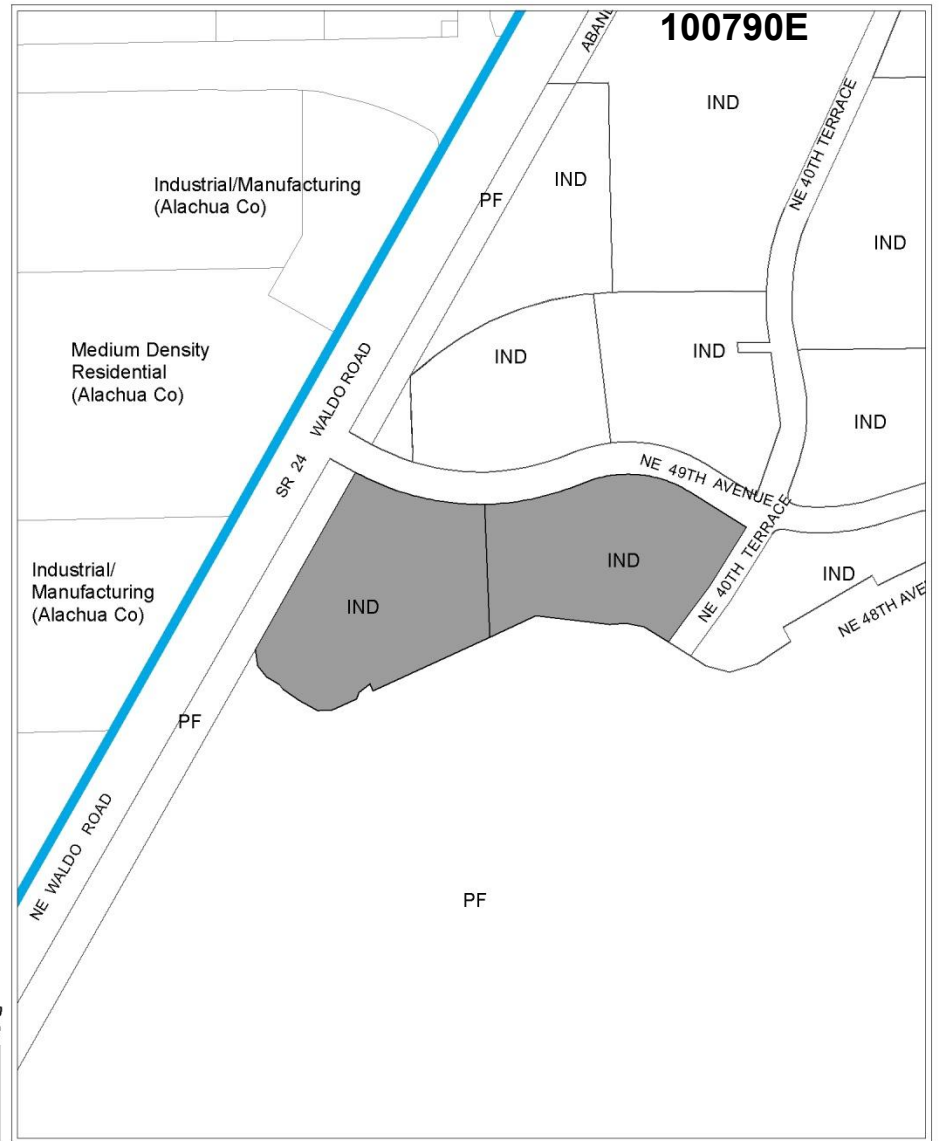
## EXISTING LAND USE

	Name	Petition Request	Map(s)	Petition Number
	Eng, Denman and Associates, agent for the City of Gainesville	Rezone from I-2 to BI and CON	3357	PB-11-14 ZON



100790E

AIRPORT  
INDUSTRIAL PARK





100790E





100790E





100790E





100790E



PNEUMATIC POWER AND CONTROL  
3716 NE 49th Rd.



**Planning staff recommends  
approval of Petition  
PB-11-14 ZON  
and  
Ordinance 100790**