



## Planning and Development Services

# **PB-15-73 LUC**

**City Commission  
November 5, 2015**

**Legistar No. 150305**

**Presentation by Dean Mimms, AICP**

# Small-scale Land Use Amendment

<b>PB-14-73 LUC</b>	<b>Existing</b>	<b>Proposed</b>
<b>Land Use (2.84 ac)</b>	<b>CON (Conservation)</b>	<b>SF (Single-Family, up to 8 units per acre)</b>



150305G

AERIAL PHOTOGRAPH

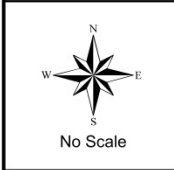

Name	Petition Request	Petition Number
City Plan Board, applicant	Amend the City of Gainesville Future Land Use Map from Conservation to Single-Family (up to 8 units per acre)	PB-15-73 LUC

## City of Gainesville Land Use Categories

- SF Single-Family (up to 8 units per acre)
- R-L Residential Low-Density (up to 12 units per acre)
- MU-M Mixed-Use Medium-Intensity (12-30 units per acre)
- CON Conservation

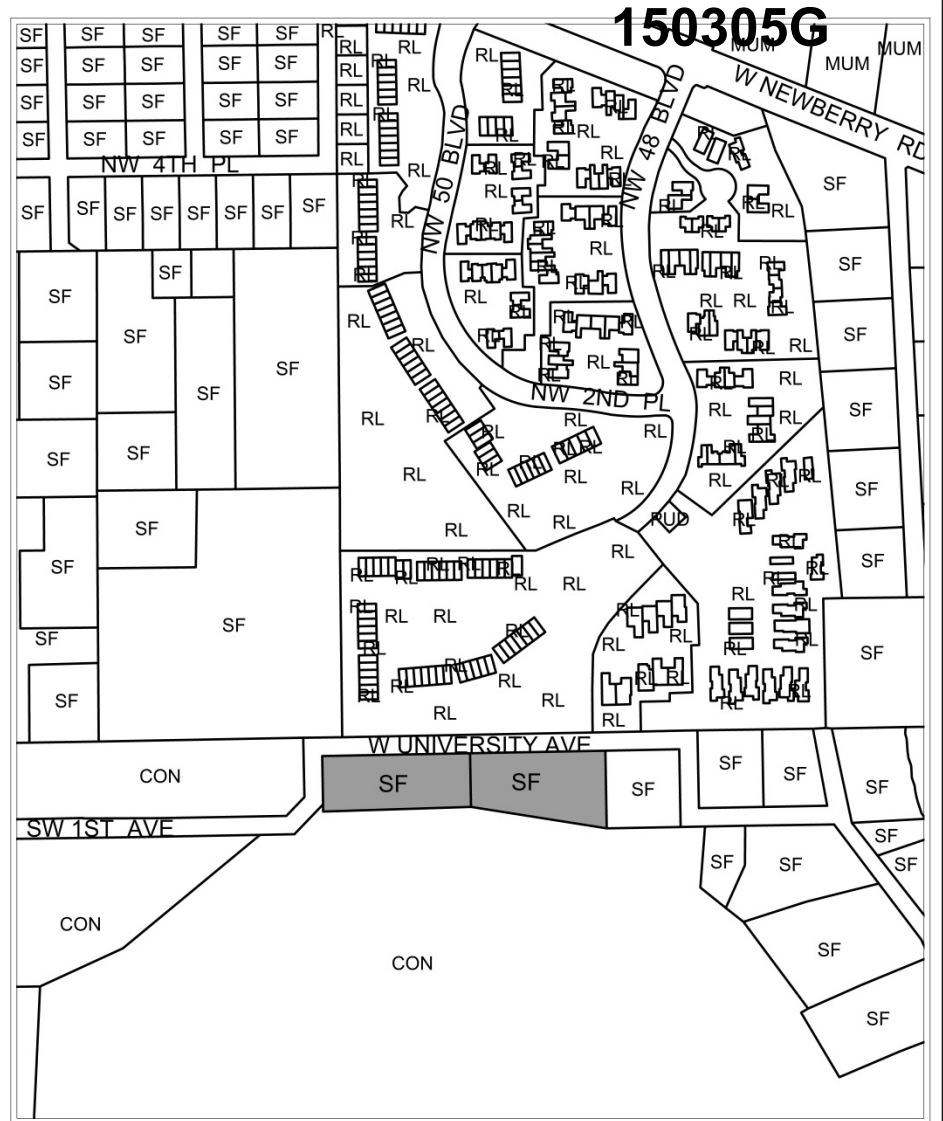

Area  
under petition  
consideration



### PROPOSED LAND USE

	Name	Petition Request	Petition Number
 No Scale	City Plan Board, applicant	Amend the City of Gainesville Future Land Use Map from Conservation to Single-Family (up to 8 units per acre)	PB-15-73 LUC

150305G



150305G

4911



150305G



150305G

**GAME WILDLIFE**

Welcome to  
**Clear Lake National Park**



**Wildlife**

- Observe wildlife from a safe distance.
- Do not feed or touch any animals.
- Do not approach or disturb nesting birds.
- Do not use flash photography.

Red circular marker at the top of the post.

Small white informational sign with a blue logo.

**CAUTION**  
Alligator may  
be present  
on trail



Red circular marker at the top of the post.



# Key Points

- **Single-Family (up to 8 units/acre) (SF) land use is consistent w/City's Comprehensive Plan, supportive of urban infill**
- **Proposed SF will change long-established, legally nonconforming use to conforming use**
- **Severe environmental constraints re: potential for additional development (e.g., one-half to two-thirds of property within regulated wetlands of Hogtown Creek Basin)**

## City Plan Board to City Commission

**Approve Petition PB-15-73 LUC**  
(Plan Board voted 6-0)

## Staff to City Commission

**Approve Petition & Ordinance**