



PUBLIC WORKS DEPARTMENT

MAIN ST. STREETScape – PHASE 2 *DESIGN UPDATE*

Stefan Broadus
Engineer
City of Gainesville Public Work

1. CONSTRAINTS
2. DESIGN CONSIDERATIONS
3. FUNDING
4. RECOMMENDATION

- Budget
- Site Conditions
- Impacts to Businesses



- Historical Component
- Public Art Component
- Low Impact Development (LID) Stormwater Treatment
- Electric Vehicle Charging Station
- Hardscaping Grassed Area
- Brick Crosswalks
- Landscaping
- Street Furniture

- Historical Component



- Low Impact Development (LID) Stormwater Treatment



- Low Impact Development (LID) Stormwater Treatment



- Low Impact Development (LID) Stormwater Treatment



- Low Impact Development (LID) Stormwater Treatment

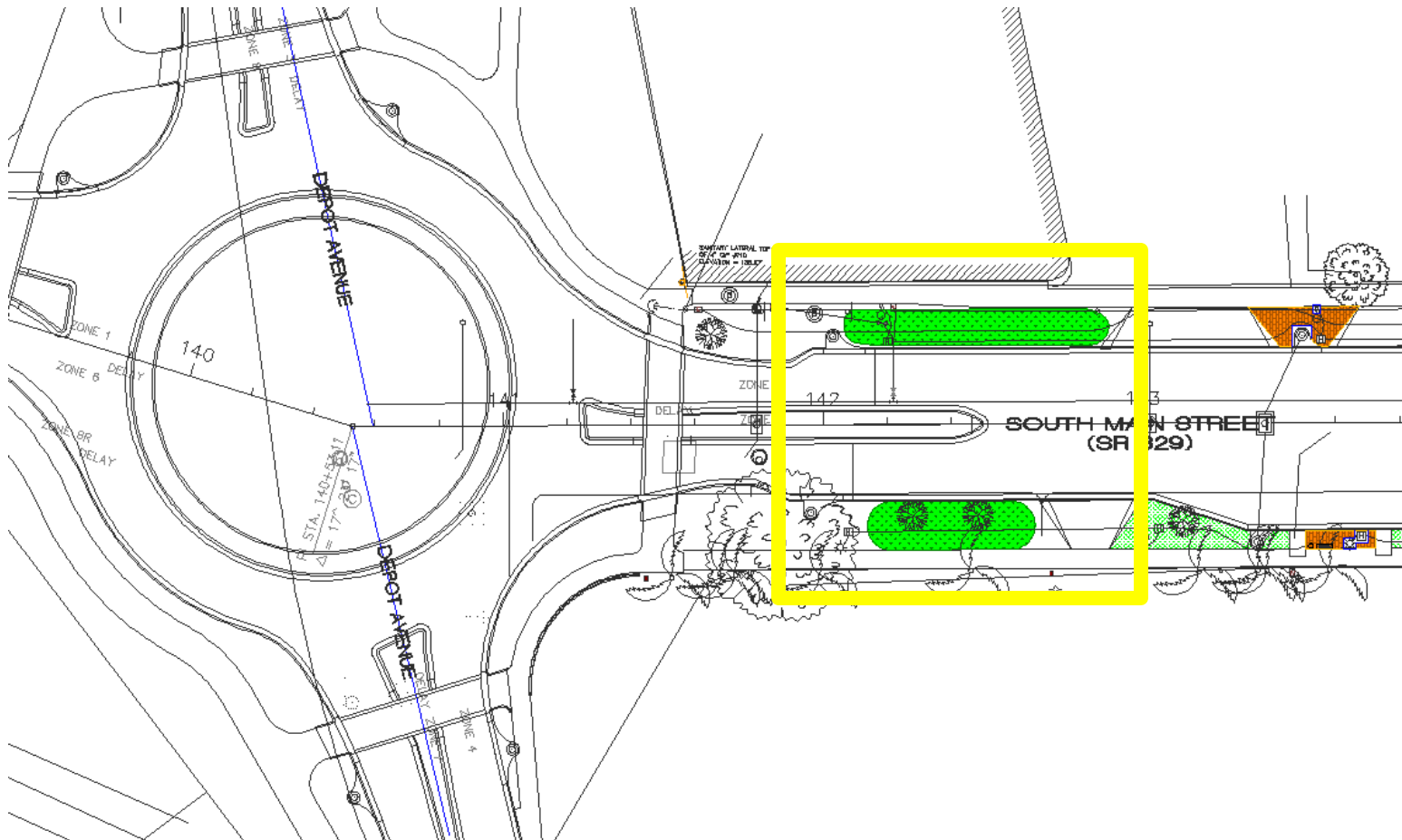

- Low Impact Development (LID) Stormwater Treatment



- Low Impact Development (LID) Stormwater Treatment



- Electric Vehicle Charging Station



- Hardscaping Grassed Area
 - Brick “Urban Core” – S 2nd Ave to N 2nd Ave
 - Light Brown = Existing Brick
 - Dark Brown = Proposed Brick

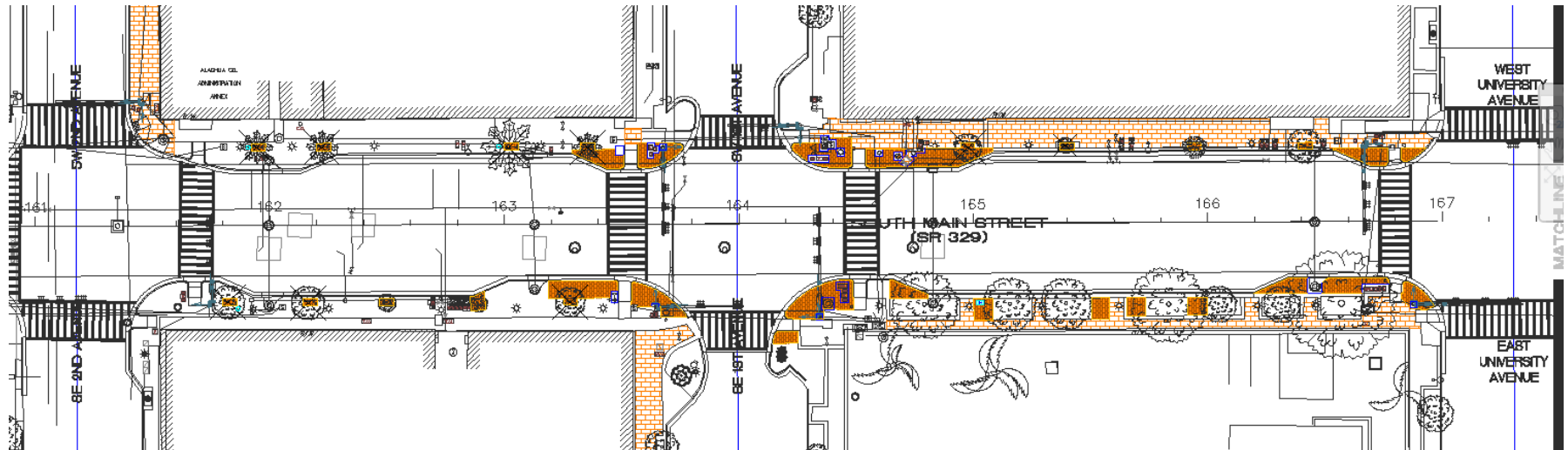

- Hardscaping Grassed Area

- Brick “Urban Core” – S 2nd Ave to N 2nd Ave
- Light Brown = Existing Brick, Dark Brown = Proposed Brick
- Match Existing Brick

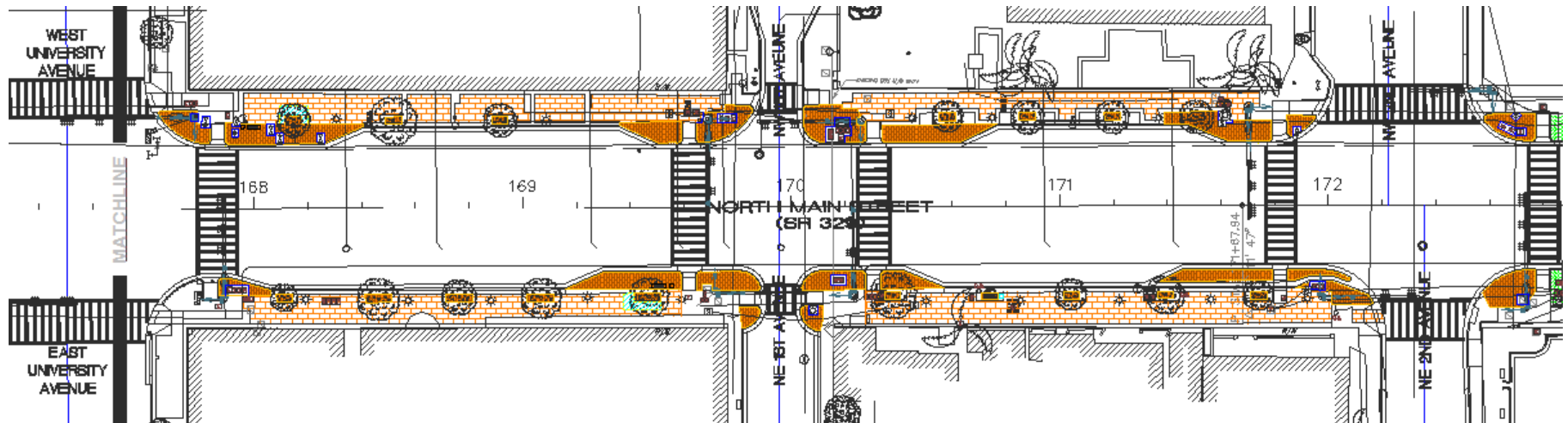

- Hardscaping Grassed Area

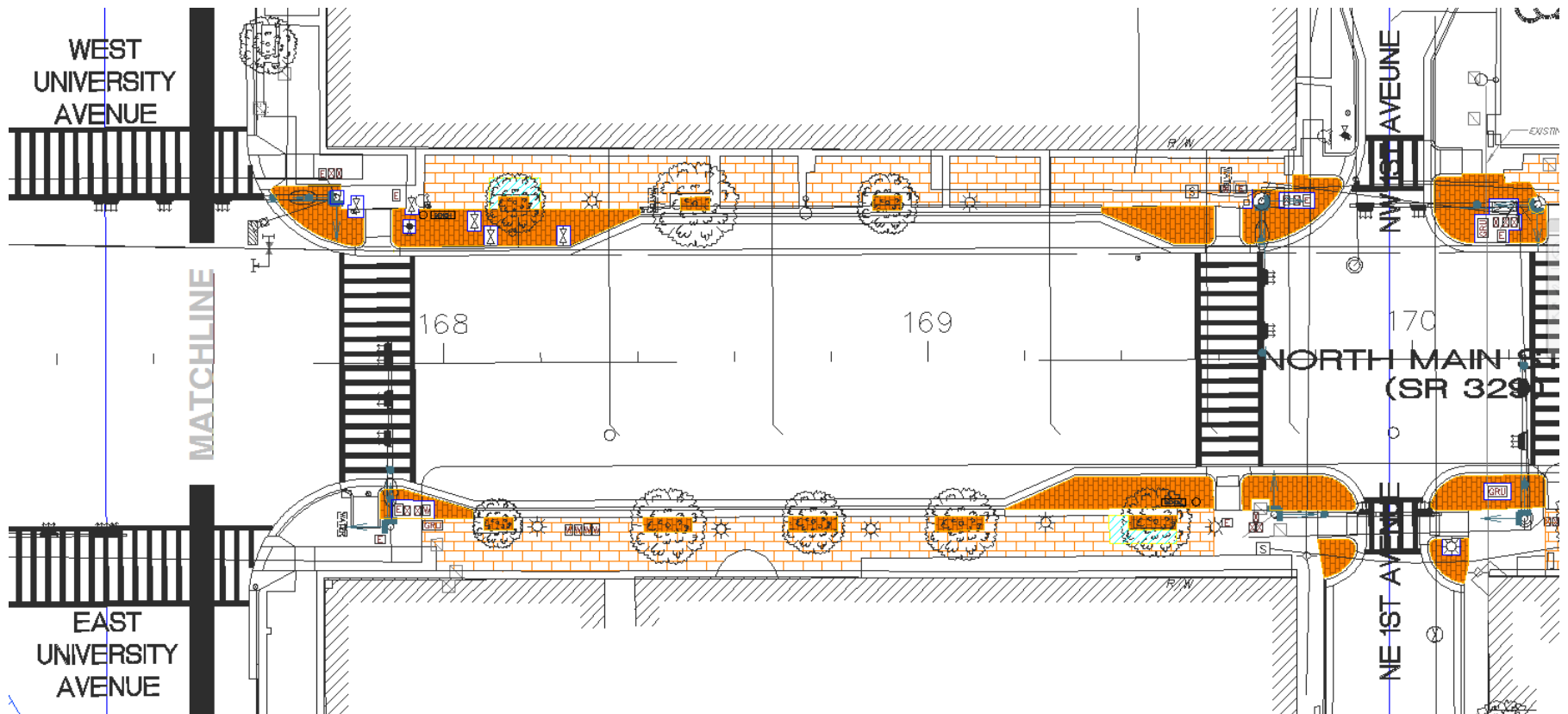

- Mid-Block Crosswalks



- Mid-Block Crosswalks



- Landscaping
 - 31 Live Oaks, 3 Crape Myrtles
 - Planting in Open Space and Replacing Ones in Poor Health

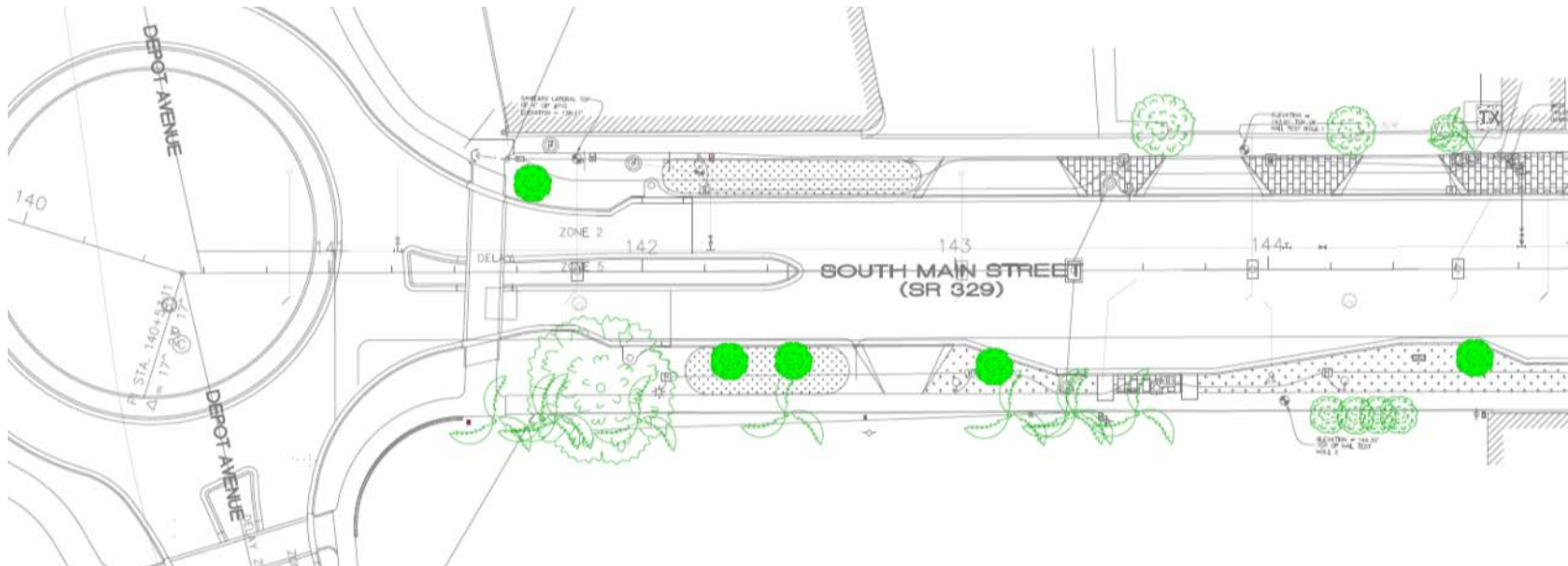

- Landscaping
 - 31 Live Oaks



- Landscaping
 - 31 Live Oaks



- Landscaping
 - 3 Crape Myrtles

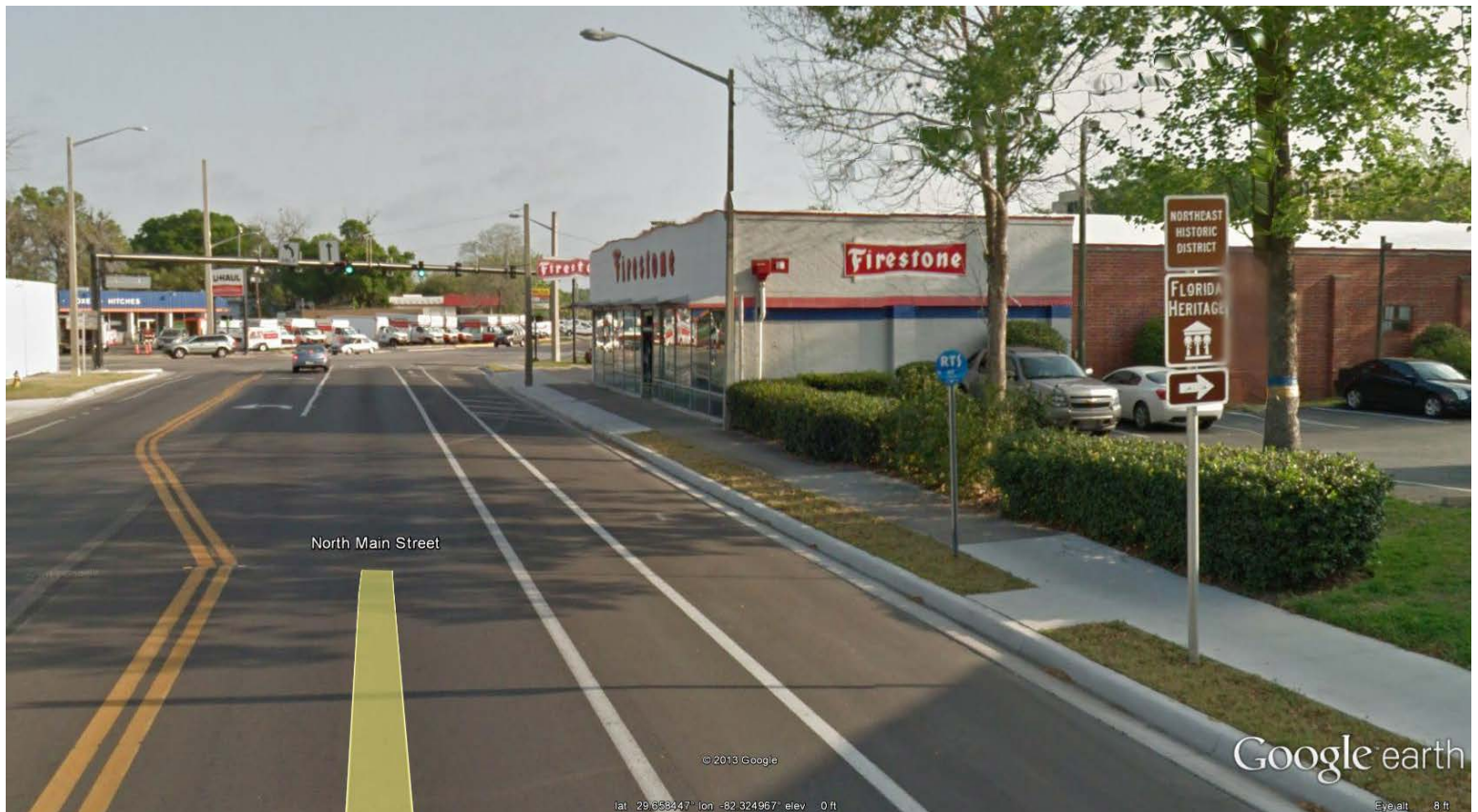

- Landscaping
 - 3 Crape Myrtles

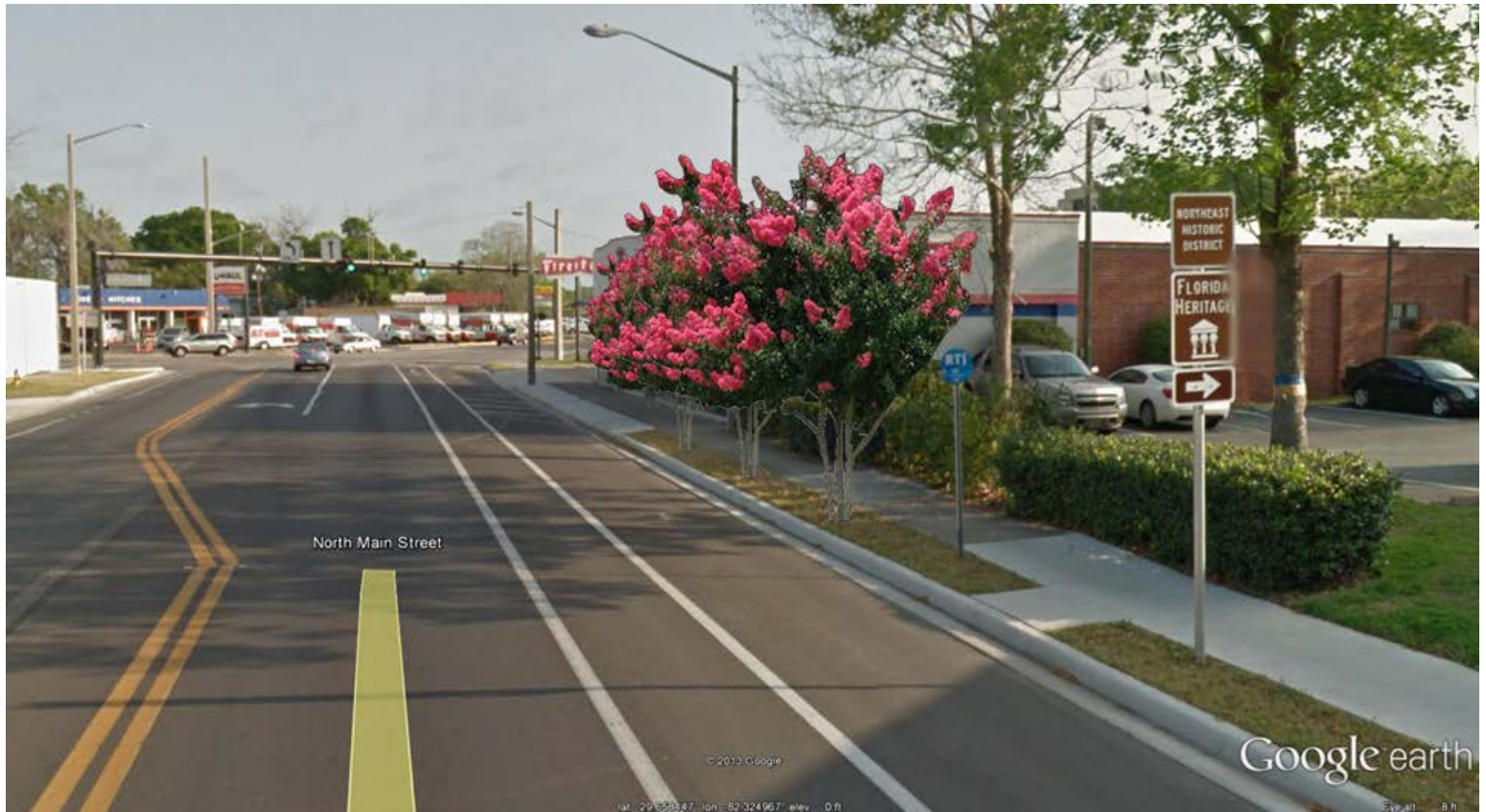

- Street Furniture
 - 17 Benches & Trash Cans

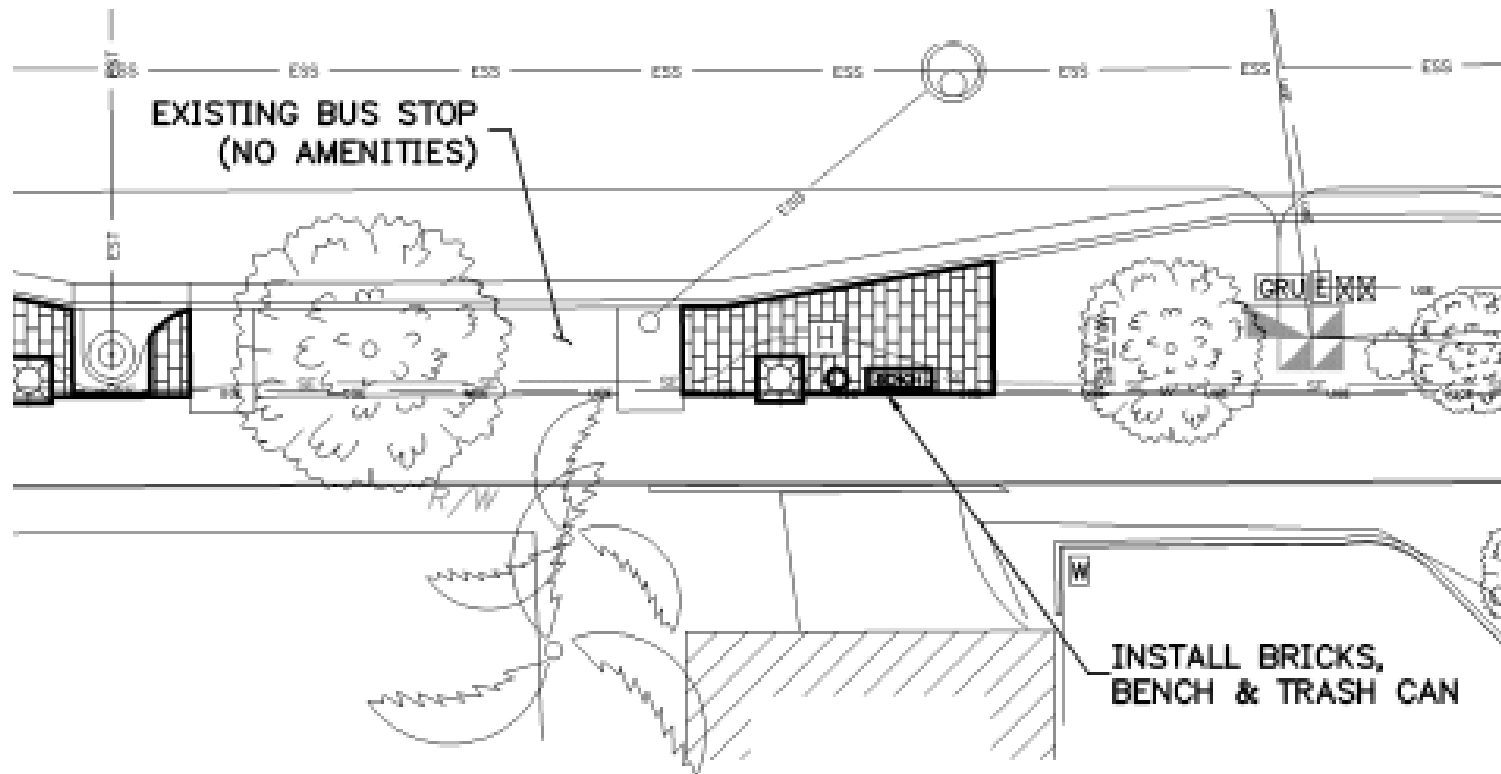

- Street Furniture
 - 17 Benches & Trash Cans



- Street Furniture
 - 17 Benches & Trash Cans



PHASE 1 & 2 FUNDING

- Budget for Phase 1&2: \$1,715,256
- Encumbered & Expended: \$1,233,820
- Available for Phase 2 Construction: \$481,436

PHASE 1 & 2 FUNDING

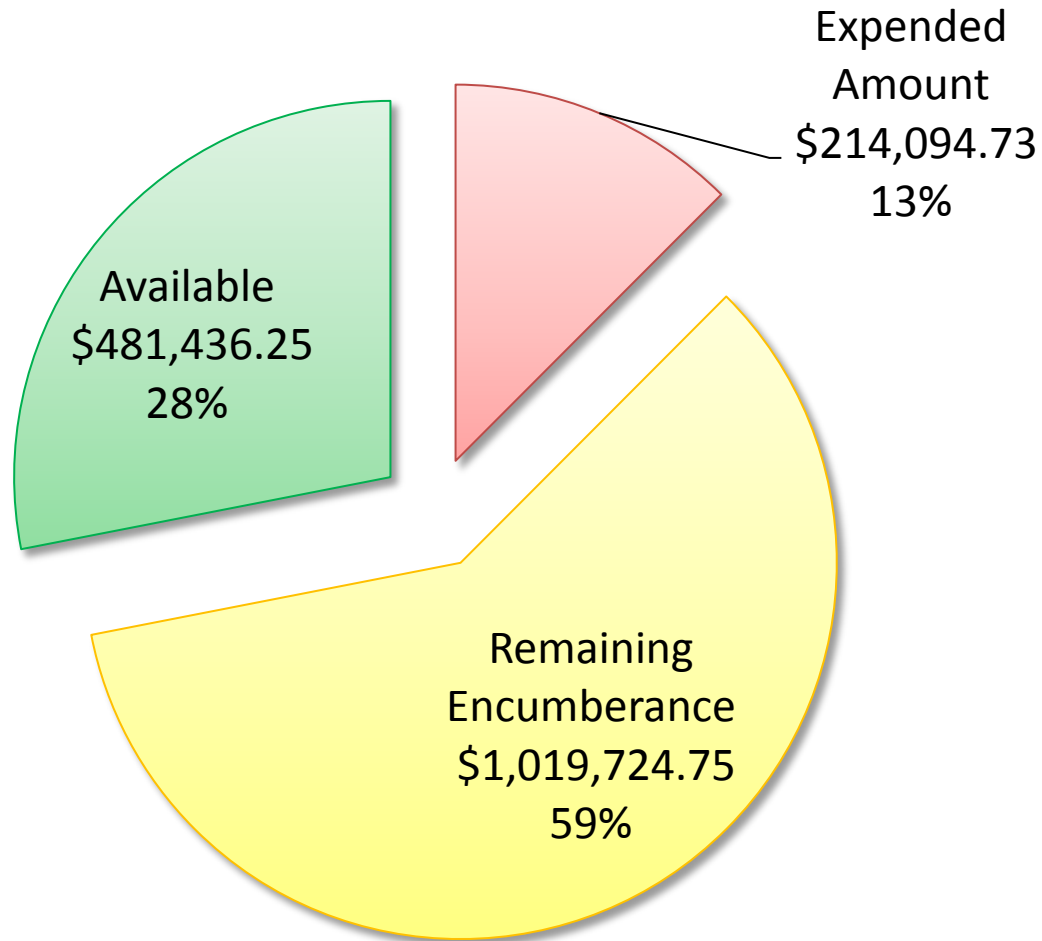

PHASE 2 FUNDING

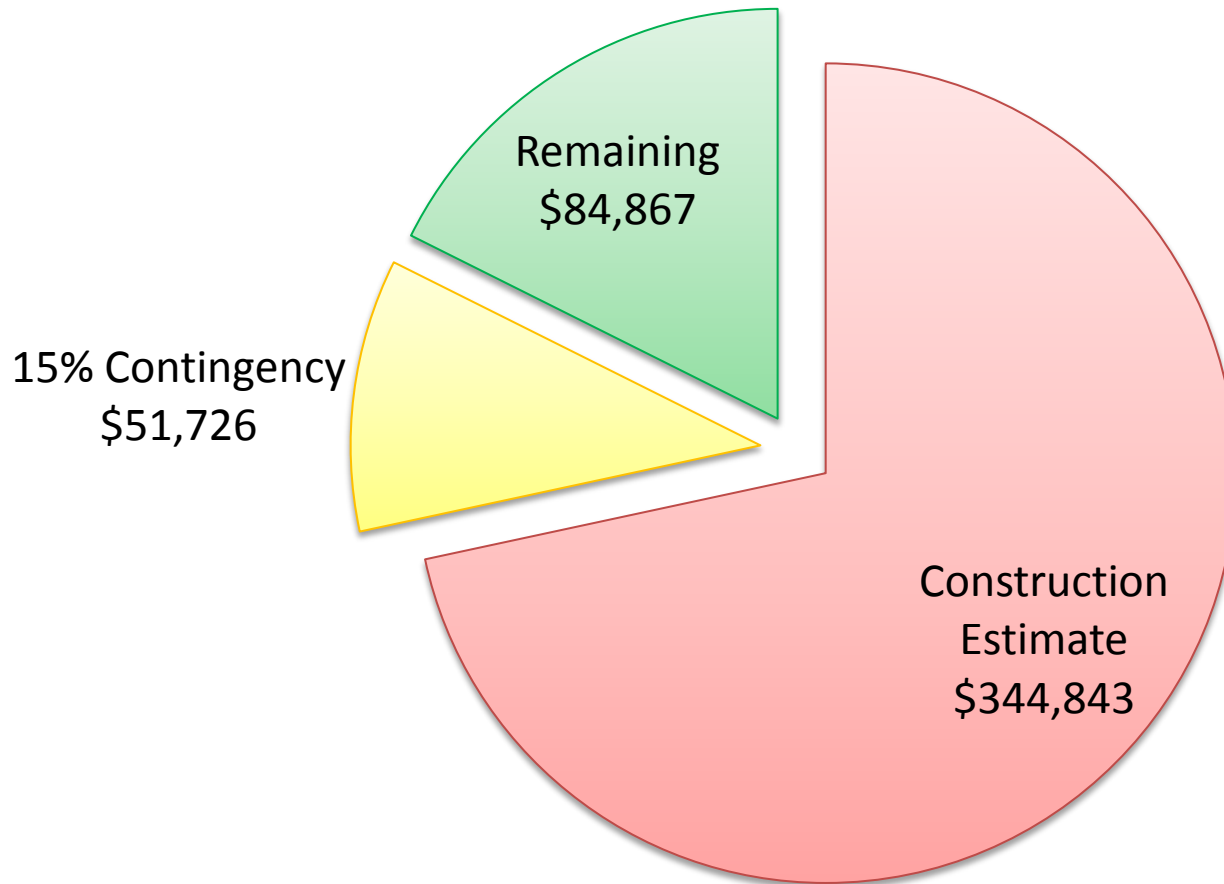

PHASE 2 FUNDING

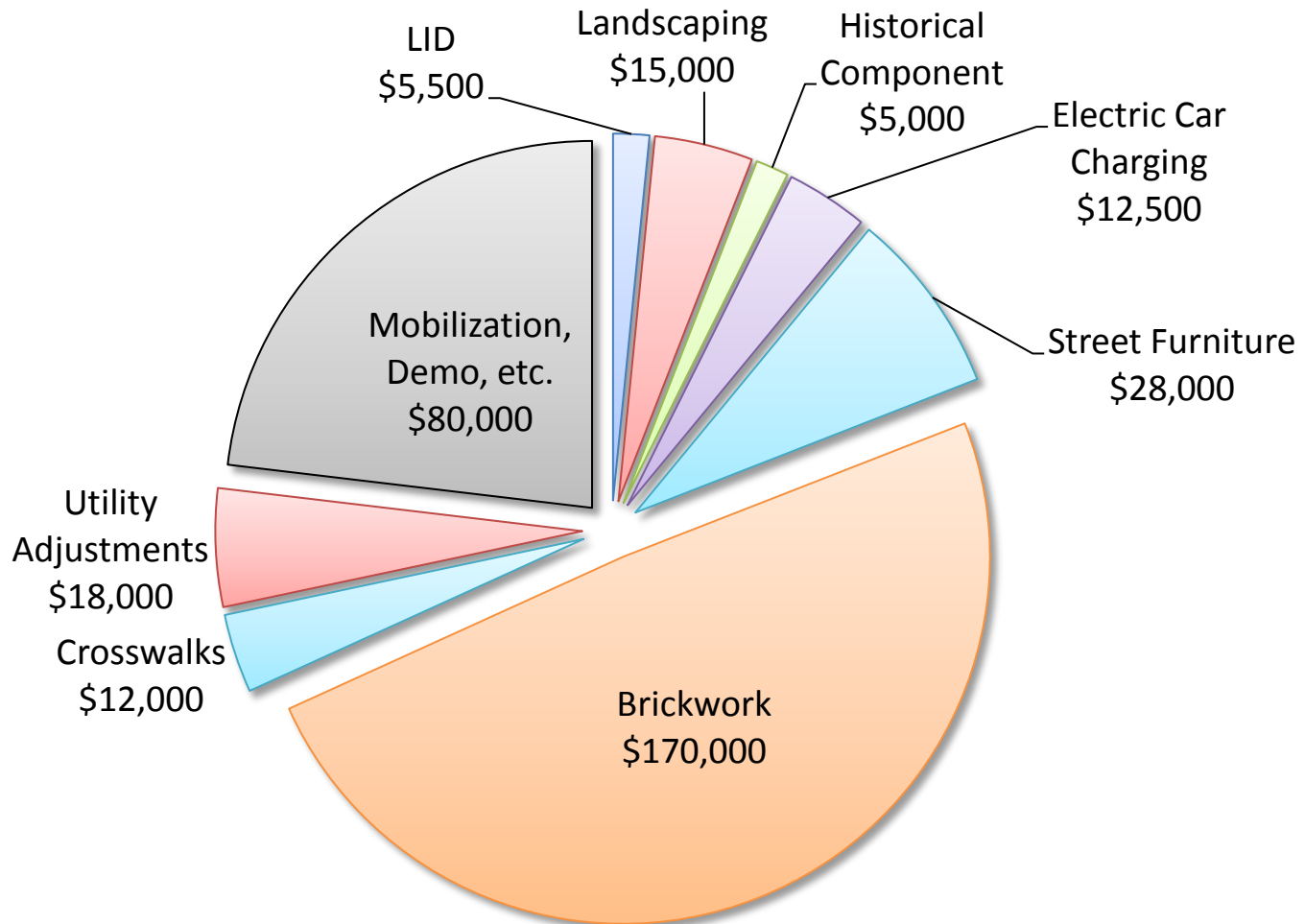

The City Commission approves this conceptual design and Public Works proceeds towards final plans.

Thank you!

Questions?