



PLANNING & DEVELOPMENT SERVICES DEPARTMENT

PO Box 490, Station 11
Gainesville, FL 32627-0490

Exhibit 4

306 N.E. 6TH AVENUE
P: (352) 334-5022
P: (352) 334-5023
F: (352) 334-2648**TO: Historic Preservation Board****Item Number: 4****FROM: Planning & Development Services Department
Staff****DATE: December 2,
2014****SUBJECT: Petition HP-14-68. City of Gainesville. Make a finding that the buildings are contributing structures in the NE Residential Historic District. Located at 207 NE 7th Street.****Recommendation**

Staff recommends approval of Petition HP-14-68 and referring the item to the City Plan Board to amend the NE Residential Historic District map to show these contributing structures.

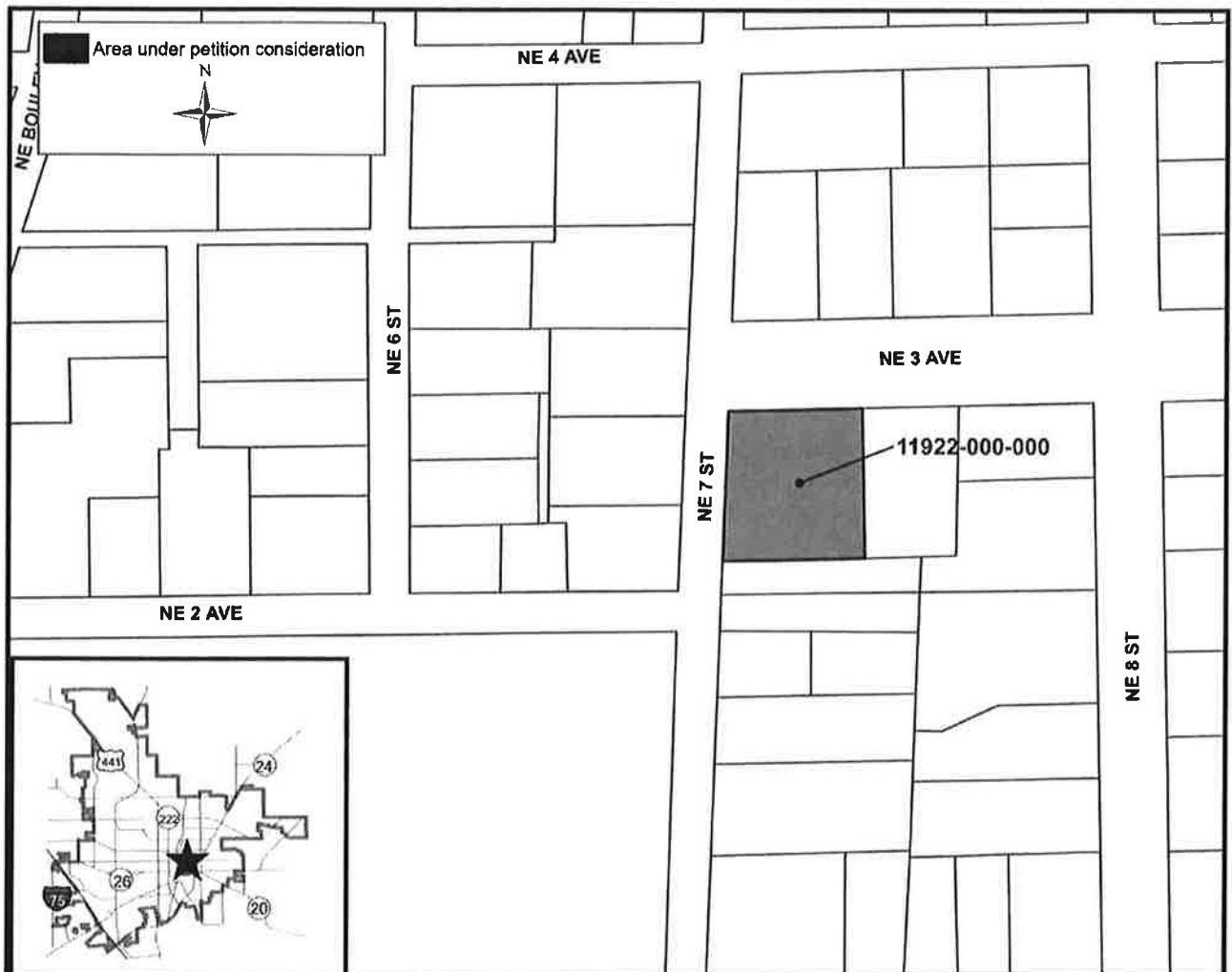

Petition HP-14-68
December 2, 2014

Description

This petition requests that the Historic Preservation Board make a finding that the buildings at 207 NE 7th Street are contributing structures in the NE Residential Historic District. In addition, staff recommends that the Historic Preservation Board formally refer this item to the City Plan Board to amend the NE Residential Historic District map to show these buildings as contributing structures.

The parcel is approximately 0.48 acres in size. The property has RMF-5 zoning, which is a low-density, multi-family zoning. The property is in use as a nursing home.

Background Information

On January 6, 2009, the Historic Preservation Board heard Petitions 4COA-09HPB and 1AVT-09HPB. These petitions concerned rehabilitation/renovation of two residences that were moved from SW 9th Road to 207 NE 7th Street in the NE Residential Historic District. In addition, there was a request for an ad valorem tax exemption related to the work on the buildings. At that meeting, there was a mention in the staff report that the HPB make a determination that the buildings be eligible for the tax exemption and contributing structures to the NE Residential Historic District. Unfortunately, the recommendation about the structures being contributing was not explicitly stated in the motion for approval of the petitions. There was also no formal recommendation to amend the NE Residential Historic District map to show the buildings as contributing. Since changes to contributing status on historic district maps also require an action by the City Plan Board to amend the map to show properties as contributing, staff is requesting that the Historic Preservation Board make that recommendation.

Basis for Recommendation

The staff recommendation that the buildings are contributing to the NE Residential Historic District is based on the following:

1. The buildings meet the age criteria for contributing structures. According to the Alachua County Property Appraiser's Office, one structure was built in 1935 and the other was built in 1939.
2. The buildings possess original architectural details and distinctive characteristics of the period and contribute to the historic fabric of the district.

Recommendation

Make a finding that the buildings are contributing structures to the NE Residential Historic District and refer this petition to the City Plan Board to amend the NE Residential Historic District map to show the buildings as contributing on the map.

Petition HP-14-68
December 2, 2014

Respectfully submitted,

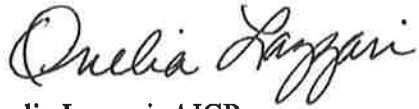
A handwritten signature in black ink, reading "Onelia Lazzari". The signature is fluid and cursive, with the first name "Onelia" and last name "Lazzari" clearly distinguishable.

Onelia Lazzari, AICP
Principal Planner

List of Exhibits

Exhibit 1 Application

Exhibit 2 Photos of the Property