

SOUTHWEST 4TH AVENUE

Partnership Opportunity for Utility Undergrounding & Lighting

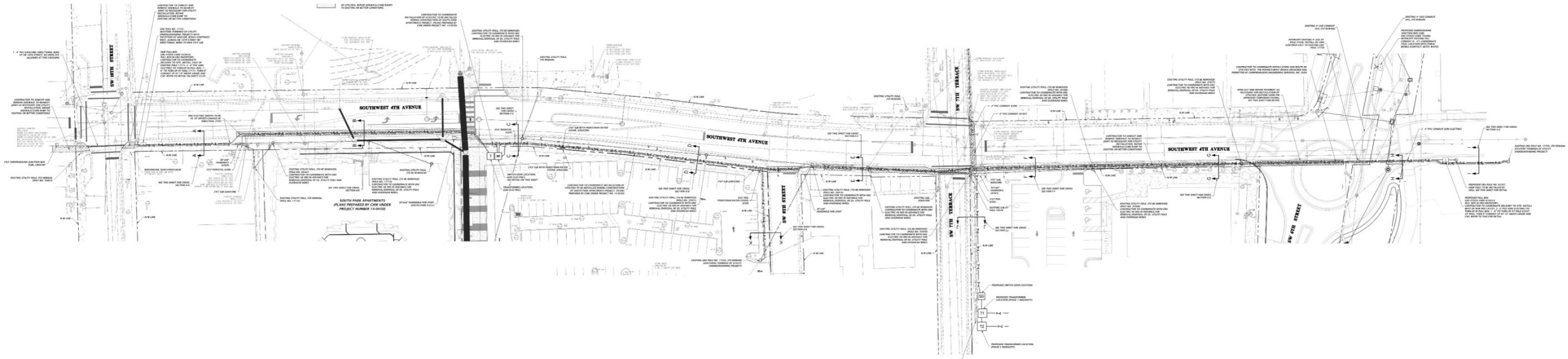

August 21, 2017 CRA Board Meeting

SOUTHWEST 4TH AVENUE

Utility Undergrounding SW 10th Street to SW 6th Street

CONTEXT AREA



SOUTHWEST 4TH AVENUE

Utility Undergrounding SW 10th Street to SW 6th Street

HISTORY

- FALL 2013 - CITY COMMISSION APPROVES BASIS OF DESIGN FOR RECONSTRUCTION OF SW 6TH STREET
- SUMMER 2014 - CRA COMPLETES UTILITY UNDERGROUNDED @ INNOVATION SQUARE
- 2014-2015 - TRIMARK PROPERTIES BEGINS PLANNING CASCADES AND INGENUITY
- FALL 2014 - TRIMARK / GRU / PUBLIC WORKS BEGIN COORDINATING JOINT UTILITY TRENCH
- WINTER 2017 - TRIMARK / PUBLIC WORKS ENGAGE IN P3 TO UNDERGROUND ACROSS SW 6TH



SOUTHWEST 4TH AVENUE

Utility Undergrounding SW 10th Street to SW 6th Street

CONTEXT AREA (BY SEGMENT)

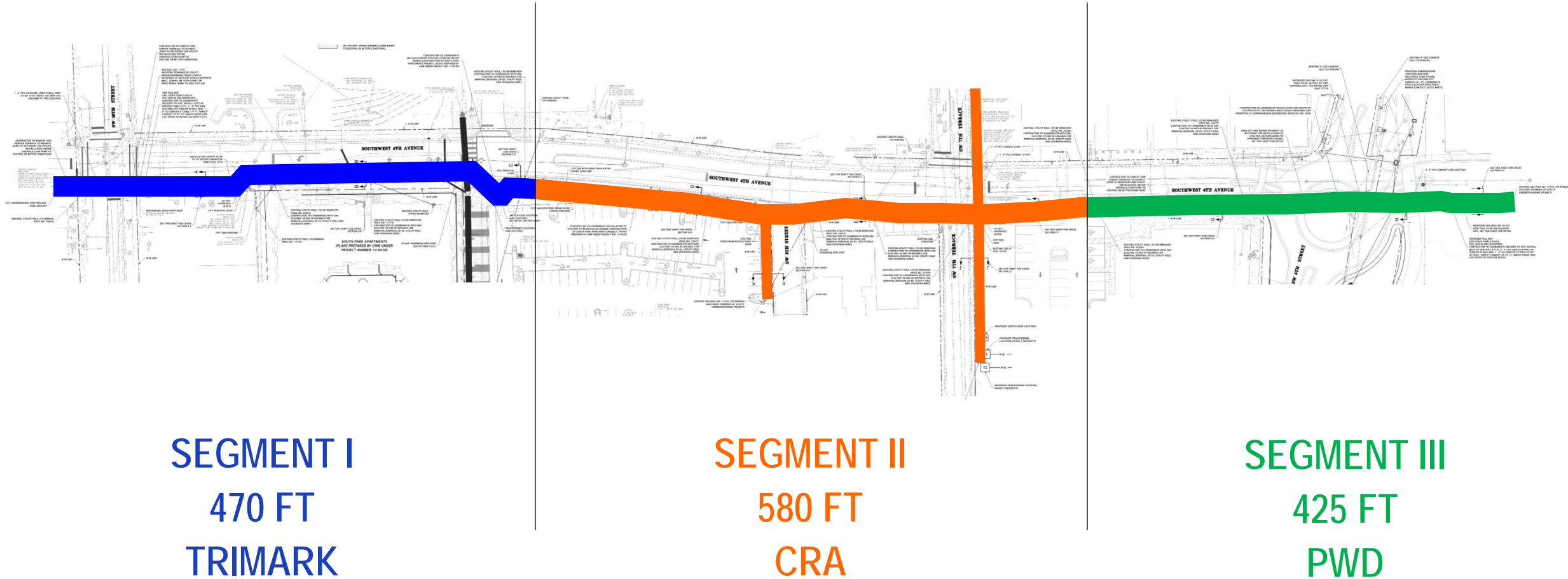

SOUTHWEST 4TH AVENUE

Utility Undergrounding SW 10th Street to SW 6th Street

PROJECT SCOPE

- 3 SEGMENTS
 - SEGMENT 1 – TRIMARK
 - SEGMENT 3 – PUBLIC WORKS
 - SEGMENT 2 – CRA
- 1900 FEET (SW10TH ST to SW 6TH ST)
- INNOVATION SQUARE FRONTAGE
- ALL UTILITIES INCLUDED
 - GRU ELECTRIC
 - GRUCOM
 - COX
 - AT&T



SOUTHWEST 4TH AVENUE

Utility Undergrounding SW 10th Street to SW 6th Street

PWD PROJECT REQUIREMENTS

- SEGMENT 3 UNDERGROUNDING IS A PREREQUISITE OF THE CITY'S SW 6TH STREET RECONSTRUCTION PROJECT

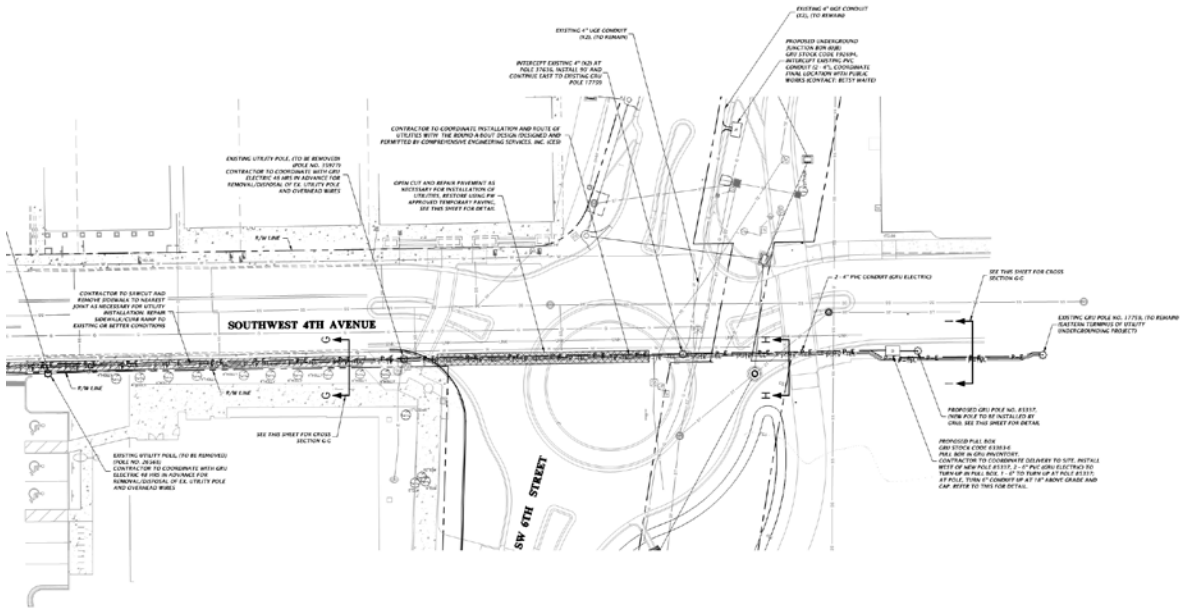

SOUTHWEST 4TH AVENUE

Utility Undergrounding SW 10th Street to SW 6th Street

PROJECT BENEFITS

- COHESIVE UNDERGROUNDING ALONG THE CORRIDOR
- ALIGNS WITH UF, CITY AND CRA-CPUH STRATEGIC PLANS



SOUTHWEST 4TH AVENUE

Utility Undergrounding SW 10th Street to SW 6th Street

PROJECT DELIVERY

PUBLIC-PRIVATE PARTNERSHIP (P3)

- PUBLIC WORKS, TRIMARK, CRA-CP/UH DISTRICT
- CM DELIVERY W/ DE SCORPIO CORPORATION
 - UNDER CONTRACT WITH TRIMARK
 - CURRENTLY MOBILIZED ON CASCADES & SW 9TH STREET INFRASTRUCTURE PROJECT
 - BID-OUT GMP PROPOSAL
 - SEPARATE PRICING FROM GRU, GRU.COM, AT&T AND COX FOR CONDUCTORS / CABLING

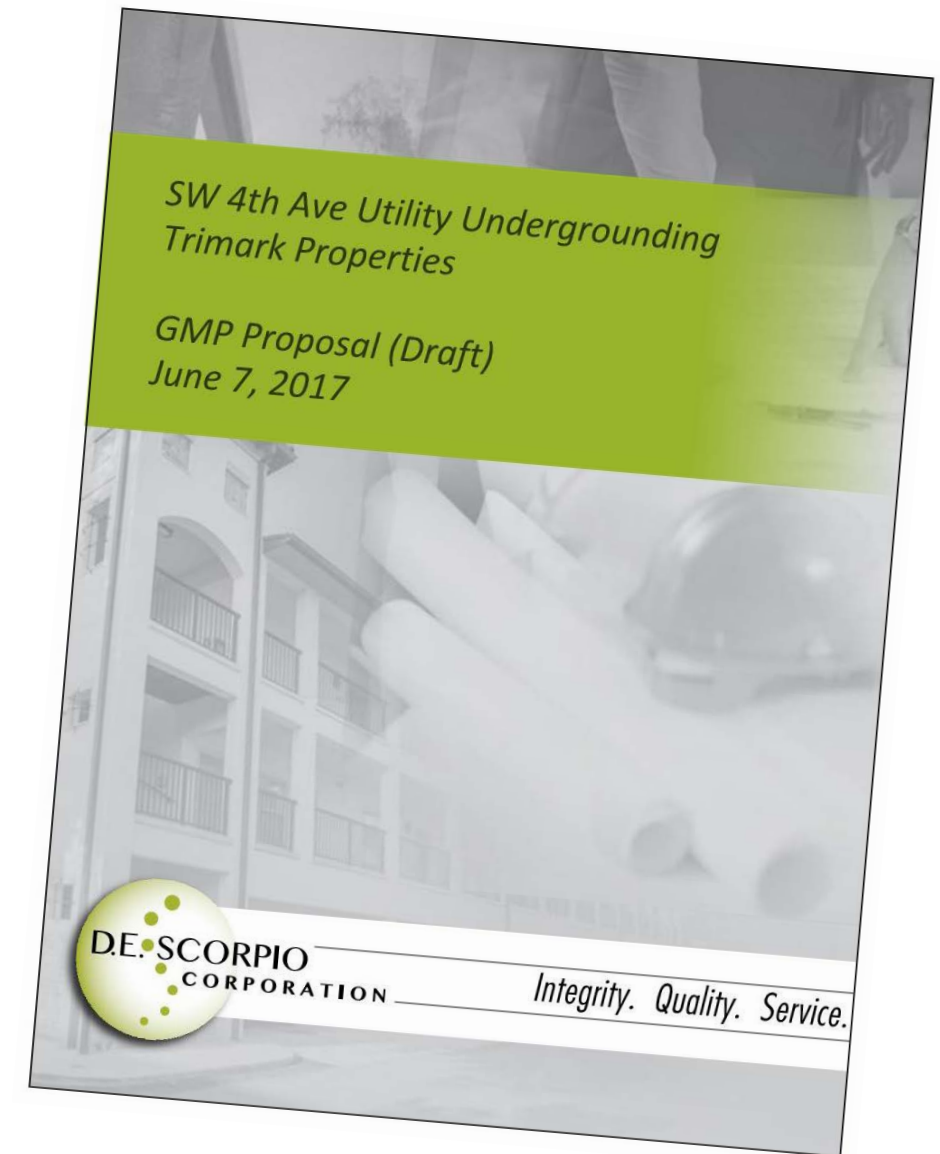

SOUTHWEST 4TH AVENUE

Utility Undergrounding SW 10th Street to SW 6th Street

PROJECT COST BREAKDOWN

■	SEGMENT 1 TRIMARK	\$222,520
■	SEGMENT 2 CRA	\$346,919 [*]
■	SEGMENT 3 PWD	\$186,147
■	STREET LIGHTING CRA	\$152,216 [*]
	TOTAL	\$907,802
	[*] CRA PORTION	\$500,135

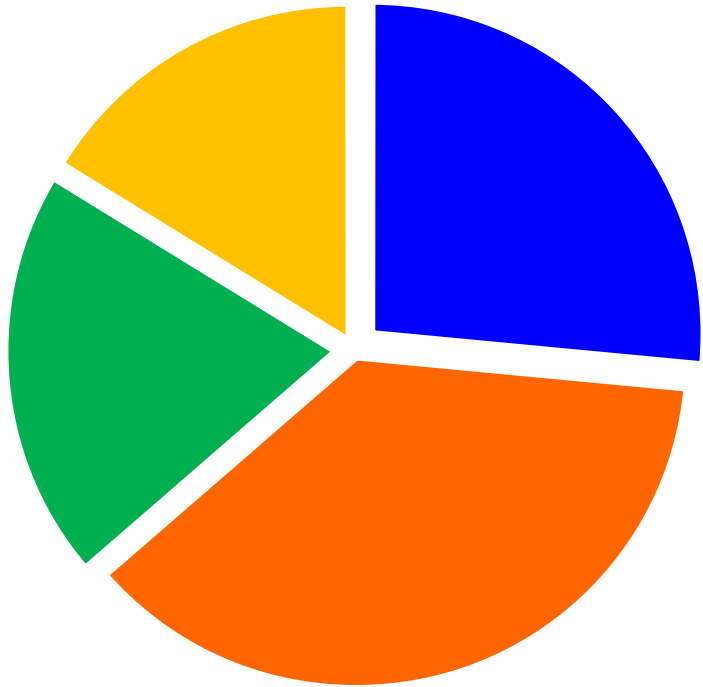

SOUTHWEST 4TH AVENUE

Utility Undergrounding SW 10th Street to SW 6th Street

RECOMMENDATION

CRA EXECUTIVE DIRECTOR TO CRA BOARD: APPROVE THE PUBLIC PRIVATE PARTNERSHIP AND CRA FUNDING OF SW 4TH AVENUE SEGMENT II UNDERGROUNDING AND STREET LIGHTING AS DESCRIBED, IN AN AMOUNT NOT TO EXCEED \$500,135

